

Always there to help you

Register your product and get support at
www.philips.com/welcome

CED232



User manual

PHILIPS

Contents

1 Important	2
Safety	2
Notice	2
2 Your car audio system	4
Introduction	4
What's in the box	4
Overview of the main unit	5
Overview of the remote control	6
3 Install the car audio	8
Connect wires	8
Mount into the dashboard	10
Attach the front panel	11
4 Get started	12
Prepare the remote control	12
Turn on and turn off	12
Set clock	12
5 Play audio/video/picture	13
Load and eject discs	13
Insert and remove USB device	13
Skip/search	14
Select Language	14
Select audio language	14
Intro play	14
Repeat play	14
Random play	15
Zoom	15
6 Radio	15
Manual tune to a radio station	15
Auto tune to a radio station	15
Store stations manually	15
Store stations automatically	16
Select the preset station	16
Play with RDS	16
7 Adjust sound	17
Adjust volume	17
Mute	17
Dynamic Bass Boost	17
MAX sound	17
Select equalizer settings	17
Select listening zone	18
Other sound settings	18
8 System settings	19
Adjust general settings	19
Select video settings	20
Select language settings	21
Adjust tuner settings	21
9 Other settings	22
Turn on or off the screen backlight	22
Select Video Output format	22
Listen to other devices	22
Reset	22
Replace fuse	22
10 Product information	23
General	23
Disc player	23
Tuner	23
LCD	23
Compatible USB devices	23
Supported formats	23
Unsupported formats	24
11 Troubleshooting	24

1 Important

Safety

- Read and understand all instructions before you use the apparatus. If damage is caused by failure to follow instructions, the warranty does not apply.
- Use of controls or adjustments or performance of procedures other than herein may result in hazardous radiation exposure or other unsafe operation.
- This unit is designed for negative ground (earth) 12 V DC operation only.
- To reduce the risk of traffic accident, do not watch video during driving.
- To ensure safe driving, adjust the volume to a safe and comfortable level.
- Improper fuses can cause damage or fire. When you need to change the fuse, consult a professional.
- Use only the supplied mounting hardware for a safe and secure installation.
- To avoid short circuit, do not expose the apparatus, remote control or remote control batteries to rain or water.
- Never insert objects into the ventilation slots or other openings on the apparatus.
- Never place any objects other than discs into the disc tray/slot.
- Visible and invisible laser radiation when open. Avoid exposure to beam.
- Risk of damage to the screen! Never touch, push, rub or strike the screen with any object.
- Never use solvents such as benzene, thinner, cleaners available commercially, or anti-static sprays intended for discs.
- Clean the apparatus with soft, damp cloth. Never use substances such as alcohol, chemicals or household cleaners on the apparatus.
- The product/remote control may contain a coin/button type battery, which can be swallowed. Keep the battery out of reach

of children at all times! If swallowed, the battery can cause serious injury or death. Severe internal burns can occur within two hours of ingestion.

- If you suspect that a battery has been swallowed or placed inside any part of the body, seek immediate medical attention.
- When you change the batteries, always keep all new and used batteries out of reach of children. Ensure that the battery compartment is completely secure after you replace the battery.
- If the battery compartment cannot be completely secured, discontinue use of the product. Keep out of reach of children and contact the manufacturer.

Notice



Be responsible
Respect copyrights

The making of unauthorized copies of copy-protected material, including computer programs, files, broadcasts and sound recordings, may be an infringement of copyrights and constitute a criminal offence. This equipment should not be used for such purposes.



Manufactured under license from Dolby Laboratories.

"Dolby" and the double-D symbol are trademarks of Dolby Laboratories.

Other trademarks and trade names are those of their respective owners.

This apparatus includes this label:



Environmental information

All unnecessary packaging has been omitted. We have tried to make the packaging easy to separate into three materials: cardboard (box), polystyrene foam (buffer) and polyethylene (bags, protective foam sheet.)

Your system consists of materials which can be recycled and reused if disassembled by a specialized company. Please observe the local regulations regarding the disposal of packaging materials, exhausted batteries and old equipment.

Disposal of your old product and batteries

Your product is designed and manufactured with high quality materials and components, which can be recycled and reused.

Never dispose of your product with other household waste. Please inform yourself about the local rules on the separate collection of electrical and electronic products and batteries. The correct disposal of these products helps prevent potentially negative consequences on the environment and human health.

Your product contains batteries, which cannot be disposed of with normal household waste.

Please inform yourself about the local rules on separate collection of batteries. The correct disposal of batteries helps prevent potentially negative consequences on the environment and human health.

Please visit www.recycle.philips.com for additional information on a recycling center in your area.

Any changes or modifications made to this device that are not expressly approved by

WOOX Innovations may void the user's authority to operate the equipment.

2014 © WOOX Innovations Limited. All rights reserved.

Specifications are subject to change without notice. WOOX reserves the right to change products at any time without being obliged to adjust earlier supplies accordingly.

2 Your car audio system

Congratulations on your purchase, and welcome to Philips!

To fully benefit from the support that Philips offers, register your product at www.Philips.com/welcome.

Read this user manual carefully before you install and use the unit. Save it for future reference.

Introduction

With the in-car audio system, you can enjoy your drive while you listen to:

- FM or AM (MW) radio
- Audio from USB drive or external devices.
- Music CDs
- DVD and VCD video

What's in the box

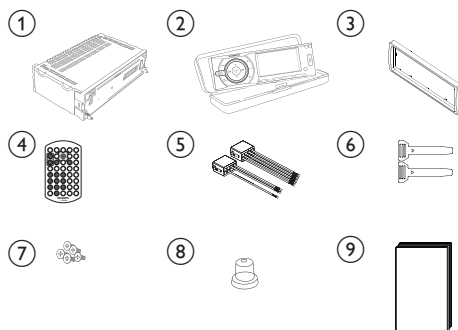

- ① Main unit (with a sleeve)
- ② Carrying case (with front panel included)
- ③ Trim plate
- ④ Remote control
- ⑤ ISO male connector X 2
- ⑥ Disassembly tool X 2
- ⑦ Screw X 4
- ⑧ Rubber cushion
- ⑨ User manual

Overview of the main unit

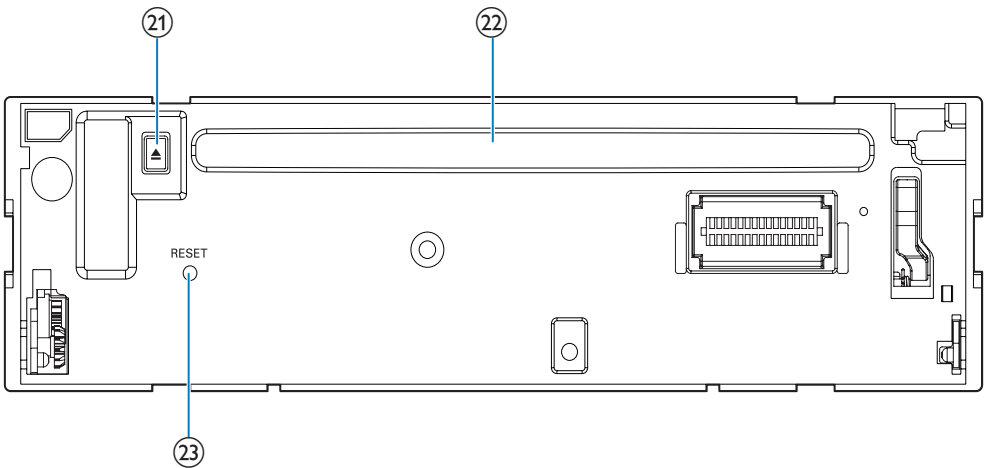
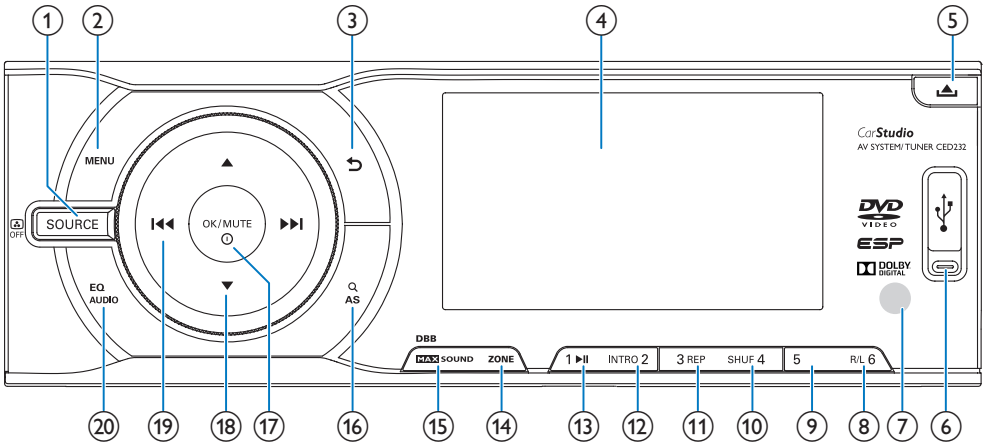

① SOURCE

- Press to select source.
- Pres and hold to change the brightness of the display or turn off the display.

② MENU

- Access the system menu.

③ ↶

- Return to previous menu.

④ Screen

⑤ 🔒

- Unlock the front panel.

⑥ USB socket

⑦ Remote control sensor

⑧ R/L, 6

- Select preset station no. 6.
- Select audio channel.

⑨ 5, ■

- Select preset station no. 5

- Stop playback.
- ⑩ **SHUF, 4**
- Turn random play on or off.
 - Select preset station no. 4
- ⑪ **3, REP**
- Select repeat play mode.
 - Select preset station no. 3
- ⑫ **INTRO, 2**
- Turn scan play on or off.
 - Select preset station no. 2
- ⑬ **1, ►||**
- Start play.
 - Pause or resume play.
 - Select preset station no. 1
- ⑭ **ZONE**
- Select listening zone.
- ⑮ **DBB, MAX SOUND**,
- Turn on or off Dynamic Bass Boost (DBB) sound and maximum volume.
- ⑯ **Q, AS**
- Store radio station automatically.
- ⑰ **OK/MUTE ◯**
- Turn the unit on or off.
 - Turn mute on or off.
 - Adjust volume.
 - Confirm selection.
- ⑱ **▲ / ▼**
- Select tuner band.
 - Select folder:
- ⑲ **◀◀ / ▶▶**
- Tune for radio station.
 - Skip/search for track.
- ⑳ **EQ/AUDIO**
- Select equalizer (EQ) setting.
 - Access audio setting menu.
- ㉑ **▲**
- Eject disc.
- ㉒ **Disc slot**
- ㉓ **RESET**
- Restore default settings.

Overview of the remote control

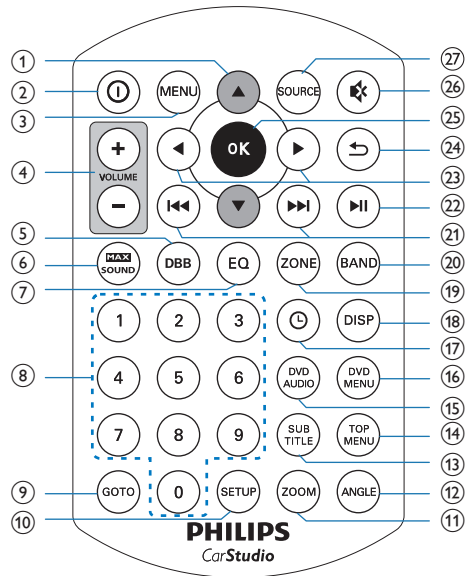

- ① **▲ / ▼**
- Skip to the previous or next track, chapter, or file.
 - Navigate through on-screen menus.
- ② **◯**
- Press to power on the system.
 - Press and hold to power off the system.
- ③ **MENU**
- Access or exit the system menu.
- ④ **VOLUME + / -**
- Press to increase or decrease the volume.
- ⑤ **DBB**
- Enable or disable the DBB (Dynamic Bass Boost) sound effect.
- ⑥ **MAX SOUND**
- Enable or disable the **MAX Sound** effect.

- ⑦ **EQ**
 - Press repeatedly to select a preset sound equalizer.
- ⑧ **Numeric buttons**
 - Enter numbers.
- ⑨ **GOTO**
 - Skip to a chapter/title/track/file or a point of a video/audio directly.
- ⑩ **SETUP**
 - Access or exit the menu for audio and video output settings.
- ⑪ **ZOOM**
 - Zoom in or out of the picture.
- ⑫ **ANGLE**
 - Select an available picture viewing angle.
- ⑬ **SUB TITLE**
 - Select an available subtitle.
- ⑭ **TOP MENU**
 - Return to or exit the top menu.
- ⑮ **DVD AUDIO**
 - Select an audio language or audio channel.
- ⑯ **DVD MENU**
 - Access or exit the DVD menu of a DVD disc.
- ⑰ **⊕**
 - Press to display the set clock.
- ⑱ **DISP**
 - Press repeatedly to display available information about the current track.
- ⑲ **ZONE**
 - Select a music listening zone.
- ⑳ **BAND**
 - Press to return to radio mode.
 - Press repeatedly to select a tuner band.
- ㉑ **I◀◀/▶▶I**
 - Tune to a radio station.
 - Press to skip to the previous/next track.
 - Press and hold to rewind a chapter/ title/track or search forward fast.
- ㉒ **▶||**
 - Start, pause, or resume the play.
- ㉓ **◀ / ▶**
 - Skip to the previous or next track, chapter, or file.
 - Navigate through on-screen menus.
- ㉔ **↶**
 - Return to the previous menu or exit.
- ㉕ **OK**
 - Confirm an option.
- ㉖ **✳**
 - Press to mute the speakers or release them from mute status.
- ㉗ **SOURCE**
 - Press repeatedly to select a source.

3 Install the car audio

These instructions are for a typical installation. However, if your car has different requirements, make the corresponding adjustment. If you have any questions regarding installation kits, consult your Philips car audio dealer.

! Caution

- This unit is designed for negative ground (earth) 12V DC operation only.
- Always install this unit in the car dashboard. Other locations can be dangerous as the rear of the unit heats up during use.
- To avoid short-circuit: before you connect, ensure that the ignition is off.
- Ensure that you connect the yellow and red power supply leads after all other leads are connected.
- Ensure that all loose leads are insulated with electrical tape.
- Ensure that the leads do not get caught under screws or parts that will move (e.g. seat rail).
- Ensure that all ground (earth) leads are run to a common ground (earth) point.
- Use only the supplied mounting hardware for a safe and secure installation.
- Improper fuses can cause damage or fire. When you need to change the fuse, consult a professional.

These instructions are for a typical installation. However, if your car has different requirements, make the adjustment accordingly. If you have any question regarding installation kits, consult your local retailer.

☰ Note

- This system is designed for negative ground (earth) 12V DC operation only.
- Always install this system in the car dashboard. Other locations can be dangerous as the rear of the system heats up during use.
- To avoid short-circuit: before you connect, make sure that the ignition is off.
- Make sure that you connect the yellow and red power supply leads after all other leads are connected.
- Make sure that all loose leads are insulated with electrical tape.
- Make sure that the leads do not get caught under screws or iron parts that will move (e.g. seat rail).
- Make sure that all ground (earth) leads are run to a common ground (earth) point.
- Use only the supplied mounting hardware for a safe and secure installation.
- Improper fuses can cause damage or fire. When you need to change the fuse, consult a professional.
- When you connect other devices to this system, make sure that the rating of the car circuit is higher than the total fuse value of all the connected devices.
- Never connect speaker wires to the metal body or chassis of the car.
- Never connect speaker wires with stripes to one another.

Connect wires

☰ Note

- To enjoy video on an external screen, make sure that you have correctly connected the system to the screen as indicated below in step 2.
- Make sure that all loose leads are insulated with electrical tape.
- Consult a professional to connect wires as instructed below.

- 1 Check the car's wiring carefully and connect them to the the ISO male connectors.

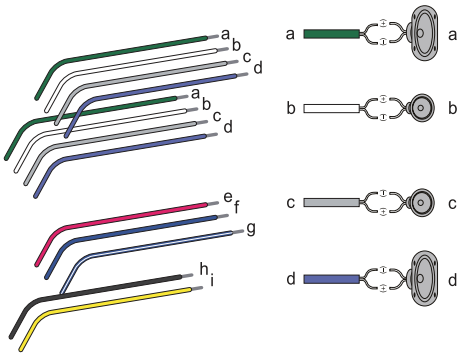

	ISO male connectors	Connect to
a	Green strip, black-edged green strip	Rear left speaker
b	White strip, black-edged white strip	Front left speaker
c	Gray strip, black-edged gray strip	Front right speaker
d	Purple strip, black-edged purple strip	Rear right speaker
e	Red strip	Ignition key +12V DC when ON/ ACC
f	Blue strip	Motor/electric antenna relay control lead
g	White-edged blue strip	Amplifier relay control lead
h	Black strip	Ground
i	Yellow strip	To the +12V car battery which is energized at all times

2 Connect the ISO male connectors and other wires to the rear panel of the main unit if necessary.

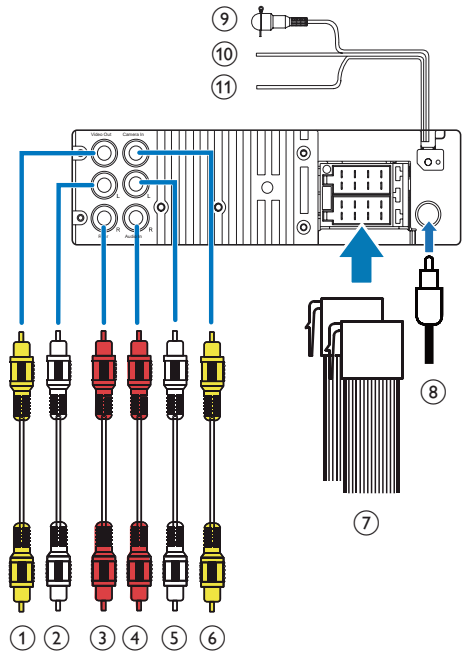

	Sockets or connectors on rear panel	External sockets or connectors
1	VIDEO OUT (Yellow socket)	Video input socket for an external display device
2	REAR L (White socket)	Rear left speaker
3	REAR R (Red socket)	Rear right speaker
4	AUDIO IN R (Red socket)	Right audio channel output socket of an external video player
5	AUDIO IN L (White socket)	Left audio channel output socket of an external video player
6	CAMERA IN (Yellow socket)	Video output socket of an external camera
7	Sockets for ISO male connectors	As indicated in step 1 above
8	Antenna socket	Radio antenna

	Sockets or connectors on rear panel	External sockets or connectors
9	VIDEO IN (Black strip)	Video output socket of an external video player
10	REVERSE CAMERA (Orange strip)	Reverse camera (B+)
11	PARKING BRAKE (Pink strip)	Parking brake (-)

Tip

- The pin arrangement for the ISO connectors depends on the type of your vehicle. To avoid damage to the unit, connect properly.

Mount into the dashboard

- If the car does not have an on-board drive or navigation computer, disconnect the negative terminal of the car battery.
 - If the car battery is not disconnected, to avoid short-circuit, make sure that the bare wires do not touch each other.
- 1 Make sure that the car dashboard opening is within these measurements.

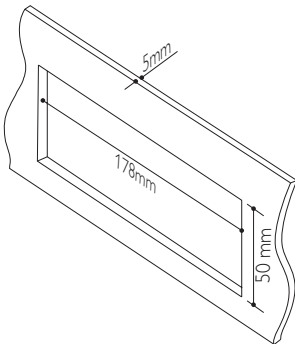

- 2 Remove the mounting sleeve with the supplied disassembly tools.

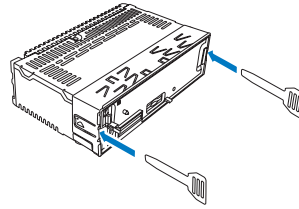

- 3 Install the sleeve into the dashboard and bend the tabs outward to fix the sleeve.

Note

- If the unit is not fixed by sleeve but by the supplied screw, skip this step.

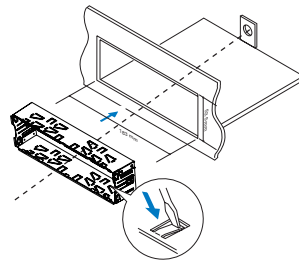

- 4 Slide the unit into the dashboard until you hear a "click".

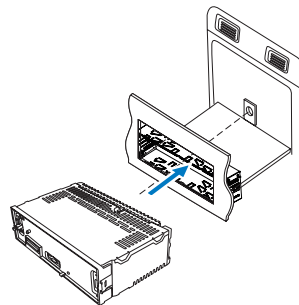

- 5 Attach the trim plate.

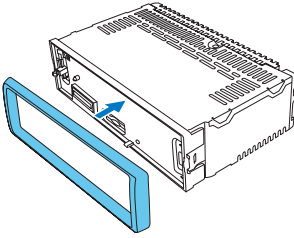

- 6 Reconnect the negative terminal of the car battery.

Detach the front panel

Note

- Before you detach the front panel, make sure that the system is turned off.

- 1 Press  to release the front panel.
- 2 Pull the front panel leftward to release it from the chassis of the main unit.
- 3 Pull the front panel outwards to remove it.

Attach the front panel

- 1 Insert the notch on the front panel to the chassis on the main unit.
- 2 Press the left end of the front panel inwards until it is securely locked with a "click".

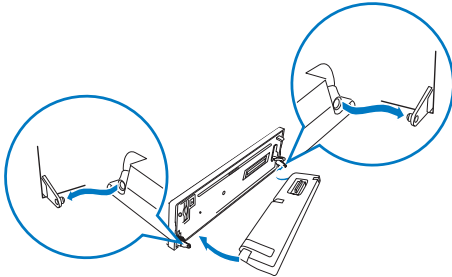

4 Get started

Prepare the remote control

For the first time use

Pull the protective sheet out.

↳ The remote control is ready for use.

Replace the battery

! Caution

- Risk of explosion! Keep batteries away from heat, sunshine or fire. Never discard batteries in fire.

☰ Note

- Remove the battery if it is exhausted or if the remote control is not to be used for a long time.
- Batteries contain chemical substances, they should be disposed of properly.
- Perchlorate Material - special handling may apply. See www.dtsc.ca.gov/hazardouswaste/perchlorate.

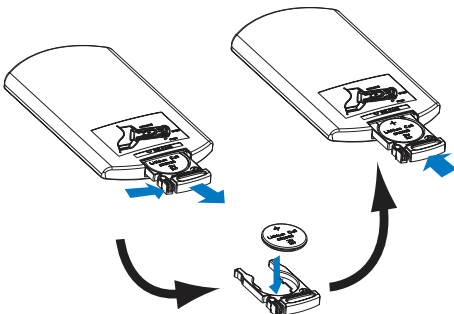

- 1 Pull out the battery tray.
- 2 Insert one CR2025 battery with correct polarity (+/-) as indicated.
- 3 Insert the battery tray.

Turn on and turn off

Turn On

Press the power button (⏻).

Turn Off

Press and hold the same power button for 3 seconds.

Set clock

- 1 Press MENU.
- 2 Press the navigation buttons to select [SETTINGS], then press ^{OK/MUTE} ⏻.
- 3 Select ⚙ [GENERAL], then press ▶▶.
- 4 Press the navigation buttons to select [TIME MODE], then press ▶▶.
↳ The time mode options are displayed:
 - [12 HOUR]
 - [24 HOUR]
- 5 Select a mode, then press ^{OK/MUTE} ⏻.
- 6 Press the navigation buttons to select [TIMEADJUST], then press ▶▶.
- 7 Press ▲ or ▼ to enter clock, then press ^{OK/MUTE} ⏻.

5 Play audio/ video/picture

Make sure that the disc or device contains playable music or video.

Note

- For CDs recorded in multiple sessions, only the first session is played.
- Does not support MP3 Pro audio format.
- It may not support and display special characters track name (ID3) or album name properly.
- It cannot play some WMA is protected by Digital Rights Management (DRM).
- The system does not display or play the folders or files that exceed the supporting limit.

Warning

- To reduce the risk of traffic accident, do not watch video during driving.

Load and eject discs

Warning

- To reduce the risk of traffic accident, do no watch video during driving.

You can play video, audio or images stored on the following discs:

- DVD video, DVD-R, DVD-RW
- VCD
- Audio CD, CD with JPEG files, CD-R, CD-RW

Note

- Ensure that the disc contains playable content.

You can play DVD discs with the following region codes: Press **▲** to open the front panel.



- 8 Insert the disc into the disc slot with label side facing up.
↳ Play resumes from the point where it was last stopped.

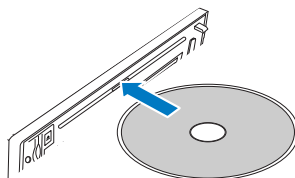

- 9 To remove the disc, press the **▲** button.
↳ When the disc is ejected, the unit switches to TUNER mode automatically.

- 10 Close the front panel.
↳ After a few seconds, the screen illuminates.
 - For video discs, press **◀◀** or **▶▶** to select an item, then press **⊕** to start playing.
 - For discs that contain MP3s, WMAs, or JPEGs, press **▲** or **▼** to select a folder, track or picture. Press **⊕** to start playing.

Tip

- If the disc is blocked in the disc compartment, press and hold the **▲** button until the disc comes out.

Insert and remove USB device

- 1 Slide down the USB socket cover.
- 2 Insert the USB device into the USB socket.

→ The unit starts playing from the USB device automatically.

- 3 To remove the USB device, press **OK/MUTE** to turn off the unit.
- 4 Remove the USB device.

Skip/search

During video and audio disc play

- To skip to a specified chapter or track, press the numeric buttons.
- To skip to the previous or next chapter or track, press **◀◀** or **▶▶**.



- To search backward or forward quickly, press **◀◀** or **▶▶** for 3 seconds.

During MP3/WMA play

- To select a track, press **▲** or **▼** to select a folder. Press **◀◀** or **▶▶** to skip to previous or next track.

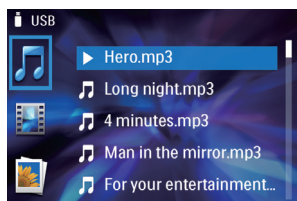

- To skip to a specified chapter or track, press the numeric buttons.

Select Language

You can select the subtitle language if the DVD or DivX discs contain two or more subtitle languages.

During play, press **SUBTITLE** on the remote control repeatedly until the language is selected.

Select audio language

You can select the audio language if the video discs contain two or more audio channels.

During play, press **R/L** on the remote control repeatedly until the language is selected.

Intro play

This feature plays the first 10 seconds of each audio track.

Press the **INTRO 2** button to select an option.

- **[INTRO 1]**: play the first 10 seconds of each audio track.
- **[SEQ PLAY]**: resume normal play.

Repeat play

There are different modes of repeat play for video, audio, and MP3/WMA.

Press the **3 REP** button repeatedly to select.

- **[RPT]: [RPT 1]** - play the current chapter or track repeatedly.
- **[RPT]: [RPT DIR]** - play the current folder repeatedly.
- **[RPT]: [RPT ALL]** - play all chapters in the title or all tracks repeatedly.
- **[RPT]: [RPT OFF]** - cancel repeat play.

Random play

There are different modes of random play for audio and MP3/WMA.

Press the **SHUF** 4 button repeatedly to select.

- **[SHUFFLE]:[ON]** - start random play for all tracks.
- **[RANDOM DIR]**: start random play in current folder.
- **[SHUFFLE]: [OFF]** - cancel random play.

Zoom

To zoom in and out of video images and pictures:

- 1 Press **ZOOM** on the remote control repeatedly.
↳ **[ZOOM]** is displayed.
- 2 Press the navigation buttons to pan across the display.

6 Radio

Manual tune to a radio station

- 1 Press **MENU**.
- 2 Press the navigation buttons to select **[RADIO]**, then press **OK/MUTE**.
- 3 Press and hold **▲** or **▼** to select band.
↳ **[FM]** or **[AM]** is display.
- 4 Press **◀◀** or **▶▶** to tune to a radio station manually.



Auto tune to a radio station

In **[RADIO]** mode, press and hold **◀◀** or **▶▶** for 3 seconds.

Store stations manually

You can store up to 6 stations in each band.

- 1 Tune to the station which you want to store.
- 2 Press and hold the numeric buttons (1 to 6) for 3 seconds.

Store stations automatically

You can store up to 6 stations in each band.

- 1 Press **SEARCH**.
↳ The six strongest stations of the selected band are saved in preset channels 1-6 automatically.

Select the preset station

- 1 Press ▲ or ▼ to select band.
↳ [FM] or [AM] is display.
- 2 Press the numeric button (1 to 6) to select the preset station.

Play with RDS

The RDS (Radio Data System) function operates only in areas with FM stations broadcasting RDS signals. If you tune to an RDS station, an RDS icon and the station name are displayed.

Search for an RDS station by PTY information

The PTY (program type) function lets you find similar programming by genre, and the radio starts searching for stations broadcasting in the selected category.

- 1 Press and hold **SEARCH**.
↳ The PTY menu is displayed.
- 2 Turn Ⓞ to select a program type, then press Ⓞ to start searching.

- 3 Select a channel.

RDS program types

Item	Program type	Description
1	NEWS	News services
2	AFFAIRS	Politics and current affairs
3	INFO	Special information programs
4	SPORT	Sports
5	EDUCATE	Education and advanced training
6	DRAMA	Radio plays and literature
7	CULTURE	Culture, religion and society
8	SCIENCE	Science
9	VARIED	Entertainment programs
10	POP M	Pop music
11	ROCK M	Rock music
12	MOR M	Light music
13	LIGHT M	Light classical music
14	CLASSICS	Classical music
15	OTHER M	Special music programs
16	WEATHER	Weather
17	FINANCE	Finance
18	CHILDREN	Children's programs
19	SOCIAL	Social Affairs
20	RELIGION	Religion
21	PHONE IN	Phone In
22	TRAVEL	Travel
23	LEISURE	Leisure
24	JAZZ	Jazz Music
25	COUNTRY	Country Music
26	NATION M	National Music
27	OLDIES	Oldies Music
28	FOLK M	Folk Music
29	DOCUMENT	Documentary
30	TES	Alarm Test
31	ALARM	Alarm

Activate AF/TA/REG/CT functions

- 1 Press and hold **MENU**.
↳ The setting menu is displayed.
- 2 Press the navigation buttons to select **[Radio] > [LOC_DX] > [DX]**, then press **⊙** to select an option.
 - **TA** (traffic announcement): allows you to receive traffic announcements automatically no matter what source you are listening to.
 - **AF** (alternate frequency): automatically searches for a different station when the tuner cannot get a good reception.
 - **REG** (regional radio): sets AF tuning region.
 - **CT** (clock time): synchronizes the clock of the unit with that on the RDS station.
- 3 Turn **⊙** to select **[ON]**, then press **⊙** to confirm.

7 Adjust sound

Adjust volume

To adjust volume, rotate ^{ON/MUTE} knob on the front panel or press **VOLUME +/-** on the remote control.

Mute

Press **⊙**  on the front panel.

- To release the speakers from mute status, press **⊙**  again.

Dynamic Bass Boost

- 1 Press **MAX SOUND / DBB** on the car audio system for 3 seconds or press **DBB** on the remote control.
 - ↳ **[DBB ON]**: The Dynamic Bass Boost (DBB) function is on.
 - ↳ **[DBB OFF]**: The DBB function is off.
- 2 Press **DBB** again to change the DBB setting.

MAX sound

- 1 Press **MAX SOUND / DBB** to produce an instant boost in bass and maximize volume.
- 2 Press **MAX SOUND / DBB** again to turn off.

Select equalizer settings

You can select preset equalizer settings, and they are:

- **[USER]**
- **[TECHNO]**

- [ROCK]
- [CLASSIC]
- [JAZZ]
- [OPTIMAL]
- [FLAT]
- [POP]

Note

- Only when you select [USER], then you can adjust the sound value of [BASS], [MID], and [TREBLE].

- 1 Press EQ/AUDIO.
↳ The current equalizer setting is displayed.

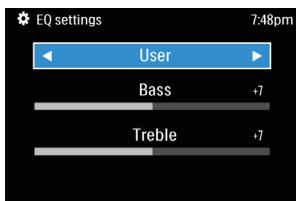

- 2 Press ◀◀ or ▶▶ to select one of the preset equalizer settings.
- 3 You can also select [USER], and then press OK/MUTE to confirm.
- 4 Then, press ▲ or ▼ to select of [BASS], and [TREBLE].
- 5 Press ◀◀ or ▶▶ to adjust the values.
- 6 Press ↵ to exit.

Select listening zone

- 1 Press ZONE.
↳ The current zone setting is displayed.



- 2 Press ◀◀ or ▶▶ to select one of the preset zone settings:
 - [ALL] - all speakers are in same volume level.
 - [LEFT] - front left speaker is louder than the rest of the speakers.
 - [RIGHT] - front right speaker is louder than the rest of the speakers.
 - [FRONT] - the front speakers are louder than the rear speakers.
- 3 Press OK/MUTE to confirm.
- 4 Press ↵ to exit.

Other sound settings

You can adjust the front and rear speaker balance, and the left and right speaker balance.

- 1 Press EQ/AUDIO for 3 seconds.
↳ The following options are displayed.

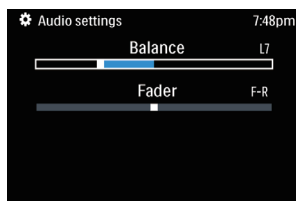

- 2 Press ▲ or ▼ to select the audio settings to be adjusted.
 - [BALANCE]: 7L to 7R (L= left speaker ; R= right speaker)
 - [FADE]: 7R to 7F (R= rear speaker ; F= front speaker)

- 3 Press **◀◀** or **▶▶** to change the value, and then press **OK/MUTE** to confirm.
 - You can also turn the control knob to select a value.
- 4 Press **↵** to exit.

8 System settings

Within system settings, there are:

- General settings,
- DVD settings,
- Language settings, and
- Radio settings.

Adjust general settings

- 1 Press **MENU**.
 - ↳ The main menu is displayed.



- 2 Press the navigation buttons to select **[SETTINGS]**, the press **OK/MUTE** to confirm.
 - ↳ The settings menu is displayed

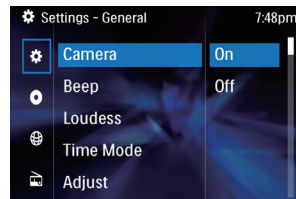

- 3 Press **▲** or **▼** buttons to select the general setting **⚙**.
- 4 Press **▶▶**, then **▲** or **▼** to select the sub-menu, and then press **OK/MUTE** to confirm.

[AV-IN]	[ON]/[OFF]
[CAMERA]	[ON]/[OFF]

[BEEP]	[ON]/[OFF]	Turn on or off the beep sound. When it turned on, each time you press a button, the device beeps
[LOUDNESS]	[ON]/[OFF]	
[TIME MODE]	[12 HOUR MODE]/ [24 HOUR MODE]	
[TIME ADJUST]		Set clock.
[PARKING]	[ON]/[OFF]	Disable or enable DVD watching during driving.
[INVERTED CAMERA]	[ON]/ [OFF]	

Select video settings

- 1 Press **MENU**.
- 2 Press the navigation buttons to select **[SETTINGS]**, then press **OK/MUTE** to confirm.
- 3 Press **▲** or **▼** to select the DVD setting **●**.
- 4 Press **▶▶**, and then **▲** or **▼** to highlight an option, then press **OK/MUTE** to confirm.

[TV SYSTEM]	[NTSC]	Used in the United States, Canada, Japan, Mexico, the Philippines, South Korea, Taiwan, and some other countries.
-------------	--------	---





	[PAL]	Used in the United States, Canada, Japan, Mexico, the Philippines, South Korea, Taiwan, and some other countries.
	[AUTO]	The correct format is set automatically. Select this option if you are not sure which format should be selected.
[TV TYPE]	[4:3 PS]	While playing a full-height picture, the sides of the picture may be trimmed.
	[4:3 LB]	While playing a wide-screen picture, black bars may appear on the top and the bottom of the screen.
	[16:9]	For widescreen display.
[PASSWORD]		Set password to restrict the play of discs. The default password is 0000.
[RATING]	[1 KID SAFE]	Acceptable for children.
	[2 G]	Acceptable for general viewers.
	[3 PG]	Parental guidance suggested.

[4 PG 13]	Unsuitable for children under age 13
[5 PGR]	Recommend parents to restrict children under 17 to view.
[6 R]	Restricted. Recommend parent to guide children under 17 to view.
[7 NC 17]	Unsuitable for children under age 17.
[8 ADULT]	Acceptable for adults only.
[DEFAULT]	Restore to default settings.
[BRIGHTNESS]	Adjust the intensity and details of dark areas.
[CONTRAST]	Adjust the intensity of bright areas.
[HUE]	Compensate for color variations.
[SATURATION]	Adjust color saturation.

- [SUBTITLE LANG]
- [MENU LANG]
- [DivX[R]VOD]
- [DEACTIVATION]





5 Press  to confirm

Adjust tuner settings

- 1 Press MENU.
- 2 Press the navigation buttons to select [SETTINGS], then press .
- 3 Press  to select [RADIO], then press .
- 4 Press the navigation buttons to select an option, then press  to confirm.

[LOC/DX]	[LOC]	Only broadcast local stations with strong signals.
	[DX]	Broadcast any stations with strong and weak signals.
[STEREO/MONO]	[STEREO]	For stereo broadcasting.
	[MONO]	For mono broadcasting.

Select language settings

- 1 Press MENU.
- 2 Press the navigation buttons to select [SETTING], then press  to confirm.
- 3 Press  or  buttons to select the language setting .
- 4 Press , and then  or  to select a language:
 - [OSD LANGUAGE]
 - [AUDIO LANG]

9 Other settings

Turn on or off the screen backlight

To change screen backlight of the system, press and hold **SOURCE**.

- Dimmer High
- Dimmer Low
- Screen backlight turn off

Select Video Output format

The default video output format is based on the format that is broadcast in your country. If the picture is distorted, change the video output.

Simply press the **P/N** button repeatedly to select the correct video output format.

Listen to other devices

You can connect an external audio/video device to the car audio system.

- 1 Connect the the device to the car audio system.
- 2 Press **MENU**.
↳ The main menu is displayed.T
- 3 Press the navigation buttons to select **[AV-IN]**.
- 4 Operate the connected the device (see the device's instructions manual).

Reset

To reset the car audio system to its default setting:

- 1 Detach the front panel.

- 2 Press **RESET** by using a ball-point pen or similar tool.
↳ All settings are erased except clock.

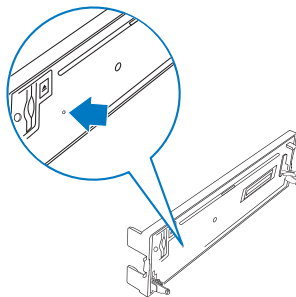

Replace fuse

If the system does not power on, the fuse may be damaged and need replacement.

- 1 Detach the front panel and take out the system.
- 2 Check the electric connection.
- 3 Buy a new fuse that matches the voltage of the damaged fuse (15A).
- 4 Replace the fuse.

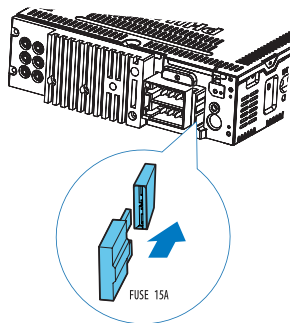

10 Product information



Note

- Product information is subject to change without prior notice.

General

Power supply	12V DC (11V - 16V), negative ground
Fuse	15A
Suitable speaker impedance	4-8 Ω
Continuous power output	21W x 4
Line output voltage	2.0V
Aux-in level	500mV
Dimensions (W x H x D)	188 x 58 x 194 mm
Weight	2.12kg
Operating temperature range	-20°C to 70 °C

Disc player

System	DVD / CD audio / MP3 system
Frequency response	20Hz - 20k Hz
Signal / noise ratio	> 75dB
Total harmonic distortion	Less than 1%
Channel separation	> 55dB
Video signal format	NTSC / PAL / AUTO
Video output	1 +/- 2.0V

Tuner

Frequency range - FM	87.5 - 108.0 MHz (50kHz per step)
Frequency range - AM (MW)	520 - 1710 kHz (9kHz per step)
Usable sensitivity - FM	8 uV
Usable sensitivity - AM (MW)	30 uV

LCD

Screen size	3 inches (16:9)
Display resolution	320 x 240 dots
Contrast ratio	300
Brightness	250 cd/m ²

Compatible USB devices

- USB flash memory (USB 2.0 or USB1.1)
- USB flash player (USB2.0 or USB1.1)

Supported formats

- USB or memory file format: FAT16, FAT32
- MP3 bit rate (data rate): 32 - 320 Kbps and variable bit rate
- WMA v9 or earlier
- Directory nesting up to a maximum of 8 levels
- Number of albums / folders: maximum 99
- Number of tracks / titles: maximum 999
- ID3 tag v2.0 or later
- File name in Unicode UTF8 (maximum length: 128 bytes)

Unsupported formats

- Empty albums: an empty album is an album that does not contain MP3 / WMA files, and is not be shown in the display.
- Unsupported file formats are skipped. For example, Word documents (.doc) or MP3 files with extension .dlf are ignored and not played.
- AAC, WAV, and PCM audio files.
- DRM protected WMA files (.wav, .m4a, .m4p, .mp4, .aac)
- WMA files in Lossless format
- ISO9660, Joliet
- Maximum title number: 512 (depending on file name length)
- Maximum album number: 255
- Supported sampling frequencies: 32 kHz, 44.1 kHz, and 48 kHz
- Supported bit-rates: 32 ~ 256 (Kbps), variable bit rates

11 Troubleshooting



Caution

- Never remove the casing of this apparatus.

To keep the warranty valid, never try to repair the system yourself.

If you encounter problems when using this system, check the following points before requesting service. If the problem remains unsolved, go to the Philips web site (www.philips.com/support). When you contact Philips, make sure that your system is nearby and the model number and serial number are available.

No power

- Car engine has not been started. Start the car engine.
- Connections is incorrect.
- Fuse has been damaged. Replace fuse.

No sound

- Volume is too low. Adjust volume.
- Speaker connections is incorrect.

No response to the remote control

- Ensure that the path between the remote control and the unit is clear from obstacles.
- From a close distance, point the remote control directly at the unit.
- Replace the remote control battery.
- The function does not work. Refer to the instructions.

Disc does not play

- Disc is upside down. Ensure the printed side is upwards.
- Disc is dirty. Clean the disc with a clean, soft, lint-free cloth. Wipe the disc outwards from the center.
- Disc is defective. Try another disc.
- Incompatible disc is used. Try another disc.

- Disc rating exceeds the restrict setting. Change the rating settings to lower one.
- Disc region code is not compatible with the unit. Use disc with proper region code.

Disc is blocked in the disc compartment

- Press and hold ▲ until the disc comes out.

No image

- Parking brake wire connection is incorrect. Check the parking wiring.

Image flashes or distorted

- Video DVD settings do not match with the DVD. Adjust video DVD settings.
- Video connection is improper. Check the connections.

Noise in broadcasts.

- Signals are too weak. Select other stations with stronger signals.
- Check the connection of the car antenna.
- Change broadcast from stereo to mono.

Preset stations lost.

- Battery cable is not connected correctly. Connect the battery cable to the terminal that is always live.

Fuse is broken

- The Fuse type is incorrect. Replace it with a 15A fuse.
- Speaker wire or power wire is grounded. Check the connections.

Display show ERR-12

- USB data error. Check the USB device.



Specifications are subject to change without notice

2014 © WOOX Innovations Limited. All rights reserved.

This product was brought to the market by WOOX Innovations Limited or one of its affiliates, further referred to in this document as WOOX Innovations, and is the manufacturer of the product. WOOX Innovations is the warrantor in relation to the product with which this booklet was packaged. Philips and the Philips Shield Emblem are registered trademarks of Koninklijke Philips N.V."

CED232_55_UM_V1.0

