

Register your product and get support at
www.philips.com/welcome

HSB2313/93



EN User manual

ZH-CN 用户手册

PHILIPS

Contents

1 Important	4
Safety	4
Notice	4
2 Your home theater system	6
Introduction	6
What's in the box	6
Overview of the main unit	7
Overview of the remote control	8
3 Get started	10
Attach speakers to the main unit	10
Attach the stand	10
Connect AV devices	11
Connect FM antenna	14
Connect power	14
Prepare the remote control	15
Set clock	15
Turn on	16
Enable Easylink	16
4 Play	17
Play from USB	17
Play connected AV devices	17
5 Listen to radio	18
Store radio stations in memory	18
Tune to a preset radio station	18
6 Adjust volume level and sound effect	19
Adjust volume level	19
Select a sound effect	19
Mute sound	19
Enable audio sync	19
7 Use more of your home theater system	20
Set timer	20
Set sleep time	20

8 Product information	21
Product information	21
USB playability information	21
9 Troubleshooting	23
10 Appendix	24
Mount to a wall	24

1 Important

Safety

- Read and understand all instructions before you use the apparatus. If damage is caused by failure to follow instructions, the warranty does not apply.
- Never insert objects into the ventilation slots or other openings on the apparatus.
- Never remove the casing of this apparatus.
- Place the apparatus on a flat, hard and stable surface.
- Place the set in a location with adequate ventilation to prevent internal heat build-up in your system. Allow at least 10 cm (4 inches) clearance from the rear and the top of the unit and 5 cm (2 inches) from each sides.
- The ventilation shall not be impeded by covering the ventilation opening with items such as newspapers, table-cloths, curtains, etc.
- The apparatus shall not be exposed to dripping or splashing.
- Never expose the apparatus to direct sunlight, naked flames or heat.
- Ensure that you always have easy access to the power cord, plug or adaptor to disconnect this apparatus from the power.
- Use only the supplied mounting hardware for a safe and secure installation.
- Wall mounting of the apparatus should only be performed by qualified personal. The apparatus must only be mounted on an appropriate wall bracket and on a wall that can safely hold the weight of the apparatus. Improper wall mounting can result in severe injury or damage.
- Clean the apparatus with soft, damp cloth. Never use substances such as alcohol, chemicals or household cleaners on the apparatus.

Know these safety symbols

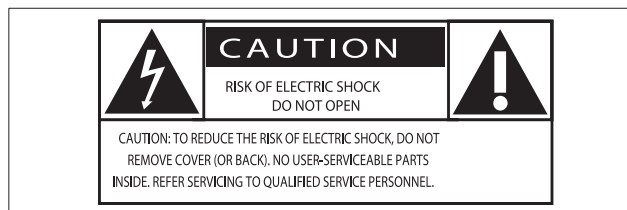

This 'bolt of lightning' indicates uninsulated material within your unit may cause an electrical shock. For the safety of everyone in your household, please do not remove product covering.

The 'exclamation point' calls attention to features for which you should read the enclosed literature closely to prevent operating and maintenance problems.

WARNING: To reduce the risk of fire or electric shock, this apparatus should not be exposed to rain or moisture and objects filled with liquids, such as vases, should not be placed on this apparatus.

CAUTION: To prevent electric shock, match wide blade of plug to wide slot, fully insert.

Notice

Environmental information

All unnecessary packaging has been omitted. We have tried to make the packaging easy to separate into three materials: cardboard (box), polystyrene foam (buffer) and polyethylene (bags, protective foam sheet.)

Your system consists of materials which can be recycled and reused if disassembled by a specialized company. Please observe the local regulations regarding the disposal of packaging materials, exhausted batteries and old equipment.



Your product is designed and manufactured with high quality materials and components, which can be recycled and reused. When you see the crossed-out wheel bin symbol attached to a product, it means the product is covered by the European Directive 2002/96/EC:



Never dispose of your product with other household waste. Please inform yourself about the local rules on the separate collection of electrical and electronic products. The correct disposal of your old product helps prevent potentially negative consequences on the environment and human health.



HDMI, and HDMI logo and High-Definition Multimedia Interface are trademarks or registered trademarks of HDMI licensing LLC.



The making of unauthorized copies of copy-protected material, including computer programs, files, broadcasts and sound recordings, may be an infringement of copyrights and constitute a criminal offence. This equipment should not be used for such purposes.



Manufactured under license from Dolby Laboratories.

Dolby and the double-D symbol are trademarks of Dolby Laboratories.



Manufactured under license from Dolby Laboratories.

Dolby, Pro Logic, and the double-D symbol are trademarks of Dolby Laboratories.

Other trademarks and trade names are those of their respective owners.

This apparatus includes this label:

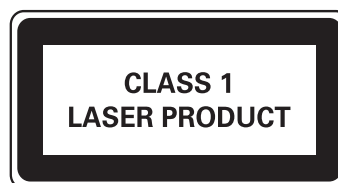

Note

- The type plate is located on the back of the apparatus.

2 Your home theater system

Congratulations on your purchase, and welcome to Philips! To fully benefit from the support that Philips offers, register your product at www.Philips.com/welcome.

Introduction

With the home theater system, you can

- Get superb sound performance when you watch TV, DVDs, listen to music, or play games.
- Enjoy MP3/WMA music directly from your portable USB device.
- Enjoy high definition performance from HDMI (High Definition Multimedia Interface) devices such as Blu-ray Disc players, digital receivers, game consoles etc.
- Listen to FM radio.

What's in the box

Check and identify the contents of your package:

- Main unit
- Speakers (x 2)
- Digital subwoofer
- Remote control (with battery)
- Table stand
- Wall mount bracket and screws (x4)
- AV cable
- Coaxial cable
- FM antenna
- AV switch cable

Overview of the main unit

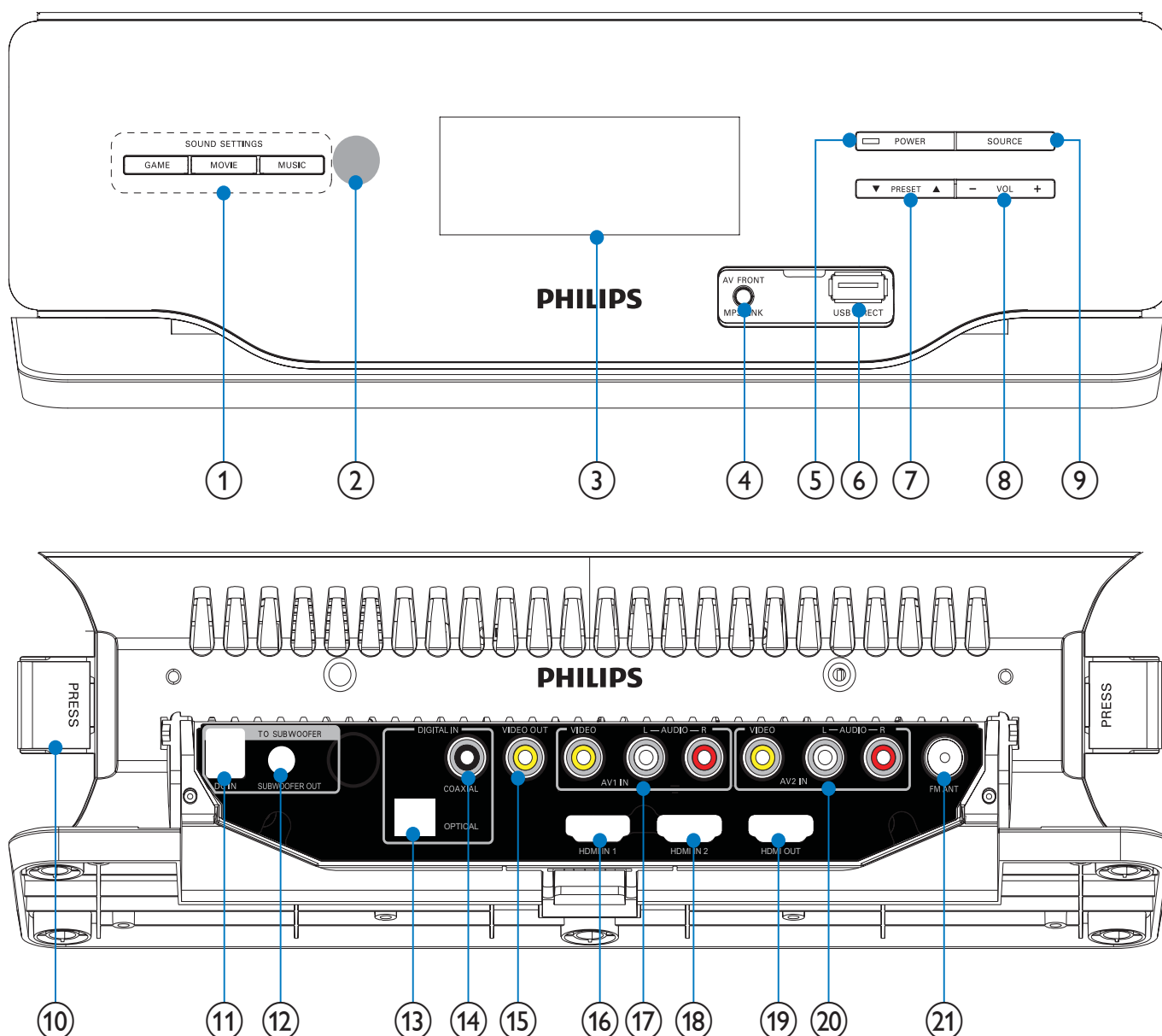

① **SOUND SETTINGS (GAMES, MOVIE, MUSIC)**

- Select a sound effect.

② **IR sensor**

③ **Display panel**

- Show current status.

④ **AV FRONT / MP3 LINK**

- AV input socket on the front panel.
- Jack for an external audio device.

⑤ **POWER**

- Turn on the unit, switch it to standby mode, or switch it to Eco Power Standby.

⑥ **USB DIRECT**

- Socket for a USB mass storage device.

⑦ **▼ PRESET ▲**

- Skip to the previous/next track in the USB device.
- Select preset radio station.

- ⑧ **-VOL +**
 - Adjust volume.
 - Adjust time.
- ⑨ **SOURCE**
 - Select a source.
- ⑩ **PRESS**
 - Detach speakers from the main unit.
- ⑪ **DC IN**
 - Power supply socket.
- ⑫ **SUBWOOFER OUT**
 - Subwoofer out socket.
- ⑬ **DIGITAL IN - OPTICAL**
 - Optical audio input socket.
- ⑭ **DIGITAL IN - COAXIAL**
 - Coaxial audio input socket.
- ⑮ **VIDEO OUT**
 - Socket for composite video output.
- ⑯ **HDMI IN 1**
 - HDMI input socket.
- ⑰ **AV1 IN (VIDEO,AUDIO L/R)**
 - AV input sockets.
- ⑱ **HDMI IN 2**
 - HDMI input socket.
- ⑲ **HDMI OUT**
 - HDMI output socket.
- ⑳ **AV2 IN (VIDEO,AUDIO L/R)**
 - AV input sockets.
- ㉑ **FM ANT**
 - FM antenna socket.

Overview of the remote control

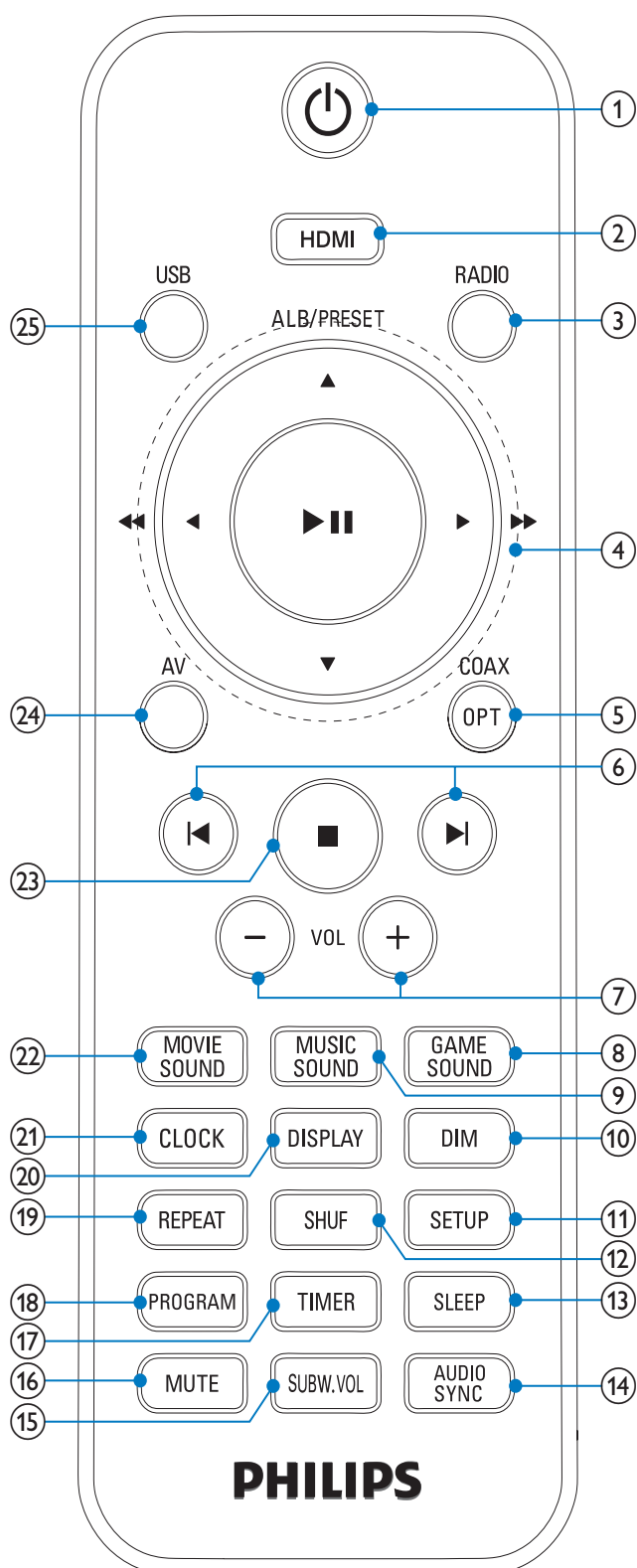

- ①
 - Turn on the unit, switch it to standby mode, or switch it to Eco Power Standby.

- ② **HDMI**
 - Select an HDMI audio input source.
- ③ **RADIO**
 - Switch to tuner mode.
- ④ **Navigation buttons**
 - **ALB/PRESET/▲▼**
Skip to the previous/next album (folder) in the USB device.
Select a preset radio station.
 - **◀◀/▶▶, ◀/▶**
Fast reverse or fast forward within a track in the USB device.
Tune to a radio station.
 - **▶||**
Start or pause USB play.
- ⑤ **COAX /OPT**
 - Select the AV input source.
- ⑥ **◀ / ▶**
 - Skip to the previous/next track in the USB device.
 - Select preset radio station.
- ⑦ **VOL +/-**
 - Adjust volume.
 - Adjust time.
- ⑧ **GAME SOUND**
 - Select a game sound setting.
- ⑨ **MUSIC SOUND**
 - Select an equalizer setting.
- ⑩ **DIM**
 - Select different levels of display brightness.
- ⑪ **SETUP**
 - Enable/disable Easylink.
- ⑫ **SHUF**
 - Play tracks in the USB device randomly.
- ⑬ **SLEEP**
 - Set the sleep timer.
- ⑭ **AUDIO SYNC**
 - Synchronize audio and video.
- ⑮ **SUBW.VOL**
 - Adjust subwoofer volume.
- ⑯ **MUTE**
 - Mutes volume.
- ⑰ **TIMER**
 - Set the alarm timer.
- ⑱ **PROGRAM**
 - Program tracks in a USB device.
 - Store radio stations in memory.
- ⑲ **REPEAT**
 - Select a repeat play mode for the connected USB device.
- ⑳ **DISPLAY**
 - Select display information during play.
- ㉑ **CLOCK**
 - Set the clock.
 - View the clock.
- ㉒ **MOVIE SOUND**
 - Select a movie sound setting.
- ㉓ **■**
 - Stop play.
- ㉔ **AV**
 - Select AV source.
- ㉕ **USB**
 - Select the USB source.

3 Get started

! Caution

- Use of controls or adjustments or performance of procedures other than herein may result in hazardous radiation exposure or other unsafe operation.

Always follow the instructions in this chapter in sequence.

If you contact Philips, you will be asked for the model and serial number of this apparatus. The model number and serial number are on the back of the apparatus. Write the numbers here:

Model No. _____

Serial No. _____

Attach speakers to the main unit

- 1 Place the main unit on a soft and flat surface.
 - Ensure that the bottom side faces upwards.

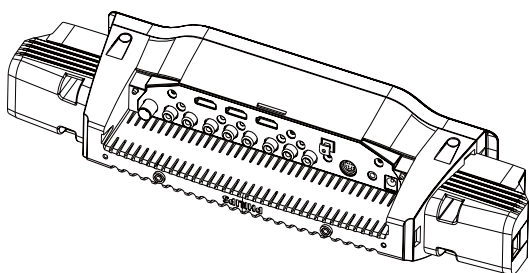

- 2 Attach the left speaker to the left side of the main unit.

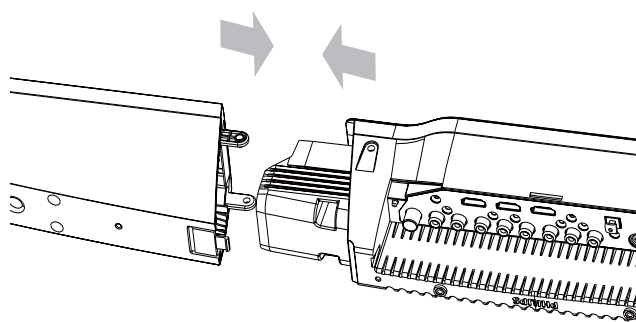

- 3 Repeat step 2 to attach the right speaker.

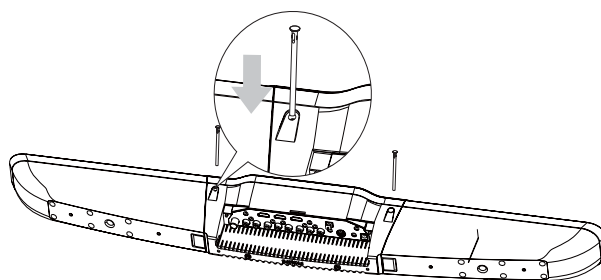

Attach the stand

- 1 Slide the supplied table stand onto the bottom of the main unit.

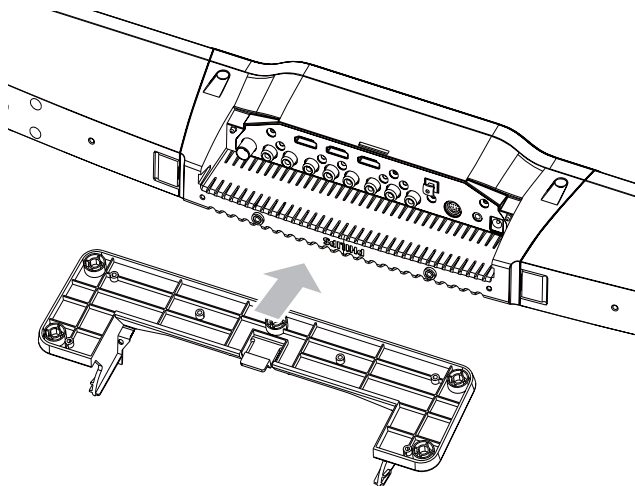



Tip

- You can also mount the apparatus on a wall.

Connect AV devices



Note

- The type of devices and connections in the following instructions are for reference only.
- When you connect cables, ensure that the color of the plug matches the color of the socket.

Connect TV

If you connect the home theater system to your TV, you can enjoy the superb sound performance while watching TV.

- If the TV has a digital output socket, connect the supplied coaxial cable (orange) from the TV to the **DIGITAL IN -COAXIAL** socket on the system.

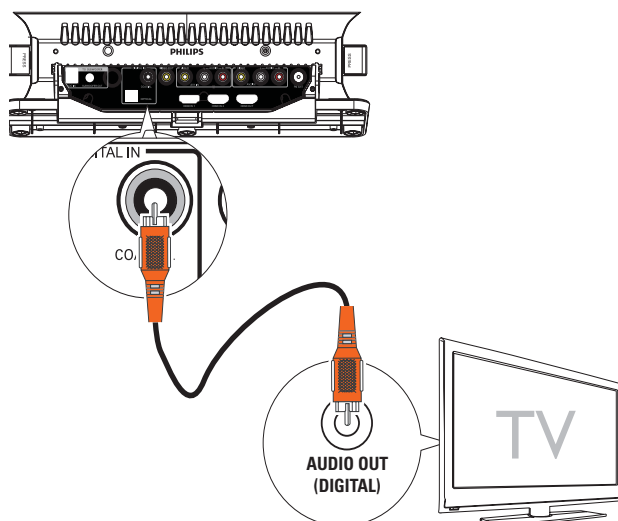

- You can also connect the system to the TV by using the supplied AV cable (see below illustration).

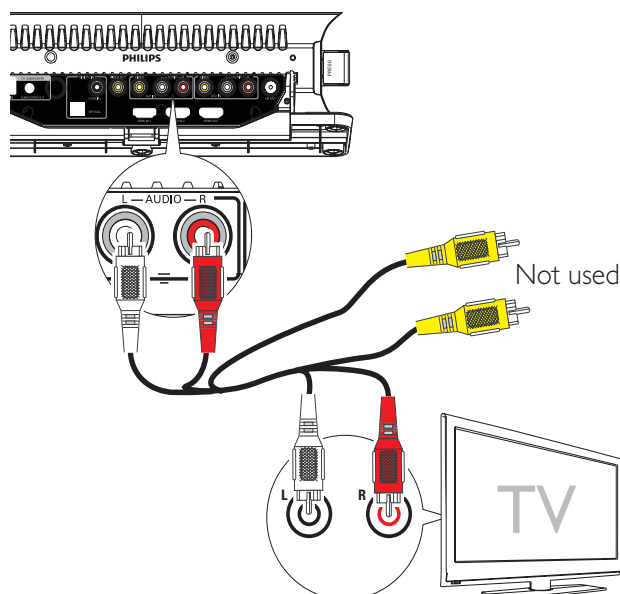

Tip

- It is unnecessary to connect the yellow video connectors.

- If your TV connected to a set-top-box (to convert analog signal into digital signal), connect the supplied AV cable to AV output sockets on the set-top-box and the **AV1 IN** or **AV2 IN** sockets.

Connect DVD player

If you connect your DVD player and TV to the home theater system, you can enjoy superb sound performance during watching DVD movie.

- Connect the system to the TV.
- Connect the supplied AV cable to the **AV1 IN** or **AV2 IN** sockets on the system and the **AV OUT** sockets on the DVD player.

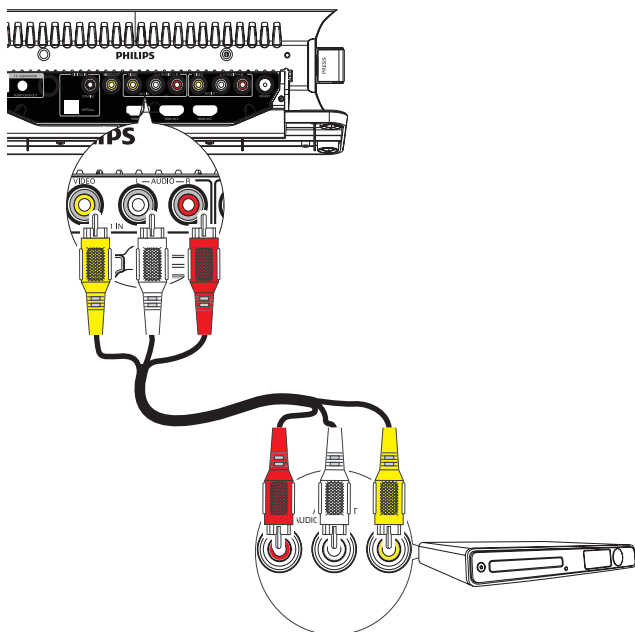

- You can also connect the supplied AV switch cable to the **AV FRONT** socket first, then connect the AV cable to the AV output sockets on the DVD player:

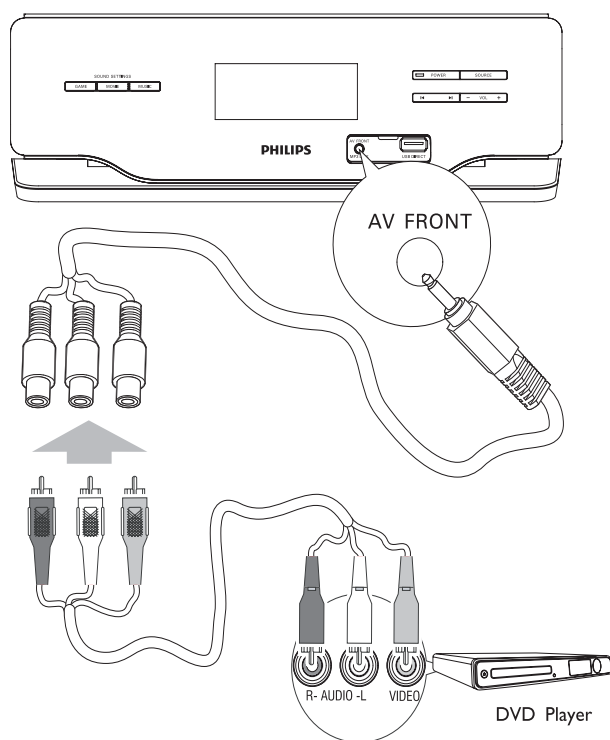

- 1 Connect the system to the TV.
- 2 Connect an MP3 Link cable (not supplied) to the **AV FRONT** socket on the system and the **AV OUT** socket on the game console.

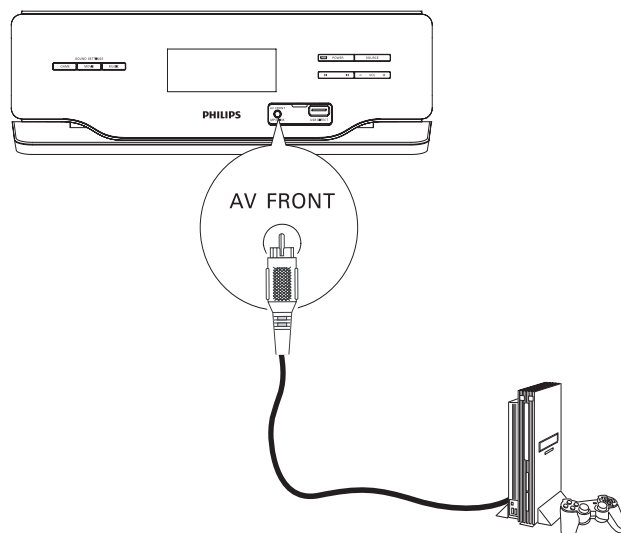

- You can connect the AV output sockets on a game console to the **AV1 IN** or **AV2 IN** sockets on the system.

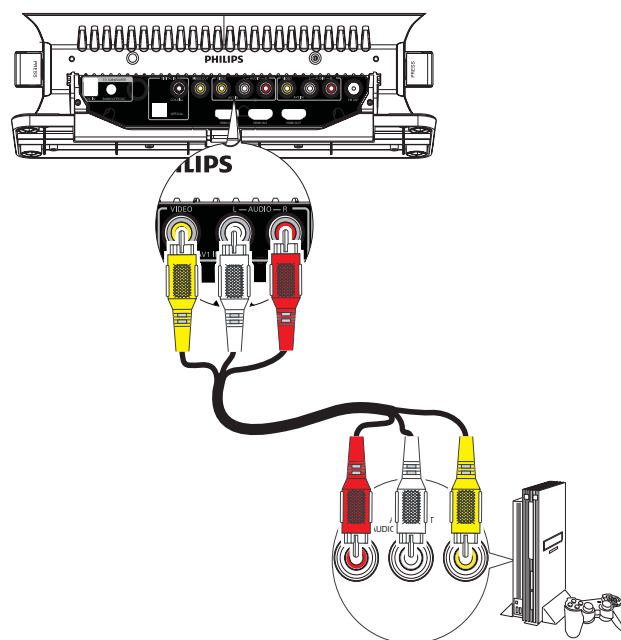

Connect game console

If you connect your game console and TV to the home theater system, you can enjoy the superb sound performance while playing game.

- You can also connect the supplied AV switch cable to the **AV FRONT** socket first, then connect the AV cable

to the AV output sockets on the DVD player.

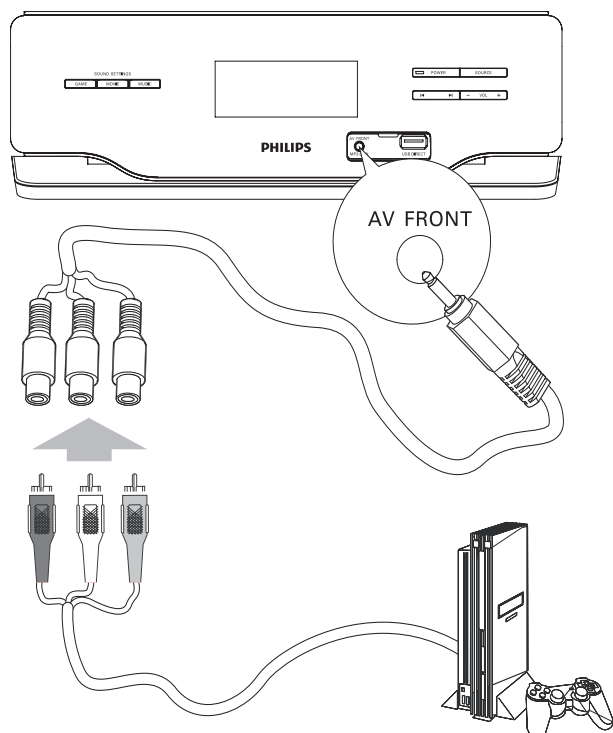

Connect HDMI supported devices

HDMI (High Definition Multimedia Interface) is a digital interface that supports both audio and video transmission through a single cable. If you connect your HDMI-compliant DVD players and TV to the home theater system, you can watch DVDs or Blu-ray discs that contain HD (High-Definition) content. This connection provides the best picture quality.

Note

- Some TVs do not support HDMI audio transmission.

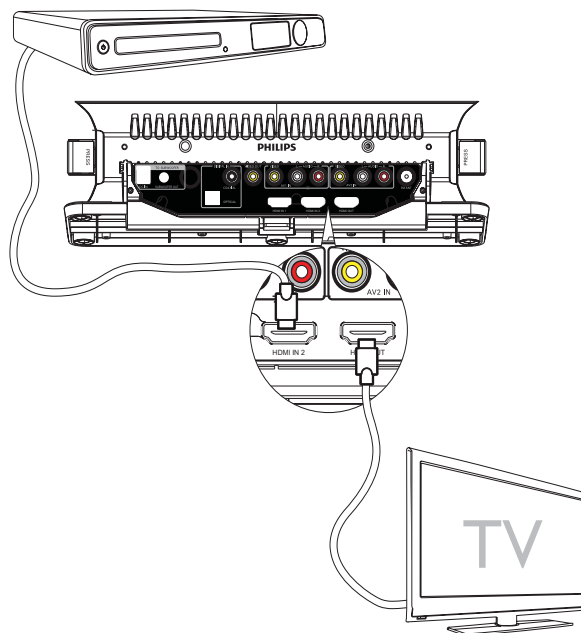

- 1 Connect an HDMI cable (not supplied) to the **HDMI OUT** socket on the DVD player and **HDMI IN 1** or **HDMI IN 2** socket on the system.
- 2 Connect another HDMI cable (not supplied) to the **HDMI OUT** socket on the system and the **HDMI IN** socket on the TV.
 - If your TV has only a DVI(Digital Visual Interface) connection, connect through a HDMI/DVI adaptor. An extra audio connection is needed to complete this connection.
- 3 Press **HDMI** to select **HDMI 1** or **HDMI 2**.

Connect coax supported devices

The home theater system can decode digital audio signal. You can connect the system to your digital amplifier or receiver.

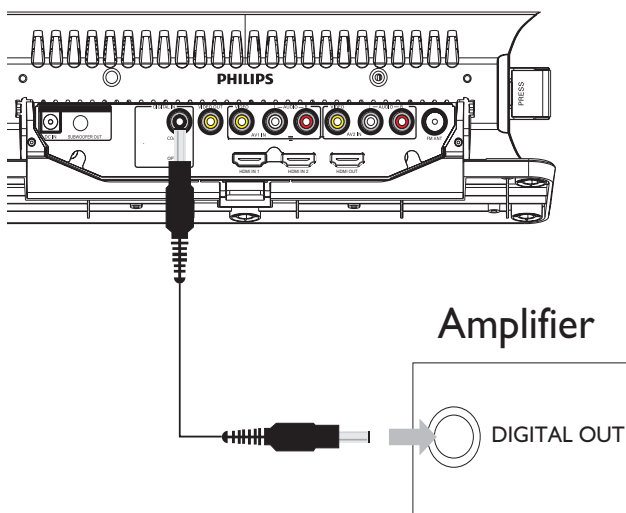

- 1 Connect the supplied coaxial cable to the **COAXIAL** socket on the system and the **COAXIAL/DIGITAL** output socket on the connected device.
 - You can connect an optical cable (not supplied) to the **OPTICAL** socket on the system and the **COAXIAL/DIGITAL** output socket on the connected device.

Tip

- You can connect all the devices to the home theater system at the same time.



Tip

- For optimal reception, fully extend and adjust the position of the antenna.
- For better FM reception, connect an outdoor FM antenna to the **FM ANT** socket.
- The home theater system does not support AM radio reception.

Connect power



Caution

- Risk of product damage! Ensure that the power supply voltage corresponds to the voltage printed on the back or the underside of the product.
- Risk of electric shock! When you unplug the AC power, always pull the plug from the socket. Never pull the cord.



Note

- Before connecting AC power, ensure you have completed all other connections.

- 1 Connect one end of the power plug to the **DC IN** and **SUBWOOFER OUT** socket on the main unit.

Connect FM antenna

- 1 Connect the supplied FM antenna to the **FM ANT** socket.

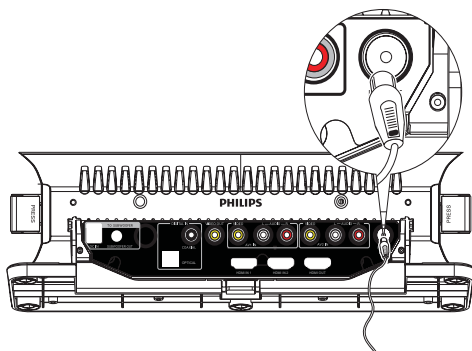

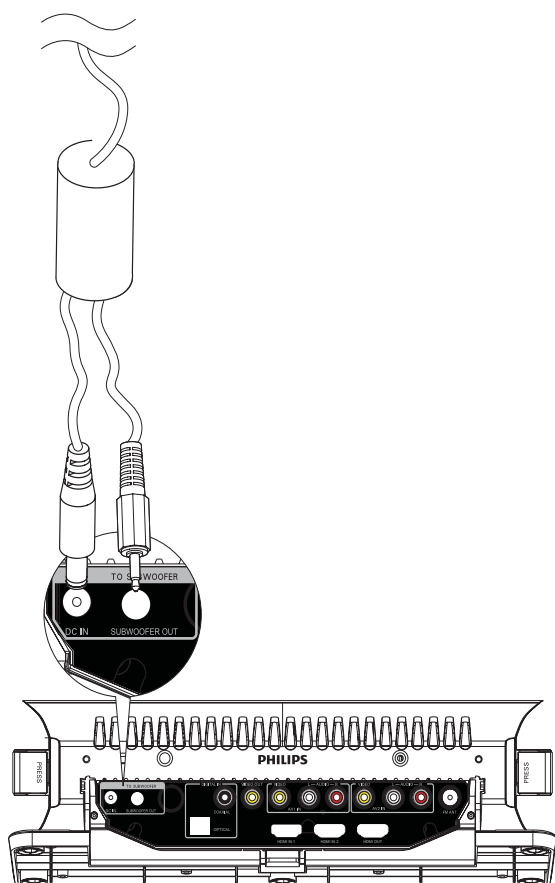

2 Connect the other end to the wall outlet.

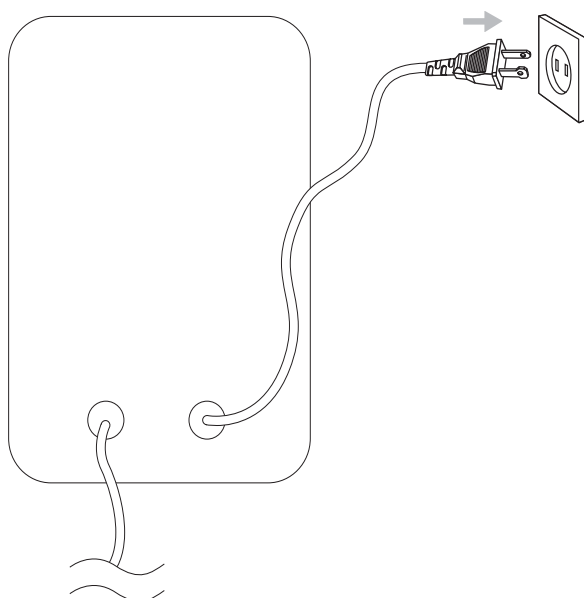

Prepare the remote control



Caution

- Risk of explosion! Keep batteries away from heat, sunshine or fire. Never discard batteries in fire.
- Risk of decreased battery life! Never mix different brands or types of batteries.
- Risk of product damage! When the remote control is not used for long periods, remove the batteries.



Note

- Perchlorate Material - special handling may apply. See www.dtsc.ca.gov/hazardouswaste/perchlorate.

- 1 Open the battery compartment.
- 2 Insert 2 AAA battery with correct polarity (+/-) as indicated.
- 3 Close the battery compartment.

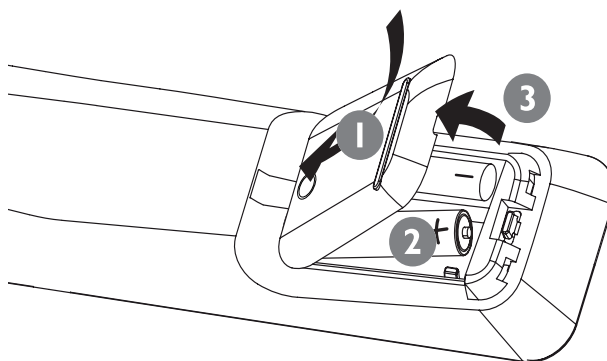

Set clock

- 1 In the standby mode, press and hold **CLOCK** to enter the clock setting mode.
→ **Clock** is displayed and the hour digits begin to blink.
- 2 Press **+VOL -** to set the hour.
- 3 Press **CLOCK** to confirm
→ The minute digits begin to blink.
- 4 Press **+VOL -** to set the minute.

- 5 Press **CLOCK** to confirm the clock setting.

Turn on

- 1 Press .
- ↳ The unit switches to the last selected source.

- **To switch to standby mode:**

- 1 Press .
- ↳ Clock is displayed (if have set).

The clock (if set) is displayed.

- **To switch to Eco Power Standby mode:**

- 1 Press  for over 3 seconds.
- ↳ The backlight on the display panel turns off.
 - ↳ The blue Eco Power indicator lights up.

Enable Easylink

EasyLink uses the HDMI CEC (Consumer Electronics Control) industry standard protocol to share functionality with all HDMI CEC compliant devices over HDMI. It enables the connected devices to control each other with a single remote control.



Note

- EasyLink (HDMI CEC) is only applicable with certain criteria. Terms and conditions may vary by product. Consult your product dealer for information.
- Philips does not guarantee 100% interoperability with all HDMI CEC devices.

- 1 Press **SETUP** for over 3 seconds.
- ↳ 'Easylink On' is displayed.
 - ↳ To disable Easylink, press and hold **SETUP** until "Easylink Off" is displayed.

4 Play

Play from USB

Note

- Ensure that the USB device contains playable music. (see 'USB playability information' on page 23)

- 1 Flip open the cover on the front panel.
- 2 Insert the USB plug of a USB device into the  socket.

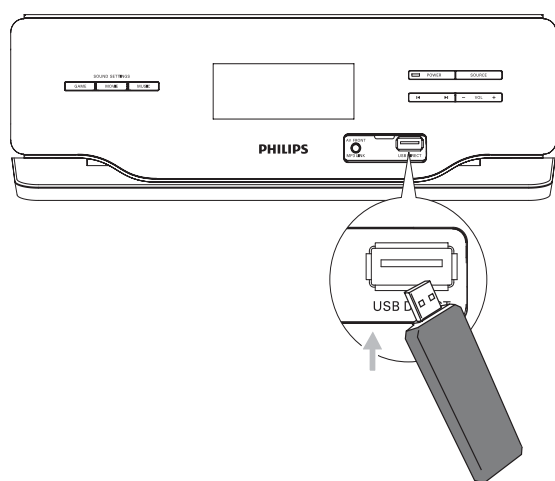

- 3 Press **USB** to select the USB source.
 - ↳ The total number of tracks is displayed.
- 4 Press **ALB/PRESET/▲▼** to select a folder.
- 5 Press **◀▶** to select a file.
- 6 Press **▶||** to start play.
 - During play, press and hold **◀◀** or **▶▶** to search fast backward or forward.
 - Press **▶||** to pause or resume play.

Repeat play

- 1 During play, press **REPEAT** repeatedly to select:
 - ↳ **[REPEAT]** (repeat): play the current track repeatedly.
 - ↳ **[REPEAT ALL]** (repeat all): play all tracks repeatedly.

- 2 To return to normal play, press **REPEAT** until the selected function is no longer displayed.

Random play

- 1 Press **SHUF**.
 - ↳ All tracks are played randomly.
- 2 To return to normal play, press **SHUF** again.



Tip

- The repeat and shuffle functions cannot be activated at the same time.

Program tracks

You can arrange the playback order of the tracks. You can store up to 20 tracks.

- 1 In stop mode, press **PROGRAM** to activate the programming mode.
 - ↳ **[01 P-00]** is displayed.
- 2 Press **ALB/PRESET/▲▼** to select the album where the track is located.
- 3 Press **◀▶** to select a track number to program, then press **PROGRAM** to confirm.
 - ↳ **[P-X]** is displayed, where "X" is the current position in the program.
- 4 Repeat steps 2 to 3 to select and store all tracks to program.
- 5 Press **▶||** to play the programmed tracks.
 - To erase the program, press **PROGRAM** in stop mode.

Play connected AV devices



Note

- Ensure that you have made the necessary AV connections. (see 'Connect AV devices' on page 12)

- 1 Press **AV**, **HDMI**, or **COAX/OPT** to select an AV source.

5 Listen to radio

- 1 Ensure that you have connected and fully extended the supplied FM antenna.
- 2 Press **RADIO**.
- 3 Press and hold **◀◀/▶▶** for over 3 seconds.
↳ The FM tuner tunes to a station with strong reception automatically.
- 4 Repeat steps 3 to find more stations.

To tune to a weak station:

- 1 Press **◀◀/▶▶** repeatedly until you find optimal reception.

Store radio stations in memory

You can store up to 20 FM stations in memory.

Store stations automatically

- 1 Press **ALB/PRESET/▲▼** to select a preset number.
- 2 Press **PROGRAM** for over 3 seconds.
↳ **[AUTO]** (auto) is displayed.
↳ All available stations are programmed in the order of reception strength.
↳ The last programmed radio station is played automatically.

Store stations manually

- 1 Tune to a radio station.
- 2 Press **PROGRAM**.
- 3 Press **ALB/PRESET/▲▼** to allocate a number from 1 to 20 to this radio station, then press **PROGRAM** to confirm.
↳ The preset number and the frequency of the preset station are displayed.

- 4 Repeat the above steps to program other stations.



Note

- To overwrite a programmed station, store another station in its place.

Tune to a preset radio station

- 1 Press **PRESET/ALB/▲▼** to select a preset number that you want.

6 Adjust volume level and sound effect

Adjust volume level

- 1 During play, press **VOL +/-** to increase/decrease the volume level.

Adjust subwoofer volume

- 1 Press **SUBW.VOL** to adjust the subwoofer volume.

Select a sound effect



Note

- You cannot use different sound effects at the same time.

Select a game sound effect

- 1 During play, press **GAME SOUND** repeatedly to select:
 - **[SHOOTING]** (shooting)
 - **[SPORT]** (sport)
 - **[RACING]** (racing)
 - **[ARCADE]** (arcade)
 - **[NORMAL]** (normal)



Note

- In radio mode, the game sound effect is not available.

Select a movie sound effect

- 1 During play, press **MOVIE SOUND** repeatedly to select:

- **[DRAMA]** (drama)
- **[SCIENCE FICTION]** (science fiction)
- **[ACTION]** (action)
- **[CONCERT]** (concert)
- **[NORMAL]** (normal)

Adjust subwoofer volume



Note

- In radio mode, the movie sound effect is not available.

Select equalizer settings

- 1 During USB play, press **MUSIC SOUND** repeatedly to select:
 - **[POP]** (pop)
 - **[JAZZ]** (jazz)
 - **[ROCK]** (rock)
 - **[CLASSIC]** (classic)
 - **[NORMAL]** (normal)

Mute sound

- 1 During play, press **MUTE** to mute/unmute sound.

Enable audio sync

If the video signal sent to the TV is slower than the audio streams, you can synchronize audio and video by delaying the audio output.

- 1 Press **AUDIO SYNC** repeatedly to select a delay time: 10, 20, 30 ...100, 110 ...190, 200.
 - To disable audio sync, press **AUDIO SYNC** repeatedly to select **OFF**.

7 Use more of your home theater system

Set timer

The home theater system can turn on automatically at a set time.

- 1 Ensure that you have set the clock correctly.
- 2 In standby mode, press and hold **TIMER**.
 - ↳ The **TIMER** is displayed and hour digits begin to blink.
- 3 Press **+VOL -** to set the hour.
- 4 Press **TIMER** to confirm.
 - ↳ The minute digits begin to blink.
- 5 Press **+VOL -** to set the minute.
- 6 Press **TIMER** to confirm.
 - ↳ The mode indicator begins to blink.
- 7 Press **+VOL -** to select **[ON]** (on).
 - ↳ A clock icon appears on the display.
 - ↳ The system turns on automatically at the set time and switches to USB mode or tuner mode (if there is USB device connected, it switches to USB mode, otherwise it switches to tuner mode).
 - ↳ To deactivate the alarm timer, repeat steps above and select **[OFF]** (off) mode.

Set sleep time

- 1 When the system is turned on, press **SLEEP** repeatedly to select a set period of time (in minutes).
 - ↳ The system turns off automatically in the selected time.

8 Product information



Note

- Product information is subject to change without prior notice.

Product information

General information

AC power	220V, 50Hz
Operation Power Consumption	70W
Standby Power Consumption	<10W
Eco Standby Power Consumption	<1W
USB Direct	Full Speed Ver1.1
Dimensions (W x H x D)	800 x 90 x 95mm
Main unit and speakers	180 x 330 x 340mm
Weight	9.5 kg
With Packing	1.8 Kg
Main unit and speakers	5.2 kg
Subwoofer	

Amplifier

Rated Output Power	180W + 120W RMS
Frequency Response	20 - 20000 Hz
Signal to Noise Ratio	>65dB
AV1, 2 Input	1.0V RMS 20kohm
Front AV Input	1.0V RMS 20kohm
Coaxial Input	1V RMS 75ohm
Total Harmonic Distortion	<1%

Tuner (FM)

Tuning Range	87.5 - 108MHz
Tuning grid	100KHz
Sensitivity	<22 dBf
- Mono, 26dB S/N Ratio	
Search Selectivity	>28dBf
Total Harmonic Distortion	<3%
Signal to Noise Ratio	>55dB

L/R speakers

Speaker Impedance	3ohm (mediant) + 3ohm (tweeter)
Speaker Driver	1.5" mediant+1.5" tweeter
Sensitivity	>82dB/m/W

Subwoofer

Speaker Impedance	3ohm*subwoofer
Speaker Driver	6.5" subwoofer
Sensitivity	>78dB/m/W

USB playability information

Compatible USB devices:

- USB flash memory (USB 2.0 or USB1.1)
- USB flash players (USB 2.0 or USB1.1)
- Memory cards (requires an additional card reader to work with the home theater system)

Supported formats:

- USB or memory file format FAT12, FAT16, FAT32 (sector size: 512 bytes)
- MP3 bit rate (data rate): 32-320 Kbps and variable bit rate
- WMA v9 or earlier
- Directory nesting up to a maximum of 8 levels
- Number of albums/ folders: maximum 99

- Number of tracks/titles: maximum 999
- File name in Unicode UTF8
(maximum length: 128 bytes)

Unsupported formats:

- Empty albums: an empty album is an album that does not contain MP3/WMA files, and is not be shown in the display.
- Unsupported file formats are skipped. For example, Word documents (.doc) or MP3 files with extension .dlf are ignored and not played.
- AAC, WAV, PCM audio files
- DRM protected WMA files (.wav, .m4a, .m4p, .mp4, .aac)
- WMA files in Lossless format

9 Troubleshooting



Warning

- Never remove the casing of this apparatus.

To keep the warranty valid, never try to repair the system yourself.

If you encounter problems when using this apparatus, check the following points before requesting service. If the problem remains unsolved, go to the Philips web site www.philips.com/welcome. When you contact Philips, ensure that the apparatus is nearby and the model number and serial number are available.

No power

- Ensure that the AC adaptor of the main unit is connected properly.
- Ensure that there is power at the AC outlet.

No sound

- Adjust the volume.
- Check that the speakers are connected correctly.
- If there is no sound in the USB mode, ensure that you have connected a USB device that contains playable music.
- If there is no sound in the AV mode, ensure that you have connected AV devices to the system correctly.

Remote control does not work

- Before you press any function button, first select the source with the remote control.
- Reduce the distance between the remote control and the system.
- Insert the batteries with its polarities (+/– signs) aligned as indicated.
- Replace the battery.
- Aim the remote control directly at the sensor on the front of the system.

Cannot display some files in USB device

- The number of folders or files in the USB device has exceeded a certain limit. This phenomenon is not a malfunction.

- The formats of these files are not supported.

USB device not supported

- The USB device is incompatible with the system. Try another one.

Timer does not work

- Set the clock correctly.
- Switch on the timer.

Clock/timer setting erased

- Power has been interrupted or the power cord has been disconnected.
- Reset the clock/timer.

No picture on HDMI connection.

- Check if the HDMI cable is faulty. Replace a new HDMI cable.
- Check if connected devices are authorized HDMI compatible. If not, the audio/video signal may not be output.

No sound on HDMI connection.

- You may not hear any sound if the connected device is non-HDCP compliant or only DVI-compatible.

10 Appendix

Mount to a wall

! Caution

- Risk of product damage! Always consult professional personnel to safely mount the product to a wall.
- Risk of injury! Ensure that no supply ducts such as gas, water or electricity are harmed when you drill the holes.

What's in the supplied mounting kit

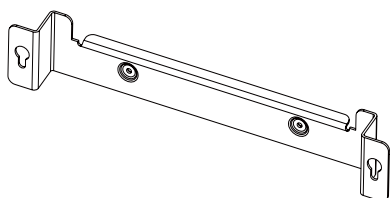

1 x wall mount bracket for the main unit and speakers

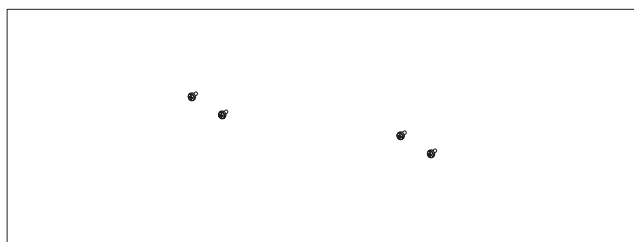

4 x screws

What else you'll need

- Electric drill
- Screwdriver
- Pencil

Mount the main unit and speakers

! Caution

- To find a suitable mounting location, make the necessary physical and wireless connections.
- Mount the main unit and speakers to a solid concrete wall or plaster board wall only!

You can use the supplied bracket to mount the main unit and speakers to the wall.

- 1 Align the bracket in the chosen location on a wall. Use a pencil to mark the drilling positions.

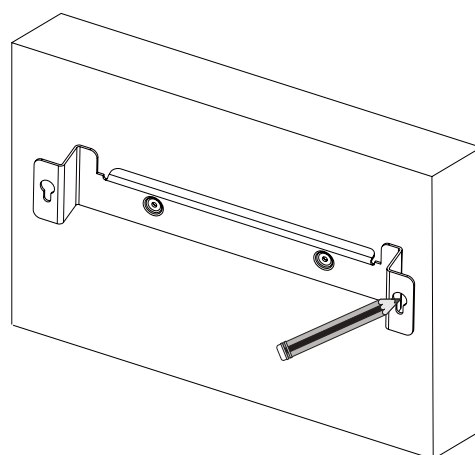

- 2 Drill holes as marked.

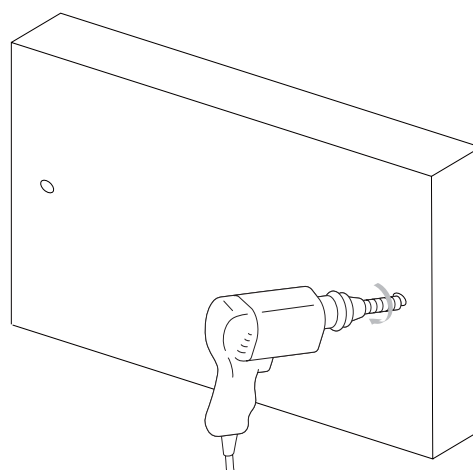

- 3 Secure 2 supplied screws in the holes, but leave 5mm between the screw head and the wall.

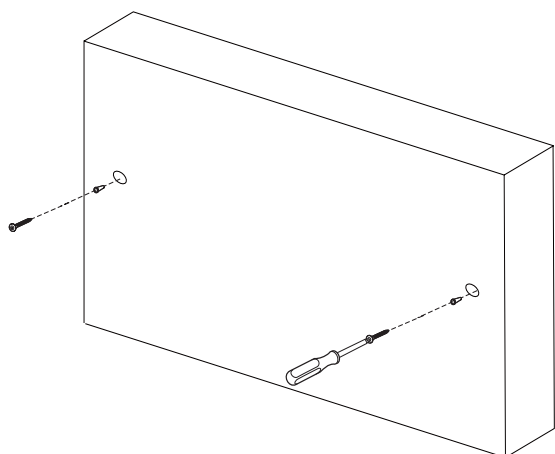

- 4** Secure the wall mount bracket onto the main unit with 2 supplied screws.

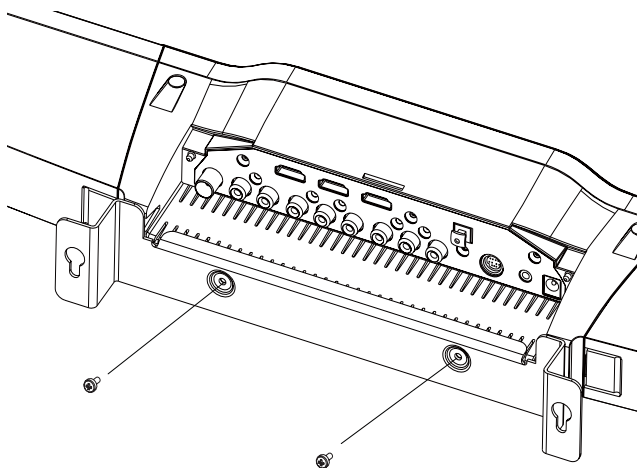

- 5** Hook the main unit and speakers in place.

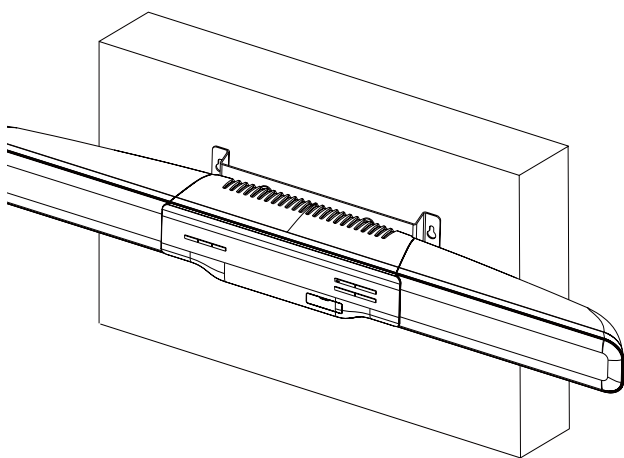



© 2009 Koninklijke Philips Electronics N.V.

All rights reserved.

Document order number: HSB2313_93_UM_V2.0

