

Always there to help you

Register your product and get support at

www.philips.com/welcome

HMP4000



User manual

PHILIPS

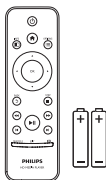

2 X AAA

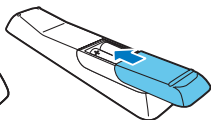
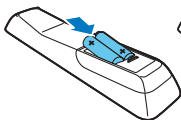
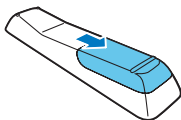

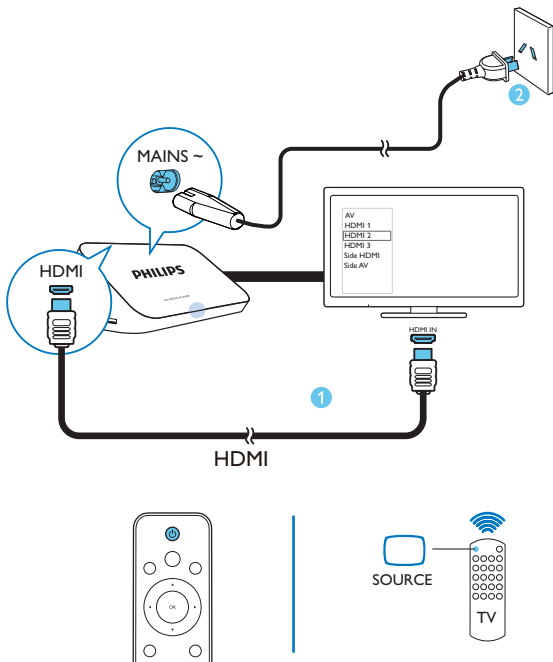

On **HMP4000**, press  on the remote control to switch on.

- The power indicator lights up white

On the remote control of your TV, use the source button to select the input connector of **HMP4000**.

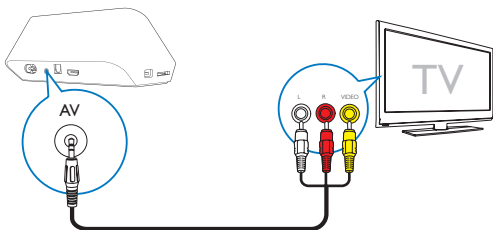

To connect to a TV through the AV cables

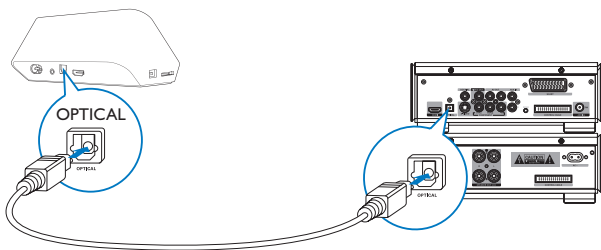



For high quality audio

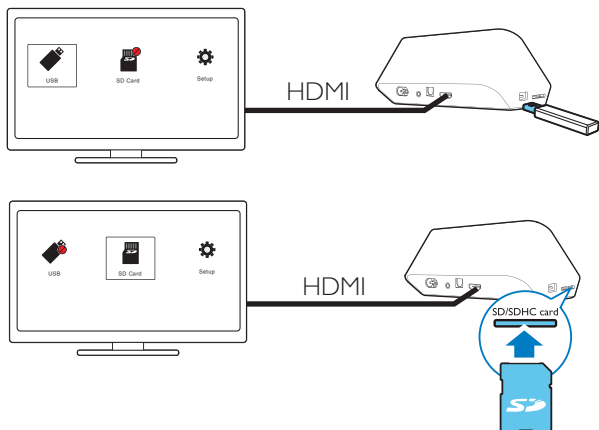

Play from a mass storage device



When the USB device or SD/ SDHC card is recognized by **HMP4000**,  changes to  or  changes to  on the Home screen.

Contents

1	Trademark notice	9
----------	-------------------------	---

2	Safety and notice	10
	Safety	10
	Compliance	11
	Copyright	12
	Care of the environment	12
	Warranty	13

3	Basics	14
	Connect	14
	Switch on or off	15
	Auto standby	16
	Screen saver	16
	Use the remote control	16
	Enter text	17

4	Play	18
	Play from a mass storage device	18
	Search for media files	19
	Select play options	20
	Manage files	21
	Copy or move files and folders	21
	Delete files and folders	21

Rename files and folders	22
Create music playlists	22
Create photo albums	22
<hr/>	
5 Setup	23
System	23
Audio	24
Video	24
<hr/>	
6 EasyLink	24
<hr/>	
7 Update the firmware through a USB storage device	25
<hr/>	
8 Troubleshooting	26
<hr/>	
9 Specification	27
<hr/>	

1 Trademark notice



The terms HDMI and HDMI High-Definition Multimedia Interface, and the HDMI Logo are trademarks or registered trademarks of HDMI Licensing LLC in the United States and other countries.



Manufactured under license from Dolby Laboratories.
Dolby and the double-D symbol are trademarks of Dolby Laboratories.



Manufactured under license under U.S. Patent Nos: 5,956,674; 5,974,380; 6,487,535 & other U.S. and worldwide patents issued & pending. DTS, the Symbol, & DTS and the Symbol together are registered trademarks & DTS 2.0+Digital Out is a trademark of DTS, Inc. Product includes software. © DTS, Inc. All Rights Reserved.



Real RMVB logo is a trademark or a registered trademark of RealNetworks, Inc.

2 Safety and notice

Read and understand all instructions before you use this product. If damage is caused by failure to follow the instructions, the warranty does not apply.

Safety



This 'bolt of lightning' indicates uninsulated material within the device may cause an electrical shock. For the safety of everyone in your household, please do not remove the covering.



The 'exclamation mark' calls attention to features for which you should read the enclosed literature closely to prevent operating and maintenance problems.

WARNING: To reduce the risk of fire or electric shock, the device should not be exposed to rain or moisture and objects filled with liquids, such as vases, should not be placed on the device.

CAUTION: To prevent electric shock, fully insert the plug. (For regions with polarized plugs: To prevent electric shock, match wide blade to wide slot.)

- Only use attachments/accessories specified by the manufacturer.
- Use only power supplies listed in the user manual.
- The product shall not be exposed to dripping or splashing.
- Do not place any sources of danger on the product (e.g. liquid filled objects, lighted candles).
- Batteries (battery pack or batteries installed) shall not be exposed to excessive heat such as sunshine, fire or the like.
- Danger of explosion if battery is incorrectly replaced. Replace only with the same or equivalent type.

Modification of the product could result in hazardous radiation of EMC or other unsafe operation.



Warning

- Never remove the casing of this product.
- Never lubricate any part of this product.
- Never place this product on other electrical equipment.
- Keep this product away from direct sunlight, naked flames or heat.
- Ensure that you always have easy access to the power cord, plug or adaptor to disconnect the product from the power.
- Where the mains plug or an appliance coupler is used as the disconnect device, the disconnect device shall remain readily operable.

Compliance



This product complies with the radio interference requirements of the European Community.

Class II equipment symbol:



CLASS II apparatus with double insulation, and no protective earth provided.

Any changes or modifications made to this product that are not expressly approved by Philips Consumer Lifestyle may void the user's authority to operate the equipment.



Note

- The type plate is located on the bottom of the product.

Copyright

Specifications are subject to change without notice. Trademarks are the property of Koninklijke Philips Electronics N.V or their respective owners. Philips reserves the right to change products at any time without being obliged to adjust earlier supplies accordingly.

Care of the environment

Environmental information

All unnecessary packaging has been omitted. We have tried to make the packaging easy to separate into three materials: cardboard (box), polystyrene foam (buffer) and polyethylene (bags, protective foam sheet.)

Your system consists of materials which can be recycled and reused if disassembled by a specialized company. Please observe the local regulations regarding the disposal of packaging materials, and old equipment.



Your product is designed and manufactured with high quality materials and components, which can be recycled and reused.



When this crossed-out wheeled bin symbol is attached to a product it means that the product is covered by the European Directive 2002/96/EC.

Please inform yourself about the local separate collection system for electrical and electronic products.

Please act according to your local rules and do not dispose of your old products with your normal household waste. Correct disposal of your old product helps to prevent potential negative consequences for the environment and human health.

Warranty

- Never attempt to repair the product, this could lead to the risk of injury, damage to the product and will void your warranty.
- Use the product and accessories only as intended by the manufacturer. The caution sign printed on the back of the product indicates risk of electric shock.
- Never remove the cover of the product. Always contact Philips Customer Support for service or repairs.
- Any operation expressly prohibited in this manual, or any adjustments and assembly procedures not recommended or authorized in this manual shall void the warranty.

3 Basics

Connect

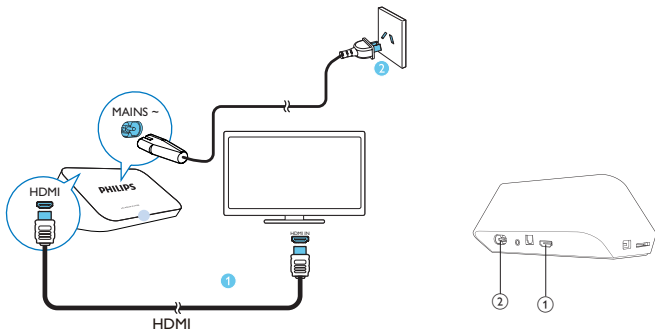

- ① **HDMI connector for audio/ video output**
 - Connects to a high-definition TV (HDTV) through an HDMI cable
- ② **Power connector**
 - Connects to power supply through the AC power cord

To connect to a TV through AV cables

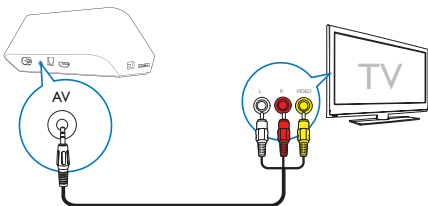

- Through **AV**, use the supplied AV cable to connect **HMP4000** to a TV.
- Make sure that the plugs and sockets match in color.

For high quality audio

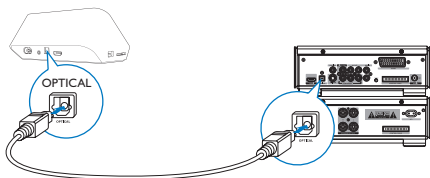

- Through **OPTICAL**, use a fiber optical cable to connect **HMP4000** to the **OPTICAL** or **SPDIF** input connector on an audio/video system.

Switch on or off

- 1 On **HMP4000**, press  on the remote control to switch on.
↳ The power indicator lights up white.



- 2 On the TV, switch to the input connector of **HMP4000**:
 - On the remote control of your TV, use the source button to select the input channel of **HMP4000**.

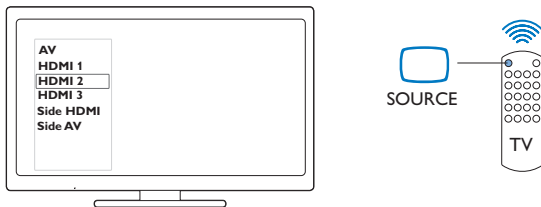

- 3** To switch **HMP4000** to standby mode, press  again on the remote control.
↳ The power indicator lights up red.
-

Auto standby

From the Home screen, go to  [Setup] > [System] to switch on [Automatic Standby]

If there is no button press or media play on **HMP4000** for 15 minutes, **HMP4000** switches to standby mode automatically.

Screen saver

From the Home screen, go to  [Setup] > [System] to switch on [Screen Saver Delay].

If there is no button press or media play on **HMP4000** for a selected time duration, the screen saver is activated. To exit the screen saver, press any button on the remote control.

Use the remote control

Switch **HMP4000** on or to standby mode

- Press 

Navigate between screens or through options



- Return to the Home screen



- Navigate through options

OK

- Confirm the option



- Back one level or exit

View options menu for media play or file navigation

- Press  OPTIONS

Control the play



- Start, pause, or resume the play



- Stop the play



- Skip to the previous/ next media file



- Search backwards or forwards within current file
- Press repeatedly to select a search speed



- Rotate a photo



- Display the information about current file during play



- Press repeatedly to select aspect ratio, or zoom in or out. To pan through an enlarged photo, press



SUBTITLE

- Access subtitle options

Remove the connected USB device safely

- Press and hold  and select the option

Manage files/folders underon the connected storage devices

- Press **EDIT**

Enter text

With the onscreen keyboard, use the remote control to enter text.

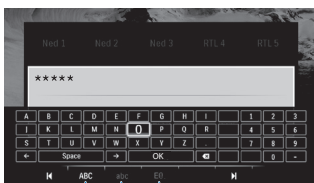

ABC abc E@

Select input modes

- Press  on the remote control.
 - ↳ On the onscreen keyboard, current input mode is highlighted.

ABC : English input in the upper case

abc : English input in the lower case

E@ : symbols

Enter text

- 1 On the remote control, press ▲ ▼ ◀ ▶ to move to a key, press **OK** to select the letter or symbol.
- 2 On the onscreen keyboard, select the input options by using the remote control:
◀ / ▶ : Move the cursor to the left or right.
<X> : Delete the entry before the cursor.
- 3 When the text entry is complete, select **OK** on the onscreen keyboard to exit.

4 Play

On the HDTV, enjoy media play from a mass storage device, including:





- a USB mass storage device,
- an SD card, or
- an SDHC card.

Play from a mass storage device

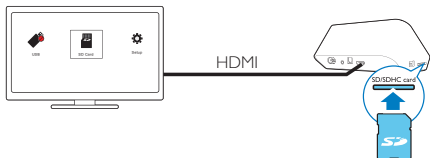
- 1 Connect your mass storage device to **HMP4000**:
 - For a USB mass storage device, connect to  on **HMP4000**.
 - Insert an SD/ SDHC card to the **SD** slot.





- ↳ When the USB device is recognized by **HMP4000**,  changes to  on the Home screen.
- ↳ When the SD/ SDHC card is recognized by **HMP4000**,  changes to  on the Home screen.

2 On the Home screen, select  or .

↳ Media files are sorted as follows:

[Folder]: Display all the files/ folders.

[Movies]: Display movie files.

[Music]: Display music files.

[Photos]: Display photo files.

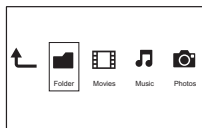

3 Select a file to start play.

Search for media files

- In the list of files or folders, press **☰ OPTIONS** to select your options:
 - In **[Folder]**:
 - To display files in different views,
 - Select **[Thumbnails]**, **[List]**, or **[Preview]**.
 - To show files by media type,
 - Select **[All Media]**, **[Movies]**, **[Photos]**, or **[Music]**.
 - In **[Movies]**, **[Music]**, and **[Photos]**:
 - To search for a file by keyword,

- Select **[Search]**. Enter the keyword on the onscreen keyboard (see 'Enter text' on page 15).
- To sort files in different ways,
- Select **[Sort Order]**.
- To go to the folder view,
- Select **[Go to Folder]**.

Select play options

1 During play, press **≡ OPTIONS** on the remote control.

2 Press **▲▼◀▶** to select an option. Press **OK** to confirm.

For videos,

[Subtitle]: Select a subtitle language

[Audio]: Select an audio language

[Night Mode]: (for audio encoded in Dolby Digital): Makes loud sound level softer and soft sound level louder so that you can enjoy videos at a low volume, without disturbing others.

[GOTO]: Skip to the specific time, title, or chapter.

[Repeat Title]: Repeat current title.

[Repeat All]: Repeat all the files.

[Repeat Off]: Switch off the repeat mode.

[Video Setting]: Select display options.

For music,

[Repeat Off]: Switch off the repeat mode.

[Repeat One]: Repeat current file.

[Repeat All]: Repeat all the files.

[Shuffle Loop]: Play all the files in random order.

For photo slideshow,

[Slide Timing]: Set the time interval before one slide switches to another.

[Slide Transition]: Set the transition mode between two slides.

[Repeat Off]: Switch off the repeat mode.

[Repeat All]: Play photos in current folder repeatedly.

[Shuffle Loop]: Play photos in current folder in random order.

[Background Music]: Play a music file during the slideshow.

[Video Setting]: Select display options.

Manage files

On **HMP4000**, select  or  on the Home screen. Go to **[Folder]**, and you can manage files on the connected storage devices.

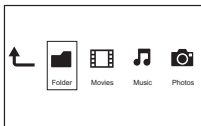

Copy or move files and folders

- 1 In **[Folder]**, select a file or folder in the list of files/ folders.
To select multiple files,
 - ① On the remote control, press **EDIT**.
↳ A list of options is displayed.
 - ② Select **[Multiple Select]**.
↳ A file list is created for you to add files or folders.
 - ③ Press **▲ / ▼** to select a file or folder. Press **▶||** to confirm.
- 2 On the remote control, press **EDIT**.
- 3 On the pop-up list of options, select **[Copy]** or **[Move]**.
- 4 Select a folder as the destination. Press **▶||** to confirm.
↳ The selected files or folders are copied or moved to the destination.

Delete files and folders

- 1 Follow Step 1-3 under "Copy or move files and folders" (see 'Copy or move files and folders' on page 19).
- 2 On the pop-up list of options, select **[Delete]**.
↳ The selected files or folders are deleted.

Rename files and folders

- 1 In **[Folder]**, select a file or folder in the list of files/ folders.
- 2 On the remote control, press **EDIT**.
- 3 On the pop-up list of options, select **[Rename]**.
- 4 On the pop-up onscreen keyboard, edit the file/ folder name (see 'Enter text' on page 15).

Create music playlists

You can create playlists for music files you want to play together.

- 1 In **[Folder]**, select music files.
 - ① On the remote control, press **EDIT**.
↳ A list of options is displayed.
 - ② Select **[Multiple Select]**.
↳ A file list is created for you to add files.
 - ③ Press **▲ / ▼** to select a file. Press **▶ ||** to confirm.
- 2 On the remote control, press **EDIT**.
- 3 On the pop-up list of options, select **[Save Playlist]**.
- 4 Name the playlist as needed.
↳ A music playlist is created.

Create photo albums

You can create photo albums for picture files.

- 1 In **[Folder]**, select picture files.
 - ① On the remote control, press **EDIT**.
↳ A list of options is displayed.
 - ② Select **[Multiple Select]**.
↳ A file list is created for you to add files.

③ Press ▲ / ▼ to select a file. Press ►|| to confirm.

- 2 On the remote control, press **EDIT**.
- 3 On the pop-up list of options, select **[Save Photo Album]**.
- 4 Name the photo album as needed.
 - ↳ A photo album is created.

5 Setup

You can change the setup options of **HMP4000**.

- 1 On the Home screen, select *** [Setup]**.
 - If necessary, press **⬆** on the remote control to go to the Home screen.
 - ↳ The setup menu is displayed.
- 2 Press **▲▼◀▶** to select an option. Press **OK** to confirm the option.
 - Press **↶** to return to the upper-level menu.

System

[Menu Language]: Select the language for onscreen menus.

[Subtitle]: Select the subtitle language for videos.

[Screen Saver Delay]: Enable the screen saver when **HMP4000** is in the idle mode for a selected time span, for example, in pause or stop mode. To exit the screen saver mode, press any key.

[Automatic Standby]: Switch **HMP4000** to standby mode when there is no button press or media play on **HMP4000** for 15 minutes.

[Request to Resume Play]: Allow you to select whether to resume video play from the last stop position.

[Reset Factory Defaults]: Restore factory settings.

Audio

[**HDMI Audio Mode**]: Select audio output for the HDMI connector.

[**Optical output**]: Select audio output for the **OPTICAL** connector

[**Lip Sync**]: Synchronize audio with video play.

Video

[**Aspect Ratio**]: Select display aspect ratio.

[**TV System**]: Select the video resolution that your TV supports. See your TV manual for details.

[**Video Zoom**]: Zoom in or out video scenes.

*[**1080P 24Hz**]: Use 1080p 24 Hz for video output, where 1080p 24 Hz denotes the resolution and frame rate.

[**Deep Color**]: Display colors with more shades and hues when the video content is recorded in Deep Color mode and the TV supports this feature.



Note

- *If the video resolution is incompatible with your TV, you can see a blank screen. To recover the display, wait for 10 seconds.

6 EasyLink

HMP4000 supports Philips EasyLink which uses the HDMI CEC (Consumer Electronics Control) protocol. You can use a single remote control to control EasyLink compliant devices that are connected through HDMI.

- 1 Through HDMI, connect **HMP4000** to a TV compliant with the HDMI CEC protocol.
- 2 On the TV, switch on the functions to allow HDMI CEC operations (Consult the user manual of the TV).
- 3 On **HMP4000**, switch on **[Easy Link]**.
 - On the Home screen, select **[Setup]** > **[Easy Link]**. Select **[On]**.
- 4 In **[Easy Link]**, you can select the following options:

[One Touch Play]

When you start play on **HMP4000**, the TV switches to the HDMI input channel automatically.

[One Touch Standby]

When you switch the TV to the standby mode, **HMP4000** switches to the standby mode automatically.

[Auto Power On From TV]

When you switch to the input channel of **HMP4000** on the TV, **HMP4000** can switch on automatically from the standby mode.



Note

- Philips does not guarantee 100% interoperability with all HDMI CEC devices.

7 Update the firmware through a USB storage device

Before you update the firmware, check current the firmware version of **HMP4000**. On the Home screen, go to * **[Setup]** > **[Software Upgrade]** > **[Version Info]**.

- 1 On your computer, do the following:

- ① Go to www.philips.com/support to find the latest firmware.
- ② Search for your model and click on "Software and drivers".
- ③ Download the firmware update and save the file to the root directory of a USB storage device.

2 On **HMP4000**, do the following:

- ① Connect the USB storage device.
- ② On the Home screen, select [Setup] > [Software Upgrade]> [USB upgrade].
↳ If a firmware update is detected, you are prompted to start the update.

3 Follow onscreen instructions to complete the update.

- ↳ When the update is complete, **HMP4000** switches off automatically, and then switches on again.



Caution

- Keep **HMP4000** powered on and the storage device mounted before the firmware update is complete.

8 Troubleshooting

If you contact Philips, you will be asked for the model and serial number of this player. The model number and serial number are at the bottom of this player.

Write the numbers here:

Model No. _____

Serial No. _____

No picture.

- Refer to the TV user manual for how to select the correct video input channel

The contents of the USB storage device cannot be read.

- The format of this USB storage device is not supported.
- The supported memory size is 1TB maximum.
- Make sure that this player supports these files. (Refer to "Specifications" > "Playable media") .

9 Specification



Note

- Specification and design are subject to change without notice.

Power

- Input: 100-240V~ 50/60Hz, 15W
- Power consumption: < 15 W
- Power consumption in standby mode: < 0.5 W

Supported formats:

- Video: MPEG 1/2/4(MPEG 4 Part 2), H.264,VC-1, WMV9, Xvid, MKV, RMVB 8/9/10, RM, MPG, AVI, TS, M2TS, TP, IFO, ISO, VOB, DAT, MP4, MPEG, MOV (MPEG 4, H.264), ASF, FLV(640 × 480)
- Audio: Dolby digital, DTS, MPEG Audio, AAC, RA, OGG, MKA, ADPCM, AC3, WMA (V9), MP3, PCM, LPCM
- Picture: .JPEG, .JPG, .BMP, .PNG, .GIF (unanimated GIF), .TIF, .TIFF, .HD-JPEG

HDD & USB support

- Compatibility: Hi-Speed USB (2.0)
- NTFS, FAT32, FAT, EXT-3, HFS+
- USB MTP support, USB PTP support, USB MSC support

Subtitle support

- .srt, .sub, .smi, .ssa, .idx+.sub

Video

- HDMI output: 480i, 480p, 576i, 576p, 720p, 1080i, 1080p, 1080p24
- Composite video output: 1 Vpp ~ 75 ohm

Audio

- HDMI output
- Optical output
- Analog stereo output
- Signal to noise ratio (1 kHz): > 90 dB (A-weighted)
- Dynamic Range (1 kHz): > 80 dB (A-weighted)
- Frequency response: +/-0.2 dB

Main Unit

- Dimensions (L x W x H): 160 x 91 x 54.1 mm
- Net Weight: 0.25 Kg

Philips Electronics Hong Kong Ltd. hereby offers to deliver, upon request, a copy of the complete corresponding source code for the copyrighted open source software packages used in this product for which such offer is requested by the respective licenses.

This offer is valid up to three years after product purchase to anyone in receipt of this information. To obtain source code, please contact open.source@philips.com. If you prefer not to use email or if you do not receive confirmation receipt within a week after mailing to this email address, please write to "Open Source Team, Philips Intellectual Property & Standards, P.O. Box 220, 5600 AE Eindhoven, The Netherlands." If you do not receive timely confirmation of your letter, please email to the email address above.

NOTICE

SOFTWARE END USER LICENSE AGREEMENT

THIS SOFTWARE END USER LICENSE AGREEMENT ("THIS AGREEMENT") IS A LEGAL AND BINDING AGREEMENT BETWEEN YOU (EITHER AN INDIVIDUAL OR ENTITY) AND PHILIPS CONSUMER LIFESTYLE B.V. A DUTCH LIMITED LIABILITY COMPANY, WITH ITS PRINCIPAL OFFICE AT HIGH TECH CAMPUS 37, 5656 AE EINDHOVEN, THE NETHERLANDS AND ITS SUBSIDIARY COMPANIES (INDIVIDUALLY AND COLLECTIVELY "PHILIPS"). THIS AGREEMENT GIVES YOU THE RIGHT TO USE CERTAIN SOFTWARE (THE "SOFTWARE") INCLUDING USER DOCUMENTATION IN ELECTRONIC FORM WHICH MAY HAVE BEEN PROVIDED SEPARATELY OR TOGETHER WITH A PHILIPS PRODUCT (THE "DEVICE") OR A PC. BY DOWNLOADING, INSTALLING OR OTHERWISE USING THE SOFTWARE, YOU ACCEPT AND AGREE TO BE BOUND BY ALL OF THE TERMS AND CONDITIONS OF THIS AGREEMENT. IF YOU DO NOT AGREE TO THESE TERMS AND CONDITIONS, DO NOT DOWNLOAD, INSTALL OR OTHERWISE USE THE SOFTWARE. IF YOU ACQUIRED THE SOFTWARE IN TANGIBLE MEDIA E.G. CD WITHOUT THE OPPORTUNITY TO REVIEW THIS LICENSE AND DO NOT ACCEPT THESE TERMS, YOU MAY RECEIVE A FULL REFUND OF THE AMOUNT, IF ANY, THAT YOU PAID FOR THE SOFTWARE IF YOU RETURN THE SOFTWARE UNUSED WITH PROOF OF PAYMENT WITHIN 30 DAYS FROM THE DATE OF PURCHASE.

- 1. Grant of License.** This Agreement grants you a non-exclusive, nontransferable, non-sub licensable license to install and use, on the Device or a PC, as applicable, one (1) copy of the specified version of the Software in object code format as set out in the user documentation solely for your personal use. The Software is "in use" when it is loaded into the temporary or permanent memory (i.e. RAM, hard disk, etc.) of the PC or the Device.

2. **Ownership.** The Software is licensed and not sold to you. This Agreement grants you only the right to use the Software, but you do not acquire any rights, express or implied, in the Software other than those specified in this Agreement. Philips and its licensors retain all right, title, and interest in and to the Software, including all patents, copyrights, trade secrets, and other intellectual property rights incorporated therein. The Software is protected by copyright laws, international treaty provisions, and other intellectual property laws. Therefore, other than as expressly set forth herein, you may not copy the Software without prior written authorization of Philips, except that you may make one (1) copy of the Software for your back-up purposes only. You may not copy any printed materials accompanying the Software, nor print more than one (1) copy of any user documentation provided in electronic form, except that you may make one (1) copy of such printed materials for your back-up purposes only.
3. **License Restrictions.** Except as provided otherwise herein, you shall not rent, lease, sublicense, sell, assign, loan, or otherwise transfer the Software. You shall not, and you shall not permit any third party, to reverse engineer, decompile, or disassemble the Software, except to the extent that applicable law expressly prohibits the foregoing restriction. You may not remove or destroy any product identification, copyright notices, or other proprietary markings or restrictions from the Software. All titles, trademarks, and copyright and restricted rights notices shall be reproduced on your back up copy of the Software. You may not modify or adapt the Software, merge the Software into another program or create derivative works based upon the Software.
4. **Termination of certain functionality.** The Software may contain components of certain licensed software including software licensed from Microsoft Corporation ("Microsoft") which implements Microsoft's digital rights management technology for Windows Media. Content providers are using the digital rights management technology for Windows Media ("WM-DRM") to protect the integrity of their content ("Secure Content") so that their intellectual property, including copyright, in such content is not misappropriated. Your Device may also use WM-DRM software to transfer or play Secure Content ("WM-DRM Software"). If the security of such

WM-DRM Software is compromised, Microsoft may revoke (either on its own or upon the request of the owners of Secure Content ("Secure Content Owners")) the WM-DRM Software's right to acquire new licenses to copy, store, transfer, display and/or play Secure Content. Revocation does not alter the WM-DRM Software's ability to play unprotected content. A list of revoked WM-DRM Software is sent to your PC and/or your Device whenever you download a license for Secure Content. Microsoft may, in conjunction with such license, also download revocation lists onto your Device on behalf of Secure Content Owners, which may disable your Device's ability to copy, store, display, transfer, and/or play Secure Content. Secure Content Owners may also require you to upgrade some of the WM-DRM components distributed with this Software ("WM-DRM Upgrades") before accessing their content. When you attempt to play Secure Content, WM-DRM Software built by Microsoft will notify you that a WM-DRM Upgrade is required and then ask for your consent before the WM-DRM Upgrade is downloaded. WM-DRM Software built by Philips may do the same. If you decline the upgrade, you will not be able to access Secure Content that requires the WM-DRM Upgrade; however, you will still be able to access unprotected content and Secure Content that does not require the upgrade. WM-DRM features that access the Internet, such as acquiring new licenses and/or performing a required WM-DRM Upgrade, can be switched off. When these features are switched off, you will still be able to play Secure Content if you have a valid license for such content already stored on your Device. However, you will not be able to use certain of the WM-DRM Software features that require Internet access such as the ability to download content that requires the WM-DRM Upgrade. All title and intellectual property rights in and to the Secure Content is the property of the respective Secure Content owners and may be protected by applicable copyright or other intellectual property laws and treaties. This Agreement grants you no rights to use such Secure Content. **To summarize, if the Software contains Microsoft WM-DRM components – Secure Content you desire to download, copy, store, display, transfer, and/or play is protected by the Microsoft WM-DRM components of the Software. Microsoft, Secure Content Owners, or Secure Content distributors**

may deny you access, or restrict your access, to Secure Content even after you have paid for, and/or obtained, it. Neither your consent nor the consent or approval of Philips is necessary for any of them to deny, withhold or otherwise restrict your access to Secure Content. Philips does not guaranty that you will be able to download, copy, store, display, transfer, and/or play Secure Content.

5. **Open Source Software.** (a) This software may contain components that are subject to open-source terms, as stated in the documentation accompanying the Device. This Agreement does not apply to this software as such. (b) Your license rights under this Agreement do not include any right or license to use, distribute or create derivative works of the Software in any manner that would subject the Software to Open Source Terms. "Open Source Terms" means the terms of any license that directly or indirectly (1) create, or purport to create, obligations for Philips with respect to the Software and/or derivative works thereof; or (2) grant, or purport to grant, to any third party any rights or immunities under intellectual property or proprietary rights in the Software or derivative works thereof.
6. **Termination.** This Agreement shall be effective upon installation or first use of the Software and shall terminate (i) at the discretion of Philips, due to your failure to comply with any term of this Agreement; or (ii) upon destruction of all copies of the Software and related materials provided to you by Philips hereunder; Philips's rights and your obligations shall survive the termination of this Agreement.
7. **Upgrades.** Philips may, at its sole option, make upgrades to the Software available by general posting on a website or by any other means or methods. Such upgrades may be made available pursuant to the terms of this Agreement or the release of such upgrades to you may be subject to your acceptance of another agreement.
8. **Support Services.** Philips is not obligated to provide technical or other support ("Support Services") for the Software. If Philips does provide you with Support Services, these will be governed by separate terms to be agreed between you and Philips.

- 9. Limited Software Warranty.** Philips provides the Software 'as is' and without any warranty except that the Software will perform substantially in accordance with the documentation accompanying the Software for a period of one year after your first download, installation or use of the Software, whichever occurs first. Philips' entire liability and your exclusive remedy for breach of this warranty shall be, at Philips' option, either (i) return of the price paid by you for the Software (if any); or (b) repair or replacement of the Software that does not meet the warranty set forth herein and that is returned to Philips with a copy of your receipt. This limited warranty shall be void if failure of the Software has resulted from any accident, abuse, misuse or wrongful application. Any replacement Software will be warranted for the remainder of the original warranty period or thirty (30) days, whichever is longer. This limited warranty shall not apply to you if the Software was provided to you free of charge on an evaluation only basis.
- 10. NO OTHER WARRANTIES.** EXCEPT AS SET FORTH ABOVE, PHILIPS AND ITS LICENSORS DO NOT WARRANT THAT THE SOFTWARE WILL OPERATE ERROR FREE OR UNINTERRUPTED, OR WILL MEET YOUR REQUIREMENTS. YOU ASSUME ALL RESPONSIBILITIES FOR SELECTION OF THE SOFTWARE TO ACHIEVE YOUR INTENDED RESULTS, AND FOR THE INSTALLATION OF, USE OF, AND RESULTS OBTAINED FROM THE SOFTWARE. TO THE MAXIMUM EXTENT PERMITTED BY APPLICABLE LAW, PHILIPS AND ITS LICENSORS DISCLAIM ALL WARRANTIES AND CONDITIONS, WHETHER EXPRESS OR IMPLIED, INCLUDING BUT NOT LIMITED TO THE IMPLIED WARRANTIES OF MERCHANTABILITY, FITNESS FOR A PARTICULAR PURPOSE, AND ACCURACY OR COMPLETENESS OF RESULTS WITH RESPECT TO THE SOFTWARE AND THE ACCOMPANYING MATERIALS. THERE IS NO WARRANTY AGAINST INFRINGEMENT. PHILIPS DOES NOT WARRANT THAT YOU WILL BE ABLE TO DOWNLOAD, COPY, STORE, DISPLAY, TRANSFER, AND/OR PLAY SECURE CONTENT.
- 11. LIMITATION OF LIABILITY.** UNDER NO CIRCUMSTANCES WILL PHILIPS OR ITS LICENSORS BE LIABLE FOR ANY CONSEQUENTIAL, SPECIAL, INDIRECT, INCIDENTAL OR PUNITIVE DAMAGES

WHATSOEVER, INCLUDING, WITHOUT LIMITATION, DAMAGES FOR LOSS OF PROFITS OR REVENUES, BUSINESS INTERRUPTION, LOSS OF BUSINESS INFORMATION, LOSS OF DATA, LOSS OF USE OR OTHER PECUNIARY LOSS, EVEN IF PHILIPS OR ITS LICENSORS HAVE BEEN ADVISED OF THE POSSIBILITY OF SUCH DAMAGES. IN NO EVENT SHALL PHILIPS' OR ITS LICENSORS' AGGREGATE LIABILITY FOR DAMAGES ARISING OUT OF THIS AGREEMENT EXCEED THE GREATER OF THE PRICE ACTUALLY PAID BY YOU FOR THE SOFTWARE OR FIVE POUNDS STERLING (5.00).

12. **Trademarks.** Certain of the product and Philips names used in this Agreement, the Software, and the printed user documentation may constitute trademarks of the Philips, its licensors or other third parties. You are not authorized to use any such trademarks.
13. **Export Administration.** You agree that you will not directly or indirectly, export or re-export the Software to any country for which the United States Export Administration Act, or any similar United States law or regulation requires an export license or other U.S. Government approval, unless the appropriate export license or approval has first been obtained. By downloading or installing the Software you agree to abide by this Export provision.
14. **Governing law.** This Agreement is governed by the laws of your country of residence, without reference to its conflict of laws principles. Any dispute between you and Philips regarding this Agreement shall be subject to the non-exclusive jurisdiction of the courts of your country of residence.
15. **General.** This Agreement contains the entire agreement between you and Philips and supersedes any prior representation, undertaking or other communication or advertising with respect to the Software and user documentation. If any part of this Agreement is held invalid, the remainder of this Agreement will continue in full force and effect. This Agreement shall not prejudice the statutory rights of any party dealing as a consumer.

Philips Electronics Australia Limited and Philips New Zealand Limited
Warranty against Defects

In this warranty:

We or us means Philips Electronics Australia Limited ACN 008 445 743 or Philips New Zealand Limited (Company Number 1723), and our contact details are set out at the end of this warranty;

You means the purchaser or the original end-user of the Goods;

Supplier means the authorised distributor or retailer of the Goods that sold you the Goods in Australia or New Zealand; and

Goods means the product or equipment which was accompanied by this warranty and purchased in Australia or New Zealand.

If you require assistance with the operation of the product, its features or specifications please call the Philips Consumer Care Centre on 1300 363 391 in Australia or 0800 658 224 in New Zealand.

Australia: Our Goods come with guarantees that cannot be excluded under the Australian Consumer Law. You are entitled to a replacement or refund for a major failure and for compensation for any other reasonably foreseeable loss or damage. You are also entitled to have the Goods repaired or replaced if the goods fail to be of acceptable quality and the failure does not amount to a major failure. This is not a complete statement of your legal rights as a consumer.

New Zealand: Our Goods come with guarantees that cannot be excluded under the Consumer Guarantees Act 1993. This guarantee applies in addition to the conditions and guarantees implied by that legislation.

Additional Warranty:

In addition to the rights and remedies that you have under the Australian Consumer Law, Consumer Guarantees Act of New Zealand or any other applicable law, we provide the following warranty against defects:

1. If, during the first 12 months from their date of purchase from the Supplier (**Warranty Period**), the Goods prove defective by reason of improper workmanship or materials and none of your statutory rights or remedies apply, we will repair or replace the Goods without charge.
2. We do not have to repair or replace the Goods under this Additional Warranty if the Goods have been used for a commercial purpose; misused, improperly or inappropriately installed, operated or repaired; abused; damaged; or not maintained in accordance with the manufacturer's instructions.
3. Even when we do not have to repair or replace the Goods, we may decide to do so anyway. In some cases, we may decide to substitute the Goods with a similar alternative product of our choosing. All such decisions are at our absolute discretion.
4. All such repaired, replaced or substituted Goods continue to receive the benefit of this Additional Warranty for the time remaining on the original Warranty Period.
5. This Additional Warranty is limited to repair, replacement or substitution only. As far as the law permits, we will not be liable for any loss or damage caused to property or persons arising from any cause whatsoever.
6. In order to claim under this Additional Warranty you must telephone us on 1300 363 391 in Australia or 0800 658 224 in New Zealand within the Warranty Period. You will be asked for details of the Goods, a description of the defect and your personal details. Upon accepting your claim, we shall assist you with either returning the Goods to the Supplier for replacement or to the most convenient Philips Authorised Service Centre for your Goods to be repaired. In some cases we may require that you return to the Goods to us (at the address below) for repair, replacement or substitution.
 All returned Goods must be accompanied by satisfactory proof of purchase which clearly indicates the name and address of the Supplier, the date and place of purchase and identifies product. It is best to provide a legible and unmodified receipt or sales invoice.
 You must bear any expense for return of the Goods or otherwise associated with making your claim under this Additional Warranty.
7. This warranty is only valid and enforceable in Australia and New Zealand.

Contact us or the place of purchase for further details.

Philips Electronics Australia Limited
Level 1, 65 Epping Rd,
North Ryde, SYDNEY NSW 2113
Consumer Care: 1300 363 391
E-mail: pceinfo.australia@philips.com
Website: www.philips.com/support

Philips New Zealand Limited
Level 2, 1 Nugent St,
Grafton, AUCKLAND, 1023
Consumer Care: 0800 658 224
Email: pceinfo.australia@philips.com
Website: www.philips.com/support



