

Quick Start Guide



What's in the Box?

You should find these items upon opening the box.

Step A **Connect**

Step B **Setup**

Step C **Enjoy**



Quick Start Guide



User Manual

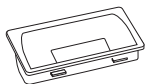

4 iPod Adaptors



Remote Control

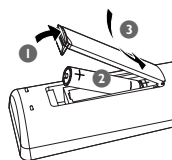

PHILIPS

Step A *Connect*

Connection

- 1** Connect the speaker wires to the **SPEAKERS** terminals.
- 2** Connect the power cord of the system to the AC power outlet.

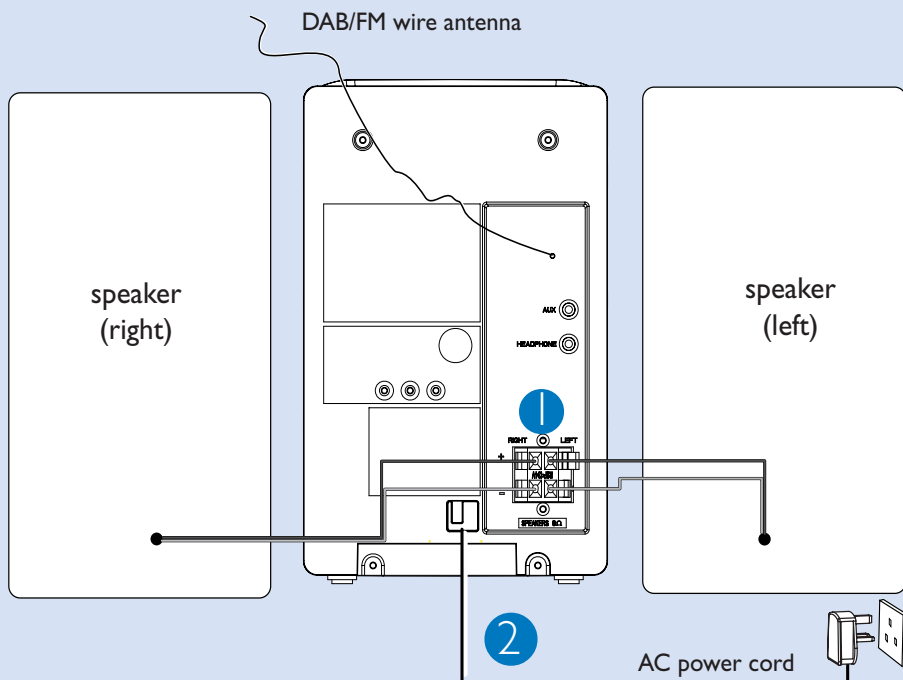

Tip:

It is unnecessary to connect the DAB/ FM antenna since it is fixed to the main unit.

Step B *Setup*

Setting the clock

- 1 In standby mode, press and hold **DISPLAY/CLOCK** on the remote control set for 2 seconds.
- 2 Press **PROG** to select 12-hour or 24-hour display.
- 3 Press **DISPLAY/CLOCK** to confirm.
→ The clock digits for the hours flash.
- 4 Press **TUNING** **|<< >>|** (or **|<< >>|** on the remote control) to set the hours.
- 5 Press **DISPLAY/CLOCK** again.
→ The clock digits for the minutes flash.
- 6 Press **TUNING** **|<< >>|** (or **|<< >>|** on the remote control) to set the minutes.
- 7 Press **DISPLAY/CLOCK** to confirm the time.

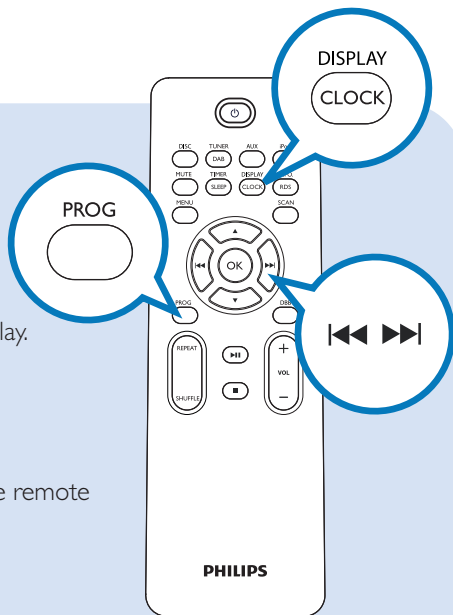

Step C *Enjoy*

Playing a disc

- 1 Select **CD** source.
- 2 Lift the CD door on the top of the system to open the CD compartment.
- 3 Insert a disc with the printed side facing up and press down on **PULL TO OPEN** to close the CD door.
- 4 Press **▶ ||** to start playback.
- 5 Press **■** to stop playback.

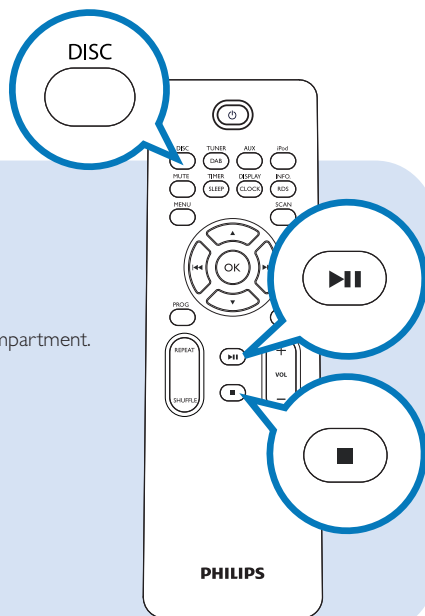

Step C *Enjoy*

Tuning to DAB stations

- 1 Press **SOURCE** (or **DAB** on the remote control) to select DAB to start an automatic search of available DAB stations.
- 2 Press **◀◀ / ▶▶** to change the DAB stations.
- 3 Press **OK** to confirm a selection.
- 4 To perform a local scan (in UK), press briefly **SCAN**.
To perform a full scan (outside UK), press and hold **SCAN**.
- 5 To access setup options, press **MENU** then use the navigation control buttons to select.

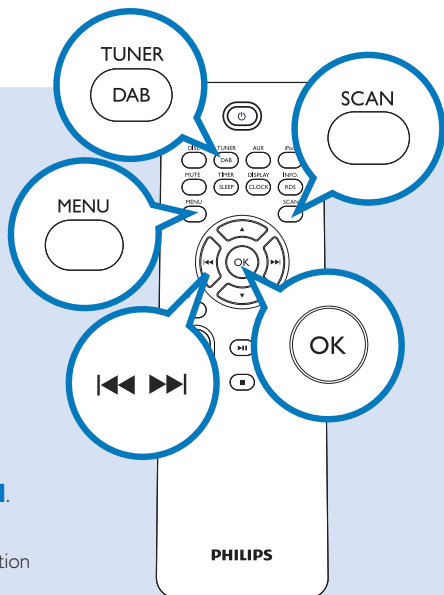

Programming and tuning to FM stations

- 1 Select FM TUNER source.
- 2 Press **SCAN** for more than two seconds to program all available stations (FM only).
- 3 Press **PRESET +/-** (or **▲ / ▼** on the remote control) until the desired preset station is displayed.

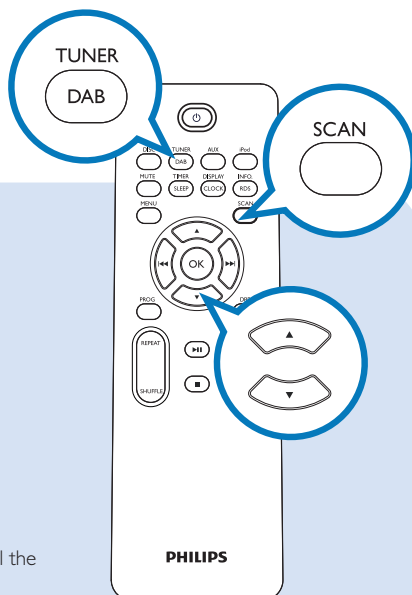

Step C *Enjoy*

Playing iPod using the dock

- 1** Press **PUSH TO OPEN** to open the dock.
- 2** Select the dock adaptor of the correct type and size, and snap it into the dock.
 - Each iPod adaptor has its indication to fit a specific iPod.
- 3** Correctly place your iPod in the dock.
- 4** Press **SOURCE** repeatedly or **DOCK** on the set (or **iPOD** on the remote control) to select iPod source.
 - The connected player will play automatically.
 - The iPod battery will be charged in either normal standby mode or power-on mode.

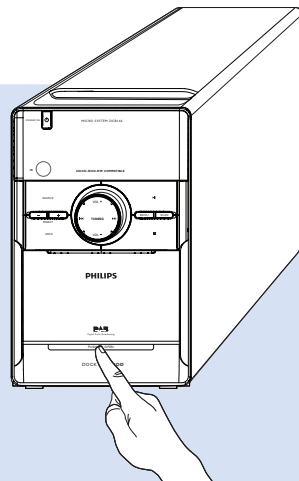

Tip:

Detailed playback features and additional functions are described in the accompanied user manual.

Notes for the remote control:

- First, select the source you wish to control by pressing one of the source select keys on the remote control (DISC or AUX, for example).
- Then select the desired function (▶▶, ◀◀, ▶▶▶ for example).



© Royal Philips Electronics N.V. 2010
All rights reserved.

<http://www.philips.com>

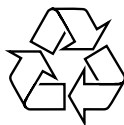

DCB146_05_QSG_V2.0