

# Always there to help you

Register your product and get support at  
[www.philips.com/welcome](http://www.philips.com/welcome)



FWM2200



# User Manual

**PHILIPS**

# Contents

---

<b>1</b>	<b>Important</b>	<b>3</b>
	Know these safety symbols	3
	Important Safety Instructions	3

---

<b>2</b>	<b>Your Mini Hi-Fi System</b>	<b>4</b>
	Introduction	4
	What's in the box	4
	Overview of the main unit	5
	Overview of the remote control	6

---

<b>3</b>	<b>Get started</b>	<b>8</b>
	Connect MW (AM) antenna	8
	Connect speakers	8
	Prepare the remote control	8
	Connect power	9
	Turn on	9
	Set clock	9

---

<b>4</b>	<b>Play from hard media</b>	<b>10</b>
	Play a disc	10
	Play from a USB storage device	10
	Basic play operations	10
	Repeat and shuffle play	11
	Program tracks	11

---

<b>5</b>	<b>Listen to radio</b>	<b>11</b>
	Tune to a radio station	11
	Store radio stations automatically	11
	Store radio stations manually	12
	Select a preset radio station	12

---

<b>6</b>	<b>Play audio from an external device</b>	<b>12</b>
----------	---	-----------

---

<b>7</b>	<b>Adjust sound</b>	<b>13</b>
----------	---------------------	-----------

---

<b>8</b>	<b>Display information</b>	<b>14</b>
----------	----------------------------	-----------

---

<b>9</b>	<b>Set the alarm timer</b>	<b>14</b>
----------	----------------------------	-----------

---

<b>10</b>	<b>Set the sleep timer</b>	<b>15</b>
-----------	----------------------------	-----------

---

<b>11</b>	<b>Product information</b>	<b>15</b>
	Specifications	15
	USB playability information	16
	Supported MP3 disc formats	16
	Maintenance	16

---

<b>12</b>	<b>Troubleshooting</b>	<b>17</b>
-----------	------------------------	-----------

---

<b>13</b>	<b>Notice</b>	<b>18</b>
	Compliance	18
	Care of the environment	18
	Trademark notice	19
	Copyright	19

# 1 Important

## Know these safety symbols



This 'bolt of lightning' indicates uninsulated material within the device may cause an electrical shock. For the safety of everyone in your household, please do not remove the covering.

The 'exclamation mark' calls attention to features for which you should read the enclosed literature closely to prevent operating and maintenance problems.

**WARNING:** To reduce the risk of fire or electric shock, the device should not be exposed to rain or moisture and objects filled with liquids, such as vases, should not be placed on the device.

**CAUTION:** To prevent electric shock, fully insert the plug. (For regions with polarized plugs: To prevent electric shock, match wide blade to wide slot.)

## Important Safety Instructions

- Read these instructions.
- Heed all warnings.
- Follow all instructions.
- Do not block any ventilation openings. Install in accordance with the manufacturer's instructions.
- Do not install near any heat sources such as radiators, heat registers, stoves, or other unit (including amplifiers) that produce heat.
- Protect the power cord from being walked on or pinched, particularly at plugs, convenience receptacles, and the point where they exit from the clock radio.
- Only use attachments/accessories specified by the manufacturer.
- Use only with the cart, stand, tripod, bracket, or table specified by the manufacturer or sold with the Hi-Fi system. When a cart is used, use caution when moving the cart/unit combination to avoid injury from tip-over.



- Unplug this Hi-Fi system during lightning storms or when unused for long periods of time.
- Refer all servicing to qualified service personnel. Servicing is required when the Hi-Fi system has been damaged in any way, such as power-supply cord or plug is damaged, liquid has been spilled or objects have fallen into the Hi-Fi system, the Hi-Fi system has been exposed to rain or moisture, does not operate normally, or has been dropped.
- This Hi-Fi system shall not be exposed to dripping or splashing.
- Do not place any sources of danger on the Hi-Fi system (e.g. liquid filled objects, lighted candles).
- Battery usage CAUTION – To prevent battery leakage which may result in bodily injury, property damage, or damage to the unit:
- Install all batteries correctly, + and - as marked on the Hi-Fi system.
- Remove batteries when the Hi-Fi system is not used for a long time.
- Where the MAINS plug or an appliance coupler is used as the disconnect device, the disconnect device shall remain readily operable.

## Warning

- Never remove the casing of this apparatus.
- Never lubricate any part of this apparatus.
- Never place this apparatus on other electrical equipment.
- Keep this apparatus away from direct sunlight, naked flames or heat.
- Never look into the laser beam inside this apparatus.
- Ensure that you always have easy access to the power cord, plug or adaptor to disconnect this apparatus from the power.

Risk of overheating! Never install this apparatus in a confined space. Always leave a space of at least four inches around this apparatus for ventilation. Ensure curtains or other objects never cover the ventilation slots on this apparatus.

## Note

- The type plate is located on the bottom of the apparatus.

# 2 Your Mini Hi-Fi System

Congratulations on your purchase, and welcome to Philips! To fully benefit from the support that Philips offers, register your product at [www.philips.com/welcome](http://www.philips.com/welcome).

## Introduction

**With this Hi-Fi system, you can:**

- enjoy audio from discs, USB device, or other external devices, and
- listen to FM/AM radio stations

**To enrich sound, this Hi-Fi system offers you these sound effects:**

- Digital Sound Control (DSC)
- Dynamic Bass Boost (DBB)
- Max Sound for instant power boost

**The Hi-Fi system supports these media formats:**



## What's in the box

Check and identify the contents of your package:

- Main unit
- Remote control (with batteries)

- Speaker box x 2
- AM loop antenna
- MP3 link cable
- Round-to-flat power plug converter
- Short user manual

## Overview of the main unit

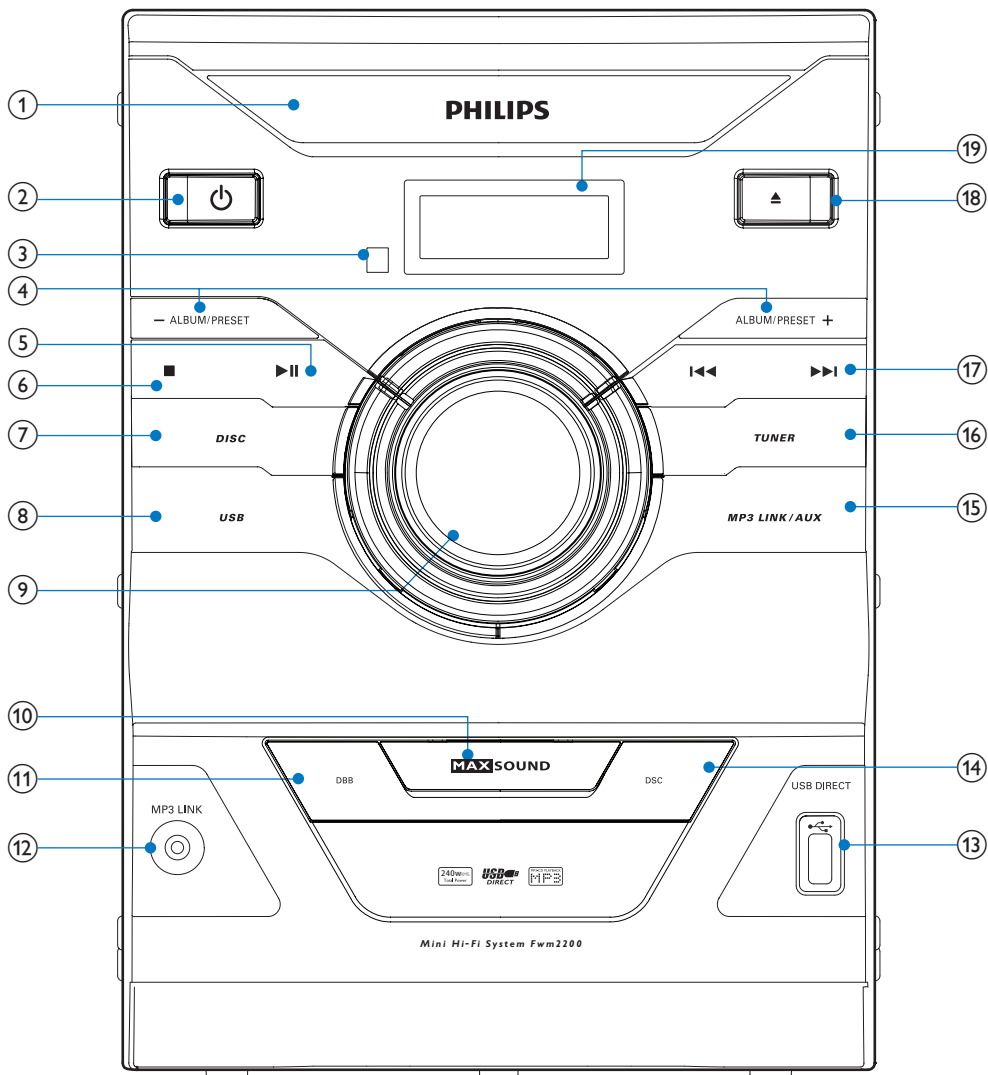

- ① **Disc compact**
- ② **⏻**
  - Power on the Hi-Fi system.
  - Switch to standby mode.
- ③ **iR sensor**
  - Receive the infrared signals from the remote control.
- ④ **ALBUM/PRESET +/-**
  - Select a preset radio station.
  - Skip to previous/next album.
- ⑤ **▶||**
  - Start or pause play.
- ⑥ **■**
  - Stop play or erase a program.
- ⑦ **DISC**
  - Select the disc source.
- ⑧ **USB**
  - Select USB source.
- ⑨ **Volume controller**
  - Adjust volume.
- ⑩ **MAX SOUND**
  - Turn on/off instant power boost.
- ⑪ **DBB**
  - Turn on/off dynamic bass enhancement.
- ⑫ **MP3 LINK**
  - Connect to an external audio device.
- ⑬ **USB DIRECT**
  - Connect a USB storage device.
- ⑭ **DSC**
  - Select a preset sound setting.
- ⑮ **MP3 LINK/AUX**
  - Select the MP3 link/AUX source.
- ⑯ **TUNER**
  - Select a tuner source.
- ⑰ **⏮ / ⏭**
  - Skip to previous/next track.
  - Search within a track/disc.
  - Tune to a radio station.
  - Adjust time.

- ⑱ **▲**
  - Eject or close the disc tray.
- ⑲ **Display panel**
  - Display current status.

## Overview of the remote control

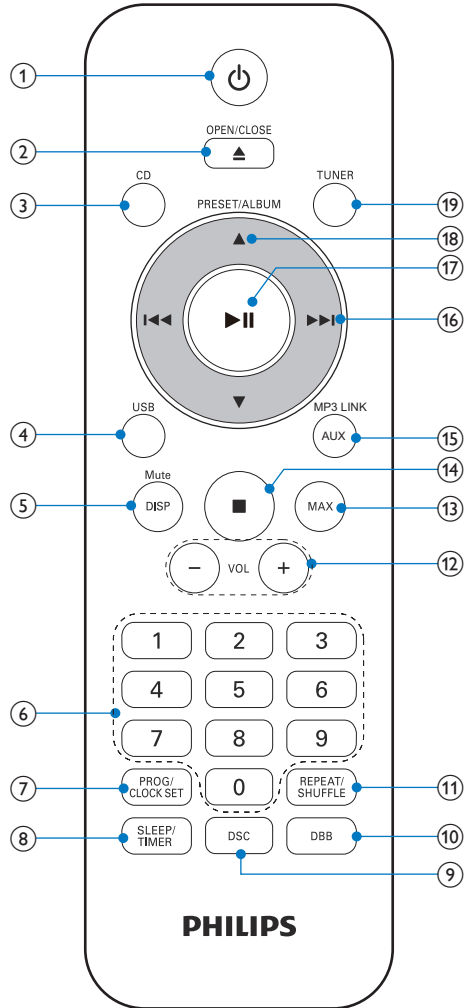

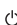
- ① 
  - Turn on the Hi-Fi system.
  - Switch to standby mode.
- ② **OPEN/CLOSE ▲**
  - Open/close the disc tray.
- ③ **CD**
  - Select disk source.
- ④ **USB**
  - Select USB source.
- ⑤ **DISP/MUTE**
  - Mute/unmute sound.
  - Display clock and play information.
- ⑥ **Numeric keypad**
  - Select a track from a disc directly.
- ⑦ **PROG/CLOCK SET**
  - Set time.
  - Program tracks and radio stations.
- ⑧ **SLEEP/TIMER**
  - Set alarm/sleep timer.
- ⑨ **DSC**
  - Select a preset sound setting.
- ⑩ **DBB**
  - Turn on/off dynamic bass enhancement.
- ⑪ **REPEAT/SHUFFLE**
  - Play tracks repeatedly/randomly.
- ⑫ **VOL +/-**
  - Adjust volume.
- ⑬ **MAX**
  - Turn on/off instant power boost.
- ⑭ **■**
  - Stop play.
  - Erase a program.
- ⑮ **MP3 LINK/AUX**
  - Select MP3 Link/AUX source.
- ⑯ **◀◀ / ▶▶**
  - Search within a track.
  - Tune to a radio station.
  - Skip to the previous/next track.
  - Adjust time.
- ⑰ **▶▶**
  - Start or pause play.
- ⑱ **PRESET/ALBUM ▲▼**
  - Select a preset radio station.
  - Skip to previous/next album.
- ⑲ **TUNER**
  - Select tuner source.

# 3 Get started

## ! Caution

- Use of controls or adjustments or performance of procedures other than herein may result in hazardous radiation exposure or other unsafe operation.

Always follow the instructions in this chapter in sequence.

## Connect MW (AM) antenna

1 Assemble the MW (AM) loop antenna.

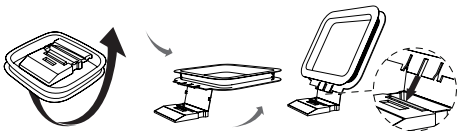

2 Connect the MW (AM) loop antenna to the **AMANT** socket at the back of the Hi-Fi system.

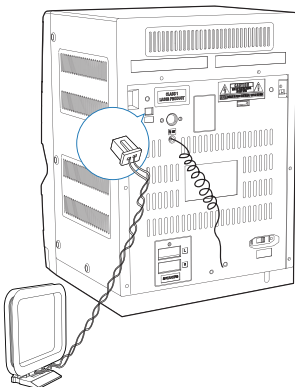

## Connect speakers

### ≡ Note

- For better sound effect, use the supplied speakers only.
- Connect only speakers with impedance that is the same or higher than the supplied speakers. Refer to the Specifications section of this manual.

Insert speaker wires completely into the speaker sockets at the back of the Hi-Fi system.

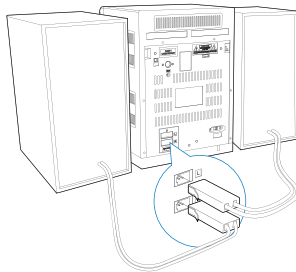

## Prepare the remote control

### ! Caution

- Risk of explosion! Keep batteries away from heat, sunshine or fire. Never discard batteries in fire.
- Risk of decreased battery life! Never mix different brands or types of batteries.

Before using the remote control, install two AAA batteries with correct polarity (+/-) as indicated.



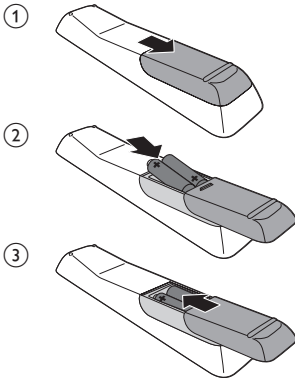

## Connect power

### ! Caution

- Risk of product damage! Make sure that the power supply voltage corresponds to the voltage printed on the bottom or back of the unit.
- Risk of electric shock! When you unplug the power cord, always hold the plug securely. Never pull the cord.

### ☰ Note

- Before connecting the AC power cord, make sure that you have completed all other connections.
- Before connecting power, switch the power voltage selector on the back panel to select the voltage that matches local power supply.

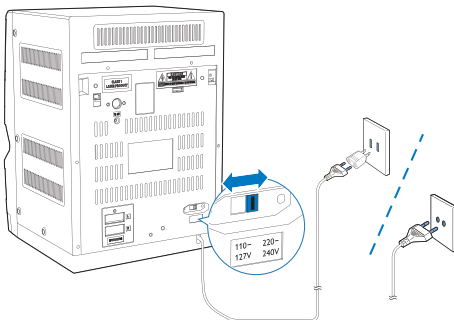

## Turn on

Press  $\phi$ .

- ↳ The Hi-Fi system switches to the last selected source.

## Switch to standby mode

Press  $\phi$  to switch the Hi-Fi system to standby mode.

- ↳ The clock (if set) appears on the display panel.

## Set clock

- 1 In standby mode, press and hold **CLOCK SET** for two seconds.
  - ↳ **[SET CLOCK]** (set clock) scrolls on the display, and then **[24H/12H]** appears.
- 2 Press **◀◀ / ▶▶** to select a time format.
  - **[24H]**: 24-hour time format
  - **[12H]**: 12-hour time format
- 3 Press **CLOCK SET** to confirm.
  - ↳ The hour digits begin to blink.
- 4 Repeat steps 2 and 3 to set the hour and minute.
  - To exit clock setting mode, press **■**.

## 4 Play from hard media

### Play a disc

#### Note

- Make sure that the disc contains playable audio content.

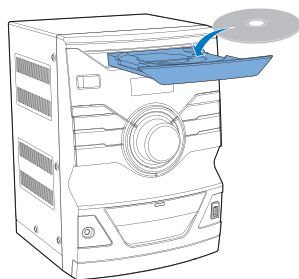



- 1 Press **CD** to select the disc source.
- 2 Press **▲**.  
↳ The disc tray opens.
- 3 Insert a disc with the printed side facing up, then press **▲** to close the disc tray.  
↳ **[Read]** (read) blinks for about 10 seconds, then play starts automatically.

### Play from a USB storage device

#### Note

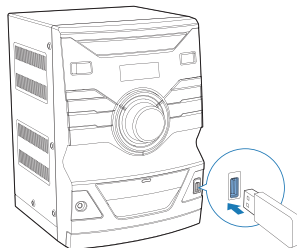
- Make sure that the USB storage device contains playable audio content.



- 1 Insert the USB storage device into the  socket.
- 2 Press **USB** to switch the source to USB storage device.  
↳ Play starts automatically.







### Basic play operations

You can control play through following operations.

Function	Action
To stop play	press <b>■</b> .
To pause/resume play	press <b>▶  </b> .
To skip to a track	press <b>◀◀ / ▶▶</b> .
To search during play	press and hold <b>◀◀ / ▶▶</b> , then release to resume normal play.
To select an album (for MP3/WMA)	press <b>▲ / ▼</b> .
To select a track directly	press the numeric buttons.

---







## Repeat and shuffle play

- 1 Press **REPEAT/SHUFFLE** repeatedly to select:
  -  : play the current track repeatedly.
  -  ALL (repeat all): play all tracks repeatedly.
  -  ALB (for MP3/WMA only): play the current album repeatedly.
  -  : play all tracks randomly.
- 2 To return to normal play, press **REPEAT/SHUFFLE** repeatedly until  or  disappears.

---

## Program tracks

You can program a maximum of 20 tracks.

- 1 In CD/USB mode, when no track is played, press **PROG**.  
↳ **[PROG]** (program) and the preset number blink on the display panel.
- 2 For MP3/WMA tracks, press  /  to select an album.
- 3 Press  /  to select a track number; and then press **PROG** to confirm.
- 4 Repeat steps 2 and 3 to program more tracks.
- 5 Press  to play the programmed tracks.  
↳ During play, **[PROG]** (program) is displayed.
  - To erase the program, press  twice.

# 5 Listen to radio



---

### Note



- For optimal reception, fully extend the antenna and adjust its position.
- You can store a maximum of 30 FM radio stations and 10 MW (AM) stations.

---

## Tune to a radio station

- 1 Press **TUNER** repeatedly to select FM/MW(AM) tuner source.
- 2 Press and hold  /  until the frequency changes.  
↳ The Hi-Fi system tunes to the previous or next station with strong reception automatically.

### To tune to a weak station,

- Press  /  repeatedly to find optimal reception.

---

## Store radio stations automatically

In tuner mode, press and hold **PROG** until **[AUTO]** (auto) is displayed.

- ↳ The system stores all the available stations.
- ↳ After the search is complete, the first available station is broadcast automatically.

---

## Store radio stations manually

- 1 Tune to an FM/MW(AM) radio station.
- 2 Press **PROG**.  
↳ The preset number begins to blink.
- 3 Press **▲** / **▼** repeatedly to select a preset number.
- 4 Press **PROG** again to confirm.
- 5 Repeat Steps 1 to 4 to store other stations.
  - To replace a preset station, store another station with its preset number.

---

## Select a preset radio station

In tuner mode, press **▲** / **▼** repeatedly to select a preset radio station.

## 6 Play audio from an external device

With this Hi-Fi system, you can play audio from an external audio device.

**For an audio device with a headphone socket**

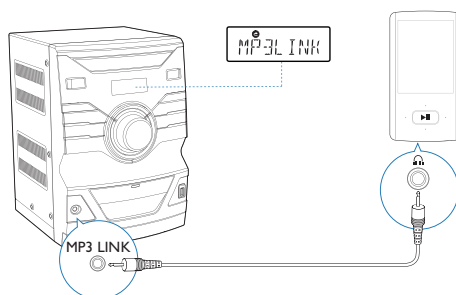

- 1 Press **MP3 LINK/AUX** to select MP3 link source.
- 2 Connect the MP3 Link cable (not supplied) to
  - the **MP3 LINK** socket.
  - the headphone socket on an external device.
- 3 Play audio on the external device (see the user manual of this device).

For other audio devices

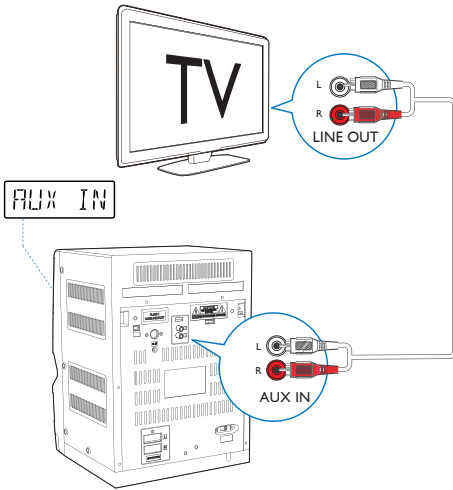

- 1 Press **MP3 LINK/AUX** repeatedly to select AUX source.
- 2 Connect the audio cables to:
  - the **AUX IN** sockets.
  - the audio output sockets on an external device.
- 3 Play the device (see the user manual of this device).

## 7 Adjust sound

During play, you can adjust volume and select sound effects:

Function	Action
To increase/decrease volume	Press <b>VOL +/-</b> .
To mute/unmute sound	Press and hold <b>MUTE</b> for two seconds.
To turn on/off instant power boost	Press <b>MAX</b> .
To turn on/off dynamic bass enhancement	Press <b>DBB</b> .
To select a preset sound effect ( <b>ROCK</b> , <b>OPTIMAL</b> , and <b>TECHNO</b> )	Press <b>DSC</b> repeatedly.

## 8 Display information

During play, press **DISP** repeatedly to view time and other play information.

## 9 Set the alarm timer



### Note

- Make sure that you have set the clock correctly.

- 1** In standby mode, press and hold **SLEEP/TIMER** until **SET TIMER** scrolls.
- 2** Press **CD**, **TUNER**, or **USB** to select an alarm source.
- 3** Press **SLEEP/TIMER** to confirm.
- 4** Press **I◀◀ / ▶▶I** to set the hour.
- 5** Press **SLEEP/TIMER** to confirm.
- 6** Repeat steps 4 and 5 to set the minute.  
↳ 🕒 is displayed.
  - To deactivate the set alarm timer, press **SLEEP/TIMER** repeatedly until 🕒 disappears.
  - To activate the set alarm timer again, press **SLEEP/TIMER** repeatedly until 🕒 is displayed.

# 10 Set the sleep timer

You can set a time period after which this Hi-Fi system switches to standby mode automatically. Press **SLEEP/TIMER** repeatedly to select a period (in minutes).

↳ When the sleep timer is activated, **zzz** is displayed.

- To deactivate the sleep timer, press **SLEEP/TIMER** repeatedly until **SLP OFF** is displayed.

# 11 Product information



## Note

- Product information is subject to change without prior notice.

## Specifications

### General information

AC power	110 - 127V/220 - 240V ~, 50/60Hz
----------	----------------------------------

Operation power consumption	100 W
-----------------------------	-------

Maximum load of USB socket	5 V, 0.5 A
----------------------------	------------

Dimensions	
- Main Unit (W x H x D)	223 x 313 x 252 mm
- Speaker Box (W x H x D)	195 x 310 x 207 mm

Weight	
- With Packing	9.7 kg
- Main Unit	3.6 kg
- Speaker Boxes	2 x 2.1 kg

### Amplifier

Rated Output Power	2 X 110 W (30% THD)
--------------------	---------------------

Frequency Response	63 - 16000 Hz, $\pm 3$ dB
--------------------	---------------------------

Signal to Noise Ratio	> 55 dBA
-----------------------	----------

AUX input	2 V RMS
-----------	---------

MP3 Link	650 mV RMS
----------	------------

---

## Disc

Laser Type	Semiconductor
Disc Diameter	12 cm, 8 cm
Support Disc	CD-DA, CD-R, CD-RW, MP3-CD, WMA-CD
Audio DAC	24 Bits / 44.1kHz
Total Harmonic Distortion	< 1%
Frequency Response	63 Hz - 16 kHz
S/N Ratio	> 60 dBA

---

## Tuner

Tuning Range	FM: 87.50 - 108.00 MHz MW: 530 - 1710 kHz
Tuning grid	FM: 50 kHz MW: 10 kHz
Sensitivity (Mono, 26dB S/N Ratio)	< 22 dBu (FM), < 86 dBu (MW)
Total Harmonic Distortion	< 3%
Signal to Noise Ratio	> 45 dBA (FM), > 40 dBA (MW)

---

## Speakers

Speaker Impedance	6 Ohm
-------------------	-------

---

## USB playability information

### Compatible USB devices:

- USB flash memory (USB 2.0 or USB1.1)
- USB flash players (USB 2.0 or USB1.1)
- memory cards (requires an additional card reader to work with this unit)

### Supported formats:

- USB or memory file format FAT12, FAT16, FAT32 (sector size: 512 bytes)
- MP3 bit rate (data rate): 32-320 kbps and variable bit rate
- WMA v9 or earlier

- Directory nesting up to a maximum of 8 levels
- Number of albums/ folders: maximum 999
- Number of tracks/titles: maximum 999
- ID3 tag v2.0 or later
- File name in Unicode UTF8 (maximum length: 128 bytes)

### Unsupported formats:

- Empty albums: an empty album is an album that does not contain MP3/WMA files, and will not be shown in the display.
- Unsupported file formats are skipped. For example, Word documents (.doc) or MP3 files with extension .dlf are ignored and not played.
- AAC, WAV, PCM audio files
- DRM protected WMA files (.wav, .m4a, .m4p, .mp4, .aac)
- WMA files in Lossless format

---

## Supported MP3 disc formats

- ISO9660, Joliet
- Maximum title number: 511 (depending on file name length)
- Maximum album number: 511
- Supported sampling frequencies: 32 kHz, 44.1kHz, 48 kHz
- Supported Bit-rates: 32~320 (kbps), variable bit rates
- ID3 tag v2.0 or later

---

## Maintenance

### Clean the cabinet

- Use a soft cloth slightly moistened with a mild detergent solution. Do not use a solution containing alcohol, spirits, ammonia or abrasives.



### Clean discs

- When a disc becomes dirty, clean it with a cleaning cloth. Wipe the disc from the centre out.

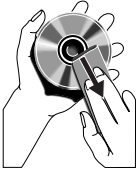

- Do not use solvents such as benzene, thinner, commercially available cleaners, or antistatic spray intended for analogue records.

### Clean the disc lens

- After prolonged use, dirt or dust may accumulate at the disc lens. To ensure good play quality, clean the disc lens with Philips CD lens cleaner or any commercially available cleaner. Follow the instructions supplied with cleaner.

## 12 Troubleshooting



### Warning

- Never remove the casing of this device.

To keep the warranty valid, never try to repair the system yourself.

If you encounter problems when using this device, check the following points before requesting service. If the problem remains unsolved, go to the Philips Web page ([www.philips.com/support](http://www.philips.com/support)). When you contact the Consumer Care, make sure that the device is nearby and the model number and serial number are available.

### No power

- Ensure that the AC power plug of the unit is connected properly.
- Ensure that there is power at the AC outlet.
- To save power, the system switches off automatically 15 minutes after track play reaches the end and no control is operated.

### No sound or poor sound

- Adjust the volume.
- Check that the speakers are connected correctly.
- Check if the stripped speaker wires are clamped.

### No response from the Hi-Fi system

- Disconnect and reconnect the AC power plug, then turn on the system again.
- As a power-saving feature, the unit switches off automatically 15 minutes after track play reaches the end and no control is operated.

### Remote control does not work

- Before you press any function button, first select the correct source with the remote control instead of the main unit.

- Reduce the distance between the remote control and the unit.
- Insert the battery with its polarities (+/– signs) aligned as indicated.
- Replace the battery.
- Aim the remote control directly at the sensor on the front of the unit.

#### No disc detected

- Insert a disc.
- Check if the disc is inserted upside down.
- Wait until the moisture condensation at the lens has cleared.
- Replace or clean the disc.
- Use a finalized CD or correct format disc.

#### Poor radio reception

- Increase the distance between the unit and your TV or VCR.
- Fully extend the FM antenna.
- Connect an outdoor FM antenna instead.

#### Alarm does not work

- Set the clock/alarm correctly.

#### Clock/alarm setting erased

- Power has been interrupted or the power plug has been disconnected.
- Reset the clock/alarm.

#### USB device not supported

- The USB device is incompatible with the unit. Try another one.

## 13 Notice

Any changes or modifications made to this device that are not expressly approved by WOOX Innovations may void the user's authority to operate the equipment.

---

## Compliance

This apparatus includes this label:



Class II equipment symbol:



CLASS II apparatus with double insulation, and no protective earth provided.

---

## Care of the environment



Your product is designed and manufactured with high quality materials and components, which can be recycled and reused. Never dispose of your product with other household waste. Please inform yourself about the local rules on the separate collection of electrical and electronic products and batteries. The correct disposal of these products helps prevent potentially negative consequences on the environment and human health. Your product contains batteries, which cannot be disposed of with normal household waste.

Please inform yourself about the local rules on separate collection of batteries. The correct disposal of batteries helps prevent potentially negative consequences on the environment and human health.

Please visit [www.recycle.philips.com](http://www.recycle.philips.com) for additional information on a recycling center in your area.

### **Environmental information**

All unnecessary packaging has been omitted. We have tried to make the packaging easy to separate into three materials: cardboard (box), polystyrene foam (buffer) and polyethylene (bags, protective foam sheet.)

Your system consists of materials which can be recycled and reused if disassembled by a specialized company. Please observe the local regulations regarding the disposal of packaging materials, exhausted batteries and old equipment.

---

## Trademark notice



Windows Media and the Windows logo are trademarks, or registered trademarks of Microsoft Corporation in the United States and/or other countries.

---

## Copyright

2014 © WOOX Innovations Limited. All rights reserved.

Philips and the Philips' Shield Emblem are registered trademarks of Koninklijke Philips N.V. and are used by WOOX Innovations Limited under license from Koninklijke Philips N.V. Specifications are subject to change without notice. WOOX reserves the right to change products at any time without being obliged to adjust earlier supplies accordingly.



2014 © WOOX Innovations Limited. All rights reserved.

This product was brought to the market by WOOX Innovations Limited or one of its affiliates, further referred to in this document as WOOX Innovations, and is the manufacturer of the product. WOOX Innovations is the warrantor in relation to the product with which this booklet was packaged. Philips and the Philips Shield Emblem are registered trademarks of Koninklijke Philips N.V.

FWM2200\_55\_UM\_V3.0

