

Quick start guide



- Step A *Connect*
- Step B *Setup*
- Step C *Enjoy*

What's in the Box?

You should find these items upon opening the box.

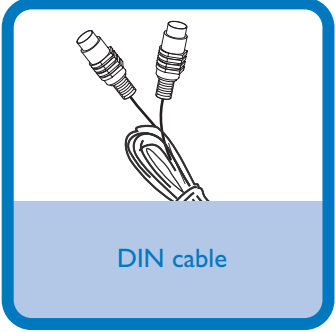
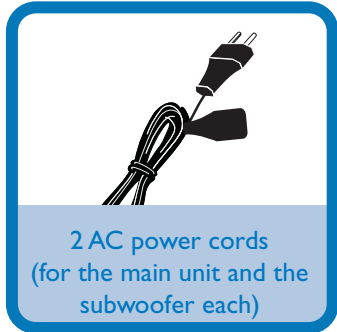
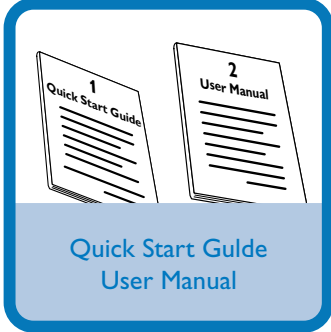
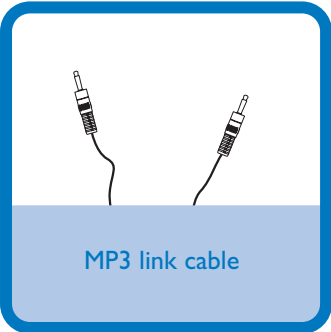
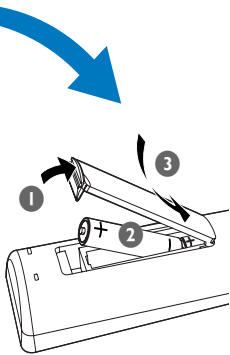
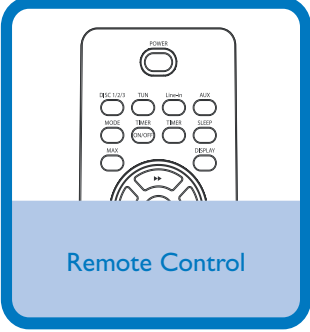
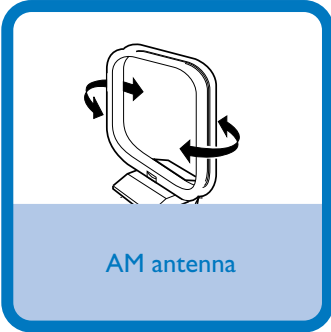
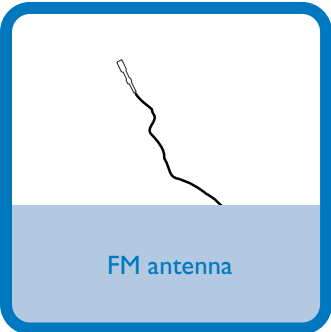

Step A *Connect*

- 1 Connect the AM and FM antennas.
- 2 Connect the speaker cables.
- 3 Connect the subwoofer and the main unit using the supplier DIN cable.
- 4 Connect the supplied AC power cords to the main unit and the subwoofer.
- 5 To turn on or off the subwoofer, press **POWER** switch on the back of the subwoofer.

Important!

This set can only be operated after the supplied DIN cable has been connected.

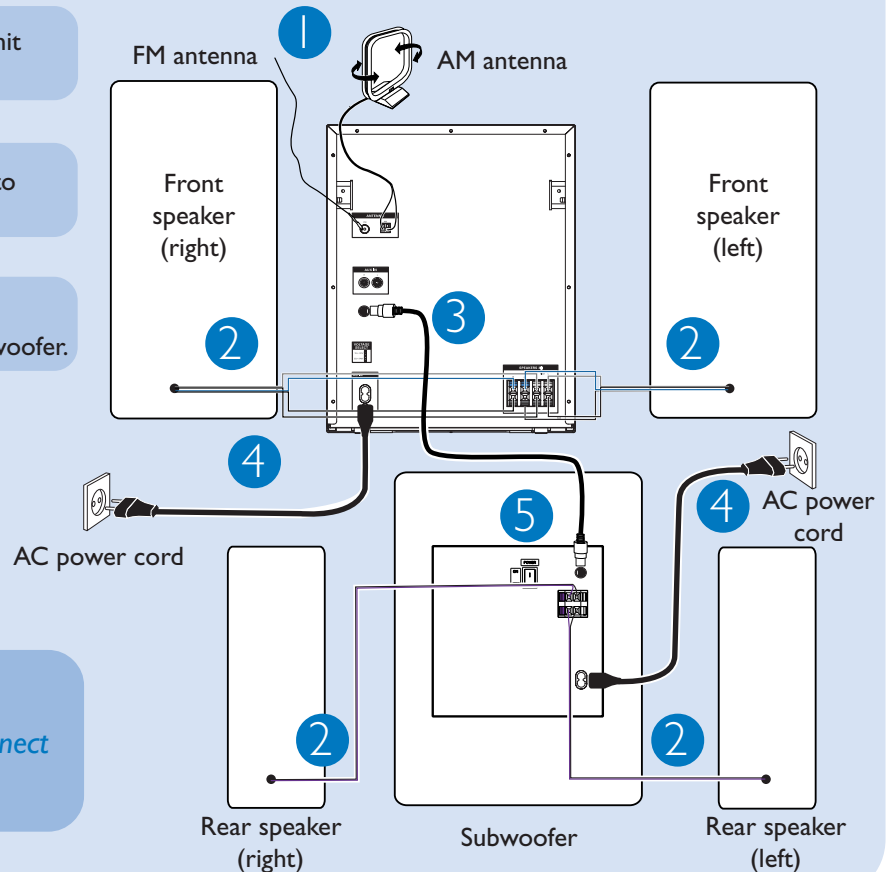

Tip

See the User Manual on how to connect other equipment to this system.

Step B *Setup*

Setting the clock

- 1 In standby or view clock mode, press **PROG/CLOCK** (or **CLOCK** on the remote control) once.
- 2 Press **ALBUM/PRESET +/-** (or **ALBUM +/-** (◀ / ▶) on the remote control) to select clock mode.
- 3 Press **PROG/CLOCK** (or **CLOCK** on the remote control) again to activate and adjust clock time.
- 4 Press **ALBUM/PRESET +/-** (or **ALBUM +/-** (◀ / ▶) on the remote control) repeatedly to set the hour.
- 5 Press ◀◀ / ▶▶ (or **TITLE - / +** (◀ / ▶) on the remote control) repeatedly to set the minute.
- 6 Press **PROG/CLOCK** (or **CLOCK** on the remote control) again to store the setting.

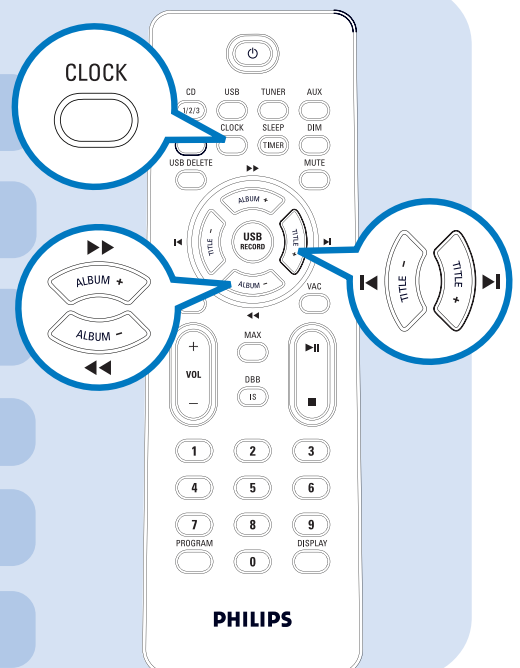

Playing a disc

- 1 Press **OPEN•CLOSE** to open the disc tray and load up to two discs on the individual disc trays. To load the third disc, press **DISC CHANGE**.
→ Make sure the label side of each loaded disc is facing up.

- 2 Press **OPEN•CLOSE** again to close the disc tray.

- 3 Use **DISC 1/2/3** (or **CD 1/2/3** on the remote control) to select a disc for playback.

- 4 To stop playback, press **■**.

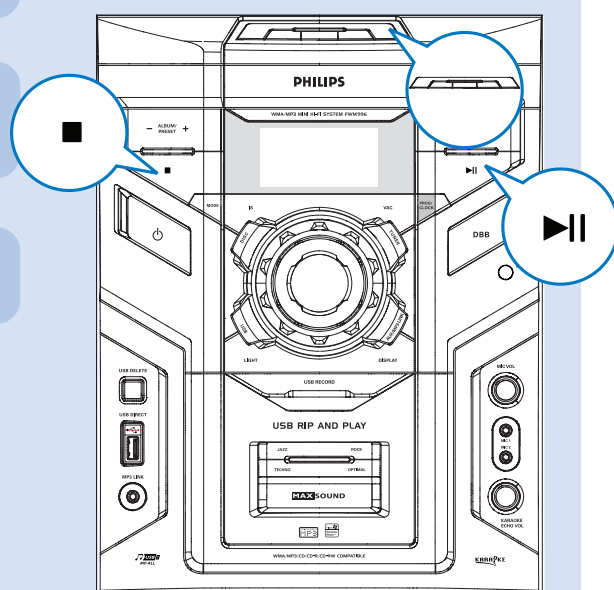
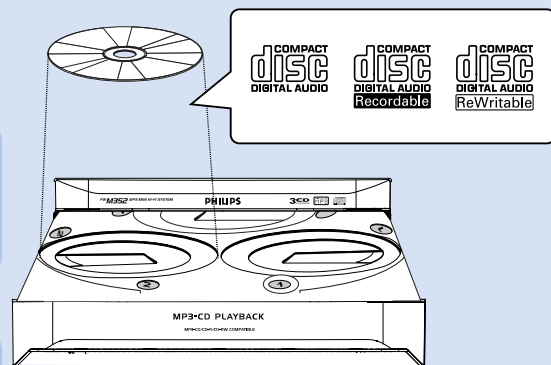

Programming and tuning to radio stations

- 1 Press **TUNER** repeatedly to select the tuner source.
- 2 Press **PROG/CLOCK** (or **PROGRAM** on the remote control) for more than two seconds to program all available stations in order of waveband.
- 3 Press **ALBUM/PRESET +/-** (or **TITLE - / +** (◀ / ▶) on the remote control) until the desired preset station is displayed.

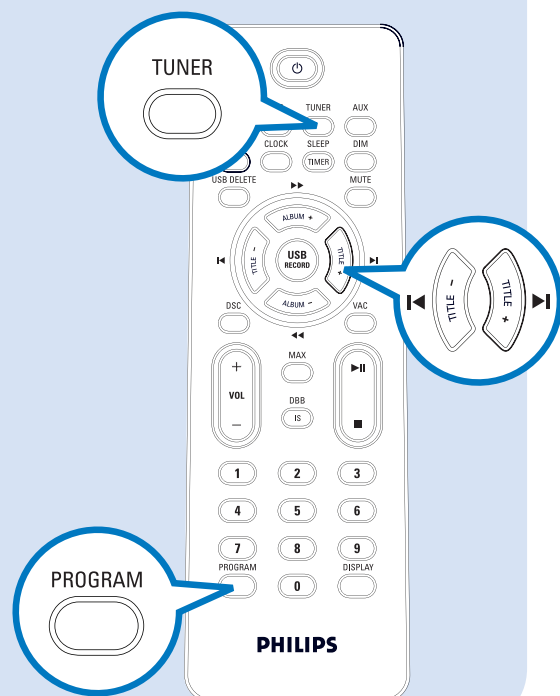



Playing a USB mass storage device

With the Hi-Fi system, you can use USB flash memory (USB 2.0 or USB1.1), USB flash players (USB 2.0 or USB1.1), memory cards (requires an additional card reader to work with this Hi-Fi system).

- 1 Insert the USB device's USB plug into the socket  on the set.
- 2 Press **USB** to select the USB source.
- 3 Play the USB's audio files as you do with the albums/tracks on a CD.

Ripping function

- 1 Insert a USB mass device with sufficient free space to the **USB DIRECT**  socket on the set.
- 2 Prepare the source to record from.
- 3 Press **USB RECORD** to start ripping.
- 4 At any moment, simply press  to stop ripping.

Tip

Detailed playback features and additional functions are described in the accompany owner's manual.



© Royal Philips Electronics N.V. 2008
All rights reserved.

<http://www.philips.com>

