

**DVD Micro Theatre**

MCD906

Register your product and get support at

**[www.philips.com/welcome](http://www.philips.com/welcome)**

User manual

使用说明



**PHILIPS**

# HDMI

HDMI (High Definition Multimedia Interface) is a digital interface that allows pure HD digital video transmission without the loss of image quality.

The integrated control bus allows system control between the TV set and connected devices like a digital set top box.

## **Manufactured under license from Dolby Laboratories.**

"Dolby", "Pro Logic" and the double-D symbol are trademarks of Dolby Laboratories.

## **CAUTION**

**Use of controls or adjustments or performance of procedures other than herein may result in hazardous radiation exposure or other unsafe operation.**

This product incorporates copyright protection technology that is protected by method claims of certain U.S. patents and other intellectual property rights owned by Macrovision Corporation and other rights owners. Use of this copyright protection technology must be authorized by Macrovision Corporation, and is intended for home and other limited viewing uses only unless otherwise authorized by Macrovision Corporation. Reverse engineering or disassembly is prohibited.

**DivX, DivX Certified, and associated logos are trademarks of DivX Networks, Inc and are used under license.**



**Windows Media is a trademark of Microsoft Corporation.**

English ..... 4

中文 ..... 35

# Contents

## General Information

Features .....	6
Supplied accessories .....	7
Environmental information .....	7
Installation .....	7
Maintenance .....	7
Hearing Safety .....	8

## Connections

Step 1: Placing the speakers .....	9
Step 2: Connecting speakers .....	9
Step 3: Connecting TV .....	10
Using Composite Video jack .....	10
Using Component Video jacks (Y Pb Pr) .....	10
Using S-Video jack .....	11
Using an accessory RF modulator .....	11
Connecting to a TV with HDMI Jack .....	12
Step 4: Connecting FM antenna .....	12
Step 5: Connecting the power cord .....	13
Additional: Connecting additional equipment .....	13
Additional connection: Connecting a USB device or memory card .....	13

## Functional Overview

DVD player and power amplifier .....	14
Remote control .....	15

## Getting Started

Step 1: Inserting batteries into the Remote Control .....	17
Using the Remote Control to operate the Player .....	17
Step 2: Setting up the TV .....	17
Selecting the colour system that corresponds to your TV .....	17
Setting up Progressive Scan feature (for Progressive Scan TV only) .....	17
To deactivate Progressive manually .....	18
Step 3: Setting language preference .....	19

## Basic Operations

Switching the system on/off .....	20
Power-saving automatic standby .....	20
Volume control .....	20
Sound control .....	20
Bass enhancement .....	20
Treble adjustment .....	20
DSC (Digital Sound Control) .....	20
LOUDNESS .....	20
Dimming the display screen .....	20

## Disc Operations

Region Codes .....	21
Playing discs .....	21
Using the Disc Menu .....	21
Basic playback controls .....	21
Pausing playback .....	21
Selecting a track/chapter/title .....	21
Resuming playback from the last stopped point .....	21
Zoom .....	22
Repeat & Shuffle .....	22
Repeat A-B .....	22
Slow Motion .....	22
Program .....	22
Forward/Reverse Searching .....	22
Time search & search by chapter/track number .....	22
Information display during playback .....	22
Special disc features .....	23
Playing a Title .....	23
Camera Angle .....	23
Changing the Audio Language .....	23
Changing the Audio Channel .....	23
Subtitles .....	23
Playing MP3/WMA/JPEG Picture CD .....	23
Special JPEG features .....	23
Preview function .....	23
Zoom picture .....	23
Playback with multi-angles .....	23
Playing a DivX disc .....	24

## External Sources

Using a USB mass storage device .....	25
---------------------------------------	----

## System Menu Options

Basic operations .....	26
General Setup Page .....	26
TV DISPLAY .....	26
OSD LANG .....	26
SCREEN SAVER .....	26
DIVX(R) VOD .....	26
Audio Setup Page .....	26
SPDIF SETUP .....	26
DOLBY DIGITAL SETUP .....	27
3D PROCESSING .....	27
HDCD .....	27
NIGHT MODE .....	27
AUDIO SYNC .....	27
Video Setup Page .....	27
COMPONENT .....	27
TV MODE .....	27
QUALITY .....	27
HDMI SETUP .....	28
Preference Page .....	28
PARENTAL .....	28
DEFAULT .....	28
PASSWORD SETUP .....	28

## Other Functions

Radio Reception .....	29
Tuning to radio stations .....	29
Presetting radio stations .....	29
Listening to preset radio stations .....	29
Setting the clock .....	30
Setting sleep/wake-up timer .....	30
Sleep timer setting .....	30
Wake-up timer setting .....	30

## Specifications .....

31

## Troubleshooting .....

32

# General Information

Congratulations on your purchase and welcome to Philips!

To fully benefit from the support that Philips offers, register your product at [www.philips.com/welcome](http://www.philips.com/welcome).

## Features

Your DVD Micro Theatre with 2.0 channel full digital amplifier creates the same dynamic sound qualities that you find in full-fledged cinemas and incorporates some of the best features in home theater technology.

### Other features include:

Built-in Dolby Digital decoder; supporting DSC sound setting.

### Additional Component Connections

Lets you connect other audio and audio/visual components to the DVD micro theatre.

### Night mode

Lets you compress the dynamic range, reducing the difference in loudness between different sounds in Dolby Digital mode.

### Parental Control (Rating Level)

Lets you set a ratings level so that your children cannot watch a DVD that has a rating higher than you set.

### Sleep/Wake-up Timer

Enables the system to switch on/off automatically at a preset time.

### Progressive Scan

Provides high quality flicker-free images for film based sources. When a picture refreshes, its vertical resolution can double to 525 lines.

#### Note:

- To fully enjoy the *progressive scan feature*, you need a *progressive scan TV*.

## Hi-Fi Tube Sound from DVD Micro Theatre

### Why do I need it?

You deserve an immersive sound experience like an audiophile.

The built-in vacuum tube preamplifier enables you to experience the highest quality sound normally you can only find in premium Hi-Fi audio equipment.

Music is dynamic and is played to be heard by human ears. The analogue nature of tube gives a more pleasing sound to the nonlinear human ear-brain hearing system. Tube sound has less distortion than solid-state sound and audiophiles always prefer tubes for their clean, warm and far more detailed and life-like sound.

### What is it?

Vacuum tube is not something new, but always a premium.

Before the introduction of transistors, most electronic amplifier used vacuum tubes. By 60s', solid-state amplification became more common, but tube amplifier has retained a loyal following among audiophiles with modern units from companies commanding very high price.

### How does it work?

Amplifiers are available based on solid-state (semiconductor) technology or vacuum-tube (valve) technology. Many audiophile systems separate the functions of the preamplifier-which selects audio signals and has a volume control- and the power amplifier; which takes a line-level audio signal and drives the loudspeakers. Audiophiles find the tube preamplifier product a more faithful and detailed reproduction in comparison to the solid-state preamplifier.

## Supplied accessories

- Remote control with two AAA batteries
- FM wire antenna
- Composite video cable (yellow)
- 2 front speakers including 2 speaker cables
- This instruction booklet and a Quick Start Guide

***If any item is damaged or missing, contact your retailer or Philips.***

## Environmental information

All unnecessary packaging has been omitted. We have tried to make the packaging easy to separate into three materials: cardboard (box), polystyrene foam (buffer) and polyethylene (bags, protective foam sheet).

Your system consists of materials which can be recycled and reused if disassembled by a specialised company. Please observe the local regulations regarding the disposal of packaging materials, exhausted batteries and old equipment.

## Installation

- Place the player on a flat, hard, and stable surface.
- In a cabinet, allow about 10cm (4 inches) of free space all around the player for adequate ventilation.

- Do not expose your player to extreme temperatures or humidity.
- The apparatus shall not be exposed to dripping or splashing.
- No objects filled with liquids, such as vases, shall be placed on the apparatus.
- No naked flame sources, such as lighted candles, shall be placed on the apparatus.
- Install this unit near the AC outlet and where the AC power plug can be reached easily.
- The ventilation should not be impeded by covering the ventilation openings with items, such as newspapers, table-cloths, curtains, et.

## Maintenance

- When a disc becomes dirty, clean it with a cleaning cloth. Wipe the disc from the center out, in a straight line.
- Do not expose the player, batteries or discs to humidity, rain, sand or excessive heat (caused by heating equipment or direct sunlight). Always keep the disc tray closed to avoid dust on the lens.
- Do not use solvents such as benzene, thinner, commercially available cleaners, or anti-static spray intended for colour discs.
- The lens may cloud over when the player is suddenly moved from cold to warm surroundings, making it impossible to play a disc. Leave the player in the warm environment until the moisture evaporates.



## Hearing Safety

### **Listen at a moderate volume.**

- Using headphones at a high volume can impair your hearing. This product can produce sounds in decibel ranges that may cause hearing loss for a normal person, even for exposure less than a minute. The higher decibel ranges are offered for those that may have already experienced some hearing loss.
- Sound can be deceiving. Over time your hearing "comfort level" adapts to higher volumes of sound. So after prolonged listening, what sounds "normal" can actually be loud and harmful to your hearing. To guard against this, set your volume to a safe level before your hearing adapts and leave it there.

### **To establish a safe volume level:**

- Set your volume control at a low setting.
- Slowly increase the sound until you can hear it comfortably and clearly, without distortion.

### **Listen for reasonable periods of time:**

- Prolonged exposure to sound, even at normally "safe" levels, can also cause hearing loss.
- Be sure to use your equipment reasonably and take appropriate breaks.

### **Be sure to observe the following guidelines when using your headphones.**

- Listen at reasonable volumes for reasonable periods of time.
- Be careful not to adjust the volume as your hearing adapts.
- Do not turn up the volume so high that you can't hear what's around you.
- You should use caution or temporarily discontinue use in potentially hazardous situations.
- Do not use headphones while operating a motorized vehicle, cycling, skateboarding, etc.; it may create a traffic hazard and is illegal in many areas.



## IMPORTANT!

- The type plate is located at the bottom of the system.
- Before connecting the AC power cord to the wall outlet, ensure that all other connections have been made.
- Never make or change any connections with the power switched on.

## Step 1: Placing the speakers

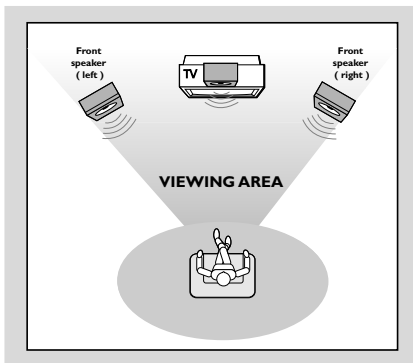

- Place the front left and right speakers at equal distances from the TV set and at an angle of approximately 45 degrees from the listening position.

### Notes:

- To avoid magnetic interference, do not position the front speakers too close to your TV set.
- Allow adequate ventilation around the DVD System.

## Step 2: Connecting speakers

- Connect the left and right speakers to the SPEAKERS ( $4\Omega$ ) terminals on the back of the system with the supplied speaker cables. Right speaker to "R" and left speaker to "L", red wire to "+" and silver wire to "-". Fully insert the stripped portion of the speaker wire into the terminal as shown.

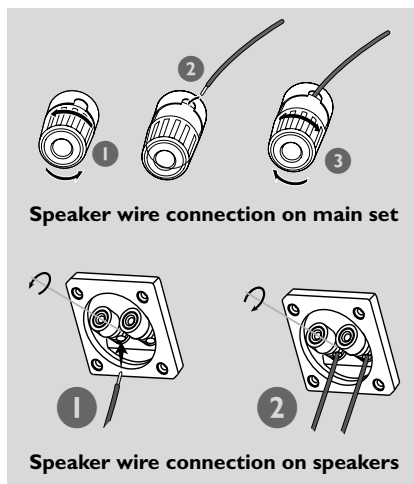

### Notes:

- Ensure that the speaker cables are correctly connected. Improper connections may damage the system due to short-circuit.
- For optimal sound performance, use the supplied speakers.
- Do not connect more than one speaker to any one pair of +/- speaker jacks.
- Do not connect speakers with an impedance lower than the speakers supplied. Please refer to the SPECIFICATIONS section of this manual.

# Connections

## Step 3: Connecting TV

### IMPORTANT!

- You only need to make one video connection from the following options, depending on the capabilities of your TV.
- Connect the DVD system directly to the TV.

### Using Composite Video jack

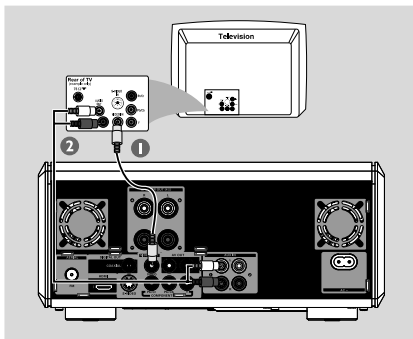

- 1 Use the composite video cable (yellow) to connect the system's **VIDEO** jack to the video input jack (or labelled as A/V In, Video In, Composite or Baseband) on the TV set.
- 2 To listen to the TV channels through this DVD system, use the audio cables (white/red-not supplied) to connect **AUX IN L/R** jacks to the corresponding AUDIO OUT jacks on the TV.

### Using Component Video jacks (Y Pb Pr)

### IMPORTANT!

- The progressive scan video quality is only possible when using Y Pb Pr, and a progressive scan TV is required.

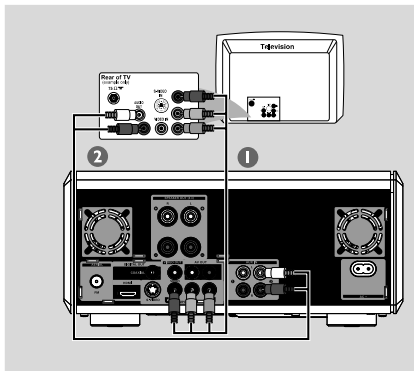

- 1 Use component video cables (red/blue/green - not supplied) to connect the DVD system's **COMPONENT (Pr/Cr Pb/Cb Y)** jacks to the corresponding Component video input jacks (or labeled as Y Pb/Cb Pr/Cr or YUV) on the TV.
- 2 To listen to the TV channels through this DVD system, use the audio cables (white/red-not supplied) to connect **AUX IN L/R** jacks to the corresponding AUDIO OUT jacks on the TV.
- 3 If you are using a Progressive Scan TV (TV must indicate Progressive Scan or ProScan capability), to activate TV Progressive Scan, please refer to your TV user manual. For DVD system Progressive Scan function, see "Getting Started-Setting up Progressive Scan feature".

### Note:

- If your TV does not support Progressive Scan, you will not be able to view the picture. Press **SYSTEM** on the remote control to exit the system menu. Then press **DISC** followed by "1" to exit progressive scan.

## Using S-Video jack

### IMPORTANT!

– If **S-Video** is used for DVD playback connection, the system's **COMPONENT** setting will need to be changed accordingly.

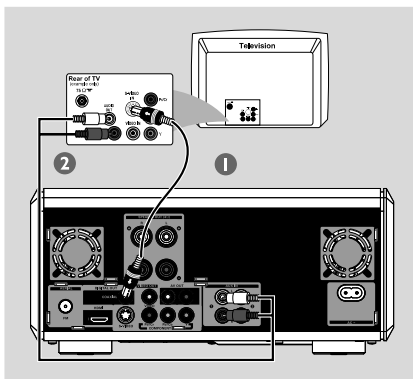

- 1 Use an S-Video cable (not supplied) to connect the DVD system's **S-VIDEO** jack to the S-Video input jack (or labeled as Y/C or S-VHS) on the TV.
- 2 To listen to the TV channels through this DVD system, use the audio cables (white/red-not supplied) to connect **AUX IN L/R** jacks to the corresponding AUDIO OUT jacks on the TV.

## Using an accessory RF modulator

### IMPORTANT!

– If your TV only has a single Antenna In jack (labeled as 75 ohm or RF In), you will need an RF modulator in order to view DVD playback on the TV. See your electronics retailer or contact Philips for details on RF modulator availability and operations.

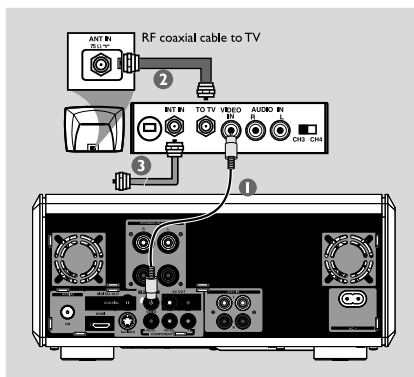

- 1 Use the composite video cable (yellow) to connect the DVD system's **VIDEO** jack to the video input jack on the RF modulator.
- 2 Use an RF coaxial cable (not supplied) to connect ANTENNA OUT or TO TV jack on the RF modulator to the Antenna IN jack on the TV.
- 3 Connect the Antenna or Cable TV service signal to the ANTENNA IN or RF IN jack on the RF modulator. (It may have been connected to your TV previously. Disconnect it from the TV.)

# Connections

## Connecting to a TV with HDMI Jack

HDMI connects untouched and uncompressed digital transmission for the highest and crispest sound/image quality.

It has plug and play capability using only one cable for both audio/video output.

- Use a HDMI cable (not supplied) to connect the **HDMI** jack on the DVD Player to **HDMI IN** on a HDMI compatible device (e.g.;TV, Projector, Adaptor).
  - It may take a while for the DVD player and input device to communicate and initialise.
  - Playback starts automatically.

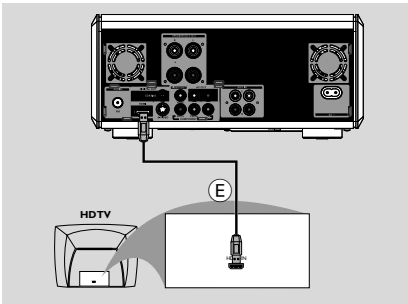

### Notes:

- Proceed to "Setup Menu Options" → "VIDEO SETUP PAGE" → "HDMI SETUP" for detailed HDMI setup.
- If you are using the HDMI as audio source make sure that "DIGITAL OUTPUT" is set to "PCM only" (see "Setup Menu Options" → "AUDIO SETUP PAGE" → "DIGITAL AUDIO SETUP").
- To stop sound output from your TV after making the HDMI connection, make sure that "DIGITAL OUTPUT" is set to "SPDIF OFF" (see "Setup Menu Options" → "AUDIO SETUP PAGE" → "DIGITAL AUDIO SETUP").

## Step 4: Connecting FM antenna

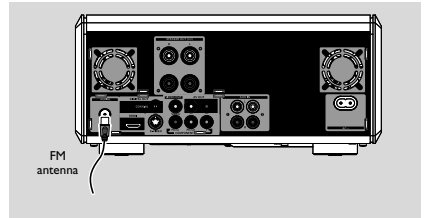

- Connect the supplied FM antenna to the **FM ANENNA** (75  $\Omega$ ) jack. Extend the FM antenna and fix its end to the wall.
- For better FM stereo reception, connect an external FM antenna (not supplied).

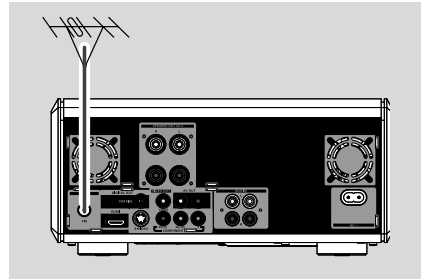

### Note:

- Adjust the position of the antenna for optimal reception.
- Position the antennas as far as possible from your TV,VCR or other radiation source to prevent unwanted interference.

## Step 5: Connecting the power cord

After everything is connected properly, plug in the AC power cord to the power outlet.

Never make or change any connection with the power switched on.

## Additional: Connecting additional equipment

### IMPORTANT!

- Some discs are copy-protected. You cannot record the disc through a VCR or digital recording device.
- When making connections, make sure the colour of cables matches the colour of jacks.
- Always refer to the owner's manual of the other equipment for complete connection and usage details.

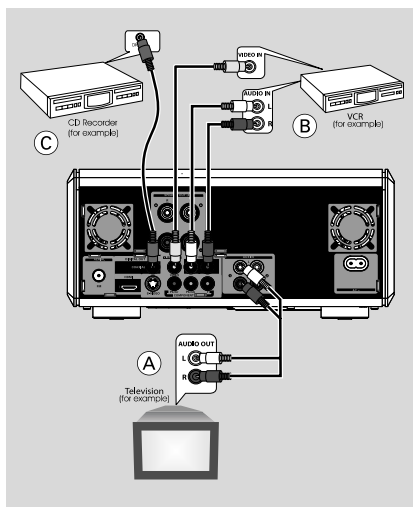

## Viewing and listening to the playback of other equipment (A)

- Connect the system's **AUX IN L/R** jacks to the **AUDIO OUT** jacks on the other audio/visual device (such as a TV, VCR, Laser Disc player or cassette deck).  
Before starting operation, press **SOURCE** on the front panel to select **AUX** or press **AUX** on the remote control in order to activate the input source.

## Using the VCR for recording DVDs (B)

- Connect one of the system's **VIDEO OUT** jacks to the corresponding **VIDEO IN** jack and **AV OUT** jacks to the **AUDIO IN** jacks on the VCR. This will allow you to make analogue stereo (two channel, right and left) recordings.

## Recording (digital) (C)

- Connect the system's **DIGITAL OUT (COAXIAL)** jack to the **DIGITAL IN** jack on a digital recording device.

## Additional connection: Connecting a USB device or memory card

By connecting a USB mass storage device (including USB flash memory, USB flash players or memory cards) to the Hi-Fi system, you can enjoy the device's stored music through the powerful speakers of Hi-Fi system.

- Insert the USB device's USB plug into the  socket on the set.

### for the devices with USB cables:

- 1 Insert one plug of the USB cable (not supplied) to the  socket on the set.
- 2 Insert the other plug of the USB cable to the USB output terminal of the USB device.

### for the memory card:

- 1 Insert the memory card into a card reader (not supplied).
- 2 Use a USB cable (not supplied) to connect the card reader into the  socket on the set.

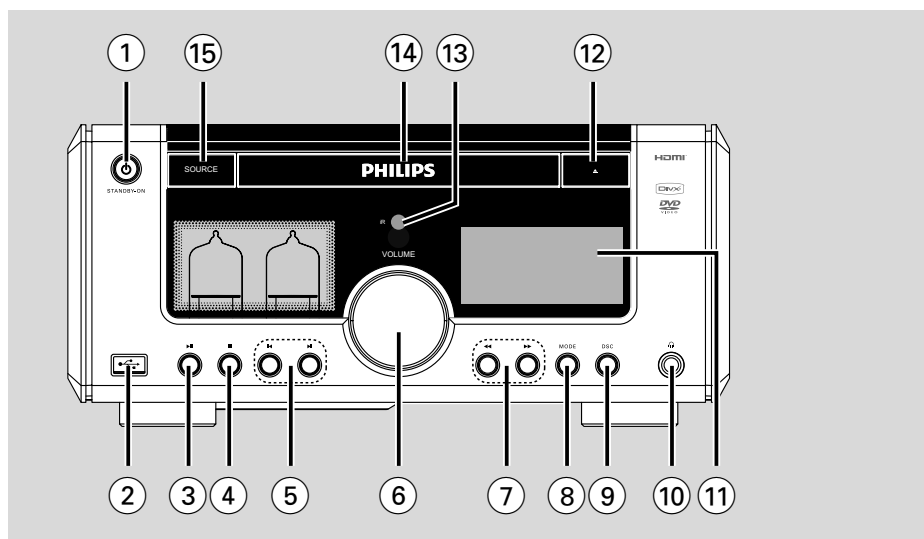

## DVD player and power amplifier

### ① **STANDBY-ON**

- switches the system on or to standby mode.

### ②

- is the jack for an external USB mass storage device.

### ③

- starts or interrupts disc playback.

### ④

- stops disc playback or erases a program.

### ⑤

- skips to the previous/next chapter/title/track.

### ⑥ **VOLUME +/-**

- adjusts the volume upward/downward.
- adjusts the hours and minutes in clock/timer setting mode.
- switches the set timer ON or OFF.

### ⑦

Tuner

- press to tune to a lower/higher radio frequency gradually.
- press and hold, then release the key to start automatic search for a radio frequency downward/upward.

Disc/USB

- searches fast backward/forward.

### ⑧ **MODE**

- selects various repeat modes or the shuffle play mode for a disc.

### ⑨ **DSC**

- selects different types of preset sound equalizer settings (CLASSIC, JAZZ, ROCK, POP or FLAT).

### ⑩

- connect a headphone.

### ⑪ **Display**

- shows the current status of the DVD player.

### ⑫

- opens or closes the disc tray.

### ⑬ **IR SENSOR**

- point the remote control towards this sensor.

### ⑭ **Disc tray**

- loads a disc.

### ⑮ **SOURCE**

- to select the respective sound source : TUNER, DISC, USB or AUX.

## Remote control

- ①
  - switches the system on or to standby mode.
- ②
  - opens or closes the disc tray.
- ③ **SOURCE**
  - to select the respective sound source : TUNER, DISC, USB or AUX.

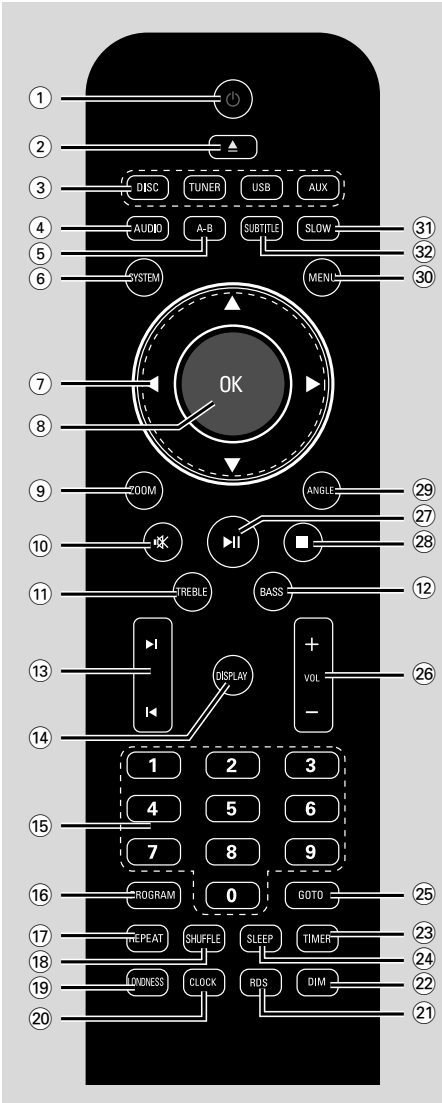

- ④ **AUDIO**
  - for VCD/DivX
    - sets Stereo, Mono-Left or Mono-Right sound mode.
  - for DVD
    - selects an audio language.
- ⑤ **A-B**
  - repeats playback of a specific section on a disc.
- ⑥ **SYSTEM (disc mode only)**
  - enters or exits the system menu.
- ⑦ / / /
  - In DISC mode, to select a movement direction in the disc menu or system menu bar.
  - Tuner /
    - press to tune to a lower/higher radio frequency gradually.
    - press and hold, then release the key to start automatic search for a radio frequency downward/upward.
  - Disc/USB /
    - searches fast backward/forward.
- ⑧ **OK**
  - confirms a selection.
- ⑨ **ZOOM**
  - DVD/VCD/Picture CD: enlarges or reduces a picture or active image on the TV screen.
- ⑩
  - disables or enables sound output.
- ⑪ **TREBLE**
  - to adjust the treble (high tone) level.
- ⑫ **BASS**
  - to adjust the bass boost level.

# Functional Overview

## ⑬ ◀/▶

- Disc/USB: skips to the previous/next chapter/ title/track.
- Tuner: selects a preset radio station.

## ⑭ DISPLAY

- displays information on TV screen during playback

## ⑮ Numeric Keypad (0-9)

- inputs a track/title/chapter number of the disc.

## ⑯ PROGRAM

- DVD/VCD/CD/MP3-CD/USB: enters the program menu.
- Picture CD: during playback, to select a slide show mode.
- Tuner: programs preset radio stations.

## ⑰ REPEAT

- selects a repeat playback mode.

## ⑱ SHUFFLE

- plays disc/USB tracks randomly.

## ⑲ LOUDNESS

- enables or disables automatic loudness adjustment.

## ⑳ CLOCK

Standby mode

- \*– sets the system clock.

Playback mode

- displays the system clock.

## ㉑ RDS (unavailable for this version)

## ㉒ DIM

- selects different levels of brightness for the display screen.

## ㉓ TIMER

Standby mode

- sets time for switching on the system automatically.

## ㉔ SLEEP

Power-on mode

- sets the sleep timer function (auto off).

## ㉕ GOTO

- In DISC mode, to fast search in a disc by entering a time, title, chapter or track.

## ㉖ VOL +/-

- adjusts the volume upward/downward.
- adjusts the hours and minutes in clock/timer setting mode.
- selects a source in timer setting mode.

## ㉗ ►||

- starts or interrupts disc playback.

## ㉘ ■

- stops disc playback or erases a program.

## ㉙ ANGLE

- selects a DVD camera angle.

## ㉚ MENU (disc mode only)

- DVD/VCD: enters or exits the disc contents menu.
- VCD2.0: switches the playback control mode on or off.

## ㉛ SLOW

- selects different slow playback modes for a VCD/SVCD/DVD.

## ㉜ SUBTITLE

- selects a subtitle language.

### Notes for remote control:

- First, select the source you wish to control by pressing one of the source select keys on the remote control (DISC or TUNER, for example).
- Then select the desired function (►||, ◀, ▶ for example).



# Getting Started

## Step 1: Inserting batteries into the Remote Control

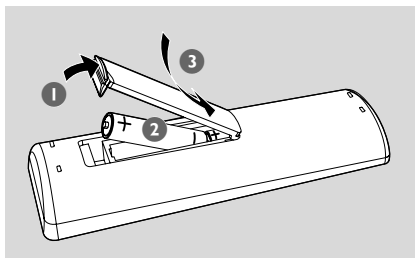

- 1 Open the battery compartment.
- 2 Insert two AAA batteries following the indications (+/-) inside the compartment.
- 3 Close the cover:

### Using the Remote Control to operate the Player

- 1 Aim the Remote Control directly at the remote sensor (IR) on the front panel.
- 2 Do not put any objects between the Remote Control and the DVD Player while operating the DVD Player.

### CAUTION!

- Remove batteries if they are exhausted or if the Remote Control is not being used for a long time.
- Do not use old and new or different types of batteries in combination.
- Batteries contain chemical substances, so they should be disposed of properly.

## Step 2: Setting up the TV

### IMPORTANT!

**Make sure you have completed all the necessary connections. (See "Connecting TV").**

- 1 Switch the DVD system on and then select DISC source. (See "Switching the system on/off").
- 2 Turn on the TV and set to the correct video-in channel. You should see the blue Philips DVD background screen on the TV.

### Selecting the colour system that corresponds to your TV

This DVD Player is compatible with both NTSC and PAL. In order for a DVD disc to play on this Player, the colour system of the Disc, the TV and the DVD Player should match.

- 1 Press **SYSTEM** in full stop mode.
- 2 Press ◀ (◀◀) / ▶ (▶▶) to select "PREFERENCE PAGE".
- 3 Use ◀ (◀◀) / ▶ (▶▶) / ▲ / ▼ on the remote to navigate in the menu.

Move to "TV TYPE" and press ▶ (▶▶).

→ **PAL**: Select this if the connected TV is PAL system. It will change the video signal of a NTSC disc and output in PAL format.

→ **AUTO**: Select this if the connected TV is compatible with both NTSC and PAL (multi-system). The output format will be in accordance with the video signal of the disc.

→ **NTSC**: Select this if the connected TV is NTSC system. It will change the video signal of a PAL disc and output in NTSC format.

- 4 Select an item and press **OK**.

### Notes:

- This option is available only when the "HDMI" is set to "OFF".
- Before changing the current TV Type setting, ensure that your TV supports the selected TV Type.

### Setting up Progressive Scan feature (for Progressive Scan TV only)

### IMPORTANT!

**Before enabling the progressive scan feature, you must ensure:**

- 1) Your TV can accept progressive signals, a progressive scan TV is required.
- 2) You have connected the DVD player to your TV using Y Pb Pr (see "Connections-Step 3: Connecting TV- Using Component Video jacks").

# Getting Started

- 1 Turn on your TV.
- 2 Turn off your TV progressive scan mode or turn on interlaced mode (refer to your TV user manual).
- 3 Press **STANDBY-ON** (⏻) on the remote to turn on the DVD player.
- 4 Select the correct Video Input channel.  
→ The DVD background screen appears on the TV.
- 5 Press **SYSTEM**.
- 6 Press ◀ (◀◀) / ▶ (▶▶) repeatedly to select "**VIDEO SETUP PAGE**".
- 7 Select "**TV MODE**" to "**P-SCAN**", then **OK** to confirm.  
→ The instruction menu appears on the TV.

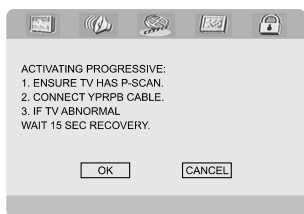

- 8 Press ◀ (◀◀) / ▶ (▶▶) to highlight OK in the menu and press **OK** to confirm.  
**There will be a distorted picture on your TV at this state until you turn on the progressive scan mode on your TV.**

- 9 Turn on your TV progressive scan mode (refer to your TV user manual).  
→ The below menu appears on the TV.

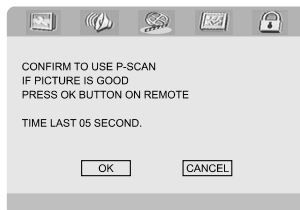

- 10 Press ◀ (◀◀) / ▶ (▶▶) to highlight OK in the menu and press **OK** to confirm.  
→ The setup is complete now and you can start enjoy the high quality picture.

## To deactivate Progressive manually

- **When the distorted sign still appears on the TV**, it may be due to the connected TV does not accept progressive signals, and progressive is set by mistake. You must reset the unit to interlace format.
- 1 Turn off your TV progressive scan mode or turn on to interlaced mode (refer to your TV user manual).
- 2 Press **SYSTEM** on the remote control to exit the system menu. Then press **DISC** followed by "1" to exit progressive scan.  
→ The DVD blue background screen will appear on the TV.

### Note:

- During normal playback in the progressive scan mode, pressing **DISC** button and "1" will exit the progressive scan mode.

## Step 3: Setting language preference

- 1 In stop mode or during playback, press **SYSTEM**.
- 2 Press ◀ (◀◀) / ▶ (▶▶) / ▲ / ▼ on the remote control to select your preferred option.
  - Move to **GENERAL SETUP PAGE** or **PREFERENCE PAGE** and press ▼.
  - Move to one of the following and press ▶ (▶▶).

### **OSD LANG** (On-Screen Display)

Switches the display language on the TV screen.  
Select the language from the displayed list.

### **AUDIO** (DVD only)

Switches the display language of the sound track.  
Select the language from the displayed list.

### **SUBTITLE** (DVD only)

Switches the display language of the subtitle.  
Select the language from the displayed list.

### **DISC MENU** (DVD only)

Select the language for the DVD menu.

When the selected language is not recorded in the DVD, one of the recorded languages will be selected automatically (except for OSD).

You can reset all the DVD settings except for Rating.

If the language selected is not available on the disc, the original language designated by each disc will be selected.



- 3 Press ▲/▼ to select a language and press **OK**.
- 4 Repeat **steps 2~3** for other settings.

### **To exit the menu**



Press **SYSTEM** again.

# Basic Operations

## Switching the system on/off

- Press **STANDBY-ON**  (or  on the remote control).  
→ A countdown of 10 seconds starts for preheating of the system. Then, the system will switch to the last selected source.
- Press **DISC, TUNER, USB** or **AUX** on the remote control.  
→ The system will switch to the selected source.

## To switch the system to standby mode

- Press **STANDBY-ON**  (or  on the remote control).  
→ "BYE BYE" is displayed briefly. The interactive sound settings, last selected source and tuner presets will be retained in the player's memory.

## Power-saving automatic standby

As a power-saving feature, the system will automatically switch to Standby mode if you do not press any buttons within 15 minutes after a disc has stopped playing.

## Volume control

Turn **VOLUME (-/+)** clockwise or anticlockwise (or press **VOL +/-** on the remote control) to increase or decrease the volume level.

→ "VOL XX" is displayed on the display panel. "XX" denotes the volume level.

## To switch off the volume temporarily

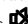
- Press  on the remote control.  
→ Playback will continue without sound and "MUTE" flashes.
- To activate sound reproduction, you can:
  - press  again;
  - adjust the volume controls;
  - change source.

## Sound control

**BASS, TREBLE, DSC and LOUDNESS sound features cannot be activated at the same time.**

### Bass enhancement

Bass adjustment enhances the bass response.

- Press **BASS** on the remote control repeatedly to adjust the bass level.  
→ Some discs might be recorded in high modulation, which causes a distortion at high volume. If this occurs, switch off BASS or reduce the volume.

### Treble adjustment

The treble (high tone) setting enables you to adjust the treble level of the system.

- Press **TREBLE** on the remote control repeatedly adjust the treble level.

### DSC (Digital Sound Control)

- Press **DSC** on the main set repeatedly to select: POP, CLASSIC, FLAT, ROCK or JAZZ.

### LOUDNESS

LOUDNESS feature enables the system to automatically increase the treble and bass sound effect at low volume (the higher the volume, the lower the treble and bass increase).

- Press **LOUDNESS** on the remote to enable or disable LOUDNESS feature.  
→  icon appears/disappears after this feature is enabled/disabled.

## Dimming the display screen

- Press **DIM** on the remote control repeatedly to select different levels of brightness for the display screen.

# Disc Operations

## IMPORTANT!

- Depending on the DVD or VIDEO CD, some operations may be different or restricted.
- Do not push on the disc tray or put any objects other than disc on the disc tray. Doing so may cause the disc player malfunction.
- If the inhibit icon (ø) appears on the TV screen when a button is pressed, it means the function is not available on the current disc or at the current time.

## Region Codes

DVDs must be labeled as shown below in order to play on this DVD system. You cannot play discs that are labeled for other regions.



Note:

- If you are having trouble playing a certain disc, remove the disc and try a different one. Improper formatted disc will not play on this DVD Player.

## Playing discs

- 1 Connect the power cords of the system and TV (or any optional stereo or AV receiver) to a power outlet.
- 2 Turn on the TV power and set to the correct Video In channel. (See “**Setting up the TV**”).
- 3 Press **STANDBY-ON** on the DVD Player front panel or on the remote control.  
→ You should see the blue Philips DVD background screen on the TV.
- 4 Press to open the disc tray and load in a disc, then press the same button again to close the disc tray.  
→ Make sure the label side is facing up.
- 5 Playback will start automatically (depending on the disc type).  
→ If a disc menu appears on the TV, see “**Using the Disc Menu**”.  
→ If the disc is locked by parental control, you must enter your four-digit password. (See “**PASSWORD SETUP PAGE**”).
- 6 At any time, simply press to stop playback.

## Using the Disc Menu

Depending on the disc, a menu may appear on the TV screen once you load the disc.

### To select a playback feature or item

- Use () / () / / and **OK** or **Numeric Keypad (0-9)** on the remote.  
→ Playback will start automatically.

### To access or exit from the menu

- Press **MENU** on the remote control.

### For VCD with Playback Control (PBC) feature (version 2.0 only)

PBC playback allows you to play Video CDs interactively, following the menu on the display.

- During playback, press **MENU**.  
→ If PBC was ON, it will switch to OFF and continue playback.  
→ If PBC was OFF, it will switch to ON and return to menu screen.

## Basic playback controls

### Pausing playback (DVD/VCD/CD/MP3/DivX/WMA)

- 1 During playback, press .
- Playback will pause and sound will be muted.
- 2 Press again to resume.

### Selecting a track/chapter/title (DVD/VCD/DivX/CD)

- 1 Press during playback to go to the next chapter/track
- 2 Press to go to the previous chapter/track.
- 3 To go directly to any chapter/track/title, enter the chapter/track/title number using the **Numeric Keypad (0-9)**.

### Resuming playback from the last stopped point (DVD/VCD/CD)

- In stop mode and when a disc has not been removed, press .

# Disc Operations

## To cancel resume mode

- In stop mode, press ■ again.

## Zoom (DVD/VCD/DivX/JPEG)

Zooming allows you to enlarge or reduce the video image during playback.

- 1 Press **ZOOM** repeatedly to enlarge or reduce the playback video image.
- 2 Press ◀(◀◀) / ▶(▶▶) / ▲ / ▼ to pan across the TV screen.

## Repeat & Shuffle (DVD/VCD/CD/MP3/DivX/WMA)

- Press **MODE** on the system repeatedly or **REPEAT** or **SHUFFLE** on the remote control to choose a repeat or random playback mode during playback.

## Repeat A-B (DVD/VCD/CD/MP3/DivX/WMA)

- 1 Press **A-B** at your chosen starting point.
- 2 Press **A-B** again at your chosen end point.  
→ The section A and B can be set only within the same chapter/track.  
→ The section will now repeat continuously.
- 3 To exit the sequence, press **A-B** again.

## Slow Motion (DVD/VCD)

- 1 Press **SLOW** during playback to select the required speed: 1/2, 1/4, 1/8 or 1/16 (backward or forward).  
→ Sound will be muted.
- 2 To return to normal speed, press ►||

### Note:

- *Slow backward is not possible on VCDs.*

## Program (not for Picture CD)

To select favourite tracks/chapters for playback in preferred sequence.

## For DVD/VCD/CD

- 1 Press **PROGRAM** on the remote control to enter the program mode.

- 2 Use the **Numerical Keypad (0-9)** to directly input the tracks or chapters (single track number with digit "0" in front, for example "05").
- 3 Move the cursor by pressing ◀(◀◀) / ▶(▶▶) / ▲ / ▼ to select **START**.
- 4 Press **OK** to start playback.

## For MP3/WMA

- 1 In Stop mode, press **MENU** to switch the menu between Album and Filelist.
- 2 When Filelist is on the screen, press ▲ ▼ to select the files and press **PROGRAM** to add the files to the program list.
- 3 Press **MENU** to display the program list.
- 4 Press **PROGRAM** to delete unwanted files from the program list.

## Forward/Reverse Searching (DVD/VCD/DivX/CD/MP3/WMA)

- 1 Press ◀◀▶▶ on the system or ◀(◀◀) / ▶(▶▶) on the remote control during playback to select the required speed: 2X, 4X, 8X, 16X or 32X (backward or forward).  
→ Sound will be muted.
- 2 To return to normal speed, press ►||

## Time search & search by chapter/track number (DVD/VCD/CD/MP3/WMA)

- 1 Press **GOTO** until the time or chapter/track edit box appears.
- 2 Enter hours, minutes and seconds from left to right in the time edit box using remote control numerical keypad.

## OR

Enter your desired chapter/track number in the chapter/track edit box using remote control numerical keypad.

## Information display during playback (not for Picture CD)

- During playback, press **DISPLAY** to show disc information on the TV screen.

# Disc Operations

## Special disc features

### Playing a Title (DVD)

- 1 Press **MENU**.  
→ The disc title menu appears on the TV screen.
- 2 Use ◀ (◀◀) / ▶ (▶▶) / ▲ / ▼ or **Numeric Keypad (0-9)** to select a play option.
- 3 Press **OK** to confirm.

### Camera Angle (DVD)

- Press **ANGLE** repeatedly to select different desired angle.

### Changing the Audio Language (for DVD recorded with multiple languages)

- Press **AUDIO** repeatedly to select different audio languages.

### Changing the Audio Channel (for VCD only)

- Press **AUDIO** to select the available audio channels provided by the disc (Mono Left, Mono Right or Stereo).

### Subtitles (DVD)

- Press **SUBTITLE** repeatedly to select different subtitle languages.

## Playing MP3/WMA/JPEG Picture CD

- 1 Load an MP3/WMA/JPEG disc.  
→ The data disc menu appears on the TV screen.
- 2 Use ▲ ▼ to select an album (folder) and press **OK** to open the album (folder).
- 3 Press ▲ ▼ or use the **Numeric Keypad (0-9)** to highlight a track. (file)
- 4 Press **OK** to confirm.  
→ The playback will start from the selected track (file) to the end of the album (folder).

## Special JPEG features

### Preview function (JPEG)

This function shows the content of the current folder or the whole disc.

- 1 Press ■ during playback.  
→ Thumbnails of 12 pictures appears on the TV screen.
- 2 Use ◀ (◀◀) / ▶ (▶▶) / ▲ / ▼ to highlight one of the pictures/"Slide Show" and press **OK** to start playback/slide show.

### To enter the remote key function menu

- Use ◀ (◀◀) / ▶ (▶▶) / ▲ / ▼ to highlight "Menu" and press **OK**.

### To display the other pictures on the previous/next page

- Press ◀ / ▶.
- Use ◀ (◀◀) / ▶ (▶▶) / ▲ / ▼ to highlight "Prev" or "Next" and press **OK**.

### Zoom picture (JPEG)

- During playback, press **ZOOM** repeatedly to display the picture with different scales.
- Use ◀ (◀◀) / ▶ (▶▶) / ▲ / ▼ to view the zoomed picture.

### Playback with multi-angles (JPEG)

- During playback, press ◀ (◀◀) / ▶ (▶▶) / ▲ / ▼ on the remote control to rotate the picture on the TV screen.

# Disc Operations

## Playing a DivX disc

This DVD player supports the DivX movie playback that you download from your computer onto a CD-R/RW (see "System Menu Options-DIVX(R) VOD registration code" for more information).

- ① Load a DivX disc.  
→ Playback will start automatically. If not press ► **II**
- ② If the DivX movie contains external subtitles, the subtitle menu will appear on the TV screen for your selection.
- In this case, pressing **SUBTITLE** on the remote control will turn on or off the subtitle.
- If multilingual subtitles are embedded on the DivX disc, pressing **SUBTITLE** will change the subtitle language during playback.

### Note:

- Subtitle files with the following filename extensions (.srt, .smi, .sub, .ssa, .ass) are supported but do not appear on the file navigation menu.
- The subtitle filename have to be the same as the filename of the movie.



## Using a USB mass storage device

By connecting a USB mass storage device to the Hi-Fi system, you can enjoy the device's stored music through the powerful speakers of Hi-Fi system.

### Playing a USB mass storage device Compatible USB mass storage devices

With the Hi-Fi system, you can use:

- USB flash memory (USB 2.0 or USB1.1)
- USB flash players (USB 2.0 or USB1.1)
- memory cards (requires an additional card reader to work with this Hi-Fi system)

**Note:**

– *In some USB flash players (or memory devices), the stored contents are recorded using copyright protection technology. Such protected contents will be unplayable on any other devices (such as this Hi-Fi system).*

### Supported formats:

- USB or memory file format FAT12, FAT16, FAT32 (sector size: 512 bytes)
- MP3 bit rate (data rate): 32-320 Kbps and variable bit rate
- WMA v9 or earlier
- Directory nesting up to a maximum of 8 levels
- Number of albums/ folders: maximum 99
- Number of tracks/titles: maximum 999
- ID3 tag v2.0 or later
- File name in Unicode UTF8 (maximum length: 128 bytes)

### The system will not play or support the following:

- Empty albums
- Non-supported file formats are skipped.
- AAC, WAV, PCM audio files
- DRM protected WMA files
- WMA files in Lossless format

## How to organize your MP3/WMA files on the USB mass storage device

This Hi-Fi system will browse the MP3/WMA files in the folders/sub-folders/titles order.

Organize your MP3/WMA files in different folders or subfolders as required.

**Notes:**

- *If you have not organized MP3/WMA files into any albums on your disc, an album "00" will be automatically assigned for all those files.*
- *Make sure that the file names of MP3 files end with .mp3. and the file names of WMA files end with .wma.*
- *For DRM protected WMA files, use Windows Media Player 10 (or later) for conversion. Visit [www.microsoft.com](http://www.microsoft.com) for details about Windows Media Player and WM DRM (Windows Media Digital Rights Management).*

- ❶ Check the USB device has been properly connected. (See "Connections - Additional connection: Connecting a USB device or memory card").
- ❷ Press **SOURCE** on the system (or **USB** on the remote control) to select USB.  
– **NO AUDIO** appears if no audio file is found in the USB device.
- ❸ Play the USB's audio files as you do with the albums/tracks on a CD (See "Disc Operations").

**Notes:**

- *For compatibility reasons, the album/track information may differ from what it is displayed through flash players' music management software.*
- *File names or ID3 tags will be displayed as — if they are not in English.*

# System Menu Options

## Basic operations

- 1 Press **SYSTEM** to enter the Setup Menu.
- 2 Press ◀ (◀◀) / ▶ (▶▶) to select a page to be set.
- 3 Press ▲ ▼ to highlight an option.
- 4 Enter its submenu by pressing ▶ (▶▶) or **OK**.
- 5 Move the cursor by pressing ▲ ▼ to highlight the selected item.  
→ In cases of value setting, press ◀ (◀◀) / ▶ (▶▶) to adjust values.
- 6 Press **OK** to confirm.

### To return to the upper-level menu

- Press ◀ (◀◀) or **OK** (in cases of value adjustment).

### To exit from the menu

- Press **SYSTEM** again.  
→ The settings will be stored in the player's memory even if the player is switched off.

#### Note:

- Some of the features in the System Menu Options are described in "Getting Started".

## GENERAL SETUP PAGE

### TV DISPLAY

Set the aspect ratio of the DVD Player according to the TV you have connected.

→ **NORMAL/PS**: If you have a normal TV and want both sides of the picture to be trimmed or formatted to fit your TV screen.

→ **NORMAL/LB**: If you have a normal TV. In this case, a wide picture with black bands on the upper and lower portions of the TV screen will be displayed.

→ **WIDE**: If you have a wide-screen TV.

### OSD LANG

See "Getting Started-Step 3: Setting language preference".

## SCREEN SAVER

This function is used to turn the screen saver on or off.

→ **ON**: In STOP, PAUSE or No DISC mode, if no actions are performed about 3 minutes, the screen saver will be activated.

→ **OFF**: Screen saver is disabled.

## DIVX(R) VOD

Philips provides you the DivX® VOD (Video On Demand) registration code that allows you to rent and purchase videos using the DivX® VOD service.

For more information, visit us at [www.divx.com/vod](http://www.divx.com/vod).

- 1 In **GENERAL SETUP PAGE**, press ▲ ▼ to highlight DIVX(R) VOD, then press ▶ (▶▶) or **OK** to enter its submenu and press **OK** again to confirm.

→ The registration code will appear:

- 2 Press **OK** to exit.
- 3 Use the registration code to purchase or rent the videos from DivX® VOD service at [www.divx.com/vod](http://www.divx.com/vod). Follow the instructions and download the video onto a CD-R for playback on this DVD player.

#### Notes:

- All the downloaded videos from DivX® VOD can only be played back on this DVD player.
- Time search feature is not available during DivX movie playback.

## AUDIO SETUP PAGE

### SPDIF SETUP

→ **OFF**: Turns off the SPDIF output.

→ **SPDIF/RAW**: If you have connected your DIGITAL OUT (COAXIAL) to a multi-channel decoder/receiver:

→ **SPDIF/PCM**: Only if your receiver is not capable of decoding multi-channel audio.

## DOLBY DIGITAL SETUP

Select the setting that matches the number of speakers you have connected.

→ **STEREO**: Left mono sound will send output signals to Left speaker and Right mono sound will send output signals to Right speaker.

→ **L-MONO**: Left mono sound will send output signals to Left speaker and Right speaker.

→ **R-MONO**: Right mono sound will send output signals to Left speaker and Right speaker.

## 3D PROCESSING

Provides a virtual surround sound experience using just two speakers.

→ **OFF, CONCERT, LIVING ROOM, HALL, BATHROOM, CAVE, ARENA and CHURCH**.

## HDCD

Sets the audio output cutoff frequency point when playing an HDCD disc.

→ **OFF, 44.1K and 88.2K**.

## NIGHT MODE

In this mode, the high volume outputs are softened and low volume outputs are brought upward to an audible level. It is useful for watching your favourite action movie without disturbing others at night.

→ **ON**: Select this to level out the volume. This feature is only available for movies with Dolby Digital mode.

→ **OFF**: Select this when you want to enjoy the surround sound with its full dynamic range.

## AUDIO SYNC

Sets the audio output delay time if the video playback is slower than the audio output.

● Select this option and then use ◀ (◀◀) / ▶ (▶▶) keys on the remote control to set the delay time for the audio output between 0~200ms.

## VIDEO SETUP PAGE

### COMPONENT

Sets the video output according to your video connection. This setting is not required if you are using the **VIDEO** jack (yellow) to connect the DVD micro system to your TV.

→ **S-VIDEO**: Select this if you have connected the DVD micro system to your TV using S-Video jack.

→ **Pr/Cr Pb/Cb Y**: Select this if you have connected the DVD micro system to your TV using Component video jacks.

### TV MODE

Selects interlace or P-SCAN video output mode when **Pr/Cr Pb/Cb Y** is selected.

→ **P-SCAN** and **INTERLACE**.

In the progressive scan mode, you can enjoy the high quality picture with less flickers. It only works when you have connected the DVD player's Y Pb Pr jacks to your TV that supports the progressive video input. Otherwise, a distorted picture will appear on the TV. For proper progressive scan set up, see "Getting started-Setting up Progressive Scan feature".

### QUALITY

This menu helps you to set the video quality.

#### SHARPNESS

Adjusts the sharpness level.

→ **HIGH, MEDIUM** and **LOW**.

#### BRIGHTNESS

Adjusts the brightness level. Range: -20~+20.

#### CONTRAST

Adjusts the contrast level. Range: -16~+16.

#### GAMMA

Adjusts the gamma level.

→ **HIGH, MEDIUM, LOW** and **NONE**.

#### HUE

Adjusts the hue level. Range: -9~+9.

#### SATURATION

Adjusts the saturation level. Range: -9~+9.

#### LUMA DELAY

Adjusts the luma delay.

→ **0T** and **1T**.

# System Menu Options

## HDMI SETUP

The options included in HDMI SETUP Page are: "HDMI" and "RESOLUTION".

### HDMI

This option is used to enable/disable HDMI output.

- **AUTO**: Enables HDMI output automatically.
- **OFF**: Disables HDMI output.

### RESOLUTION

The resolution options include 480p (60Hz), 720p (60Hz), 1080i (60Hz), 576p (50Hz), 720p (50Hz) and 1080i (50Hz).

*Notes:*

- This option is available only when the "HDMI" is set to "AUTO".
- If no display appears on the TV screen due to unsupported resolution, reconnect any available interlace video output to your display and re-adjust the resolution settings to 480p/576p.

## PREFERENCE PAGE

### IMPORTANT!

- Preference features can be selected only during "No Disc" condition or full STOP mode.

## PARENTAL

- 1 Press ▲▼ to highlight "PARENTAL".
- 2 Enter its submenu by pressing ► (►►).
- 3 Use ▲▼ to highlight a rating level for the disc inserted.
  - DVDs that are rated above the level you selected will not play unless you enter your four-digit password and choose a higher level rating.

*Note:*

- Some DVDs are not encoded with a rating though the movie rating may be printed on the Disc cover. The rating level feature does not work for such Discs.

## DEFAULT

Setting the "DEFAULT" function will reset all options and your personal settings to the factory defaults and all your personal settings will be erased.

### Caution!

- When this function is activated, all settings will be reset to factory defaults.

## PASSWORD SETUP

### PASSWORD MODE







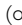

This feature is used to enable/disable password by selecting "ON"/"OFF".

### PASSWORD

Enter your four digit password when a hint is displayed on the screen. The default password is 1234.

## Radio Reception

### Tuning to radio stations

- 1 Press **STANDBY-ON**  (or  on the remote control) to switch on the last selected source.
- 2 Press **SOURCE (TUNER)** on the remote control) to select TUNER (FM) mode.
- 3 Press and hold  () /  () until the frequency indication starts to change, then release.  
→ The system automatically tunes to the next strong radio station.
- To tune to a weak station, press  () /  () briefly and repeatedly until an optimal reception is found.
- 4 Repeat Step 3 if necessary until you find the desired radio station.



### Presetting radio stations

You can preset up to 20 stations regardless of the reception.

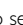

### Automatic programming

- Press **PROGRAM** on the remote control for more than two seconds to activate programming.  
→ All available stations are programmed.

### Manual programming

- 1 Tune to your desired radio station (refer to "Tuning to radio stations").
- 2 Press **PROGRAM** on the remote control.  
→ "PROG" icon flashes.
- 3 Press  /  to select the desired preset number.  
→ If "PROG" icon goes off before you select the desired preset number, press **PROGRAM** on the remote control.
- 4 Press **PROGRAM** on the remote control again to store the radio station.
- Repeat steps 1-4 to store other radio stations.

### Listening to preset radio stations

- In tuner mode, press  /  to select the desired preset number.  
→ The preset number, radio frequency, and waveband are displayed.

# Other Functions

## Setting the clock

- 1 In Standby mode, press and hold **CLOCK** on the remote control until the time flashes on the display.  
→ "SET CLOCK" is displayed briefly. Then, the hour digits flash on the display screen.
- 2 Turn **VOLUME +/-** clockwise or anticlockwise or press **VOL +/-** on the remote control to set the hours.
- 3 Press **CLOCK** to confirm.  
→ The minute digits flash on the display screen.
- 4 Turn **VOLUME +/-** clockwise or anticlockwise or press **VOL +/-** on the remote control to set the minutes.
- 5 Press **CLOCK** again to confirm the clock setting.

### Notes:

- This system only supports 24-hour mode.
- The clock setting will be erased when the system is disconnected from the power supply.
- The system will exit clock setting mode if no button is pressed within 30 seconds.

## Setting sleep/wake-up timer

### Sleep timer setting

In power-on mode, the sleep setting enables the system to switch to standby mode automatically at a preset time.

- 1 In power-on mode, press **SLEEP** on the remote control repeatedly to select a preset time.  
→ The selections are as follows (time in minutes):  
-- → 10 → 20 → 30 → 40 → 50 → 60 → 70 → 80 → 90 → --
- 2 When you reach the desired length of time, stop pressing **SLEEP**.  
→ "SLEEP" appears.

### To deactivate the sleep timer

- Press **SLEEP** repeatedly until "00" is displayed, or press **STANDBY-ON** (⏻) (⏻ on the remote control).

In standby mode, the timer setting enables the system to switch on automatically at a set time.

### Wake-up timer setting

#### IMPORTANT!

– Before setting the timer, ensure that the clock is set correctly.

- 1 Press and hold **TIMER** until the time flashes on the display.  
→ "SET TIMER" scrolls. Then, the hour digits flash on the display screen.
- 2 Turn **VOLUME +/-** clockwise or anticlockwise or press **VOL +/-** on the remote control to set the hours.
- 3 Press **TIMER** to confirm.  
→ The minute digits flash on the display screen.
- 4 Turn **VOLUME +/-** clockwise or anticlockwise or press **VOL +/-** on the remote control to set the minutes.
- 5 Press **TIMER** to confirm the time setting.  
→ "OFF" flashes on the display screen.
- 6 Turn **VOLUME +/-** clockwise or anticlockwise or press **VOL +/-** on the remote control to select "ON".  
→ ⏻ icon appears on the display screen.

### To deactivate the timer

- Select "OFF" at Step 6.

## Amplifier

Rated output power ..... 2 x 75W RMS  
 Frequency response ..... 20 - 20000Hz, - 3dB  
 Signal to noise ratio ..... > 65dB  
 Aux input ..... 1V RMS 20kohm

## Disc

Laser type ..... Semiconductor  
 Disc diameter ..... 12cm/8cm  
 Video decoding ..... MPEG-1 / MPEG-2 / Divx  
 Video DAC ..... 12Bits  
 Signal system ..... PAL / NTSC  
 Video format ..... 4:3 / 16:9  
 Video S/N ..... > 48dB  
 Audio DAC ..... 24Bits / 96kHz  
 Total harmonic distortion ..... < 1% (1kHz)  
 Frequency response ..... 4Hz - 20kHz (44.1kHz)  
 ..... 4Hz - 22kHz (48kHz)  
 ..... 4Hz - 24kHz (96kHz)  
 S/N ratio ..... > 65dBA

## Tuner

FM tuning range ..... 87.5 - 108MHz  
 Tuning grid ..... 50KHz  
 Sensitivity  
 – Mono, 26dB S/N ratio ..... <22dBf  
 – Stereo, 46dB S/N ratio ..... >48dBf  
 Search Selectivity ..... > 28dBf  
 Image Rejection ..... > 25dB  
 Total Harmonic Distortion ..... < 3%  
 Signal to Noise Ratio ..... > 55dBA

## Speakers

Speaker impedance ..... 4 ohm  
 Speaker Driver ..... 5" full range + 2" tweeter  
 Sensitivity ..... 80 ± 4dB  
 Frequency response ..... 20 - 20000 Hz

## General information

AC power ..... 220 V, 50 Hz  
 Operation power consumption ..... 85W  
 Standby power consumption ..... < 4W  
 Composite video output ..... 1.0Vp-p, 75ohm  
 Coaxial output ..... 0.5Vpp ± 0.1Vpp 75ohm  
 Headphone output ..... 2x15mW 32 ohm  
 USB direct ..... Version 2.0  
 Dimensions  
 – Main unit (W x H x D) .....  
 ..... 280 x 130 x 290mm  
 – Speaker box (W x H x D) .....  
 ..... 185 x 305 x 225mm  
 Weight  
 – With packing ..... 17kg  
 – Main unit ..... 4.85kg  
 – Speaker box ..... 2X4.5kg



**Specifications subject to change without prior notice**

# Troubleshooting

## WARNING

Under no circumstances should you try to repair the system yourself, as this will invalidate the warranty. Do not open the system as there is a risk of electric shock.

*If a fault occurs, first check the points listed below before taking the system for repair. If you are unable to remedy a problem by following these hints, consult your dealer or Philips for help.*

Problem	Solution
<b>No power.</b>	<ul style="list-style-type: none"> <li>✓ Check if the AC power cord is properly connected.</li> <li>✓ Press <b>STANDBY-ON</b>  on the top of the DVD micro system or  on the remote control to turn on the power.</li> </ul>
<b>No picture.</b>	<ul style="list-style-type: none"> <li>✓ Check if the TV is switched on.</li> <li>✓ Check the video connection.</li> <li>✓ Press SOURCE on the top of the DVD player repeatedly to select "DVD" or press DISC on the remote.</li> <li>✓ Set your TV to the correct Video In channel. This channel is usually near channel 00. Or, you may have a button on the TV remote control that selects Auxiliary or A/V IN channel. See your TV owner's manual for details. Or, change channels at the TV until you see DVD screen on the TV.</li> <li>✓ If the progressive scan feature is activated but the connected TV does not support progressive signals or the cables are not connected accordingly, see "Getting started-Setting up Progressive Scan feature" for proper progressive scan setup or deactivate the progressive scan feature as below:               <ol style="list-style-type: none"> <li>1) Turn off your TV progressive scan mode or turn on to interlaced mode.</li> <li>2) Press SYSTEM on the remote control to exit the system menu. Then press DISC followed by "1" to exit progressive scan.</li> </ol> </li> </ul>
<b>Distorted or poor picture.</b>	<ul style="list-style-type: none"> <li>✓ Sometimes a small amount of picture distortion may appear. This is not a malfunction.</li> <li>✓ Clean the disc.</li> </ul>
<b>Completely distorted picture or black/white picture.</b>	<ul style="list-style-type: none"> <li>✓ TV has a colour system standard. If the disc's or DVD system's colour system is different than your TV's colour system, the picture may be distorted or colourless.</li> </ul>



**The aspect ratio of the screen cannot be changed even though you have set the TV shape.**

**No sound or distorted sound.**

**The micro DVD player does not start playback.**

**The DVD micro system does not respond when the buttons are pressed.**

**Cannot activate some features, such as Angles, Subtitles, or multi-language Audio.**

**Considerable noise in radio broadcasts.**

- ✓ The aspect ratio is fixed on the DVD disc.
- ✓ Depending on the TV, it may not be possible to change the aspect ratio.
- ✓ Adjust the volume.
- ✓ Check that the speakers are connected correctly.
- ✓ Replace the speaker cables.
- ✓ Disconnect the headphones.
- ✓ The system is in pause, slow motion or fast forward/reverse mode, press ► || to resume normal play mode.
- ✓ Insert a readable disc with the playback side facing down.
- ✓ Check the disc type, colour system and regional code. Check for any scratches or smudges on the disc.
- ✓ Press SYSTEM to turn off the setup menu screen.
- ✓ Cancel the parental control rating function or change the rating level.
- ✓ Moisture has condensed inside the system. Remove the disc and leave the system turned on for about an hour.
- ✓ Disconnect the power plug from the outlet and insert again.
- ✓ Multi-language sound or subtitle is not recorded on the DVD.
- ✓ Changing the language for the sound or subtitle is prohibited on the DVD.
- ✓ The features may not be available on the disc.
- ✓ Tune in to the correct frequency.
- ✓ Connect the antennas.
- ✓ Fully extend the FM wire antenna. Position for best reception and secure to a wall.
- ✓ Connect an outdoor FM antenna.
- ✓ Adjust the direction and position for best reception.
- ✓ Place the antenna farther away from any equipment that may be causing the noise.
- ✓ Increase the distance between the system and your TV or other equipment.

# Troubleshooting

**The remote control does not function.**

- ✓ Select the correct source (DISC or TUNER, for example) before pressing the function button.
- ✓ Point the remote control at the remote sensor of the unit.
- ✓ Reduce the distance to the player.
- ✓ Remove any possible obstacles.
- ✓ Replace the batteries with new ones.
- ✓ Check that the batteries are loaded correctly.

**The display is dark.**

- ✓ Press DIM again.

**Low hum or buzz sound.**

- ✓ Place the DVD micro system as far away as possible from electrical devices that may be causing interference.

**Low bass response.**

- ✓ Check all speakers for correct polarity.

**Unable to select Progressive Scan.**

- ✓ Check that the output of the video signal is switched to 'Pr/Cr Pb/Cb Y'.

**No sound is output from the HDMI jack.**

- ✓ Check the connection between the TV and the HDMI jack of the DVD player.
- ✓ See if the TV supports this 480p/576p/720p/1080i DVD player.
- ✓ Check your TV system setup correctly.

**Some files on the USB device are not displayed.**

- ✓ Check if the number of folders exceeds 99 or the number of titles exceeds 999.

**"DEVICE NOT SUPPORTED" scrolls on the display.**

- ✓ Remove the USB mass storage device or select another source.

Meet Philips at the Internet  
<http://www.philips.com>

English

中文

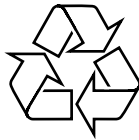

MCD906



© 2010 Koninklijke Philips Electronics N.V.  
All rights reserved.



Printed in China

MCD906\_93\_UM\_V2.0