

Micro Hi-Fi System

MCM760

User manual

Manuel d'utilisation

Manual del usuario

Benutzerhandbuch

Gebruikershandleiding

Manuale per l'utente

Användarhandböckerna

Brugermanual



PHILIPS

Important notes for users in the U.K.

Mains plug

This apparatus is fitted with an approved 13 Amp plug. To change a fuse in this type of plug proceed as follows:

- 1 Remove fuse cover and fuse.
- 2 Fix new fuse which should be a BS1362 3 Amp, A.S.T.A. or BSI approved type.
- 3 Refit the fuse cover.

If the fitted plug is not suitable for your socket outlets, it should be cut off and an appropriate plug fitted in its place.

If the mains plug contains a fuse, this should have a value of 3 Amp. If a plug without a fuse is used, the fuse at the distribution board should not be greater than 3 Amp.

Note: The severed plug must be disposed of to avoid a possible shock hazard should it be inserted into a 13 Amp socket elsewhere.

How to connect a plug

The wires in the mains lead are coloured with the following code: blue = neutral (N), brown = live (L).

- As these colours may not correspond with the colour markings identifying the terminals in your plug, proceed as follows:
 - Connect the blue wire to the terminal marked N or coloured black.
 - Connect the brown wire to the terminal marked L or coloured red.
 - Do not connect either wire to the earth terminal in the plug, marked E (or \perp) or coloured green (or green and yellow).

Before replacing the plug cover, make certain that the cord grip is clamped over the sheath of the lead - not simply over the two wires.

Copyright in the U.K.

Recording and playback of material may require consent. See Copyright Act 1956 and The Performer's Protection Acts 1958 to 1972.

Italia

DICHIARAZIONE DI CONFORMITA'

Si dichiara che l'apparecchio MCM760 Philips risponde alle prescrizioni dell'art. 2 comma 1 del D.M. 28 Agosto 1995 n. 548.

Fatto a Eindhoven

Philips Consumer Electronics
Philips, Glaslaan 2
5616 JB Eindhoven, The Netherlands

Norge

Typeskilt finnes på apparatens underside.

Observer: Nettbryteren er sekundert innkoplet. Den innebygde nettdelen er derfor ikke frakoplet nettet så lenge apparatet er tilsluttet nettkontakten.

For å redusere faren for brann eller elektrisk støt, skal apparatet ikke utsettes for regn eller fuktighet.

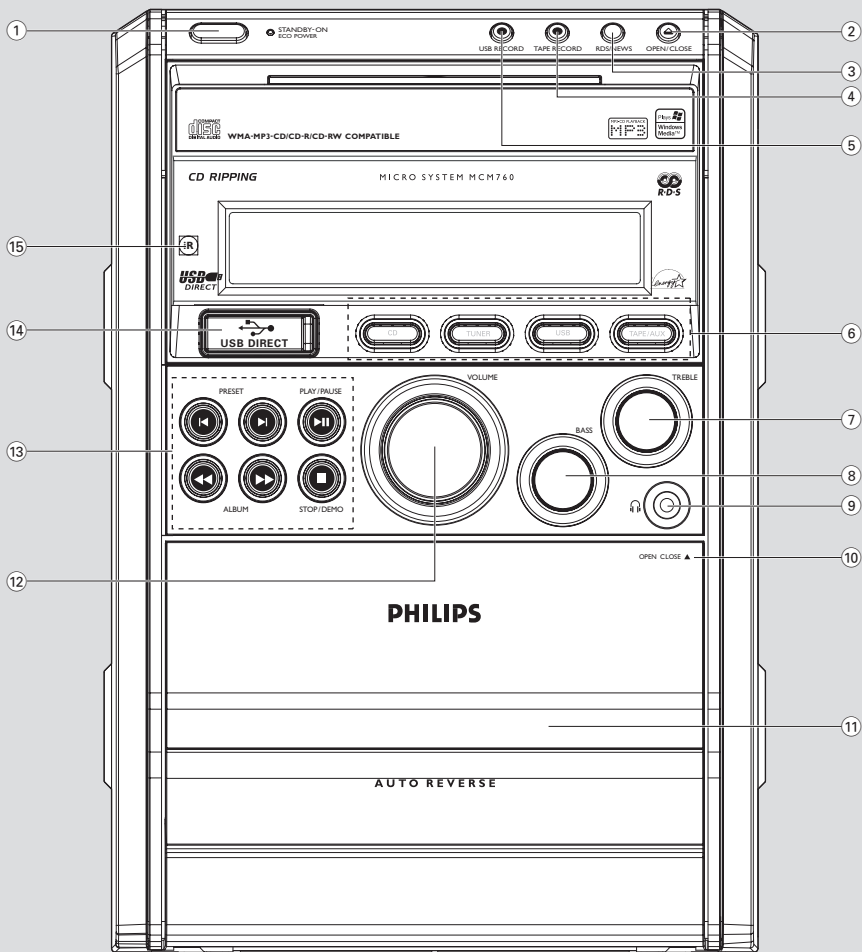

DEMO MODE

To turn ON

Press & HOLD



button

for 5 seconds

To turn OFF

Press & HOLD



button

for 5 seconds

PLUG & PLAY

(for tuner installation)

1



Plug in the unit

2



Follow instructions
in the display

3



Press "PLAY"

DK

Advarsel: Usynlig laserstråling ved åbning når sikkerhedsafbrydere er ude af funktion. Undgå udsættelse for stråling.

Bemærk: Netafbryderen er sekundært indkoblet og afbryder ikke strømmen fra nettet. Den indbyggede netdel er derfor tilsluttet til lysnettet så længe netstikket sidder i stikkontakten.

S

Klass 1 laserapparat

Varning! Om apparaten används på annat sätt än i denna bruksanvisning specificerats, kan användaren utsättas för osynlig laserstrålning, som överskrider gränsen för laserklass 1.

Observera! Stömbrytaren är sekundärt kopplad och bryter inte strömmen från nätet. Den inbyggda nätdelen är därför ansluten till elnätet så länge stickproppen sitter i vägguttaget.

SF

Luokan 1 laserlaite

Varoitus! Laitteen käyttäminen muulla kuin tässä käyttöohjeessa mainitulla tavalla saattaa altistaa käyttäjän turvallisuusluokan 1 ylittävälle näkymättömälle lasersäteilylle.

Oikeus muutoksiin varataan. Laite ei saa olla alttiina tippu- ja roiskevedelle.

Huom. Toiminnanvalitsin on kytketty toisiopuolelle, eikä se kytke laitetta irti sähköverkosta. Sisäänrakennettu verkko-osa on kytketty sähköverkkoon aina silloin, kun pistoke on pistorasiassa.

English 6

Français 34

Español 62

Deutsch 90

Nederlands 118

Italiano 146

Svenska 174

Dansk 202

English

Français

Español

Deutsch

Nederlands

Italiano

Svenska

Dansk

General Information

Supplied accessories	7
Environmental information	7
Safety information	7

Controls

Controls on the set	8
Remote control	9-10

Installation

Rear connections	11-12
Speaker connections	
Antenna connections	
Connecting an additional appliance	12-13
Connecting a USB device or memory card	
Connecting a non-USB device	
Using AC power	13

Preparations

Using the remote control	14
Setting the clock	14

Basic Functions

Switching on/off the set	15
Displaying the clock	15
Display adjustment	15
Volume control	16
Volume adjustment	
MUTE	
Sound control	16
Incredible surround	
Bass/Treble	

CD

Discs for playback	17
Playing discs	17-18
Selecting and searching	18
Selecting a different track	
Finding a passage within a track during playback	
Programming tracks	19
Erasing the program	
Different play modes: REPEAT, SHUFFLE	20
Display track information	
(MP3/WMA only)	20

Tuner

Tuning to radio stations	21
Programming radio stations	21-22
Plug & Play	
Autostore: Automatic programming	
Manual programming	
To listen to a preset station	
Deleting a preset radio station	
RDS (Radio Data System)	22-23
Switching through RDS information	
Clock setting via RDS	
NEWS	23
Activating the NEWS function	
Deactivating NEWS function	

USB

Using a USB mass storage device	24
Playing a USB mass storage device	25
Recording to a USB mass storage device	
.....	25-26

TAPE

Playing a tape	27
Recording to a tape	27-28

AUX

AUX (Listening to an external source)	29
---	----

Timer

Setting the timer	29-30
Activating and deactivating TIMER	30
Temporarily deactivating TIMER	30

SLEEP

.....	30
-------	----

Demonstration mode

.....	30
-------	----

Specifications

.....	31
-------	----

Maintenance

.....	31
-------	----

Troubleshooting

.....	32-33
-------	-------

Supplied accessories

- 2 speaker boxes including 2 speaker cables
- remote control and two AA batteries
- MW loop antenna
- FM wire antenna
- AC power cord

Environmental Information

All unnecessary packaging has been omitted. We have tried to make the packaging easy to separate into three materials: cardboard (box), polystyrene foam (buffer) and polyethylene (bags, protective foam sheet).

Your system consists of materials which can be recycled and reused if disassembled by a specialized company. Please observe the local regulations regarding the disposal of packaging materials, exhausted batteries and old equipment.

Disposal of your old product

Your product is designed and manufactured with high quality materials and components, which can be recycled and reused.

When this crossed-out wheeled bin symbol is attached to a product it means the product is covered by the European Directive 2002/96/EC



Please inform yourself about the local separate collection system for electrical and electronic products.

Please act according to your local rules and do not dispose of your old products with your normal household waste. The correct disposal of your old product will help prevent potential negative consequences for the environment and human health.

Safety Information

- Place the system on a flat, hard and stable surface.
- Place the system in a location with adequate ventilation to prevent internal heat build-up in your system. Allow at least 10 cm (4 inches) clearance from the rear and the top of the unit and 5 cm (2 inches) from each side.
- The ventilation should not be impeded by covering the ventilation openings with items, such as newspapers, table-cloths, curtains, etc.
- Do not expose the system, batteries or discs to excessive moisture, rain, sand or heat sources caused by heating equipment or direct sunlight.
- No naked flame sources, such as lighted candles, should be placed on the apparatus.
- No objects filled with liquids, such as vases, shall be placed on the apparatus.
- If the system is brought directly from a cold to a warm location, or is placed in a very damp room, moisture may condense on the lens of the disc unit inside the system. Should this occur, the CD player would not operate normally. Leave the power on for about one hour with no disc in the system until normal playback is possible.
- The mechanical parts of the set contain self-lubricating bearings and must not be oiled or lubricated.
- **When the system is switched to Standby mode, it is still consuming some power. To disconnect the system from the power supply completely, remove the AC power plug from the wall socket.**

Apparatus shall not be exposed to dripping or splashing

Controls on the set (illustrations on page 3)

① STANDBY-ON/ECO POWER

- press briefly to switch the set on or to ECO POWER (power-saving mode);
- press and hold to switch the set to standby mode
- **Red indicator:** lights up red when the set is switched to ECO POWER mode

② OPEN/CLOSE ▲

- opens/closes the CD door

③ RDS/NEWS

- **Tuner:** selects RDS (**R**adio **D**ata **S**ystem) information
- **CD/USB/TAPE/AUX:** activates/deactivates news

④ TAPE RECORD

- starts recording to a tape

⑤ USB RECORD

- starts recording to a USB mass storage device

⑥ Source buttons

CD

- selects **CD** source
- **In standby or Eco Power mode:** switches the set on and selects **CD** source

TUNER

- selects **TUNER** source and toggles between the wavebands: FM and MW
- **In standby or Eco Power mode:** switches the set on and selects **TUNER** source

USB

- selects **USB** source
- **In standby or Eco Power mode:** switches the set on and selects **USB** source

TAPE/AUX

- selects **TAPE** source or the audio input from an additional connected appliance
- **In standby or Eco Power mode:** switches the set on and selects **TAPE** source or the audio input from an additional connected appliance

⑦ TREBLE

- selects a desired TREBLE (high tone) level

⑧ BASS

- selects a desired BASS (low tone)

⑨

- 3.5 mm headphone socket

Helpful hints:

- Adjust the volume to a moderate level before you plug in the headphones.
- Connecting headphones will switch off the speakers.

⑩ OPEN/CLOSE ▲

- opens/closes the tape deck door

⑪ Tape deck

⑫ VOLUME

- adjusts the volume level

⑬ PRESET ◀▶

- **CD/USB:** skips CD tracks backwards/forwards
- **TUNER:** selects a preset radio station.
- **TAPE:** selects other side of the tape

ALBUM ◀▶

- **CD/USB:** selects albums (for MP3/WMA only)
- **CD:** searches backward/forward
- **TUNER:** tunes to radio stations
- **TAPE:** rewind or fast forward
- **CLOCK:** sets the hours or minutes

PLAY/ PAUSE ▶ II

- **CD/USB:** starts or pauses playback
- **TAPE:** starts playback
- **CLOCK:** toggles between hour and minutes setting
- **TUNER:** enters Plug & Play mode and/or starts preset radio station installation

STOP/DEMO ■

- **CD/USB:** stops playback or recording; erase a program
- **TUNER:** press and hold to erase a preset radio station
- **TAPE:** stops playback or recording
- **In standby or Eco Power mode:** press and hold to turn on/off the demonstration mode

⑭

- jack for the external USB mass storage device

⑮ IR

- sensor for the infrared remote control

Helpful hints: Always point the remote control towards this sensor.

Remote control

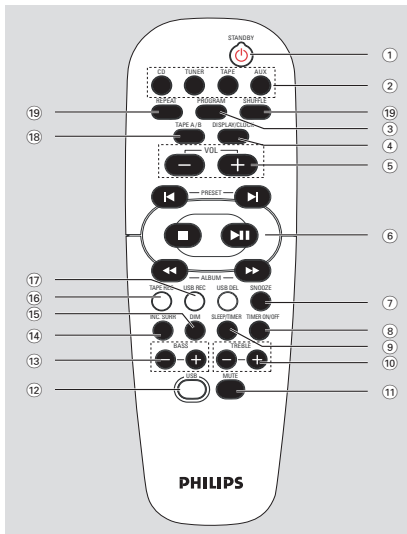

Notes for remote control:

- First select the source you wish to control by pressing one of the source select keys on the remote control (for example **CD**, **TUNER**).
- Then select the desired function (for example **▶ II**, **◀ I**, **▶ I**).

1 Power

- press briefly to switch the set to ECO POWER (power-saving mode);
- press and hold to switch the set to standby mode

2 Source buttons

CD

- selects **CD** source
- **In standby or Eco Power mode:** switches the set on and selects **CD** source

TUNER

- selects **TUNER** source and toggles between the wavebands: FM1 and MW
- **In standby or Eco Power mode:** switches the set on and selects **TUNER** source

TAPE

- selects **TAPE** source
- **In standby or Eco Power mode:** switches the set on and selects **TAPE** source

AUX

- selects the audio input from an additional connected appliance
- **In standby or Eco Power mode:** switches the set on and selects the audio input from an additional connected appliance

3 PROGRAM

- **CD/USB:** programs tracks
- **Tuner:** programs preset radio stations

4 DISPLAY/CLOCK

- **Clock:** - displays the set time
- enters the clock setting mode (press and hold for more than 2 seconds)
- **TUNER/Audio CD:** switches between clock display and playback display
- **MP3/WMA files:** displays disc information during playback

5 VOLUME

- adjusts the volume level

6 PRESET ◀ I / ▶ I

- **CD/USB:** skips CD tracks backwards/forwards
- **TUNER:** selects a preset radio station.
- **TAPE:** selects other side of the tape
- **CD/USB:** stops playback or recording; erase a program
- **TUNER:** press and hold to erase a preset radio station
- **TAPE:** stops playback or recording
- **▶ II**
- **CD/USB:** starts or pauses playback
- **TAPE:** starts playback
- **CLOCK:** toggles between hour and minutes setting
- **ALBUM ◀◀ / ▶▶**
- **CD/USB:** selects albums (for MP3/WMA only)
- **CD:** searches backward/forward
- **TUNER:** tunes to radio stations
- **TAPE:** rewind or fast forward
- **CLOCK:** sets the hours or minutes

⑦ SNOOZE

- Temporarily deactivate the timer

⑧ TIMER ON/OFF

- turns the timer on/off

⑨ SLEEP/TIMER

- set the sleep timer
- displays the timer setting
- enters the timer setting mode (press and hold for more than 2 seconds)

⑩ TREBLE (+ -)

- Selects a desired TREBLE (high tone) level

⑪ MUTE

- switches the sound off temporarily

⑫ USB

- selects **USB** source
- **In standby or Eco Power mode:** switches the set on and selects **USB** source

⑬ BASS (+ -)

- Selects a desired BASS (low tone) level

⑭ INC. SURR.

- Turns on/off the incredible surround sound effect

⑮ DIM

- Selects different levels of brightness for display panel

⑯ TAPE REC

- starts recording to a tape

⑰ USB REC

- starts recording to a USB mass storage device

USB DEL

- delete files from a USB mass storage device

⑱ TAPE A/B

- selects the desired tape playback modes : one side, both sides or auto replay

⑲ REPEAT

- selects continuous playback

SHUFFLE

- selects random playback

The making of unauthorized copies of copy-protected material, including computer programs, files, broadcasts and sound recordings, may be an infringement of copyrights and constitute a criminal offence. This equipment should not be used for such purposes.

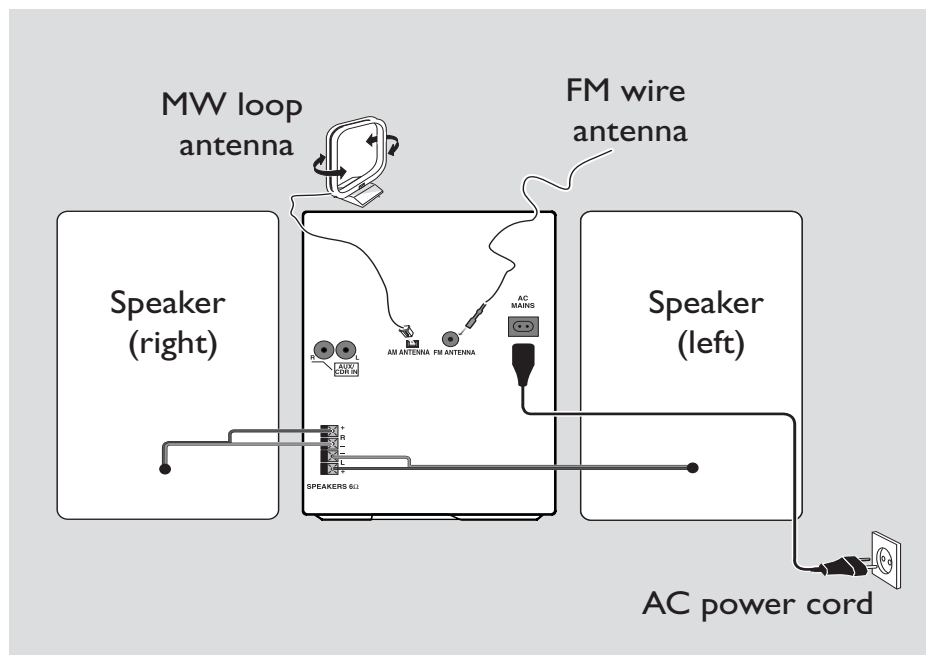

Rear connections

Warning:

- **Never make or change connections with the mains supply switched on.**
- **Install your set near the AC outlet and where the AC power plug can be reached easily.**

(A) Speaker connections

Use the supplied speakers only. Using other speakers can damage the set or the sound quality will be negatively affected.

- Connect the cable of the left speaker to **L +/-** (red and black) and the cable of the right speaker to **R +/-** (red and black) as follows:
 - a. Press the clip of the red terminal and fully insert the stripped portion of the colored (or marked) speaker cable into the socket, then release the clip
 - b. Press the clip of the black terminal and fully insert the stripped portion of the black (or unmarked) speaker cable into the socket, then release the clip

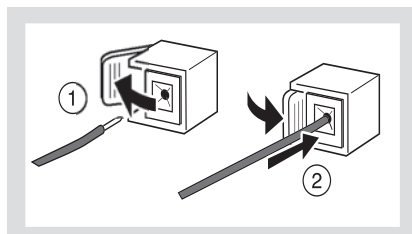

(B) Antenna connections MW antenna

- 1 Assemble the loop antenna as shown:

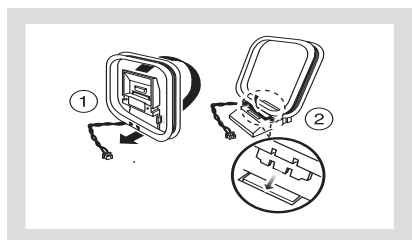

Installation

- 2 Fit the plug of the loop antenna to the AM ANTENNA as shown below
- 3 Adjust the position of the antenna for optimal reception (as far away as possible from the TV, VCR or other radiation sources)

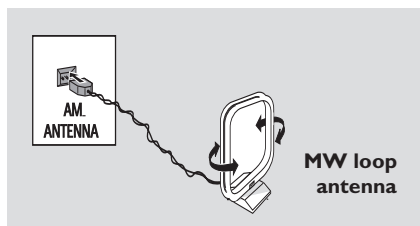

FM antenna

The wire antenna supplied can only be used to receive nearby stations. For better reception we recommend using a cable antenna system or an outdoor antenna.

- 1 Extend the wire antenna and fit it to the FM ANTENNA as shown below

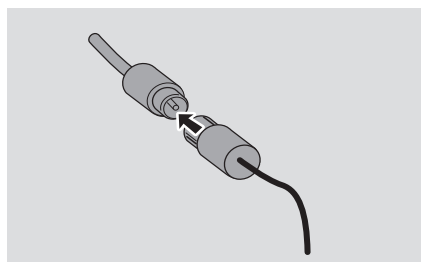

Note: If you are using a cable antenna system or an outdoor antenna, fit the antenna plug, instead of the wire antenna, to the FM ANTENNA.

- 2 Move the antenna in different positions for optimal reception (as far away as possible from the TV, VCR or other radiation sources)
- 3 Fix the antenna's end to the wall

Connecting an additional appliance

Connecting a USB device or memory card

On MCM760, you can playback music from a USB mass storage device and also record music to such a device.

- 1 Insert the USB device's USB plug into the socket  on MCM760

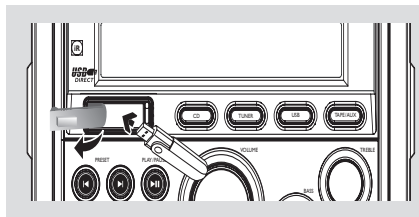

or

for the devices with USB cable:

- a. Insert one plug of the USB cable (not supplied) to the socket  on MCM760
- b. Insert the other plug of the USB cable to the USB output terminal of the USB device

or

for the memory card:

- a. Insert the memory card into a card reader (not supplied)
- b. Use a USB cable (not supplied) to connect the card reader to the socket  on MCM760

Connecting a non-USB device

It is possible to use an additional appliance, e.g. TV, VCR or CD recorder with the set. On MCM760, you can playback music from an external source.

- 1 Insert the red plug of the red/white audio cables (not supplied) to the red socket **AUX/CDR IN R** and the white plug to the white socket **AUX/CDR IN L**
- 2 Connect the other end of the audio cables to the **AUDIO OUT** terminals of the additional appliance

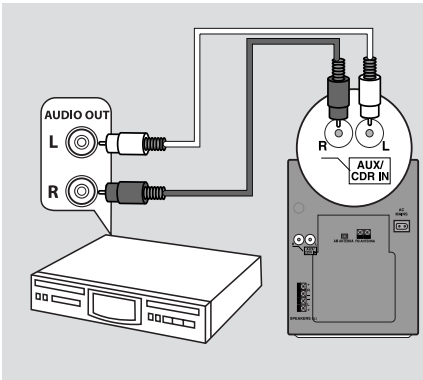

- 3 Select **AUX** mode on MCM760

Helpful hints:

- Always refer to the owner's manual of other equipment for complete connection.

Using AC power

- 1 Make sure all the connections have been made before switching on the power supply
- 2 Connect the AC power cord to the wall socket. This switches on the power supply
 → **AUTO INSTALL – PRESS PLAY** appears the first time you power up MCM760
 - Press **▶II** on the set to store all available radio stations
 - Press **■** to exit (See **Tuner**)

Helpful hints:

- If the first preset is a RDS station, it will proceed to clock setting (See **Tuner: Clock setting via RDS**)
 → "INSTALL" appears, then "TIME" and "SEARCH RDS TIME".
 → When RDS time is read, "RDS TIME" will appear and the current time will be stored.
 → If RDS station does not transmit RDS time within 90 seconds, "NO RDS TIME" will appear and the program will exit automatically.

When MCM760 is switched to standby, it is still consuming some power: **To disconnect the system from the power supply completely, remove the power plug from the wall socket.**

The type plate is located on the rear of the set.

CAUTION

Visible and invisible laser radiation. If the cover is open, do not look at the beam.

High voltage! Do not open. You run the risk of getting an electric shock.

The machine does not contain any user-serviceable parts.

Modification of the product could result in hazardous radiation of EMC or other unsafe operation.

If you disconnect the product from the mains, make sure to take the plug out of the wall socket completely.

Children could seriously injure themselves as the free end of the cable may still be live if only the connector is removed from the MAINS socket at the back of the unit.

Using the remote control

IMPORTANT!

- Always point the remote control directly towards IR area.

Notes for remote control:

- First select the source you wish to control by pressing one of the source select keys on the remote control (for example CD, TUNER).
- Then select the desired function (for example ►II, ◀▶).

Inserting batteries into the remote control

- 1 Open the battery compartment
- 2 Insert 2 batteries type R06 or AA into the remote control with the correct polarity as indicated by the "+" and "-" symbols inside the battery compartment
- 3 Put back the compartment door

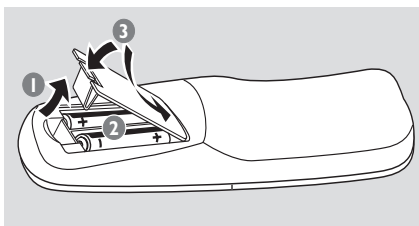

CAUTION!

- Remove batteries if they are exhausted or will not be used for a long time.
- Do not use old and new or different types of batteries in combination.
- Batteries contain chemical substances, so they should be disposed of properly.

Setting the clock

After connecting MCM760 to the power supply, set the clock first.

- 1 On the remote control, press and hold **DISPLAY/CLOCK** until the clock time starts flashing
→ The display shows the set time
→ 12:00 AM appears by default if you have not set the clock
- 2 Press **PROGRAM** repeatedly to change between 12-hour and 24-hour clock mode
- 3 Press ◀ or ▶ repeatedly to set the hour
- 4 Press ►II to change to minutes setting, then press ◀ or ▶ repeatedly to set the minutes
- 5 Press **DISPLAY/CLOCK** again to store the setting.
→ The clock will start working.

Helpful hints:

- The clock setting will be erased when the system is disconnected from the power supply.
- The set will exit from the clock setting mode if no button is pressed within 90 seconds.
- To set the clock automatically through the time information in the RDS signal, refer to **Tuner**: **Clock setting via RDS**.

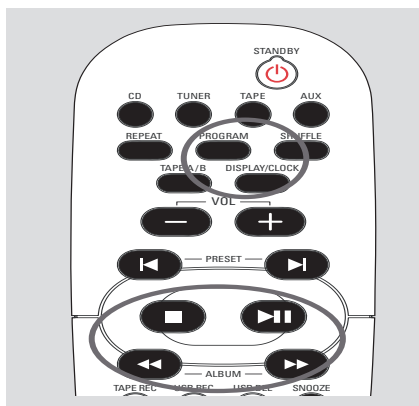

Switching on/ off the set

- 1 To switch on, press the source button **CD**, **TUNER**, **USB** or **TAPE/AUX** on the set (or on the remote control, **CD**, **TUNER**, **TAPE**, **AUX**, **USB**)
 - The selected source lights up blue
- 2 Press **STANDBY-ON/ ECO POWER** briefly to switch the set to ECO POWER (power-saving mode) (or ϕ on the remote control)
 - **ECO PWR** scrolls on the display
 - The display is switched off
 - The **Red** indicator lights up

OR

Press and hold **STANDBY-ON/ ECO POWER** to switch the set to standby mode (or ϕ on the remote control)

- The clock is displayed

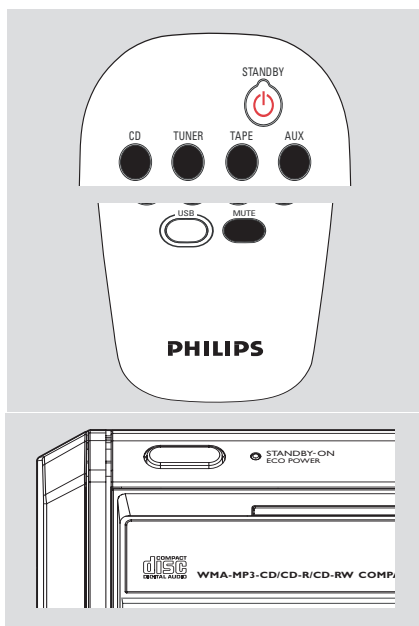

Displaying the clock

- During playback, press **DISPLAY/CLOCK** on the remote control repeatedly to switch between the clock display and the playback display

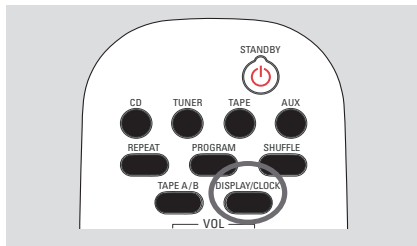

Helpful hints:

- When playing MP3 files, you will get track information by pressing **DISPLAY/CLOCK**

Display adjustment

You can select the desired brightness for the display panel.

- On the remote control, press **DIM** repeatedly to select DIM 1, DIM 2, DIM 3 or DIM OFF
 - **DIM** appears if DIM is activated

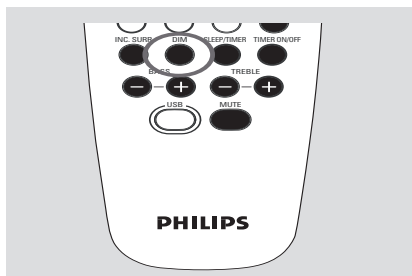

Helpful hints:

- In standby mode, pressing **DISPLAY/CLOCK** button will switch the system to **ECO POWER** mode.

Basic Functions

Volume control

Volume adjustment

- Adjust the volume by using the **VOLUME** rotary on the set or by pressing **VOL +/-** on the remote control
 → **VOL MUTE** is the minimum volume level
 → **0 dB** is the maximum volume level

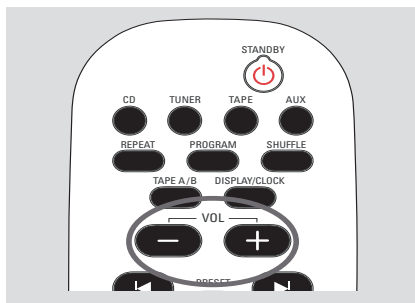

MUTE

You can temporarily switch off the sound without switching off the set.

- Press **MUTE** on the remote control to switch off the sound
 → **MUTE** appears. Playback continues without sound
- To switch on the sound, you can:
 - press **MUTE** again;
 - adjust the volume controls



Sound control

Incredible surround

- Press **INC. SURR.** once or more to turn the surround sound effect on or off
 → **INCREDIBLE SURROUND** appears if activated
 → **IS OFF** appears if deactivated



Bass/Treble

The **BASS** (low tone) and **TREBLE** (high tone) feature enables you to define the sound-processor settings.

- Adjust **BASS** or **TREBLE** (or press **BASS +/-** / **TREBLE +/-** on the remote control) repeatedly to select the desired Bass or Treble level
 → "**BASS** xx" or "**TREBLE** xx" appears, where "xx" denotes the level as follows:
 Min → -2 ... → 0 → 1 ... → +2 → Max ...

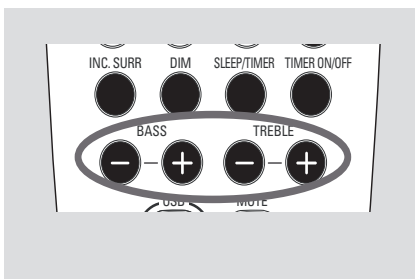

Discs for playback

With this system, you can play

- all pre-recorded audio CDs (CDDA)
- all finalized audio CD-Rs and CD-RWs
- MP3/WMA-CDs (CD-Rs/CD-RWs with MP3/WMA files)



IMPORTANT!

– **This system is designed for regular discs. Therefore, do not use any accessories such as disc stabilizer rings or disc treatment sheets, etc.**

About MP3/WMA

The music compression technology MP3 (MPEG1 Audio Layer 3) and WMA (Windows Media Audio) significantly reduces the digital data of an audio CD while maintaining CD quality sound.

Windows Media Audio® is a registered trademark of Microsoft Corporation.

Supported formats:

- Disc format ISO9660, Joliet, UDF 1.5 and multi-session CDs
- MP3 bit rate (data rate): 32-256 Kbps and variable bit rate
- Directory nesting up to a maximum of 8 levels
- Supported sampling frequencies: 32 kHz, 44.1 kHz, 48 kHz
- Maximum title number : 400 (depending on filename length)
- Maximum album number : 40
- WMA v9 or earlier

The system will not play or support the following:

- Empty albums: an empty album is an album that does not contain MP3/WMA files, and will not be shown in the display.
- Non-supported file formats are skipped. This means that e.g.: Word documents .doc or MP3 files with extension .dlf are ignored and will not be played.
- DRM protected WMA files
- WMA files in Lossless or VBR format

IMPORTANT!

- Make sure that the file names of MP3 files end with .mp3.
- For DRM protected WMA files, use Windows Media Player 10 (or later) for CD burning/conversion. Visit www.microsoft.com for details about Windows Media Player and WM DRM (Windows Media Digital Rights Management).

Playing discs

- 1 Press **CD** to select **CD** source
 → The CD icon appears
 → The selected CD source lights up blue
- 2 Press **OPEN/CLOSE** to open the CD compartment
 → **OPEN** is displayed

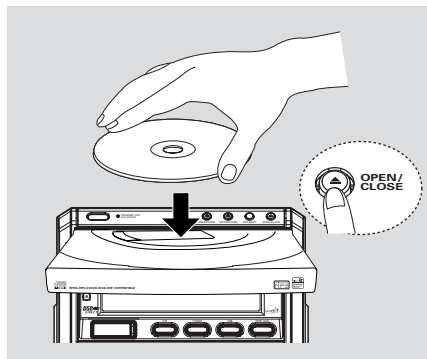

- 3 Insert a disc with the printed side facing up. Press **OPEN/CLOSE** again to close the compartment
 → **READING** is displayed as the CD player scans the contents of a disc
 → **Audio CD**: the total number of tracks and playing time are shown
MP3/WMA: Display shows current album number "A x x" and current track number "T x xx"

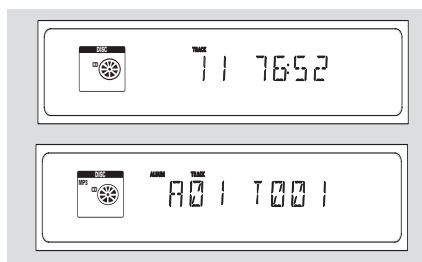

Helpful hints:

– If you have not organized MP3/WMA files into any albums on your disc, an album "01" will be automatically assigned for all those files.

- 4 Press ►|| to start playback
→ Display shows current track number and elapsed playing time

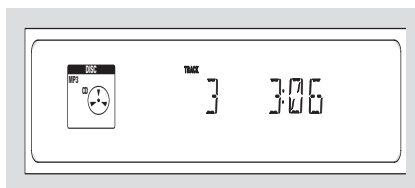

- 5 To pause playback, press ►||. To resume playback, press the button again
- 6 To stop playback, press **STOP** ■

Helpful hints:

CD playwill also stop when

- the CD door is opened
- the disc has reached the end
- you select another source: **TUNER, USB or TAPE/AUX**

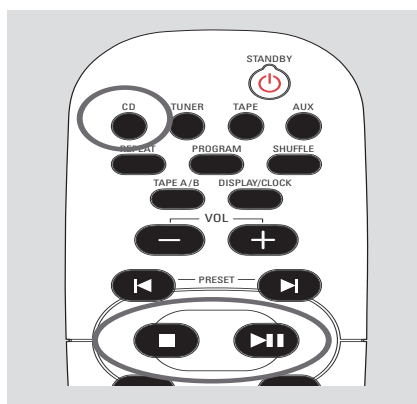
**Selecting and searching****Selecting a different track**

- Press ◀ or ▶ once or repeatedly until the desired track number appears in the display
MP3/WMA: → Track information scrolls briefly

MP3/WMA:

- Press **ALBUM** ◀◀ / ▶▶ once or more to select the next or previous album
→ Track information scrolls briefly
- or
- In the stop position, press ◀◀ / ▶▶ and ◀ or ▶ to select the desired album and track
→ **MP3/WMA:** Display shows current album/track number

Finding a passage within a track during playback

- 1 During playback, press and hold ◀◀ or ▶▶
→ The CD plays at a high speed
- 2 When you recognize the passage you want, release ◀◀ or ▶▶
→ Normal playback resumes

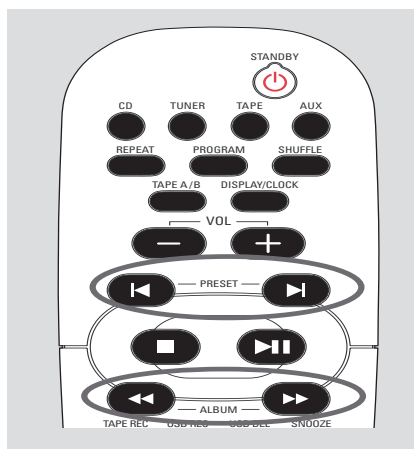

Programming tracks

You may store up to 99 tracks in the desired sequence. If you like, store any track more than once.

- 1 In the stop position, press **PROGRAM** to start programming
 - **PROG** flashes
 - **Audio CD**: Display shows current track number
 - **MP3/WMA**: Display shows current album/ track number

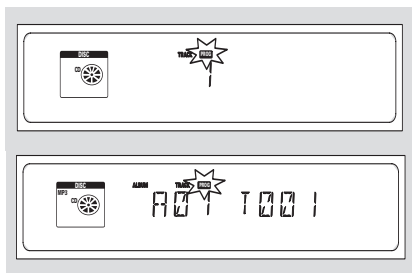

- 2 Press **◀** or **▶** once or repeatedly until the desired track number appears in the display
- **MP3/WMA**: Press **◀◀** / **▶▶** and **◀** / **▶** to select the desired album and track
- 3 Press **PROGRAM** to confirm
 - **Audio CD**: Display shows briefly the number and playing time of tracks programmed; Then, the display shows **PROG** and the track number you just stored
 - **MP3/WMA**: Display shows briefly the number of tracks programmed; Then, the display shows the album/ track number you just stored

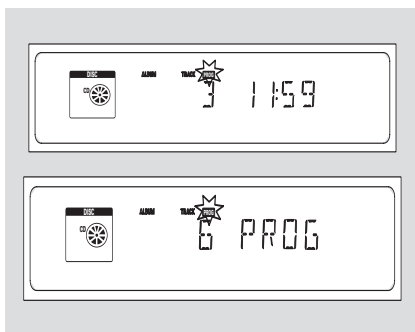

- 4 Repeat steps 2-3 to select and store all desired tracks.
 - **PROGRAM FULL** is displayed if you attempt to program more than 99 tracks
- 5 Press **■** to stop programming
 - **PROG** stops flashing
 - **Audio CD**: Display shows the number and playing time of tracks programmed
 - **MP3/WMA**: Display shows the album/ track number you just stored
- 6 Press **▶ ||** play the program

Helpful hints:

- The set will return to the stop position if no button is pressed within 20 seconds.

PROG stops flashing. To resume programming, press **PROGRAM**.

Erasing the program

You can erase the contents of the memory by:

- Press **■**
 - once if in the stop position (after you stop programming);
 - twice during playback;
- Press **STANDBY-ON/ECO POWER**
- Select another sound source
- Open the CD door
 - **PROG** disappears. **PROGRAM CLEARED** scrolls

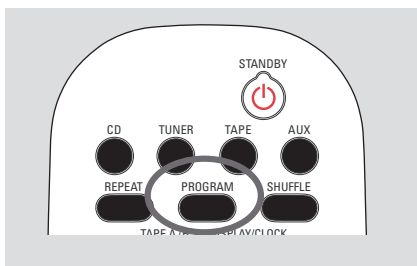

Different play modes: REPEAT, SHUFFLE

REP(*REPEAT TRACK/*
REPEAT PROGRAM) – plays the current track/program continuously

REP ALL(*REPEAT DISC*) – plays the entire disc continuously

SHUFFLE – plays all the tracks of the disc/program in random order

SHUFFLE REP - plays all the tracks of the program continuously in random order

SHUFFLE REP ALL – plays all the tracks of the disc continuously in random order

- 1 Press once or more **REPEAT** or **SHUFFLE** to select play modes
- 2 To return to normal playback, press **REPEAT** or **SHUFFLE** repeatedly until the various modes are no longer displayed
– You will also cancel the play modes by pressing **USB RECORD**

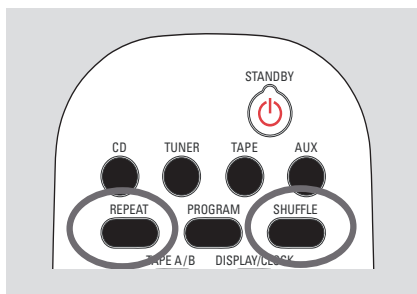

Helpful hints:

- In the shuffle mode, press **▶|** to select tracks.

Display track information (MP3/WMA only)

- During playback, press **DISPLAY/CLOCK** repeatedly on the remote control
→ Display show title name and album name

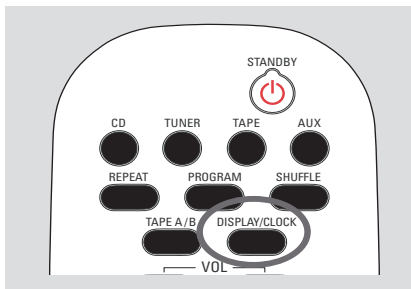

Tuning to radio stations

- 1 Press **TUNER** to select **TUNER** source
- 2 Press **TUNER** repeatedly to select your desired waveband, FM or MW
→ Display shows:  **TUNER** , radio station frequency, waveband and if programmed, a preset number

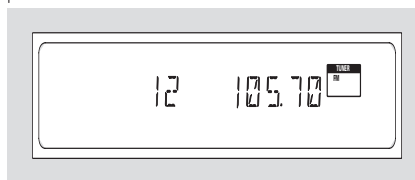

- 3 Press and hold **◀** or **▶** until **SEARCH** appears
→ The radio automatically tunes to a station with sufficient reception. Display shows **SEARCH** during automatic tuning
→ **FM**: If a station is received in stereo, **∞** is shown
→ **FM**: When you are receiving an RDS station, **R-D-S** is shown
- 4 Repeat step 3 if necessary until you find the desired station.
- To tune to a weak station, press **◀** or **▶** briefly and repeatedly until you have found optimal reception

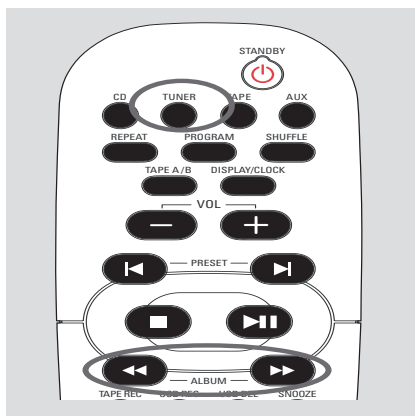

Programming radio stations

You can store up to a total of 40 radio stations (FM and MW) in the memory, manually or automatically (Autostore).

Plug & Play

Plug & Play allows you to store all available radio stations automatically.

- 1 Connect the system to the power supply
→ "AUTO INSTALL - PRESS PLAY" appears.
Or
In Eco Power standby/standby mode, press and hold **▶||** on the set until "AUTO INSTALL - PRESS PLAY" appears
- 2 Press **▶||** on the set to start installation
→ "INSTALL TUNER AUTO" appears
→ All previously stored radio stations will be replaced
→ After all stations are stored, the last preset station will then be played

Helpful hints:

- If the first preset is a RDS station, it will proceed to clock setting (See **Tuner: Clock setting via RDS**).
→ "INSTALL" appears, then "TIME" and "SEARCH RDS TIME".
→ When RDS time is read, "RDS TIME" will appear and the current time will be stored.
→ If RDS station does not transmit RDS time within 90 seconds, "NO RDS TIME" will appear and the programme will exit automatically.

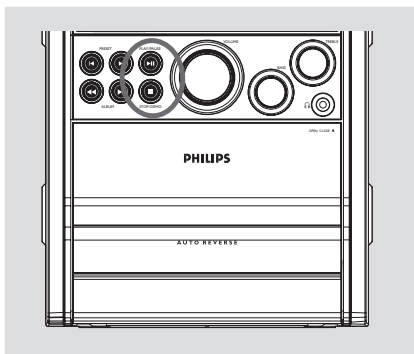

Autostore: Automatic programming

Automatic programming will start from preset 1 or a chosen preset number. From this preset number upwards, former programmed tuner stations will be erased. The set will only program stations which are not in the memory already.

- 1 Press the **◀** or **▶** buttons once or more to select the preset number where programming should start.

Note:

– If no tuner preset number is selected, default is preset 1 and all your presets will be erased.

- 2 Press and hold **PROGRAM** until **AUTO** appears
 - **PROG** flashes
 - Available stations are programmed: FM stations followed by MW stations
 - After all stations are stored, the last preset station will then be played

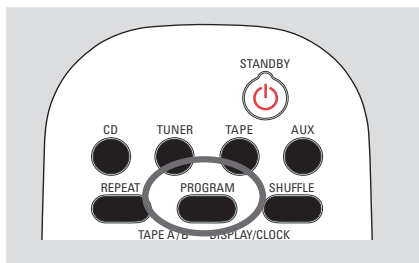

Manual programming

- 1 Tune to your desired station (see **Tuning to radio stations**)
 - 2 Press **PROGRAM** to activate programming
 - The preset number starts flashing
 - 3 Press **◀** or **▶** to allocate a number from 1 to 40 to this station
 - 4 Press **PROGRAM** to confirm
 - Display shows the preset number; waveband and the frequency of the preset station
 - 5 Repeat steps 1-4 to store other stations
- You can erase a preset station by storing another frequency in its place

To listen to a preset station

- Press the **◀** or **▶** buttons once or more until the desired preset station is displayed

Deleting a preset radio station

- Press and hold **■** until "PRESET DELETED" appears.
 - The current preset radio station will be deleted
 - The preset radio stations behind it move forward by one number

RDS

The feature RDS (**R**adio **D**ata **S**ystem) is a service that allows FM stations to send additional information along with the regular FM radio signal. When you are receiving an RDS station, and the station name are displayed.

Switching through RDS information

- 1 Tune to the desired RDS radio station on the FM waveband (see **Tuning to radio stations**)
- 2 Press **RDS/NEWS** on the set repeatedly to switch through the following information (if available):
 - Station name
 - Program type (for example: News, Sport, etc.)
 - Radio text messages
 - Frequency

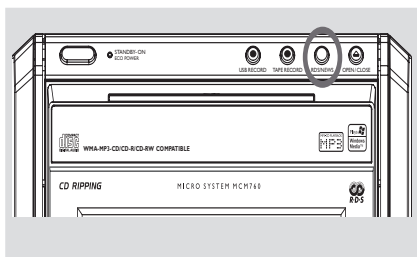

Clock setting via RDS

Some RDS radio station may be transmitting a real clock time at an interval of every minute. It is possible to set the clock by using a time signal which is broadcast together with the RDS signal.

- 1 Tune to the desired RDS radio station on the FM waveband (see **Tuning to radio stations**)
- 2 Press **CLOCK** twice

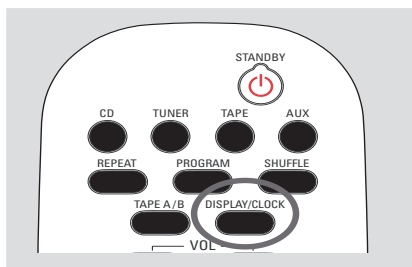

- 3 Press **RDS/NEWS**
 - "SEARCH RDS TIME" appears
 - When RDS time is read, the current time will be stored
 - If the RDS station does not transmit RDS time within 90 seconds, "NO RDS TIME" appears

Helpful hints:

– The time signal broadcast from certain RDS stations may not always be accurate..

NEWS

While listening to CD, USB, TAPE or AUX source, you can activate NEWS. The set will tune to the news/traffic announcement if the related signals are received from a RDS station.

Activating the NEWS function

- During playback in **CD, USB, TAPE** or **AUX** source, press **RDS/NEWS** until "NEWS" appears
 - Playback continues when the set scans for RDS news
 - When news transmission is detected, the set will switch to the news station. "NEWS" starts flashing

Helpful hints:

- Make sure you have stored RDS stations in the first 5 preset locations (See **Programming radio stations**).
- If no news transmission is detected during the set's scanning, "NO RDS NEWS" appears.

Deactivating NEWS function

- Press **RDS/NEWS** again
- or
- Switch the set to **TUNER** source

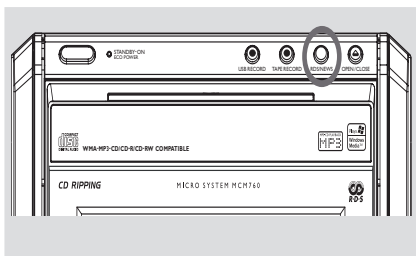

Using a USB mass storage device

On MCM760, you can playback music from a USB mass storage device and also, record music to such a device.

By connecting a USB mass storage device to the Hi-Fi system, you can enjoy the device's stored music through the powerful speakers of Hi-Fi system.

Compatible USB mass storage devices

With the Hi-Fi system, you can use

- USB flash memory (USB 2.0 or USB1.1)
- USB flash players (USB 2.0 or USB1.1)
- memory cards (requires an additional card reader to work with this Hi-Fi system)

Note:

- In some USB flash players (or memory devices), the stored contents are recorded using copyright protection technology. Such protected contents will be unplayable on any other devices (such as this Hi-Fi system).
- MTP (Media Transfer Protocol) USB devices are not supported.

Supported formats:

- USB or memory file format FAT12, FAT16, FAT32 (sector size: 512 - 65,536 bytes)
- MP3 bit rate (data rate): 32-320 Kbps and variable bit rate
- WMA v9 or earlier
- Directory nesting up to a maximum of 8 levels
- Number of albums/ folders: maximum 99
- Number of tracks/titles: maximum 999
- File name in Unicode UTF8 (maximum length: 128 bytes)

The system will not play or support the following:

- Empty albums: an empty album is an album that does not contain MP3/WMA files, and will not be shown in the display.
- Non-supported file formats are skipped. This means that e.g.: Word documents .doc or MP3 files with extension .dlf are ignored and will not be played.
- AAC, WAV, PCM audio files
- DRM protected WMA files
- WMA files in Lossless format

How to transfer music files from PC to a USB mass storage device

By dragging and dropping music files, you can easily transfer your favorite music from PC to a USB mass storage device.

For the flash player, you can also use its music management software for the music transfer.

However, those WMA files may be unplayable for compatibility reasons.

How to organize your MP3/WMA files on the USB mass storage device

This Hi-Fi system will browse the MP3/WMA files in the folders/sub-folders/titles order.

Example:

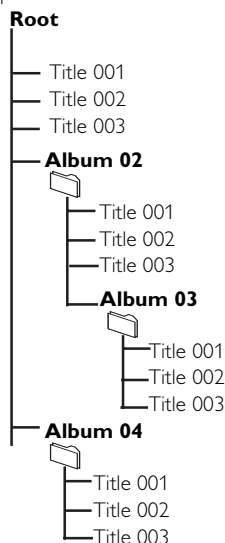

Organize your MP3/WMA files in different folders or subfolders as required.

Helpful hints:

- If you have not organized MP3/WMA files into any albums on your disc, an album "01" will be automatically assigned for all those files.
- Make sure that the file names of MP3 files end with .mp3, and the file names of WMA files end with .wma.
- For DRM protected WMA files, use Windows Media Player 10 (or later) for conversion. Visit www.microsoft.com for details about Windows Media Player and WM DRM (Windows Media Digital Rights Management).

Playing a USB mass storage device

- 1 Check the USB device has been properly connected. (See **Installation: Connecting an additional appliance**)
- 2 Press **USB** to select **USB** source
 - The icon  appears
 - **DEVICE NOT SUPPORTED** appears if the USB device is not supported by MCM760
 - **FILE SYSTEM ERROR** appears if unsupported file formats are used on the USB device

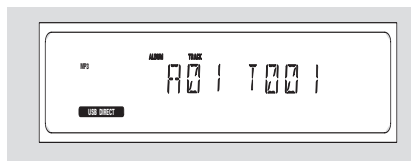

– **NO AUDIO** appears if no audio file is found in the USB device

- 3 Play the USB's audio files as you do with the albums/tracks on a CD (See **CD**)

Helpful hints:

– For compatibility reasons, the album/track information may differ from what it is displayed through flash players' music management software.



Recording to a USB mass storage device

With MCM760, you can record your favorite CD music to a USB mass storage device. Carry your favorite songs wherever you go.

IMPORTANT!

- **Recording is permissible if copyright or other rights of third parties are not infringed upon.**
- **For CDs encoded with copyright protection technologies by some record companies, recording is restricted.**

- 1 Check the USB device has been properly connected (See **Installation: Connecting an additional appliance**)
- 2 Press **CD** to select **CD** source
- 3 Insert a disc with the printed side facing up. Press **OPEN/CLOSE**  again to close the compartment

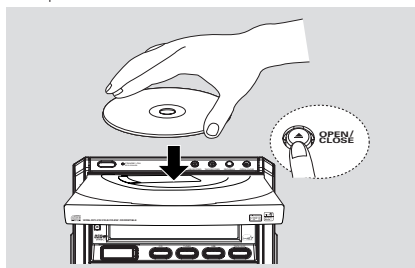

- 4 Press **◀** or **▶** once or repeatedly until the desired track number appears in the display
 - **MP3/WMA:** Press **◀◀** / **▶▶** and **◀** or **▶** to select the desired album and track
- Or**
- Program your desired tracks (see **CD: Programming tracks**)
 - Make sure you press  after finishing programming

- 5 Press **USB RECORD** once or more to select your recording options:

RECORD TRACK— record the selected track to the USB mass storage device

RECORD ALL — record the whole disc/program to the USB mass storage device

- Playback and recording start from the beginning
- A default folder name, e.g. F001, is assigned
- **USB FULL** appears if the storage space on the USB device is full
- **NUMBER FULL** appears if the number of folders exceeds 99 or the number of titles exceeds 999

- 6 Press **■** to stop recording

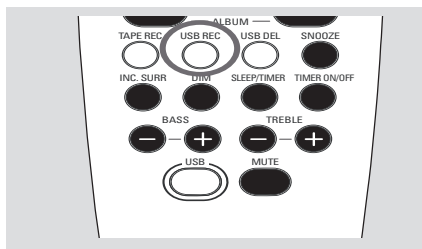

To record a disc during playback

- During playback, press **USB RECORD**
 - **Audio CD**: Recording starts from current playback point. Playback continues
 - **MP3/WMA**: Recording and playback start from the beginning of current track

Helpful hints:

- **SLOW USB** appears and CD playback pauses if the USB device is slow and the recording cannot be as fast as playback. However, the playback pause will not affect recording.
- **FILE EXIST** appears and recording stops if the track being recorded already exists in the USB device.

To find your ripped tracks

You can find and playback the ripped tracks in the album **_PHILIPS**

- 1 Press **USB** on the set to select **USB**
- 2 Press **◀/▶** and **|◀** or **▶|** to select the desired album and track
 - The audio CD files have been converted to MP3 format and named as **FXXX TXXX.MP3** (where "FXXX" denotes folder name, and "TXXX" track name)
 - For MP3/WMA files, the track information are retained (the set only supports the file names in English)
 - Only the completely ripped MP3/WMA file can be found and played by MCM760

To delete tracks from the USB device

- 1 Press **USB** to select **USB** source
- 2 Press **|◀** or **▶|** once or repeatedly until the desired track number appears in the display
- 3 Press **USB DEL** on the remote control
 - Display shows "PRESS USB DEL TO DELETE"
- 4 Press **USB DEL** again to confirm

To delete an album from the USB device (MP3/WMA only)

- 1 In the stop position, press **◀/▶** to select the desired album
- 2 Press and hold **USB DEL** until the display shows "PRESS USB DEL TO DELETE"
- 3 Press **USB DEL** again to confirm

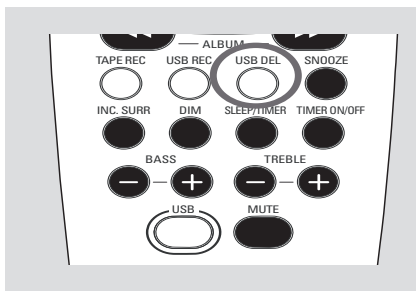

Note:

- On MCM760, the tracks of some USB devices may be indelible.

IMPORTANT!

- Before playing a tape, check and tighten slack tape with a pencil. Slack tape may get jammed or may burst in the mechanism.
- C-120 tape is extremely thin and is easily deformed or damaged. It is not recommended for use in this system.
- Store the tapes at room temperature and do not put them too close to a magnetic field (for example, a transformer, TV or speaker).

Playing a tape

- 1 Press **TAPE/AUX** once or more to select **TAPE** (or **TAPE** on the remote control)
- 2 Press **OPEN/CLOSE**  to open the tape deck door

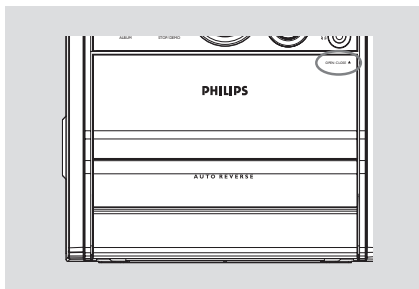

- 3 Insert a recorded tape and close the tape deck door:
→ Load the tape with the open side downward and full spool to the left

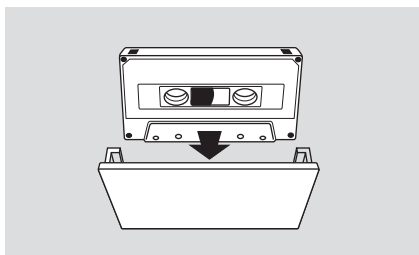



- 4 Press **▶▶** to start playback
→ At the end of one side, the tape playback will be automatically reversed and start from the beginning of the other side
→ **◀** (BACK) or **▶** (FRONT) appears

To change the playback side

- Press **◀** or **▶**
→ **◀** (BACK) or **▶** (FRONT) appears on the display, depending on the tape side selected

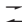
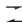
To change the playback mode

- Press **TAPE A/B** on the remote control repeatedly to select the different playback modes
 : plays one side of the tape
 : plays both sides once
 : plays both sides repeatedly (up to 10 times)

To rewind or fast forward

- 1 Press **◀◀** or **▶▶**
- 2 Press **■** when you reached the desired passage
→ The tape will stop automatically at the end of rewinding or fast forwarding.

To stop playback

- Press **■**

Helpful hints:

- During rewinding or fast forwarding of a tape, it is also possible to select another source (CD or TUNER, for example).

Recording to a tape**General information on recording**

- For recording, use only tape of IEC type I (normal tape).
- The recording level is set automatically, regardless of the position of the Volume, Incredible Surround, BASS/TREBLE and so forth.
- The tape is secured at both ends with leader tape. At the beginning and end of the tape, nothing will be recorded for six to seven seconds.
- To prevent accidental recording, break out the tab on the left shoulder of the tape side you want to protect.
- If "CHECK TAPE" is displayed, the protection tab has been broken. Put a piece of clear adhesive tape over the opening.

IMPORTANT!

Recording is permissible if copyright or other rights of third parties are not infringed upon.

Preparation

- 1 Press **TAPE/AUX** once or more to select **TAPE** (or **TAPE** on the remote control)
- 2 Load a recordable tape into the tape deck.
- 3 Press **◀** or **▶** on the remote control to select the recording tape side.
→ **◀** appears on the display for the reverse side
→ **▶** appears on the display for the forward side
- 4 Press **TAPE A/B** repeatedly on the remote control to select a recording mode.
→ **⏮** for recording on one side only.
→ **⏭** for recording on both sides.
- 5 Prepare the source to be recorded.
CD – load the disc
TUNER – tune to the desired radio station
USB – connect a USB device
AUX – connect external equipment

Helpful hints:

When recording is in progress, it is not possible:

- to change tape side;
- to listen to another source;
- to activate the timer function.

– One Touch Recording is not possible in **TAPE** mode, "SELECT SOURCE" will appear.

Tape recording

One touch recording

- 1 Select the recording source: **CD**, **TUNER**, **USB** or **AUX**
- 2 Start playback of the selected source
- 3 Press **TAPE RECORD**
→ **REC** starts flashing
- 4 To stop recording, press **■** on the set

CD/USB Synchro start recording

- 1 Select the recording source: **CD** or **USB**
- 2 If necessary, press **◀** or **▶** once or repeatedly until the desired track number appears in the display
- **MP3/WMA:** Press **◀◀/▶▶** and **◀** or **▶** to select the desired album and track
Or
- Program your desired tracks (see **CD: Programming tracks**)
– Make sure you press **■** after finishing programming
- 2 Press **TAPE RECORD**
→ The playback and recording start automatically
- 3 For brief interruption, press **▶||**. To resume recording, press **▶||** again
- 4 To stop recording, press **■**
→ Recording and playback will stop simultaneously

AUX (Listening to an external source)

You can listen to the sound of the connected external device through your MCM760



- ❶ Check the external device has been properly connected (See **Installation, Connecting an additional appliance**)
- ❷ Press **TAPE/AUX** once or more to select **AUX** (or **AUX** on the remote control)
- ❸ To avoid noise distortion, turn down the volume on your external device
- ❹ Press the **PLAY** key on the connected device to start playback
- ❺ To adjust the sound and volume, use the sound controls on your external device and the MCM760

Setting the timer

The set can be used as an alarm clock, whereby the selected source (CD, TUNER, USB or TAPE) starts playback at a preset time. **Make sure the clock is set before using the timer.**

IMPORTANT!

- if recording is in progress, the timer function will not be activated.
- The volume of the timer will increase gradually to the last tuned volume level. If the last tuned volume level is too low, the set will then increase to a predetermined minimum audible level (-29dB).

- ❶ On the remote control, press and hold **SLEEP/TIMER**
→  icon starts flashing
- ❷ Select the timer source: **CD, TUNER, USB** or **TAPE**
→ The selected source lights up
- ❸ Press **◀◀** or **▶▶** repeatedly to set the hour
- ❹ Press **▶||** to change to minutes setting, then press **◀◀** or **▶▶** repeatedly to set the minutes
- ❺ Press **SLEEP/TIMER** to store the setting
→  icon stops flashing. The timer is now set and activated
→ At the set alarm time, the CD, TUNER, USB or TAPE will switch on and after 30 minutes switch to ECO POWER automatically

Note:

- The set will exit from the timer setting mode if no button is pressed within 90 seconds.

Helpful hints:

The timer will not work at the set time if

- the CD is switched on
- the timer is deactivated

The set will switch to Tuner source automatically if :

- no CD is inserted when the selected source is CD;
- no USB device is connected when the selected source is USB

Activating and deactivating TIMER

- Press **TIMER ON/OFF** on the remote control to turn off the timer or turn on to the last setting again.
 - If activated, the timer information are displayed
 - If deactivated, "OFF" appears

Temporarily deactivating TIMER

- 1 Within 30 seconds after the timer is activated, press **SNOOZE** on the remote control
 - The set will switch to standby mode for 5 minutes. And then, the timer will be re-activated
- 2 To cancel the snooze function, press **SNOOZE** again

SLEEP

You can set a certain period of time after which the set will switch to ECO POWER.

- 1 On the remote control, press **SLEEP/TIMER** repeatedly to select the desired time period options (in minutes):
 - Display shows in sequence: **SLEEP 15, 30, 45, 60, 90, 120, SLEEP OFF**
 - Display shows the selected option briefly and returns to its previous status. The icon **zzZ** appears
- 2 To view the time countdown to ECO POWER, press **SLEEP/TIMER** again

To deactivate the sleep timer, press **SLEEP/TIMER** until **SLEEP OFF** is displayed
or

Press **STANDBY-ON/ ECO POWER** to switch off the set (or ϕ on the remote control)

Demonstration mode

The demonstration mode displays various features of MCM760.

To activate the demonstration

- When the set is switched off, press and hold \blacksquare on the set until "DEMO ON" appears
 - The demonstration mode will be activated when the set is switched off

To deactivate the demonstration

- Press and hold \blacksquare on the set until "DEMO OFF" appears

AMPLIFIER

Output power	
.....	2 x 150 W MPO
.....	2 x 75 W RMS ⁽¹⁾
Signal-to-noise ratio ≥ 75 dBA (IEC)
Frequency response 50 – 20000 Hz, –3 dB
Input sensitivity	
AUX 500 mV
Output	
Speakers $\geq 6 \Omega$
Headphones 32 Ω – 1000 Ω
(1) (6 Ω , 1 kHz, 10% THD)	

DISC PLAYER

Programmable tracks 99
Frequency response 20 – 20000 Hz, –3 dB
Signal-to-noise ratio ≥ 76 dBA
Channel separation ≥ 55 dB (1 kHz)
MPEG 1 Layer 3 (MP3-CD) MPEG AUDIO
MP3/WMA-CD bit rate 32-256 kbps
.....	(128 kbps advised)
Sampling frequencies 32, 44.1, 48 kHz

TUNER

FM wave range 87.5 – 108 MHz
MW wave range 531 – 1602 kHz
Number of presets 40
Antenna	
FM 75 Ω wire
MW Loop antenna

TAPE PLAYER

Frequency response
CrO ₂ tape (type II) 80 – 12500 Hz, –8 dB
Normal tape (type I) 80 – 12500 Hz, –8 dB
Signal-to-noise ratio	
CrO ₂ tape (type II) ≥ 50 dBA
Normal tape (type I) ≥ 47 dBA
Wow and flutter $\leq -0.48\%$ DIN

SPEAKERS

System 2 way, Bass reflex
Impedance 6 Ω
Woofer 1 x 5.25" Aluminium
.....	con woofer
Tweeter Ribbon tweeter
Dimensions (w x h x d)	
.....	175 x 252 x 196 (mm)
Weight	
.....	3.1 kg each
.....	6.82 pounds each

GENERAL

Material/finish Polystyrene/Metal
AC Power 220 – 230 V / 50 Hz
.....	230 – 240 V / 50 Hz (for the UK)
Power Consumption	
Active 130 W
Standby < 15 W
Eco Power Standby < 1 W
Dimensions (w x h x d) 179 x 252 x 340 (mm)
Weight (without speakers) 5.53 kg

Specifications and external appearance are subject to change without notice.

Maintenance

Cleaning the Cabinet

- Use a soft cloth slightly moistened with a mild detergent solution. Do not use a solution containing alcohol, spirits, ammonia or abrasives.

Cleaning Discs

- When a disc becomes dirty, clean it with a cleaning cloth. Wipe the disc from the centre out.

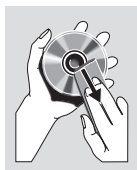

- Do not use solvents such as benzene, thinner; commercially available cleaners, or antistatic spray intended for analogue records.

Cleaning the disc lens

- After prolonged use, dirt or dust may accumulate at the disc lens. To ensure good playback quality, clean the disc lens with Philips CD Lens Cleaner or any commercially available cleaner. Follow the instructions supplied with cleaner.

Troubleshooting

WARNING

Under no circumstances should you try to repair the system yourself, as this will invalidate the warranty. Do not open the system as there is a risk of electric shock.

If a fault occurs, first check the points listed below before taking the system for repair. If you are unable to remedy a problem by following these hints, consult your dealer or Philips for help.

Problem	Solution
"NO DISC" is displayed.	<ul style="list-style-type: none"> ✓ Insert a disc. ✓ Wait until the moisture condensation at the lens has cleared. ✓ Replace or clean the disc, see "Maintenance". ✓ Use a finalised CD-RW or a correct MP3/WMA-CD format disc.
Some files on the USB device are not displayed.	<ul style="list-style-type: none"> ✓ Check if the number of folders exceeds 99 or the number of titles exceeds 999. ✓ Only the completely ripped MP3/WMA file can be found and played by MCM760. Check if the file has been completely ripped.
"POWER NOT ENOUGH" is displayed.	<ul style="list-style-type: none"> ✓ Check if the USB device needs extra power supply.
Radio reception is poor.	<ul style="list-style-type: none"> ✓ If the signal is too weak, adjust the antenna or connect an external antenna for better reception. ✓ Increase the distance between the Micro HiFi System and your TV or VCR.
Tape recording or playback cannot be made.	<ul style="list-style-type: none"> ✓ Use only NORMAL (IEC I) tape. ✓ Apply a piece of adhesive tape over the missing tab space.
The tape deck door cannot open.	<ul style="list-style-type: none"> ✓ Remove and reconnect the AC power plug and switch on the system again.
The system does not react when buttons are pressed.	<ul style="list-style-type: none"> ✓ Remove and reconnect the AC power plug and switch on the system again.
Sound cannot be heard or is of poor quality.	<ul style="list-style-type: none"> ✓ Adjust the volume. ✓ Disconnect the headphones. ✓ Check that the speakers are connected correctly. ✓ Check if the stripped speaker wire is clamped.

The left and right sound outputs are reversed.

- ✓ Check the speaker connections and location.

The remote control does not function properly.

- ✓ Select the source (CD or TUNER, for example) before pressing the function button (▶||, ◀, ▶|).
- ✓ Reduce the distance between the remote control and the system.
- ✓ Insert the battery with its polarities (+/- signs) aligned as indicated.
- ✓ Replace the battery.
- ✓ Point the remote control directly toward IR sensor on the front of the system.

The timer is not working.

- ✓ Check the set is switched off
- ✓ Set the clock correctly.
- ✓ Press TIMER to switch on the timer.

The Clock/Timer setting is erased.

- ✓ Power has been interrupted or the power cord has been disconnected. Reset the clock/timer.