

Register your product and get support at
www.philips.com/welcome

XL5950



Quick start guide

1

Get started

2

Register the handsets

PHILIPS

What is in the box



Handset



Charger



Power adapter



User manual, quick start guide,
guarantee



Caution

- Use only the supplied batteries and power adapter.

1 Get started

Connect the charger

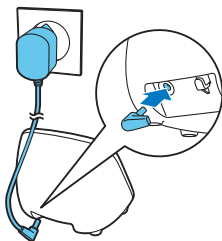

Connect each end of the power adapter to:

- the DC input jack at the back of the extra handset charger;
- the power socket on the wall

Configure your phone

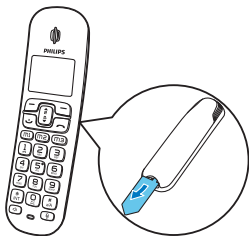

1 The batteries are pre-installed in the handset. Pull the battery tape off from the battery door before charging.

2 When using your phone for the first time, you see a welcome message (country dependent).

3 Please set the country and language if prompted.

4 Set the date and time.

- If the time is in 12-hour format, press  to select **[am]** or **[pm]**.

Charge your phone

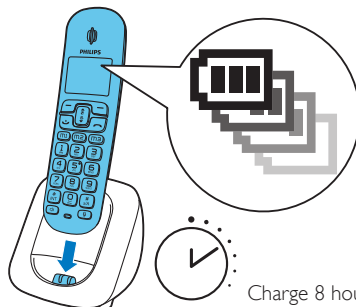

Charge 8 hours



Place the handset on the charger to charge the handset. When the handset is placed correctly on the charger, you hear a docking sound.

↳ The handset starts charging.

Note

- Charge the batteries for 8 hours before first use.

Check the battery level

Icon	Status
	When the handset is off the base station/charger, the bars indicate the battery level (full to low).
	When the handset is on the base station/charger, the bars flash until charging completes.
	The empty battery icon flashes and you hear an alert tone. The battery is low and needs recharging.

2 Register the handsets

You can register additional handsets to the base station. The base station can register up to 4 handsets.

Auto registration

Place the unregistered handset on the base station.

- ↳ The handset detects the base station and registers automatically.
- ↳ Registration is completed in less than two minutes. The base station automatically assigns a handset number to the handset.

Manual registration

- 1 Select **[Menu]** > **[Services]** > **[Register]**, then press **[OK]** to confirm.
- 2 Press and hold **[M]** on the base station for 5 seconds.
- 3 Enter the system PIN. Press **[Clear]** to make corrections.
- 4 Press **[OK]** to confirm the PIN.
 - ↳ Registration is complete in less than 2 minutes. The base automatically assigns a handset number to the handset.



Note

- If the PIN is incorrect or no base is found within a certain period, your handset displays a notification message. Repeat the above procedure if registration fails.
- The preset PIN is 0000. No change can be made on it.

Welcome to Philips

Register your product at www.philips.com/welcome

Need help?

[User manual](#)

Refer to the user manual that came with your new phone.

[Online help](#)

www.philips.com/support

CE 0168



Reproduction in whole or in part is prohibited without the written consent of the copyright owner. Trademarks are the property of Koninklijke Philips Electronics N.V. or their respective owners. All rights reserved.
© 2012 Koninklijke Philips Electronics N.V.



QSG_XL5950
12_EN_V1.0
WK11495