

BG2039



Manufactured for: Philips Personal Health
a division of Philips North America LLC
P.O. Box 10313, Stamford, CT 06904, USA

 This symbol on the product's nameplate means it is listed by Underwriters' Laboratories, Inc.

Norelco is a registered trademark of Philips North America LLC.

PHILIPS and Philips shield are registered trademarks of Koninklijke Philips N.V.

©2023 Philips North America LLC. All rights reserved.

4222.002.8113.1 (11/15/2023)



>75 % recycled paper
>75 % papier recyclé

- 2
- 3
- 4
- 5
- 6
- 7
- 8
- 9
- 10
- 11
- 12
- 13
- 14
- 15
- 16
- 17
- 18
- 19
- 20
- 21
- 22
- 23
- 24
- 25

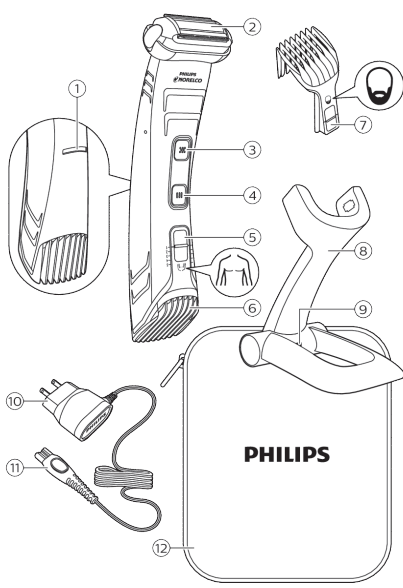
1

English

IMPORTANT SAFETY INSTRUCTIONS

When using an electric product, basic precautions should always be followed, including the following:

Read all instructions before using this product.

DANGER

To reduce the risk of electric shock:

- Do not reach for a corded product or charging stand that has fallen into water. Unplug immediately from the power outlet.
- Keep the power cord and charging stand dry.
- Do not place or store the product or charging stand where it can fall or be pulled into a tub or sink. Do not place or drop the product or charging stand into water or other liquid.
- Except when charging, always unplug this product from the power outlet immediately after use.
- Remove power cord from power outlet and product before cleaning.
- Plug power cord directly into power outlet. Do not use an extension cord.

WARNING

To reduce the risk of burns, fire, electric shock, or injury to persons:

- Close supervision is required when this product is used by, on, or near children, or persons with limited physical, sensory, or mental capabilities or invalids.
- Use this product only for its intended household use as described in this manual. Do not use attachments not recommended by Philips North America LLC.
- Never operate the product or charging stand if it has a damaged power cord, if it is not working properly, after it has been dropped or damaged, or after the product or power cord has been dropped into water. For assistance call 1-800-243-3050.
- Keep the power cord away from heated surfaces.
- Never drop or insert any object into any opening.
- Do not use the power cord in or near a power outlet that contains an electric air freshener to prevent damage to the power cord.
- Do not charge or plug in product or charging stand outdoors or operate where aerosol (spray) products are being used or where oxygen is being administered.
- Always check cutters, cutting unit and guards before using the product. Do not use the product if cutters, cutting unit or guards are damaged, as injury may occur.
- Always attach power cord to product or charging stand first, then to power outlet. To disconnect, set all controls to 'off' position. Then remove power cord from power outlet.

- Unplug power cord before plugging in or unplugging the product.
- Only use the power cord and other accessories supplied with the product.
- Do not attempt to open the product to remove or replace the built-in rechargeable battery.

IMPORTANT: The power plug contains a transformer. Do not cut off the power plug to replace it with another plug as this will cause a hazardous condition.

SAVE THESE INSTRUCTIONS

Introduction

Congratulations on your purchase and welcome to Philips Norelco!

To fully benefit from the support that Philips Norelco offers, register your Bodygroom system at www.norelco.com/register.

General description (Fig. 1)

- 1 Charging and battery low indicator light
- 2 Shaving unit
- 3 Shaving unit on/off button
- 4 Trimming unit on/off button
- 5 Hair length selector
- 6 Trimming unit with body comb
- 7 Beard comb
- 8 Charging stand
- 9 Socket for small plug
- 10 Power plug
- 11 Small plug
- 12 Pouch

Cleaning brush (not shown)

 This symbol indicates that the product can be used in the bath or shower.

Charging

Battery status indications

- When the battery is almost empty, the battery charge indicator flashes orange (Fig. 5).
- When the product is charging, the battery charge indicator flashes green.
- When the battery is fully charged, the battery charge indicator lights up green continuously.

Note: After approx. 30 minutes, the light goes out automatically.

Charging

Note: The product can only be charged in the charging stand. Only use the power cord and charging stand provided.

Charging takes approx. 8 hours. Charge the product before first use and when the display indicates that the battery is almost empty.

- Charging or using the product at temperatures below 40 °F (4.5 °C) or higher than 95 °F (35 °C) adversely affects the lifespan of the battery.
 - If the product is subjected to a major change in temperature, pressure or humidity, let the product acclimatize for 30 minutes before using.
- 1 Make sure the product is turned off.
 - 2 Put the small plug in the charging stand (Fig. 2) and put the power plug in any 120V AC outlet.

Note: The small plug is easiest to insert when the charging stand is folded.

- 3 Unfold the charging stand (Fig. 3).
 - 4 Put the product in the charging stand with the shaving unit pointing upwards (Fig. 4).
- Make sure the charging contacts on each side of the product fit into the charging stand correctly.
 - When placed correctly, the charging light will flash green to indicate the product is (re)charging (Fig. 5).
- 5 After charging, remove the power plug from the wall outlet and pull the small plug out of the charging stand.

Note: An adapter plug may be necessary for cord usage in some foreign countries. Use an attachment plug adapter of the proper configuration for the power outlet.

Optimize the working life of the battery

- After the product has been charged for the first time, do not recharge the product between grooming sessions. Continue using it until the battery is completely empty.

- Discharge the battery completely twice a year by letting the motor run until it stops.
- Do not keep plug permanently plugged in.

Operating time

When the product is fully charged, it has a cordless operating time of up to 50 minutes.

Using the product

- Use this product for its intended household use as described in this manual.
- For hygienic reasons, the product should only be used by one person.

Note: This product is for cordless use only.

Switching the product on and off

Shaver

- 1 Press the shaving on/off button once to switch the product on or off (Fig. 6).

Trimmer

- 1 Press the trimming on/off button once to switch the product on or off (Fig. 7).

Attaching and detaching the combs

Attaching the comb

- 1 Slide the beard or body comb into the guiding grooves on both sides of the handle.
- 2 Press the length selector and then slide it up or down to select the desired hair length setting (Fig. 8).

Detaching the comb

- 1 Press the length selector and then slide the comb upwards off the product.

Trimming length settings

The trimming combs allow you to cut hair to 5 different lengths:

Hair length setting	Hair length after trimming
1	1/8 in. / 3 mm
2	3/16 in. / 5 mm
3	9/32 in. / 7 mm
4	3/8 in. / 9 mm
5	7/16 in. / 11 mm

Trimming

- If you are trimming for the first time, be careful. Do not move the product too fast. Make smooth and gentle movements.
 - When you trim for the first time, start at the highest length setting to familiarize yourself with the product.
 - Since all hairs do not grow in the same direction, you may want to try different trimming positions (i.e. upwards, downwards, or across). Practice is best for optimum results.
 - Always make smooth and gentle movements and be sure the surface of the comb always stays in contact with your skin.
 - For body trimming, make sure hair is clean and dry as wet hair tends to stick to the body and, when trimming sensitive areas, always use the body comb.
- 1 Hold the product in the trimming position, with the trimming unit pointing upwards and the shaving unit pointing downwards (Fig. 9).
 - 2 Slide the beard or body comb into the guiding grooves on both sides of the handle.
 - 3 Press the length selector and then slide it up or down to select the desired hair length setting (Fig. 10).
 - The two lines next to the setting selector show which setting you have selected (Fig. 11).
 - 4 Switch on the product (Fig. 7).
 - 5 Hold product as shown and move the trimmer against the direction of hair growth making sure the tips of the comb point in the same direction as you are moving the product (Fig. 12).
 - 6 Switch off and clean the product after each use (see 'Cleaning').

Shaving

Do not use this shaving unit to shave or trim facial or scalp hair (Fig. 15). The shaving unit should only be used on skin below the neckline.

- When shaving sensitive areas for the first time, you may feel some discomfort, irritation or reddening of the skin. This is normal as your skin needs time to adjust to shaving.

- If your hair is longer than 13/32 in./10 mm, trim hair using a trimmer first for optimum shaving results.
 - For dry use, be certain that your skin is clean and dry before using the shaving unit.
 - For wet use, prepare your skin with lathered soap or shaving foam before using the shaving unit.
- 1 Hold the product in the shaving position, with the shaving unit pointing upwards and the trimming unit pointing downwards (Fig. 13).
 - 2 Switch on the shaver (Fig. 6).
 - 3 Stretch your skin taut with your free hand (Fig. 14). Gently press shaving unit to skin and move it slowly and smoothly against the direction of hair growth (Fig. 15).
 - Do not press too hard. Too much pressure can distort the foil and cause skin irritation.
 - Make sure the shaving unit is always in full contact with your skin
 - 4 Switch off and clean the product after each use (see 'Cleaning').

Cleaning

Never use scouring pads, abrasive cleaning agents or aggressive liquids such as gasoline or acetone to clean the product.

Never dry trimmer or shaving foil head with a towel or tissue, as this may cause damage.

Cleaning the trimmer

- 1 Switch off the product and disconnect the charging stand from the wall outlet.
- 2 Rinse the handle of the product and wipe the handle dry with a dry cloth.
- 3 Remove the trimming comb by sliding it off the product. Shake and/or blow out the hair or clean it under the tap.
- 4 Push the middle part of the trimming unit upwards with your thumb until it opens (Fig. 16).
- 5 Clean the hair chamber with the cleaning brush supplied (Fig. 17). You may also rinse the hair chamber under warm running tap water to remove any residual debris.
- 6 Rinse the trimming unit with warm running tap water (Fig. 18).
- 7 Leave the trimming unit open to air dry completely.
- 8 Close the trimming unit and reattach the trimming comb (Fig. 19). You will hear a click.

Cleaning the shaving unit

- 1 Switch off the product and disconnect the charging stand from the wall outlet.
- 2 Rinse the handle of the product and wipe dry with a dry cloth.
- 3 Remove the shaving foil head by pulling it off the product (Fig. 20).
 - Hold the shaving foil head by the plastic housing only.
- 4 Rinse the shaving foil head with warm running tap water (Fig. 21).
 - Do not use the cleaning brush to clean the shaving foil head as this may cause damage to the foil or cutters.
- 5 Allow the shaving foil head to air dry completely.
 - Never dry trimmer or shaving foil head with a towel or tissue, as this may cause damage.
- 6 Clean the hair chamber with the cleaning brush supplied. You may also rinse the hair chamber under warm running tap water to remove any residual debris (Fig. 22).
- 7 Reattach the shaving foil head by snapping it back onto the product (Fig. 23). You will hear a click.

This product has no other user-serviceable parts. For assistance call 1-800-243-3050.

Storage

- Fold the charging stand for easy travelling or storage (Fig. 24).
- Be sure the product is turned off. Remove cord from outlet and charging stand before storing in a safe, dry location where it will not be crushed, banged, or subject to damage.
- Do not wrap cord around the product when storing.

- Store cord and other accessories in a safe location where these will not be cut or damaged.
- Do not place or store the product/charging stand where it can fall or be pulled into a tub or sink, water or other liquid while plugged in.

Replacement

Replacing the shaving foil head

For maximum shaving performance, we advise you to replace the shaving foil head and cutters every year.

If shaving head foil and cutters are worn or damaged, do not use the product and replace immediately.

Always replace the shaving foil head and cutters with original Philips Norelco shaving foil head (see 'Accessories').

- 1 Switch the product off and disconnect it from the wall outlet.
- 2 Remove the shaving foil head by pulling it off the product (Fig. 20).

Note: The foil is a precision part. Handle with care.

- 3 Place the new shaving foil head on the product by snapping it into place (Fig. 23). You will hear a click.
- 4 After replacing the shaving foil head, check that the shaving head is firmly attached before using product.

Accessories

Replacement parts and accessories may be purchased at a store near you or on our website www.philips.com/store.

For maximum product performance, replace shaving foil head once a year.

- Model BG2000 Philips Norelco Replacement Shaving Foil Head

Assistance

For assistance, visit our website:

www.philips.com/support or call toll free

1-800-243-3050.

Disposal

- This product contains a rechargeable nickel metal hydride battery which must be disposed of properly.
- The built-in battery should not be disposed of with normal household waste
- Contact your local town or city officials for battery disposal information. You can also call 1-800-822-8837 or visit www.call2recycle.org for battery drop-off locations.
- For assistance, visit our website **www.philips.com/support** or call 1-800-243-3050 toll free.
- Your product is designed and manufactured with high quality materials and components, which can be recycled and reused. For recycling information, please contact your local waste management facilities or visit **www.recycle.philips.com**

Full Two-Year Warranty

Philips North America LLC warrants this new product (except foil, cutters and guards) against defects in materials or workmanship for a period of two years from the date of purchase, and agrees to repair or replace any defective product without charge.

IMPORTANT: This warranty does not cover damage resulting from accident, misuse or abuse, lack of reasonable care, the affixing of any attachment not provided with the product or loss of parts or subjecting the product to any but the specified voltage or batteries.*

NO RESPONSIBILITY IS ASSUMED FOR ANY SPECIAL, INCIDENTAL OR CONSEQUENTIAL DAMAGES.

In order to obtain warranty service, simply go to **www.philips.com/support**. It is suggested that for your protection you return shipments of product by insured mail, insurance prepaid. Damage occurring during shipment is not covered by this warranty.

NOTE: No other warranty, written or oral, is authorized by Philips North America LLC.

This warranty gives you specific legal rights, and you may also have other rights which vary from state to state. Some states do not allow the exclusion or limitation of incidental or consequential damages, so the above exclusion and limitations may not apply to you.

*Read enclosed instructions carefully.

45-DAY MONEY-BACK GUARANTEE

If you are not fully satisfied with your product send the product back and we'll refund you the full purchase price.

The product must be shipped prepaid by insured mail, insurance prepaid, have the original sales receipt, indicating purchase price and date of purchase.

We cannot be responsible for lost mail.

The product must be postmarked no later than 45 days after the date of purchase. Philips reserves the right to verify the purchase price of the product and limit refunds not to exceed suggested retail price.

To obtain the money-back guarantee service, please go to www.PhilipsMoneyBack.com and follow the simple 3-step process.

Delivery of refund check will occur 6–8 weeks after receipt of returned product.