

**PHILIPS**

Water Dispenser

ADD5962

# Read this First !

Quick Start Guide & FAQs

# First time cleaning

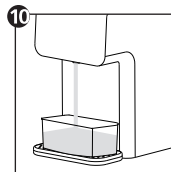
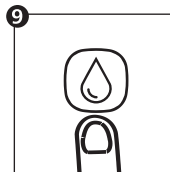
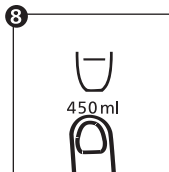
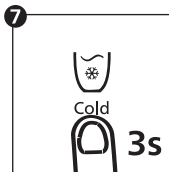
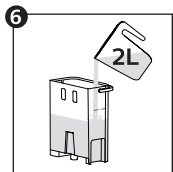
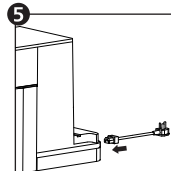
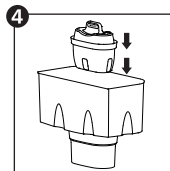
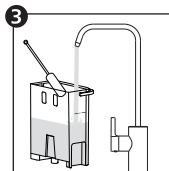
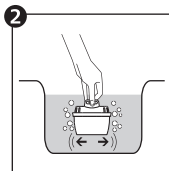
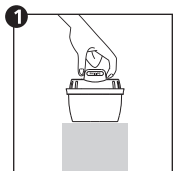

10 \* Fill the cooling tank by pressing "  ", "450ml", and "  ". Repeat this 3 times until the water comes out from the nozzle.

# User interface



## Safety Lock

When hot water  $\geq 40^{\circ}\text{C}$  is chosen, press to unlock before pressing the dispense button.  
Press to lock the appliance.





## Dispense Button

Press to start or stop dispensing. Long press for 3 seconds to continuously dispense 1L of water.



## Descal Indicator/Button

Light flashes when it is time to descale. Long press for 3 seconds to start the descaling process.  
During descaling, press "  " Button to pause, and press "  " Button again to restart.



Cold



Ambient

### Water Temperature Adjustment

Select the temperature you need by pressing the button

Cold: chilled water

Ambient: press it repeatedly to select between ambient and 40°C

Warm: press it repeatedly to select between 70°C and 80°C

Hot: press it repeatedly to select between 90°C and 100°C



Warm



Hot



150ml



250ml

### Water Volume Adjustment

Select the volume you need by pressing the button.



300ml



450ml



### Cooling Indicator

Lights flashes: the water is being cooled.

Lights up constantly: the cooling is done.



### Water Shortage Indicator

Light flashes: not enough water in the water tank.

Light off: enough water in the water tank.

### Filter Lifetime Indicator



Constant white light: the filter is in its lifespan.

Flashing red light: the filter is about to reach the end of life.

Constant red light: the filter reaches the end of life.



Cold

### Turn on/off the cooling system

Long press for 5 seconds to turn off/turn on the cooling system.

## The lifetime of the filter cartridge

Model	Suggested Replacement Cycle
AWP230	After 100 liters or every 30 days, whichever comes first.

Filter indicator lifetime constant white: the filter is in its lifespan.

Filter indicator lifetime flashing red: the filter is about to reach the end of life.

Filter indicator lifetime constant red: the filter reaches the end of life.



Reset

### Filter Lifetime Reset

Long press for 3 seconds to reset the filter lifetime.

## How to install the CO<sub>2</sub> cylinder ?

**Note:** the CO<sub>2</sub> cylinder is not included. It needs to be purchased separately.

- Remove the carbonating bottle from the appliance before installing or replacing the CO<sub>2</sub> cylinder.
- Slide up the metal plate. (A-1)
- Pick up the cylinder handle. (A-2)
- Remove seal and cap from the CO<sub>2</sub> cylinder. Carefully insert the cylinder, and screw it tight. (A-3)
- Put the CO<sub>2</sub> cylinder back in the appliance. Push the cylinder handle down. Put the metal plate back.

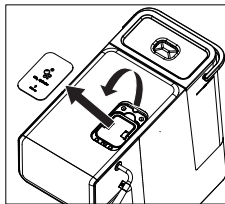

A-1

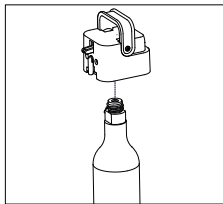

A-2

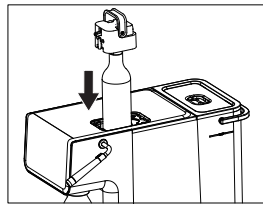

A-3

# How to dispense water ?





## Note:

- When dispensing 100°C hot water for the first time, boiled water will flow out from the nozzle, and the boiling point calibration will be automatically completed. This procedure will last for approximately 60 seconds. Please ensure that a container with a volume of at least 500ml is placed under the nozzle during this procedure.
- There might be steam ejection during the boiling point calibration, please be aware of burn hazards.

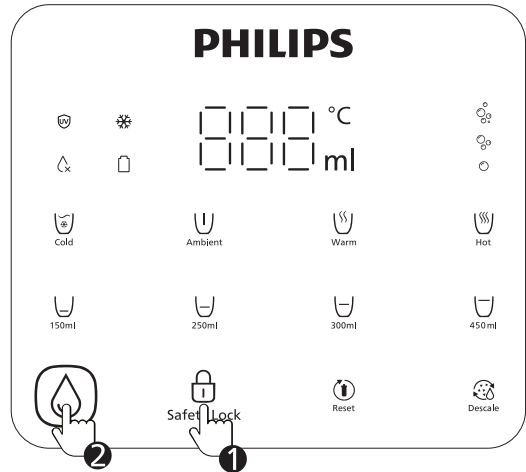
## How to dispense water

- When hot water  $\geq 40^{\circ}\text{C}$  is chosen, press the "  " to unlock.



- Press the "  " to start or stop dispensing.
- Press "  " to choose chilled water;
- Press "  " repeatedly to choose between ambient and 40°C;
- Press "  " repeatedly to choose between 70°C and 80°C;
- Press "  " repeatedly to choose between 90°C and 100°C;
- Press water volume buttons for selection: 150ml, 250ml, 300ml, and 450ml.

## How to carbonate ?

1. Fill the carbonating bottle with chilled water between the Max and Min lines by selecting "  " and 450ml. (B-1) There could be a deviation of the dispensing volume. Please make sure the water level is always between the Max and the Min lines.
- We recommend carbonating chilled water to have a better taste.

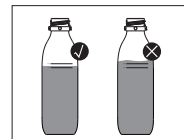

**B-1**



## 2. Install the carbonating bottle. (B-2)

- Attach the carbonating bottle to the carbonating bottle socket.
- Twist it counterclockwise, and push it to the back to get it in the upright position.

## 3. Carbonate the water

- Please pour out the water in the drip tray before carbonating. Always put the drip tray back into the appliance before carbonating.
- Press the lever downwards firmly. (B-3) The bubble indicators will light up.
- The longer you press down the lever, the stronger the sparkling water gets. Never continuously carbonate for over 3 seconds each time.

## 4. Ventilate the bottle.

When hearing a buzzing sound, you need to release the lever immediately. Lift the bottle and twist it clockwise to detach the bottle. The remaining pressure in the carbonating bottle will be released with a puff sound. The sparkling water is ready to enjoy.

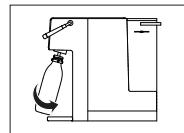

**B-2**

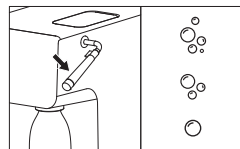

**B-3**

# How to descal ?

- Empty the tap water tank, remove the filter and the funnel.
- Fill the tap water tank with 3 liters of 5% citric acid solution (1g citric acid per 20 ml tap water).
- Place a jug under the dispense nozzle.  
Long press the "🌀" for 3 seconds.  
The "🌀" will flash, and the appliance will run a descale process.
- When the "🌀" flashes for the second times, the descale procedure has completed.
- The descaling process lasts for about 30 minutes.

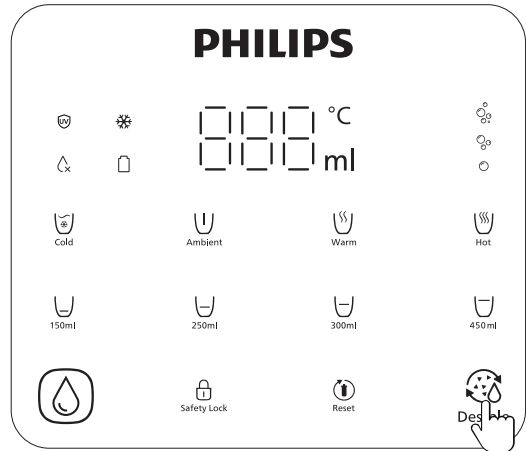

# How to reset the filter lifetime ?

- Please clean and install the filter cartridge as per the first-time cleaning instruction above.
- Reset the filter lifetime by long pressing the "  " button for 3 seconds.

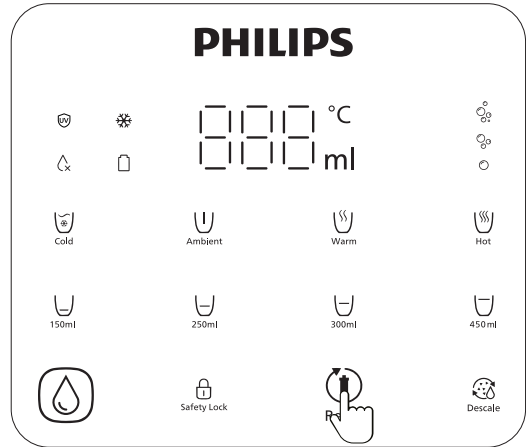



Register your product and learn more in the website link below:

[www.philips.com/water](http://www.philips.com/water)

Specifications are subject to change without notice

© 2023 AquaShield

All rights reserved.

Philips and the Philips Shield Emblem are registered trademarks of Koninklijke Philips N.V. and are used under license.

This product has been manufactured by and is sold under the responsibility of Hong Kong AquaShield Health Technology Company Limited and Hong Kong AquaShield Health Technology Company Limited is the warrantor in relation to this product.

Rev A AUG 23

