

PHILIPS

RO Dispenser

ADD6921



User Manual
説明書

CONTENTS

1 Important notes 1

2 Product specifications 3

3 Product overview 4

4 User interface 5

5 Product setup 6

6 Usage instructions 10

7 Daily maintenance 13

8 Troubleshooting 19

9 Packing list 21

10 Guarantee and support 21

1 Important notes

Noted: All contents of this part relate to safety. The dangers, harmfulness, and potential accidents are explained herein. All users must strictly follow the instructions.

- Misuse may cause injury.
- The heating element surface is subject to residual heat after use.
- This appliance is intended for household and indoor use only.
- Do not immerse the appliance in any liquid.
- Do not use accessories which are not authorised by the manufacturer. The warranty will terminate automatically if machine failure is caused by unauthorised accessories.
- Please check for machine damages and verify all parts are included after unpacking.
- Keep the plastic bag or film away from babies and children to avoid suffocation.
- Use municipal tap water as the water source.
- Please do not pour unknown liquids, water from sources of unknown quality or other extraneous materials of any sort into the tap water tank and filtered water jug.
- Please handle the machine with care to avoid injury or damages resulting from dropping the appliance.
- This appliance is not intended for use by persons (including children) with reduced physical, sensory or mental capabilities, or lack of experience and knowledge, unless they have been given supervision or instruction concerning use of the appliances by a person responsible for their safety.
- This appliance can be used by children aged from 8 years and above and persons with reduced physical, sensory or mental capacities or lack of experience and knowledge if they have been given supervision or instruction concerning use of the appliance in a safe way and understand the hazards involved.
- Children shall not play with the appliance and user maintenance shall not be made by children without supervision.
- Place the machine in a cool and dry place, away from direct sunlight. Do not place it near any form of heat sources.
- The machine shall not be placed in an environment that may have inflammable gas leakage.
- To avoid electric shock, do not touch the power plug with wet hands.
- To avoid damage, do not disassemble or modify the machine, or put any heavy objects on it.
- If the dispenser will not be used for a long time, please make sure it is disconnected from the power supply, and empty the tap water tank, filtered water jug, and cold water tank. Seal the the

filter cartridge and store it in the refrigerator (2-5°C, do not put it in the freezer).

- The inlet water temperature should be 5°C-38°C. If the temperature is higher than 38°C, the filter cartridge will be damaged and be unable to work. If the temperature is lower than 5°C, the dispenser might be frozen and the elements of the dispenser will be damaged.
- The dispenser can only be installed and used indoors, and with power supply of reliable grounding.
- For first time use, or if the machine hasn't been used for a long time, fill the tap water tank and discard all the filtered water. Details can refer to the Rinising procedure (Chapter 5 - Product set up).
- Always use certified elements and accessories from Philips authorized services for the repairment and maintenance of the dispenser.
- Organic solvent such as gasoline shall not be used for wiping the housing of the dispenser. If cleaning is required, please gently wipe the surface of the product with a wet cloth after it is disconnected from power supply.
- If there is any abnormality, unplug the product from power supply immediately, and do not leave the defective dispenser in working mode.
- With upgrade of the product, certain words or pictures on the manual may be different from the actual product, and the actual product shall govern in this case.
- If the user intends to extract ambient water or water of 45°C immediately after extracting hot water, some hot water may come out at the beginning, if so please watch out to avoid being burnt by the hot water. It is recommended to extract ambient water for 10 seconds to cool down the heating element.
- It is recommended to discard the filtered water if the machine hasn't been used for over 24 hours.
- If the power cord appears to be damaged, please stop using the product. To avoid risks of danger, the power cord must be replaced by personnels authorised by the manufacturer.
- Do not disassemble or repair the dispenser by yourself, nor hand it over to any person not authorized to repair, as improper repairing may cause risks of danger.
- The manufacturer will not bear responsibility for any consequences that are results of failure to operate the appliance in accordance with the above guidelines.

2 Product specifications

Product name	Philips RO Water Dispenser
Product model	ADD6921
Rated voltage	220V-240V~
Rated total power	2100W-2400W
Rated frequency	50Hz-60Hz
Heating capacity	20L/h, $\geq 90^{\circ}\text{C}$
Cooling capacity	$\geq 2.7\text{L/h}$ ($\leq 10^{\circ}\text{C}$)
Cooling current	0.6A
Refrigerant and filling amount	R600a, 18g
Filter cartridge total filtration capacity	2000L
Rated water flow rate	0.2L/min
Applicable water source	Municipal tap water
Inlet water pressure	0 - 0.06MPa
Applicable water temperature	5-38 $^{\circ}\text{C}$

3 Product overview

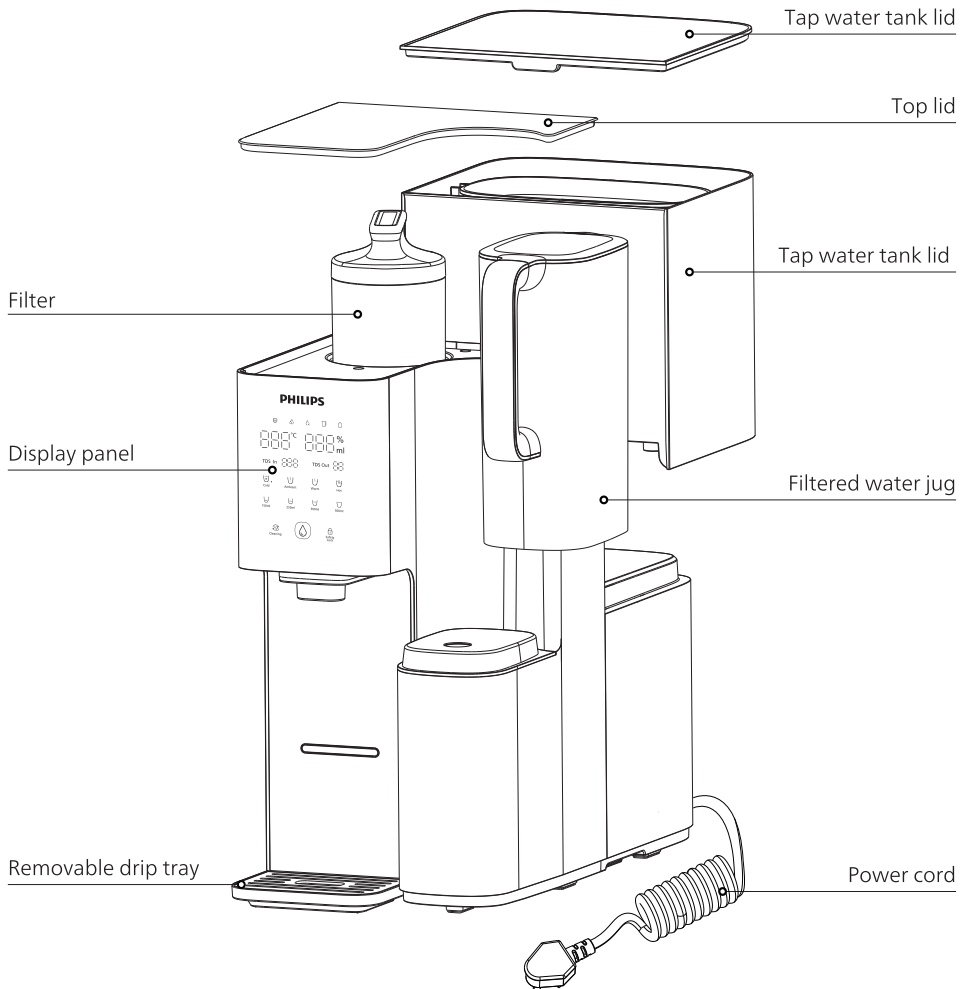

4 User interface

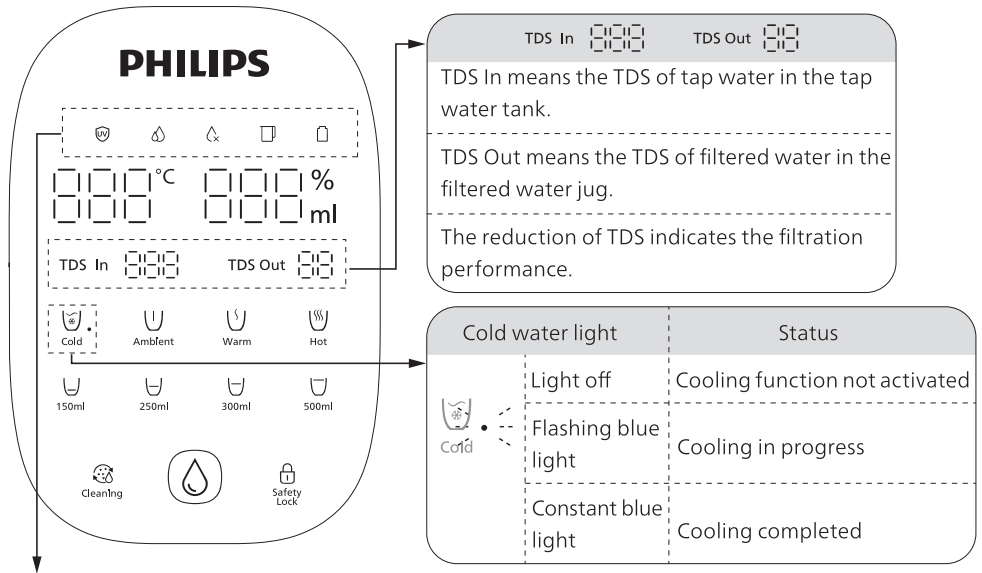

Icon	Status	Meaning
	Constant white light	UV sterilization in progress.
	Constant white light	Filtration process is ongoing, you can still extract water.
	Flashing white light	Filtration process is ongoing, the water level in the filtered water jug is insufficient for extraction.
	Flashing white light	The tap water in the tap water tank has not been replaced for a long time.
	Flashing red light	The tap water in the tap water tank is at a low level or the water quality is poor, please empty the remaining water in the tank and refill it with fresh tap water.
		*When "Water tap" indicator of changing water flashes, the water in the tap water tank needs to be changed. Please discarding the drain water before adding fresh tap water into the tap water tank.
	Constant white light	Filtered water jug is in place.
	Flashing white light	Filtered water jug is not in place. Please put it back.
	White light on	More than 10% of the filter cartridge's lifetime remaining.
	Flashing red light	Less than 10% of the filter cartridge's lifetime left. Please replace the filter soon.
	Red light on	Less than 7 days of the filter cartridge's lifetime remaining. Please replace the filter as soon as possible.

5 Product setup

Setup guide

- (1) The dispenser should be 20cm from the wall. This will help to optimize the cooling performance.

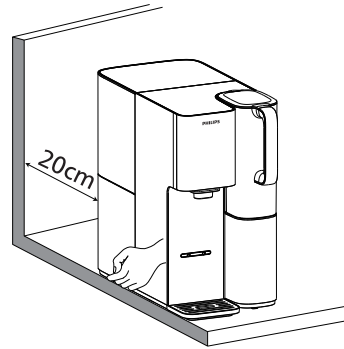

- (2) If a small cup is used, the removable drip tray can be adjusted to a higher position by pulling it out and putting it at the higher position.

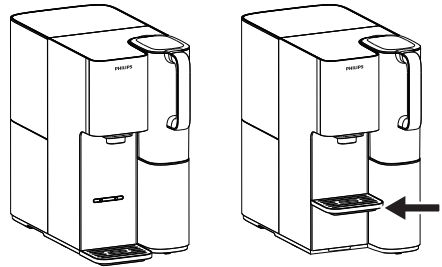

Please let the product stand in an upright position, for at least 2 hours, before activating the cooling function.

This product has a built-in compression cooling system. Please let the product stand plugged, in an upright position, for at least 2 hours before activating the cooling function.

Rinsing (Takes approximately 1.5 hours or more)

❗ For optimal performance, it is recommended to follow these steps of membrane rinsing for the new dispenser before its initial use or after replacing the filter. This process typically takes approximately 1.5 hours.

To prevent the growth of microorganisms, place the product in a location that avoids direct sunlight.

(1) Remove the tap water tank lid and lift the tank upwards; fill the tap water tank with tap water and place it back to the machine, then place the lid back to the tap water tank properly.

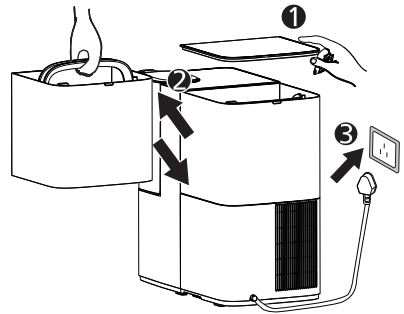

❗ Please make sure the tap water tank is fully attached to the back panel, otherwise, it will cause improper water filtration or water leakage.

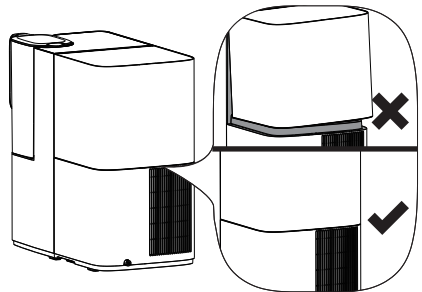

(2) After installing the filtered water jug, long press the "🧼" button for 5 seconds. When you hear a "beep" sound, it indicates that the machine is working.

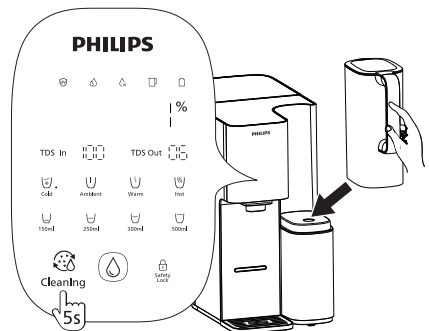

! Please make sure the filtered water jug is fully attached to the pedestal, otherwise, it will cause improper water filtration or water leakage.

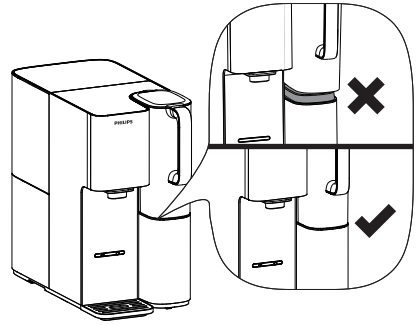

(3) During the progress from 0% to 80%, when you see the percentage flash and hear 3 beeps, please empty the filtered water jug.

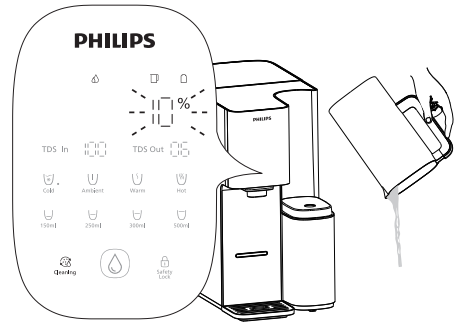

(4) When the "⚠️" light flashes, you will hear 3 beeps. Empty the water in the tap water tank, refill it with fresh tap water up to the Max line, and place it back.

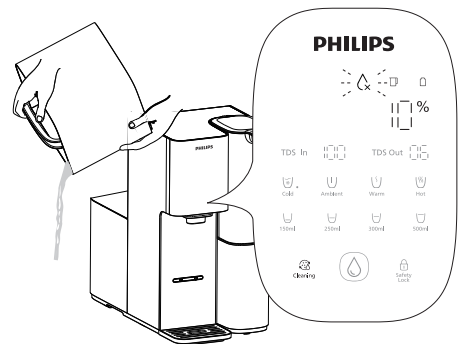

(5) When the progress reaches "90%", and "💧" flashes, you will hear 3 beeps. There is no need to empty filtered water jug. Place a container with a volume of no less than 2 liters under the water outlet and press "💧".

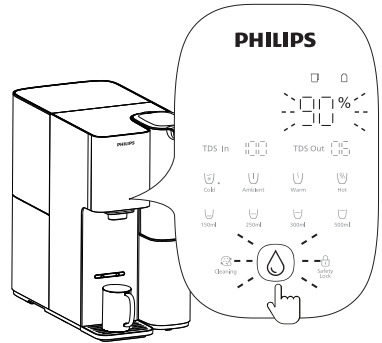

(6) When it shows "100%", it means that the rinsing process is complete. You can now start using the dispenser.

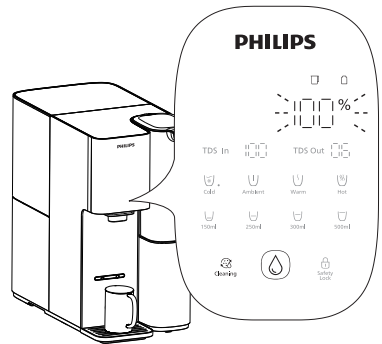

Important notes for flushing:

- During the rinsing process, you can exit the rinsing program by long-pressing the "🔄" button for 5 seconds (not recommended). However, in order to ensure a better water taste, we do not suggest exiting the rinsing program. If you cannot wait, it is important to note that when the progress reaches 50%, the filtered water is also safe to drink.
- During the water dispensing process from 90% to 100%, it is normal to hear a sucking sound. Please do not worry.
- During the first-time use, please check for any water leaks from or gathering around the dispenser. If you notice any strange noise, burnt smell, or smoke coming out from the machine, disconnect the cord immediately. In such cases, please contact customer services for further assistance.
- During the rinsing process, when air passes through high-precision filter elements, micro bubbles are generated, causing the water in the filtered water jug appears white and cloudy. This is a normal phenomenon.

Boiling point calibration

To prevent excess steam, the local boiling point should be checked and adjusted.

When the filtration process is complete and 100°C water is extracted for the first time, boiled water will flow out from the nozzle, and the boiling point calibration will be automatically completed. This procedure will last for approximately 60 seconds. Please ensure that a container with a volume of at least 500ml is placed under the nozzle during this procedure.

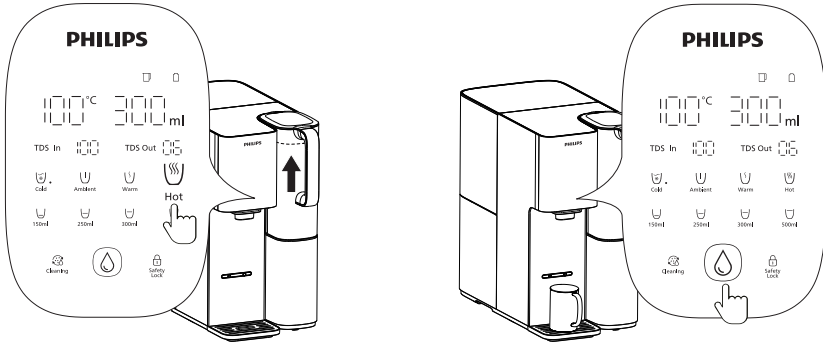

Note: There might be steam ejection during the boiling point calibration, please be aware of burn hazards.

6 Usage instructions

Turn on the cooling function

After being plugged in for two hours, long-press the "Cold" button for 5 seconds until the cold water light flashes. This indicates that the cooling function has been activated.

Cooling Status	Meaning
Flashing	Cooling in progress
Constant blue light	Cooling completed

When the cooling light is flashing, it is not recommended to extract water in order to avoid affecting the cooling speed. It is advisable to wait for 20 minutes for the cooling process to complete after it is turned on for the first time.

Turn off the cooling function

(After turning off the cooling function, it is necessary to empty the cooling tank.

Please follow the following steps to prevent bacteria growth inside the cooling tank.)

- (1) Please place a container with a volume of no less than 2 liters under the water outlet.

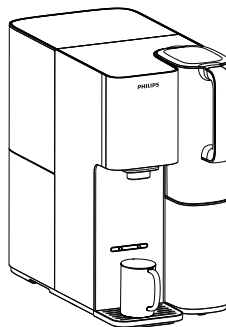

- (2) Long press "Cold" for 5 seconds until the "Water" light flashes, then press "Water" to extract water until the inner pipes and cooling tank are empty.

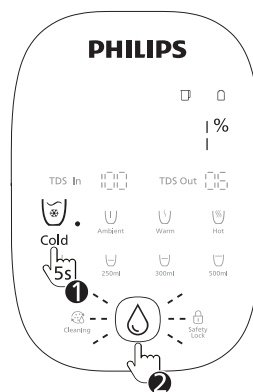

- (3) This procedure will last for about 60 seconds.
When the progress reaches 100%, the draining process has been completed.

- (4) The cold water light goes out and the cooling function is turned off.

- ⚠ Please do not exit or unplug the power during the draining process.
- ⚠ During the draining process, it is normal to hear a suction sound. When the progress reaches 100%, the sound will stop. Please do not worry.

Extracting water

(1) Press the "🔒" to unlock.

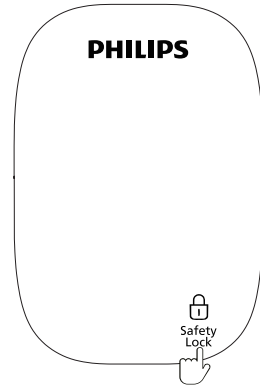

(2) Water temperature adjustment:

Press "🔪" repeatedly to choose between 45°C and 55°C;

Press "🌀" repeatedly to choose between 85°C and 100°C.

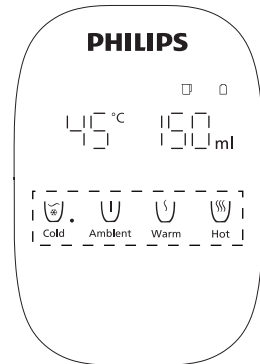

(3) Water volume adjustment:

There are four water volume presets for selection: 150ml, 250ml, 300ml, 500ml.

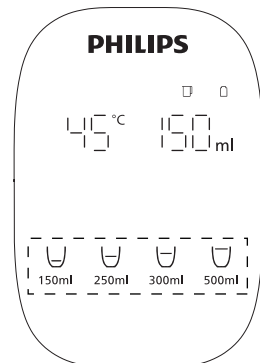

- (4) Press "🔒" and "💧" to extract hot water.
 Press it again or press any other buttons to stop.
 Ambient water can be extracted directly
 without pressing "🔒".

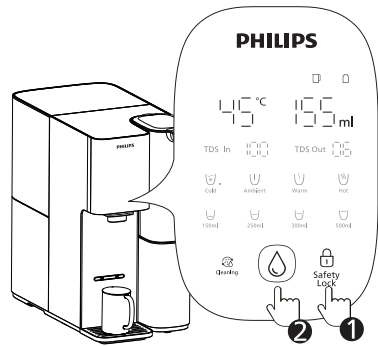

Notes:

- Press the safety lock key for 10 seconds to disable/enable the safety lock.
- Press and hold the "🌀" and "500ml" buttons for 3 seconds to disable/enable the beep sound prompt.
- To avoid being scalded, keep away from the nozzle when extracting hot water.

7 Daily maintenance

Waterway Cleaning

It is recommended to clean the waterway if the product has not been used for more than 1 week, or if it has been used continuously for 1 month.

If the dispenser will not be used for an extended period of time, please drain the appliance and disconnect the dispenser from power supply. Seal the filter cartridge and store it in the refrigerator (2-5°C, do not put it in the freezer). When you use it again, please follow the cleaning procedure for the first time use.

- (1) Fill the tap water tank with tap water. and
 Place it back to the machine, then place the lid
 back to the tap water tank properly.

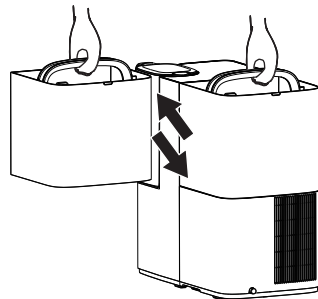

- (2) Wait until the filtered water jug is full, and the
 "💧" light disappears, otherwise this function
 cannot be activated.

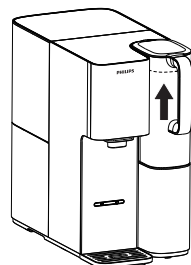

(3) The cleaning process is expected to dispense 1800ml of water. Please place a container with a volume of not less than 2000ml under the water outlet. Press the "🔄", "🔒", and "💧" buttons in sequence to start the cleaning process. During the cleaning process, ambient water and hot water at 70°C will be dispensed to flush the waterway.

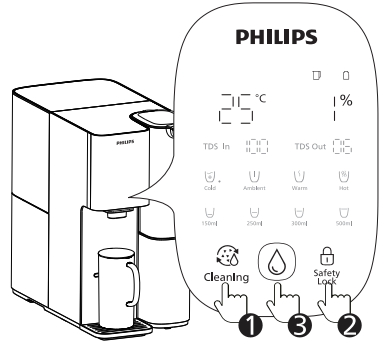

(4) During the cleaning process, press "💧" to pause. To exit the cleaning program, press "🔄".

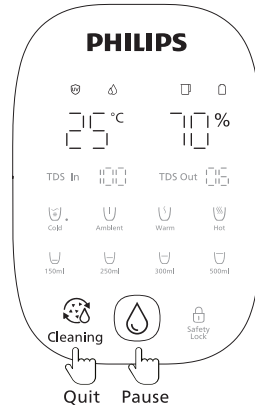

(5) When "100%" flashes, the cleaning process is completed.

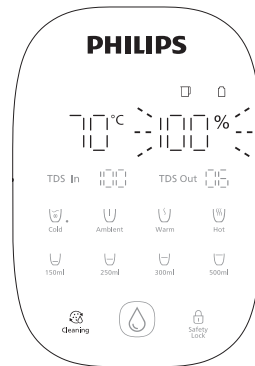

(6) To clean the water nozzle, twist it out, wash it with clean water, and then reinstall it.

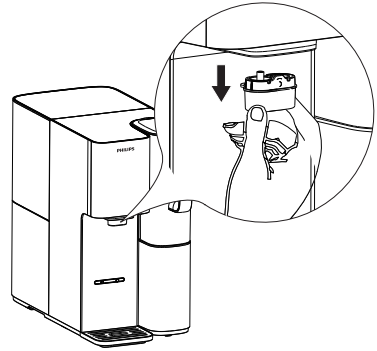

Cleaning of the tap water tank and the filtered water jug

If there are obvious impurities at the bottom of the tap water tank or filtered water jug, please rinse it with water and clean it with a cleaning brush. Clean the tap water tank and the filtered water jug with brush at least once per week.

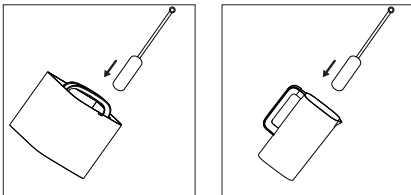

Do not put the tap water tank or the filtered water jug in the dishwasher.

Descaling of tap water tank

① Empty the tap water tank.

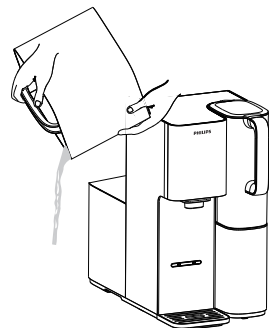

- ② Fill the tap water tank to the half and add 30g of citric acid. Stir lightly then soak for 2 hours (do not place the tap water tank back to the dispenser).

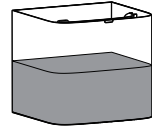

- ③ Discard the citric acid solution and clean the entire water tank with tap water.

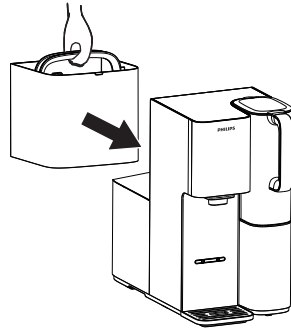

- ④ Thoroughly rinse with tap water and refill the water tank with tap water. Then, put it back into the dispenser.

Draining the cooling tank manually

- (1) Remove the filtered water jug and move the product forward.

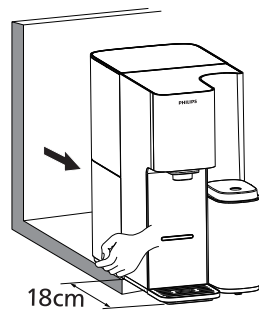

- (2) Locate the "cooling tank drainage hole" at the bottom. It is secured with a silicone plug.

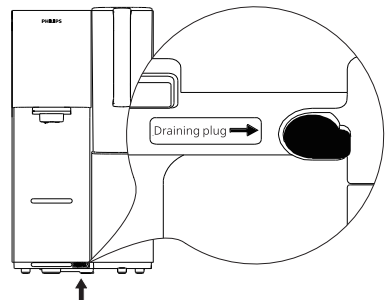

(3) A container with a volume no less than 2 liters should be placed under the draining hole and remove the blue silicone plug to drain the cooling tank manually. Wait until there is no more water flowing out, re-insert the silicone plug tightly.

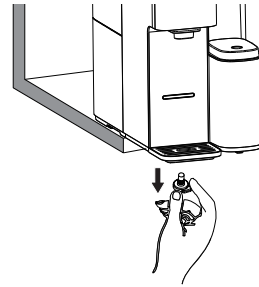

Cleaning the air filter (It is recommended to clean the air filter every six months to maintain the cooling performance.)

(1) Pull out the air filter from the bottom right of the product.

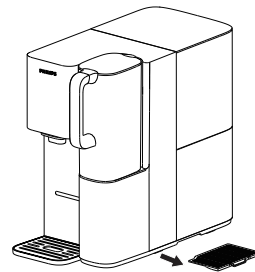

(2) Clean the air filter with clean water, wipe it dry, and reinstall it.

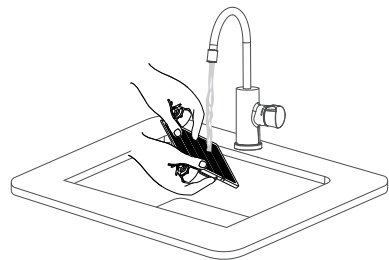

Filter replacement

Please change the filter cartridge according to the filter lifetime indicator "  " on the display panel, or the suggested replacement cycle. New filter cartridge can be purchased from authorized retailers and service center, the model is ADD583.

Name	Model	Suggested Replacement Cycle
Aquaporin All-in-One Mineral RO Filter	ADD583	1 year

 Only the original Philips filter cartridge can be used for replacement.

(1) Power off and take out the tap water tank and the machine top lid.

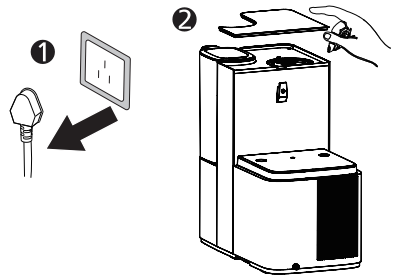

(2) Rotate the used filtered cartridge counter clockwise to the "  " position and take it out.

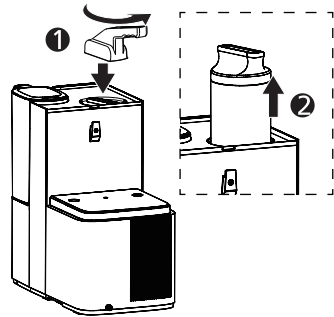

(3) Insert the new filter cartridge into the filter cartridge holder and rotate it clockwise to the locked "  " position, and cover the machine top lid. Put the tap water tank back to the dispenser.

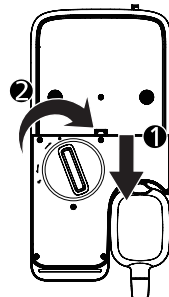

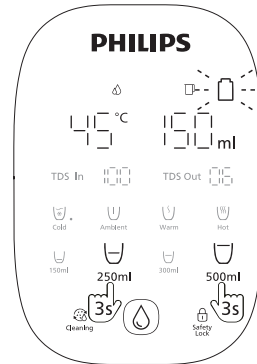

(4) Long press "250ml" and "500ml" for 3 seconds.
 The " " changes to white again, which means you have reset the lifetime successfully.
 If you want to cancel the reset, long press "250ml"+"500ml" for 3 seconds within 2 hours.



(If you need to cancel the reset, press and hold "150ml" + "250ml" for 3 seconds within 2 hours.)

8 Troubleshooting

Error	Causes	Solutions
E01: Cannot extract hot water.	Tap water temperature exceeds 38°C.	Make sure the tap water temperature does not exceed 38°C.
E02: Cannot extract hot water.	Abnormal alarm from the water outlet temperature probe.	When the filtration is completed, extract 300ml of ambient water, and try extracting the hot water again. Please contact customer services if the problem cannot be solved.
E04: Unable to dispense hot water.	Abnormal heating alarm.	Take 3 cups of 150ml of ambient temperature water first, and then try again to dispense hot water.
E06: The product is unable to filter and dispense water normally.	"Abnormal water filtration alarm. Filter not installed properly or clogged."	Check if the filter is installed properly or clogged. If the filter is clogged, please replace it.
E0b: Unable to cool the water	If the machine is not dispensing ice water, or the cooling time exceeds 1 hour in a single cycle, the machine will activate its cooling protection and stop cooling.	Turn off the power for 1-2 minutes, and reconnect with power.
E0L: Unable to dispenser cold water	Cooling tank temperature sensor abnormal alarm	Turn off the power for 1-2 minutes, and reconnect with power.

EU: Communication abnormality of the product	Abnormal communication signal within the product's electronic control board.	Turn off the power for 1-2 minutes, and then reconnect the power.
Unable to dispense water	Filtered water jug is out of water.	If "  " is flashing, wait for it to stop flashing before dispensing water normally.
	Tap water tank is not installed properly	Check if the tap water tank is installed properly.
Cannot filter water	Tap water tank is at a low water level, and "  " flashes red.	Empty the water in the tap water tank completely, and then refill it with tap water.
	Tap water tank is not installed properly	Check if the raw water tank is installed properly.
Water leakage	Water overflows from the water drip tray.	Empty the water drip tray.
	The sealing valve at the bottom of the tap water tank is blocked.	Hold the sealing valve with a thimble or a finger to remove the blockage.
	Filtered water jug not installed properly.	Ensure that the filtered water jug or the tap water tank is installed properly.
Odd taste of the water	The new dispenser hasn't been cleaned.	Follow the cleaning procedures for the first time use.
	Filtered cartridge is not changed as required.	Change the filter cartridge.
Leakage of electricity	Bad grounding and the power cord is damaged	Three-core plug with reliable grounding must be used. Please contact customer services.
Buttons/display screen does not respond	System malfunction or hardware damage	Turn off the power for 1-2 minutes, and then reconnect the power.

9 Packing list

Dispenser (with 1 filter inside)	x1
Removable water drip tray	x1
User manual	x1
Filtered water jug	x2
Quick start guide	x1
Filter replacement guide	x1

10 Guarantee and support

If you need information or have any questions, please visit www.philips.com/support or contact the consumer service center in your country/region. If there is no consumer service center in your country/region, please contact your local distributor.

Within two years from the date of purchase, you will receive free warranty service for any damage caused by manufacturing process problems, or any damage to components under normal use conditions confirmed by our maintenance service personnel.

Warranty service excludes frequently replaced consumables, auxiliary equipment, shipping costs and door-to-door service. Please show proof of purchase to service personnel when servicing.

Please keep this user manual for future reference.

目錄

1	重要事項	23	7	清潔與保養	34
2	主要技術參數	24	8	故障診斷	40
3	結構示意圖	25	9	裝箱清單	41
4	操作與顯示介面	26	10	產品售後服務指南	41
5	首次使用指南	27			
6	使用說明	31			

1 重要事項

注意：本項目所有內容均與安全有關，當中解釋了相關風險、危害程度及可能發生的事故。為了能正確地使用本機器，請用戶務必遵守。

- 請勿使用未經廠商許可的其他配件，若因此造成機器故障，保修將自動終止；
- 請在拆除包裝後檢查機器是否有損傷，核對配件是否齊全；
- 為了避免窒息的危險，請將塑膠袋遠離嬰兒和兒童；
- 本機器進水水質為市政自來水；
- 禁止往原水箱及純淨水壺倒入不明液體、不明水質的水源或其它異物；
- 請勿向純淨水壺內加水，避免超過機器自身設定的最高水位後，從出水口不斷流出等異常情況；
- 請注意輕拿輕放，以免機器跌落造成砸傷；
- 機器應放在兒童及寵物無法觸及的地方；
- 兒童及無行為能力人請在監護人監督下使用本機器；
- 本機器應放置於室內陰涼乾燥的地方，避免陽光直射，擺放位置不得靠近暖氣設備、電熱產品或其他高溫場所；
- 機器擺放位置不得處於會出現或有可能出現可燃性氣體洩露的場所；
- 切勿用濕手插拔電源插頭，以免引發觸電危險；
- 切勿自行拆卸、改裝機器或在機器上放置重物，以免造成損壞；
- 長期不使用機器，務必斷開電源，排空原水箱和純淨水壺內的水；
- 本機器進水溫度要求5-38°C，如進水溫度超過38°C時，會損壞濾芯，使濾芯失效；進水溫度低於5°C時，可能造成冰凍，引起機器元件破裂；
- 本機器僅適用於室內安裝與使用，必須使用有可靠接地的三芯插座；
- 初次使用或長期停用後，建議先執行自動清潔程序；
- 本機器的維護保養、更換濾芯，需使用飛利浦所認可的更換部件；
- 嚴禁使用汽油等有機溶劑擦拭本機外殼，確需清潔時，斷電後用濕抹布輕擦產品；
- 倘若發生故障，應立即拔掉電源插頭，切勿將有缺陷的機器置於工作狀態；
- 隨著產品升級，說明書某些文字或圖案可能與實物有所不同，請以產品實物為準；
- 如果先取熱水後馬上取常溫水或暖水，機器會先出一段殘留熱水，請注意防止燙傷，建議先放常溫水10秒以冷卻加熱體；
- 機器閒置超過24小時建議倒掉純淨水壺內的水；
- 如果電源軟線損壞，請停止使用機器，為了避免危險，必須由製造商授權的專業人員更換；
- 請勿擅自拆解維修本機器或交由非飛利浦授權的售後人員維修，因不當的維修可能造成危險；
- 未按上述注意事項操作所造成的後果，本公司將不承擔任何責任。

2 主要技術參數

產品名稱	飛利浦RO純淨飲水機
產品型號	ADD6921
額定電壓	220V-240V~
額定頻率	50Hz-60Hz
額定總功率	2100W-2400W
製冷水能力	≥2.7L/h(≤10°C)
製冷電流	0.6A
製冷劑及裝入量	R600a, 18g
濾芯額定總淨水量	2000L
額定淨水流量	0.2L/min
適用水源	市政自來水
進水壓力	0 - 0.06MPa
適用水溫	5-38°C

3 結構示意圖

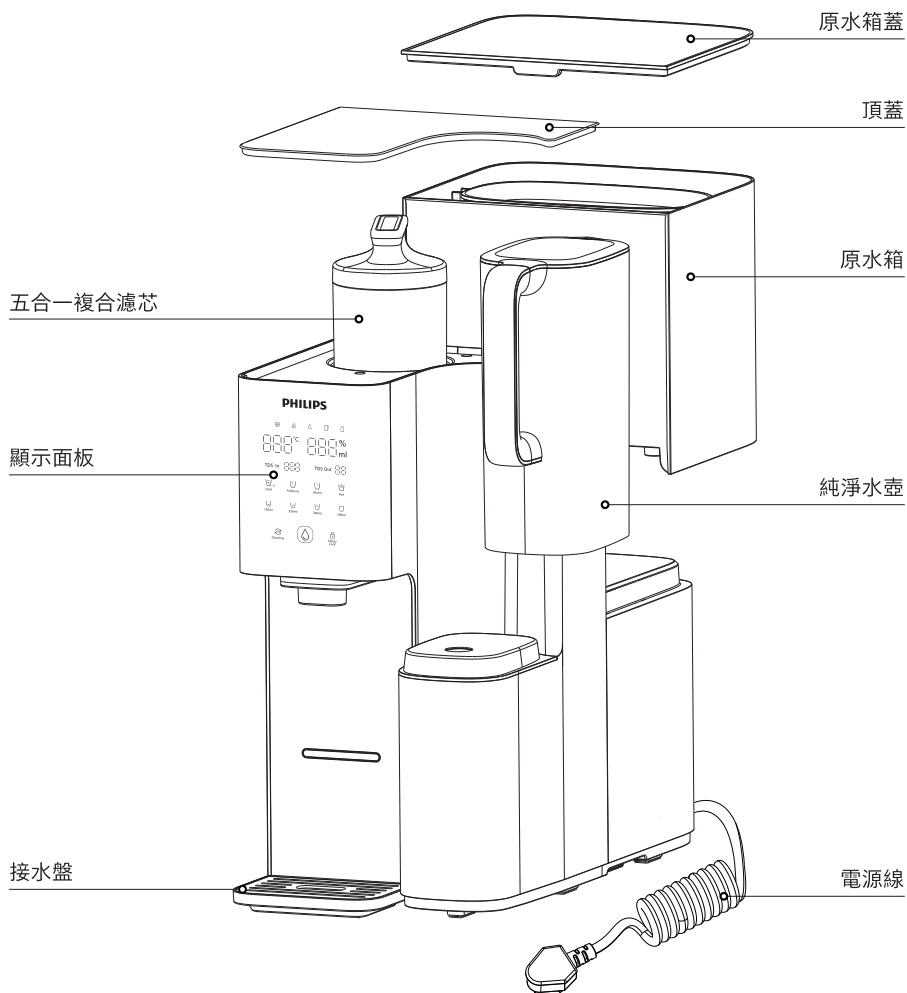

4 操作與顯示介面

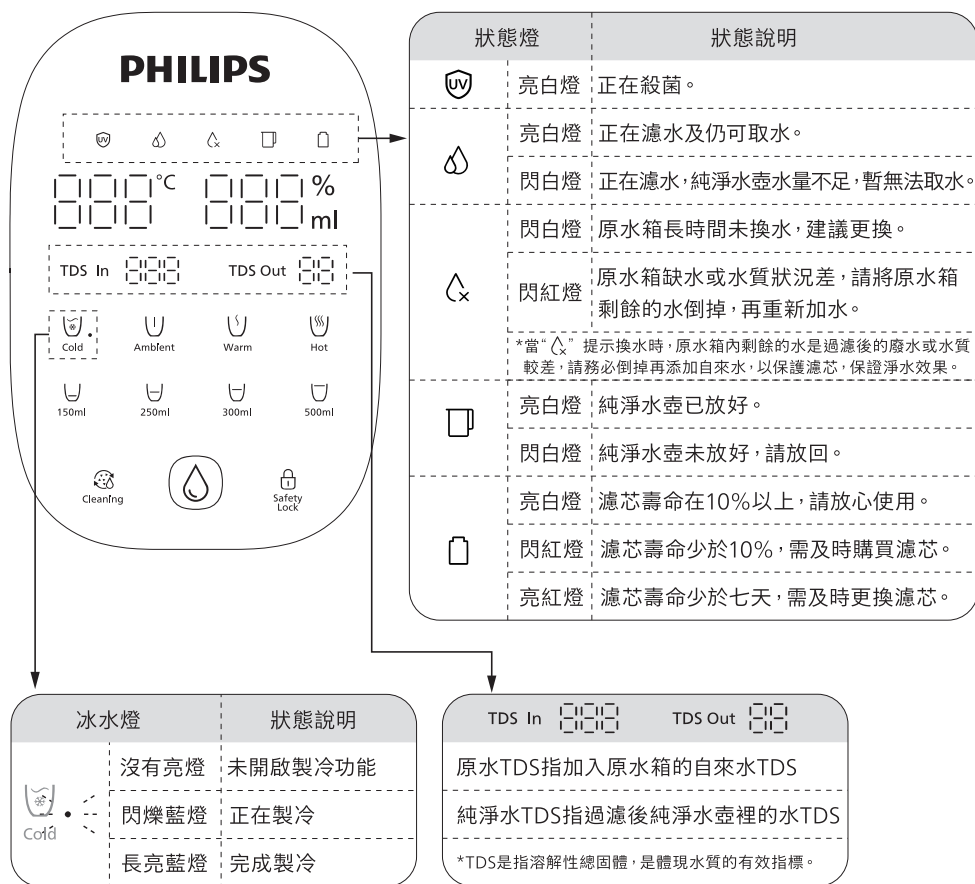

5 首次使用指南

安裝擺放指引

- (1) 產品背部距離牆面建議預留20cm的散熱空間，以免影響壓縮機製冷效率和壽命。

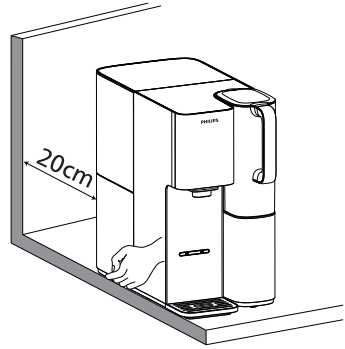

- (2) 接水盤可調節高度，根據杯子大小選擇接水盤高度。

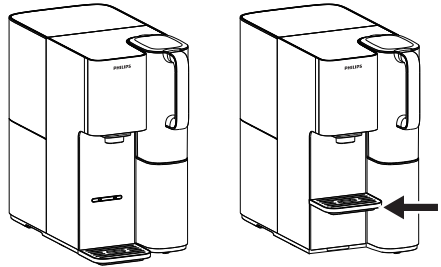

請靜置2小時，然後再啟用製冷功能。

因產品內含壓縮機製冷系統，受運輸顛簸影響，如未靜置易導致產品損壞。

使用前請先完成首次沖洗，以保證更佳飲用體驗。

沖洗指引

新機首次使用或更換濾芯後，按以下步驟沖洗，沖洗過程耗時約1.5小時。
產品安放位置需避免陽光直射，以防微生物滋生。

- (1) 揭開原水箱蓋，接水至Max線，接通電源。

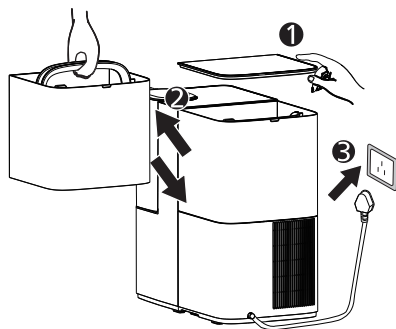

- ❗ 請確保水箱與背板完全貼合，否則會導致無法正常濾水或水箱漏水。

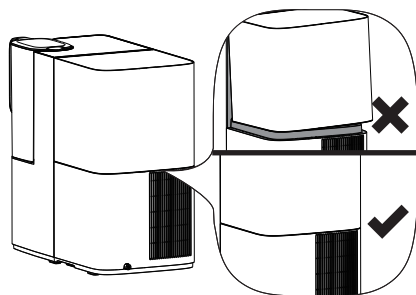

- (2) 安裝好純淨水壺，長按“清潔”鍵5秒，聽到“滴”提示音，開始進入沖洗。

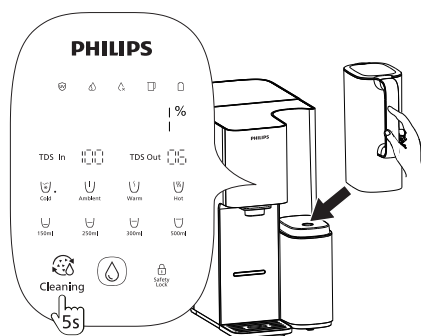

❗ 請確保純淨水壺與底部完全貼合，否則會導致無法正常濾水或純淨水壺漏水。

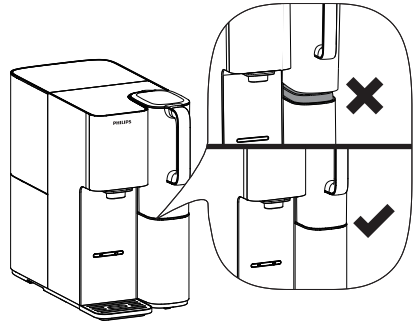

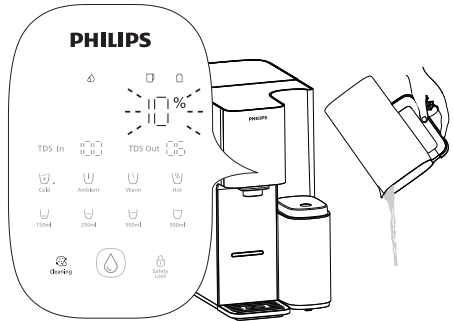

(3) 在0 - 80%的進度中，每當進度增加10%，進度%閃爍，產品發出“滴滴滴”的提示音，將純淨水壺的水倒掉再放回。(共需倒掉8壺純淨水)。

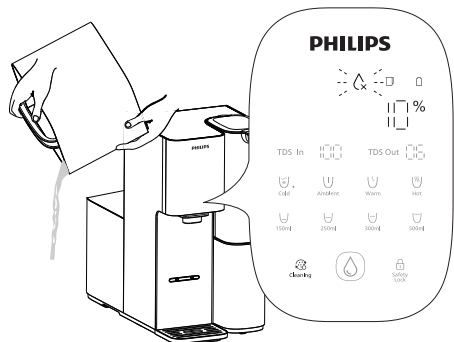

(4) 當“”閃爍，產品發出“滴滴滴”的提示音，閃爍時，將原水箱的水倒掉，重新加入自來水至“Max”線再放回。



(5) 當進度到“90%”，“”閃爍，產品發出“嘀嗒嗒”的提示音，無需倒水，在出水口放置一個2公升以上的容器，按“”。

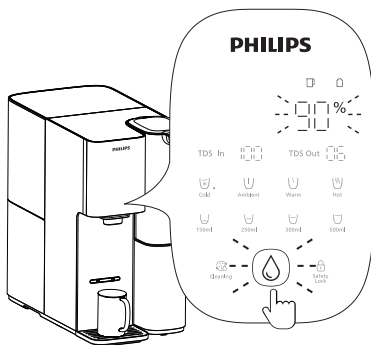

(6) 螢幕顯示100%代表沖洗完成，可開始正常使用。

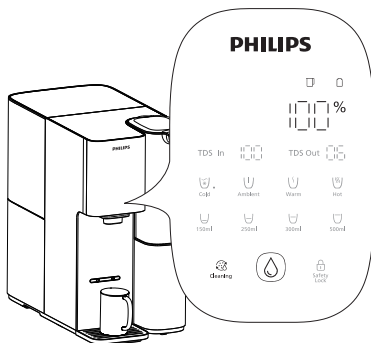

沖洗須知：

- 沖洗過程中，再次長按清潔鍵5秒可退出沖洗程式（不建議退出，為了給消費者提供更好的口感，我們建議沖洗到100%。如無法等待，可在進度到50%時退出，之後再濾出的水也可飲用。
- 90%-100%出水過程中，如出現空抽聲響為正常現象，請勿擔心。
- 觀察產品是否有水滲出或積水，或發現異響、焦糊味、冒煙等，如有上述情況，請斷開電源連接並與售後人員聯繫。
- 在沖洗過程中，水箱水壺出現白色渾濁為空氣經過高精度濾芯產生的微氣泡導致，若出現黑色雜質為濾芯活性炭殘留，均為正常現象。

沸點調節

- (1) 首次使用，待純淨水壺注入適量的純淨水，水溫選擇“”。

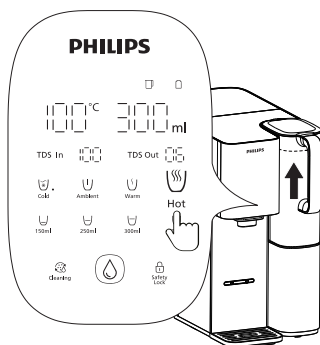

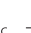
- (2) 出水口放置一個大容量容器(2公升以上)，按“”。產品將出沸騰開水約1分鐘，停止出水後沸點調節完畢。

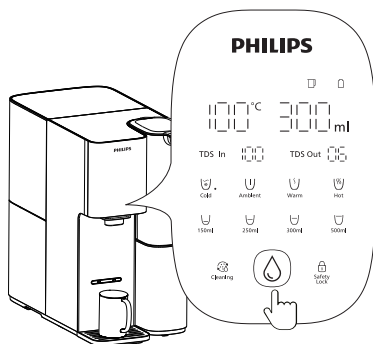



注意：沸點自調節過程可能出現水汽噴射，請注意保持距離避免燙傷。

6 使用說明

使用製冷功能

通電靜置兩小時後，長按“”5秒至冰水燈閃爍，製冷功能成功開啟。

冰水燈	狀態說明
	不亮變閃爍
	閃爍變為長亮
	開始製冷
	完成製冷

冰水燈閃爍時不建議取冰水，以免影響製冷速度。首次開啟製冷預計需等待20分鐘。

關閉製冷功能

(關閉製冷後產品需要排空冰水箱內的冰水，請務必按照以下步驟完成排空，以免冰水箱內部殘水滋生細菌。)

(1) 在出水口放置一個大容量容器(2公升以上)。

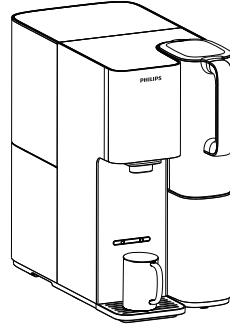

(2) 長按“Cold”5秒至“Water”閃爍，按“Water”，開始排空冰水箱(可通過按“Water”暫停)。

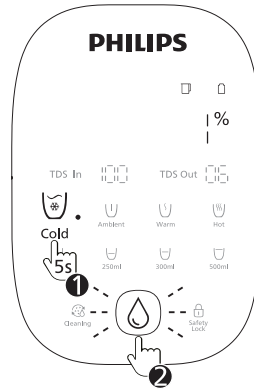

(3) 排空時間約為60秒。
待進度到100%，說明排空完成。

(4) 冰水燈熄滅，製冷功能關閉。

- ❗ 排空期間請勿退出或拔掉電源。
- ❗ 排空期間，空抽聲響為正常運作，當進度完成至100%時空抽將停止，請勿擔心。

日常取水操作

(1) 點擊童鎖喚醒螢幕。

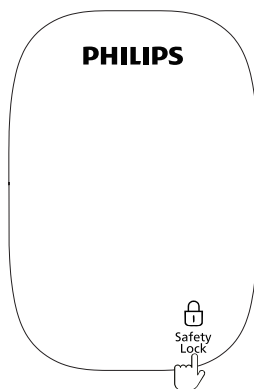

(2) 選擇溫度：

連續按“溫水”，可選45° C或55° C；

連續按“熱水”，可選85° C或100° C。

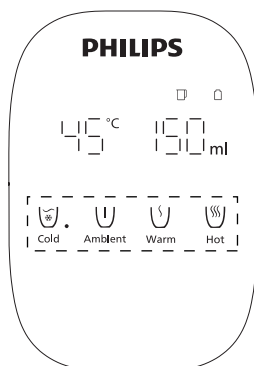

(3) 選擇出水量。

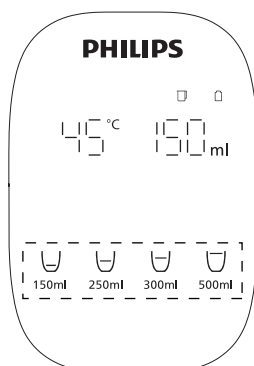

(4) 依次按“童鎖”，“”。出水過程中再次按“”，即可停止出水。

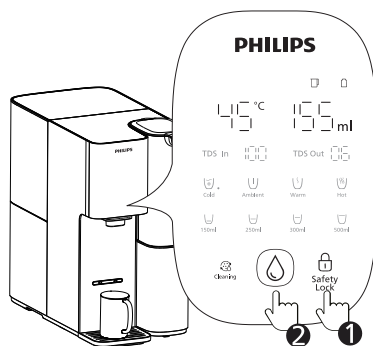

更多操作選擇：

- 取消/啟用童鎖：長按“童鎖”5秒。
- 取消/啟用按鍵提示音“滴”：長按“”+“500ml”3秒。

7 清潔與保養

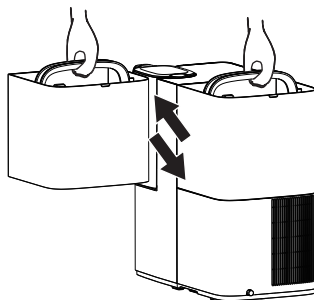

水路清潔 (超過1周末使用，或連續使用1個月，建議進行水路清潔)

(1) 原水箱裝滿水。



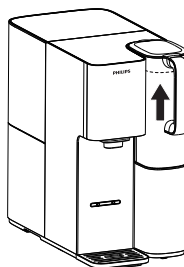

(2) 待水壺濾滿水(即“”燈熄滅)，否則無法使用此功能。

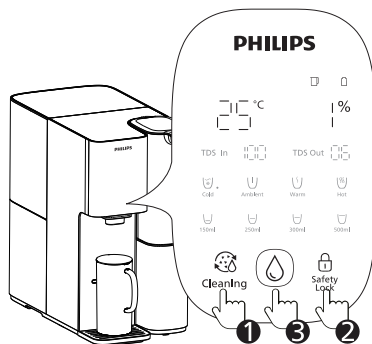

- (3) 清潔過程預計出水1800ml，建議在出水口處放置一個大容量容器(2公升)，依次按“”-“”，啟動清潔程序。

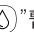

- (4) 清潔過程，按“”暫停。
(如需退出清潔程序，按“”)



- (5) 當“100%”閃爍，代表清潔完成。

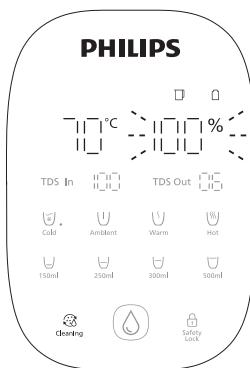

(6) 水嘴清潔：向下拔出水嘴，用清水洗淨後裝回。

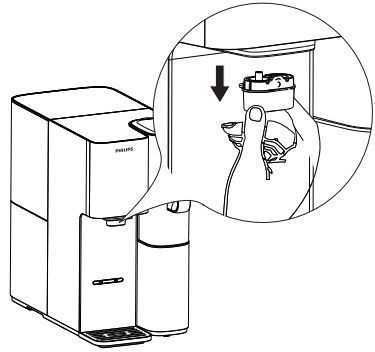

原水箱及純淨水壺清洗

(1) 當原水箱或純淨水壺有明顯污垢時，配合清潔工具進行水洗。

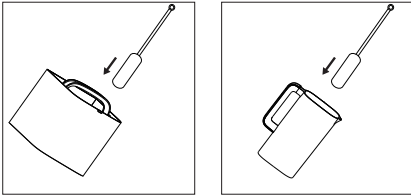

(2) 原水箱除垢。

① 將原水箱剩餘的水倒掉。

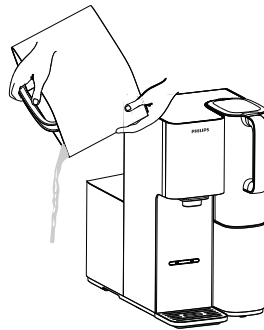

② 加入3公升(約半箱) 市政自來水，再加入檸檬酸除垢劑30g，攪拌溶解後放置2小時，切勿把原水箱放回機器。

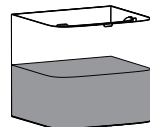

- ③ 用清水清洗乾淨原水箱，再重新加入自來水裝好，放回機器上。

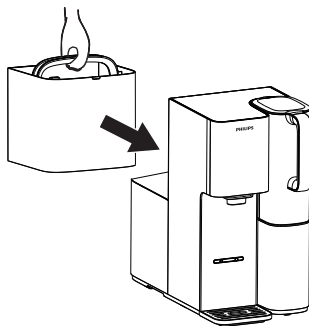

手動排空冰水箱與散熱網清潔

手動排空冰水箱

- (1) 拿出純淨水壺，將產品往前移出約18cm。

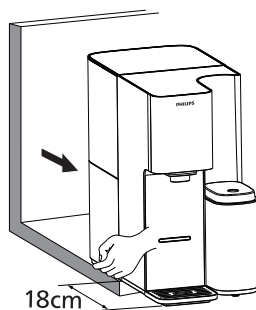

- (2) 找到底部插著矽膠塞的“冰水箱排水孔”。

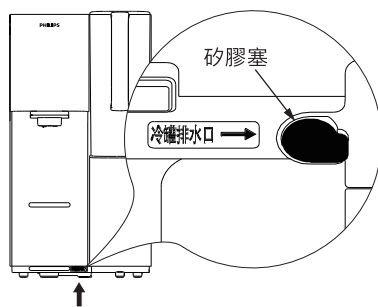

- (3) 排水孔下方放置一個大容量容器(2公升以上)，拔出矽膠塞排空。待再無水流後，請確保矽膠塞回塞緊。

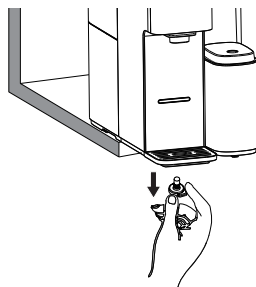

防塵網清潔

建議在製冷時間變長，製冷噪音變大，或使用超過半年後，定期作清潔

(1) 從產品右側底部抽出防塵網。

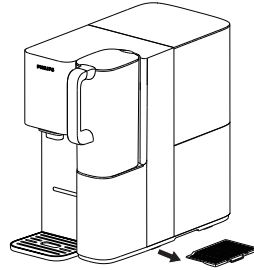

(2) 用清水清洗防塵網，擦乾，再重新裝回。

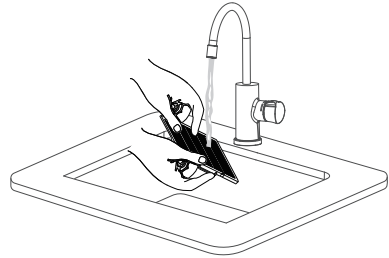

濾芯更換

請根據顯示幕濾芯壽命提示或建議更換週期更換濾芯。新的濾芯可從飛利浦經銷商處或經授權的飛利浦服務中心購得，其供應型號為：ADD583。

名稱	型號	建議更換周期
Aquaporin RO複合濾芯	ADD583	一年

❗ 僅可使用原裝飛利浦濾芯進行更換。

(1) 拔出電源，取出原水箱後取出頂蓋。

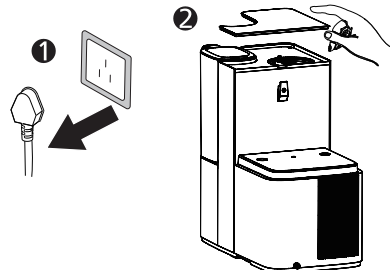

- (2) 使用濾芯扳手，將已到壽命的濾芯逆時針旋轉至開鎖“☐”位置並提出。

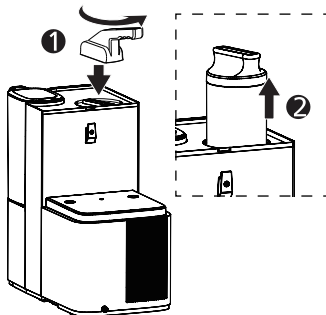

- (3) 將新的濾芯放入濾芯座並順時針旋入至鎖上“☐”位置，蓋上頂蓋，裝好原水箱。

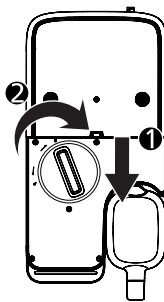

- (4) 長按“250ml”和“500ml”3秒，“☐”閃爍，由紅燈轉為白燈，說明重設成功。

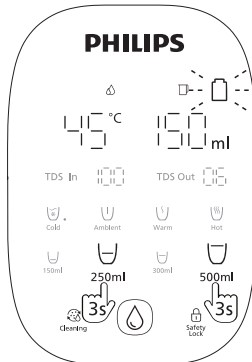

(如需撤銷重設，請在2小時內長按“150ml”+“250ml”3秒)

- (5) 濾芯更換完成後請按照沖洗程序進行濾芯沖洗，完成沖洗後即可正常使用產品。

如超過一周不使用機器，請提前倒掉原水箱和純淨水壺的水，排空冷水箱，斷開電源。同時，將濾芯密封好，放入冰箱保鮮室保存（攝氏2-5度），切勿放入冰格。再次使用時，遵照沖洗程序進行沖洗。

8 故障診斷

異常現象	潛在原因排查	解決方法
E01故障代碼 無法取熱水	原水箱溫度探頭故障報警，或者加入了超過38° C的原水	確保原水箱加入的自來水低於38° C
E02故障代碼 無法取熱水	出水溫度探頭異常報警	先取3杯150ml常溫水，再次嘗試是否可正常取熱水
E04故障代碼 無法取熱水	加熱異常報警	先取3杯150ml常溫水，再次嘗試是否可正常取熱水
E06故障代碼 產品無法正常濾水和取水	濾水異常警報 濾芯未安裝到位或堵塞	檢查濾芯是否安裝到位或堵塞，若濾芯堵塞請更換濾芯
E0b故障代碼 無法製冷	在不取冰水的情況下，單次製冷時間超過1小時，機器製冷保護，停止製冷	關閉電源1-2分鐘，再重新連接電源
E0L故障代碼 無法取冷水	冷罐溫度探頭異常報警	關閉電源1-2分鐘，再重新連接電源
E0U故障代碼 產品通訊異常	通訊異常報警 產品電控板內部通訊信號出現異常	關閉電源1-2分鐘，再重新連接電源
無法取水	純淨水壺缺水	若“  ”正在閃爍，待“  ”不再閃爍，即可正常取水
	原水箱未安裝到位	檢查原水箱是否安裝到位
無故障代碼 但產品不濾水	原水箱處於低水位，“  ”閃爍紅色	倒掉原水箱的水，再重新添加自來水
	原水箱未安裝到位	檢查原水箱是否安裝到位
機器漏水	接水盤水滿溢出	清空接水盤
	原水箱底部密封處有異物卡住	用頂針檢查產品底部密封彈簧處是否存在異物卡住，並進行清理
	純淨水壺未裝好	檢查純淨水壺是否裝好插緊，勿留縫隙
飲用水出現異味	首次使用或更換濾芯後未按要求沖洗，或過久未使用機器。	參考9.2 首次沖洗/更換濾芯沖洗
	未及時更換濾芯	參考11.4 更換濾芯
漏電及機身帶感應電	機器接地不良或電源軟線破損	必須使用有可靠接地的三孔插座，若電源破損需及時聯繫售後更換
按鍵/顯示幕無反應	系統出現故障	關閉電源1-2分鐘，再重新連接電源

❗ 如以上解決方案無法排除異常，請及時聯繫售後服務

9 裝箱清單

主機	× 1
接水盤	× 1
說明書	× 1
純淨水壺	× 2
快速入門指南	× 1
濾芯更換指南	× 1

10 產品售後服務指南

如果您需要信息或有任何問題，請訪問 www.philips.com/support 或聯繫您所在國家/地區的消費者服務中心。如果您所在的國家/地區沒有消費者服務中心，請聯繫當地經銷商。自購買之日起兩年內，因製造過程問題造成的任何損壞，或經我們維修服務人員確認的在正常使用狀況下的部件損壞，您將獲得免費保修服務。保修服務不包括經常更換的耗材、輔助設備、運輸費用和上門服務。維修時請向服務人員出示購買憑證。

請妥善保管本說明書



Register your product and learn more via the website link below:

www.philips.com/water

Specifications are subject to change without prio notice

© 2023 AquaShield

All rights reserved.

Philips and the Philips Shield Emblem are registered trademarks of Koninklijke Philips N.V. and are used under license.

This product has been manufactured by and is sold under the responsibility of Hong Kong AquaShield Health Technology Company Limited

and Hong Kong AquaShield Health Technology Company Limited is the warrantor in relation to this product.

Rev A JUN 23

