

CAUTION: READ THIS FIRST



PLEASE KEEP PACKING MATERIALS FOR FUTURE TRANSPORTATION!

For more information, see the back of this sheet.

The information on the back is intended for regular installation of this TV (not for wall mount installation).

Caution for packing when you move / ship

Please pack the unit properly by following the diagram on the carton.

Caution!

To avoid damage to the TV screen, do not pack the stand on the same side as the TV screen.

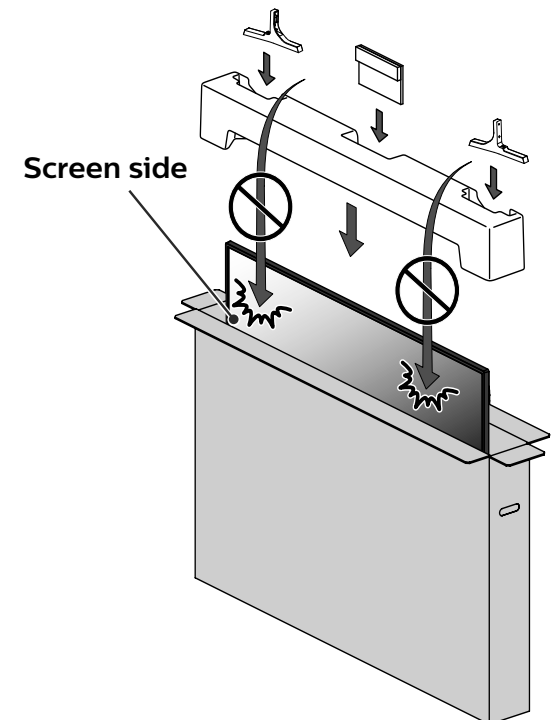

1 Getting started

- ⚠ Please read the entire instructions once before following them step by step.

A wide open space is recommended for assembly.

A phillips-head screwdriver is required to fasten the stands to the TV set.

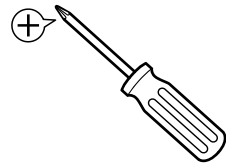

Be careful not to injure your fingers and keep children away during assembly.

It is recommended that two or more people remove the TV set from the box.

- ⚠ Thin TVs can easily bend. To avoid damage to this TV and its screen, it **MUST NOT** be carried in a horizontal position when being moved.

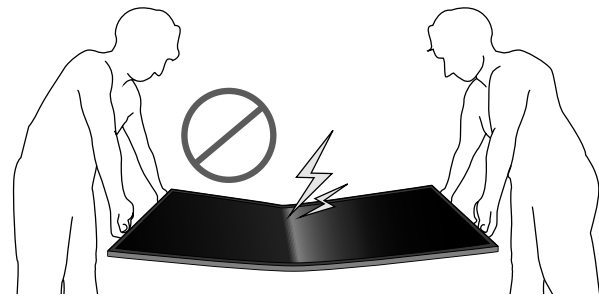

2 Unpacking

- 1 Cut the polypropylene strapping (plastic strapping).

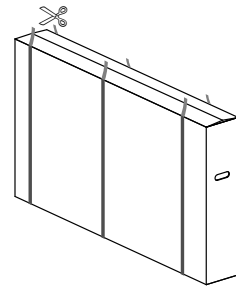

- 2 Open the top flaps of the box.

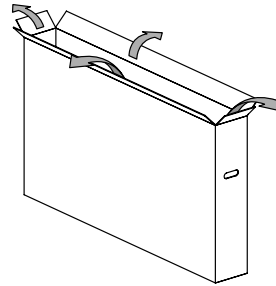

- 3 Remove all accessories.

- ⚠ DO NOT take the TV set out of the box yet.

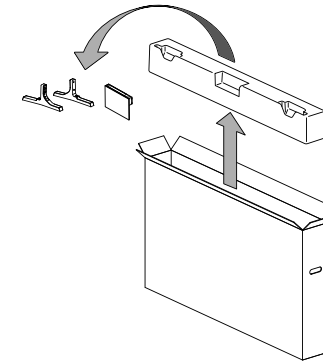

- 4 Remove the outer slipbox with care.

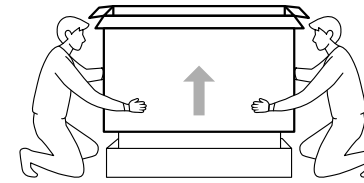

- 5 Support the top of the TV set with a hand to prevent the TV from falling.

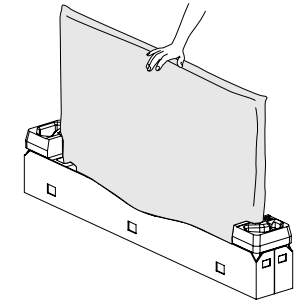

- 6 Unhinge the retaining tabs and unfold the left and right side of the bottom packaging.

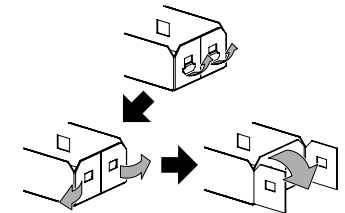

3 Installing the stands

- 1 Remove both of the bottom polystyrene foam bases. Carefully tear the plastic bag until the bottom corner of the TV is exposed.

Support the top of the TV set at all times to prevent the TV from falling.

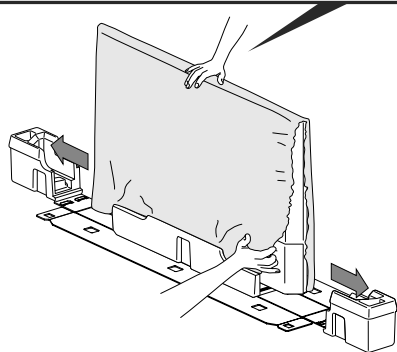

- 2 Lift up one side of the TV approx. 1" (2.5 cm) and insert the matching stand upward until it fits the main unit.

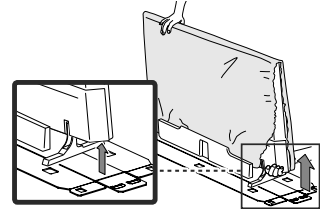

- 3 Fasten the matching stand to the TV with 2 screws (included).

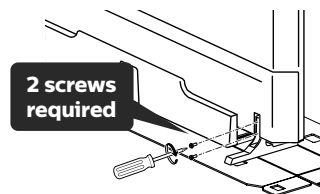

- 4 In the same manner as step 2, install the other stand.

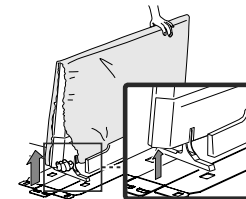

- 5 Fasten the other stand to the TV with 2 screws (included).

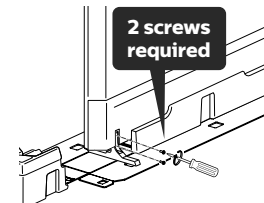

- 6 Both stands should now be securely fastened.

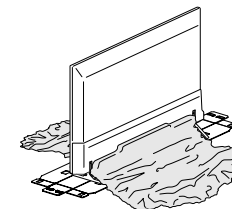

4 Lifting the TV set

Carefully lift the TV set as shown in the illustration and place it onto a stable, level surface.

