

13 Connect the stand power adaptor

14 Plug in the power and connect your devices

15 Mount the stand cover

Don't forget to upgrade your signal to fully enjoy your HDTV.
Please contact your cable or satellite provider.

Your TV connections in full-size scale

Unpack

Déballer
Desempaquetar

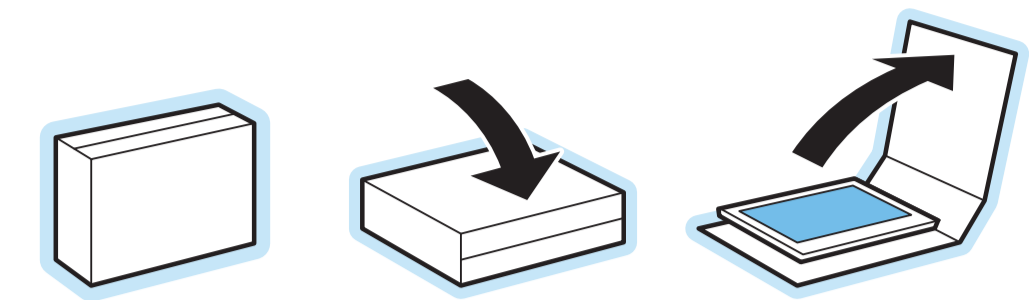

PHILIPS



Mount your TV on a VESA™ compliant mounting kit

VESA MIS-F, 800, 400, 8 (not included)

- 1** Unpack the 4 spacers
- 2** Tighten the 4 spacers
- 3** Connect your cables
- 4** Your TV is ready to mount on the VESA MIS-F, 800, 400, 8 compliant bracket (not included).

- 15** Place the batteries in the remote
- 16** Switch the TV on
- 17** Install the TV channels
Read the instructions in the User Manual

What's in the box

What's else you'll need
AC, Screws, Wrench, Pencil, For VESA

Need help?
User Manual
See the User Manual in the User Kit box that came with your TV.
Online help : www.philips.com/support
Contact line :
1 888 PHILIPS (744 5477) English speaking
1 800 651 6162 Francophone
Call our specialists any time.
Please, have the Model and Serial Number ready before you call.
You can find these numbers on the packaging label or on the back of your TV.

Register
Return your Warranty Registration Card today or register on www.register.philips.com to ensure you receive all the benefits you're entitled to.

Take your TV out of the box

- 1**
- 2**
- 3**
- 4**
- 5**
- 6**
- 7**
- 8**

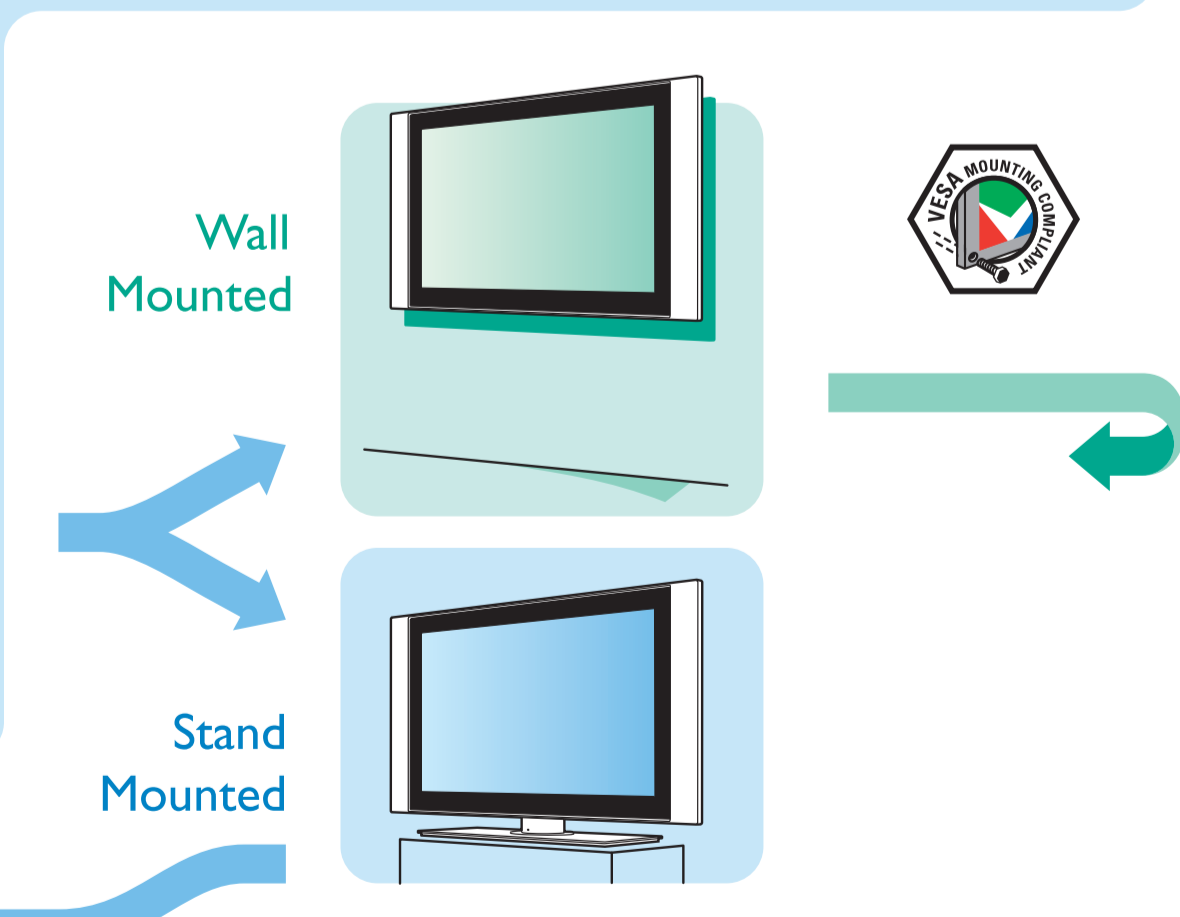

Mount your TV on the table top stand

- 9** Collect the stand parts
- 10** Mount the bracket
- 11** Place your TV on the stand
- 12** Secure the TV on the stand
- 13**