

PHILIPS

LCD TV

Thank you for purchasing this Philips LCD Television set. You are now the proud owner of a LCD TV set which promises full value to you as a customer. Before you proceed to install the LCD TV, please follow the steps and diagrams as shown to familiarise yourself with the correct and safe way of assembling the stand to the TV.

ASSEMBLING THE STAND

1

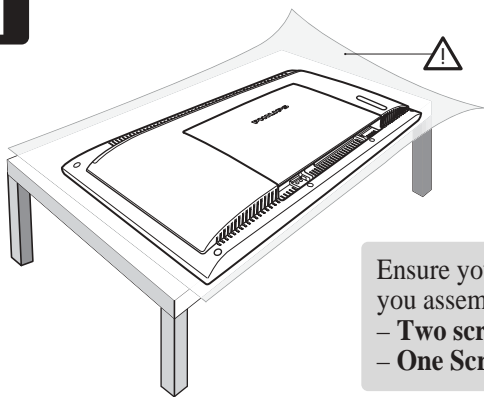

Ensure you have the following before you assemble the stand :

- **Two screws** (supplied with set)
- **One Screwdriver** (not supplied)

Place the set facing down on a protective sheet close to the edge of a flat surface.

2

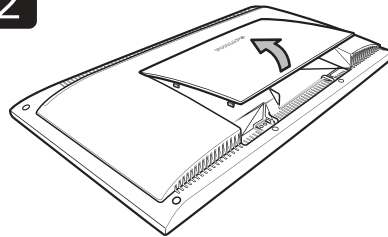

23"/58cm 20"/51cm

For the 20"/23" models, open back plate cover by gently pulling upwards.

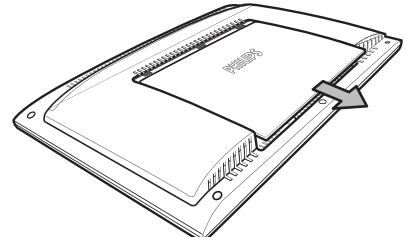

17"/44cm 15"/39cm

For the 15"/17" models, open back plate cover by sliding the plate cover downwards and then pull upwards.

3

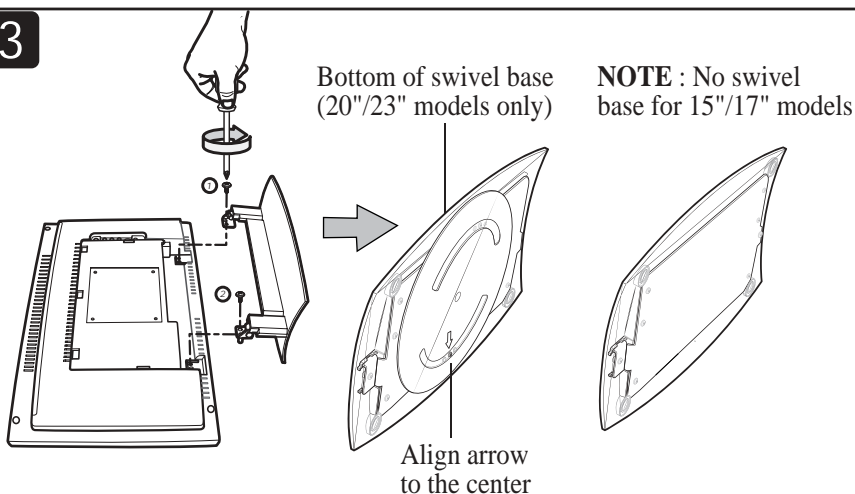

For swivelling of the stand to function properly, adjust the swivel base at the back of the stand until arrow is aligned in the center. Align the stand studs into the holes at the bottom of the set. Put in the screws (provided) into the 2 holes and tightened with a screwdriver.

CAUTION : While putting in the screws, hold onto the stand.

4

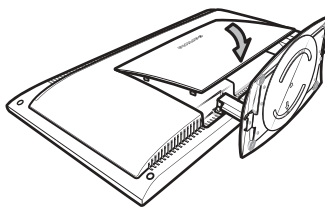

23"/58cm 20"/51cm

For the 20"/23"models, close back plate cover by gently pushing downwards.

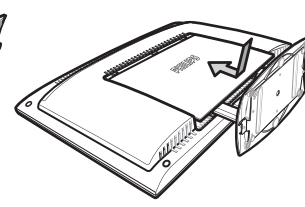

17"/44cm 15"/39cm

For the 15"/17" models, close back plate cover by sliding plate upward.

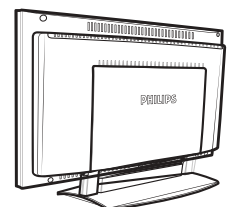

Check the stand arm is rigid and properly installed. Place the set upright.

INSTALLING LCD TV ON THE WALL

If you intend to install the LCD TV on the wall. ensure you have the following :

– Standard VESA 100 bracket for 15"/17"/20"/23" LCD TV (not supplied) and four spacers found in the accessory bag.

Do the following when installing the LCD TV on the wall :

1

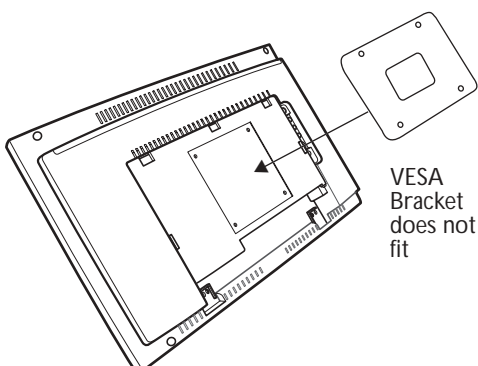

If your VESA bracket does not fit into the slot at the rear of the LCD TV, proceed to make use of the four spacers provided. Note : If VESA bracket fits into the slot, you need not use the spacers.

2

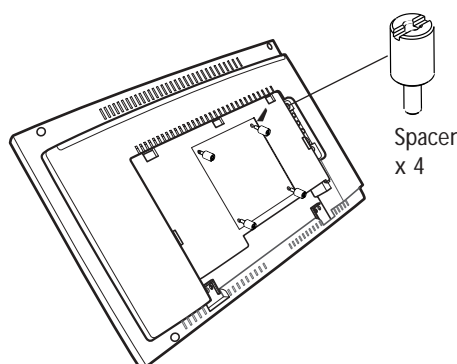

Screw the four spacers to the holes at the rear of the set. Ensure the spacers are properly tightened (torque of 1.2N-m or 1 lbf-in).

3

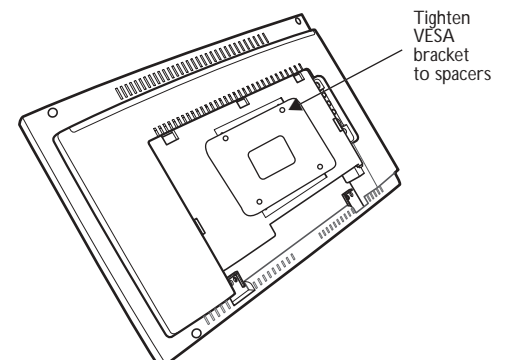

Place the VESA bracket on the spacers and tightened with the VESA bracket screws.

PHILIPS

LCD TV

Quick Use and Hookup Guide

CONTENTS

Presentation of the LCD Television	2
Remote Control Operation	2
Hooking Up the Television	
Remote Control Batteries	3
Cable/Cable Box TV	3
Antenna TV	3

AV1 Inputs	4
Component (CVI) Inputs	4
HD (High Definition Inputs)	4
PC (Monotor) Inputs	4
AV2 Inputs	4
Monitor Outputs	4

IMPORTANT

NOTE: This owner's manual is used with several different television models. Not all features (and drawings) discussed in this manual will necessarily match those found with your television set. This is normal and does not require that you contact your dealer or request service.

WARNING: TO PREVENT FIRE OR SHOCK HAZARD DO NOT EXPOSE THIS UNIT TO RAIN OR EXCESSIVE MOISTURE.

PRESENTATION OF THE LCD TELEVISION

1 Television keys

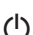
-  : to switch the TV on or off.
- VOLUME + / - : to adjust sound level.
- PROGRAM + / - : to select programmes.

To access or close menus, press the VOLUME + / - keys simultaneously. The PROGRAM + / - keys can be used to select an adjustment and the VOLUME + / - keys make that adjustment.

2 Adjustable stand

The stand has swivel and tilt functions. For swivelling function, ensure the arrows at the bottom of the stand arm and the swivel base are aligned in the center (see diagram on the right). For tilting function, you can tilt the set backward or forward to your preferred angle.

Note : The stand can be removed and the LCD TV can be installed on the wall. This set has four mounting interfaces fulfilling VESA specifications. Pull out the back plate cover to access the four installing interfaces. Installation of the LCD TV on the wall should be carried out by qualified servicemen. Improper or incorrect installation may render the set unsafe.

3 LED light and infrared sensors

Aim remote control at infrared sensors to activate TV controls.

4 Rear connectors

Located at the rear of the set.

5 Bottom connectors

Located at the bottom of the set.

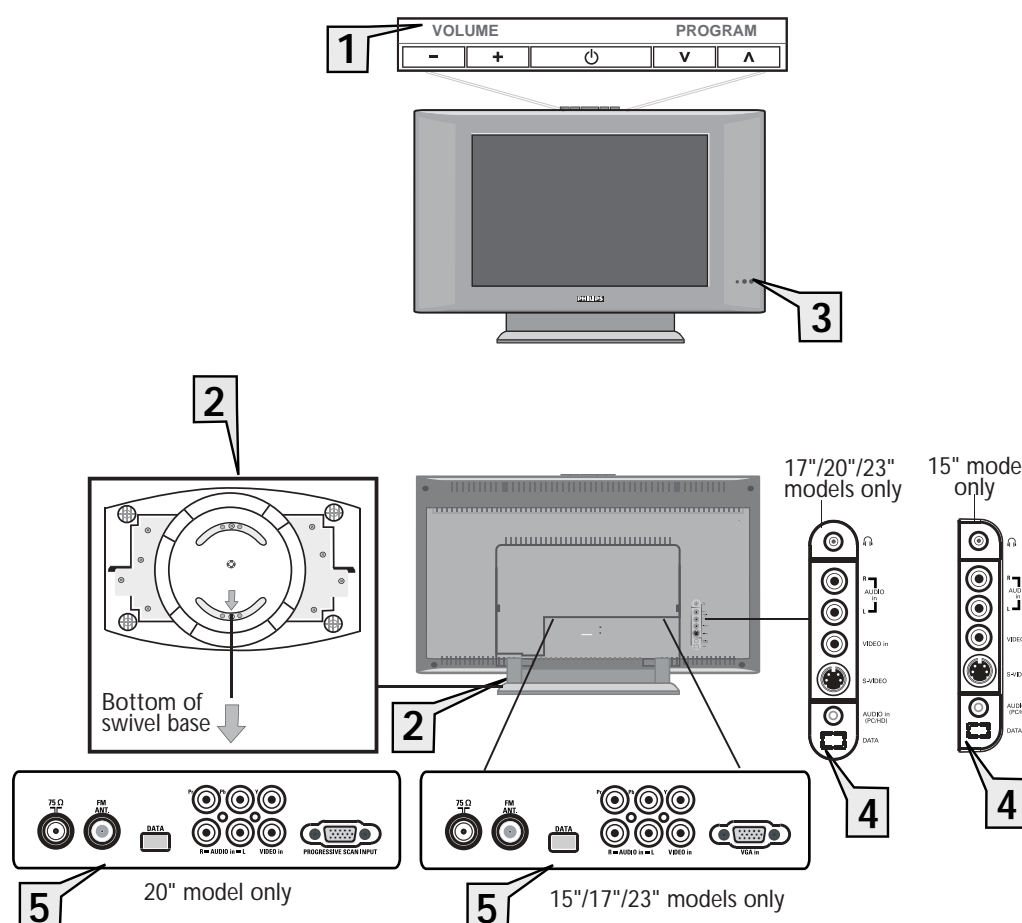

REMOTE CONTROL OPERATION

Sleep Button - Press to set the TV to automatically turn itself OFF at a given amount of time.

Status/Exit Button - Press to see the current channel number on the TV screen. Also press to clear the TV menu after control adjustments.

VGA Mode Button - Press to directly enter PC mode. Applicable to 15"/17"/23" models only.

TV Mode Button - Press to directly enter TV mode.

Auto Sound Button - Press to select an AutoSound™ control. Choose from three factory-set controls (VOICE, MUSIC, and THEATRE) and a PERSONAL to tailor the TV sound to enhance the particular type of program you are watching.

Menu Button - Press for the onscreen menu to appear. Pressing the menu button after menu selections are made will exit the menu from the TV screen.

Volume (+) or (-) Buttons - Press to adjust the TV sound level.

Mute Button - Press to turn the TV sound OFF. Press again to return the sound to its previous level.

Number Buttons - Press the number buttons for direct access to the TV channels. For a 2-digit channel, enter the 2nd digit before the dash disappears. For a 3-digit channel, enter the first digit followed the next 2 digits.

Source Button - Press to toggle between the different A/V Input jack connections and the currently tuned channel.

Format Button - Press to toggle the different screen format options.

Power Button - Press to turn the TV ON and OFF.

Program List - Press to display a list of channel numbers. Each channel will appear as a selectable menu item.

CC Button - Press to select Closed Captioning options within the menu.

FM Radio Mode Button - Press to directly enter Radio mode.

HD Mode Button - Press to directly enter HD mode.

Auto Picture Button - Press to select an AutoPicture™ control. Choose from four factory-set controls (MOVIES, SPORTS, WEAK SIGNAL and MULTI MEDIA) and a PERSONAL control that you set according to your own preferences through the onscreen PICTURE menu. The four factory-set controls will tailor the TV picture so as to enhance the particular type of program you are watching, or to improve the picture of a program that has a weak signal.

A/CH Button - Press to toggle between the currently viewed channel and the previously viewed channel.

Cursor Buttons (Left, Right, Up, Down) - Press these buttons to highlight, select, and adjust items on the TV's onscreen menu.

Channel (+) or (-) Buttons - Press to access the next or previous channel.

Surf Button - Press to select previously viewed channels. You can place up to 10 channels in memory. Then by pressing the SURF button you can quickly view the select channels.



HOOKING UP THE TELEVISION

REMOTE CONTROL BATTERIES

To load the supplied batteries into the remote:

- 1 Remove the battery compartment door on the back of the remote.
- 2 Place the two batteries in the remote. Be sure the (+) and (–) ends of the batteries line up correctly (the inside of the case is marked).
- 3 Reattach the battery compartment door.

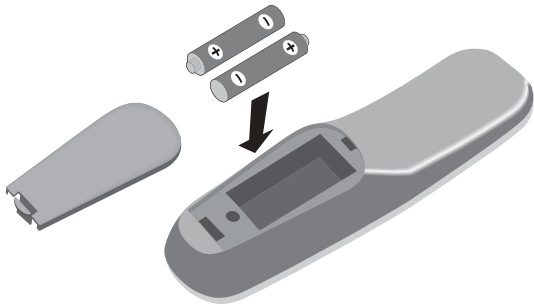

CABLE/CABLE BOX TV

Your Cable TV input into your home may be a single (75 ohm) cable or use a cable box decoder. In either case the connection is very simple. Follow the steps below to connect your cable signal to your new television.

Direct Cable Connections:

This connection will supply Stereo sound to the TV.

- 1 Connect the open end of the round Cable Company supplied cable to the 75Ω input on the bottom of the TV. Screw it down finger tight.

Direct Cable Connection

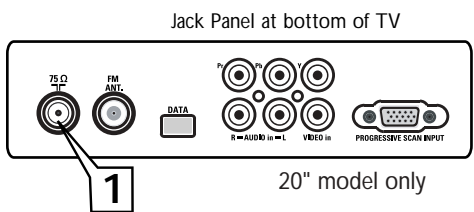
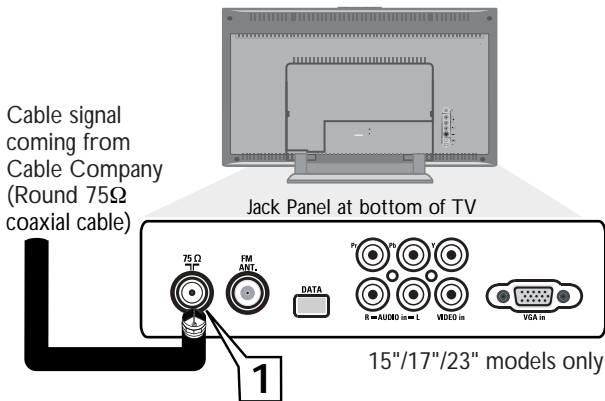

Cable Box (w/RF In/Outputs):

This connection will NOT supply Stereo sound to the TV. The sound from the cable box will be mono.

- 1 Connect the open end of the round Cable Company supplied cable to the cable signal IN(put) plug on the back of the Cable Box.
- 2 Using a separate round coaxial cable, connect one end to the OUT(put) (TO TV) plug on the back of the Cable Box.
- 3 Connect the other end of the round coaxial cable to the 75Ω input on the bottom of the television. Screw it down finger tight.

Direct Cable Connection

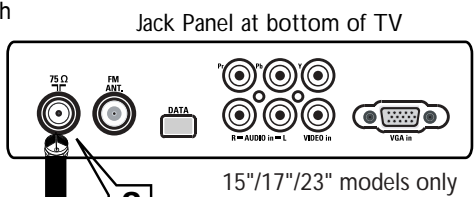
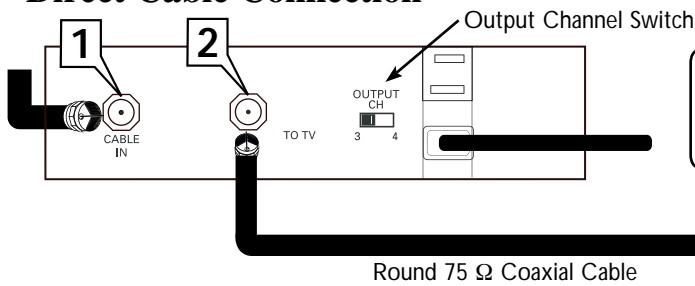

NOTE: Be sure to set the OUTPUT CHANNEL SWITCH on the back of the cable box to CH 3 or 4, then tune the cable box on the TV to the corresponding channel. Once tuned, change channels at the cable box, not the television.

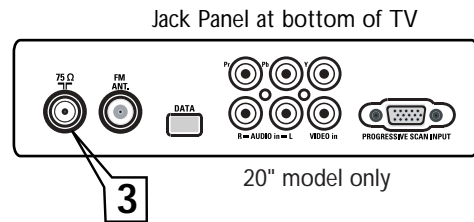

Cable Box (w/Audio/Video Outputs):

This connection will supply Stereo sound to the TV.

- 1 Connect the open end of the round Cable Company supplied cable to the cable signal IN(put) plug on the back of the Cable Box.
- 2 Using an RCA type Video Cable, connect one end of the cable to the Video (yellow) (or ANT, your cable box may be labeled differently) Out jack on the cable box and the other end to the Video end of the composite adapter included with the TV.
- 3 Using an RCA type Audio Left and Right Cable, connect one end to the left and right Audio Out L and R jacks (red and white) on the cable box. Connect the other ends to the Audio end of the composite adapter cable included with the TV. Connect the adapter into the AV In jack on the bottom of the TV.

Cable Box with Audio/Video Outputs Connection:

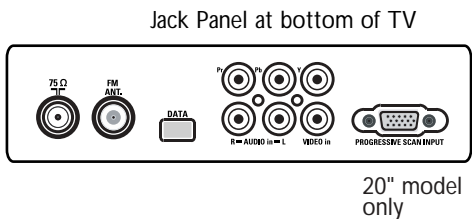
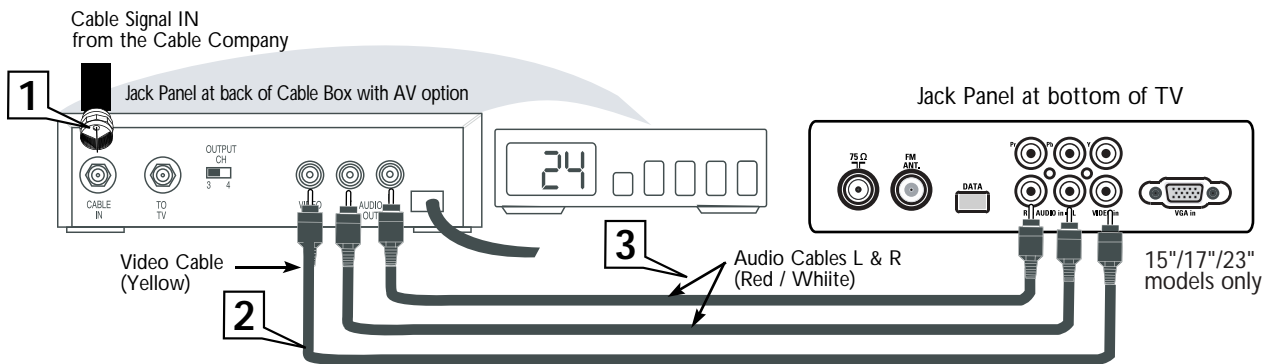

NOTE: Use the **Source** button on the remote control to tune to the AV1 channel for the cable box signal. Once tuned, change channels at the cable box, not the television. Pressing the **Source** button repeatedly will scroll all the AV input channels, including the presently tuned channel.

ANTENNA TV, FM

A combination antenna receives normal broadcast channels (VHF 2–13 and UHF 14–69). Your connection is easy because there is only one 75Ω (ohm) antenna plug on the back of your TV, and that's where the antenna goes.

- 1 If your antenna has a round cable (75 ohm) on the end, then you're ready to connect it to the TV. If your antenna has flat, twin-lead wire (300 ohm), you first need to attach the antenna wires to the screws on a 300- to 75-ohm adapter.
- 2 Push the round end of the adapter (or antenna) onto the 75Ω (ohm) plug on the bottom of the TV. If the round end of the antenna wire is threaded, screw it down finger tight.

Antenna Connection:

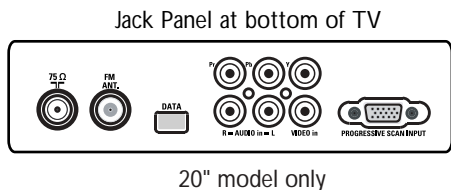
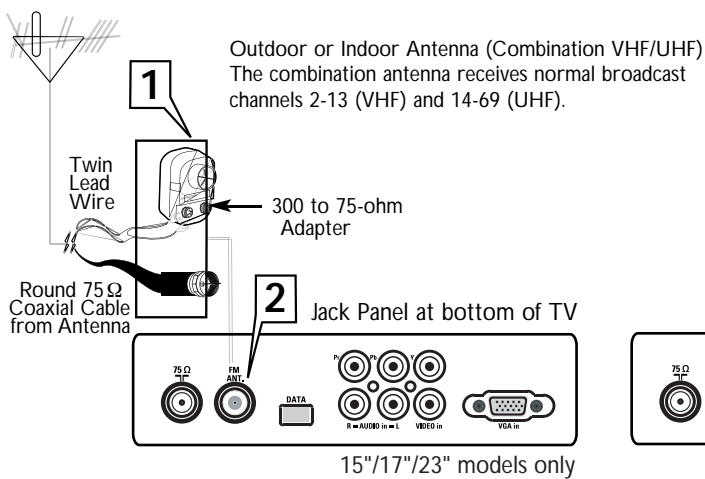

HOOKING UP THE TELEVISION

AV1 INPUTS

The audio/video input jacks on the bottom panel of the TV are for direct picture and sound connections between the TV and a VCR (or similar device) that has audio/video output jacks.

- 1 Connect the **VIDEO OUT (yellow) jack** of the **VCR** to the **VIDEO IN** jack on the bottom of the TV.
- 2 Connect the **AUDIO OUT (left and right) jacks** of the **VCR** to the **AUDIO IN (left and right) jacks** on the bottom of the TV.
- 3 Turn the **VCR** or accessory device and the **TV ON**.
- 4 Press the **SOURCE** button on the remote control to select AV1 channel for the accessory device. AV1 will appear in the upper left corner on the TV screen when tuned properly.
- 5 With the **VCR** (or accessory device) **ON**, press the **PLAY** button of the **VCR** to view the tape on the television.

Note : The Audio/Video cables needed for this connection are not supplied with your TV. Please contact your dealer or Philips at 800-531-0039 for information about purchasing the needed cables.

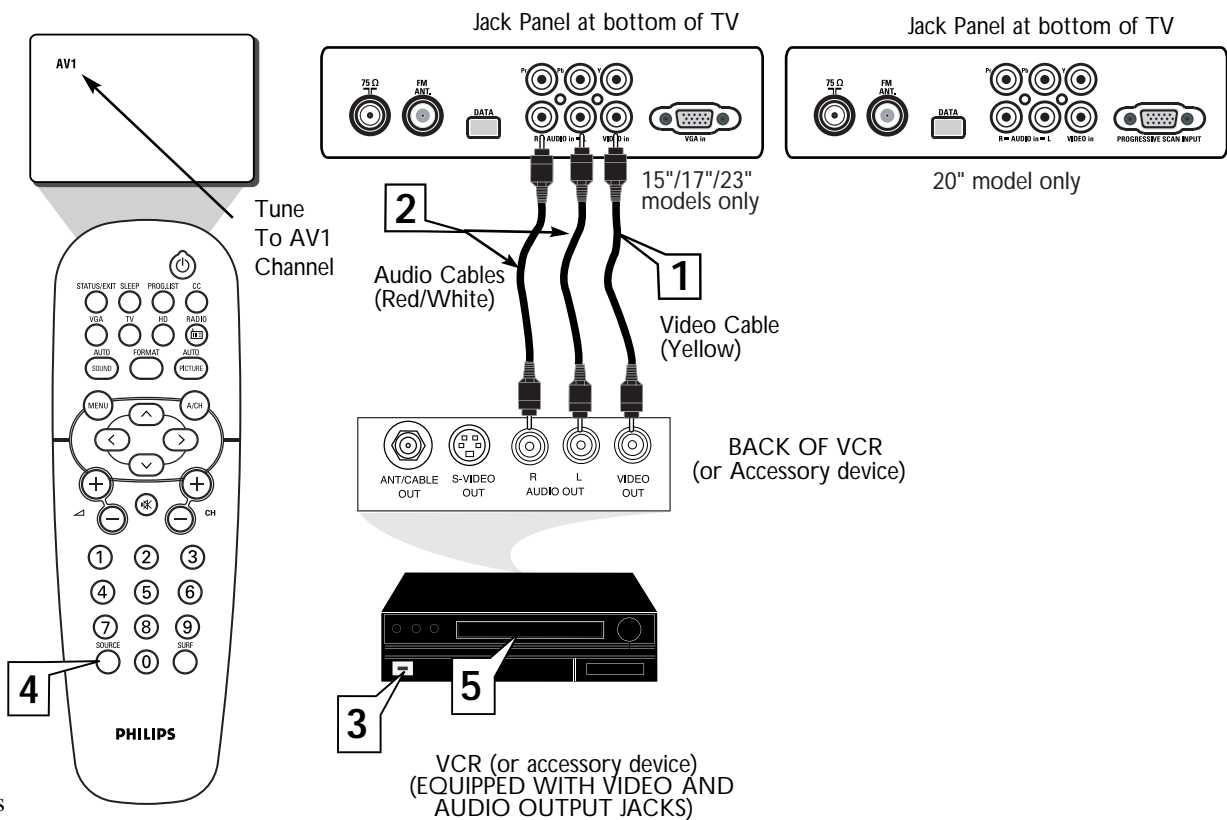

COMPONENT (CVI) INPUTS

Component Video inputs provide the highest possible color and picture resolution in the playback of digital signal source material, such as with DVD players.

- 1 Connect the **Component (Y, Pb, Pr) Video OUT** jacks from the DVD player (or similar device) to the **COMP(onent) VIDEO Input (Y green, Pb blue, Pr red)** jacks on the bottom of the TV. When using the Component Video Inputs, it is best not to connect a signal to the AV1 IN Video Jack. The CVI connection will dominate over the AV1 in Video Input jack.
- 2 Connect the **red and white AUDIO CABLES** to the Audio (left and right) output jacks on the rear of the accessory device to the AV1 in Input Jacks on the TV.
- 3 Turn the **TV and the DVD (or digital accessory device) ON**.
- 4 Press the **SOURCE** button on the remote control to select CVI channel for the accessory device. CVI will appear in the upper left corner on the TV screen.
- 5 Insert a DVD disc into the DVD player and press the **PLAY ►** button on the DVD Player

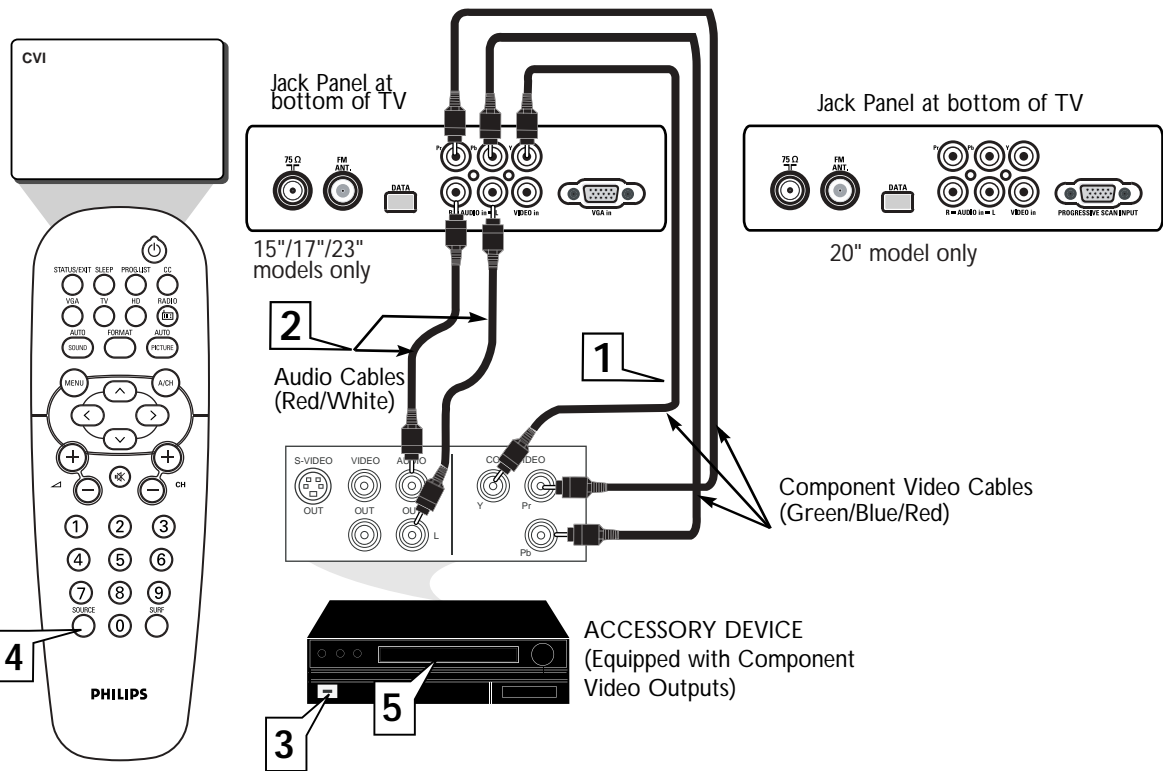

HELPFUL HINT

The description for the component video connectors may differ depending on the DVD player or accessory digital source equipment used (for example, Y, Pb, Pr; Y, B-Y, R-Y; Y, Cr, Cb). Refer to your DVD or digital accessory owner's manual for definitions and connection details.

HD (HIGH DEFINITION) INPUTS

If you are using a High Definition receiver that can transmit high definition programming, the TV can accept those signals through the HD Inputs located on the bottom of the TV.

- 1 Connect the **Component (Y, Pb Pr) Video Out** jacks from the HD Receiver (or similar device) to the **VGA In jack** (15"/17"/23" models) via the **VGA cinch to cable** (not supplied with set) or to the **PROGRESSIVE SCAN INPUT** (20" model) jack on the bottom of the TV.
- 2 Connect the **red and white AUDIO CABLES** to the Audio (left and right) output jacks on the rear of the HD Receiver to the **AUDIO PC/HD** jack at the bottom of the TV.
- 3 Turn the **TV and the HD Receiver ON**.
- 4 Press the **HD Mode** button to set the TV into the HD Mode and tune to the HD signal.

Note : Rear of HD Receiver (Illustration is for reference only. Your HD Receiver's jack panel may look and be labelled differently.) The Audio/Video cables needed for this connection are not supplied with your TV. Please contact your dealer or Philips at 800-531-0039 for information about purchasing the needed cables.

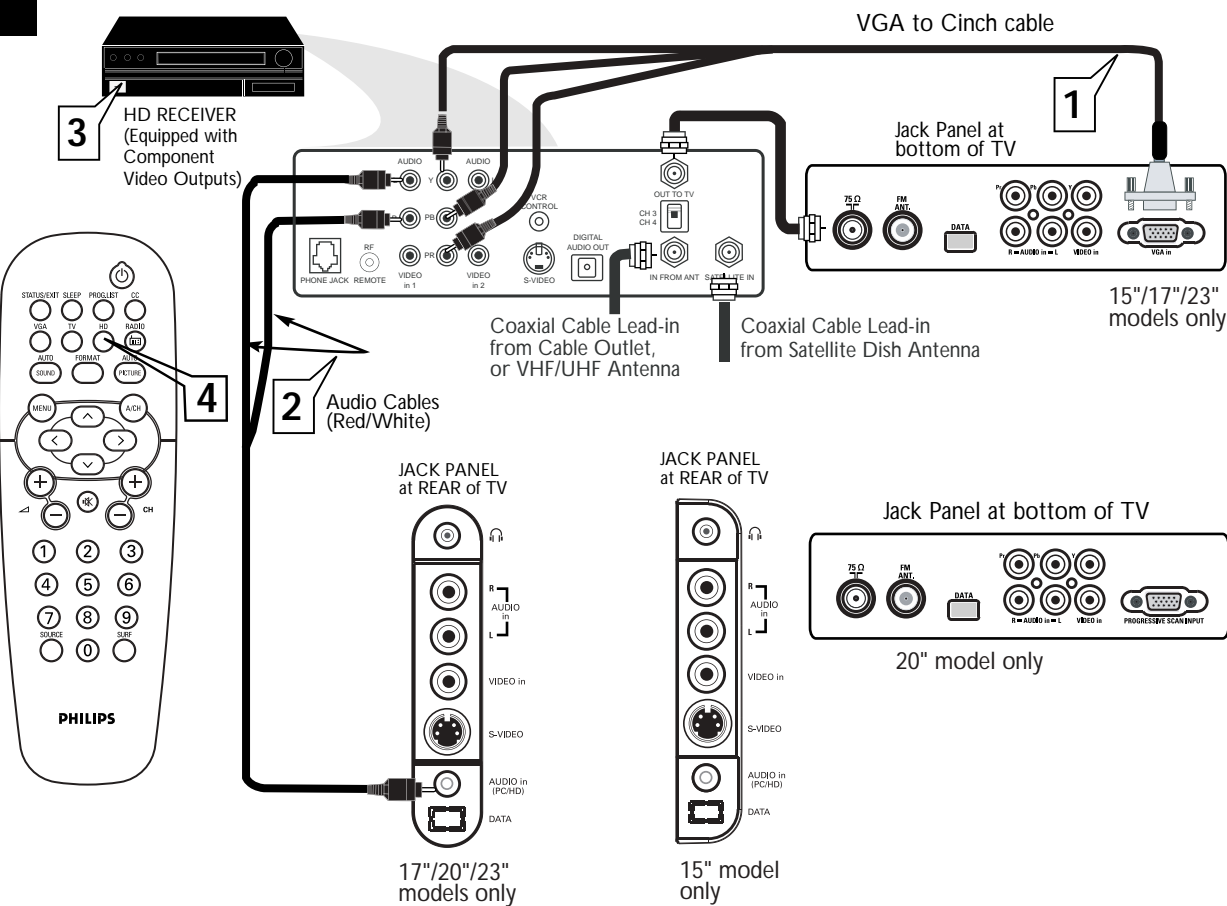

HOOKING UP THE TELEVISION

PC (MONITOR) INPUTS

This TV can be used as a PC Monitor. Your computer will have to be equipped with a VGA type video output and VGA cable. Applicable to 15"/17"/23" models only. 20" model is for 480p Progressive Scan DVD playback.

- 1 **Connect one end of the VGA video cable** to the Monitor (video) output on the computer to the PC Input (VGA) jack on the bottom of the TV.
- 2 **Connect the AUDIO PC/HD cable** of the TV to the Audio output on the PC.
- 3 **Turn the TV and the Computer ON.**
- 4 **Press the VGA Mode button** to set the TV into the VGA Mode and tune to the computer's signal.

Note : For the display resolutions available to your TV, refer to the Operating Instruction Manual

Please contact your dealer or Philips at 800-531-0039 for information about purchasing the needed cables.

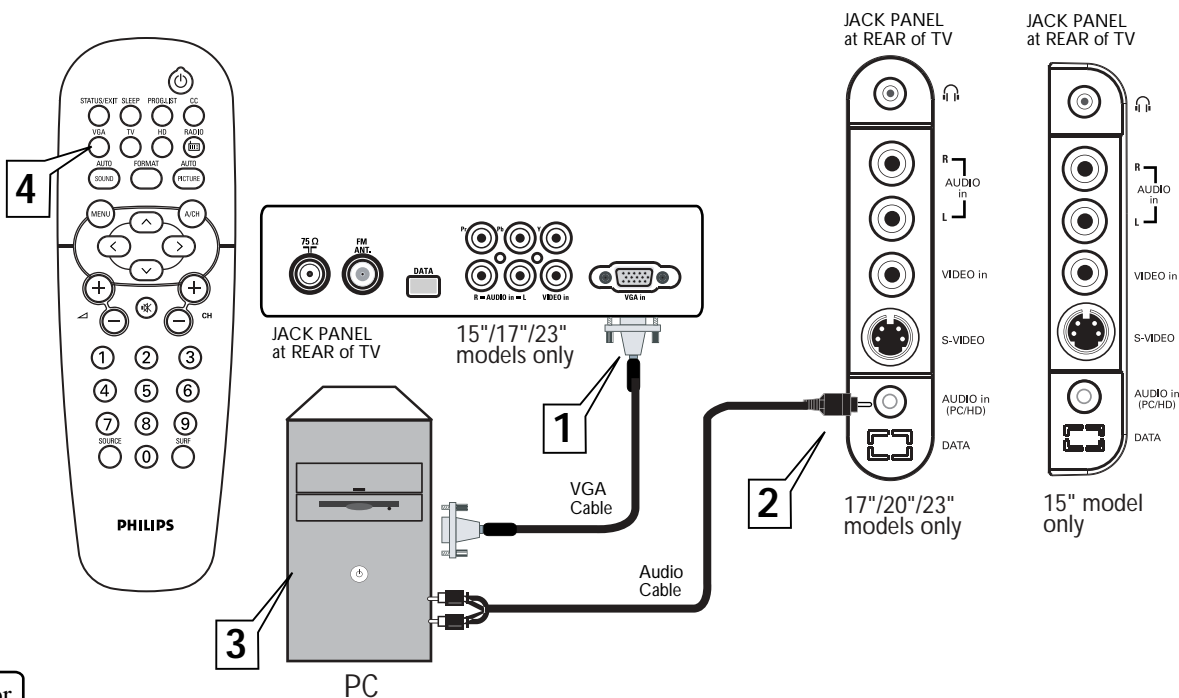

AV2 (SIDE) INPUTS

Much like the AV1 jacks, the AV2 jacks allow for extra accessory device connections for items such as cameras or gaming stations. The AV2 Input Jacks are located on the rear of the TV.

- 1 **Connect the VIDEO OUT (yellow) jack of the Accessory device** to the VIDEO IN jack on the bottom of the TV. If your accessory device is equipped with a S-VIDEO jack, do not connect to the VIDEO jack. Connect to the S-VIDEO jack instead.
- 2 **Connect the AUDIO OUT (left and right) jacks of the Accessory device** to the AUDIO IN (left and right) jacks on the bottom of the TV.
- 3 **Turn the Accessory Device and the TV ON.**
- 4 **Press the SOURCE button** on the remote control to select AV2 channel for the accessory device. AV2 will appear in the upper left corner on the TV screen when tuned properly.
- 5 **With the Accessory Device ON, press the PLAY button** to activate the playback on the television.

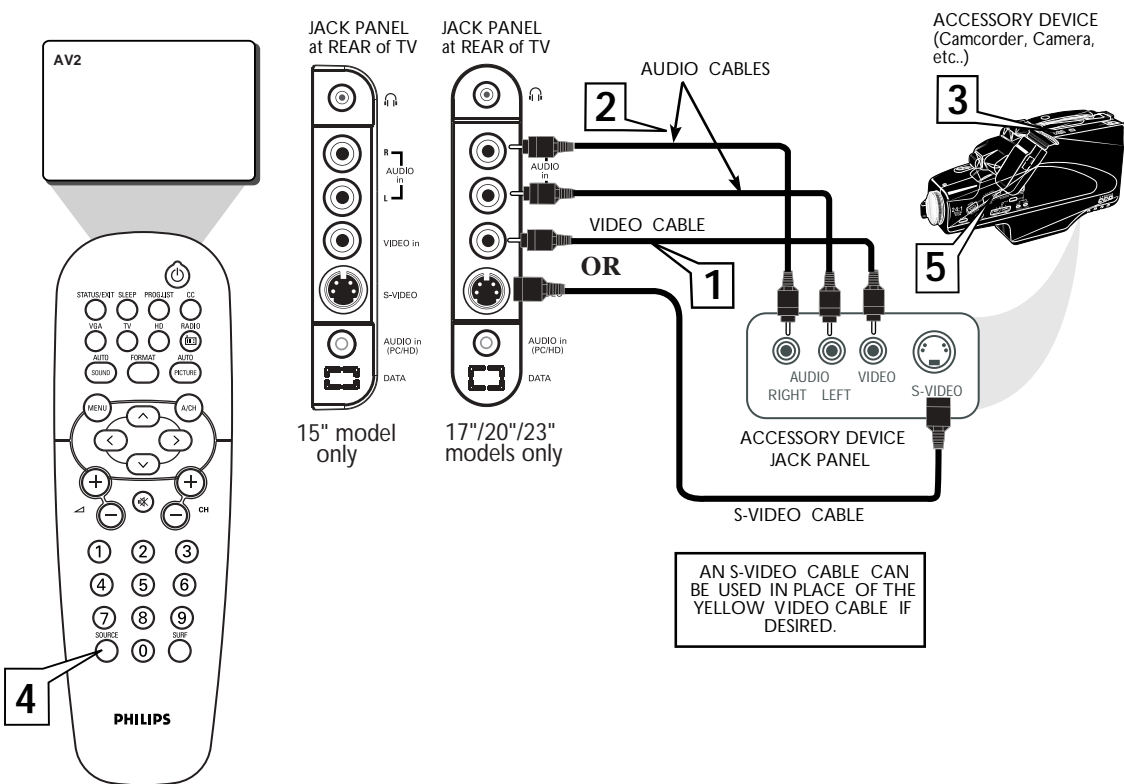

MONITOR OUTPUTS

The Audio headphone jack can be used to connect an external audio system for better audio sound or to a headphone in any of the available modes.

If connected to an audio system or a headphone, there will be no sound from the TV speakers. The sound will come from the audio system of the headphone.

- 1 **Connect Headphone jack** located on the right rear of the TV to the R and L audio input jacks on your sound system or to your headphone set.
- 2 **Turn the TV and Audio system/Headphone ON.** The TV sound can be heard through the Audio system/Headphone.

