

Quick Start Guide

DVP 1013
DVD Video Player



What's in the box?



DVD Video Player

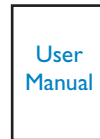

User Manual

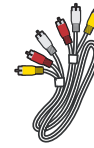

Audio/Video Cables



Remote Control and 2 AAA batteries



1 Connect

Basic Audio/Video Connections

Composite Video CVBS (Good Quality)

(Good Quality)

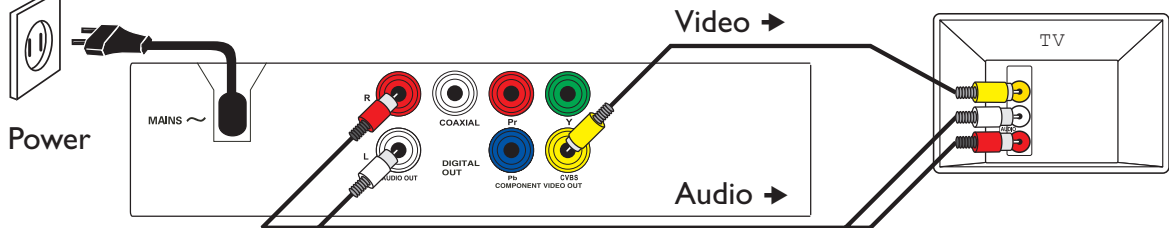

OR

Component Video (Better Quality)

(Better Quality)

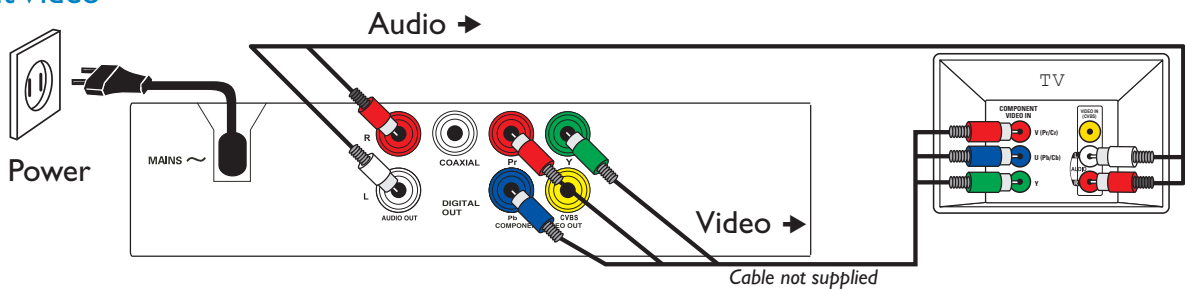

OR

RF Modulator

RF Modulator (not supplied)

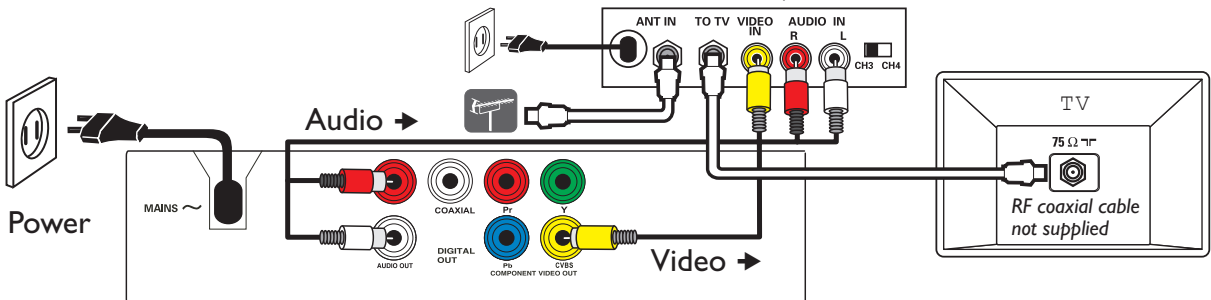

2 Set up

A Finding the viewing channel

- 1 Press **STANDBY-ON** on this unit to turn it on.

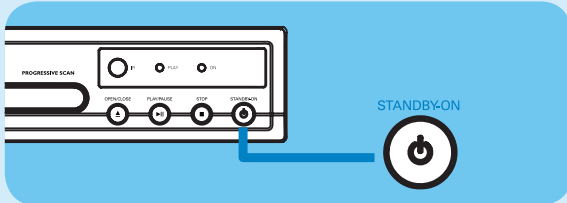

- 2 Turn on the TV. Use the TV's remote control to select the correct viewing channel.

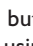
Note To search for the correct viewing channel, press the Channel Down button on the TV's remote control repeatedly (or AV, SELECT,  button) until you see the Video In channel. If you are using a RF modulator, set the TV to channel 3 or 4.

See the accompanying user manual on 'Getting started' for more information.

B Select the display language on the screen

- 1 Press **SETUP**.
The { General Setup Page } appears.

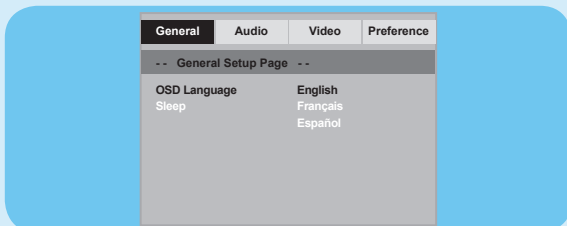

- 2 Press **▼** to select { OSD Language } and press **▶**.
- 3 Use **▲▼** keys to select a language option in the menu and press **OK** to confirm.

Note The language set here is only for the menus that are shown on the TV while operating this unit, not for the DVD disc menu.

3 Enjoy

A Start disc playback

- 1 Playback may start automatically when a disc has been loaded in the disc tray.

Note If a disc menu appears on the TV, use **▲▼◀▶** keys to navigate in the DVD menu.

- 2 Press **PLAY/PAUSE ▶||** to start playback.
- 3 To stop playback, press **STOP ■**.

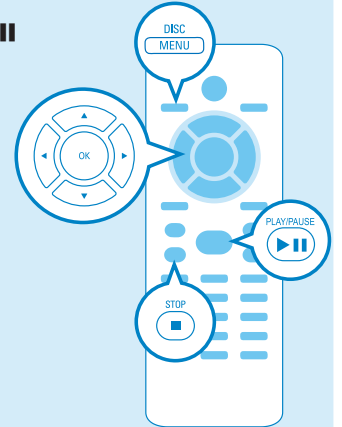

Troubleshooting

For more troubleshooting tips, see the user manual.

No power

- Check if the AC power cord is properly connected.
- Press the STANDBY-ON on the top panel of this unit to turn on the power.

No picture

- Check connection to TV and ensure the plugs are firmly in place.

No sound or distorted sound

- Check audio connections and make sure that the connected audio device is turned on.

Remote control does not work

- Check the batteries are loaded correctly or replace the batteries with new ones.
- Reduce the distance between the remote control and this unit.
- Point the remote control directly toward the IR sensor.

Need help?

User Manual

See the user manual that came with your Philips DVD Player

Online

Register your product and get support at www.philips.com/welcome

Hotline

Call 1-866-771-4018 for our operators.

2008 © Philips Consumer Lifestyle

Philips and Philips Shield are used under license of

Koninklijke Philips Electronics

P&F USA, Inc. PO Box 672768 Marietta, GA 30006

Printed in China

sgptt_0851/F7_03



Be responsible
Respect copyrights