

3 Enjoy

Start Disc Playback

- 1 Press **[OPEN/CLOSE ▲]** to open the disc tray.
- 2 Place the disc on the disc tray with its label side facing up.

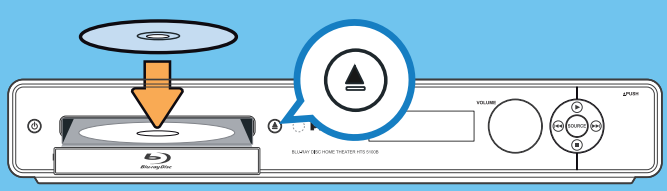

* Make sure the disc is compatible with this unit.
(Refer to page 19 in the user manual for the list of compatible discs.)

- 3 Press **[OPEN/CLOSE ▲]** to close the disc tray.

It may take a while to load the disc.

- 4 Playback may start automatically.
If not, press **[PLAY ►]**.

To pause playback:
Press **[PAUSE II]**.

To return to the normal playback:
Press **[PLAY ►]**.

To stop playback:
Press **[STOP ■]**.

To eject the disc:
Press **[OPEN/CLOSE ▲]** to open the disc tray.
Remove the disc.
Press **[OPEN/CLOSE ▲]** to close the disc tray.

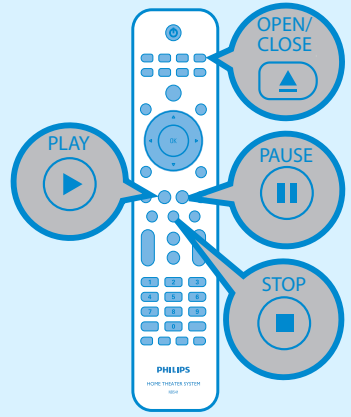

Need help?
User Manual
 See the user manual that came with your Philips Blu-ray Disc Home Theater.
Online
 Go To www.philips.com/welcome.
Hotline
 Call 1-866-309-0866 for our operators.

Be responsible
Respect copyrights

Playback other supported device

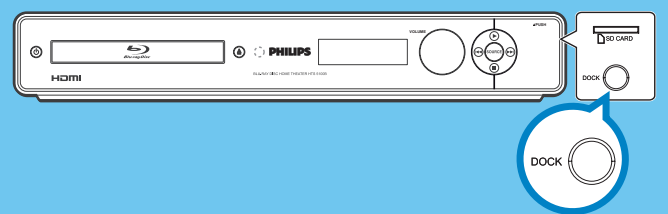

Apple iPod

- 1 Connect the docking station to the DOCK jack.
- 2 Dock your iPod in the docking station and adjust the support to fit it. Then turn on the iPod.
- 3 Press **[SOURCE]** to switch to "iPod" mode.
- 4 Start playback on your iPod.

Register your product and get support at
www.philips.com/welcome

HTS5100B



- 1 Connect
- 2 Set up
- 3 Enjoy

Quick Start Guide

What's in the box?

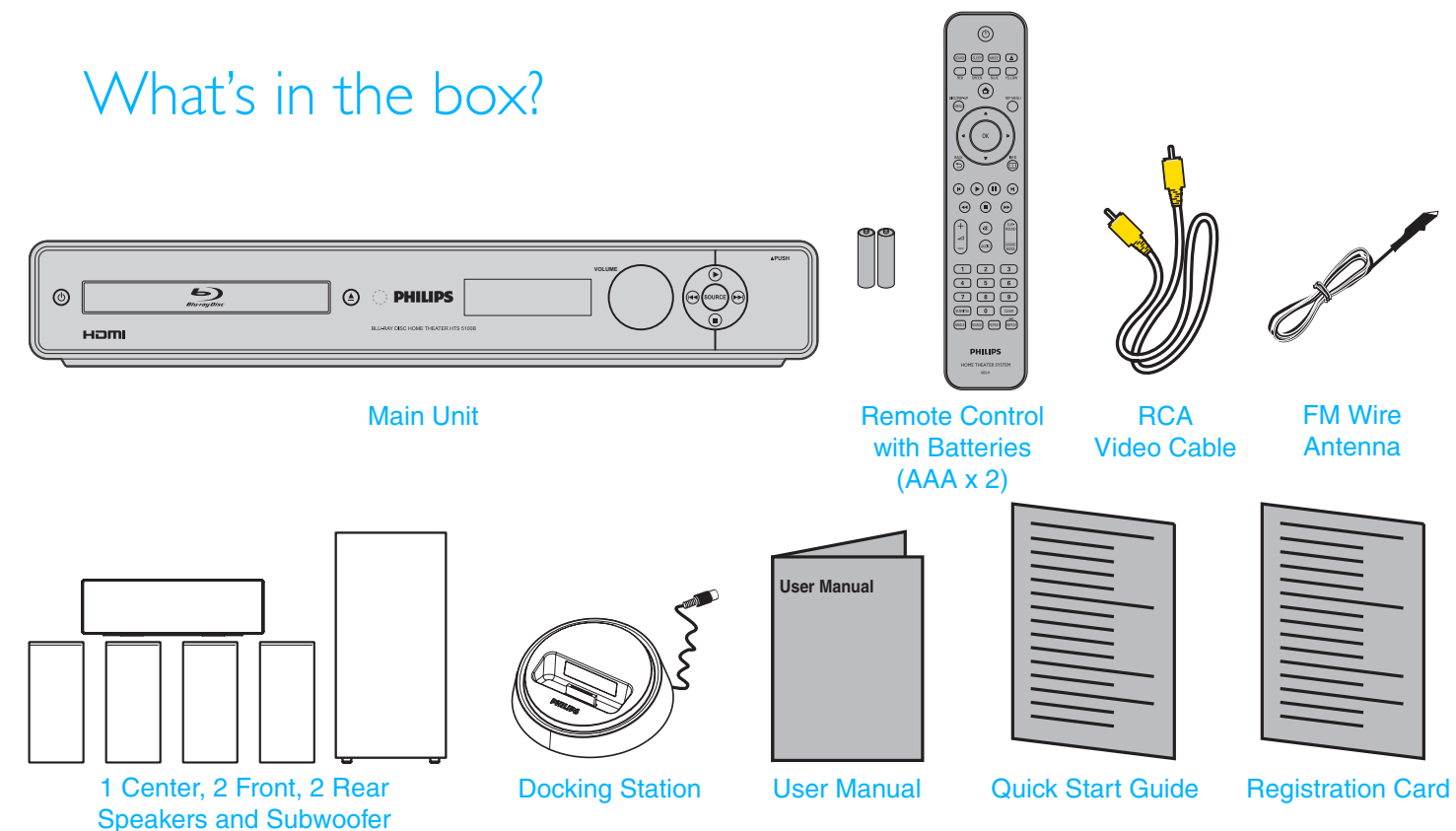

 © 2009 P&F USA, Inc.
 PO Box 430 Daleville, IN 47334-0430
 All rights reserved.
 Printed in China
 JpnYN-0923/F7-3
 CQE1A433Z★★★★
 E1P00UD

PHILIPS

1 Connect

Basic Connection

A Placement

Proper speakers system placement is important to ensure optimum sound performance.

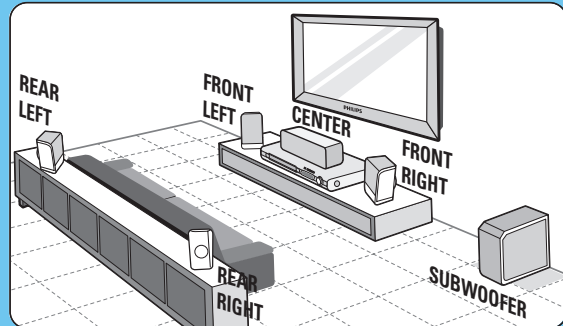

- 1 Place the center speaker above or close to the TV.
- 2 Place the subwoofer on the floor, at least one meter away from the TV.
- 3 Place the front speakers at equal distances from the TV.
- 4 Place the rear speakers at normal listening ear level.

B Connect the main unit to TV

Using HDMI (best quality)*1

- 1 Take an HDMI cable.
- 2 Plug one end of the HDMI cable into the HDMI OUT jack of this unit.
- 3 Plug the other end of the HDMI cable into the HDMI input jack of your TV.

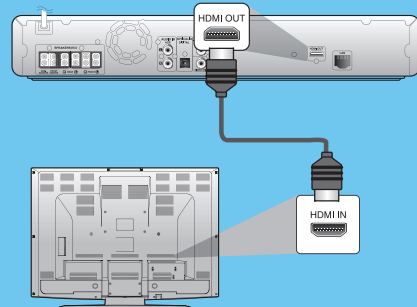

OR

ANALOG VIDEO CONNECTION

Option 1 - Using Composite Video (standard quality)

- 1 Take the supplied RCA video cable.
- 2 Plug the yellow RCA video cable into the VIDEO OUT jack of this unit.
- 3 Plug the other end of the RCA video cable into the video input jack of your TV.

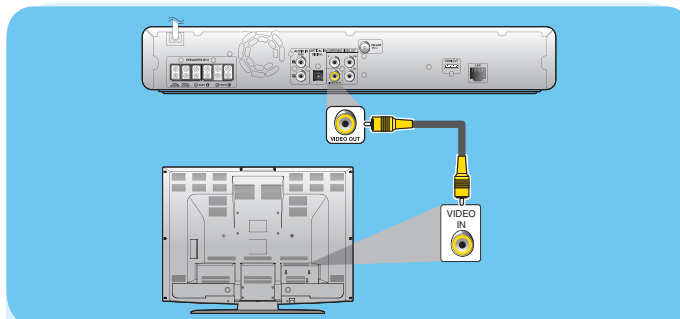

Option 2 - Using Component Video (better quality)*1

- 1 Take a green, blue, and red component video cable.
- 2 Plug the component video cable into the COMPONENT VIDEO OUT jacks of this unit.
- 3 Plug the other ends of the component video cable into the component video input jacks of your TV.

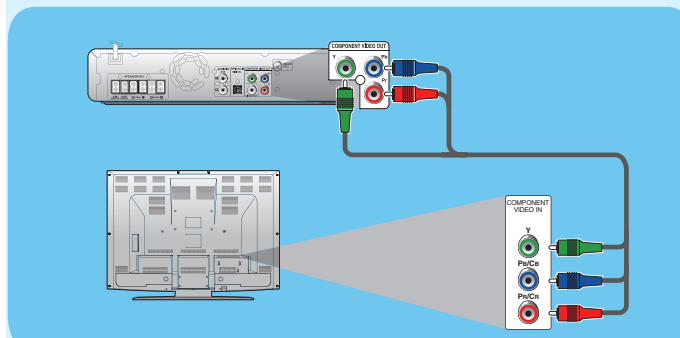

*1) This unit is compatible with the progressive scan system. The feature provides you with the higher quality pictures than traditional output system does. To utilize this feature, a component or an HDMI connection is required. Refer to the "Video Resolution" on page 41 in the user manual to set the resolution.

Supplied cables used in these connections are as follows:

- RCA video cable x 1
- Please purchase the rest of the necessary cables at your local store.

C Connect the speakers and subwoofer

Connect the various colored cables from the speakers and subwoofer to the same colored jacks at the rear of the main unit.

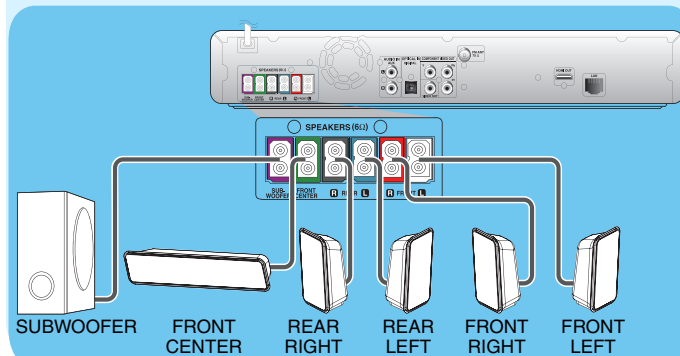

D Connect the radio antenna and power cable

Keep the antenna away from the electronic devices to prevent unwanted interference.

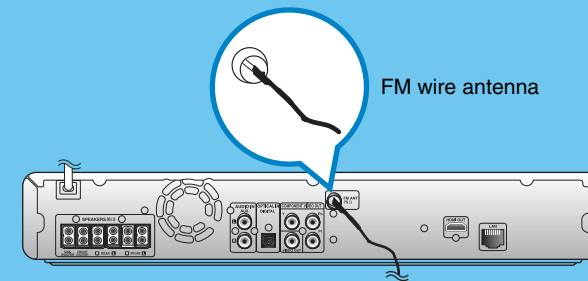

Connect the supplied FM wire antenna to the inner pin of the FM ANT 75 Ω jack. Extend the wire for optimum reception.

CONNECTING THE AC CORD

After you made all necessary connections, connect the AC cord to the AC outlet.

Insert the plugs securely. Incomplete connections will result in the generation of noise.

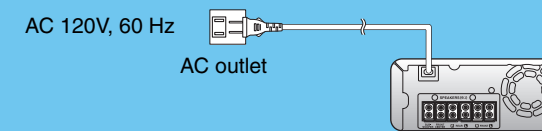

Note Refer to the user manual for other possible connections and important safety instructions.

E Connect audio output from TV (optional)

To hear the TV audio through this unit, use a red and white RCA audio cable (not supplied) to connect the AUDIO IN (AUX) jacks on the main unit to the AUDIO OUT jacks on your TV.

Note When watching the TV programs, you can press [SOURCE] repeatedly on the remote control until "AUX" is displayed to get the sound output from the speakers.

2 Set up

Finding The Viewing Channel On Your TV

- 1 After you have made all the necessary connections, press [STANDBY-ON ⏻] to turn on the unit.
- 2 Turn on your TV.
- 3 Press the button on the TV's remote control that accesses the external input channel. It may be labeled "SOURCE", "AV" or "SELECT" (refer to your TV's user manual). Or press "2" on the TV's remote control, then press channel down button repeatedly until you see the PHILIPS splash screen.



This is the correct viewing channel (external input channel).

* To call up the home menu, press [HOME ⏮]. Home menu:

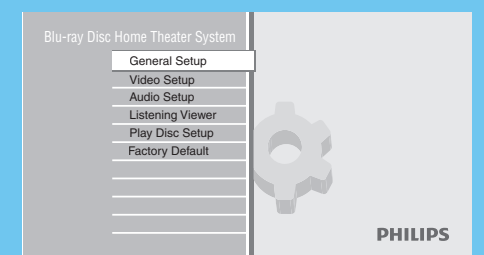

The HTS5100B is now ready for use.