

## 8 Using the remote control

ES Uso del mando a distancia  
FR Utilisez la télécommande



### NETTV

Opens **NetTV** home screen.

- ES Abre la pantalla de inicio de **NetTV**.
- FR Ouvre l'écran d'accueil de **NetTV**.

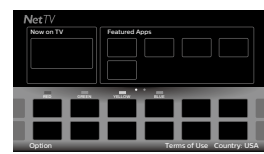

↑ (HOME button ES Boton de HOME FR Bouton de HOME)

Opens the main on-screen menu.

- ES Abre el menú principal en pantalla.
- FR Ouvre le menu principal à l'écran.



To turn off the Retail Demo

- ES Para apagar la demostración de tienda
- FR Pour éteindre la démo de détail

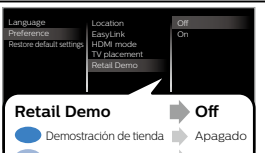
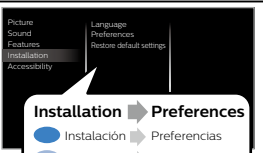
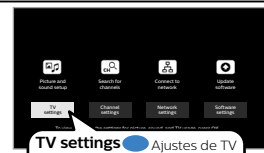
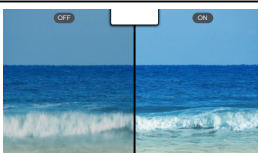

### INFO

Displays information about the current program.

- ES Muestra información sobre el programa actual.
- FR Affiche les renseignements sur l'émission en cours.

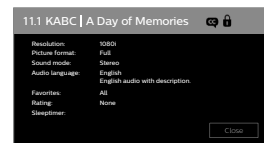

### OPTIONS

Displays a list of menu items applicable to the highlighted object or screen.

- ES Muestra una lista de opciones de menú aplicables a la pantalla o al objeto resaltado.
- FR Affiche une liste d'articles du menu applicable à l'objet ou à l'écran sélectionné.

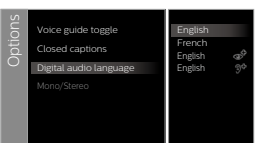
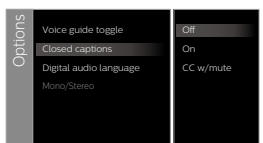
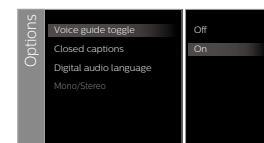

### SOURCE

Selects connected devices.

- ES Selecciona los dispositivos conectados.
- FR Sélectionne les appareils connectés.

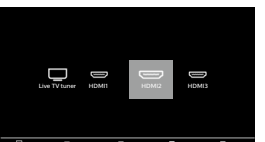
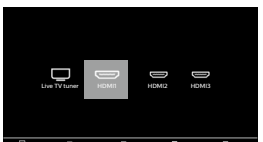
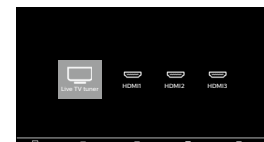

### FORMAT

Adjusts the picture size on the TV screen.

- ES Ajusta el tamaño de imagen en la pantalla del televisor.
- FR Régle la taille de l'image sur l'écran du téléviseur.

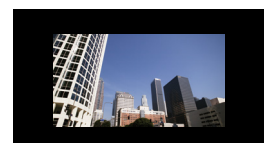

## 9 Network setup

ES Instalación de la red  
FR Installation d'un réseau

### Wireless Inalámbrico Sans fil

Please note the name of your wireless network, security type and security code of the wireless router before proceeding to step 5b.  
Por favor observe el nombre de su red inalámbrica, tipo de seguridad, y código de seguridad del router inalámbrico antes de continuar a 5b.  
Veuillez noter le nom de votre réseau sans fil, le type et le code de sécurité du routeur sans fil avant de passer à 5b.

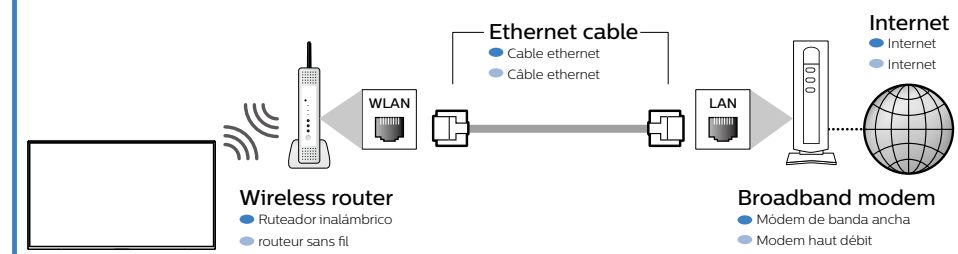

1 Press ↑ select Setup.

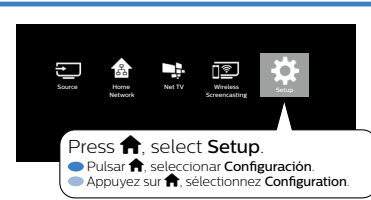

2 Select Connect to network, then press OK.

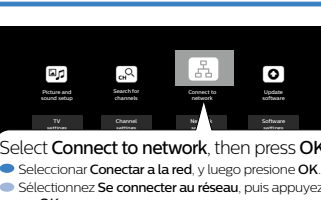

3 Select Wireless, follow the next steps.

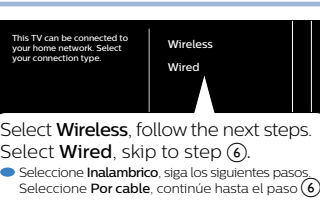

Select Easy Connect if your router has an easy connect push button feature.

- ES Selecciona Easy Connect si su router posee un botón de fácil configuración.
- FR Sélectionnez Easy Connect si votre routeur a un paramètre sans fil protégé avec son bouton.

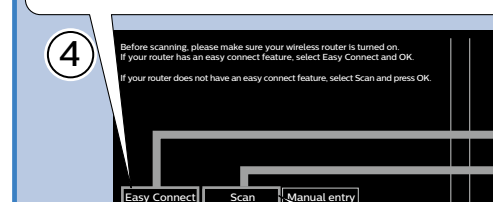

5a Press the router easy connect button, then within 2 minutes select Connect on the TV and press OK.

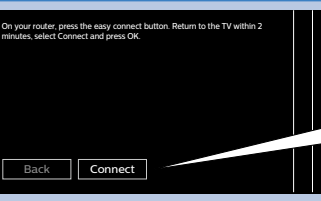

5b Select Scan. The unit searches for available networks.

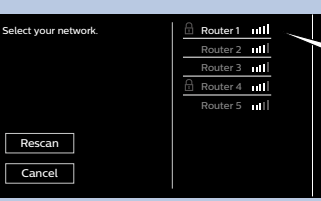

Caution Some features may require an always-on broadband Internet connection, firmware update and/or a minimum bandwidth. Internet services vary by location.

Funai Corporation Inc. does not warrant access to the portal or to any of the services, content, software and advertising. Funai Corporation Inc. may, in its sole discretion, add or remove access to any specific services, content, software and advertising at any time. Although Funai Corporation Inc. will strive to provide a good selection of services, content or software, Funai Corporation Inc. does not warrant continued access to any specific services, and content or software.

Precaución Algunas características pueden requerir una conexión de Internet de banda ancha encendida todo el tiempo, actualización de firmware y/o un ancho de banda mínimo. Los servicios de Internet varían por ubicación.

Funai Corporation Inc. no garantiza acceso al portal o cualquiera de los servicios, contenido, software y publicidad. Funai Corporation Inc. pueden, a su criterio, agregar o retirar acceso a cualquier servicio, contenido, software y publicidad específicos en cualquier momento. Aunque Funai Corporation Inc. intentará proporcionar una buena selección de servicios, contenido o software, Funai Corporation Inc. no garantiza el acceso continuo a cualquier servicio, contenido o software específico.

Attention Certaines fonctions nécessitent une connexion Internet à large bande en continu, une mise à jour du micrologiciel et/ou une bande passant minimale. Les services Internet varient selon la région.

Funai Corporation Inc. ne garantit pas l'accès au portail ou tout service, contenu, logiciel et publicité. Funai Corporation Inc. peut, à sa seule discrétion, ajouter ou retirer l'accès à tout service, contenu, logiciel et publicité spécifiques en tout temps. Même si Funai Corporation Inc. s'efforcera de fournir un bon choix de services, contenu ou logiciels, Funai Corporation Inc. ne garantit pas un accès continu à tout service, contenu ou logiciel spécifique.

7 Press OK to exit.

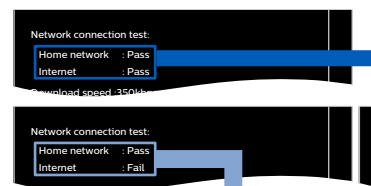

Press OK to exit.

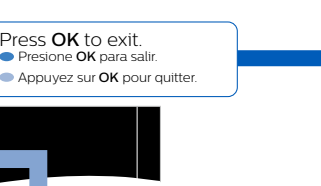

Enjoy your NetTV!



Please verify your settings and try again. Refer to page 9 of the User manual for detailed instructions.

- ES Verifique su configuración e intente nuevamente. Refiérase a la página 9 del Manual del usuario para instrucciones detalladas.
- FR Vérifiez les paramètres et réessayez. Pour obtenir des instructions supplémentaires, consultez la page 9 du Manuel d'utilisation.

Network service icons may differ according to the country you set.

- ES Los iconos de servicio de red pueden diferir de acuerdo al país que configure.
- FR Les icônes de service de réseau peuvent varier selon le pays sélectionné.

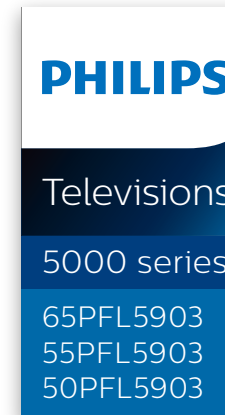

# Quick start guide

ES Guía de inicio rápido FR Guide de démarrage rapide

The pages in Quick start guide are based on User manual which is provided with product.  
Las páginas de la Guía de inicio rápido se basan en el Manual del usuario que se proporciona con el producto.  
Les pages du Guide de démarrage rapide sont basées sur le Manuel d'utilisation fourni avec le produit.

If you have any questions or need a detailed manual, please visit our support website at

- ES Si tiene cualquier pregunta o necesita un manual detallado, por favor visite nuestro sitio web de soporte en
- FR Si vous avez des questions ou avez besoin d'un manuel détaillé, veuillez visiter notre site de soutien au

www.philips.com/support



# 1 What's in the box

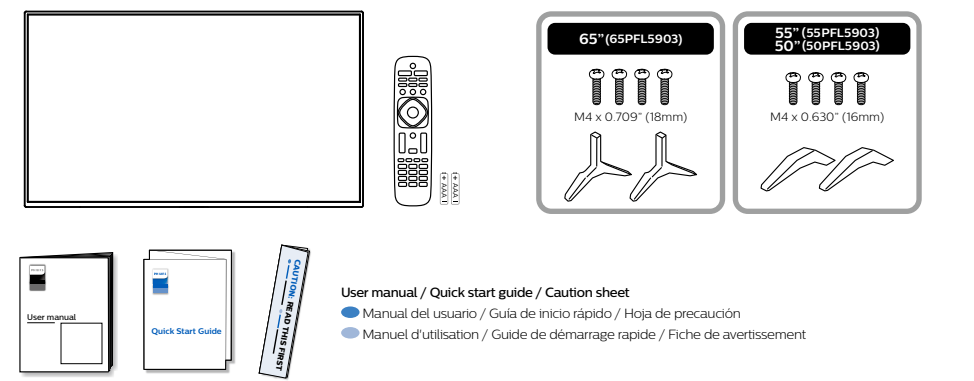

# 2 Installing the stands

Refer to the Caution sheet for instructions on how to install the stand.

If you plan to wall mount your TV, refer to page 3 of the User manual for recommended wall mount bracket kit.

# 3 Connect the power and antenna, cable or satellite

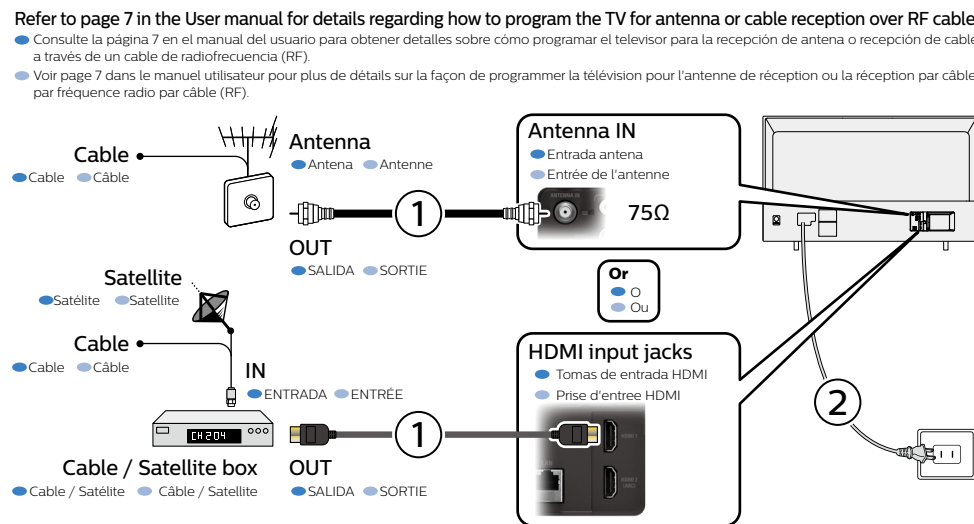

# 4 Connection overview

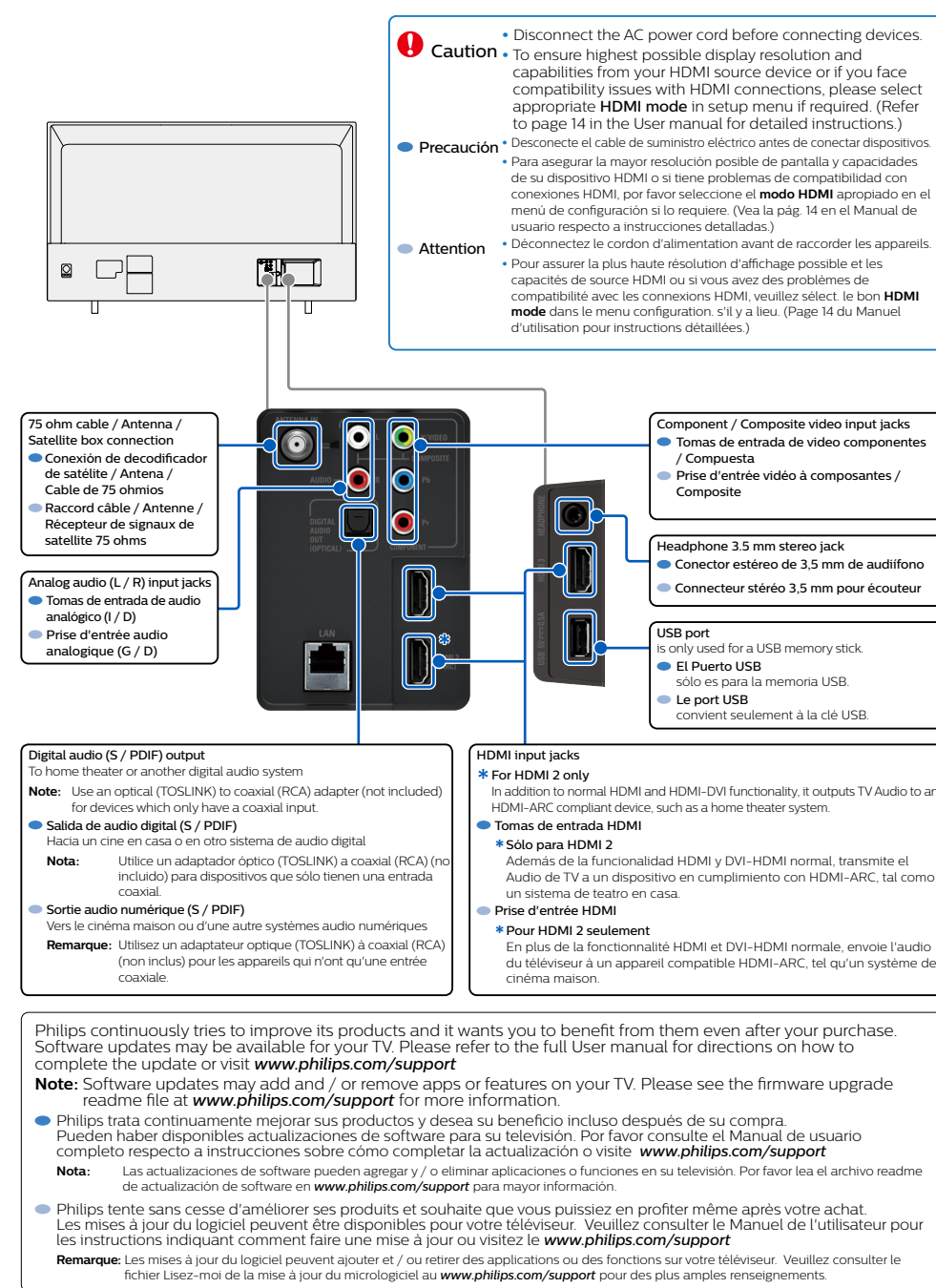

# 5 Connect to external devices

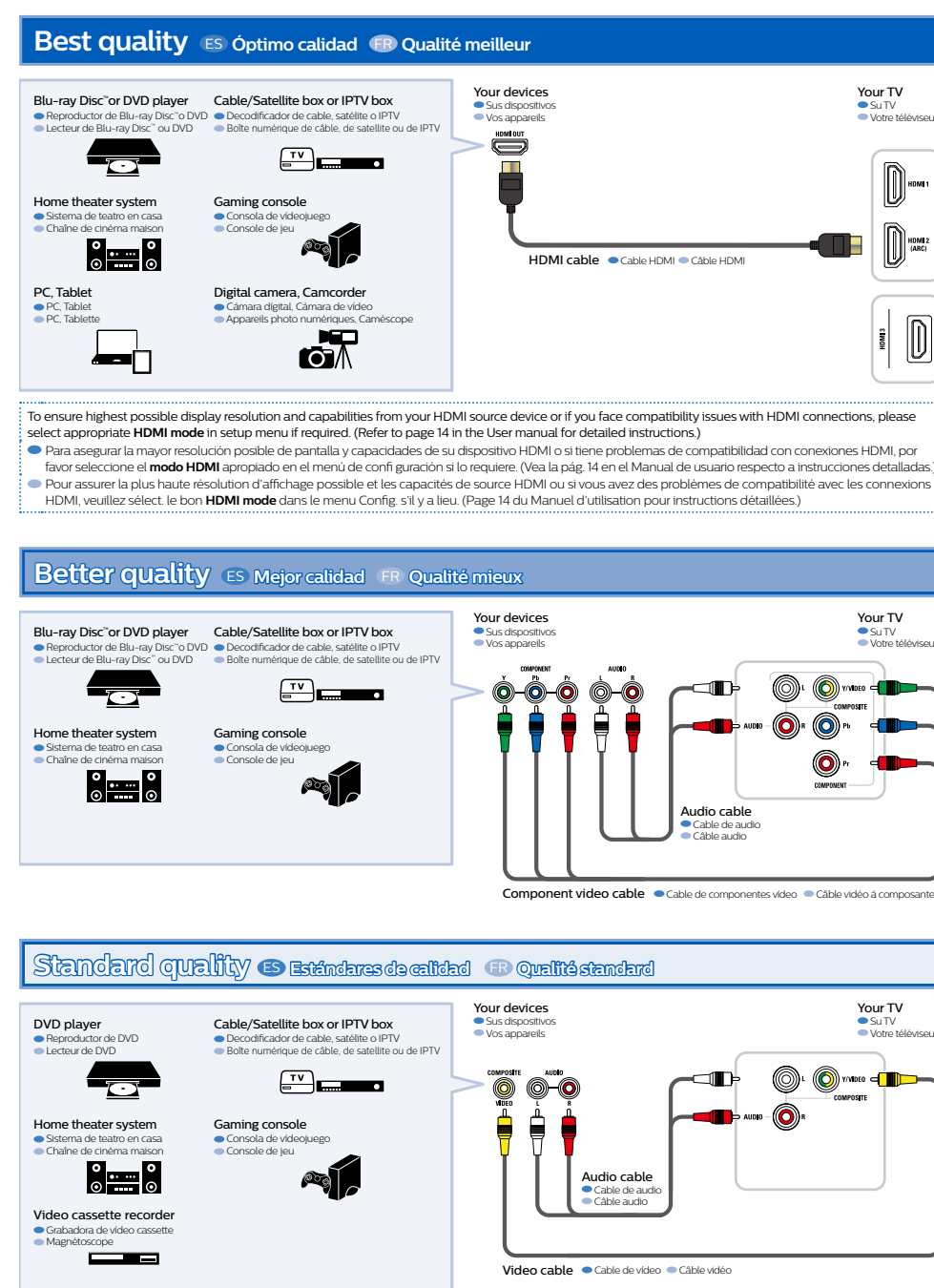

# 6 Control panel

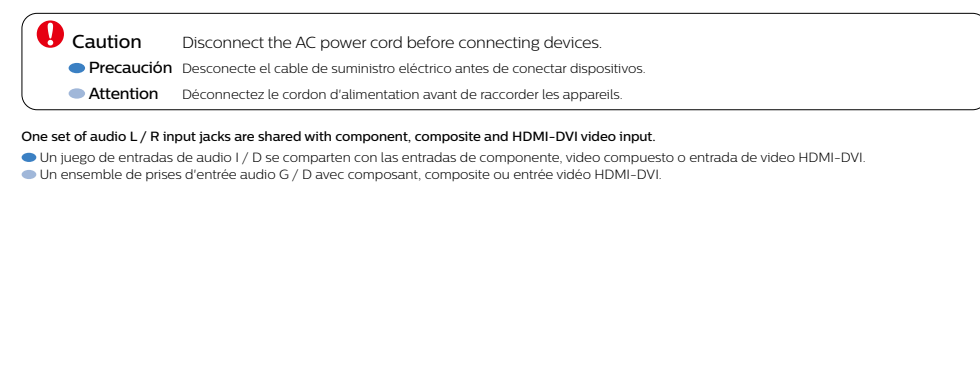

# 7 Initial setup

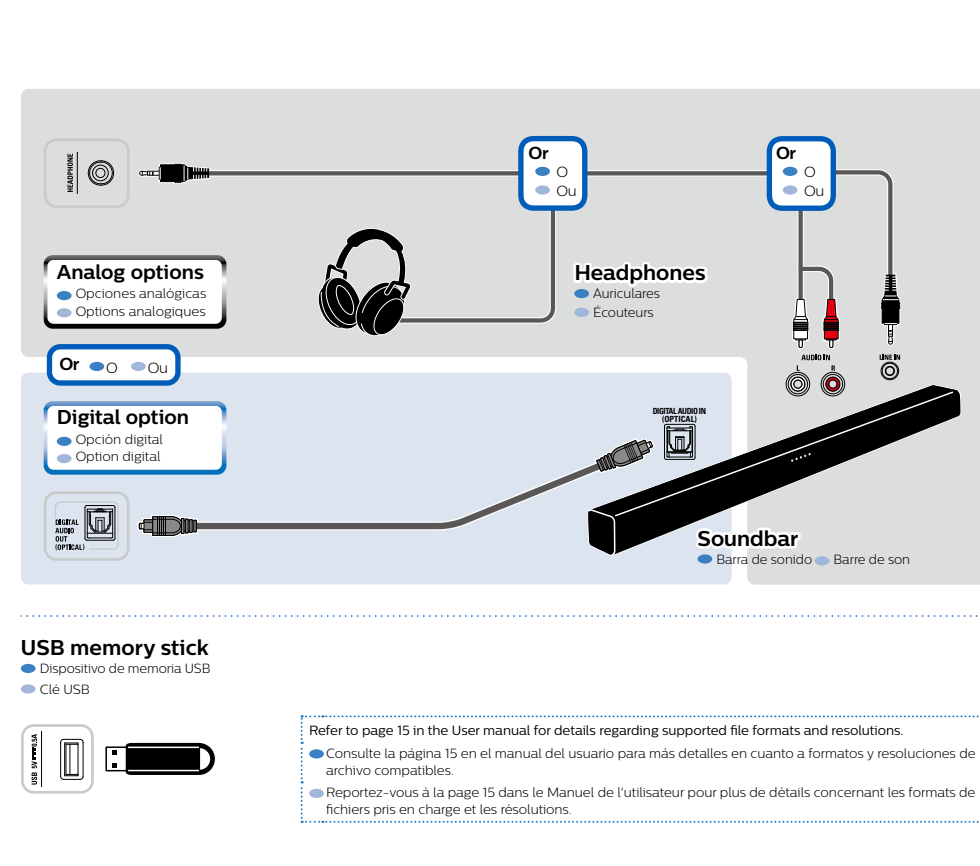

# 8 Remote control sensor

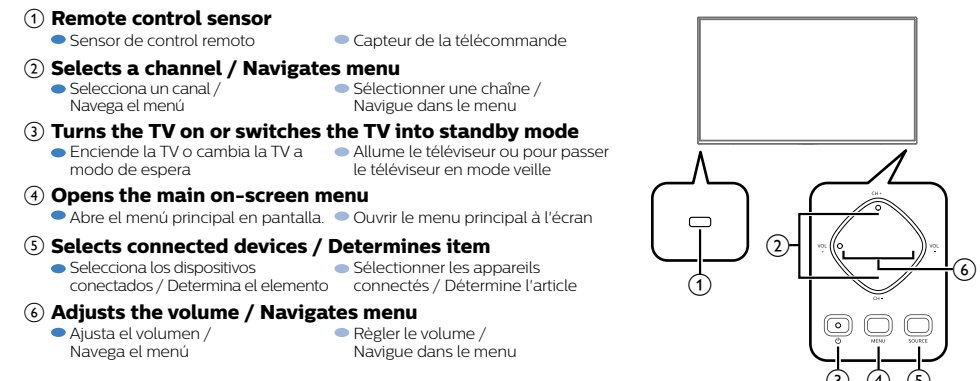

# 9 Selects a channel / Navigates menu

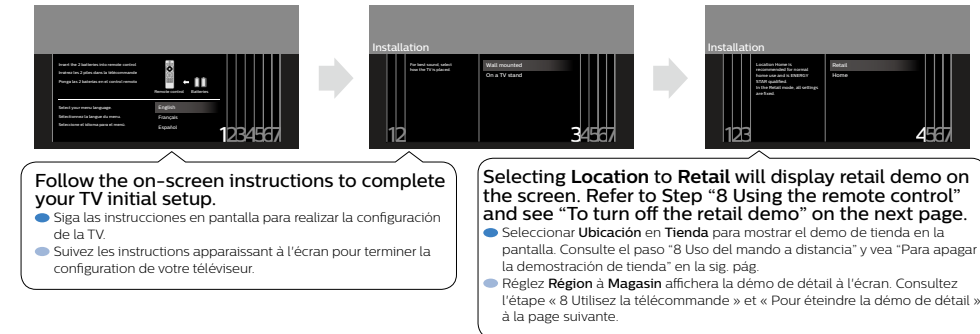

# 10 Turns the TV on or switches the TV into standby mode

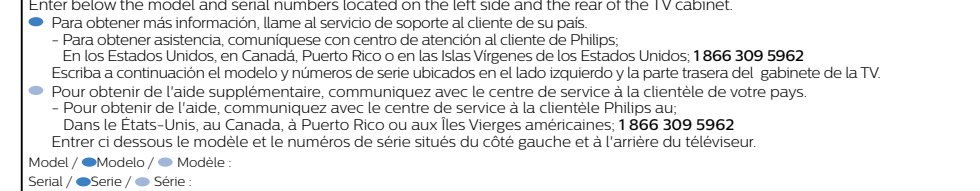

# 11 Opens the main on-screen menu



# 12 Selects connected devices / Determines item



# 13 Adjusts the volume / Navigates menu



Philips continuously tries to improve its products and it wants you to benefit from them even after your purchase. Software updates may be available for your TV. Please refer to the full User manual for directions on how to complete the update or visit [www.philips.com/support](http://www.philips.com/support)

Philips trata continuamente mejorar sus productos y desea su beneficio incluso después de su compra. Pueden haber disponibles actualizaciones de software para su televisión. Por favor consulte el Manual de usuario completo respecto a instrucciones sobre cómo completar la actualización o visite [www.philips.com/support](http://www.philips.com/support)

Philips tente sans cesse d'améliorer ses produits et souhaite que vous puissiez en profiter même après votre achat. Les mises à jour du logiciel peuvent être disponibles pour votre téléviseur. Veuillez consulter le Manuel de l'utilisateur pour les instructions indiquant comment faire une mise à jour ou visitez le [www.philips.com/support](http://www.philips.com/support)

For further assistance, call the customer support service in your country. To obtain assistance, contact Philips customer care center. In the U.S.A., Canada, Puerto Rico, or the U.S. Virgin Islands 1 866 309 5962. Enter below the model and serial numbers located on the left side and the rear of the TV cabinet.

For complete instructions, please visit [www.philips.com/support](http://www.philips.com/support) to download the full version of the online user manual.

This product has been manufactured by and is sold under the responsibility of Funai Corporation, Inc., and Funai Corporation, Inc. is the warrantor in relation to this product.

