

PHILIPS

EasyKey

7000 series

Smart Lever Door
Lock

7300

User manual

Bluetooth Edition
Register products and get
support on the following sites

www.philips.com/support



Contents

1 Important info	02	5 How to use your EasyKey	16
Security		Unlock	
Caution		Unlock from outside	
Disposal of used products and batteries		-With PIN code	
		-With fingerprint	
		-With card	
		Unlock from inside	
		-With handle	
		Lock	
		-Lock from outside	
		-Lock from inside	
		Deadlock from inside	
		Auto and manual modes	
		Mechanical key opening	
2 Install your EasyKey	03	6 Other functions	18
Packaging list		Safe handle function	
Exploded views		Restore to factory settings	
Pre-installation instructions		One-button mute function	
Installation steps		Outside forced lock function	
3 Get to know your EasyKey	09	7 Meaning and use of indicators	20
Outside escutcheon		Door lock status indicator	
Inside escutcheon		Low battery indicator	
		Outside forced lock mode indicator	
		Mute mode indicator	
		System lock indicator	
		[CLOSE] button indicator	
4 How to set up your EasyKey	10	8 Troubleshooting	22
-Modify master PIN code		Alarm types and alarm modes	
-User settings		How to apply an emergency power supply	
-Delete a user		How to replace batteries	
-System settings			
-Extended functions			
-System query			
-Local query			

1 Important info

Security

- ◆ Before using Philips EasyKey, please read and understand all instructions. Damage caused by non-compliance with the instructions will not be covered by warranty.
- ◆ Use only the manufacturer-specified accessories/components.
- ◆ Use only the alkaline batteries the product is equipped with, or use the same specification type of alkaline batteries.
- ◆ Do not forcibly disassemble this product to avoid triggering an alarm or damaging the product.
- ◆ Do not scrape the fingerprint sensor with sharp objects, otherwise it may cause permanent damage.
- ◆ Do not expose products to environments where there is water leakage or splashing.
- ◆ Do not expose the product to corrosive substances to prevent damaging the protective cover.
- ◆ Do not hang objects on the handle, in case it might affect the normal use of the lock.
- ◆ Please clean the product with a soft cloth.
- ◆ Do not remove the battery during setting up and operating.
- ◆ Please let a professional technician to install the door lock and follow the installation guidelines provided. Do not disassemble the lock by yourself. Keep the relevant sealed stickers properly. Do not easily disclose the password information.
- ◆ Please modify the default master PIN code immediately after installation and configuration, and keep the mechanical key properly.
- ◆ Please replace all the batteries immediately if there is a low battery alarm. Please make sure to correctly match the poles (+/-) when installing the batteries.

Caution

- ◆ Do not place the battery near a fire to avoid an explosion.
- ◆ Do not use any emergency power supply that does not meet the safety requirements to power up the product.
- ◆ Do not connect the 2 poles of the batteries with metals to avoid short circuit which may lead to an explosion.
- ◆ Please make sure any component replacement is executed by Philips, Philips authorized service center or professional technicians.
- ◆ Do not use accessories or parts that have been produced by other manufacturers or have not been specifically recommended by Philips. Use of such accessories and parts may void your warranty.

Disposal of used products and batteries

- ◆ You can have your locks reclaimed at Philips authorized service centers. You will receive corresponding compensation if your products meet our conditions.
- ◆ Please learn by yourself the local electronic product classification and collection system.
- ◆ Please abide by local regulations and do not mix used products with ordinary domestic waste.
- ◆ Proper disposal of used products can help to avoid potential negative impacts on the environment and human health.
- ◆ This product contains batteries which can not be disposed of together with domestic waste.
- ◆ Please learn the local regulations concerning battery classification and collection by yourself. Proper disposal of used batteries can help to avoid negative impacts on environment and human health.

2. Install your EasyKey

Packaging list

This packaging list is for reference only. Please refer to the actual packaging contents.

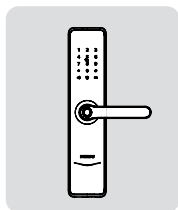

① Outside escutcheon (including silicone pad)

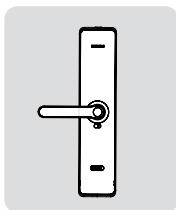

② Inside escutcheon (including silicone pad)

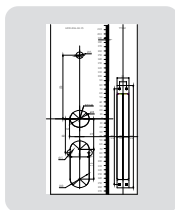

③ Drilling template

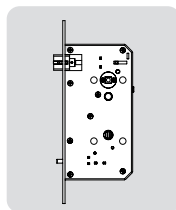

④ Mortise

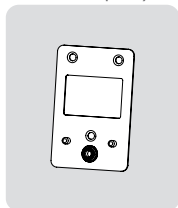

⑤ Mounting plate



⑥ User manual



⑦ Quick start guide



⑧ Warranty card



⑨ Certificate of Quality

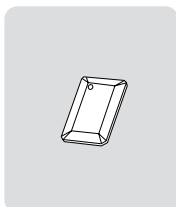

⑩ Smart door card x2

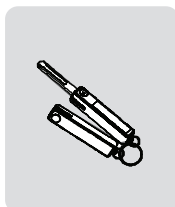

⑪ Mechanical key x2

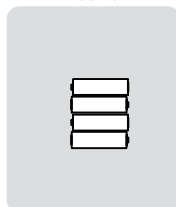

⑫ Batteries

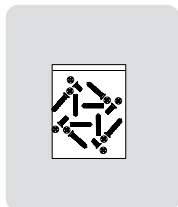

⑬ Installation kit

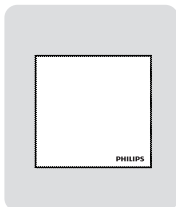

⑭ Scouring pad

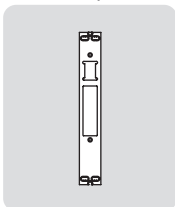

Striker

Exploded Views

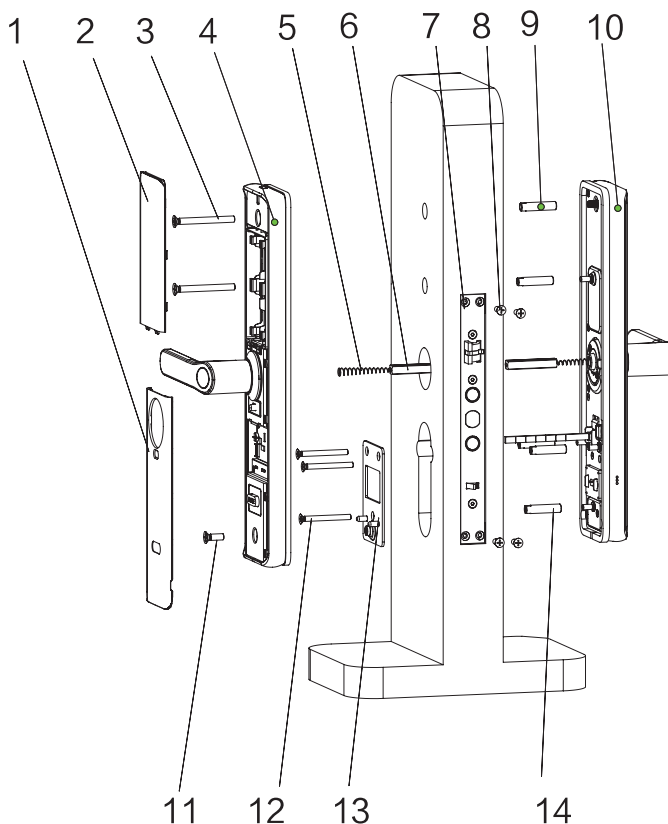

1. Inner escutcheon
bottom part (x1)

2. Battery cover(x1)

3. M6 fixed screw (x2)

4. Inner escutcheon(x1)

5. Square shaft
compressed spring (x2)

6. Square shaft (x2)

7. Mortise(x1)

8. Fixed screw (x4)

9. M6 connecting
screw tube (x2)

10. Outer escutcheon(x1)

11.M6 fixed screw (x1)

12.M5 fixed screw (x3)

13. Mounting plate (x1)

14. M5 connecting
screw tube (x3)

Pre-installation instructions

Step 1 | Check the door opening direction

This product can be installed on doors of 4 types of opening directions: left-out pull, right-in push, right-out pull and left-in push.

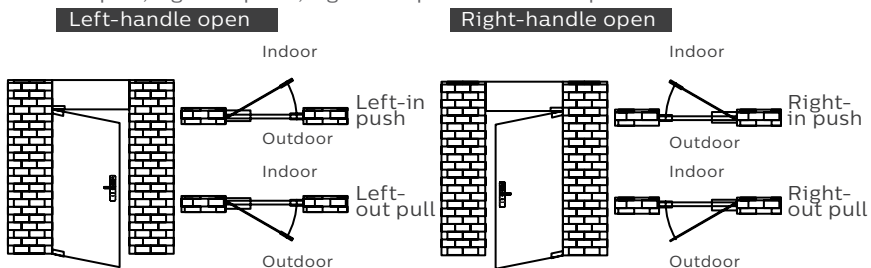

Step 2 | Change the handle direction

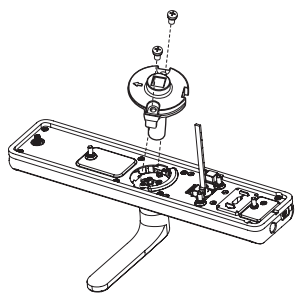

- 1 Unscrew the screws and remove the direction adjustment stand.

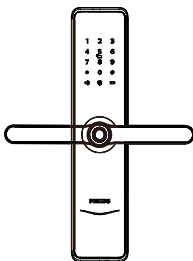

- 2 Rotate the handle to 180 degrees for optimal placement.

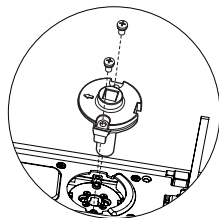

- 3 Adjust the cable to the specific place, put the direction adjustment stand back and then tighten the screws.

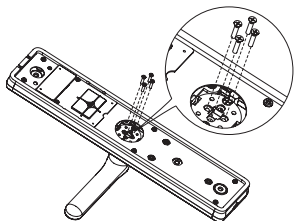

- 1 Unscrew the screws.

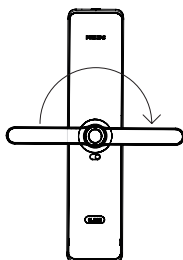

- 2 Rotate the handle to 180 degrees for optimal placement.

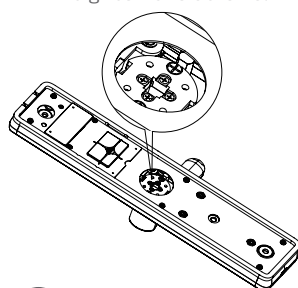

- 3 Tighten the screws.

Step 3 | Change the latch bolt direction

You can change the direction of the latch bolt to adapt to doors of different opening directions. When the bolt bevel faces out the door, it is for outwards door opening; And when the bolt bevel faces in the door, it is for inwards door opening.

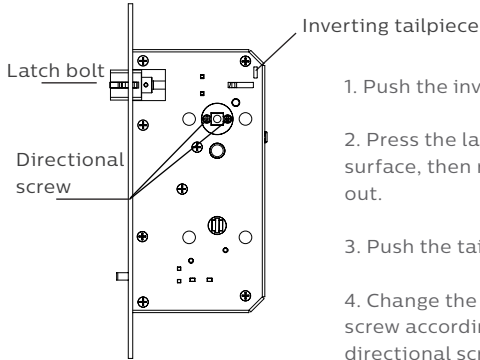

1. Push the inverting tailpiece to the top.
2. Press the latch bolt down to the mortise surface, then rotate it 180 degrees and pull it out.
3. Push the tailpiece to the bottom.
4. Change the direction of the directional screw according to your actual needs (the directional screw must be installed on the inside of the door, i.e. the inside escutcheon)

⚠ Attention

1. Choose a proper installation kit based on the door thickness;
2. The default tool kit is applicable to door thickness of 38-60mm. If your door thickness is out of this range, please contact us.

Installation steps

The following installation steps apply to right-open doors. For left-open doors, please read the [Pre-installation instructions] carefully and make needed adjustments.

- 1 Use the drilling template to drill the needed holes on the door and mount the mortise into the door.
- 2 Tighten up the 4 fixed screws when inserting the mortise.

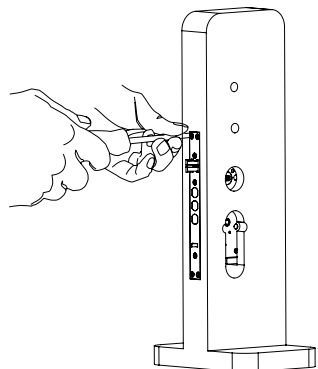
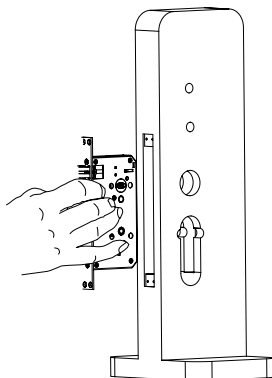

- 3 Install the connecting screw tube, and place the square shaft and compressed spring into the hole of the lever. (The square shaft compressed spring must be put towards the lever)

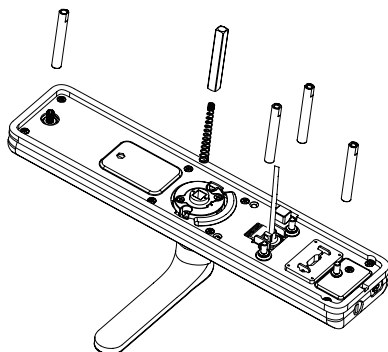

⚠ Attention

Please cut the key tailpiece according to your needs and use square shaft and connecting screw tube with proper length to fix the screw tube.

- 4 Pass the connection wire through the hole on the mortise. Align the cylinder key tailpiece and the square shaft with the 2 rotary holes on the mortise, and insert them to make sure the outside escutcheon is kept close to the outside of the door.

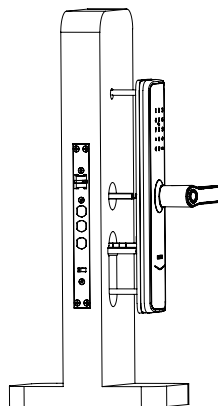

- 5 Tighten up the mounting plate with 3 anchor screws against the inside of the door.

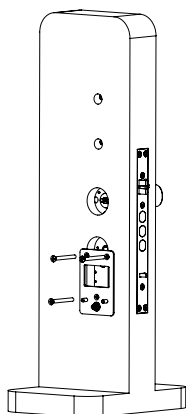

- 6 Put the compressed spring, then the square shaft into the inside escutcheon. Insert the outside escutcheon connection wire and mortise wire into the corresponding sockets on the inside escutcheon. Align the square shaft to the rotary holes on the mortise and insert them to make the inside escutcheon close to the inside of the door.

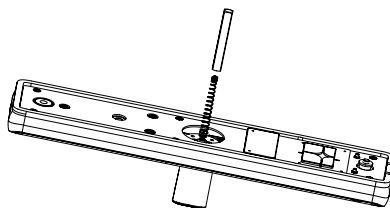

⚠ Attention

Please make sure the extra connection wire is hidden in the door hole.

- 7 Tighten the 2 anchor screws.

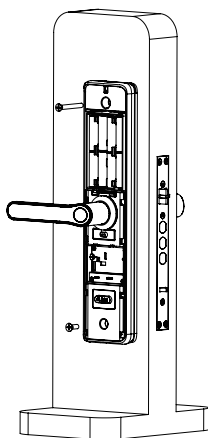

- 8 Install the batteries, then the battery cover and the inside lower cover.

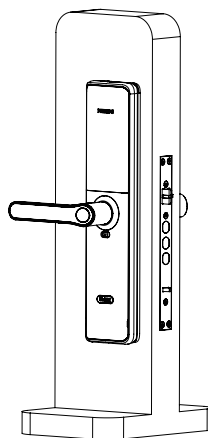

- 9 Try the inside and outside levers, the mechanical key and check if all components are well connected.

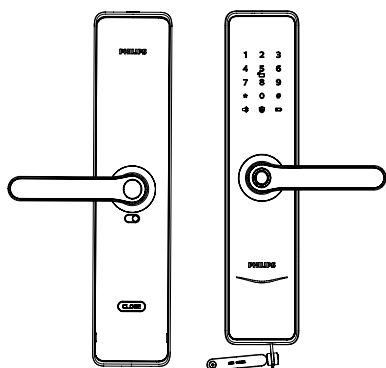

3 Get to know your EasyKey

Outside escutcheon

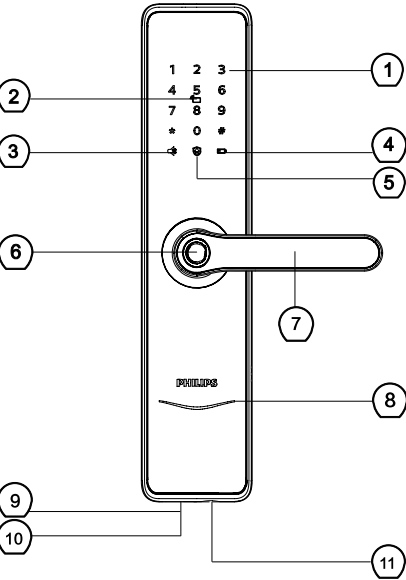

1	Keypad
2	Card reader
3	Mute button
4	Low battery indicator
5	Outside forced lock button
6	Fingerprint sensor
7	Lever
8	Door status indicator
9	Emergency power interface
10	Reset button
11	Mechanical key hole

Inside escutcheon

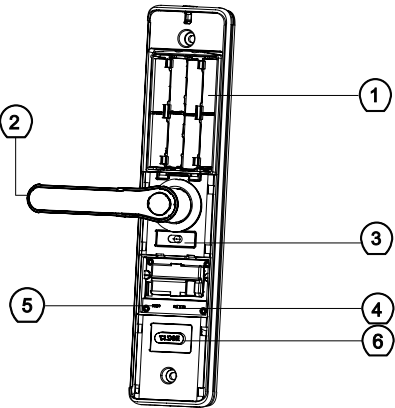

1	Battery cover
2	Lever
3	Safe handle switch
4	A/M mode switch
5	Reset button
6	Close button

4. How to set up your EasyKey

Pre-setup Instructions:

◆There are 2 operating modes in the EasyKey: General mode and dual verification mode.

General mode	Dual verification mode
Unlock with any registered identity information	Unlock with any two of PIN code, card and fingerprint

◆User Number

You can delete a single user information by its user number without having to delete everything in the system.

◆You can record the user information in the following table for future query.

Number	Name	Fingerprint	PIN Code	Card
00				
01				
02				
03				
04				
05				
06				
07				
08				
09				

◆Icon annotation



Master PIN code

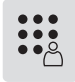

One-time user PIN code



Visitor PIN code



User PIN code



User number 00-09



User number 00-99



Register a fingerprint



Register a card



key

⚠Attention

- 1.Press [*] key to return to the previous menu.
2. The default master PIN code is 12345678.

◆How to enter master mode:

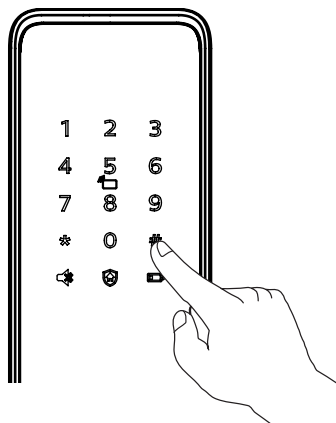

① Press [#] key before inputting any other numbers. After hearing a voice prompt of "Enter master PIN code", enter your master PIN code and confirm with [#]. Then you are in master mode.

Modify master PIN code



Press [#], enter master PIN code and confirm with [#].

1

Press [1] to modify master PIN code.



Enter the new master PIN code and confirm with [#]. Re-enter the new master PIN code and confirm with [#]. After hearing a voice prompt of "Succeeded", press [*] several times until you exit master mode.

User settings

Register a user PIN code



Press [#], enter master PIN code and confirm with [#].

2 1

Press [2] to enter user registration, then press [1] to register a new user PIN code, which will be automatically numbered and broadcasted by the system.



Enter a user PIN code of 6 to 12 digits, and confirm with [#]. Then re-enter the user PIN code and confirm with [#]. After hearing a voice prompt of "Succeeded", press [*] several times until you exit master mode.

Register a one-time user PIN code



Press [#], enter master PIN code and confirm with [#].

2 2

Press [2] to enter user settings, then press [2] again to enter one-time PIN code registration.



Enter a one-time user PIN code of 6 to 12 digits and confirm with [#]. Re-enter the user PIN code and confirm with [#]. After hearing a voice prompt of "Succeeded", press [*] several times until you exit master mode.

Register a fingerprint



Press [#], enter master PIN code and confirm with [#].



Press [2] to enter user settings, then press [3] to enter fingerprint registration. The system will automatically number the fingerprint and broadcast the number.



Place your finger against the sensor. After hearing a voice prompt of "Take away your finger and enroll again", please take away your finger and re-place it against the sensor. After hearing a voice prompt of "Succeeded", press [*] several times until you exit master mode.

Register a card



Press [#], enter master PIN code and confirm with [#].



Press [2] to add a new user, then press [4] to enter card registration. The system will automatically number the card and broadcast the number.



Hold the card close to the card reader until you hear a beep. After hearing a voice prompt of "Succeeded", press [*] several times until you exit master mode.

User Information Deletion

Delete a user PIN code



Press [#], enter master PIN code and confirm with [#].



Press [3] to enter user deletion, then press [1] to enter user PIN code deletion. Press [1] again to delete a single user PIN code.



Enter the 2-digit [user number] (00-09) of the user PIN code that is to be deleted and press [#] to confirm. After hearing a voice prompt of "Succeeded", press [*] several times until you exit master mode.

Delete all user PIN codes



Press [#], enter master PIN code and confirm with [#].



Press [3] to enter user deletion, then press [1] to enter user PIN code deletion. Press [2] to delete all user PIN codes. After hearing a voice prompt of "Succeeded", press [*] several times until you exit master mode.

Delete a one-time user PIN code



Press [#], enter master PIN code and confirm with [#].



Press [3] to enter user deletion, then press [2] to enter one-time user PIN code deletion.



After hearing a voice prompt of "Succeeded", press [*] several times until you exit master mode.

Delete a fingerprint



Press [#], enter master PIN code and confirm with [#].



Press [3] to enter user deletion, then press [3] again to enter fingerprint deletion. Press [1] to enter single fingerprint deletion.



Enter the 2-digit [user number] (00-99) of the fingerprint that is to be deleted and confirm with [#]. After hearing a voice prompt of "Succeeded", press [*] several times until you exit master mode.

Delete all fingerprints



Press [#], enter master PIN code and confirm with [#].



Press [3] to enter user deletion, then press [3] again to enter fingerprint deletion. Press [2] to delete all fingerprints. After hearing a voice prompt of "Succeeded", press [*] several times until you exit master mode.

Delete a card



Press [#], enter master PIN code and confirm with [#].



Press [3] to enter user deletion, then press [4] to enter card deletion. Press [1] to delete a single card and then press [*] several times until you exit master mode.

Delete all cards



Press [#], enter master PIN code and confirm with [#].



Press [3] to enter user deletion, then press [4] to enter card deletion. Press [2] to delete all cards. After hearing a voice prompt of "Succeeded", press [*] several times until you exit master mode.

System date initialization

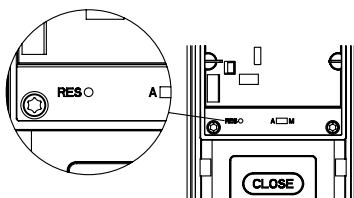

Remove the inside lower cover and double click the [RES] button with a sharp object, until you hear a voice prompt of "Restored to factory settings". All user information will be emptied.

Language Settings



Press [#], enter master PIN code and confirm with [#].



Press [4] to enter system settings, then press [1] to enter language settings.



Adjust the language to needed: For Chinese, press [1]; for English, press [2]. After hearing a voice prompt of "Succeeded", press [*] several times until you exit master mode.

⚠ Attention

The default language is English.

Volume settings



Press [#], enter master PIN code and confirm with [#].



Press [4] to enter system settings, then press [2] to enter volume settings.

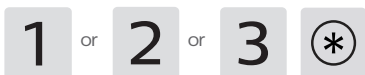

Adjust the volume as needed: For higher volume, press [1]; for lower volume, press [2]; for mute mode, press [3]. After hearing a voice prompt of "Succeeded", press [*] several times until you exit master mode.

⚠ Attention

The default volume is "higher volume".

System settings

Switch to dual verification mode



Press [#], enter master PIN code and confirm with [#].



Press [4] to enter system settings, then press [3] to choose verification method.



For single verification, press [1]; for dual verification, press [2]. After hearing a voice prompt of "Succeeded", press [*] several times until you exit master mode.

Extended Functions



Press [#], enter master PIN code and confirm with [#].



Press [5] to enter extended functions.

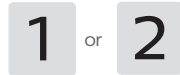

To join a network, press [1]. To exit a network, press [2]. Before setting up the extended functions, please download and open the Philips EasyKey APP via your mobile phone.

⚠ Attention

The extended functions are optional.

System Query

Anti-fake code query



Press [#], enter master PIN code and confirm with [#].



Press [6] to enter system query, then press [1] to get the serial number (anti-fake code) automatically broadcasted.

Attention

Enter 400# is a shortcut to start system query.

Local Query



Press [#], enter master PIN code and confirm with [#].



Press [6] to enter system query, then press [2] to get the software version automatically broadcasted.

Attention

Enter 114# is a shortcut to start local query.

Bluetooth Settings



Press [#] and input master Pin code, then press [#] to confirm.



Press [7] to enter Bluetooth settings.



To disable Bluetooth, press [3]. After hearing a voice prompt of "Settings succeeded", press [*] back to previous menu until you exit master mode.

Attention

1. Bluetooth switch shortcut, directly input 403# to open the Bluetooth module, input 404# to turn off the Bluetooth module.
2. When the Bluetooth is off, please press [1] to enable Bluetooth.

5.How to use your EasyKey

Unlock | Unlock from outside

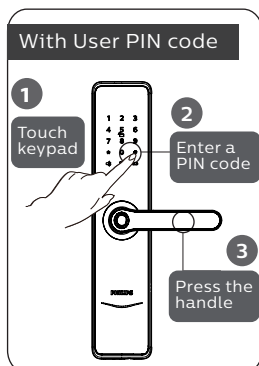

- ① Touch the keypad to wake up the system.
- ② Enter the registered user PIN code and confirm with [#].
- ③ After hearing a voice prompt of "Door opened", press down the handle to open the door.

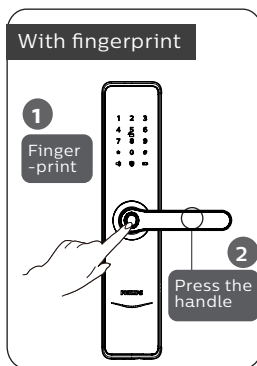

- ① Place your registered finger properly on the sensor.
- ② After hearing a voice prompt of "Door opened", press down the handle to open the door.

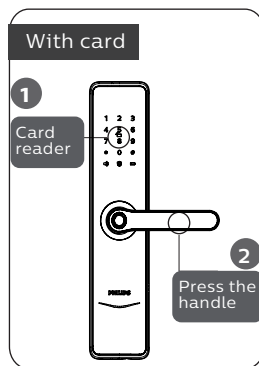

- ① Place your registered card on the card reader.
- ② After hearing a voice prompt of "Door opened", press the handle to open the door.

Unlock | Unlock from inside

With handle

Philips EasyKey employs indoor fast opening motise allowing you to directly press down the handle to unlock.

⚠ Attention

When you want to open the door from inside, please make sure the safe handle switch is toggled to green scale and the safe handle function is disabled.

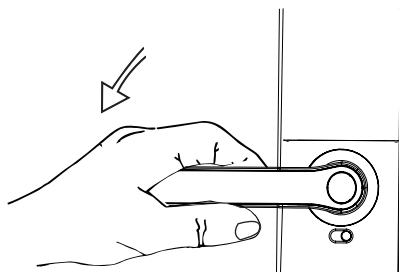

Lock | Lock from outside/inside

Lock from outside

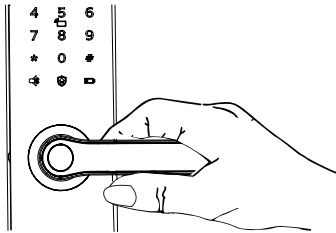

The sensor bolt can detect the signal when you close the door, and the motor will drive the main dead bolt to let it automatically pop up and lock the door.

Lock from inside

The sensor bolt can detect the signal when you close the door, and the motor will drive the main dead bolt to let it automatically pop up and lock the door.

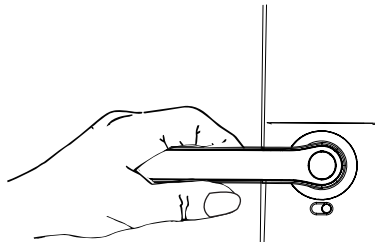

Dead lock from inside

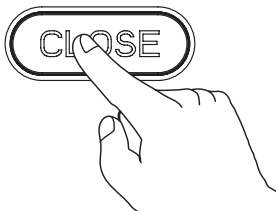

After the door is locked, long press the [CLOSE] button until the button flashes in red and there is a voice prompt of "Inside deadlock enabled".

⚠ Attention

Under inside deadlock mode, all functions of the outside escutcheon will be locked. If you try to wake up the system manually, the keypad area will display the combination of "15937(X)" and there will be a voice prompt of "Inside deadlock enabled" reminding you that the door has been dead locked from inside.

Under deadlock mode, all operations on the outside escutcheon are disabled. Master PIN code verification or mechanical key opening is required to unlock the door from deadlock mode.

Auto and manual modes

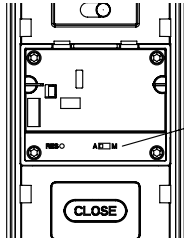

Switch
between auto/
manual modes



[A] represents Auto mode. The dead bolt will pop up automatically after closing the door and the door will be locked.



[M] represents Manual mode. The dead bolt will not pop up automatically after closing the door and the door will stay open.

Lock from outside the door



Under Auto Mode, shutting the door will make the dead bolt automatically pop up and there will be a voice prompt of “Door closed”.



Under Manual Mode, the dead bolt won't pop up automatically after shutting the door. Only fingerprint, card or PIN code verification can make it automatically pop up. After the door is locked, you will hear a voice prompt of “Door closed”. You can wake up the outside escutcheon to unlock and open the door after the door is closed.

Lock from inside the door



Under Auto Mode, shutting the door will make the deadbolt automatically pop up and there will be a voice prompt of “Door closed”.



Under Manual Mode, the deadbolt won't pop up automatically after shutting the door. Only after you double click the [CLOSE] button within a second can the deadbolt pop up and lock the door. After the door is locked, you will hear a voice prompt of “Door closed”.

Mechanical key opening

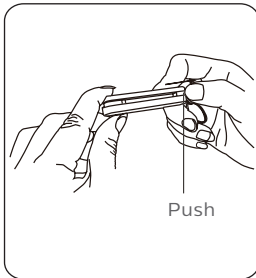

- 1 Cut the box with a scissors and take out the key shell. Push the cover aside and reveal the key itself.

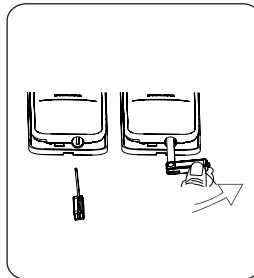

- 2 Insert the key into the key hole and keep the key and key shell vertical to each other. Rotate the key shell towards the handle for 90° until it becomes close to the door surface.

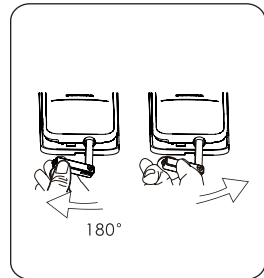

- 3 Rotate the key shell downwards for 180° to make the key shell parallel to the ground. Then rotate the key shell horizontally towards the handle to unlock the door.

⚠ Attention

It is suggested that not to use the mechanical key for daily unlocking. Use the key for emergencies, i.e. when the battery has been ran out of, when you forget the PIN code, or when the system fails to work properly.

6 Other functions

Safe handle function: Lock up the handle from inside

Function:

When safe handle function is enabled, you could lock up the handle from inside, and doors can't be unlocked from inside.

How to use:

1. Enable safe handle function: Toggle the switch to red scale.
2. Disable safe handle function: Toggle the switch to green scale.

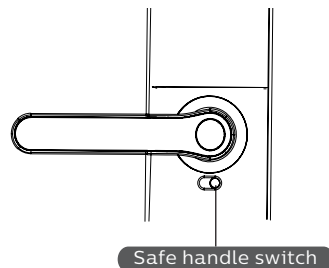

Restore factory settings: one button to return to initial state

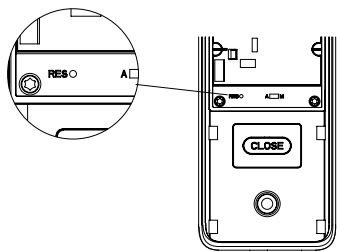

Function:
Empty all user information and restore to factory settings.

How to use:
Double click the [RES] button with a sharp object, and all the user information will be emptied. The lock will be restored to factory settings.

One-button mute function

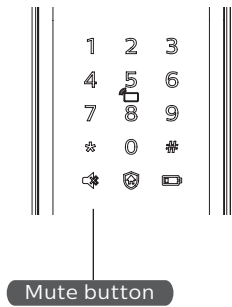

Function:
Use only one button to mute the lock by turning off the voice guide. Applicable to the scenes where you don't want to disturb your family.

How to use:
1. Mute: When the system is awake, long press the [Mute] button for 2 seconds to enter one-time mute mode. The button will glow green.
2. Unmute: When the system is awake, long press the [Mute] button for 2 seconds to restore the voice guide. The button will glow white.

Outside forced lock function

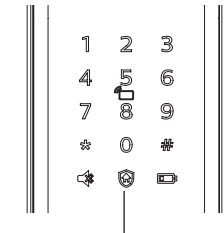

Outside forced lock button

Function:

Unlocking from inside will trigger an alarm.

How to use:

After the door is successfully locked, long press the functional button for 2 seconds to enter the outside forced lock mode.

⚠ Attention

Enabling the outside forced lock function will not affect normal unlocking from outside.

7 Meaning and use of indicators

Lock status indicator

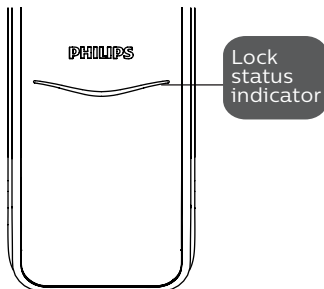

Colors of the light and the corresponding meanings:

Blue: After the system wakes up, the light will glow blue, indicating that you can operate the lock.

Green: After the door is unlocked, the light will glow green, indicating that the door has been opened.

Red: After the door is locked, the light will glow red, indicating that the door has been closed.

Low battery indicator

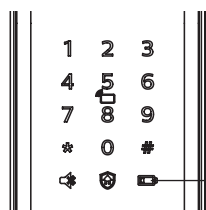

Low battery indicator

Colors of the light and the corresponding meanings:

After waking up, the system will run an automatic examination on the battery voltage. If the voltage is too low, the light will flash in red and there will be a voice prompt of "Low battery. Please replace all batteries" when the door is open.

Outside forced lock indicator

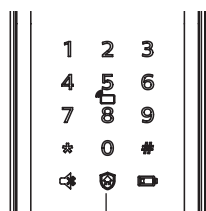

Outside forced lock indicator

Colors of the light and the corresponding meanings:

White:

1. When the door is locked, the light will light up alone, indicating that you can enable the outside forced lock function.

2. If you have enabled the outside forced lock function, the light will light up after the system wakes up, indicating this function is in use.

Mute mode indicator

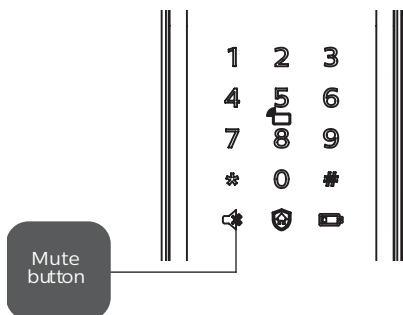

Colors of the light and the corresponding meanings:

1. **White:** Indicates the mute mode is off.

2. **Green:** Indicates the mute mode is on.

System lock indicator

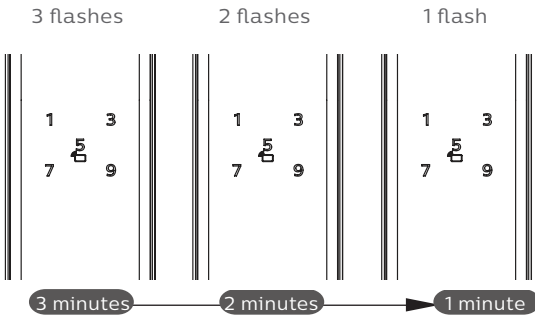

If there are 5 consecutive incorrect inputs of any of the 3 types of verification methods (fingerprint/PIN code/card), the system will be locked for 3 minutes.

⚠ Attention

Only when touching the keyboard panel will the system appear the prompt of system being locked.

[CLOSE] button indicator

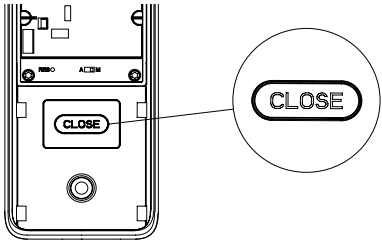

Colors of the light and the corresponding meanings:

1. Red light with 2 flashes: Indicates the door has been locked.
2. Green light with 2 flashes: Indicates the door has been unlocked.
3. Red light with 1 flash: Indicates the door has been dead locked.

8 Troubleshooting

Types of alarms and alarm modes

Low battery alarm, reminding you to replace the batteries in time

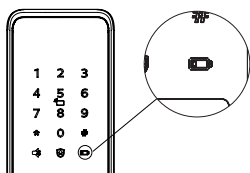

Triggering: After waking up, the system will run an automatic examination on the battery voltage. If the voltage is too low, the lock give an alarm and a voice prompt of “Low battery. Please replace all batteries”.

Alarm mode:A voice prompt of “Low battery. Please replace all batteries” during unlocking.

Turning off: The alarm will be automatically turned off.

Anti-dismantle alarm

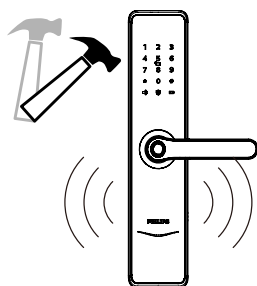

Triggering 1: The door is pried open and the sensor bolt pops up.

Alarm mode: Continuous repeated alarms.

Turning off: The alarm can be turned off automatically or by any one of the successful verification methods.

Triggering 2: Outside escutcheon is pried open and does not tightly fit with the door.

Alarm mode: Continuous repeated alarms.

Turning off: Auto-close, or close after one of the successful verification methods, or close after the normal indoor unlocking.

Abnormal latch bolt alarm

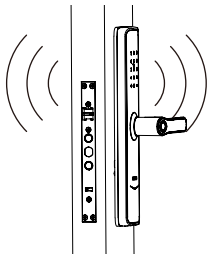

Triggering: The latch bolt performs abnormally and cannot unlock or lock properly.

Alarm mode: Continuous repeated alarms

Turning off: Automatically turned off.

Outside forced unlock mode: inside unlocking alarm

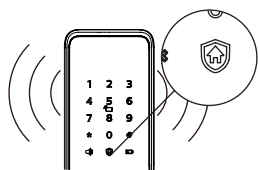

Triggering: If the lock is under outside forced lock mode, unlocking from inside will trigger an alarm.

Alarm mode: Continuous repeated alarms

Turning off: The alarm can be turned off by a successful verification method of any type

How to use an emergency power

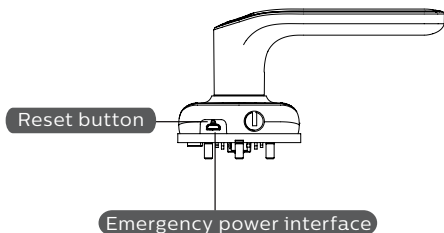

When the battery voltage is insufficient, and the door cannot be opened from the outside, you can power up the lock through the Micro USB interface by using a 5V power bank as an emergency power supply. After opening the door lock, please replace the batteries immediately.

In case of a system crash and it's unable to open the door from outside, please press the Reset button and then release to let it restart automatically.

How to replace batteries

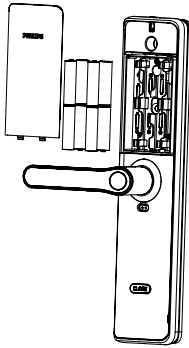

The lock is powered by 4pcs AA alkaline batteries. There are two sets of working power station inside the battery case. Eight batteries can be put in to extend the battery life and reduce battery replacement frequency. The battery case is located at the upper end of the inside escutcheon. By pushing the button at the top of the inside escutcheon, you could take out the battery cover and the batteries inside.



Philips and the Philips Shield Emblem are registered trademarks of Koninklijke Philips N.V. and are used under license. This product has been manufactured by and is sold under the responsibility of Shenzhen Conex Intelligent Technology Co., Ltd., and Shenzhen Conex Intelligent Technology Co., Ltd. is the warrantor in relation to this product.

Version:2.0