

## Safety instructions

Register online at [www.philips.com/welcome](http://www.philips.com/welcome) today to get the most benefits from your purchase.

Registering your model with Philips makes you eligible for all of the valuable benefits listed below, so don't miss out.

Register online at [www.philips.com/welcome](http://www.philips.com/welcome) to ensure:

- Product safety notification** – Registering your product guarantees that you'll receive notification – directly from the manufacturer – in the rare case of a product recall or safety defect.
- Additional benefits** – Registering your product guarantees that you'll receive all of the privileges to which you're entitled, including special money-saving offers.

### Know these safety symbols



**CAUTION: TO REDUCE THE RISK OF ELECTRIC SHOCK, DO NOT REMOVE COVER (OR BACK). NO USER-SERVICEABLE PARTS ARE INSIDE. REFER SERVICING TO QUALIFIED SERVICE PERSONNEL.**

The caution marking is located on the rear or bottom of the cabinet.

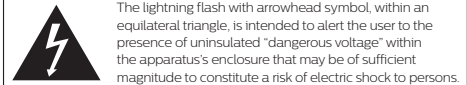

The lightning flash with arrowhead symbol, within an equilateral triangle, is intended to alert the user to the presence of uninsulated "dangerous voltage" within the apparatus's enclosure that may be of sufficient magnitude to constitute a risk of electric shock to persons.



The exclamation point within an equilateral triangle is intended to alert the user to the presence of important operating and maintenance (servicing) instructions in the literature accompanying the apparatus.

**WARNING:** To reduce the risk of fire or electric shock, do not expose this apparatus to rain or moisture. Apparatus shall not be exposed to dripping or splashing and no objects filled with liquids, such as vases, shall be placed on the apparatus.

**CAUTION:** To prevent electric shock, match wide blade of plug to wide slot, fully insert.

**PHILIPS** For fastest support visit us online for chat and self service solutions at [www.philips.com/support](http://www.philips.com/support)

**CHILD SAFETY:** PROPER TELEVISION PLACEMENT MATTERS. THE CONSUMER ELECTRONICS INDUSTRY CARES. Manufacturers, retailers and the rest of the consumer electronics industry are committed to making home entertainment safe and enjoyable. As you enjoy your television, please note that all televisions – new and old – must be supported on proper stands or installed according to the manufacturer's recommendations. Televisions that are inappropriately situated on dressers, bookcases, shelves, desks, speakers, chests, carts, etc., may fall over, resulting in injury.

### TUNE IN TO SAFETY

- ALWAYS** follow the manufacturer's recommendations for the safe installation of your television.
- ALWAYS** read and follow all instructions for proper use of your television.
- NEVER** allow children to climb on or play on the television or the furniture on which the television is placed.
- NEVER** place the television on furniture that can easily be used as steps, such as a chest of drawers.
- ALWAYS** install the television where it cannot be pushed, pulled over or knocked down.
- ALWAYS** route cords and cables connected to the television so that they cannot be tripped over, pulled or grabbed.

### WALL OR CEILING MOUNT YOUR TELEVISION

- ALWAYS** contact your retailer about professional installation if you have any doubts about your ability to safely mount your television.
- ALWAYS** use a mount that has been recommended by the television manufacturer and has a safety certification by an independent laboratory (such as UL, CSA, ETL).
- ALWAYS** follow all instructions supplied by the television and mount manufacturers.
- ALWAYS** make sure that the wall or ceiling where you are mounting the television is appropriate. Some mounts are not designed to be mounted to walls and ceilings with steel studs or cinder block construction. If you are unsure, contact a professional installer.
- Televisions can be heavy. A minimum of two people is required for a wall or ceiling mount installation.

### MOVING AN OLDER TELEVISION TO A NEW PLACE IN YOUR HOME

- Many new television buyers move their older CRT televisions into a secondary room after the purchase of a flat-panel television. Special care should be made in the placement of older CRT televisions.
- ALWAYS** place your older CRT television on furniture that is sturdy and appropriate for its size and weight.
- NEVER** place your older CRT television on a dresser where children may be tempted to use the drawers to climb.
- ALWAYS** make sure your older CRT television does not hang over the edge of your furniture.

CTA.tech/safety Consumer Technology Association

## Important safety instructions

- Read these instructions.
- Keep these instructions.
- Heed all warnings.
- Follow all instructions.
- Do not use this apparatus near water.
- Clean only with dry cloth.
- Do not block any ventilation openings. Install in accordance with the manufacturer's instructions.
- Do not install near any heat sources such as radiators, heat registers, stoves, or other apparatus (including amplifiers) that produce heat.
- Do not defeat the safety purpose of the polarized or grounding-type plug. A polarized plug has two blades with one wider than the other. A grounding type plug has two blades and a third grounding prong. The wide blade or the third prong are provided for your safety. If the provided plug does not fit into your outlet, consult an electrician for replacement of the obsolete outlet.
- Protect the power cord from being walked on or pinched particularly at plugs, convenience receptacles, and the point where they exit from the apparatus.
- Only use attachments / accessories specified by the manufacturer.
- Use only with the cart, stand, tripod, bracket, or table specified by the manufacturer, or sold with the apparatus. When a cart is used, use caution when moving the cart / apparatus combination to avoid injury from tip-over.
- Unplug this apparatus during lightning storms or when unused for long periods of time.
- Refer all servicing to qualified service personnel. Servicing is required when the apparatus has been damaged in any way, such as power-supply cord or plug is damaged, liquid has been spilled or objects have fallen into the apparatus, the power cord has been damaged or rain or moisture, does not operate normally, or has been dropped.

**Note to the CATV system installer:** This reminder is provided to call the CATV system installer's attention to Article 820-40 of the NEC that provides guidelines for proper grounding and, in particular, specifies that the cable ground shall be connected to the grounding system of the building, as close to the point of cable entry as practical.

**Example of antenna grounding as per NEC - National Electric Code**

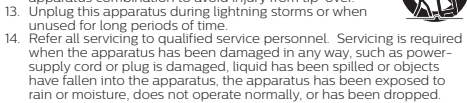

Do not place the unit on the furniture that is capable of being tilted by a child and an adult leaning, pulling, standing or climbing on it. A falling unit can cause serious injury or even death. In order to avoid interruption of ventilation, this unit should not be placed in built-in equipment such as book cabinet, rack, etc., and the vents of this unit should not be covered with anything such as a tablecloth, curtain, newspaper, etc. Make sure there is enough ventilation space (4" / 10 cm or more) around this unit.

Press **Q** to turn the unit on and go into standby mode. To completely turn off the unit, you must unplug the AC power plug from the AC power outlet. Disconnect the AC power plug to shut the unit off when trouble is found or not in use. The AC plug shall remain readily available.

Never use a gas duster on this TV. The gas trapped inside of this unit may cause ignition and explosion.

Trademarks are the property of Koninklijke Philips N.V. or their respective owners. Funai Corporation reserves the right to change products at any time without being obliged to adjust earlier supplies accordingly. The material in document is believed adequate for the intended use of the system. If the product or its individual modules or procedures are used for purposes other than intended herein, confirmation of their validity and suitability must be obtained. Funai Corporation warrants that the material itself does not infringe any United States patent. No further warranty is expressed or implied. Funai Corporation cannot be held responsible neither for any errors in the content of document nor for any problems as a result of the content in document. Errors reported to Funai Corporation will be adapted and published on the Funai Corporation support website as soon as possible.

### Pixel characteristics

This LCD product has a high number of color pixels. Although it has effective pixels of 99.999 % or more, black dots or bright points of light (red, green or blue) may appear constantly on the screen. This is a structural property of the display (within common industry standards) and is not a malfunction.

### Warranty

No components are user serviceable. Do not open or remove covers to the inside of the product. Repairs may only be done by service centers and official repair shops. Failure to do so shall void any warranty, stated or implied. Any operation expressly prohibited in document, any adjustments or assembly procedures not recommended or authorized in document shall void the warranty.

### Positioning the TV

- Large screen TVs are heavy. 2 people are required to carry and handle a large screen TV.
- Make sure to hold the upper and bottom frames of the unit firmly as illustrated.
- Install the unit in a horizontal and stable position.
- Do not install the unit in direct sunlight or in a place subject to dust or strong vibration.

**Disposal of used batteries** The batteries supplied do not contain the heavy metals mercury and cadmium, however, in certain localities, disposing batteries with household waste is not permitted. Please ensure you dispose of batteries according to local regulations.

**Preparing to move / ship the unit** Please pack the unit properly by following the diagram on the carton.

- To avoid damage to the screen, do not pack the stand on the same side as the TV screen, refer to the illustration.

**Federal communications commission notice** This equipment has been tested and found to comply with the limits for a Class B digital device, pursuant to part 15 of the FCC Rules. These limits are designed to provide reasonable protection against harmful interference in a residential installation. This equipment generates, uses and can radiate radio frequency energy and, if not installed and used in accordance with the instructions, may cause harmful interference to radio communications. However, there is no guarantee that interference will not occur in a particular installation. If this equipment does cause harmful interference to radio or television reception, which can be determined by turning the equipment off and on, the user is encouraged to try to correct the interference by one or more of the following measures:

- Reorient or relocate the receiving antenna.
- Increase the separation between the equipment and the receiver.
- Connect the equipment into an outlet on a circuit different from that to which the receiver is connected.
- Consult the dealer or an experienced radio or television technician for help.

**This device complies with part 15 of the FCC rules. Operation is subject to the following two conditions:** (1) This device may not cause harmful interference, and (2) this device must accept interference received, including interference that may cause undesired operation.

**Declaration of conformity** Trade name: PHILIPS Responsible party: Funai Corporation, Inc. Model: 32PFL5505/F7 Address: 21061 S. Western Ave. Suite 210, Torrance, CA 90501, USA Telephone number: 1 833 978 3323

**Modifications** This apparatus may generate or use radio frequency energy. Changes or modifications to this apparatus may cause harmful interference. Any modifications to the apparatus must be approved by Funai Corporation. The user could lose the authority to operate this apparatus if an unauthorized change or modification is made.

**Cables** Connections to this device must be made with shielded cables with metallic RF / EMI connector hoods to maintain compliance with FCC rules and regulations.

**FCC statutory notice for wireless LAN adapter.** FCC caution: Any changes or modifications not expressly approved by the party responsible for compliance could void the user's authority to operate this equipment.

This transmitter must not be co-located or operated in conjunction with any other antenna or transmitter.

**FCC RF Exposure Compliance** This equipment complies with FCC radiation exposure limits set forth for an uncontrolled environment and meets the FCC radio frequency (RF) Exposure Guidelines. This equipment should be installed and operated keeping the radiator at least 20 cm or more away from your body.

**Compliance with FCC requirement 15.407(c)** Data transmission is always initiated by software, which is the passed down through the MAC, through the digital and analog baseband, and finally to the RF chip. Several special packets are initiated by the MAC. These are the only ways the digital baseband portion will turn on the RF transmitter, which it then turns off at the end of the packet. Therefore, the transmitter will be on only while one of the aforementioned packets is being transmitted. In other words, this device automatically discontinue transmission in case of either absence of information to transmit or operational failure.

**Downloading an electronic copy** To obtain a more detailed electronic copy of document:

- Print your browser to: [www.philips.com/support](http://www.philips.com/support)
- Choose your country of location with language.
- Enter the product name or number in the search field. Alternatively, you can browse the catalog.
- Click the description or model.
- Under product support, click "User manual".

**▲ Batteries usage** CAUTION: Danger of explosion if battery is incorrectly replaced. Replace only with the same or equivalent type.

**WARNING:** Batteries (battery pack or battery installed) should not be exposed to excessive heat such as sunshine, fire or the like.

- Do not mix old and new batteries.
- Do not mix alkaline, standard (carbon-zinc) or rechargeable (ni-cad, ni-mh, Li-ion, etc.) batteries.

- Depending on the environment, the temperature of this unit may increase slightly. This is not a malfunction.
- When installing this unit in a temperate environment, avoid a place with rapid temperature changes.
- Operating temperature: 41°F (5 °C) to 104°F (40 °C)
- This unit should not be used in a tropical environment as it has not been evaluated under such conditions.
- No objects should be placed directly on or under this unit, especially lighted candles or other flaming objects.
- Depending on your external devices, noise or disturbance of the picture and / or sound may be generated if the unit is placed too close to them. In this case, please ensure enough space between the external devices and the unit.
- Do not insert the AC power cord into the power socket outlet before all the connectors are made.
- Ensure that you always have easy access to the AC power cord and outlet to disconnect the TV from the AC outlet.
- Before you move the TV, disconnect attached cables to prevent damage to connectors, especially the TV tuner.
- Be sure to unplug the AC power plug from the AC outlet before moving or carrying the unit.
- When moving the TV and then setting it down, please be careful not to pinch the AC power cord under the unit.

**Regulatory notices** **WARNING:** To prevent injury, this apparatus must be securely attached to the furniture / wall in accordance with the instructions.

**WARNING:** Never place a TV in an unstable location. A TV may fall, causing serious personal injury or death. Many injuries, particularly to children, can be avoided by taking simple precautions such as:

- Using cabinets or stands recommended by the manufacturer of the TV.
- Only using furniture that can safely support the TV.
- Ensuring the TV is not overhanging the edge of the supporting furniture.
- Not placing the TV on tall furniture (for example, cupboards or bookcases) without anchoring both the furniture and the TV to a suitable support.
- Not placing the TV on cloth or other materials that may be located between the TV and supporting furniture.
- Educating the children about the dangers of climbing on furniture to reach the TV or its controls.

If your existing TV is being retained and relocated, the same considerations as above should be applied.

Do not place the unit on the furniture that is capable of being tilted by a child and an adult leaning, pulling, standing or climbing on it. A falling unit can cause serious injury or even death. In order to avoid interruption of ventilation, this unit should not be placed in built-in equipment such as book cabinet, rack, etc., and the vents of this unit should not be covered with anything such as a tablecloth, curtain, newspaper, etc. Make sure there is enough ventilation space (4" / 10 cm or more) around this unit.

Press **Q** to turn the unit on and go into standby mode. To completely turn off the unit, you must unplug the AC power plug from the AC power outlet. Disconnect the AC power plug to shut the unit off when trouble is found or not in use. The AC plug shall remain readily available.

Never use a gas duster on this TV. The gas trapped inside of this unit may cause ignition and explosion.

Trademarks are the property of Koninklijke Philips N.V. or their respective owners. Funai Corporation reserves the right to change products at any time without being obliged to adjust earlier supplies accordingly. The material in document is believed adequate for the intended use of the system. If the product or its individual modules or procedures are used for purposes other than intended herein, confirmation of their validity and suitability must be obtained. Funai Corporation warrants that the material itself does not infringe any United States patent. No further warranty is expressed or implied. Funai Corporation cannot be held responsible neither for any errors in the content of document nor for any problems as a result of the content in document. Errors reported to Funai Corporation will be adapted and published on the Funai Corporation support website as soon as possible.

### Pixel characteristics

This LCD product has a high number of color pixels. Although it has effective pixels of 99.999 % or more, black dots or bright points of light (red, green or blue) may appear constantly on the screen. This is a structural property of the display (within common industry standards) and is not a malfunction.

### Warranty

No components are user serviceable. Do not open or remove covers to the inside of the product. Repairs may only be done by service centers and official repair shops. Failure to do so shall void any warranty, stated or implied. Any operation expressly prohibited in document, any adjustments or assembly procedures not recommended or authorized in document shall void the warranty.

### Positioning the TV

- Large screen TVs are heavy. 2 people are required to carry and handle a large screen TV.
- Make sure to hold the upper and bottom frames of the unit firmly as illustrated.
- Install the unit in a horizontal and stable position.
- Do not install the unit in direct sunlight or in a place subject to dust or strong vibration.

**Disposal of used batteries** The batteries supplied do not contain the heavy metals mercury and cadmium, however, in certain localities, disposing batteries with household waste is not permitted. Please ensure you dispose of batteries according to local regulations.

**Preparing to move / ship the unit** Please pack the unit properly by following the diagram on the carton.

- To avoid damage to the screen, do not pack the stand on the same side as the TV screen, refer to the illustration.

**Federal communications commission notice** This equipment has been tested and found to comply with the limits for a Class B digital device, pursuant to part 15 of the FCC Rules. These limits are designed to provide reasonable protection against harmful interference in a residential installation. This equipment generates, uses and can radiate radio frequency energy and, if not installed and used in accordance with the instructions, may cause harmful interference to radio communications. However, there is no guarantee that interference will not occur in a particular installation. If this equipment does cause harmful interference to radio or television reception, which can be determined by turning the equipment off and on, the user is encouraged to try to correct the interference by one or more of the following measures:

- Reorient or relocate the receiving antenna.
- Increase the separation between the equipment and the receiver.
- Connect the equipment into an outlet on a circuit different from that to which the receiver is connected.
- Consult the dealer or an experienced radio or television technician for help.

**This device complies with part 15 of the FCC rules. Operation is subject to the following two conditions:** (1) This device may not cause harmful interference, and (2) this device must accept interference received, including interference that may cause undesired operation.

**Declaration of conformity** Trade name: PHILIPS Responsible party: Funai Corporation, Inc. Model: 32PFL5505/F7 Address: 21061 S. Western Ave. Suite 210, Torrance, CA 90501, USA Telephone number: 1 833 978 3323

**Modifications** This apparatus may generate or use radio frequency energy. Changes or modifications to this apparatus may cause harmful interference. Any modifications to the apparatus must be approved by Funai Corporation. The user could lose the authority to operate this apparatus if an unauthorized change or modification is made.

**Cables** Connections to this device must be made with shielded cables with metallic RF / EMI connector hoods to maintain compliance with FCC rules and regulations.

**FCC statutory notice for wireless LAN adapter.** FCC caution: Any changes or modifications not expressly approved by the party responsible for compliance could void the user's authority to operate this equipment.

This transmitter must not be co-located or operated in conjunction with any other antenna or transmitter.

**FCC RF Exposure Compliance** This equipment complies with FCC radiation exposure limits set forth for an uncontrolled environment and meets the FCC radio frequency (RF) Exposure Guidelines. This equipment should be installed and operated keeping the radiator at least 20 cm or more away from your body.

**Compliance with FCC requirement 15.407(c)** Data transmission is always initiated by software, which is the passed down through the MAC, through the digital and analog baseband, and finally to the RF chip. Several special packets are initiated by the MAC. These are the only ways the digital baseband portion will turn on the RF transmitter, which it then turns off at the end of the packet. Therefore, the transmitter will be on only while one of the aforementioned packets is being transmitted. In other words, this device automatically discontinue transmission in case of either absence of information to transmit or operational failure.

**Downloading an electronic copy** To obtain a more detailed electronic copy of document:

- Print your browser to: [www.philips.com/support](http://www.philips.com/support)
- Choose your country of location with language.
- Enter the product name or number in the search field. Alternatively, you can browse the catalog.
- Click the description or model.
- Under product support, click "User manual".

**▲ Batteries usage** CAUTION: Danger of explosion if battery is incorrectly replaced. Replace only with the same or equivalent type.

**WARNING:** Batteries (battery pack or battery installed) should not be exposed to excessive heat such as sunshine, fire or the like.

- Do not mix old and new batteries.
- Do not mix alkaline, standard (carbon-zinc) or rechargeable (ni-cad, ni-mh, Li-ion, etc.) batteries.

**Disposal of used batteries** The batteries supplied do not contain the heavy metals mercury and cadmium, however, in certain localities, disposing batteries with household waste is not permitted. Please ensure you dispose of batteries according to local regulations.

**Preparing to move / ship the unit** Please pack the unit properly by following the diagram on the carton.

- To avoid damage to the screen, do not pack the stand on the same side as the TV screen, refer to the illustration.

**Federal communications commission notice** This equipment has been tested and found to comply with the limits for a Class B digital device, pursuant to part 15 of the FCC Rules. These limits are designed to provide reasonable protection against harmful interference in a residential installation. This equipment generates, uses and can radiate radio frequency energy and, if not installed and used in accordance with the instructions, may cause harmful interference to radio communications. However, there is no guarantee that interference will not occur in a particular installation. If this equipment does cause harmful interference to radio or television reception, which can be determined by turning the equipment off and on, the user is encouraged to try to correct the interference by one or more of the following measures:

- Reorient or relocate the receiving antenna.
- Increase the separation between the equipment and the receiver.
- Connect the equipment into an outlet on a circuit different from that to which the receiver is connected.
- Consult the dealer or an experienced radio or television technician for help.

**This device complies with part 15 of the FCC rules. Operation is subject to the following two conditions:** (1) This device may not cause harmful interference, and (2) this device must accept interference received, including interference that may cause undesired operation.

**Declaration of conformity** Trade name: PHILIPS Responsible party: Funai Corporation, Inc. Model: 32PFL5505/F7 Address: 21061 S. Western Ave. Suite 210, Torrance, CA 90501, USA Telephone number: 1 833 978 3323

**Modifications** This apparatus may generate or use radio frequency energy. Changes or modifications to this apparatus may cause harmful interference. Any modifications to the apparatus must be approved by Funai Corporation. The user could lose the authority to operate this apparatus if an unauthorized change or modification is made.

**Cables** Connections to this device must be made with shielded cables with metallic RF / EMI connector hoods to maintain compliance with FCC rules and regulations.

**FCC statutory notice for wireless LAN adapter.** FCC caution: Any changes or modifications not expressly approved by the party responsible for compliance could void the user's authority to operate this equipment.

This transmitter must not be co-located or operated in conjunction with any other antenna or transmitter.

**FCC RF Exposure Compliance** This equipment complies with FCC radiation exposure limits set forth for an uncontrolled environment and meets the FCC radio frequency (RF) Exposure Guidelines. This equipment should be installed and operated keeping the radiator at least 20 cm or more away from your body.

**Compliance with FCC requirement 15.407(c)** Data transmission is always initiated by software, which is the passed down through the MAC, through the digital and analog baseband, and finally to the RF chip. Several special packets are initiated by the MAC. These are the only ways the digital baseband portion will turn on the RF transmitter, which it then turns off at the end of the packet. Therefore, the transmitter will be on only while one of the aforementioned packets is being transmitted. In other words, this device automatically discontinue transmission in case of either absence of information to transmit or operational failure.

**Downloading an electronic copy** To obtain a more detailed electronic copy of document:

- Print your browser to: [www.philips.com/support](http://www.philips.com/support)
- Choose your country of location with language.
- Enter the product name or number in the search field. Alternatively, you can browse the catalog.
- Click the description or model.
- Under product support, click "User manual".

**▲ Batteries usage** CAUTION: Danger of explosion if battery is incorrectly replaced. Replace only with the same or equivalent type.

**WARNING:** Batteries (battery pack or battery installed) should not be exposed to excessive heat such as sunshine, fire or the like.

- Do not mix old and new batteries.
- Do not mix alkaline, standard (carbon-zinc) or rechargeable (ni-cad, ni-mh, Li-ion, etc.) batteries.

**Disposal of used batteries** The batteries supplied do not contain the heavy metals mercury and cadmium, however, in certain localities, disposing batteries with household waste is not permitted. Please ensure you dispose of batteries according to local regulations.

**Preparing to move / ship the unit** Please pack the unit properly by following the diagram on the carton.

- To avoid damage to the screen, do not pack the stand on the same side as the TV screen, refer to the illustration.

**Federal communications commission notice** This equipment has been tested and found to comply with the limits for a Class B digital device, pursuant to part 15 of the FCC Rules. These limits are designed to provide reasonable protection against harmful interference in a residential installation. This equipment generates, uses and can radiate radio frequency energy and, if not installed and used in accordance with the instructions, may cause harmful interference to radio communications. However, there is no guarantee that interference will not occur in a particular installation. If this equipment does cause harmful interference to radio or television reception, which can be determined by turning the equipment off and on, the user is encouraged to try to correct the interference by one or more of the following measures:

- Reorient or relocate the receiving antenna.
- Increase the separation between the equipment and the receiver.
- Connect the equipment into an outlet on a circuit different from that to which the receiver is connected.
- Consult the dealer or an experienced radio or television technician for help.

**This device complies with part 15 of the FCC rules. Operation is subject to the following two conditions:** (1) This device may not cause harmful interference, and (2) this device must accept interference received, including interference that may cause undesired operation.

**Declaration of conformity** Trade name: PHILIPS Responsible party: Funai Corporation, Inc. Model: 32PFL5505/F7 Address: 21061 S. Western Ave. Suite 210, Torrance, CA 90501, USA Telephone number: 1 833 978 3323

**Modifications** This apparatus may generate or use radio frequency energy. Changes or modifications to this apparatus may cause harmful interference. Any modifications to the apparatus must be approved by Funai Corporation. The user could lose the authority to operate this apparatus if an unauthorized change or modification is made.

**Cables** Connections to this device must be made with shielded cables with metallic RF / EMI connector hoods to maintain compliance with FCC rules and regulations.

**FCC statutory notice for wireless LAN adapter.** FCC caution: Any changes or modifications not expressly approved by the party responsible for compliance could void the user's authority to operate this equipment.

This transmitter must not be co-located or operated in conjunction with any other antenna or transmitter.

**FCC RF Exposure Compliance** This equipment complies with FCC radiation exposure limits set forth for an uncontrolled environment and meets the FCC radio frequency (RF) Exposure Guidelines. This equipment should be installed and operated keeping the radiator at least 20 cm or more away from your body.

**Compliance with FCC requirement 15.407(c)** Data transmission is always initiated by software, which is the passed down through the MAC, through the digital and analog baseband, and finally to the RF chip. Several special packets are initiated by the MAC. These are the only ways the digital baseband portion will turn on the RF transmitter, which it then turns off at the end of the packet. Therefore, the transmitter will be on only while one of the aforementioned packets is being transmitted. In other words, this device automatically discontinue transmission in case of either absence of information to transmit or operational failure.

**Downloading an electronic copy** To obtain a more detailed electronic copy of document:

- Print your browser to: [www.philips.com/support](http://www.philips.com/support)
- Choose your country of location with language.
- Enter the product name or number in the search field. Alternatively, you can browse the catalog.
- Click the description or model.
- Under product support, click "User manual".

**▲ Batteries usage** CAUTION: Danger of explosion if battery is incorrectly replaced. Replace only with the same or equivalent type.

**WARNING:** Batteries (battery pack or battery installed) should not be exposed to excessive heat such as sunshine, fire or the like.

- Do not mix old and new batteries.
- Do not mix alkaline, standard (carbon-zinc) or rechargeable (ni-cad, ni-mh, Li-ion, etc.) batteries.

**Disposal of used batteries** The batteries supplied do not contain the heavy metals mercury and cadmium, however, in certain localities, disposing batteries with household waste is not permitted. Please ensure you dispose of batteries according to local regulations.

**Preparing to move / ship the unit** Please pack the unit properly by following the diagram on the carton.

- To avoid damage to the screen, do not pack the stand on the same side as the TV screen, refer to the illustration.

**Federal communications commission notice** This equipment has been tested and found to comply with the limits for a Class B digital device, pursuant to part 15 of the FCC Rules. These limits are designed to provide reasonable protection against harmful interference in a residential installation. This equipment generates, uses and can radiate radio frequency energy and, if not installed and used in accordance with the instructions, may cause harmful interference to radio communications. However, there is no guarantee that interference will not occur in a particular installation. If this equipment does cause harmful interference to radio or television reception, which can be determined by turning the equipment off and on, the user is encouraged to try to correct the interference by one or more of the following measures:

- Reorient or relocate the receiving antenna.
- Increase the separation between the equipment and the receiver.
- Connect the equipment into an outlet on a circuit different from that to which the receiver is connected.
- Consult the dealer or an experienced radio or television technician for help.

**This device complies with part 15 of the FCC rules. Operation is subject to the following two conditions:** (1) This device may not cause harmful interference, and (2) this device must accept interference received, including interference that may cause undesired operation.

**Declaration of conformity** Trade name: PHILIPS Responsible party: Funai Corporation, Inc. Model: 32PFL5505/F7 Address: 21061 S. Western Ave. Suite 210, Torrance, CA 90501, USA Telephone number: 1 833 978 3323

**Modifications** This apparatus may generate or use radio frequency energy. Changes or modifications to this apparatus may cause harmful interference. Any modifications to the apparatus must be approved by Funai Corporation. The user could lose the authority to operate this apparatus if an unauthorized change or modification is made.

**Cables** Connections to this device must be made with shielded cables with metallic RF / EMI connector hoods to maintain compliance with FCC rules and regulations.

**FCC statutory notice for wireless LAN adapter.** FCC caution: Any changes or modifications not expressly approved by



## 2 Using the remote

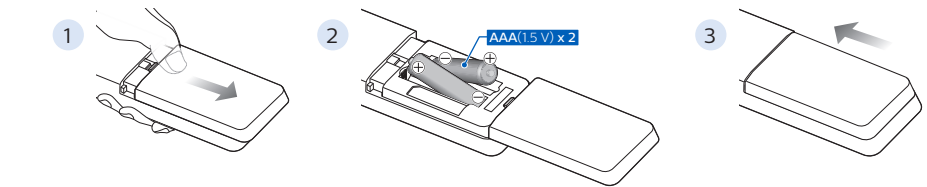

Controllable range for the remote

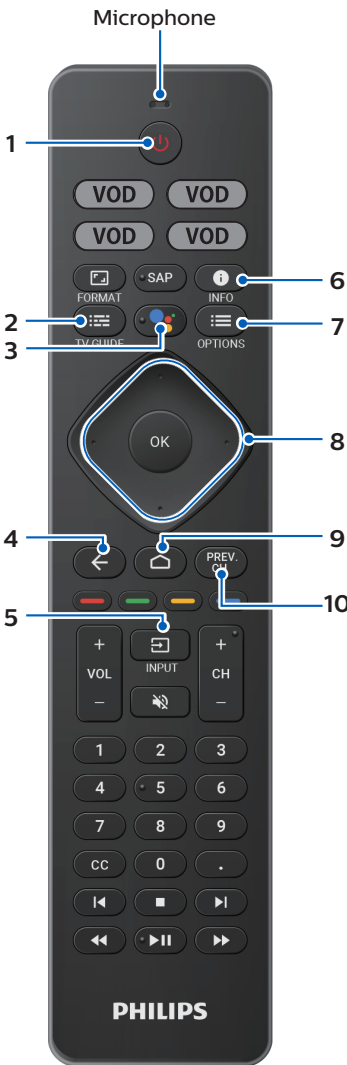
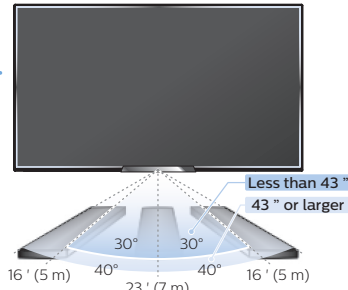

- 1 (POWER)**  
Turns the TV on and off of standby.
- 2 (TV GUIDE)**  
Access to the Electronic Program Guide (EPG).
- 3 The Google Assistant**  
Press the Assistant button on your remote to talk to your Google Assistant.
- 4 (BACK)**  
Returns to the previous menu screen.
- 5 (INPUT)**  
Change input source.  
Select and change access to the attached devices such as Blu-ray player, gaming consoles, or cable box.
- 6 (INFO)**  
Displays input and resolution information.
- 7 (OPTIONS)**  
Displays a list of menu options applicable to the active screen.
- 8 (CURSOR as ▲▼◀▶) and OK**  
Moves to select an item and to determine on the various menu.
- 9 (HOME)**  
Access to your apps, Live TV, input devices, settings, and the Google Play store.
- 10 PREV.CH**  
Direct access to the Live TV channels.  
Displays the last selected terminal or channel.

## 3 Installing the stands

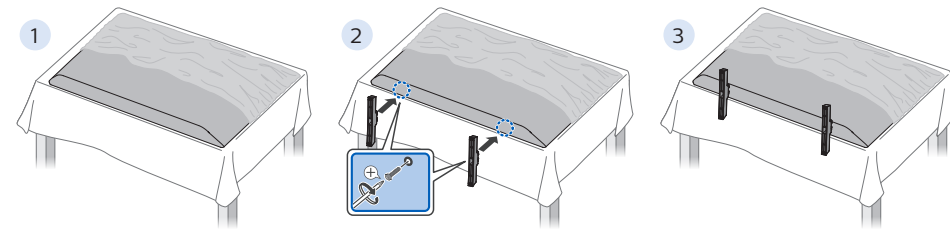

- Remove the tape on the bottom of the TV set and the plastic bag.
- Fasten the stand to the TV with provided screws. While fastening the screws, hold the stand to prevent it from falling.
- Both stands should now be securely fastened.

\* If you plan to wall mount your TV, refer to "Wall mount" on the reverse side of this guide for recommended wall mount bracket kit.

## 4 Connect the power and antenna, cable or satellite

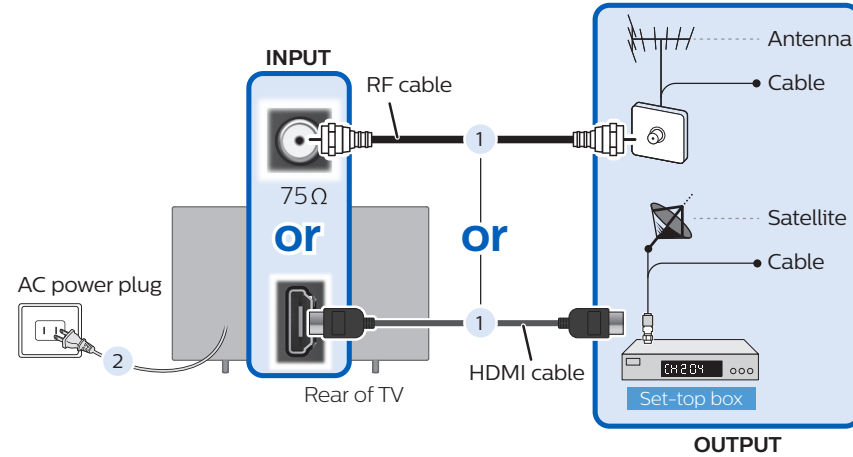

## 5 Connection overview

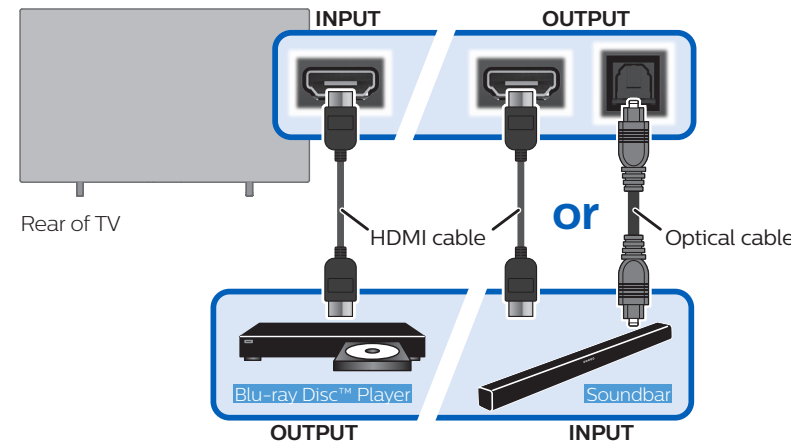

## 6 Best experience

### Google account

Unleash your television's true potential. With a Google® account you can effortlessly expand your entertainment library via the Google Play store and Google Play app and also keep apps up-to-date.

While you can enjoy this Philips Android TV™ without a Google Account via the preinstalled selection of applications, we recommend a Google account to download additional apps from the Google Play Store or use the Google Assistant.

- Note:**  
Simply login with your Google account.

- Tip:**  
It is recommended to create a new Google account specifically for your Android TV. A new account will prevent interference and syncing of your personal account. To create a new Google account, visit <http://accounts.google.com/signup> on your smartphone, tablet, or computer.

### Network router

#### Wireless Connection:

The Philips 5000 series Android TV is equipped with wireless LAN 802.11ac for wireless streaming.

- Note:**  
Wireless performance may be affected by various factors, including the distance between the TV and your Wi-Fi router. To improve wireless performance, we recommend placing your Wi-Fi router within 15 feet of your TV. The use of open or unencrypted Wi-Fi networks is not recommended, as these networks are not secured, and your data could be at risk.

- Tip:**  
If your Wi-Fi router was set up by your internet service provider (ISP), you may find a sticker on the bottom of your router indicating your Wi-Fi SSID and password.

### Set up Android TV with your Android smartphone or tablet

If you have an Android phone or tablet, you can quickly and easily set up your Android TV from your Android device. Pairing your Android device will allow you to wirelessly sync your Wi-Fi credentials, Google account, and Android TV compatible apps. During the initial setup, you will be prompted to set up your TV with your Android device, select **Yes**, and follow the on-screen instructions.

- Note:**  
Be sure to enable pairing mode on your Android device in the beginning.

## 7 The Google Assistant

### Activate the Google Assistant

- Tip:**  
To enjoy all of the benefits the Google Assistant can provide, an internet connection and a Google account are required.

### How to use the remote

Press your Assistant button on your remote to talk to the Google Assistant. To learn more about the Google Assistant visit <https://assistant.google.com>

### SafeSearch filter for Google search

SafeSearch can help you block inappropriate or explicit images from your Google search results. The SafeSearch filter helps block most adult content from your television. Parental supervision is strongly recommended.

- On the Android TV home screen, select **Settings** in the upper right corner of the screen, and press **OK**.
- Select **Device Preferences** and press **OK**.
- Select **the Google Assistant** and press **OK**.
- Select **SafeSearch filter** and press **OK**.

## 8 Explore your television

From the Android TV home screen, you can easily access movies, TV shows, music, apps, input devices, settings, and more. To go back to the home screen at any time, press **⏠ (HOME)** on your remote.

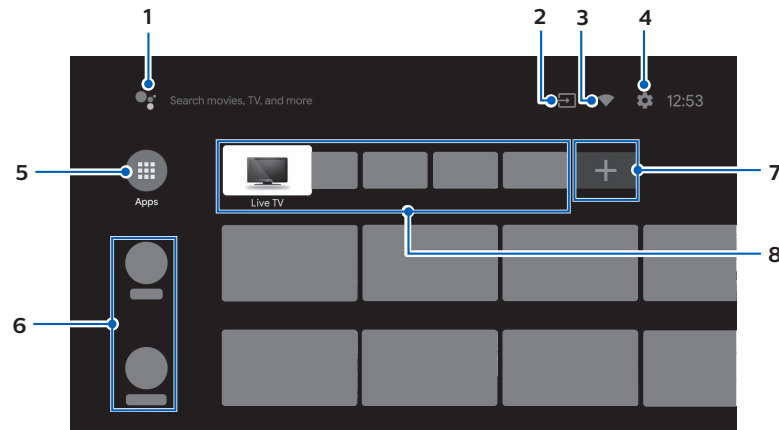

### 1 The Google Assistant

With the Google Assistant, quickly access entertainment, control smart devices, get answers on screen, and more using your voice.

### 2 Inputs

Toggle inputs between your favorite source devices.

### 3 Network condition

Display the network status and open network settings if selected.

### 4 Settings

Configure your television settings and connect to wireless devices.

### 5 Apps

Apps gallery  
You must sign in with a Google account to visit and download apps from the Google Play store.

### 6 How to rearrange channels

Within the row, you want to rearrange, press **◀** on your remote. To rearrange channels, select arrow (**▲▼**) icon, and press **OK**. Use **▲▼** to move up or down. Press **OK**. To delete channels, select minus (**-**) icon, and press **OK**.

### 7 Install Additional Apps

Select the "+" and click on the Google Play Store to expand your entertainment library.

### 8 How to move or delete applications

Select the application and long press **OK** on your remote. To move, select **Move** in the list, and press **OK**. Use **◀▶** to move left or right. Press **OK**. To delete, select **Remove from favorites** in the list, and press **OK**.

## 9 Live TV/Antenna

The Live TV channels feature on Android TV loads television shows, sports, news, and more from your participating TV apps or Antenna / OTA TV tuner so you can watch them all in one place.

To select channels, use **CH + / -** on your remote. For installation of TV channels using a set-top box, go to "4 Connect the power and antenna, cable or satellite".

### Add channels

To add for the first time or additional channels, please follow the steps below:

- On the Home menu, go to the **Apps** row and select **How to...**

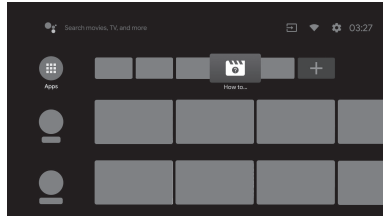

- Select **Live TV** to open channel installation page. Once open, select **Setup** and press **OK**.
- Select your signal type **Antenna / Cable** to start the channel installation.

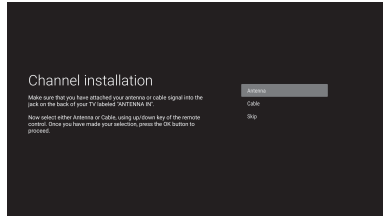

### Channel List

Press **OK** while viewing Live TV to open channel list. Based on the type of channels installed, select with the yellow color key **Broadcast (conventional TV channels)** or **Network (internet TV channels)**.

### Program guide

To view the latest TV program schedule, press **≡ (TV GUIDE)** on your remote.

- Tip:**  
Live TV feature is only compatible with antenna and select cable broadcasting. To access your cable box or other source inputs, you must press **⏠ (INPUT)** on your remote.

For further assistance, call the customer support service in your country.

- To obtain assistance, contact Philips customer care center;

In the U.S.A., Canada, Puerto Rico, or the U.S. Virgin Islands **1 833 978 3323**

Enter below the model and serial numbers located on the left side and the rear of the TV cabinet.

Model :

Serial :

For complete instructions, please visit [www.philips.com/support](http://www.philips.com/support) to download the full version of the online user manual.

This product has been manufactured by and is sold under the responsibility of Funai Corporation, Inc., and Funai Corporation, Inc. is the warrantor in relation to this product.

The Philips trademark and the Philips shield emblem are registered trademarks of Koninklijke Philips N.V. used under license.

