

PHILIPS

Roku TV

6 series Quick Start Guide



Scan to register

Register your product:

www.philips.com/my-tv

- Early access to exclusive offers and more!
- Keep track of your product warranty coverage
- Get easy access to product support



Scan to download

User manual:

www.philips.com/support

For a detailed manual, please visit our support page and enter your TV model number to download.



Scan to call

Call us:

1-833-978-3323

To obtain assistance, contact Philips customer care center; In the U.S.A., Canada, Puerto Rico, or the U.S. Virgin Islands



Scan to chat

Chat with us:

<http://tinyurl.com/y2e29xsq>

For a detailed manual, please visit our support page and enter your TV model number to download.

★★★★★

1 What you need (not included)

• **Wireless router**
(needed to connect your TV to the Internet)

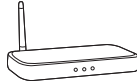

• **Computer, tablet, or smartphone**
(needed for setup)



• **Internet connection**
(needed for streaming)



• **Roku account**
(needed to access entertainment across thousands of streaming channels)

For additional support, please see online owner's manual at www.philips.com/support

Key things to know: A paid subscription or other payments may be required for some streaming channel content. Channel availability is subject to change and varies by country.

2 Using the remote

How to install the batteries in the remote

Open the battery cover by firmly sliding down. Insert 2 AAA (1.5 V) batteries matching the polarity indicated inside battery compartment of the remote.

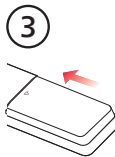
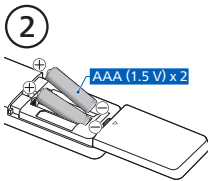
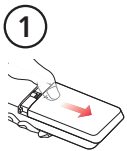

[Remote control sensor]

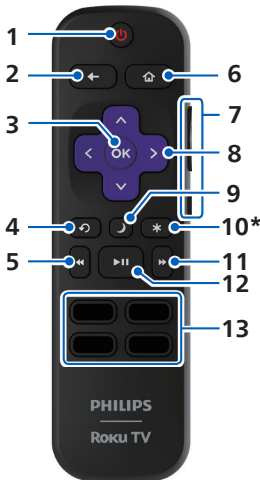

- 1 **Power** Turn TV on and off
- 2 **Back** Return to previous screen
- 3 **OK** Select an option from a menu
- 4 **Instant replay** Replay the last few seconds of streaming video
- 5 **RWD scan** Rewind streaming video, scroll left one page at a time
- 6 **Home** Return to Roku Home screen
- 7 **Volume/Mute** Increase/Decrease volume and mutes the TV sound
- 8 **Directional keypad (D-Pad)** Move up, down, left or right
- 9 **Sleep** Set the sleep timer
- 10 **Options** Access to picture settings, move streaming channel icons and more
- 11 **FWD scan** Fast forward streaming video, scroll right one page at a time
- 12 **Play/Pause** Start or pause playback
- 13 **Featured channel shortcut** Lets you directly access featured channels

* The  gives you easy access to picture settings, display options and more. Try it on every screen.

3 Plug in and turn on TV

Connect the AC power cord to the AC outlet. Press the power button on the TV's remote.

4 Follow the on-screen instructions

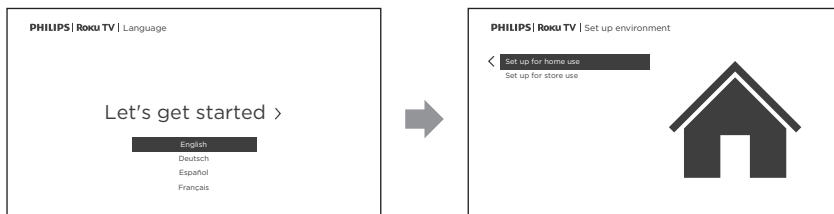

1. Once your Roku TV powers on, follow the on-screen instructions. Your Roku TV will walk you through initial setup and help connect to your preferred wireless network.
2. Your TV will automatically detect wireless networks in your area. Have your network name and password handy and follow the easy on-screen instructions.
 - If you are not ready to connect your TV to a wireless network, you can still use it as a regular TV by selecting "Connect to the Internet later".
3. Once connected your TV will automatically update with the latest software. This can take a few minutes to update.

Once you complete guided setup, your TV will automatically update with the latest software. Your new Philips Roku TV automatically receives regular software updates in the background when it's connected to the Internet. This allows it to give you a better experience over time.

5 Activate your smart TV

You need a Roku account to activate your Roku TV and to access entertainment across thousands of streaming channels.

Your Roku account

Follow the on-screen instructions on your Roku TV. You will need to activate your Roku TV using your smartphone, tablet, or computer to link to a Roku account. See more information below.

- Roku accounts are free, and while a valid credit card number is not required to create your account, providing your credit card information makes renting and purchasing entertainment from the Roku Channel Store fast and convenient.
- If you choose to provide a payment method, you will be able to seamlessly rent content, download channels and subscribe to services without having to enter your credit card information each time.
- A unique PIN can be added to the account to prevent unauthorized purchases.

Tip:

Roku does not charge for activation support — beware of scams.

Caution:

Funai Corporation, Inc. does not warrant access to the portal or to any of the services, content, software and advertising. Funai Corporation, Inc. may, in its sole discretion, add or remove access to any specific services, content, software and advertising at any time. Although Funai Corporation, Inc. will strive to provide a good selection of services, content or software, Funai Corporation, Inc. does not warrant continued access to any specific services, and content or software.

6 Download the Roku mobile app (optional)

The free Roku mobile app allows you to use your mobile device as a fully functioning remote with voice search and keyboard.

- Download the Roku mobile app on your smartphone or tablet through Google Play or Apple App Store.
- Simply search for “Roku app” and choose the “Roku” app provided by Roku Inc.
- Follow the on-screen prompts and you are on your way.

7 Connect antenna or cable (optional)

With the tuner built-in you can connect your TV to antenna or cable (free cable only, does not work with cable TV using a set-top box) and enjoy over-the-air entertainment.

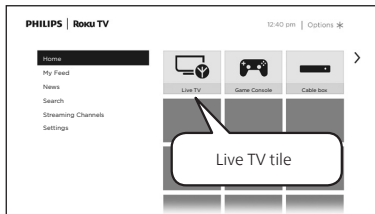

1. When the setup wizard is complete, select the Antenna TV tile from the home screen.
2. Follow the on-screen instructions.
3. Whenever you want to watch local broadcast TV, select this tile.

- User interface may vary.

* Tip:

While in the antenna TV input, you can use your remote to access additional features.

- D-Pad left: Pressing this key brings up the smart guide, a list of antenna TV channels.
 - Play/Pause: Pause live TV for up to 90 minutes when a 16 GB USB drive is connected.
 - RWD scan and FWD scan: Allows you to fast forward and rewind while using the Live TV Pause feature.
 - D-Pad left and right: Allows you to scroll through the paused Live TV and select scenes.
- Live TV Pause can pause content received on the antenna TV input for up to 90 minutes and requires a 16 GB or larger USB drive and a valid Roku account. All data on the USB drive will be deleted prior to use.

8 Parental Controls

Parental controls enable you to control whether the members of your household can view certain kinds of broadcast TV programs. When a program or feature is blocked, you can unblock it by entering a parental control PIN that only you know.

! Note:

Parental controls block content from the TV tuner and from streaming options, if any, on the Home screen menu. Parental controls do not block content on other TV inputs or content from streaming channels you add to your TV.

Creating a parental control PIN

To create a new parental control PIN, from the Home screen menu navigate to **Settings > Parental controls**. The screen displays a numeric keypad. Use the purple directional pad to enter a four-digit code, and then press **OK**. Then repeat the process to enter the same PIN again, just to make sure you correctly entered the PIN you want to use.

! Important:

If you forget your parental control PIN, the only way to recover is to perform a factory reset operation.

Blocking broadcast TV programs

Enabling parental control of TV programs

The first step in blocking TV programs is to enable parental control of TV programs.

To enable parental control of TV programs:

1. In the Home screen menu, navigate to **Settings > Parental controls**, and then enter your parental control PIN.
2. In the **Parental controls** screen, navigate to **TV tuner > Enable parental controls**.
3. Make sure the check box next to **Enable parental controls** is checked. If not, highlight it and press **OK**.

Blocking based on US TV ratings

To block TV programs based on US television ratings:

1. From the Home screen menu, navigate to **Settings > Parental controls**, and then enter your parental control PIN.
2. In the **Parental controls** screen, navigate to **TV tuner > TV ratings**. Choose among the following settings:
 - **Entire ratings** – Highlight the rating you want to block, and then navigate to the right and select the first option that blocks the entire rating level (and all higher rating levels).
 - **Individual content types** – Highlight the rating that contains the content type you want to block, and then select the content types you want to block from among those listed. Remember that blocking a content type in one rating blocks the equivalent content type in all higher rating levels.

Copyright

All other registered and unregistered trademarks are the property of their respective owners.



The terms HDMI and HDMI High-Definition Multimedia Interface, and the HDMI Logo are trademarks or registered trademarks of HDMI Licensing Administrator, Inc. in the United States and other countries.



Manufactured under license from Dolby Laboratories. Dolby, Dolby Audio, and the double-D symbol are trademarks of Dolby Laboratories Licensing Corporation.

Portions of this software are copyright © The FreeType Project (www.freetype.org).

The American Academy of Pediatrics discourages television viewing for children younger than two years of age.

Some features may require an always-on broadband internet connection, firmware update and/or a minimum bandwidth.

Internet services vary by location.

This product has been manufactured by and is sold under the responsibility of Funai Corporation, Inc., and Funai Corporation, Inc. is the warrantor in relation to this product.

9 Troubleshooting

Category	Problem	Tip
Power	No power	<ul style="list-style-type: none">• Ensure that the AC outlet supplies the proper voltage. Plug another electrical appliance into the AC outlet to ensure that the AC outlet operates normally.• If a power failure occurs, unplug the AC power cord for 1 minute to allow the unit to reset itself.
Remote	Remote buttons are not functional.	<ul style="list-style-type: none">• Re-insert or replace the AAA batteries with their polarities (+/-) as indicated on the remote battery area.
Network	Cannot connect the network.	<ul style="list-style-type: none">• Check if your router and/or modem is properly connected.• Check if the Ethernet cable connection between the TV and your router or modem is properly secured.• Power cycle the router and/or modem.• Check your network settings.
	Slow Data Connection or buffering.	<ul style="list-style-type: none">• Check the settings between your router and ISP modem or gateway (if applicable).• Connect to a stable wireless connection from home wireless or wired network.• The use of mobile hot spots or public wireless connections is not recommended.
Picture on HDMI Input	Television has sound with no picture or abnormal picture.	<ul style="list-style-type: none">• HDMI EDID Version setting is set to a different mode than your source device.• Change the resolution output of your source device.
Sound on HDMI with external devices	Television has no sound.	<ul style="list-style-type: none">• Please check to be sure the device is connected to the HDMI 1 (eARC) input on the TV.

License

Funai Corporation, Inc. hereby offers to deliver, upon request, a copy of the complete corresponding source code for the copyrighted open source code packages, on an "AS IS" basis, used in this product for which such offer is requested by the respective licenses.

This offer is valid up to three years after the product purchase to anyone in receipt of this information. To obtain source code, please contact Funai Corporation, Inc. You should write to Funai Service Corporation OSS Request, 2425 Spiegel Drive, Groveport, OH 43125, USA. Funai Corporation, Inc. disclaims any and all warranties and representations with respect to such software and related source code including quality, reliability, usability, and accuracy, and further disclaim all express, implied, statutory or otherwise, including without limitation, any implied warranties of title, non-infringement, merchantability, or fitness for a particular purpose. Funai Corporation, Inc. shall not be liable to make any corrections to the open source software or source code or to provide any support or assistance with respect to it. Funai Corporation, Inc. disclaims any and all liability arising out of or in connection with the use of this software and/or source code.

Philips and the Philips Shield Emblem are registered trademarks of Koninklijke Philips N.V. and are used under license.

ROKU, ROKU TV and the ROKU logo are the trademarks or registered trademarks of Roku, Inc.

All other trademarks and logos herein are the property of their respective owners.

