

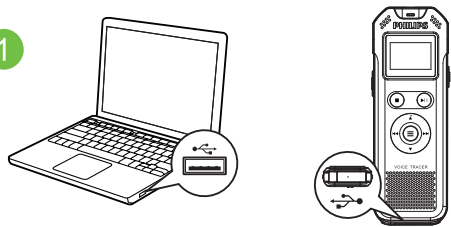

1

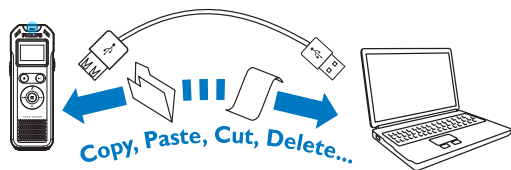

2

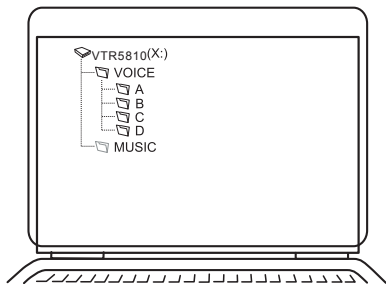

Specifications subject to change without notice.

© 2015 Speech Processing Solutions GmbH. All rights reserved. Philips and the Philips' shield emblem are registered trademarks of Koninklijke Philips N.V. and are used by Speech Processing Solutions GmbH under license from Koninklijke Philips N.V. All trademarks are the property of their respective owners.

Document version 1.0, 2015-01-01

VOICE TRACER

VTR5810



快速操作指南 Quick start guide

需要帮助？
Need help?

User manual

请查看包装盒中的使用手册

See the user manual stored on the recorder.

Online

请登录：www.philips.com/welcome.

Go to www.philips.com/welcome.

PHILIPS

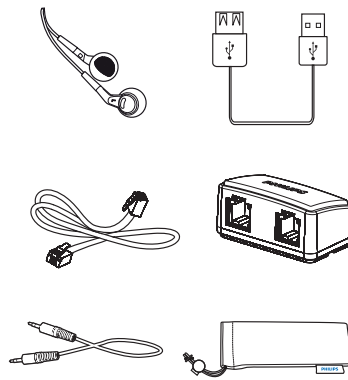
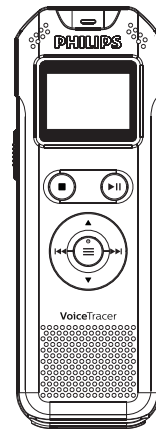



1

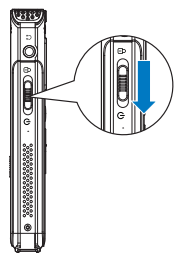

PHILIPS

2

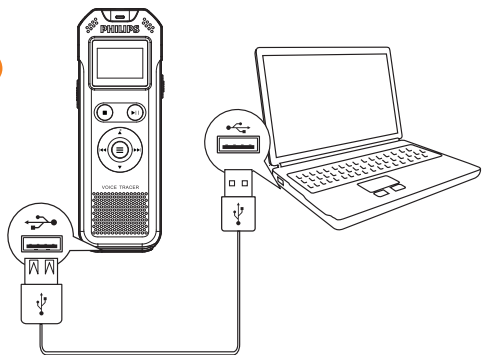

PHILIPS REC001.MP3 OFF >> ON

REC003.MP3 REC001.MP3

录音中...

录音新停

保存...

PHILIPS ON >> OFF

.mp3 → A B C D



PHILIPS REC001.MP3 OFF >> ON

REC003.MP3 REC001.MP3

REC001.MP3 REC002.MP3 ..003..004..005..

REC003.MP3

REC003.MP3

语音音量

REC003.MP3



录音类型 Record type	降噪录音 Noise cut Rec	PCM录音 PCM Rec	立体声录音 HQ Rec	长时间录音 SLP Rec
录音指示灯 Record lamp	开 ON	关 OFF		
声控设置 VA control	禁用 Disable	开启 Enable		
监听设置 Listen in	禁用 Disable	开启 Enable		
分段录音 Auto divide	关闭 off	30分钟 30 min	60分钟 60 min	
背光时间 Backlight	恒亮 Constant	15秒 15S	30秒 30S	45秒 45S
关机设定 Auto off	0-60分钟 0-60 mins			
语言选择 Language	简体中文 S-Chinese	繁体中文 T-Chinese	英文 English	
按键音 Key tone	开 ON	关 OFF		
磁盘信息 Memory info	空间总量 Memory capacity	剩余空间 Remaining memory		
固件版本 Firmware ver	20170720-V1.0			
系统时间 System time	时间格式 设定日期 设置时间	12小时制 24小时制		
		2015 - 05 - 01		
		12 : 22		
定时录音 Record timer	录音时间 录音时长	定时日期 定时时间		
		30分钟 60分钟 120分钟 不限长度		
恢复出厂设置 Reset	是 YES	否 NO		