

Philips Cinema 21:9
LCD TV

142 cm (56")
Full HD 1080p
digital TV

56PFL9954H



Every night a premiere

with the 21:9 movie format and Ambilight

Be blown away by movies the way they're meant to be seen. The ultrawide TV matches perfectly the 21:9 (2.39:1) movie format and comes to life with immersive Ambilight.

Make every night a premiere at your place.

True cinema experience

- Cinema 21:9 movie aspect ratio, no black bars bottom and top
- Ambilight Spectra 3 for an immersive viewing experience

In-built internet TV

- Philips Net TV with Wi-Fi for online services on your TV
- Enjoy a rich selection of web videos from YouTube and others
- DLNA PC network link for watching videos from your computer

Perfect LCD Picture

- Full HD LCD display, with a 2560 x 1080p resolution
- Perfect Pixel HD Engine for unrivalled sharpness and clarity
- Perfect Natural Motion for ultra smooth Full HD movies
- 200 Hz Clear LCD*, 1 ms performance: superb motion sharpness

PHILIPS

LCD TV
142 cm (56") Full HD 1080p, digital TV

Highlights

Full HD LCD display 2560x1080p

Enjoy the exceptional picture quality of Full HD sources like HDTV broadcast or Blu-ray on your Cinema 21:9. The unique movie format screen comes with 2560x1080p resolution, matching the 21:9 aspect ratio of the screen.

21:9 movie aspect ratio



Most TVs have an aspect ratio of 16:9 (or 1.78:1) and a resolution of 1080p Full HD. Hollywood blockbusters, though, are usually filmed in 2.39:1 aspect ratio. With Philips new Cinema 21:9 TVs perfectly match the original movie format used by directors with a 21:9 (2.39:1) aspect ratio. So no matter which movie, you can now watch it in its original aspect ratio and without the black bars.

Ambilight Spectra 3



Add a new dimension to your viewing experience with Ambilight Spectra 3. This patented Philips technology enlarges the screen further by projecting a glow of light from the back of the screen onto the surrounding wall. Ambilight adjusts automatically the colour and brightness of the

light surrounding the TV to match with the picture, creating an immersive viewing experience. With Ambilight Spectra 3 movies truly come to life!

Perfect Pixel HD Engine

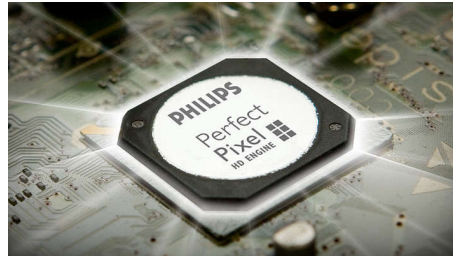

Experience unrivalled sharpness and clarity with Perfect Pixel HD Engine. Each pixel of the picture is enhanced to better match the surrounding pixels, resulting in a more natural picture. The result is a unique combination of sharpness, natural detail, vivid colors superior contrast and smooth natural motion whatever you are watching. Clean and razor sharp images result from artifact and noise detection and reduction in all content sources - from multimedia to standard TV.

Philips Net TV with Wi-Fi



Experience a rich selection of online services with Net TV. Enjoy movies, pictures, infotainment and other online content directly on your TV whenever you like. Simply connect your home theater directly to your home network through the ethernet connection, and navigate and select what you want to watch with the remote control. The Philips menu

56PFL9954H/98

gives you access to popular Net TV services fitted for your TV screen. Additionally, with the DLNA certified PC network you can watch videos or access pictures stored on your computer using your remote control.

Perfect Natural Motion



Enjoy the action without any judder. Perfect Natural Motion estimates motion in the picture and corrects juddering movements in both broadcast and pre-recorded movie material (including 1080p movies and 24p True Cinema on Blu-ray and DVD). The result is even smoother and quieter pictures with excellent sharpness. Enjoy motion performance that surpasses cinema quality!

200Hz Clear LCD* (1ms)

Enjoy extreme motion sharpness. The Philips 200Hz Clear LCD brings the response time of LCD TV to an incredible 1ms, so even with the fastest car chase scene you will be enthralled by the action, and not following the stretched car across the screen.

Videos from YouTube and others

Net TV brings you a rich selection of videos from YouTube and other video websites. The videos are tailored to fit your TV screen, allowing you to sit back and enjoy online videos at an optimum quality.

DLNA PC network link for video

DLNA PC network link lets you watch videos, view pictures and listen to music from your PC

Specifications

Ambilight

- Ambilight Features: Ambilight Spectra 3, Lounge light mode
- Ambilight light system: LED wide color
- Dimming Function: Manual and via Light Sensor

Picture/Display

- Aspect ratio: 2.39:1, 21:9
- Diagonal screen size (inch): 56 inch
- Diagonal screen size (metric): 142 cm
- Color cabinet: Black glass decofront with black backcover
- Panel resolution: 2560x1080p
- Picture enhancement: Perfect Pixel HD Engine, Perfect Natural Motion, Perfect Contrast, Perfect Colors, 3/2 - 2/2 motion pull down, 3D Combfiter, Active Control + Light sensor, Jagged Line

- Suppression, Progressive scan, 1080p 24/25/30Hz processing, 1080p 50/60Hz processing, 200Hz Clear LCD*, Scanning backlight
- Display screen type: LCD Full HD UW-UXGA Act.matrix
- Viewing angle: 176° (H) / 176° (V)
- Screen enhancement: Anti-Reflection coated screen
- Color processing: 2250 trillion colors 17bit RGB

Supported Display Resolution

- Computer formats: 640 x 480, 60Hz, 800 x 600, 60Hz, 1024 x 768, 60Hz, 1280 x 768, 60Hz, 1360 x 768, 60Hz, 1920 x 1080, 60Hz
- Video formats: 480i, 60Hz, 480p, 60Hz, 576i, 50Hz, 576p, 50Hz, 720p, 50, 60Hz, 1080i, 50, 60Hz, 1080p, 24, 50, 60Hz, 1080p, 24, 25, 30Hz

Tuner/Reception/Transmission

- Aerial Input: 75 ohm coaxial (IEC75)
- Tuner bands: Hyperband, S-Channel, UHF, VHF
- Video Playback: NTSC, SECAM, PAL

Multimedia Applications

- Multimedia connections: Ethernet-UTP5, USB, Wi-Fi 802.11g (built in)
- Playback Formats: MP3, WMA v2 up to v9.2, Slideshow files (.alb), JPEG Still pictures, MPEG1, MPEG2, MPEG4, AVI, H.264/MPEG-4 AVC, MPEG-Program-stream PAL, WMV9/VC1

Convenience

- Child Protection: Child Lock+Parental Control
- Ease of Installation: Auto Program Naming, Automatic Channel Install(ACI), Automatic Tuning

Rear connectors

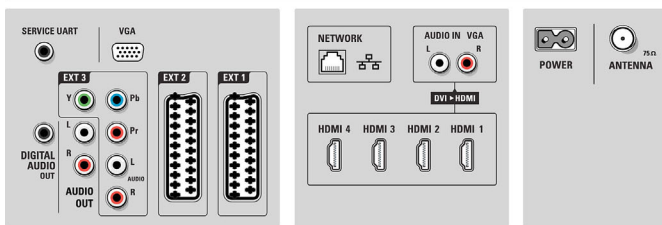

Side

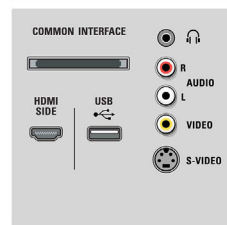

Specifications

System (ATS), Autostore, Fine Tuning, PLL Digital Tuning, Plug & Play

- Ease of Use: Auto Volume Leveller (AVL), Delta Volume per preset, Graphical User Interface, On Screen Display, Program List, Settings assistant Wizard, Side Control, Connectivity assistant, Automatic setup wizard, Demo mode, Onscreen Usermanual, Touch control buttons, Favorite program selection, Iconic home screen, Mozaic channel grid
- Connection Enhancement: Easy link
- Screen Format Adjustments: 4:3, Auto Format, Movie expand 16:9, Subtitle and Heading Shift, Super Zoom, Widescreen, unscaled (1080p dot by dot), Cinema 21:9, Cinema 21:9 subtitle-shift
- Multimedia: Digital media reader (browser), USB autobreak-in, DLNA media Browser, Net TV services
- Remote Control: DVD, DVD-R, Sat, STB (Set-Top Box), Universal, HTS (Home Theater System)
- Remote control type: RC4495
- Teletext: 1200 page Hypertext
- Firmware upgradeable: Firmware auto upgrade wizard, Firmware upgradeable via USB
- Picture in Picture: Text dual screen
- Smart mode: Game, Cinema, Personal, Power saver, Standard, Vivid

Sound

- Output power (RMS): 2 x 12W RMS (4 ohm @ 7% THD)
- Sound System: BBE
- Sound Enhancement: Auto Volume Leveler, Digital Signal Processing, Dynamic Bass Enhancement, Treble and Bass Control

Loudspeakers

- Built-in speakers: 4
- Loudspeaker types: 2 integrated subwoofers, 2x Dome tweeter

Connectivity

- EasyLink (HDMI-CEC): One touch play, EasyLink,

- Pixel Plus link (Philips), Remote control pass-through, System audio control, System standby
- Front / Side connections: HDMI v1.3, S-video in, CVBS in, Audio L/R in, Headphone Out, USB
- Ext 1 Scart: Audio L/R, CVBS in, RGB
- HDMI 1: HDMI v1.3
- Ext 2 Scart: Audio L/R, CVBS in, RGB
- HDMI 2: HDMI v1.3
- Other connections: Analog audio Left/Right out, S/PDIF out (coaxial), Common Interface
- HDMI 3: HDMI v1.3
- PC network link: DLNA 1.0 certified
- Ext 3: YPbPr, Audio L/R in, VGA PC-in
- HDMI 4: HDMI v1.3

Power

- Mains power: AC 220 - 240 V +/- 10%
- Ambient temperature: 5 °C to 35 °C
- Standby power consumption: $\leq 0.15\text{ W}$
- Power consumption (typical): 240 W

Accessories

- Included accessories: Smart leveling wall bracket, RF antenna cable, Power cord, Quick start guide, User Manual, Warranty certificate, Remote Control, Batteries for remote control
- Optional accessories: Matching stand ST569954

Dimensions

- Set Width: 1418 mm
- Set Height: 691 mm
- Set Depth: 105 mm
- Product weight: 31.9 kg
- Set height (with stand): 745 mm
- Set depth (with stand): 324 mm
- Product weight (+stand): 37.4 kg
- Box width: 1550 mm
- Box height: 994 mm
- Box depth: 362 mm
- Weight incl. Packaging: 50 kg
- Stand width: 550 mm
- Wall mount compatible: 400 x 400 mm



Issue date 2023-08-21

Version: 8.1.5

EAN: 87 12581 50909 5

© 2023 Koninklijke Philips N.V.
All Rights reserved.

Specifications are subject to change without notice.
Trademarks are the property of Koninklijke Philips N.V.
or their respective owners.

www.philips.com

* 200Hz Clear LCD displays 200 scenes per second by combining advanced 100Hz technology with scanning backlight @ 50% dutycycle.

* 8 days EPG, service not available in all countries

* Net TV, service offering is dependent on country and subject to terms of use.