

Philips OLED 8 series
Razor Slim 4K UHD OLED
Android TV

164 cm (65") Ambilight TV

4100 Picture Performance Index
HDR perfect WCG 99%
P5 Perfect Picture Engine

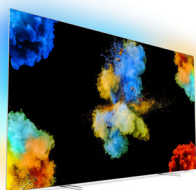

65OLED803

Razor Slim 4K UHD OLED Android TV with Ambilight 3-sided

Enrich your viewing with the Philips 803 OLED TV. Experience a sharper 4K UHD picture and a wider viewing angle. Enjoy immersive movie or gaming nights with Ambilight. This smart TV won't take over your living room-unless you want it to.

Sharp design. Beautiful light.

- Ambilight. Take the emotion beyond the screen.
- Razor-slim minimalist frame with brushed metallic finish.

Slim TV. Deep sound.

- DTS HD Premium Sound. Deep bass and crystal-clear dialogue
- Philips Triple Ring technology. Powerful performance.

Always stunning.

- 4K UHD OLED TV. This is what lifelike feels like.
- Philips P5 Engine. Whatever the source, always perfection.
- Certified UHD Premium. Feast your eyes.
- HDR Perfect. Truly cinematic colour, depth, and dimension

Android TV-all the content you love

- Add more content with 16 GB of expandable memory.
- Google Assistant built-in. Content and more at your command.
- Google Play store and Philips app gallery. More to love.

PHILIPS

Razor Slim 4K UHD OLED Android TV
164 cm (65") Ambilight TV 4100 Picture Performance Index, HDR perfect WCG 99%, P5 Perfect Picture Engine

Highlights

Ambilight 3-sided

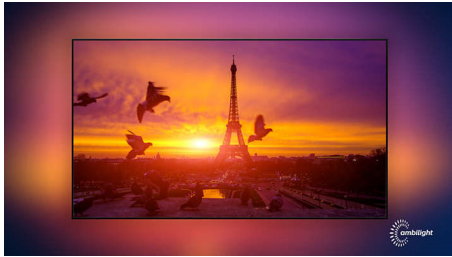

With Philips Ambilight, movies and games feel more immersive. Music gets a light show. And your screen will feel bigger than it is. Intelligent LEDs around the edges of the TV cast on-screen colours onto the walls, and into the room, in real time. You get perfectly tuned ambient lighting. And one more reason to love your TV.

Razor-slim minimalist frame

Razor-slim minimalist frame with brushed metallic finish.

OLED TV

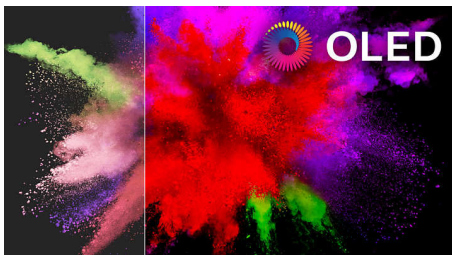

With a Philips OLED TV, every scene feels impressively real. Individual pixels can be dimmed or turned off, giving deeper blacks, vibrant colours, and astonishing contrast. Even details in shadows and highlights are precisely reproduced. You also get a wider viewing angle and, thanks to the Philips processing engine, beautifully smooth motion.

P5 Perfect Picture Engine

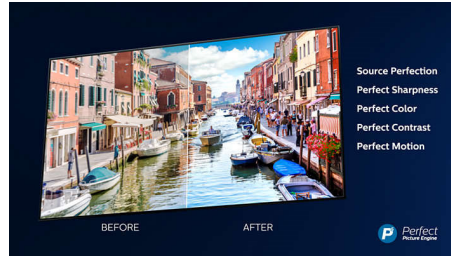

The Philips P5 engine delivers a picture as brilliant as the content you love. Details have noticeably more depth. Colors are vivid, while skin tones look natural. Contrast is so crisp you'll feel every detail. Motion is perfectly smooth.

Ultra HD Premium

The Ultra HD Premium certification on your Philips OLED TV is the promise of an incredibly lifelike 4K UHD picture for the content you love. You'll be captivated by greater brightness and contrast, and a wider colour gamut that unlocks millions of subtle shades. The HDR content you watch will come to life with more realistic depth and detail.

High Dynamic Range Perfect



High Dynamic Range Perfect delivers a sensory experience that captures the original richness and liveliness of your content. Enjoy brighter highlights, ultimate contrast and vivid colors just like the director intended.

65OLED803/56

Google Assistant built-in

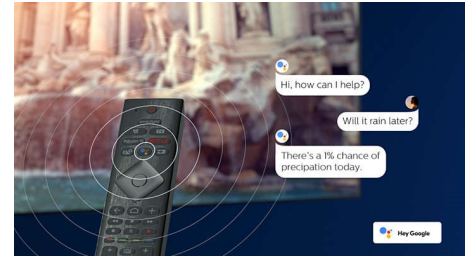

Control your Philips Android TV with your voice. Want to play a game, watch Netflix, or find content and apps in the Google Play store? Just tell your TV. You can even command all Google Assistant-compatible smart home devices-like dimming the lights and setting the thermostat on movie night. Without leaving the sofa.

TV Content

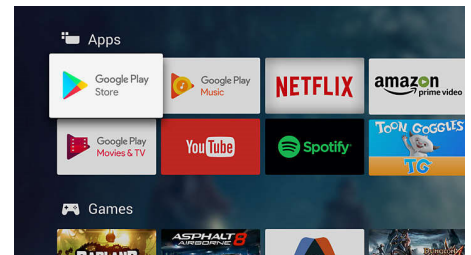

Go beyond traditional TV programming with Google Play Store and Philips App Gallery. Experience endless movies, TV, music, apps and games online. More to love.

16GB of expandable memory

16GB of expandable memory means there is plenty of room to store all your favorite content and to install more apps.

DTS HD Premium Sound

DTS HD Premium Suite delivers high-end audio processing for better sound from your speakers. Preserving the purity of the original content, you'll enjoy immersive sound, deep bass and crystal clear dialog without any fluctuations, clipping, or distortion.



Razor Slim 4K UHD OLED Android TV
164 cm (65") Ambilight TV 4100 Picture Performance Index, HDR perfect WCG 99%, P5 Perfect Picture Engine

Specifications

Ambilight

- Ambilight Features: Built in Ambilight+hue, Ambilight Music, Game Mode, Wall colour adaptive, Lounge mode
- Ambilight Version: 3-sided

Picture/Display

- Aspect ratio: 16:9
- Diagonal screen size (inch): 65 inch
- Diagonal screen size (metric): 164 cm
- Display: 4K Ultra HD OLED
- Panel resolution: 3840x2160
- Picture engine: P5 Perfect Picture Engine
- Picture enhancement: Perfect Natural Motion, Ultra Resolution, Micro Dimming Perfect, 4100 PPI, HDR Perfect

Supported Display Resolution

- Computer inputs on all HDMI: up to 4K UHD 3840x2160 @60Hz
- Computer inputs on HDMI3/4: up to 4K UHD 3840x2160 @30Hz
- Video inputs on HDMI1/2: up to 4K UHD 3840x2160@60Hz
- Video inputs on HDMI3/4: up to 4K UHD 3840x2160 @30Hz

Tuner/Reception/Transmission

- Digital TV: DVB-T/T2
- Video Playback: NTSC, PAL, SECAM
- MPEG Support: MPEG2, MPEG4
- TV Program guide*: 8 day Electronic Program Guide
- Signal strength indication
- Teletext: 1000 page Hypertext
- HEVC support

Android TV

- OS: Android™ 7.0 (Nougat)
- Pre-installed apps: Google Play Movies*, Google Play Music*, Google Search, YouTube
- Memory size(Flash): 16GB*, extendable via USB storage
- Memory size to install apps: 12GB

Smart TV Features

- User Interaction: MultiRoom client and server, SimplyShare
- Program: Pause TV, USB recording*

- SmartTV apps*: Online video stores, Open internet browser, Social TV, TV on demand, Youtube
- Ease of Installation: Auto detect Philips devices, Network installation wizard, Settings assistant wizard, Device connection wizard
- Ease of Use: One-stop smart menu button, Onscreen usermanual
- Firmware upgradeable: Firmware auto upgrade wizard, Firmware upgradeable via USB, Online firmware upgrade
- Screen Format Adjustments: Basic - Fill Screen, Fit to screen, Advance - Shift, Zoom, stretch
- Philips TV Remote app*: Apps, Channels, Control, NowOnTV, TV Guide, Video On Demand
- Remote Control: with Keyboard, with Voice

Multimedia Applications

- Video Playback Formats: Containers: AVI, MKV, H264/MPEG-4 AVC, MPEG-1, MPEG-2, MPEG-4, WMV9/VC1, VP9, HEVC (H.265)
- Music Playback Formats: AAC, MP3, WAV, WMA (v2 up to v9.2), WMA-PRO (v9 and v10)
- Subtitles Formats Support: .SRT, .SUB, .TXT, .SMI
- Picture Playback Formats: JPEG, BMP, GIF, PNG

Processing

- Processing Power: Quad Core

Sound

- Output power (RMS): 50W
- Sound Enhancement: Clear Sound, Smart Sound, DTS-HD Premium Sound
- Sound Features: Triple ring technology

Connectivity

- Number of HDMI connections: 4
- HDMI features: 4K, Audio Return Channel
- Number of component in (YPbPr): 1
- EasyLink (HDMI-CEC): Remote control pass-through, System audio control, System standby, One touch play
- Number of USBs: 2
- Wireless connection: Dual Band, Wi-Fi 802.11ac 2x2 integrated
- Other connections: Antenna IEC75, Digital audio out (optical), Ethernet-LAN RJ-45, Audio L/R in, Headphone out
- HDCP 2.2: Yes on all HDMI

65OLED803/56

Power

- Mains power: AC 220 - 240 V 50/60Hz
- Ambient temperature: 5 °C to 35 °C
- Power Saving Features: Auto switch-off timer, Light sensor, Picture mute (for radio)

Accessories

- Included accessories: 2 x AA Batteries, Legal and safety brochure, Mini-jack to L/R cable, Mini-jack to YPbPr cable, Power cord, Quick start guide, Remote Control, Table top stand

Dimensions

- Set Width: 1448.7 mm
- Set Height: 829.5 mm
- Set Depth: 49.3 mm
- Product weight: 27.1 kg
- Set width (with stand): 1448.7 mm
- Set height (with stand): 842.2 mm
- Set depth (with stand): 280.0 mm
- Product weight (+stand): 27.4 kg
- Box width: 1660 mm
- Box height: 1002 mm
- Box depth: 174 mm
- Weight incl. Packaging: 35.6 kg
- Wall mount compatible: 300 x 300 mm

Connections

Side

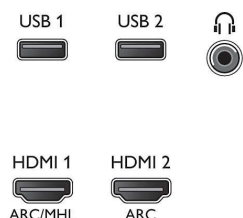

Bottom

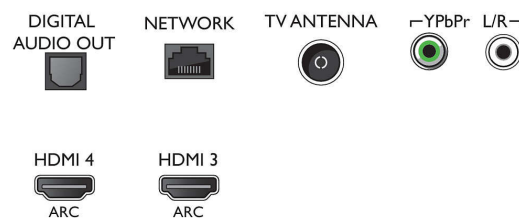

Issue date 2023-08-21

Version: 3.3.1

EAN: 87 18863 01792 0

© 2023 Koninklijke Philips N.V.
All Rights reserved.

Specifications are subject to change without notice.
Trademarks are the property of Koninklijke Philips N.V.
or their respective owners.

www.philips.com

- * EPG and actual visibility (up to 8 days) is country and operator dependent.
- * Android App offerings vary per country. For more details please visit your local Google Play Store.
- * The TV supports DVB reception for 'Free to air' broadcast. Specific DVB operators may not be supported. An up to date list can be found in the FAQ section of the Philips support website. For some operators Conditional Access and subscription are required. Contact your operator for more information.
- * Philips TV Remote app and related functionalities vary per TV model, operator, and country, as well as smart device model and OS. For more details please visit: www.philips.com/TVRemoteapp.
- * Smart TV app offerings vary per TV model and country. For more details please visit: www.philips.com/smartv.
- * Its functionality is subject to ChromeCast built-in apps and smart devices. For more details, please visit ChromeCast built-in product pages.
- * Google Assistant built-in will come as a software update for 2018 Android TVs.