

PHILIPS



4K UHD LED Android
TV

8500 series

3-sided Ambilight TV

Major HDR formats supported

P5 Perfect Picture Engine

126 cm (50") Android TV



50PUT8516

The one to watch

4K UHD LED Android TV with Ambilight

Choosing your next TV just got easy. When you're looking for superb picture and sound, easy connectivity, and responsive, hassle-free gaming-you're looking for The One. Plus you get Ambilight for an immersive experience like no other.

Slim TV. Beautiful light.

- The one with magical Ambilight. Only from Philips.
- The one with a vibrant HDR picture. Philips 4K UHD TV.
- Slim, attractive design

Smooth motion. Real color. Incredible depth.

- Major HDR formats. See more of what the director intended.
- Cinematic vision and sound. Dolby Vision and Dolby Atmos
- The one for gamers. Low latency on any console.
- Whatever the source, always perfection. Philips P5 engine.

Content at your command.

- Voice control. The Google Assistant. Works with Alexa.
- The one that's simply smart. Android TV
- The one for multi-room audio. DTS Play-Fi compatible

8500 series

4K UHD LED Android TV

50PUT8516/98

Highlights

3-sided Ambilight

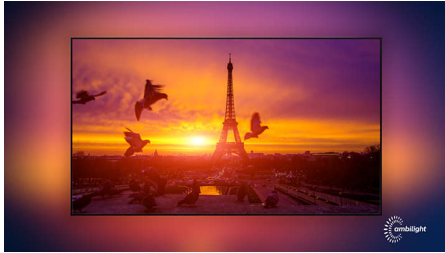

With Philips Ambilight every moment feels closer. Intelligent LEDs around the edge of the TV respond to the on-screen action and emit an immersive glow that's simply captivating. Experience it once and wonder how you enjoyed TV without it.

Dolby Vision + Dolby Atmos

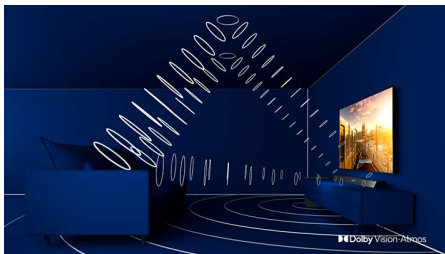

Support for Dolby's premium sound and video formats means the HDR content you watch will look-and-sound-glorious. You'll enjoy a picture that reflects the director's original intentions and experience spacious sound with real clarity and depth.

Android TV



Your Philips Android TV gives you the content you want-when you want it. You can customize the home screen to display your favorite apps,

making it simple to start streaming the movies and shows you love. Or pick up where you left off.

Philips P5 Picture Engine

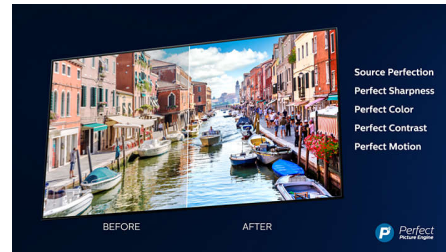

The Philips P5 engine delivers a picture as brilliant as the content you love. Details have noticeably more depth. Colors are vivid, while skin tones look natural. Contrast is so crisp you'll feel every detail. Motion is perfectly smooth.

Vibrant HDR picture

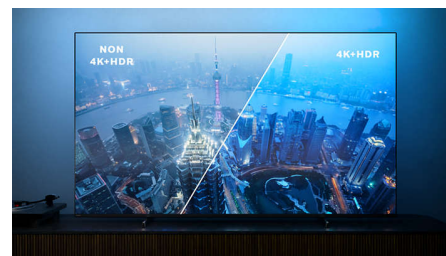

Your Philips 4K UHD TV is compatible with all major HDR formats, including Dolby Vision. Whether it's a must-watch series or the latest video game, shadows will be deeper. Bright surfaces will shine. Colors will be truer.

DTS Play-Fi compatible

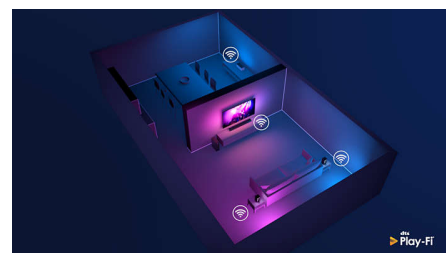

With DTS Play-Fi on your Philips TV you can connect to compatible speakers in any room. Got wireless speakers in the kitchen? Listen to the

movie while you make a snack, or keep up with the sports commentary while you get everyone drinks.

HDMI 2.1 VRR and low latency



Your Philips TV boasts the latest HDMI 2.1 connectivity, and the TV automatically switches to a low latency setting when you start playing a game on your console. VRR is supported for smooth fast-action gameplay. Ambilight's gaming mode brings the thrill right into the room.

AI voice control

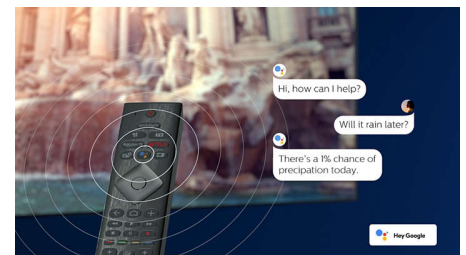

Push a button on the remote to talk to the Google Assistant. Control the TV or Google Assistant-compatible smart home devices with your voice. Or ask Alexa to control the TV via Alexa-enabled devices.



8500 series

4K UHD LED Android TV

50PUT8516/98

Specifications

Ambilight

Ambilight Features: Ambilight Music, Game Mode, Wall colour adaptive, Lounge mode, AmbiWakeup, AmbiSleep

Ambilight Version: 3-sided

Picture/Display

Aspect ratio: 16:9

Display: 4K Ultra HD LED

Panel resolution: 3840x2160

Picture engine: P5 Perfect Picture Engine

Picture enhancement: Ultra Resolution, Dolby Vision, HDR10+, Micro Dimming Pro, ISF Color Management

Supported Display Resolution

Computer inputs on all HDMI: HDR supported, HDR10/ HLG, up to 4K UHD 3840x2160 @60Hz, HDR supported, HDR10+/HLG

Video inputs on all HDMI: up to 4K UHD 3840x2160@60Hz, HDR supported, HDR10/HLG (Hybrid Log Gamma), HDR10+/Dolby Vision

Tuner/Reception/Transmission

Digital TV: DVB-T/T2

Video Playback: PAL, SECAM

Interactive TV: meWatch Red Button

MPEG Support: MPEG2, MPEG4

TV Program guide*: 8 day Electronic Program Guide

Signal strength indication

HEVC support

Android TV

OS: Android TV™ 10 (Q)

Pre-installed apps: Google Play Movies*, Google Play Music*, Google Search, YouTube, Netflix, Amazon Prime Video, Spotify

Memory size(Flash): 32GB*

Smart TV Features

User Interaction: SimplyShare

Program: Pause TV, USB recording*

Ease of Installation: Auto detect Philips devices, Device connection wizard, Network installation wizard, Settings assistant wizard

Ease of Use: One-stop smart menu button,

Onscreen usermanual

Firmware upgradeable: Firmware auto upgrade wizard, Firmware upgradeable via USB, Online firmware upgrade, FW download in background

Screen Format Adjustments: Basic - Fill Screen, Fit to screen, Advance - Shift, Zoom, stretch, Wide screen

Remote Control: with Voice

Voice assistant*: Google Assistant built-in, RC with Mic., Works with Alexa

Multimedia Applications

Video Playback Formats: Containers: AVI, MKV, H264/MPEG-4 AVC, MPEG-1, MPEG-2, MPEG-4, VP9, HEVC (H.265), AV1, HEVC

Music Playback Formats: AAC, MP3, WAV, WMA (v2 up to v9.2), WMA-PRO (v9 and v10)

Subtitles Formats Support: .SRT, .SUB, .TXT, .SMI

Picture Playback Formats: JPEG, BMP, GIF, PNG, 360 photo, HEIF

Processing

Processing Power: Quad Core

Sound

Output power (RMS): 20W

Speaker configuration: 2x10W full range speaker

Sound Enhancement: Dolby Atmos, A.I. Sound, Clear Dialogue, Night mode, A.I. EQ, Dolby Bass Enhancement, Dolby Volume Leveler, DTS Play-Fi, Mimi Sound Personalization

Specifications

Connectivity

Number of HDMI connections: 4

HDMI features: 4K, Audio Return Channel

EasyLink (HDMI-CEC): Remote control pass-through, System audio control, System standby,

One touch play

Number of USBs: 2

Wireless connection: Wi-Fi 802.11ac, 2x2, Dual band, Bluetooth 5.0

Other connections: Digital audio out (optical), Ethernet-LAN RJ-45, Headphone out

HDCP 2.3: Yes on all HDMI

HDMI ARC: Yes for all ports

HDMI eARC: Yes on HDMI2

HDMI 2.1 features: ALLM on all HDMI ports, eARC on HDMI 2, VRR on all HDMI ports

Power

Mains power: AC 220 - 240 V 50/60Hz

Ambient temperature: 5 °C to 35 °C

Power Saving Features: Auto switch-off timer, Light sensor, Picture mute (for radio), Eco mode

Accessories

Included accessories: Remote Control, Quick start guide, Legal and safety brochure, Power cord, Table top stand, 2 x AAA Batteries

Dimensions

Set Width: 1116 mm

Set Height: 645 mm

Set Depth: 81 mm

Product weight: 12.6 kg

Set width (with stand): 1116 mm

Set height (with stand): 715 mm

Set depth (with stand): 265 mm

Product weight (+stand): 13 kg

Box width: 1240.0 mm

Box height: 785.0 mm

Box depth: 150 mm

Weight incl. Packaging: 16.5 kg

Wall mount compatible: 200 x 300 mm

Connections

Side



Bottom



- * EPG and actual visibility (up to 8 days) is country and operator dependent.
- * Android App offerings vary per country. For more details please visit your local Google Play Store.
- * The TV supports DVB reception for 'Free to air' broadcast. Specific DVB operators may not be supported. An up to date list can be found in the FAQ section of the Philips support website. For some operators Conditional Access and subscription are required. Contact your operator for more information.
- * Philips TV Remote app and related functionalities vary per TV model, operator, and country, as well as smart device model and OS. For more details please visit: www.philips.com/TVRemoteapp.
- * Smart TV app offerings vary per TV model and country. For more details please visit: www.philips.com/smarttv.
- * Amazon Prime is available in selected languages and countries.
- * Google Assistant is available on Philips Android TVs running on Android O (8) or higher OS version. Google Assistant is available in selected languages and countries.
- * Netflix subscription required. Subject to terms at <https://www.netflix.com>
- * Amazon, Alexa and all related logos are trademarks of Amazon.com, Inc. or its affiliates. Amazon Alexa is available in selected languages and countries.
- * Image depicted on the website are non-contractual pictures. Please always refer to the actual TV that are sold in the retail or stores.
- * Disney+ subscription required. Subject to terms at <https://www.disneyplus.com> (c) 2020 Disney and its related entities. Disney+ is available in selected languages and countries.