



Philips 7300 series  
4K UHD Android TV with  
Ambilight 3-sided

139 cm (55") Ambilight TV  
1600 Picture Performance Index  
HDR Plus  
P5 Perfect Picture Engine



55PUS7303

## Simply smart. Clearly brilliant.

with Ambilight 3-sided

Indulge in the shows, films and games you love with a 4K UHD TV that makes content from any source look superb. With Android TV, wireless connectivity and Ambilight you won't just stream your favourites. You'll get lost in them.

### Sharp. Light. Immersive.

- Slender bezel and metal stand.
- Ambilight. Take the emotion beyond the screen.

### Delight in the beauty of 4K

- 4K Ultra HD. Pictures so sharp you'll think you're there.
- Philips P5 Engine. Whatever the source, always perfection.

### Rich colour. Sharp contrast.

- HDR Plus. Enhanced contrast, colour and sharpness.
- Micro Dimming Pro. Intelligent contrast for dynamic scenes.

### Android TV-powerfully smart

- Quad Core processor and Android. Unleash your content.
- Google Assistant built in. Content and more at your command.
- Google Play store and Philips app gallery. More to love.

# PHILIPS

4K UHD Android TV with Ambilight 3-sided  
139 cm (55") Ambilight TV 1600 Picture Performance Index, HDR Plus, P5 Perfect Picture Engine

55PUS7303/12

# Highlights

## Ambilight 3-sided

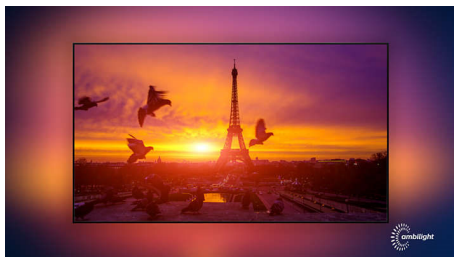

With Philips Ambilight, movies and games feel more immersive. Music gets a light show. And your screen will feel bigger than it is. Intelligent LEDs around the edges of the TV cast on-screen colours onto the walls and into the room, in real time. You get perfectly tuned ambient lighting. And one more reason to love your TV.

## Slender Bezel

Slender bezel and metal stand.

## 4K Ultra HD

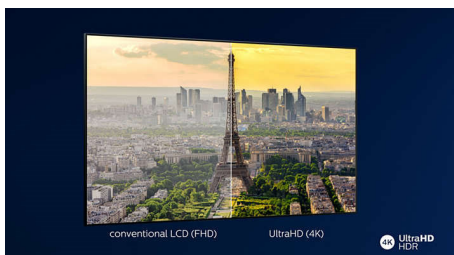

With four times the resolution of conventional Full HD, Ultra HD lights up your screen with over 8 million pixels and our unique Ultra Resolution Upscaling technology. Experience improved images regardless of the original content, and enjoy a sharper picture with superior depth, contrast, natural motion and vivid details.

## P5 Perfect Picture Engine

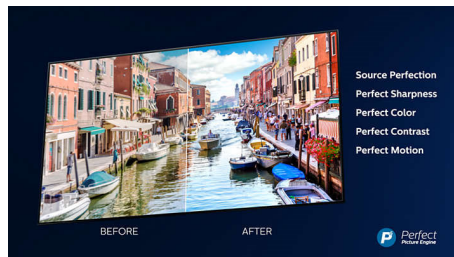

The Philips P5 Perfect Picture Engine delivers an image as brilliant as the content you love. Details have noticeably more depth. Colours are vivid, while skin tones look natural. Contrast is so crisp you'll feel every detail. And motion is so smooth that you'll never lose sight of the ball, no matter how fast the play.

## High Dynamic Range Plus



High Dynamic Range Plus is a new video standard. It redefines in-home entertainment through advances in contrast and colour. Enjoy a sensory experience that captures the original richness and liveliness, yet accurately reflects the content creator's intent. The end result? Brighter highlights, greater contrast, a broader range of colours and detail like never before.

## Micro Dimming Pro

Micro Dimming Pro optimises the contrast on your TV based on the lighting conditions of your room. Combined with its special software that analyses the picture in 6400 different zones, you will enjoy incredible contrast and

image quality for a truly lifelike visual experience - day or night.

## Quad Core + Android

Philips Quad Core processor meets the power of Android to deliver an exciting gaming experience. And with Android on your TV you'll navigate, launch apps and play videos in a way that is super fast, super intuitive and super fun.

## Google Assistant built in

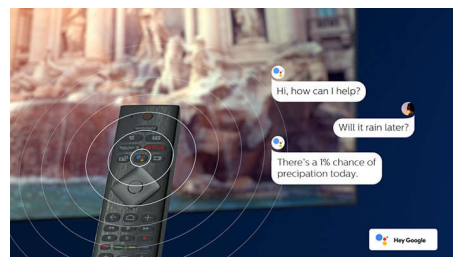

Control your Philips Android TV with your voice. Want to play a game, watch Netflix or find content and apps in the Google Play store? Just tell your TV. You can even command all Google Assistant-compatible smart home devices, like dimming the lights and setting the thermostat on movie night. Without leaving the sofa.

## TV Content

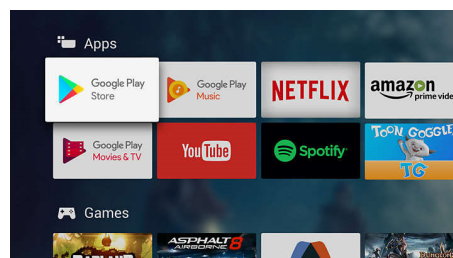

Go beyond traditional TV programming with Google Play Store and Philips App Gallery. Experience endless movies, TV, music, apps and games online. More to love.



# Specifications

## Ambilight

- Ambilight Features: Built-in Ambilight+hue, Ambilight Music, Game Mode, Wall colour adaptive, Lounge mode
- Ambilight Version: 3 sided

## Picture/Display

- Aspect ratio: 16:9
- Diagonal screen size (inch): 55 inch
- Diagonal screen size (metric): 139 cm
- Display: 4K Ultra HD LED
- Panel resolution: 3840 x 2160
- Picture engine: P5 Perfect Picture Engine
- Picture enhancement: Ultra Resolution, Micro Dimming Pro, 1600 PPI

## Supported Display Resolution

- Computer inputs on HDMI 1/2: up to 4K UHD 3840 x 2160 @60 Hz, HDR supported, HDR10/HLG
- Computer inputs on HDMI 3/4: up to 4K UHD 3840 x 2160 @60 Hz
- Video inputs on HDMI 1/2: up to 4K UHD 3840 x 2160 @60 Hz, HDR supported, HDR10/HLG
- Video inputs on HDMI 3/4: up to 4K UHD 3840 x 2160 @60 Hz

## Tuner/Reception/Transmission

- Digital TV: DVB-T/T2/T2-HD/C/S/S2
- Video Playback: NTSC, PAL, SECAM
- MPEG Support: MPEG2, MPEG4
- TV Programme guide\*: 8-day Electronic Programme Guide
- Signal strength indication
- Teletext: 1000 page Hypertext
- HEVC support

## Android TV

- OS: Android TV™ 8 (Oreo)
- Pre-installed apps: Google Play Movies\*, Google Play Music\*, Google Search, YouTube
- Memory size (Flash): 16 GB\*

## Smart TV Features

- User Interaction: SimplyShare
- Interactive TV: HbbTV
- Programme: Pause TV, USB recording\*
- SmartTV apps\*: Online video stores, Open Internet browser, Social TV, TV on demand, YouTube
- Ease of Installation: Auto detect Philips devices, Device connection wizard, Network installation wizard, Settings assistant wizard

- Ease of Use: One-stop smart menu button, On-screen user manual
- Firmware upgradeable: Firmware auto upgrade wizard, Firmware upgradeable via USB, Online firmware upgrade
- Screen Format Adjustments: Basic - Fill Screen, Fit to screen, Advance - Shift, Zoom, stretch
- Philips TV Remote app\*: Apps, Channels, Control, NowOnTV, TV Guide, Video On Demand
- Remote Control: with Voice, with Keyboard

## Multimedia Applications

- Video Playback Formats: Containers: AVI, MKV, H264/MPEG-4 AVC, MPEG-1, MPEG-2, MPEG-4, WMV9/VC1, VP9, HEVC (H.265)
- Music Playback Formats: AAC, MP3, WAV, WMA (v2 up to v9.2), WMA-PRO (v9 and v10)
- Subtitles Formats Support: .SRT, .SUB, .TXT, .SMI
- Picture Playback Formats: JPEG, BMP, GIF, PNG

## Processing

- Processing Power: Quad Core

## Sound

- Output power (RMS): 20 W
- Speaker configuration: 2 x 10 W full-range speaker
- Sound Enhancement: Smart Sound, DTS-HD Premium Sound, DTS Studio Sound, DTS TruSurround

## Connectivity

- Number of HDMI connections: 4
- HDMI features: 4K, Audio Return Channel
- Number of components in (YPbPr): 1
- EasyLink (HDMI-CEC): Remote control pass-through, System audio control, System standby, One touch play
- Number of USBs: 2
- Wireless connection: Dual Band, Wi-Fi 802.11n 2 x 2 integrated
- Other connections: Antenna IEC75, Satellite Connector, Common Interface Plus (CI+), Digital audio out (optical), Ethernet-LAN RJ-45, Audio L/R in, Headphone out
- HDCP 2.2: Yes on all HDMI

## Power

- Mains power: AC 220 - 240 V 50/60 Hz
- Ambient temperature: 5°C to 35°C
- Standby power consumption: <0.3 W
- Energy Label Class: A+
- EU Energy Label power: 86 W

- Power Saving Features: Auto switch-off timer, Picture mute (for radio), Light sensor
- Off mode power consumption: N/A
- Annual energy consumption: 126 kWh
- Presence of lead: Yes\*
- Mercury content: 0 mg

## Accessories

- Included accessories: Remote Control, 2 x AA Batteries, Quick start guide, Legal and safety brochure, Power cord, Mini-jack to L/R cable, Mini-jack to YPbPr cable, Tabletop stand

## Colour & Finish

- TV Front: Dark Silver

## Dimensions

- Set Width: 1244.2 mm
- Set Height: 729.0 mm
- Set Depth: 78.2 mm
- Product weight: 15.3 kg
- Set width (with stand): 1244.2 mm
- Set height (with stand): 781.2 mm
- Set depth (with stand): 266.3 mm
- Product weight (+stand): 16.1 kg
- Box width: 1360 mm
- Box height: 860 mm
- Box depth: 160 mm
- Weight incl. Packaging: 21.5 kg
- Wall-mount compatible: 300 x 200 mm
- TV stand width distance: 780 mm



## Connections

### Side

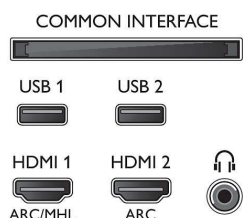

### Bottom

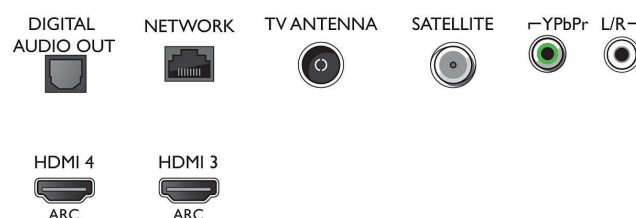

Issue date 2023-07-13

Version: 14.0.1

EAN: 87 18863 01508 7

© 2023 Koninklijke Philips N.V.  
All Rights reserved.

Specifications are subject to change without notice.  
Trademarks are the property of Koninklijke Philips N.V.  
or their respective owners.

[www.philips.com](http://www.philips.com)

\* EPG and actual visibility (up to 8 days) is country- and operator-dependent.

\* Android App offerings vary per country. For more details please visit your local Google Play Store.

\* Energy consumption in kWh per year based on the power consumption of the television operating 4 hours per day for 365 days. The actual energy consumption will depend on how the television is used.

\* The TV supports DVB reception for 'Free to air' broadcast. Specific DVB operators may not be supported. An up to date list can be found in the FAQ section of the Philips support website. For some operators Conditional Access and subscription are required. Contact your operator for more information.

\* Philips TV Remote app and related functionalities vary per TV model, operator and country, as well as smart device model and OS. For more details please visit: [www.philips.com/TVRemoteapp](http://www.philips.com/TVRemoteapp).

\* Smart TV app availability varies per TV model and country. For more details please visit: [www.philips.com/smarttv](http://www.philips.com/smarttv).

\* USB recording for digital channels only, recordings may be limited by broadcast copy protection (CI+). Country and channel restrictions may apply.

\* Please note that your Amazon Apps may not always be available in your country. (Currently Amazon apps works only in the UK, Germany and Austria)

\* This television contains lead only in certain parts or components where no technology alternatives exist in accordance with existing exemption clauses under the RoHS Directive.

\* Its functionality is subject to ChromeCast built-in apps and smart devices. For more details, please visit ChromeCast built-in product pages.

\* Google Assistant built in will come as a software update for 2018 Android TVs.