

PHILIPS

SP9883
SP9886

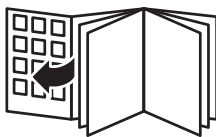

www.philips.com/support/ifu-lux



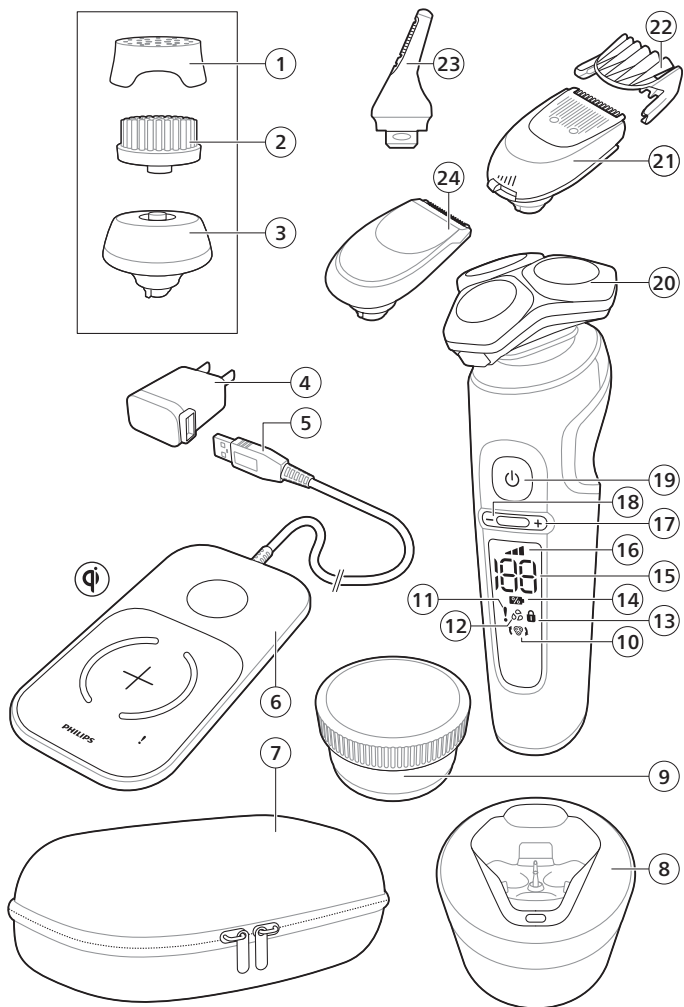

English 6
简体中文 39

Introduction

Congratulations on your purchase and welcome to Philips! To fully benefit from the support that Philips offers, register your product at

www.philips.com/welcome.

Please read this user manual, as it contains information about the features of this shaver as well as some tips to make shaving easier and more enjoyable.

General description (Fig. 1)

- 1 Protection cap for cleansing brush attachment (SP9883 only)
- 2 Click-on cleansing brush attachment (SP9883 only)
- 3 Attachment holder (SP9883 only)
- 4 Supply unit
- 5 USB plug
- 6 Wireless Qi charging pad
- 7 Pouch
- 8 Quick Clean Pod
- 9 Quick Clean Pod Cartridge
- 10 Replacement reminder
- 11 Notification symbol
- 12 Cleaning reminder
- 13 Travel lock symbol
- 14 Battery charge indicator
- 15 Battery charge percentage
- 16 Personal comfort settings bar
- 17 Personal comfort settings increase button
- 18 Personal comfort settings decrease button
- 19 On/off button
- 20 Shaving unit with hair chamber
- 21 Click-on beard styler attachment (SP9883 only)
- 22 Comb for beard styler attachment (SP9883 only)
- 23 Click-on nose trimmer attachment (SP9886 only)
- 24 Click-on precision trimmer attachment (SP9886 only)

The accessories supplied may vary for different products. The box shows the accessories that have been supplied with your appliance.

Important safety information

Read this important information carefully before you use the appliance and its accessories and save it for future reference. The accessories supplied may vary for different products.

Warning



- Keep the supply unit dry.



- This shaver is waterproof. It is suitable for use in the bath or shower and for cleaning under the tap.



- The appliance is a Class III construction.
- Never immerse the charging pad in water, nor rinse it under the tap.
- Always make sure the charging pad is completely dry before you connect it to the wall socket.
- Do not use a USB extension cord.
- This appliance can be used by children aged from 8 years and above and persons with reduced physical, sensory or mental capabilities or lack of experience and knowledge if they have been given supervision or instruction concerning use of the appliance in a safe way and understand the hazards involved. Children shall not play with the appliance. Cleaning and user maintenance shall not be made by children without supervision.
- Do not use a damaged appliance. Replace damaged parts with new Philips parts.
- The charging pad is not intended for use in a car. It may interfere with the automotive electronic systems.
- Because of hygiene, only one person should use the appliance.

- Only use cold or lukewarm water to clean the appliance.
- Never use compressed air, scouring pads, abrasive cleaning agents or aggressive liquids to clean the appliance.
- Do not put the appliance or any part in the dishwasher.
- Water may drip from the socket at the bottom of the shaver when you rinse it. This is normal and not dangerous because all electronics are enclosed in a sealed power unit inside the shaver.
- Do not use the supply unit in or near wall sockets that contain an electric air freshener to prevent irreparable damage to the supply unit.
- Remove piercings, jewelry, glasses etc. before using the appliance.
- Do not use the cleansing brush on chapped skin, open wounds, healing wounds, skin recovering from surgery or if you suffer from a skin disease or severe skin irritation, such as severe acne, sunburn, skin infection, skin cancer, inflammation, eczema, psoriasis, nylon allergy etc.
- Do not use the cleansing brush if you take steroid-based medication.
- Only use original Philips accessories or consumables. Only use detachable supply unit HQ87 and charging pad HQ8510.
- Charge, use and store the product at a temperature between 5 °C and 35 °C.
- Keep product and batteries away from fire and do not expose them to direct sunlight or high temperatures.
- If the product becomes abnormally hot or smelly, changes color or if charging takes longer than usual, stop using and charging the product and contact Philips.
- Do not place products and their batteries in microwave ovens or on induction cookers.
- Do not open, modify, pierce, damage or dismantle the product or battery to prevent batteries from heating up or releasing toxic or hazardous substances. Do not short-circuit, overcharge or reverse charge batteries.

- If batteries are damaged or leaking, avoid contact with the skin or eyes. If this occurs, immediately rinse well with water and seek medical care.

Electromagnetic fields (EMF)

This Philips appliance complies with all applicable standards and regulations regarding exposure to electromagnetic fields.

Caution

- If your shaver comes with a cleaning system, always use the original Philips Quick Clean Pod cartridge.
- Always place the cleaning system on a stable, level and horizontal surface to prevent leakage.
- Always make sure the cartridge compartment is closed before you use the cleaning system.
- When the cleaning system is ready for use, do not move it to prevent leakage of cleaning fluid.

Danger

Philips Quick Clean Pod Cartridge fluid

- Do not swallow.
- Keep out of reach of children.

The display

Note: Remove any sticker or protective foil from the display before using the product.

Charging



When the shaver is charging, the ring on the pad lights up and the battery charge indicator on the shaver flashes white.

The battery charge is indicated by the battery charge percentage flashing on the display, which is shown when the shaver is moved.

Quick charge: After approx. 18 minutes charging, the appliance contains enough energy for one shave.

Battery fully charged

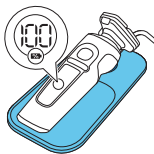

When the battery is fully charged, the battery charge indicator and the ring on the pad light up white continuously.

Note: Both lights switch off automatically after 15 minutes.

The battery charge percentage lights up white continuously, which is shown when the shaver is moved.

Battery low



When the battery is almost empty, the battery charge indicator flashes orange and the shaver beeps. At this point there is enough energy left for one shave..

Remaining battery charge



The remaining battery charge is indicated by the battery charge percentage shown on the display.

Personal comfort settings

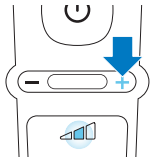

The shaver has a feature that allows you to personalize your settings. Depending on your personal shaving needs, choose between three settings, from low to high: comfort, dynamic or efficiency. When you press the button on the left or right of the display, the segment of the personal comfort settings bar lights up to indicate the selected setting. To select a lower or higher setting, press the button on the left or right of the display.

Cleaning reminder



Clean the shaver after every use for optimal performance (see 'Cleaning and maintenance'). When you switch off the shaver, the cleaning reminder flashes to remind you to clean the shaver.

Travel lock

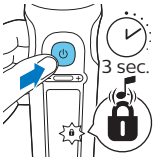

When you are going to travel, you can lock the shaver to prevent it from accidentally switching on (see 'Activating the travel lock').

Replacement reminder

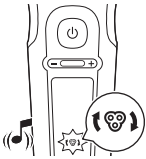

For maximum shaving performance, replace the shaving heads every two years. The shaver is equipped with a replacement reminder which reminds you to replace the shaving heads. The shaver beeps, the replacement reminder lights up and the arrows flash to indicate that you have to replace the shaving heads.

Note: After replacing the shaving heads, you can reset the replacement reminder by pressing the on/off button for 7 seconds. If you do not reset the replacement reminder, the shaver resets automatically after 9 shaves.

Notification symbol

Overheating



If the shaver overheats during charging, the notification symbol flashes. When this happens, the shaver stops charging automatically. Charging continues once the temperature of the shaver has decreased to the normal level after approx. 10 minutes.

Blocked shaving heads



If the shaving heads are blocked, the notification symbol continuously lights up red. The replacement reminder and the cleaning reminder alternately flash white and the shaver beeps. In this case, the motor cannot run because the shaving heads are dirty or damaged. If the shaving heads are dirty, you have to clean them. If the shaving heads are damaged, you have to replace them.

Foreign object on wireless Qi charging pad



If there is a foreign (metal) object on the wireless Qi charging pad during charging, the notification symbol on the wireless Qi charging pad lights up. The wireless Qi charging pad switches off automatically and restarts 5 minutes after the foreign object has been removed.

Do not place any foreign (metal) objects on the wireless Qi charging pad. Only use the wireless Qi charging pad to charge the shaver or another device (e.g. smartphone) compliant with Qi charging.

Charging

Charge the shaver before you use it for the first time and when the display indicates that the battery is almost empty.

Charging takes approx. 3 hours. A fully charged shaver has a shaving time of up to 60 minutes.

After approx. 18 minutes of charging the shaver contains enough power for one shave.

Note: You cannot use the shaver while it is charging.

Quick charge

After approx. 18 minutes of charging the shaver contains enough power for one shave.

Charging with the wireless Qi charging pad



Note: The charging pad is Qi compliant. Only charge the Qi compatible shaver or other Qi charging compliant appliances on the wireless Qi charging pad provided.

Note: Carefully shake off excess water before placing the shaver on the Qi pad.

- 1 Put the USB plug in the supply unit supplied.
- 2 Put the supply unit in the wall socket.

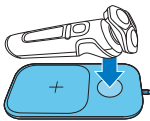
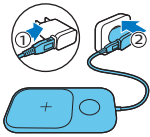

Place the shaver on the cross mark of the wireless Qi charging pad. Make sure the shaver fits into the cavity of the wireless Qi charging pad.

Only charge the shaver on the provided wireless Qi charging pad.



- The wireless Qi charging pad beeps and the ring on the pad lights up when the shaver is correctly placed and connected for charging.

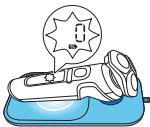

- When the shaver is charging, the ring on the pad lights up and the battery charge indicator on the shaver flashes white. The battery charge is indicated by the battery charge percentage flashing on the display, which is shown when the shaver is moved.
- 3 When the battery is fully charged, the battery charge indicator and the ring on the pad light up white continuously. Both lights switch off automatically after 15 minutes.

Using the shaver



Always check the shaver and all accessories before use. Do not use the shaver or any accessory if it is damaged, as this may cause injury. Always replace a damaged part with one of the original type.

This symbol indicates that the shaver can be used in the bath or shower.

- Use this shaver for its intended household use as described in this manual.
- For hygienic reasons, the shaver should only be used by one person.
- Trimming is easier when the skin and hair are dry.

Note: This shaver is waterproof. It is suitable for use in the bath or shower and for cleaning under the tap. For safety reasons, the shaver can only be used without cord.

Switching the shaver on and off

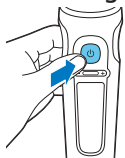

- 1 To switch on the shaver, press the on/off button once. The battery charge percentage lights up for a few seconds.
- 2 To switch off the shaver, press the on/off button once. The battery charge percentage lights up for a few seconds and shows the remaining battery charge.

Shaving

Skin adaptation period

Your first shaves may not bring you the result you expect and your skin may even become slightly irritated. This is normal. Your skin and beard need time to adapt to any new shaving system. To allow your skin to adapt to this new appliance, we advise you to shave regularly (at least 3 times a week) and exclusively with this appliance for a period of 3 weeks.

Shaving tips

- For the best results on skin comfort, pre-trim your beard if you have not shaved for 3 days or longer.
- Select your personal comfort setting (see 'Personal comfort settings').



Dry shaving

- 1 Switch on the shaver.
- 2 Move the shaving heads over your skin in circular movements to catch all hairs growing in different directions. Make sure each shaving head is fully in contact with the skin. Exert gentle pressure for a close, comfortable shave.

Note: Do not press too hard, as this can cause skin irritation.

- 3 Switch off and clean the shaver after each use (see 'Cleaning and maintenance').
The display lights up for a few seconds to show the remaining battery charge.

Wet shaving

For a more comfortable shave, you can also use this appliance on a wet face with shaving foam or shaving gel.

- 1 Apply some water to your skin.



- 2 Apply shaving foam or shaving gel to your skin.



- 3 Rinse the shaving unit under the tap to ensure that the shaving unit glides smoothly over your skin.
- 4 Switch on the shaver.

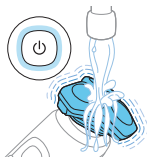



- 5 Move the shaving heads over your skin in circular movements to catch all hairs growing in different directions. Make sure each shaving head is fully in contact with the skin. Exert gentle pressure for a close, comfortable shave.

Note: Do not press too hard, as this can cause skin irritation.

Note: Rinse the shaving unit regularly to ensure that it continues to glide smoothly over your skin.

- 6 Dry your face.
- 7 Switch off the shaver and clean it after each use.

Note: Make sure that you rinse all foam or shaving gel off the shaver.

Using click-on attachments

It is recommended not to use the click-on cleansing brush attachment directly after shaving to prevent skin irritation.

Removing or attaching click-on attachments

- 1 Make sure the shaver is switched off.
- 2 Pull the attachment straight off the shaver.

Note: Do not twist the attachment while you pull it off the shaver.



- 3 Insert the lug of the attachment into the slot in the top of the shaver. Then press down the attachment to attach it to the shaver ('click').

Attachment holder

Note: Attach the click-on cleansing brush attachment on the attachment holder first, before you place the attachment onto the appliance.



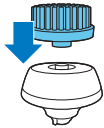

- 1 Place the click-on attachment onto the attachment holder until it locks into position with a click.

Using the beard styler attachment with comb

You can use the beard styler with the comb attached to style your beard at one fixed setting, but also at different length settings. You can also use it to pre-trim any long hairs before shaving for a more comfortable shave.

Note: The beard styler is only intended for trimming facial hair. Do not use on areas below the neck.

The length settings on the beard styler attachment correspond to the remaining hair length after cutting and range from 1 to 5 mm ($3/64$ - $3/16$ in).

- 1 Attach the attachment to the appliance ('click').



- 2 Slide the comb straight into the guiding grooves on both sides of the beard styler attachment ('click').



- 3 Press the length selector and then push it to the left or right to select the desired hair length setting.
- 4 Switch on the appliance.

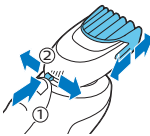



- 5 Move the appliance upwards while you exert gentle pressure. Make sure the front of the comb is in full contact with the skin.
- 6 Clean the attachment after use.

Using the beard styler attachment without comb

You can use the beard styler attachment without the comb to contour your beard, moustache, sideburns or neckline at a length of 0.5 mm (1/32 in).

Note: The beard styler is only intended for trimming facial hair. Do not use it on areas below the neck.



- 1 Pull the comb off the beard styler attachment.

Note: Grab the comb in the center to pull it off the beard styler attachment. Do not pull at the sides of the comb.

- 2 Switch on the appliance.



- 3 Hold the beard styler attachment perpendicular to the skin and move the appliance downwards while you exert gentle pressure.
- 4 Clean the attachment after use.

Using the cleansing brush attachment

Note: For better shaving results, use the click-on cleansing brush attachment before shaving.

Use the rotating cleansing brush with your daily cleansing cream. The cleansing brush removes oil and dirt, contributing to a healthy and oil-free skin. We advise you to use it no more than twice a day. Start with the lowest personal comfort setting to familiarize yourself with the attachment.

Do not use the appliance on damaged or irritated skin or on wounds.



- 1 Place the attachment on the attachment holder.
- 2 Attach the attachment to the appliance ('click').

- 3 Moisten the attachment with water.

Note: Do not use the appliance with a dry cleansing brush attachment, as this can irritate the skin.

- 4 Moisten your face with water and apply a cleanser to your face.
- 5 Place the attachment on your cheek.
- 6 Switch on the appliance.

- 7 Gently move the brush across your skin from the nose towards the ear. Do not push the brush too hard onto the skin to make sure that the treatment remains comfortable.

Note: Do not cleanse the sensitive area around your eyes.

- 8 After approx. 20 seconds, move the appliance to your other cheek and start cleansing this part of your face.



- 9** After approx. 20 seconds, move the appliance to your forehead and start cleansing this part of your face. Gently move the brush head from left to right.

Note: We advise you to not overdo the cleansing and to not cleanse any zone longer than 20 seconds.



- 10** Switch off the appliance and clean the attachment after use.
- 11** After the treatment, rinse and dry your face. Your face is now ready for the next step of your daily skincare routine.

Using the precision trimmer attachment

You can use the precision trimmer attachment to touch up your beard, sideburns and moustache.



- 1** Attach the attachment to the appliance ('click').
- 2** Switch on the appliance.



- 3** Hold the precision trimmer perpendicular to the skin and move it downwards while exerting gentle pressure.
- 4** Switch off the appliance and clean the attachment after use.

Using the nose/ear trimmer attachment

You can use the nose/ear trimmer attachment to trim your nose and/or ear hair.

Trimming nose hair

When trimming nose hair, make sure your nostrils are clean.

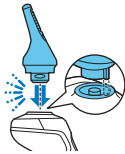

- 1 Attach the attachment to the appliance ('click').
- 2 Switch on the appliance.

max.
5mm



- 3 Carefully insert the trimming head into one of your nostrils.

Do not insert the attachment more than 0.5cm into your nostrils.



- 4 Slowly move the trimming head around to remove all unwanted hairs in your nostrils.
- 5 Switch off the appliance and clean the attachment after use.

Trimming ear hair

When trimming ear hair, make sure your outer ear channels are clean and free from wax.

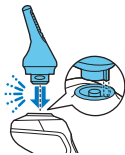

- 1 Attach the attachment to the appliance ('click').
- 2 Switch on the appliance.

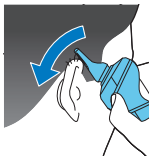

- 3 Slowly move the trimming head along the rim of the ear to remove hairs that stick out beyond the rim.
- 4 Carefully insert the trimming head into the outer ear channel.

max.
5mm



Do not insert the trimming head more than 0.5 cm into your ear channel, as this could damage the eardrum.

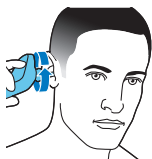

- 5 Slowly turn the trimming head around to remove all unwanted hairs from your outer ear channel.
- 6 Switch off the appliance and clean the attachment after use.

Travel lock

You can lock the shaver when you are going to travel to prevent it from switching on accidentally.

Activating the travel lock

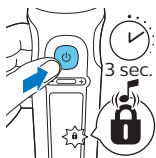

- 1 Press the on/off button for 3 seconds to use the travel lock mode.

While you activate the travel lock, the travel lock symbol lights up briefly and the shaver produces a short sound. When the travel lock is activated, the travel lock symbol flashes.

If you try to switch on the shaver while the travel lock is active, the travel lock symbol flashes.

Deactivating the travel lock



- 1 Press the on/off button for 3 seconds.

While you deactivate the travel lock, the travel lock symbol lights up briefly and the shaver produces a short sound. The shaver switches on and is now ready for use again.

Note: The shaver unlocks automatically when it is placed on the wireless Qi charging pad.

Cleaning and maintenance

Regular cleaning guarantees better shaving results.

Never clean, remove or replace the shaving unit while the shaver is switched on.

Do not apply pressure to shaving head guards.

Do not touch shaving heads with hard objects as this may dent or damage the precision-made slotted guards.

Do not use compressed air, abrasives, scourers or aggressive liquids such as petrol or acetone to clean the shaver.

How do I use the Quick Clean Pod ?

What does the icon on my Quick Clean Pod mean?

Icon	Behavior	Meaning
	Becomes visible on the Quick Clean Pod	The Quick Clean Pod Cartridge needs to be replaced.

Preparing the Quick Clean Pod for use

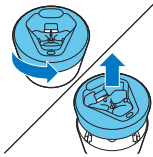

- 1 Twist and remove the top of the Quick Clean Pod.

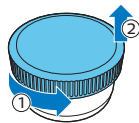

- 2 Twist the lid off of the Quick Clean Pod Cartridge.

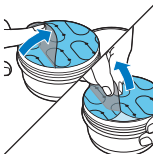

- 3 Lift the tab on the seal and pull it by the corner to remove the seal from the Quick Clean Pod Cartridge.

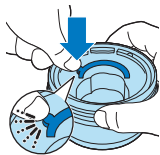

- 4 Press the small circular piece on the handle of the Quick Clean Pod Cartridge to break the snap hook on the handle.



- 5 Place the Quick Clean Pod Cartridge into the Quick Clean Pod.

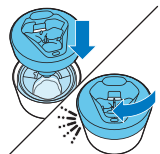

- 6 Put the top of the Quick Clean Pod back onto the base and turn it clockwise until you hear a click.

Do not tilt the Quick Clean Pod to prevent leakage.



Using the Quick Clean Pod

Note: If you use the shaver with shaving foam, shaving gel or pre-shave products, thoroughly rinse the shaving heads before you use the Quick Clean Pod.

Always shake excess water off the shaver before you place it in the Quick Clean Pod.

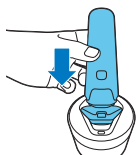

- 1 Place the shaver upside down into the Quick Clean Pod. The shaver automatically detects that it is in the Quick Clean Pod.
- 2 Switch on the shaver to start the cleaning program.

Each cleaning program takes approximately one minute. During the cleaning program the remaining time is displayed as a countdown clock on the handle.

- Let the shaver air-dry completely in the Quick Clean Pod before storing it.

Replacing the Quick Clean Pod Cartridge



Replace the Quick Clean Pod Cartridge immediately when the cartridge replacement icon on the Quick Clean Pod becomes visible or follow the table below.

Frequency of use	Cycles	When to replace the Quick Clean Pod Cartridge
Every day	About 30	Every month
A few times per week	About 20	Every 2 months
Every week	About 13	Every 3 months
Every month	About 3	Every 3 months

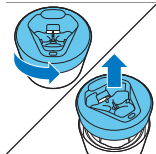

- Twist and remove the top of the Quick Clean Pod.

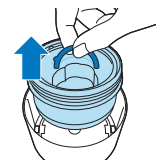

- Lift the Quick Clean Pod Cartridge out of the Quick Clean Pod by the handle.



- 3 Pour any remaining fluid down a drain and recycle the empty cartridge in accordance with local waste regulations.



- 4 Place a new Quick Clean Pod Cartridge into the Quick Clean Pod (see 'Preparing the Quick Clean Pod for use'). Scan the QR code to the left or visit www.philips.com/cleaning-cartridge to order replacement Quick Clean Pod Cartridges.

Thorough cleaning

We advise you to clean the shaving heads thoroughly once a month or when the shaver does not shave as well as it used to.

- 1 Switch off the shaver.
- 2 Pull the shaving head holder off the bottom part of the shaving unit.

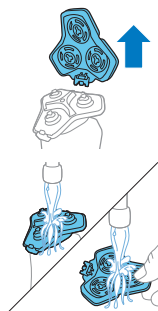

- 3 Rinse the hair chamber and shaving head holder under the tap. You can also use the cleaning brush to remove excess hairs before rinsing.

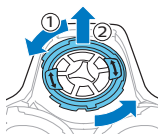

- 4 Turn the retaining ring counterclockwise and lift it off the shaving head. Repeat this process for the other retaining rings. Place them aside in a safe place.

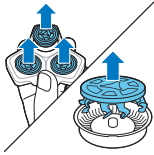

- 5** Remove the shaving heads from the shaving head holder. Each shaving head consists of a cutter and guard.

Note: Do not clean more than one cutter and guard at a time, since they are all matching sets. If you accidentally put a cutter in the wrong shaving guard, it may take several weeks before optimal shaving performance is restored.

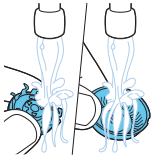

- 6** Clean the cutter and guard under the tap.
You can also use the cleaning brush to remove excess hairs before rinsing.
- 7** Shake off excess water.
- 8** Put the cutter back into the guard.

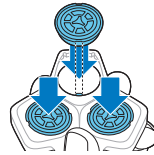

- 9** Place the shaving heads in the shaving head holder.



- 10** Place the retaining ring on the shaving head.

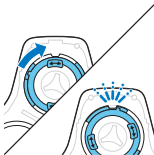

- 11** Align the arrows on the retaining ring with the projections in the shaving head holder. Turn the ring clockwise until it clicks to indicate that the ring is fixed.



- 12 Attach the shaving head holder to the bottom part of the shaving unit ('click').

Cleaning the beard styler attachment

Clean the beard styler attachment after each use.

- 1 Pull the comb off the beard styler attachment.

Note: Grab the comb in the center to pull it off the beard styler attachment. Do not pull at the sides of the comb.

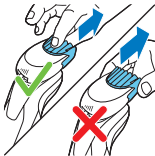

- 2 Rinse cut hairs off the cutting unit with lukewarm water.
- 3 Rinse cut hairs off the comb.

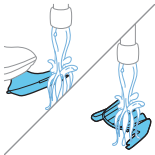

- 4 Remove the cutting unit from the beard styler attachment. By pushing the cutting unit off the beard styler attachment, you can remove any hairs that have accumulated inside the beard styler attachment. You can also rinse the bottom of the cutting unit.



- 5 Rinse cut hairs out of the beard styler attachment.
- 6 Carefully shake off excess water and leave the comb, cutting unit and beard styler attachment to air-dry before you use them again.

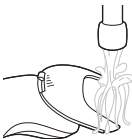



- 7 When the cutting unit is dry, attach it to the beard styler attachment.



- 8 When the comb is dry, attach it to the beard styler attachment.
9 For optimal performance, lubricate the teeth of the attachment with a drop of sewing machine oil regularly.

Cleaning the cleansing brush

Clean the attachment after each use.

- 1 Switch off the appliance.
- 2 Remove the attachment from the attachment holder.

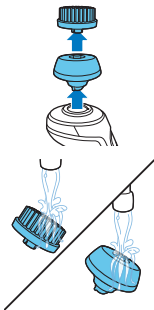

- 3 Clean the parts thoroughly with warm water.
- 4 Dry the attachment with a towel.

Cleaning the trimmer attachment

Never dry the trimmer with a towel or tissue, as this may damage the trimming teeth.

Clean the trimmer attachment after each use.

- 1 Switch on the appliance with the precision trimmer attachment attached.

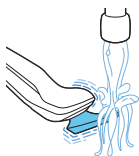

- 2 Rinse the attachment under a warm tap.
- 3 After cleaning, switch off the appliance.
- 4 Carefully shake off excess water and let the attachment air-dry completely.

Tip: For optimal performance, lubricate the teeth of the attachment with a drop of sewing machine oil regularly.

Cleaning the nose trimmer attachment

Clean the nose trimmer attachment every time you have used it.

- 1 Switch off the appliance.
- 2 Rinse the trimming head of the nose trimmer with hot water.

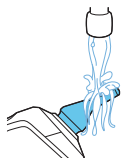

- 3 Switch on the appliance and rinse the trimming head once more to remove any remaining hairs. Then switch off the appliance again.

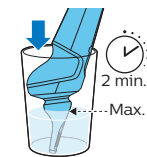

If rinsing the trimming head under the tap is not sufficient, immerse the trimming head in a glass with warm water for a few minutes. Then switch on the appliance and rinse it under the tap.



- 4 Carefully shake off excess water and let the nose trimmer attachment dry.

Tip: For optimal trimmer performance, lubricate the trimming head with a drop of sewing machine oil every six months.

Replacement

Replacing the shaving heads

For maximum shaving performance, we advise you to replace the shaving heads every two years. Replace damaged shaving heads immediately.



Always replace the shaving heads with original Philips shaving heads (see 'Ordering accessories').



Replacement reminder

The replacement reminder indicates that the shaving heads need to be replaced. The shaving unit symbol lights up continuously, the arrows flash white and you hear a beep when you switch the shaver on or off.

1 Switch off the shaver.



2 Press the release button on the shaving unit and pull the shaving head holder off the shaving unit.



3 Remove the shaving heads from the shaving head holder. Discard the used shaving heads immediately to avoid mixing them with the new shaving heads.

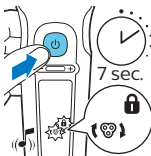

4 After replacing the shaving heads, you can reset the replacement reminder by pressing the on/off button for 7 seconds. Wait until you hear 3 beeps. If you do not reset the replacement reminder, the shaver resets automatically after 9 shaves.

Replacing the cleansing brush attachment

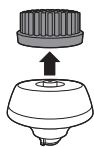

The cleansing brush attachment should be replaced every 3 months or earlier if the brush hairs are bent or damaged (see 'Ordering accessories').

Storage



Store the shaver in a safe and dry place, using the storage pouch provided.

Note: Always let the shaver dry completely before you store it in the pouch.

Ordering accessories

To buy accessories or spare parts, visit

www.philips.com/parts-and-accessories or go to your Philips dealer. You can also contact the Philips Consumer Care Center in your country (see the international warranty leaflet for contact details).

The following accessories and spare parts are available:

- SH91 Philips shaving heads
- HQ110 Philips shaving head cleaning spray
- RQ111 Philips beard styler attachment
- RQ585 Philips cleansing brush attachment
- RQ560 Philips cleansing brush attachment
- RQ563 Philips cleansing brush attachment 3-pack
- HQ87 USB supply unit
- HQ8509, HQ8510 wireless Qi charging pad

Note: The availability of the accessories may differ by country.

Recycling



- This symbol means that electrical products and batteries shall not be disposed of with normal household waste.
- Follow your country's rules for the separate collection of electrical products and batteries.

Removing the rechargeable shaver battery

Only remove the rechargeable battery when you discard the shaver. Before you remove the battery, make sure that the shaver is disconnected from the wall socket and that the battery is completely empty.

Take any necessary safety precautions when you handle tools to open the shaver and when you dispose of the rechargeable battery.

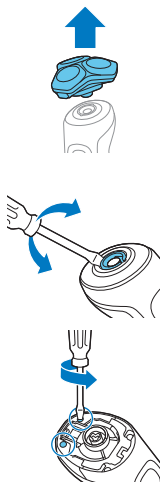

- 1 Remove the click-on attachment from the appliance.
- 2 On top of the appliance insert a screwdriver between the black cylinder and silver ring. Force the silver ring up off the appliance and remove the top panel.

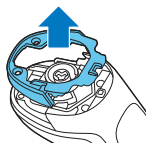

3 Unscrew the two screws and remove the frame.

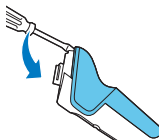

4 Remove the two back black covers and slide the front housing off the appliance.

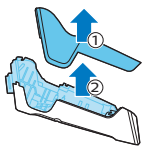

5 Unscrew the two screws at the top of the inner panel.

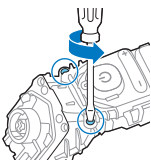

6 Place a screwdriver between the lips of the inner panel and bend them aside. Then remove the inner panel.

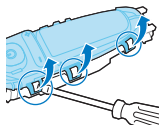

7 Lift out the printed circuit board with the rechargeable battery.

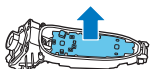

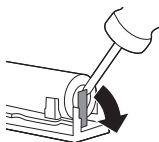

- 8 Bend the battery tags aside with a screwdriver.
- 9 Remove the rechargeable battery.

Warranty and support

If you need information or support, please visit www.philips.com/support or read the international warranty leaflet.

Warranty restrictions

The shaving heads (cutters and guards) are not covered by the terms of the international warranty because they are subject to wear.

Troubleshooting

This chapter summarizes the most common problems you could encounter with the appliance. If you are unable to solve the problem with the information below, visit www.philips.com/support for a list of frequently asked questions or contact the Consumer Care Center in your country.

Shaver

Problem	Possible cause	Solution
The appliance does not work when I press the on/off button.	The appliance is still placed on the wireless Qi charging pad.	Remove the appliance from the wireless Qi charging pad and press the on/off button to switch on the appliance.
	The rechargeable battery is empty.	Recharge the battery (see 'Charging').
	The travel lock is activated.	Press the on/off button for 3 seconds to deactivate the travel lock.

Problem	Possible cause	Solution
	The shaving unit is soiled or damaged to such an extent that the motor cannot run.	Clean the shaving heads thoroughly or replace them.
The appliance does not shave as well as it used to.	The shaving heads are damaged or worn.	Replace the shaving heads (see 'Replacement').
	Hairs or dirt obstruct the shaving heads.	Clean the shaving heads in the regular way or clean them thoroughly.
I replaced the shaving heads, but the display still shows the replacement reminder.	You have not reset the appliance.	Reset the appliance by pressing the on/off button for approx. 7 seconds.
A shaving unit symbol has suddenly appeared on the display.	This symbol reminds you to replace the shaving heads.	Replace the shaving heads (see 'Replacement').
The notification symbol flashes and the shaver beeps while the shaver is charging.	The appliance is overheated.	When this happens, the shaver stops charging automatically. Charging continues once the temperature of the shaver has decreased to the normal level after approx. 10 minutes.
The notification symbol flashes and the shaver beeps when I try to shave.	The shaving heads are soiled.	Clean the shaving heads (see 'Cleaning and maintenance').
The notification symbol flashes and the shaver beeps after cleaning the shaving heads.	The shaving heads are damaged.	Replace the shaving heads (see 'Replacement').

Problem	Possible cause	Solution
Water is leaking from the bottom of the appliance.	During cleaning, water may collect between the inner body and the outer shell of the appliance.	This is normal and not dangerous because all electronics are enclosed in a sealed power unit inside the appliance.

Click-on attachments

Problem	Possible cause	Solution
I do not know if the appliance is suitable for use on my skin.		Do not use the appliance on dry, chapped skin, open wounds, healing wounds, skin recovering from surgery or if you suffer from a skin disease or skin irritation, such as severe acne, sunburn, skin infection, skin cancer, inflammation, eczema, psoriasis etc. Do not use the appliance if you are taking steroid-based medication.
I don't know which facial attachments I can use with the appliance.		All attachments provided with this appliance can be used with this appliance. To find out more about the range of attachments, consult our website www.shop.philips.com or the shop where you purchased your Philips appliance. If you have any difficulties obtaining information, please contact the Philips Consumer Care Center in your country. You find its contact details in the international warranty leaflet. You can also visit www.philips.com/support .

Problem	Possible cause	Solution
The cleansing brush attachment feels too harsh on my skin.		Start with the lowest personal comfort setting to familiarize yourself with the attachment.
I don't know with which cleansing products I can use the cleansing brush attachment.		We advise you to cleanse your skin with your favorite cleanser. You can use cleansing gel, foam, oil, milk or lotions. Please do not use scrub cream or gel with particles.
The click-on attachment do not fit on the appliance.		Attach the cleansing brush attachment on the attachment holder, before placing it on the appliance.

介绍

感谢您的惠顾，很高兴您选择飞利浦！为了让您能充分享受飞利浦提供的支持，请在 www.philips.com/welcome 上注册您的产品。

请阅读本用户手册，手册包含有关此剃须刀各种功能的信息以及一些使用技巧，让您的剃须体验更轻松更舒适。

基本说明 (图 1)

- 1 洁面刷附件保护盖 (仅 SP9883)
- 2 卡入式洁面刷附件 (仅 SP9883)
- 3 附件支架 (仅 SP9883)
- 4 电源部件
- 5 USB 插头
- 6 Qi 无线充电基座
- 7 存储袋
- 8 须刀清洁中心
- 9 须刀清洁中心滤芯
- 10 更换提醒
- 11 通知符号
- 12 清洁提醒
- 13 旅行锁指示灯
- 14 电池充电指示灯
- 15 电池充电百分比
- 16 个人舒适度设置栏
- 17 个人舒适度设置提高按钮
- 18 个人舒适度设置降低按钮
- 19 开/关按钮
- 20 剃须刀头部件及胡茬储藏室

- 21 卡入式胡须造型器附件（仅 SP9883）
- 22 适用于胡须造型器附件的修剪梳（仅 SP9883）
- 23 卡入式鼻毛修剪器附件（仅 SP9886）
- 24 卡入式精确修剪器附件（仅 SP9886）

随附的附件可能因产品而异。包装盒上会显示随附于您产品的附件。

重要安全信息

使用本产品及其附件之前，请仔细阅读本产品重要信息，并妥善保管以供日后参考。随附的附件可能因产品而异。

警告



- 保持电源部件干燥。
- 警告符号注释：禁止在打开的水龙头下进行清洗。
- 该剃须刀具有防水性能。适合在沐浴或淋浴时使用，也可以放在水龙头下清洗。
- 符号注释：适合于在洗澡或淋浴时使用。允许在盛水的浴缸、淋浴、洗脸盆或其他器皿附近使用本器具。



- 本产品为 III 级构造。
- 切勿将充电基座浸入水中，也不要在水龙头下冲洗。
- 务必确保充电基座完全干燥后，再将其连接至电源插座。
- 请勿使用 USB 延长线。
- 本产品也可以由 8 岁或以上年龄的儿童以及肢体不健全、感觉或精神上有障碍或缺乏相关经验和知识的人士使用，但前提是有人对他们使用本产品进行监督或指导，以确保他们安全使用，并且让他们明白相关的危害。切勿让儿童玩弄本产品。不要让儿童在无人监督的情况下对本产品进行清洁和保养。
- 请勿使用已经损坏的产品。请用新的飞利浦部件更换损坏的部件。
- 充电基座不适用于车载充电。它可能会干扰汽车的电子系统。
- 出于卫生考虑，仅能由一个人使用本产品。
- 请仅使用冷水或温水清洁产品。
- 切勿使用压缩气体、钢丝绒、研磨性清洁剂或腐蚀性液体清洁设备。
- 请勿将本产品或其任何部件放在洗碗机中。

- 冲洗剃须刀时，水可能从产品底部的插口漏出。这是正常的，而且没有危险，因为所有电子元件都封闭在剃须刀内部的密封电源部件中。
- 请勿在包含电动空气清新器的墙壁插座上或其周围使用电源部件，以免电源部件受到不可修复的损坏。
- 使用产品前，请摘下穿环、首饰、眼镜等配饰。
- 请勿在出现皴裂、有开放性伤口、有愈合中伤口、处于手术恢复期的皮肤上使用清洁刷。如果您患有皮肤疾病或皮肤具有严重过敏反应（例如严重的痤疮、晒伤、皮肤感染、皮肤癌、发炎、湿疹、牛皮癣、尼龙过敏等情况），也请勿使用清洁刷。
- 如果您服用了类固醇类药物，请勿使用洁面刷。
- 请仅使用 Philips 原装附件或消耗品。要给电池充电，请仅使用该产品随附的可拆卸电源部件和充电基座（电源部件，类型 HQ87。充电基座，类型 HQ8510）。
- 充电、使用和存放本产品的温度应介于 5 ° C 至 35 ° C 之间。
- 请将产品和电池远离火源，切勿将其暴露于阳光直射处或高温下。

- 如果产品异常发热或发出异味、变色或充电时间比平时长，请停止使用并停止为其充电，并联系飞利浦。
- 切勿将产品及其电池放置在微波炉中或电磁炉上。
- 为防止电池发热或释放有毒有害物质，切勿打开、改装、刺穿、损坏或拆卸产品或电池。切勿使电池短路、过度充电或反向充电。
- 如果电池损坏或出现泄漏，请避免与皮肤或眼睛接触。如果不慎接触，请立即用清水冲洗并就医。

电磁场 (EMF)

本 Philips 产品符合所有有关暴露于电磁场的适用标准和法规。

注意

- 如果您的剃须刀随附清洁系统，请始终使用飞利浦原装须刀清洁中心滤芯。
- 清洁系统必须放在稳定、平坦的水平表面上，以防漏液。
- 使用清洁系统前，请始终确保滤芯仓已关闭。
- 清洁系统准备就绪时，切勿移动，以免清洁液漏出。

危险

飞利浦须刀清洁中心滤芯液

- 切勿吞食。

- 请置于儿童接触不到的地方。

显示屏

注意：使用本产品前，请先取下显示屏上的任何不干胶标签或保护膜。

正在充电

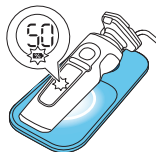

剃须刀充电时，基座上的环将亮起，且剃须刀上的电池充电指示灯呈白色闪烁。移动剃须刀时，显示屏上会以闪烁的电池充电百分比表示电池的充电情况。
快速充电：充电大约 18 分钟后，本产品含有的电量足以完成一次剃须。

电池已完全充满



电池充满电后，电池充电指示灯和基座上的环都将呈白色持续亮起。

注意：两种指示灯都将在 15 分钟后自动关闭。

移动剃须刀时，电池充电百分比指示灯呈白色持续亮起。

电池电量不足



当电池电量即将耗尽时，电池符号将呈橙色闪烁，并且您将听到声音。此时，电池含有的电量足以完成一次剃须。

电池剩余电量



显示屏上显示的电池充电百分比表示剩余的电池电量。

个人舒适度设置

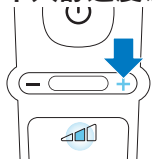

剃须刀提供进行个性化设置的功能。您可以根据个人的剃须需要，从三种设置（由低至高）中进行选择：舒适、强劲或高效。当您按下显示屏左侧或右侧的按钮时，个人舒适度设置栏格段亮起，显示选择的设置。如需选择较低或较高设置，请按下显示屏左侧或右侧按钮。

清洗提示



每次使用后请清洁剃须刀，以获得出色性能（请参见“清洁和保养”）。关闭剃须刀时，清洗提示符号闪烁，提醒您需要清洁剃须刀。

旅行锁

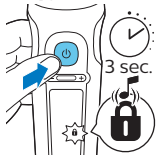

您在旅行时，可以锁住剃须刀，以防止电源意外开启（请参见“启用旅行锁”）。

更换提示



要获得更好的剃须效果，请每两年更换一次剃须刀头。剃须刀配有更换提示符号，它会提醒您更换剃须刀头。剃须刀发出提示音，更换指示灯亮起且箭头闪烁，这表示需要更换剃须刀头。

注意：更换剃须刀头后，您需要通过按开/关按钮 7 秒来重置更换提醒。

通知符号

过热



如果剃须刀在充电期间过热，通知符号会闪烁。在这种情况下，剃须刀会自动停止充电。在大约 10 分钟后，只要剃须刀温度降至正常水平，就会继续充电。

剃须刀头被阻塞



如果剃须刀头被阻塞，通知符号将呈红色持续亮起。更换提醒符号和清洁提醒符号会呈白色交替闪烁，并且剃须刀会发出蜂鸣音。在这种情况下，马达不会运行，因为剃须刀头太脏或已损坏。如果剃须刀头太脏，则必须进行清洁。如果剃须刀头已损坏，您必须对其进行更换。

Qi 无线充电基座上有异物



如果充电期间 Qi 无线充电基座上有异物（金属），Qi 无线充电基座上的通知符号会亮起。Qi 无线充电基座将自动关闭，并在异物移除 5 分钟后重新启动。

请勿在 Qi 无线充电基座上放置异物（金属）。仅使用 Qi 无线充电基座为剃须刀或其他与 Qi 充电基座兼容的设备（例如智能手机）充电。

充电

首次使用剃须刀之前，或当显示屏指示电池电量几乎耗尽时，请先为剃须刀充电。充电约需 3 小时。充满电的剃须刀剃须时间可长达 60 分钟。

剃须刀充电约 18 分钟后所含的电量足以完成一次剃须。

注意：切勿在充电时使用剃须刀。

快速充电

剃须刀充电约 18 分钟后所含的电量足以完成一次剃须。

使用 Qi 无线充电基座充电



注意：充电基座兼容 Qi。只能在随附的 Qi 无线充电基座上为兼容 Qi 的剃须刀或其他与 Qi 充电基座兼容的产品充电。

注意：在将剃须刀放在 Qi 基座上之前，请小心地甩掉多余水分。

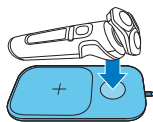
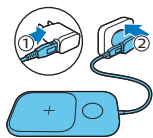

- 1 将 USB 插头插入随附的电源部件。
- 2 将电源部件插入电源插座。

将剃须刀放在 Qi 无线充电基座的十字标志上。确保剃须刀能恰好放入 Qi 无线充电基座的仓中。

只能在随附的 Qi 无线充电基座上为剃须刀充电。

- 如果剃须刀放置正确并已连接进行充电，则 Qi 无线充电基座会发出提示音，且基座上的环亮起。
 - 剃须刀充电时，基座上的环将亮起，且剃须刀上的电池充电指示灯呈白色闪烁。移动剃须刀时，显示屏上会以闪烁的电池充电百分比表示电池的充电情况。
- 3 电池充满电后，电池充电指示灯和基座上的环都将呈白色持续亮起。两种指示灯都将在 15 分钟后自动关闭。

使用剃须刀

使用前务必要检查剃须刀和所有配件。如果剃须刀或任何配件损坏，请勿再使用，

否则可能对人体造成伤害。请务必用原装型号更换损坏的部件。



此标准表示该剃须刀可在沐浴或淋浴时使用。

符号注释：适合于在洗澡或淋浴时使用。允许在盛水的浴缸、淋浴、洗脸盆或其他器皿附近使用本器具。

- 请按照本用户手册中所述的预期家用用途使用本剃须刀。
- 出于卫生考虑，请勿共用剃须刀。
- 皮肤和毛发干燥时修剪更容易。

注意：该剃须刀具有防水性能。适合在沐浴或淋浴时使用，也可以放在水龙头下清洗。出于安全原因，该剃须刀在使用时不能连接电源线。

打开或关闭剃须刀

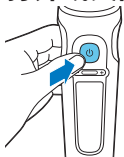

- 1 要打开剃须刀，请按一下开/关按钮。电池充电百分比指示灯亮起几秒钟。
- 2 要关闭剃须刀，请按一下开/关按钮。电池充电百分比指示灯亮起几秒钟并显示剩余电池电量。

剃须

皮肤适应期

前几次剃须可能不会带给您预期效果，并且您的皮肤可能会受到轻度刺激。这是正常的。您的皮肤和胡须需要时间适应任何新的剃须系统。为了让您的皮肤适应这款

新产品，我们建议您在 3 周时间内定期（至少每周 3 次）仅使用本产品剃须。

剃须提示

如果您连续 3 天或更长时间没有剃须，为确保皮肤获得更好的舒适感，请预先修剪胡须。

选择您的个人舒适度设置 (请参见“个人舒适度设置”)。

干剃

- 1 打开剃须刀。
- 2 让剃须刀头在您的皮肤上作迂回运动，以刮剃向不同方向生长的所有须发。轻轻按压，以获取舒适贴面的剃须感受。

注意：不要用力按压剃须刀，这样做可能会导致皮肤受刺激。

- 3 每次使用后，请关闭并清洗剃须刀 (请参见“清洁和保养”)。

显示屏将亮起几秒钟时间，以显示电池剩余电量。

湿剃

要获得更舒适的剃须体验，您也可以先用剃须泡沫或剃须啫喱将脸弄湿，然后再用本产品进行剃须。

- 1 用水润湿皮肤。

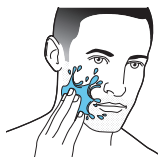

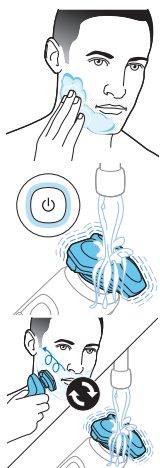

- 2 在皮肤上涂抹剃须泡沫或剃须啫喱。
- 3 在水龙头下冲洗一下剃须刀头部件，确保剃须刀头部件可以在您的皮肤上顺畅滑动。
- 4 打开剃须刀。
- 5 让剃须刀头在您的皮肤上作迂回运动，以刮剃向不同方向生长的所有须发。轻轻按压，以获取舒适贴面的剃须感受。

注意：不要用力按压剃须刀，这样做可能会导致皮肤受刺激。

注意：定期冲洗剃须刀头部件，确保其能够继续在您的皮肤上顺畅滑动。

- 6 擦干面部。
- 7 每次使用后，请关闭并清洗剃须刀。

注意：确保冲净剃须刀上的所有泡沫或剃须啫喱。

使用卡入式附件

建议不要在剃须后直接使用卡入式洁面刷附件，以免皮肤过敏。

拆卸或安装卡入式附件

- 1 确保剃须刀已关闭。



- 2 将附件竖直抽出剃须刀。

注意：将附件从剃须刀上抽出时，不要旋转。



- 3 将附件的凸缘插入本剃须刀顶部的槽内。然后，按下附件将其安装到本剃须刀上（可听到“咔哒”一声）。

附件支架

注意：请先将卡入式洁面刷附件安装在附件支架上，然后再将附件安装到本产品上。

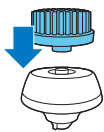

- 1 将卡入式附件安装到附件支架上，直至其锁定到位（可听到“咔哒”一声）。

使用带修剪梳的胡须造型器附件

您可以使用带修剪梳的胡须造型器以固定设置（也可使用不同的长度设置）修整胡须。您也可以在剃须前用其预先修剪较长须发，以实现更舒适的剃须体验。

注意：胡须造型器仅可用于修剪面部须发。请勿在颈部以下部位上使用。

胡须造型器附件的长度设置对应修剪后剩余的须发长度，范围为 1 到 5 毫米（ $3/64$ - $3/16$ 英寸）。



- 1 将附件安装到产品上（可听到“咔哒”一声）。



- 2 将修剪梳直接滑入胡须造型器附件两侧的导槽中（可听到“咔哒”一声）。

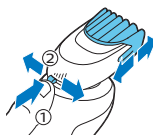

- 3 按下长度选择器，然后将其向左或向右推动以选择所需的须发长度设置。
- 4 启动产品。



- 5 向上移动产品，同时轻轻按压。确保修剪梳的正面与皮肤完全接触。
- 6 使用后要清洁附件。

使用不带修剪梳的胡须造型器附件

您可以使用不带修剪梳的胡须造型器附件将胡须、须髥、鬓角或颈部轮廓修整至 0.5 毫米（1/32 英寸）。

注意：胡须造型器仅可用于修剪面部须发。请勿在颈部以下部位使用。

- 1 将修剪梳抽离胡须造型器附件。

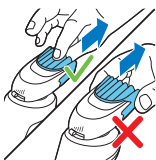

注意：抓住修剪梳的中间位置，将其抽离胡须造型器附件。不要拉拔修剪梳的侧面。

- 2 启动产品。
- 3 将胡须造型器附件垂直放在皮肤上，向下移动产品，同时轻轻按压。
- 4 使用后要清洁附件。

使用洁面刷附件

注意：为获得更佳的剃须效果，剃须之前使用卡入式洁面刷附件进行清洁。

将旋转洁面刷与日常洁面产品一起使用。洁面刷可去除油脂和污垢，焕发健康无油脂的肌肤。建议每天使用本产品不超过 2 次。从最低个人舒适度设置开始，以熟悉附件的使用方法。

请不要在受伤或发炎的皮肤或伤口上使用本产品。

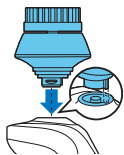

- 1 将附件安装至附件支架上。
- 2 将附件安装到产品上（可听到“咔哒”一声）。



3 用水湿润附件。

注意：切勿在洁面刷附件干燥的情况下使用产品，否则可能会刺激皮肤。

4 用水润湿面部，并将洁面乳涂抹到脸上。

5 将附件置于面颊上。

6 启动产品。

7 在鼻子至耳朵的皮肤上轻轻地移动刷头。请勿太过用力地将刷子压在皮肤上，以确保舒适护理。

注意：切勿清洁眼部周围的敏感区域。

8 约 20 秒后，可将本产品移至另一侧面颊，开始清洁这部分面部皮肤。



9 约 20 秒后，可将本产品移至前额，开始清洁这部分面部皮肤。轻轻将刷头从左向右移动。

注意：建议您不要过度清洁，任何部位的清洁时间不要超过 20 秒钟。



10 使用后，请关闭本产品并清洁附件。



- 11** 清洁后，洗脸并擦干。现在您可以进行日常面部护肤的下一步了。

使用精确修剪器附件

您可使用修剪器附件修剪鬓角和须髥。

- 1** 将附件安装到产品上（可听到“咔哒”一声）。
- 2** 启动产品。
- 3** 将修剪器垂直放在皮肤上，向下移动产品，同时轻轻按压。
- 4** 使用后，请关闭本产品并清洁附件。



使用鼻毛/耳毛修剪器附件

您可以使用鼻毛/耳毛修剪器附件修剪鼻毛和/或耳毛。

修剪鼻毛

修剪鼻毛时，请确保鼻腔保持清洁。

- 1** 将附件安装到产品上（可听到“咔哒”一声）。
- 2** 启动产品。

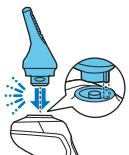

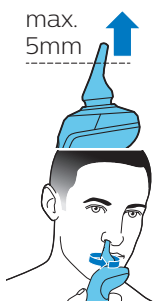

- 3 将修剪刀头小心地插入一个鼻孔。
附件插入鼻孔的深度不得超过 0.5 厘米。

- 4 在四周缓慢地移动修剪刀头，以剃掉鼻孔中所有多余的毛发。
- 5 使用后，请关闭本产品并清洁附件。

修剪耳毛

修剪耳毛时，请确保外耳道保持清洁，没有耳垢。

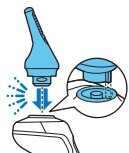

- 1 将附件安装到产品上（可听到“咔哒”一声）。
- 2 启动产品。

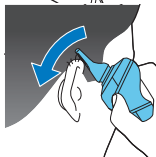

- 3 缓缓地沿着耳缘移动修剪刀头，以剃掉凸出耳缘的毛发。
- 4 将修剪刀头小心地插入外耳道。



修剪刀头插入耳道的深度不能超过 0.5 厘米，否则可能损伤鼓膜。



- 5 缓缓地转动修剪刀头，以剃掉外耳道中所有多余的毛发。
- 6 使用后，请关闭本产品并清洁附件。

旅行锁

您在旅行时，可以锁住剃须刀，以防止电源意外开启。

启用旅行锁

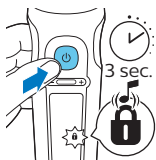

- 1 按住开/关按钮 3 秒钟以进入旅行锁模式。

启用旅行锁后，旅行锁符号会短暂亮起且剃须刀会发出短促声音。旅行锁启用后，旅行锁符号将闪烁。

如果在旅行锁处于激活状态下尝试打开剃须刀，旅行锁符号将闪烁。

禁用旅行锁



- 1 按开/关按钮 3 秒钟。

禁用旅行锁后，旅行锁符号会短暂亮起且剃须刀会发出短促声音。剃须刀打开后即可供再次使用。

注意：当放在 Qi 无线充电基座上时，剃须刀会自动解锁。

清洁和保养

为保证更好的剃须效果，请定期清洗剃须刀。

切勿在剃须刀开启时清洗、拆除或更换剃须刀头部件。

请勿对剃须刀头网罩施加压力。

请勿使用硬物触碰剃须刀头，以免挫伤或损坏制作精密的带槽网罩。

切勿使用压缩气体、研磨剂、硬毛刷或汽油或丙酮等腐蚀性液体清洗本剃须刀。

如何使用须刀清洁中心？

快速清洗器上的图标是什么意思？

图标	行为	含义
	显示在须刀清洁中心上	须刀清洁中心滤芯需要更换。

准备使用须刀清洁中心

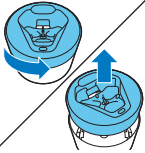
- 

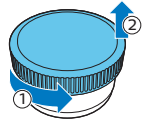
1 旋转并取下须刀清洁中心的顶部。
- 

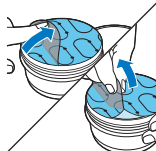
2 拧开须刀清洁中心滤芯盖。
- 

3 提起密封圈上的卡舌并拉动一角，以从须刀清洁中心滤芯上取下密封圈。

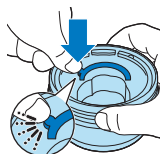

- 4 按下须刀清洁中心滤芯手柄上的小圆片，以脱开手柄上的卡扣。



- 5 将须刀清洁中心滤芯放入须刀清洁中心。

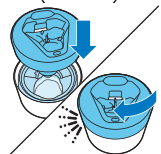

- 6 将须刀清洁中心的顶部放回基座，然后顺时针旋转直到听到“咔哒”声。



切勿倾斜须刀清洁中心，以防溢漏。

使用须刀清洁中心

注意：如果您在剃须时使用了剃须泡沫、剃须啫喱或剃须前用品，请在使用须刀清洁中心前彻底冲洗剃须刀头。

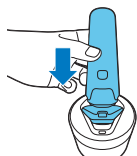

将剃须刀放入须刀清洁中心之前，务必确保甩掉剃须刀上多余的水份。

- 1 将剃须刀倒置放入须刀清洁中心中。剃须刀会自动检测其是否位于须刀清洁中心中。
- 2 打开剃须刀，启动清洁程序。

每个清洁程序大约需要一分钟。在清洁程序运行期间，剩余时间将在手柄上显示为倒计时时钟。

- 待剃须刀在须刀清洁中心中完全晾干后再存放。

更换须刀清洁中心滤芯

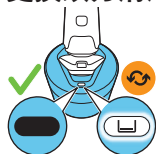

当须刀清洁中心上显示滤芯更换图标时，请立即更换须刀清洁中心滤芯，或遵循下表进行更换。

使用频率	周期数	何时更换须刀清洁中心滤芯
每天	大约 30 个	每月
每周几次	大约 20 个	每 2 个月
每周	大约 13 个	每 3 个月
每月	大约 3 个	每 3 个月

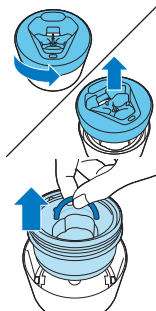

- 旋转并取下须刀清洁中心的顶部。

- 握住手柄将须刀清洁中心滤芯从须刀清洁中心中取出。



3 将滤芯中的所有剩余液体倒入排水
管，并按照当地废物管理条例回收空
的滤芯。

4 将新的须刀清洁中心滤芯放入须刀清
洁中心 (请参见“准备使用须刀清洁中
心”)。

扫描左侧二维码或访问

www.philips.com/cleaning-cartridge 订购须刀清洁中心滤芯替
换件。

彻底清洁

我们建议您每个月彻底清洁一次剃须刀
头，或在剃须效果没有以前好时进行清
洁。



1 关闭剃须刀。

2 将剃须刀头支架从剃须刀头部件的底
部抽离。

3 在水龙头下冲洗胡茬储藏室和剃须刀
头支架。
也可以在冲洗前用清洁刷去除多余毛
发。

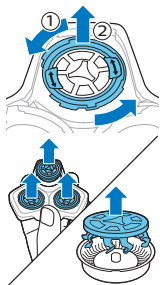

- 4** 逆时针转动固定环，然后将它从剃须刀头中取出。
对其他固定环重复此过程。将其存放在安全的地方。

- 5** 从剃须刀头支架上卸下剃须刀头。每个剃须刀头都包括刀片和网罩。

注意：不要同时清洁多组刀片和网罩，因为它们都是相互匹配的。如果不小心将刀片装到了错误的网罩上，则需要数周时间才能恢复产品的出色剃须性能。

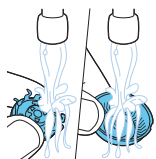

- 6** 在水龙头下清洁刀片和网罩。
也可以冲洗前用清洁刷去除多余毛发。

- 7** 甩掉多余的水分。

- 8** 将刀片重新装回至网罩。

- 9** 将剃须刀头装到剃须刀头支架中。

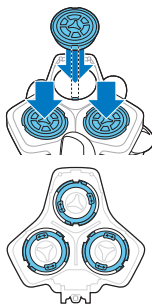

- 10** 将固定环装到剃须刀头上。

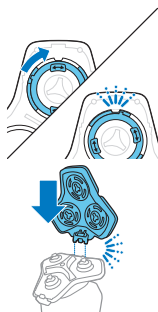

- 11 将固定环上的箭头与剃须刀头支架上的凸起部位对齐。顺时针旋转固定环，直至听到“咔哒”一声，表明固定环已就位。
- 12 将剃须刀头支架安装到剃须刀头部件的底部（可听到“咔哒”一声）。

清洁胡须造型器附件

每次使用后都要清洁胡须造型器附件。

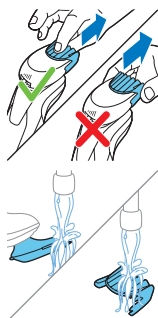

- 1 将修剪梳抽离胡须造型器附件。

注意：抓住修剪梳的中间位置，将其抽离胡须造型器附件。不要拉拔修剪梳的侧面。

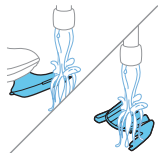

- 2 用温水冲洗修剪部件上的须发。
- 3 冲洗修剪梳上的须发。



- 4 从胡须造型器附件中取下修剪部件。通过将修剪部件推离胡须造型器附件，您可以清理胡须造型器内积累的须发。您也可以冲洗修剪部件的底部。

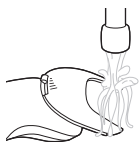

- 5 冲洗出胡须造型器附件中的须发。
- 6 小心甩干多余的水份，并晾干修剪梳、修剪部件和胡须造型器附件，以备下次使用。



- 7 修剪部件晾干后，请将其安装到胡须造型器附件。



- 8 修剪梳晾干后，请将其安装到胡须造型器附件。
- 9 为获得最佳效果，请定期用一滴缝纫机油润滑附件齿部。

清洗洁面刷



每次使用后都要清洁附件。

- 1 关闭产品。
- 2 从附件支架上取下附件。
- 3 用温水彻底清洗部件。
- 4 用毛巾擦干附件。

清洁修剪器附件

切勿用毛巾或纸巾擦干修剪器，否则可能会损坏修剪齿。

清洁准确修剪器附件。

- 1 打开装有准确修剪器附件的产品。
- 2 在温水水龙头下冲洗附件。
- 3 清洁完成后，关闭产品。
- 4 小心地甩干多余的水，然后将附件晾干。

提示：为达到最佳效果，请定期用一滴缝纫机油润滑附件齿部。

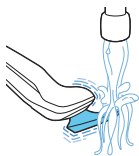

清洁鼻毛修剪器附件

每次使用后都要清洁鼻毛修剪器附件。

- 1 关闭产品。
- 2 用热水冲洗鼻毛修剪器的修剪刀头。
- 3 打开产品，再次冲洗修剪刀头，以去除所有残留的毛发。然后再次关闭产品。

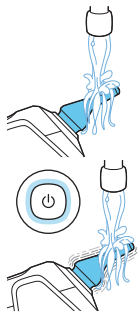



如果在水龙头下冲洗修剪刀头无法充分清洁，请将其浸入盛有温水的玻璃杯中几分钟。然后启动产品，并在水龙头下冲洗。

- 4** 小心地甩干多余的水份，然后将鼻毛修剪器附件晾干。

提示：为获得最佳修剪效果，请每隔六个月用一滴缝纫机油润滑修剪刀头。

更换

更换剃须刀头

为获得更好剃须效果，建议每两年更换一次剃须刀头。立即更换损坏的剃须刀头。



务必使用原装飞利浦剃须刀头（请参见“订购配件”）进行更换。



更换提醒

出现更换提醒表示需要更换剃须刀头。剃须刀头部件符号持续亮起，箭头呈白色闪烁，并在打开或关闭剃须刀时听到蜂鸣音。

- 1** 关闭剃须刀。

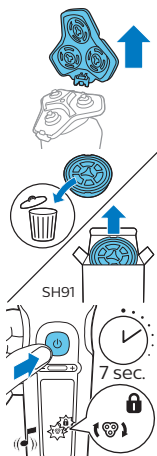

2 按剃须刀头部件上的释放钮并将剃须刀头支架从剃须刀头部件中抽离。

3 从剃须刀头支架上卸下剃须刀头。直接丢弃用过的剃须刀头，以免与新的剃须刀头混淆。

4 更换剃须刀头后，可通过按开/关按钮 7 秒来重置更换提醒。请等到听见 3 声蜂鸣音。如果未重置更换提醒，剃须刀会在剃须 9 次后自动重置。

更换洁面刷附件

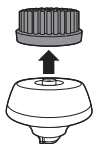

每 3 个月应更换一次刷头，或当刷毛在更短时间内出现弯曲或损坏 (请参见“订购配件”)时更换。

存放



使用随附的存储袋将剃须刀存放在安全干燥处。

注意：务必确保剃须刀彻底干燥，然后再将其存放在存储袋中。

订购配件

如需购买附件或备件，请访问 www.philips.com/parts-and-accessories 或联系您的飞利浦经销商。您还可以联系所在国家/地区的飞利浦客户服务中心（请参阅保修卡了解详细联系信息）。

可选配以下附件和备件：

- SH91 飞利浦剃须刀头
- HQ110 飞利浦剃须刀头清洁喷雾剂
- RQ111 飞利浦胡须造型器附件
- RQ585 飞利浦洁面刷附件
- RQ560 飞利浦洁面刷附件
- RQ563 飞利浦洁面刷附件（三件装）
- HQ87 USB 电源部件
- HQ8509、HQ8510 Qi 无线充电基座

注意：配件可用性可能因国家/地区而异。

回收



- 此符号表示电器产品和电池不能与一般的生活垃圾一同弃置。
- 请遵守您所在国家/地区有关分类回收电器产品和电池的规定。

卸下剃须刀的充电电池

必须在丢弃剃须刀前拆下充电电池。卸下电池之前，请确保剃须刀与电源插座断开连接并且电池电量已耗尽。

当您使用工具打开剃须刀时以及在您弃置充电电池时，请采取必要的安全保护措施。

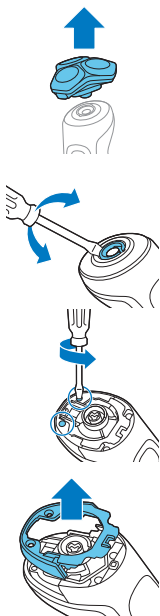

1 从产品中取出卡入式附件。

2 将螺丝刀插入本产品顶部的黑色柱体和银色圆环之间。强行将银色圆环从产品上撬起，然后卸下顶部面板。

3 拧下两个螺丝，然后卸下框架。

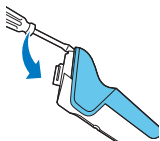

- 4** 卸下两个黑色背盖，然后将前壳从产品上滑出。

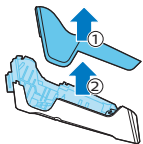

- 5** 拧下内侧面板顶部的两个螺丝。

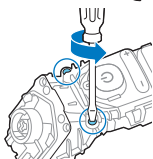

- 6** 将螺丝刀置于内侧面板和卡舌之间，然后将卡舌向一侧弯曲。然后卸下内侧面板。

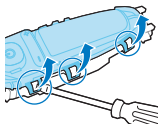

- 7** 取出带有充电电池的印刷电路板。

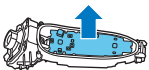

- 8** 用螺丝刀将电池标签向外掰。

- 9** 卸下充电电池。

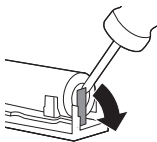

保修和支持

如需信息或支持，请访问

www.philips.com/support 或阅读保修卡。

保修条款

由于剃须刀头（刀片和网罩）属于易磨损物品，因此不在国际保修条款的涵盖范围之列。

故障处理方法

本章归纳了使用本产品时最常见的一些问题。如果您无法根据以下信息解决问题，请访问 **www.philips.com/support** 查阅常见问题列表，或联系您所在国家/地区的客户服务中心。

剃须刀

问题	可能的原因	解决方法
按下开/关按钮时，产品不工作。	产品仍位于 Qi 无线充电基座上。	从 Qi 无线充电基座上取下产品，然后按开/关按钮打开产品。
	充电电池的电量已耗尽。	给电池充电（请参见“充电”）。
	旅行锁已被激活。	按住开/关按钮 3 秒钟以禁用旅行锁。

问题	可能的原因	解决方法
	剃须刀头部件被污染或损坏，导致马达无法运行。	彻底清洁剃须刀头或将其更换。
产品的剃须效果不如以前好。	剃须刀头已损坏或磨损。	更换剃须刀头 (请参见“更换”)。
	毛发或污垢堵塞了剃须刀头。	对剃须刀头进行常规式或彻底清洁。
我更换了剃须刀头，但显示屏仍然显示更换提醒。	产品尚未重置。	按住开/关按钮大约 7 秒钟以重置产品。
显示屏上突然出现剃须刀头部件符号。	此符号提醒您更换剃须刀头。	更换剃须刀头 (请参见“更换”)。
剃须刀充电时，通知符号闪烁且剃须刀会发出提示音。	产品过热。	在这种情况下，剃须刀会自动停止充电。在大约 10 分钟后，只要剃须刀温度降至正常水平，就会继续充电。

问题	可能的原因	解决方法
在我尝试进行剃须时，通知符号闪烁且剃须刀会发出提示音。	剃须刀头被污染。	清洁剃须刀头 (请参见“清洁和保养”)。
清洁剃须刀头后，通知符号会闪烁且剃须刀会发出提示音。	剃须刀头已损坏。	更换剃须刀头 (请参见“更换”)。
水从产品底部漏出。	在清洁过程中，水可能聚集在产品的机身内部与外壳之间。	这是正常现象，而且没有危险，因为所有电子元件都封闭在产品内部的密封电源部件中。

卡入式附件

问题	可能的原因	解决方法
我不知道本产品是否适合我的皮肤。		如果皮肤出现干燥皴裂、开放性伤口、正在愈合的伤口、皮肤处于术后恢复期或存在严重粉刺、晒伤、皮肤感染、皮肤癌、发炎、湿疹、牛皮癣等皮肤病或皮肤过敏，请勿使用本产品。如果您正在服用类固醇类药物，请勿使用本产品。

问题	可能的原因	解决方法
我不知道哪款面部附件可与本产品配合使用。		本产品随附的所有附件均可与本产品配合使用。要了解有关附件系列的更多信息，请参阅我们的网站 www.shop.philips.com 或从您购买 Philips 产品的商店获得。如果您获取信息有困难，请联系您所在国家/地区的 Philips 客户服务中心。可在国际保修卡中找到详细的联系信息。您还可以访问 www.philips.com/support 。
我感觉洁面刷附件太粗糙。		从最低个人舒适度设置开始，以熟悉附件的使用方法。
我不知道洁面刷附件可与哪款清洁产品配合使用。		建议您使用自己喜爱的洁面乳清洁肌肤。您可以使用清洁凝胶、泡沫、精油、牛奶或乳液。请勿使用带微粒的磨砂膏或凝胶。

问题	可能的原因	解决方法
卡入式附件不适合本产品。		请先将洁面刷附件安装到附件支架上，然后再安装到本产品上。

PHILIPS

产品：飞利浦电动剃须刀
 型号：SP9883
 额定电压：100-240V~
 额定频率：50/60Hz
 额定输入功率：11W
 生产日期：请见产品本体
 产地：荷兰

IPX4



飞利浦（中国）投资有限公司
 上海市静安区灵石路718号A1幢
 全国顾客服务热线：4008 800 008

本产品根据国标 GB4706.1-2005,
 GB4706.9-2008制造

PHILIPS

产品：飞利浦电动剃须刀
 型号：SP9886
 额定电压：100-240V~
 额定频率：50/60Hz
 额定输入功率：11W
 生产日期：请见产品本体
 产地：荷兰

IPX4



飞利浦（中国）投资有限公司
 上海市静安区灵石路718号A1幢
 全国顾客服务热线：4008 800 008

本产品根据国标 GB4706.1-2005,
 GB4706.9-2008制造

保留备用

发行日期: 12/05/2023

部件名称	产品中有害物质的名称及含量					
	有害物质					
	铅 (Pb)	汞 (Hg)	镉 (Cd)	六价铬 (Cr (VI))	多溴联苯 (PBB)	多溴二苯醚 (PBDE)
PCBs 集成电路板	X	0	0	0	0	0
Electrical contact pins 电接触片	X	0	0	0	0	0
Power plug 电源插头	X	0	0	0	0	0
Internal metal parts 内部金属件	X	0	0	0	0	0

本表格依据SJ/T 11364的规定编制。

0: 表示该有害物质在该部件所有均质材料中的含量均在GB/T 26572规定的限量要求以下。

X: 表示该有害物质至少在该部件的某一均质材料中的含量超出GB/T 26572规定的限量要求。

- 该表格中所显示的“有害物质”在产品正常使用情况下不会对人身和环境产生任何伤害。
- 该表格中所显示的“有害物质”及其存在的部件向消费者和回收处理从业者提供相关物质的存在信息，有助于产品废弃时的妥善处理。

© 2023 Koninklijke Philips N.V.

All rights reserved

保留所有权利

3000.090.2602.4 (12/05/2023)

> 75% 循环再造纸

保留备用



>75 % recycled paper
>75 % papier recyclé