

PHILIPS

NORELCO

Tripleheader shaver

S3145
S3243
S3242
S3341

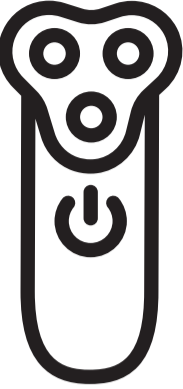

1

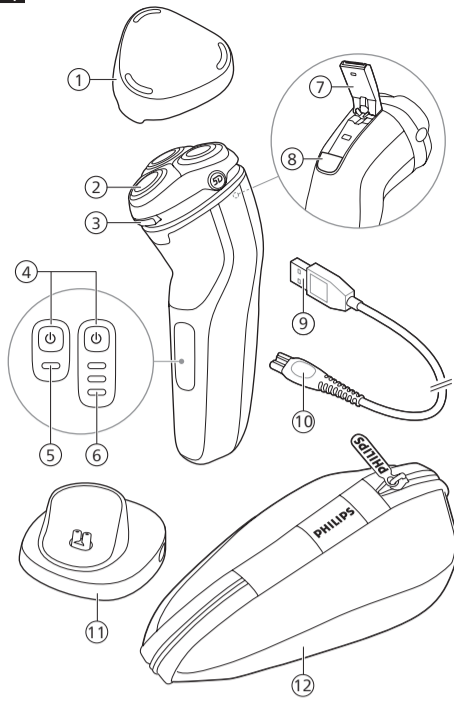

- Only use original Philips accessories or consumables.
- Charge, use and store the product at a temperature between 40 °F / 4.5 °C and 95 °F / 35 °C.
- Keep product and batteries away from fire and do not expose them to direct sunlight or high temperatures.
- If the product becomes abnormally hot or smelly, changes color or if charging takes longer than usual, stop using and charging the product and contact Philips.
- Do not place products and their batteries in microwave ovens or on induction cookers.
- Do not open, modify, pierce, damage or dismantle the product or battery to prevent batteries from heating up or releasing toxic or hazardous substances. Do not short-circuit, overcharge or reverse charge batteries.
- If batteries are damaged or leaking, avoid contact with the skin or eyes. If this occurs, immediately rinse well with water and seek medical care.
- When you handle batteries, make sure that your hands, the product and the batteries are dry.
- To avoid accidental short-circuiting of batteries after removal, do not let battery terminals come into contact with metal objects (e.g. coins, hairpins, rings). Do not wrap batteries in aluminum foil. Tape battery terminals or put batteries in a plastic bag before you discard them.

SAVE THESE INSTRUCTIONS

English

IMPORTANT SAFETY INSTRUCTIONS

When using an electric product, basic precautions should always be followed, including the following: **Read all instructions before using this product.**

DANGER

To reduce the risk of electric shock:

To charge the product, only use a USB power source on a certified product with output rating 5 V, ≥ 1 A. For safe charging in a moist environment (e.g. in a bathroom), only use an IPX4 (splash-proof) power source. A suitable power source (e.g. Philips HQ87) is available via www.philips.com/support. If you need support finding the correct USB power source, contact Philips support at 1-800-243-3050. Using a non-certified USB power source may cause hazards or serious injuries. Keep the USB cable, the USB power source and the charging stand dry.



Do not reach for a corded product that has fallen into water. Unplug immediately from the power outlet. Do not place or store the product where it can fall or be pulled into a tub or sink. Do not place or drop the product into water or other liquid. This product does not work while it is connected to the power outlet. Except when charging, always unplug this product from the power outlet and product before cleaning.

WARNING

To reduce the risk of burns, fire, electric shock, or injury to persons:

This product is only intended for shaving facial hair and scalp hair. Scalp hair must be shorter than 1.5 mm. Only use this product on skin that is undamaged and not affected by skin growths, skin disease or severe skin irritation.

This product is not intended for use by persons (including children) with reduced physical, sensory or mental capabilities, or lack of experience and knowledge, unless they have been given supervision or instruction concerning use of the product by a person responsible for their safety. Children should be supervised to ensure that they do not play with the product.

Use this product only for its intended household use as described in this manual. Misuse can lead to hazards or serious injuries. Do not use attachments not recommended by Philips North America LLC. Accessories supplied may vary for different products.

Never operate this product if it has a damaged USB power source, if it is not working properly, after it has been dropped or damaged, or after the product or the USB power source has been dropped into water. For assistance call 1-800-243-3050.

Keep the USB cable and the USB power source away from heated surfaces. Never drop or insert any object into any opening. Do not use the USB power source in or near a power outlet that contains an electric air freshener to prevent damage to the USB power source. Do not use product outdoors or operate where aerosol (spray) products are being used or where oxygen is being administered. Always check shaving heads (guards and cutters) before using the product. Do not use the product if cutters or guards are damaged, as injury may occur.

Always attach the USB cable to the USB power source and the product first, then attach the USB power source to the power outlet. To disconnect, set all controls to 'off' position. Then remove the USB power source from the power outlet. Plug USB power source directly into power outlet. Do not use an extension cord. Unplug USB power source before plugging in or unplugging the product.

The batteries used in this product may present a fire or chemical burn hazard if mistreated. Do not disassemble, heat above 100 °C (212 °F) or incinerate.

Danger: Keep the USB cable, the USB power source and the charging stand dry.

Charging with a USB power source

- 1 Make sure that the product is switched off.
- 2 Insert the small plug of the USB cable into the socket in the bottom of the product.
- 3 Insert the USB plug into the USB power source (not included) (Fig. 6).
- 4 Insert the USB power source into the power outlet (Fig. 7).
- 5 The charging light on the product will indicate the charging status (see 'Charge indications').
- 6 After charging, remove the USB power source from the power outlet and pull the small plug out of the product.

Charging with charging stand (S3341 only)

- 1 Make sure that the product is switched off.
- 2 Connect the small plug of the USB cable to the charging stand.
- 3 Insert the USB plug into the USB power source (not included) (Fig. 6).
- 4 Insert the USB power source into the power outlet (Fig. 7).
- 5 Place the shaver in the charging stand in upright position, making sure the charging contacts in the bottom of the stand fit into recess in the bottom of the shaver (Fig. 8).
- 6 The charging light on the product will indicate the charging status (see 'Charge indications').
- 7 After charging, remove the shaver from the charging stand by lifting it straight up. Do not tilt the shaver.

Using the product

Always check the product and all accessories before using. Do not use the product or any accessory if it is damaged, as this may cause injury. Always replace a damaged part with one of the original type.

This product is only intended for household use.

For hygienic reasons, the product should only be used by one person.

Note: This product is waterproof (Fig. 9). It is suitable for use in the bath or shower and for cleaning under the tap with water. For safety reasons, this product can only be used without cord.

Switching the product on and off

To switch the product on or off, press the on/off button once (Fig. 10).

Shaving

- For the best results on skin comfort, pre-trim your beard if you have not shaved for 3 days or longer. You can use this product either wet or dry, or even in the shower. For a wet shave, apply some water and shaving foam or gel to your skin and rinse the shaving heads under the tap with warm water before following the steps below.
- 1 Switch on the shaver.
 - 2 Move the shaver in circular movements over your skin to catch hair growing in all directions (Fig. 11). Make sure each shaving head is fully in contact with the skin. Exert gentle pressure for a close, comfortable shave.

Note: Do not press too hard, as this can cause skin irritation.

Note: If you are shaving with gel or foam, rinse the shaving unit regularly during your shave to ensure that it continues to glide smoothly over your skin (Fig. 12).

- 3 Use the narrow sides of the shaving unit to shave in hard-to-reach areas such as along your jawline and under your nose.
- 4 Switch off and clean the product after each use (see 'Cleaning and maintenance').
- 5 Put the protective cap on the product to protect the shaving heads during storage and travel (Fig. 13).

Note: Make sure you rinse all foam or shaving gel off the product.

21-Day adaptation process

- 21 Day Trial and Conversion Process. It is a fact that your skin and beard need time to adjust to a new grooming system.
- Use your new shaver exclusively for 3 weeks to fully enjoy the closeness of a Philips Norelco shave.
- At first you may not get as close a shave as you expect, or your face may even become slightly irritated. This is normal since your beard and skin will need time to adjust. Invest 3 weeks and you'll soon experience the full joy of your new shaver.
- Stick with it! If you alternate shaving methods during the adjustment period, it may make it more difficult to adapt to the Philips Norelco shaving system.
- If you are still not convinced after 21 days, Philips Norelco will refund you the full purchase price as long as the request is received within 45 days of purchase.

Trimming with pop-up trimmer

You can use the trimmer to groom your sideburns and moustache.

- 1 Push the trimmer release slide downwards to open the trimmer (Fig. 14).
- 2 Press the on/off button once to switch on the product (Fig. 10).
- 3 Hold the trimmer perpendicular to the skin and move the product downwards, exerting gentle pressure (Fig. 15).
- 4 Switch off the product and clean the trimmer after each use to prevent clogging and damage (see 'Cleaning and maintenance').
- 5 Close the trimmer ('click').

©2024 Philips North America LLC. All rights reserved.

Philips and Philips shield are registered trademarks of Philips North America LLC.

Norelco and Tripleheader are registered trademarks of Philips Personal Health.

This symbol on the product's nameplate means it is listed by Underwriters' Laboratories, Inc.

Manufactured for: P.O. Box 10313, Stamford, CT 06904

Philips Personal Health



Note: If the shaving unit does not close smoothly, check if you have inserted the shaving heads properly and if the retaining frame is locked.

This product has no other user-serviceable parts. For assistance call 1-800-243-3050.

Storage

- Make sure the product is switched off. Remove the USB power source from the power outlet and the product before storing the product in a safe, dry location where it will not be crushed, banged, or subject to damage.
- Do not wrap cord around the product when storing.
- Store cord and other accessories in a safe location where these will not be cut or damaged.
- Do not place or store the product where it can fall or be pulled into a tub or sink, water or other liquid while plugged in.

Put the protective cap on the shaver to prevent damage (Fig. 13).

Note: Always let the shaver dry completely before storing.

Storage in travel pouch (S3243 and S3341 only)

Store the shaver in the travel pouch supplied.

Note: Make sure the shaver is dry before you store it in the travel pouch.

Accessories

Replacement parts and accessories may be purchased at a store near you or on our website www.philips.com/store.

The following accessory is available:

- SH30 Philips Norelco replacement shaving heads

Assistance

For assistance, visit our website: www.philips.com/support or call toll free 1-800-243-3050.

Disposal

- This product contains a rechargeable lithium-ion battery which must be disposed of properly.
- Contact your local town or city officials for battery disposal information. You can also call 1-800-822-8837 or visit: www.call2recycle.org for battery drop-off locations (Fig. 28).
- For assistance, visit our website www.philips.com/support or call 1-800-243-3050 toll free.
- Your product is designed and manufactured with high quality materials and components, which can be recycled and reused. For recycling information, please contact your local waste management facilities or visit: www.recycle.philips.com.

Full Two-Year Warranty

Philips North America LLC warrants this new product against defects in materials or workmanship for a period of two years from the date of purchase, and agrees to repair or replace any defective product without charge.

IMPORTANT: This warranty does not cover damage resulting from accident, misuse or abuse, lack of reasonable care, the affixing of any attachment not provided with the product or loss of parts or subjecting the product to any but the specified voltage.*

The shaving heads (cutters and guards) are not covered by the terms of this warranty because they are subject to wear and tear.

NO RESPONSIBILITY IS ASSUMED FOR ANY SPECIAL, INCIDENTAL OR CONSEQUENTIAL DAMAGES.

In order to obtain warranty service, simply go to www.philips.com/support. It is suggested that for your protection you return shipments of product by insured mail, insurance prepaid. Damage occurring during shipment is not covered by this warranty.

NOTE: No other warranty, written or oral, is authorized by Philips North America LLC. This warranty gives you specific legal rights, and you may also have other rights which vary from state to state. Some states do not allow the exclusion or limitation of incidental or consequential damages, so the above exclusion and limitations may not apply to you.

*Read enclosed instructions carefully.

45-DAY MONEY-BACK GUARANTEE

If you are not fully satisfied with your product send the product back and we'll refund you the full purchase price.

The product must be shipped prepaid by insured mail, insurance prepaid, have the original sales receipt, indicating purchase price and date of purchase.

We cannot be responsible for lost mail. The product must be postmarked no later than 45 days after the date of purchase. Philips reserves the right to verify the purchase price of the product and limit refunds not to exceed suggested retail price.

To obtain the money-back guarantee service, please go to www.PhilipsMoneyBack.com and follow the simple 3-step process. Delivery of refund check will occur 6-8 weeks after receipt of returned product.

