

PHILIPS

EVNIA



OLED gaming
monitor

Gaming Monitor

Evnia 8000

42 (41.54" / 105.5 cm diag.)

3840 x 2160 (4K UHD)



42M2N8900

Gaming beyond innovation

Be prepared to get stunned by the precise colour reproduction of the Evnia OLED gaming monitor. The innovative Ambiglow redefines what a gaming environment usually is, levelling up not only your game gear, but also your gaming experience.

Features designed for gamers' needs

- AI-enhanced Ambiglow: for intensified entertainment
- LowBlue mode and Flicker-free easy-on-the eyes viewing
- Access and display multiple sources on two devices
- Connect your notebook with one USB-C cable
- Enhanced audio with DTS Sound™

Built for fast action

- AMD FreeSync™ Premium; tear free, stutter free, fluid gaming
- SmartImage game mode optimised for gamers
- VESA ClearMR 8000: for trusted, high-quality image

Immersive visuals

- OLED display for lifelike visuals with deeper black details
- Ultra Wide-Color wider range of colours for a vivid picture
- UltraClear 4K UHD (3840 x 2160) resolution for precision
- True 10-bit display reproduces smoother gradients on visuals

Gaming Monitor

OLED gaming monitor

42M2N8900/01

Highlights

Philips OLED display



This Philips OLED display delivers a wider viewing angle and uniquely lifelike visuals. Deeper black for a stunning viewing experience. Details in shadows and highlights are precisely reproduced.

AMD FreeSync™ Premium

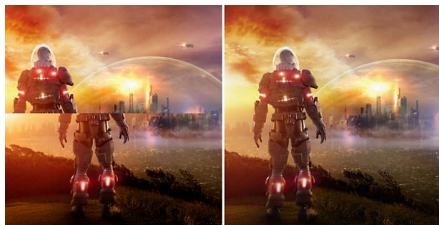

Gaming shouldn't be a choice between choppy gameplay or broken frames. AMD FreeSync™ Premium equips serious gamers with a fluid, tear-free gameplay experience at peak performance. There are no compromises, game confidently with a high refresh rate, low framerate compensation and low latency.

VESA ClearMR 8000

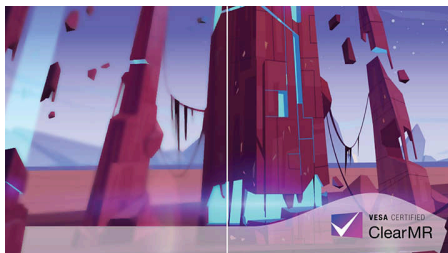

Previously, methods to test blurry image quality were measured through MRPT. VESA Certified ClearMR acts as an alternative to MRPT in which blur is tested with a digital high-speed camera. For monitors that are sent in and certified through VESA Certified ClearMR, you can rest assured that you will have an accurate assessment of the monitor's blur quality. Each certification is defined through a CMR range, with the highest tier being VESA ClearMR 8000.

As this monitor is certified as ClearMR 8000, it has one of the highest classifications of image quality, meaning less overall blur.

UltraClear 4K UHD resolution



These Philips displays utilise high-performance panels to deliver UltraClear, 4K UHD (3840 x 2160) resolution images. Whether you are a demanding professional requiring extremely detailed images for CAD solutions, a user of 3D graphics applications or a financial wizard working on huge spreadsheets, Philips displays will make your images and graphics come alive.

True 10-bit colour depth



With this Philips true 10-bit colour display, you can see colour-critical professional work of exceptional colour accuracy that meets professional standards. Compared with conventional 8-bit colour displays, this Philips monitor produces a more natural transition between hues for smoother gradients.

LowBlue mode and Flicker-free



Our LowBlue Mode and Flicker-free technology have been developed to reduce eye strain and fatigue often caused by long hours in front of a monitor.

DTS Sound™



DTS Sound is an audio-processing solution designed to optimise the playback of music, movies, streaming and games on the PC regardless of form factors. DTS Sound enables an immersive virtual surround sound experience, complete with rich bass and dialogue enhancement and maximised volume levels free of any clipping or distortion.

MultiView and built-in KVM



Control and switch between two devices through a single keyboard and mouse with the built-in KVM. MultiView lets you survey both sources simultaneously on one screen. With these features, you can reduce cable clutter and save valuable time. Perfect for streamers with two PCs, content creators or when prepping devices for a LAN event.



Highlights

AI-enhanced Ambiglow



Our AI-enhanced processor analyses the incoming image content and continuously adapts the colour and brightness of the emitted light to match the image. This feature adds a new dimension to your viewing experience. The innovative Ambiglow uses its AI capabilities to create a truly immersive and customisable gaming experience. From filling your gaming room with colour to feeling like you are part of the game, the AI-enhanced Ambiglow is made to make your gaming experience the best it's ever been by combining intelligence, colour and light.

USB-C connection



This Philips display features a USB type-C connector with power delivery. With intelligent and flexible power management, you can power charge your compatible device directly. Its slim, reversible USB-C allows for easy, one-cable connection. You can watch high-resolution video and transfer data at super speed, while powering up and recharging your compatible device at the same time.

SmartImage Game mode

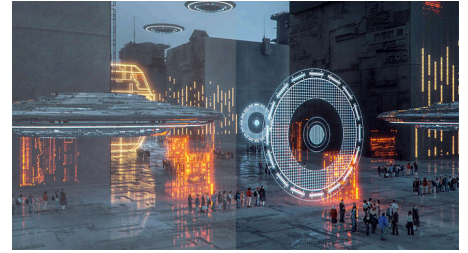

The new Philips gaming display has quick-access OSD fine-tuned for gamers, offering you multiple options. "FPS" mode (First person shooting) improves dark themes in games, allowing you to see hidden objects in dark areas. "Racing" mode adapts the display with the fastest response time and high colour, along with image adjustments. "RTS" mode (Real-time strategy) has a special SmartFrame mode that enables highlighting of specific area and allows for size and image adjustments. Gamer 1 and Gamer 2 enable you to save personal customised settings based on different games, ensuring best performance.

Specifications

Picture/Display

Panel Size: 41.54 inch/105.5 cm
Aspect ratio: 16:9
Monitor Panel Type: OLED
Pixel pitch: 0.2395 x 0.2395 mm
Brightness: Peak: 450 nit, Normal: 135 nit
Display colours: Colour support 1.07 billion colours (10-bit)
Colour gamut (typical): NTSC 110.3%*, sRGB 131.3%*, Adobe RGB 93.6%*
Colour gamut (min.): DCI-P3: 98.5%*
Contrast ratio (typical): 1,500,000:1
SmartContrast: Mega Infinity DCR
Response time (typical): 0.1 ms (Grey to Grey)*
Viewing angle: 178° (H)/178° (V), @ C/R > 10000
Picture enhancement: SmartImage game
Maximum resolution: 3840 x 2160 @ 138 Hz* (overclock)
Effective viewing area: 919.68 (H) x 517.32 (V)
Scanning Frequency: 30 - 255 kHz (H)/48 - 138 Hz (V)
sRGB
Delta E: < 2 (sRGB)
Flicker-free
Pixel Density: 106.06 PPI
LowBlue Mode
Display Screen Coating: Anti-Glare, Low-reflection 2%, Haze 25%
Low Input Lag
EasyRead
AMD FreeSync™ technology: Premium
HDR: HDR 10 supported
Ambiglow: 3 sided
Pixel format: RWBG Strip arrangement

Connectivity

Signal Input: HDMI 2.1 x 2, DisplayPort 1.4 x 1, USB-C x 1 (DP Alt mode, Power Delivery)
Sync Input: Separate Sync
Audio (In/Out): Audio out
HDCP: HDCP 1.4 (HDMI/DisplayPort/USB-C), HDCP 2.2 (HDMI/DisplayPort/USB-C), HDCP 2.3 (HDMI/DisplayPort/USB-C)
USB Hub: USB version 3.2 Gen1 / 5 Gbps, USB-B upstream x 1, USB-A downstream x 4 (with 2 for fast charge B.C 1.2)

Power Delivery

Max power delivery: USB-C up to 90 W (5 V/3 A, 7 V/3 A, 9 V/3 A, 10 V/3 A, 12 V/3 A, 15 V/3 A, 20 V/4.5 A)
Version: USB PD version 3.0

Convenience

Built-in Speakers: 10 W x 2, DTS
Plug and Play Compatibility: DDC/CI, Mac OS X, sRGB, Windows 11/10/8.1/8
User convenience: Power On/Off, Menu/OK, Input/Up, Game Settings/Down, SmartImage game/Back
OSD Languages: Brazil Portuguese, Czech, Dutch, English, Finnish, French, German, Greek, Hungarian, Italian, Japanese, Korean, Polish, Portuguese, Russian, Spanish, Simplified Chinese, Swedish, Turkish, Traditional Chinese, Ukrainian
Other convenience: Kensington lock, VESA mount (100 x 100 mm)
MultiView: PIP/PBP mode, 2 x devices
KVM

Stand

Height adjustment: 120 mm
Swivel: -/+ 20 degree
Tilt: -5/15 degree

Power

Power supply: Internal, 100–240 VAC, 50–60 Hz
Off mode: 0.3 W (typ.)
On mode: 69.6 W (typ.)
Standby mode: 0.5 W (typ.)
Power LED indicator: Operation - White, Standby mode - White (flashing)
Energy Label Class: G

Dimensions

Packaging in mm (W x H x D): 1070 x 635 x 188 mm
Product without stand (mm): 932 x 535 x 79 mm
Product with stand (max height): 932 x 689 x 359 mm

Weight

Product with packaging (kg): 21.01 kg
Product with stand (kg): 17.30 kg
Product without stand (kg): 13.84 kg

Operating conditions

Altitude: Operation: +12,000 ft (3658 m), Non-operation: +40,000 ft (12,192 m)
Temperature range (operation): 0°C to 40 °C
MTBF: 30,000 hour(s)
Relative humidity: 20%-80 %
Temperature range (storage): -20°C to 60 °C

Sustainability

Environmental and energy: RoHS
Recyclable packaging material: 100 %
Specific Substances: Mercury free, PVC/BFR free housing

Compliance and standards

Regulatory Approvals: CB, CE Mark, FCC Class B, ICES-003, CU-EAC, EAEU RoHS, TUV/ISO9241-307, TUV-BAUART, cETLus

Cabinet

Colour: White
Finish: Textured

What's in the box?

Cables: HDMI cable, DisplayPort cable, USB upstream cable, USB-C to USB-C cable, Power cable
Monitor with stand
User Documentation
Accessory: Remote control, VESA bracket



* For best output performance, please always ensure that your graphic card is capable of achieving the maximum resolution and refresh rate of this Philips display.

* Response time value equal to SmartResponse

* DCI-P3 Coverage based on CIE1976

* NTSC Area based on CIE 1976

* sRGB Area based on CIE1931

* Adobe RGB Coverage based on CIE 1976

* For USB-C power and charging function, your Notebook/device must support USB-C standard Power Delivery specifications. Please check with your Notebook user manual or manufacturer for more details.

* For Video transmission via USB-C, your Notebook/device must support USB-C DP Alt mode

* 2020 Advanced Micro Devices, Inc. All rights reserved. AMD, the AMD Arrow logo, AMD FreeSync™ and combinations thereof are trademarks of Advanced Micro Devices, Inc. Other product names used in this publication are for identification purposes only and may be trademarks of their respective companies.

* The monitor may look different from feature images.