

Connecting plate: 3 pcs

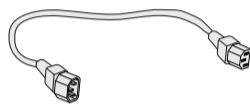

Screw bolt: 4 pcs (M10*70)



Power cable (daisy chain): 1 pcs



LAN cable (RJ45, CAT-5): 1 pcs (130 cm)



Quick start guide: 1 pcs

Quick Start



Display design and accessories may differ from those illustrated above.



x2



Not included:

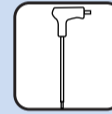

1 Rear/side/top/bottom views

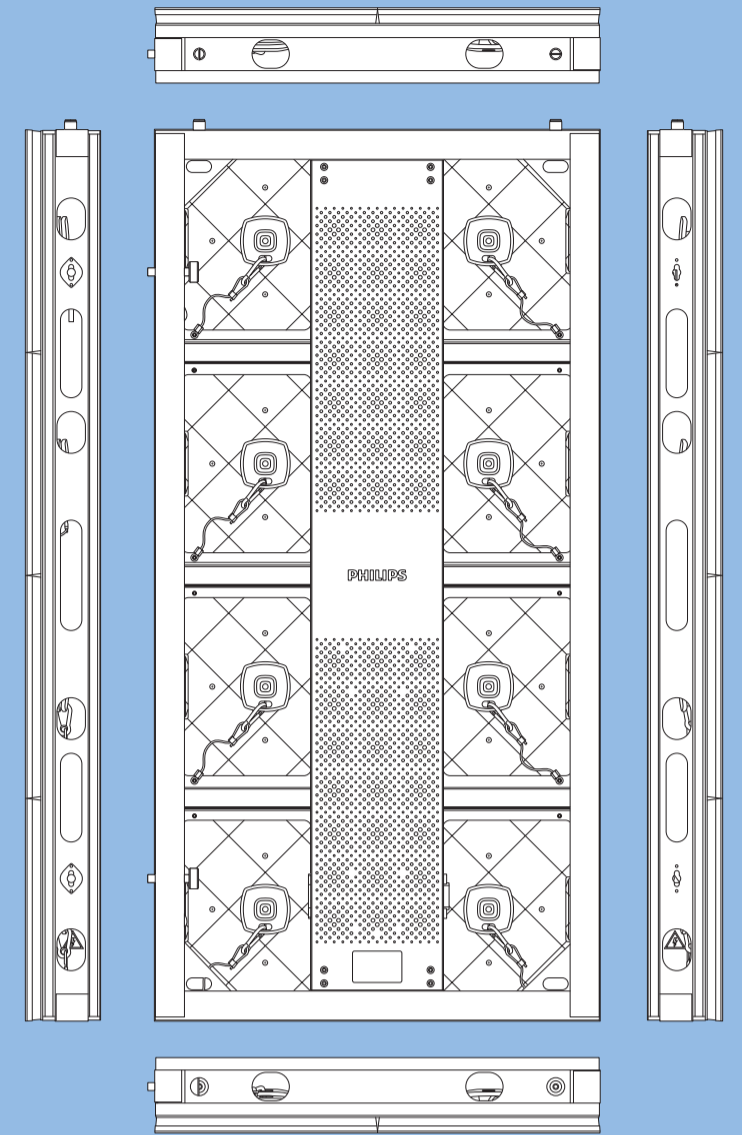

Please visit the website below for more product information.
www.philips.com/signagesolutions-support

2 Using the plate to fix the cabinets

A

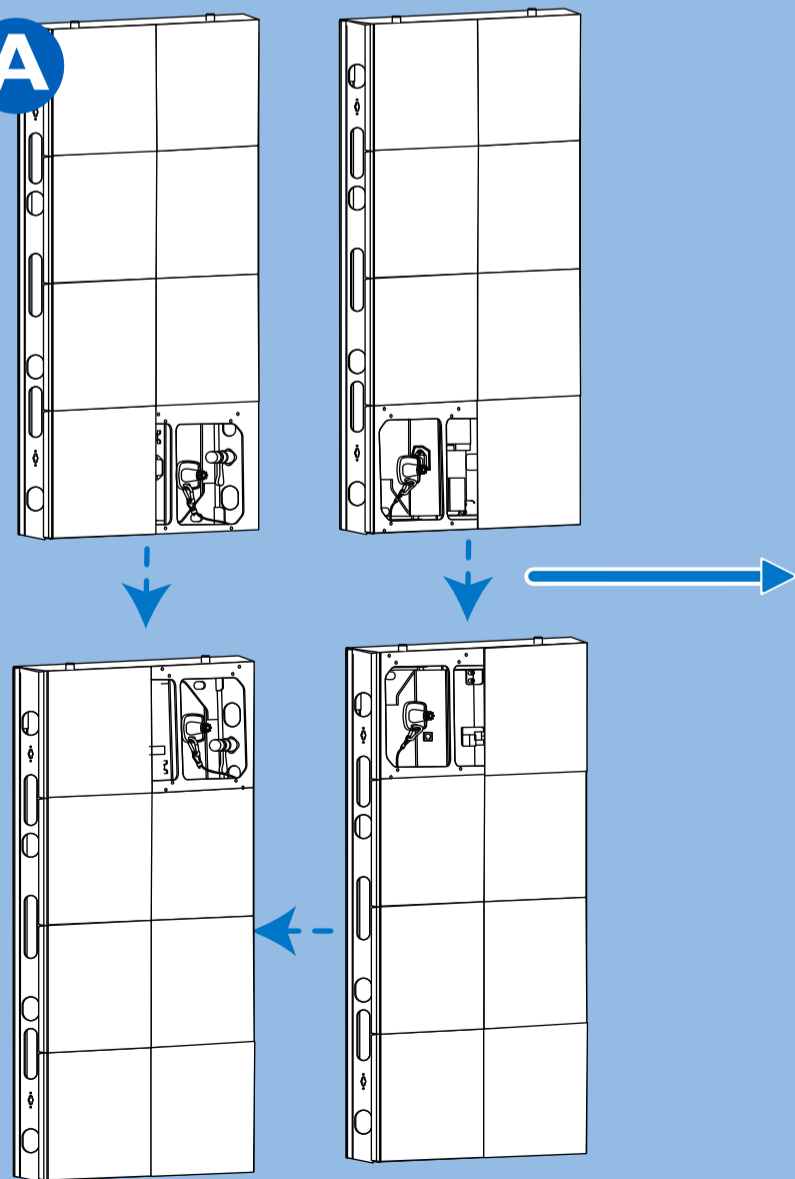

x2

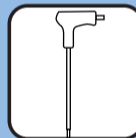

B

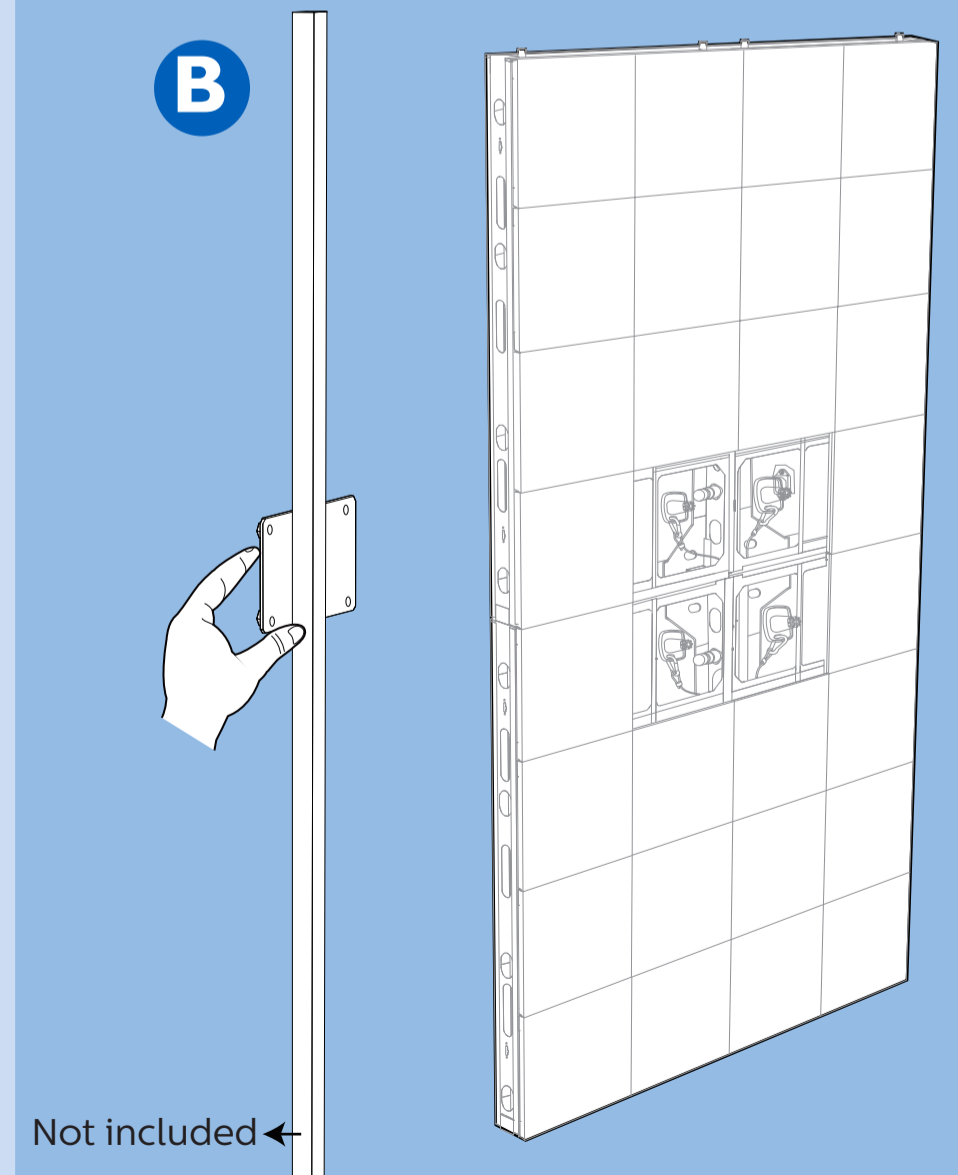

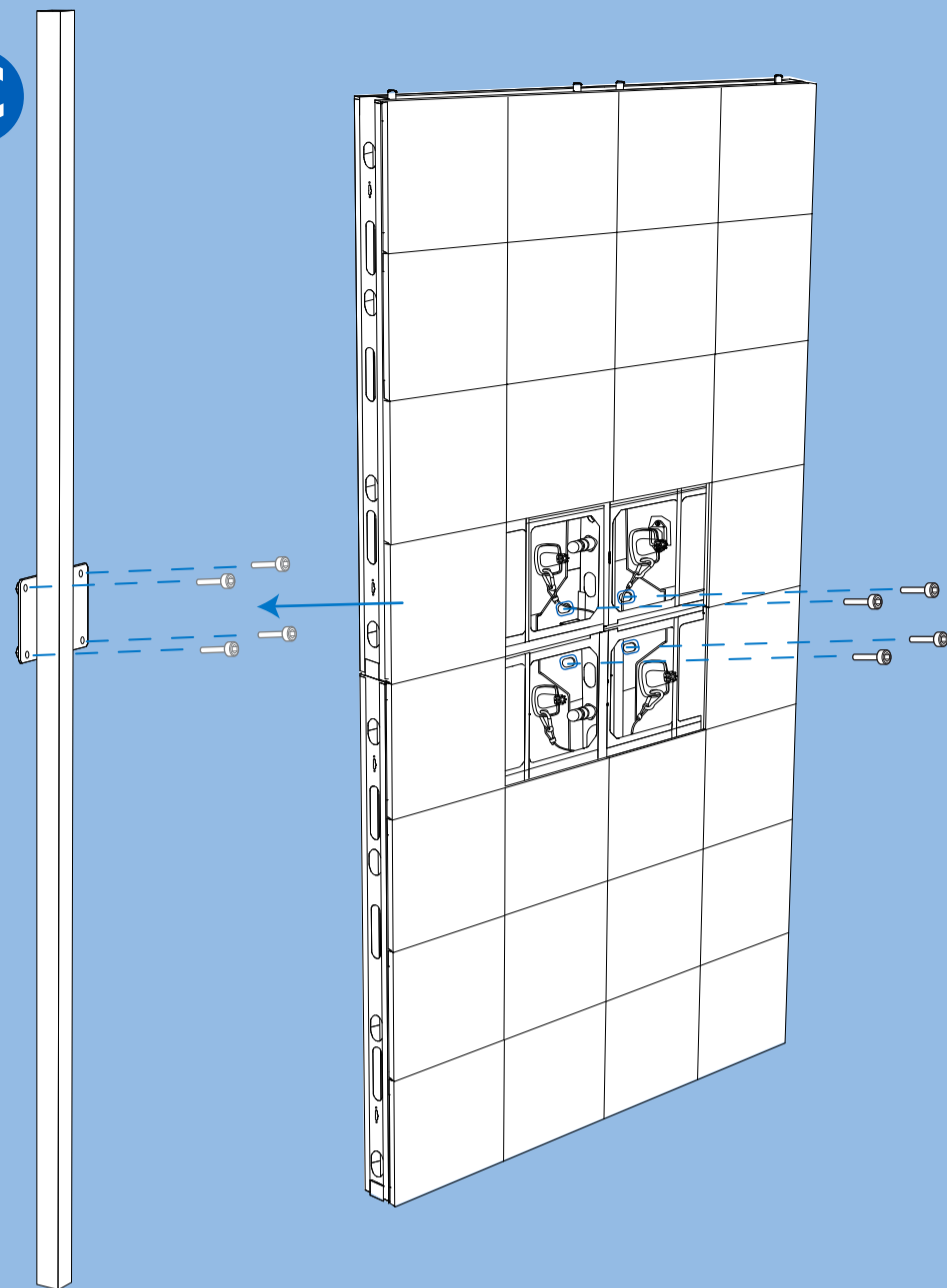
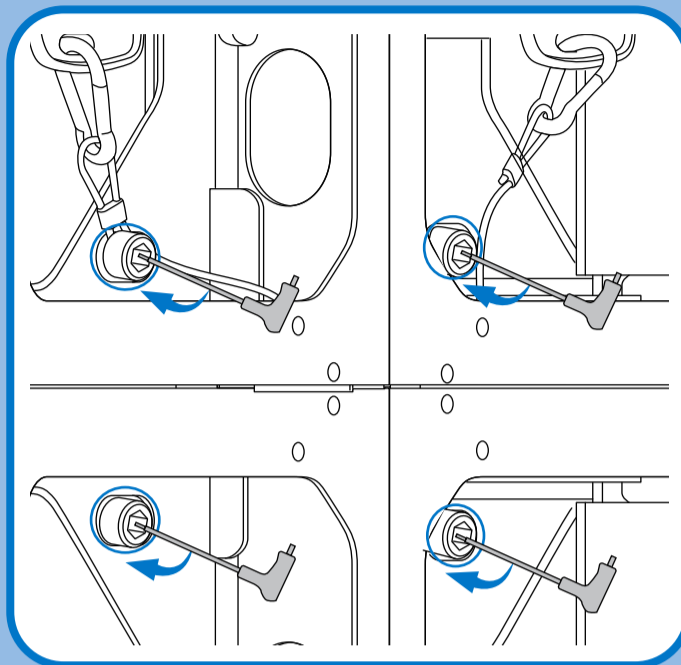
C**D****3**

Connecting the signal and power cables

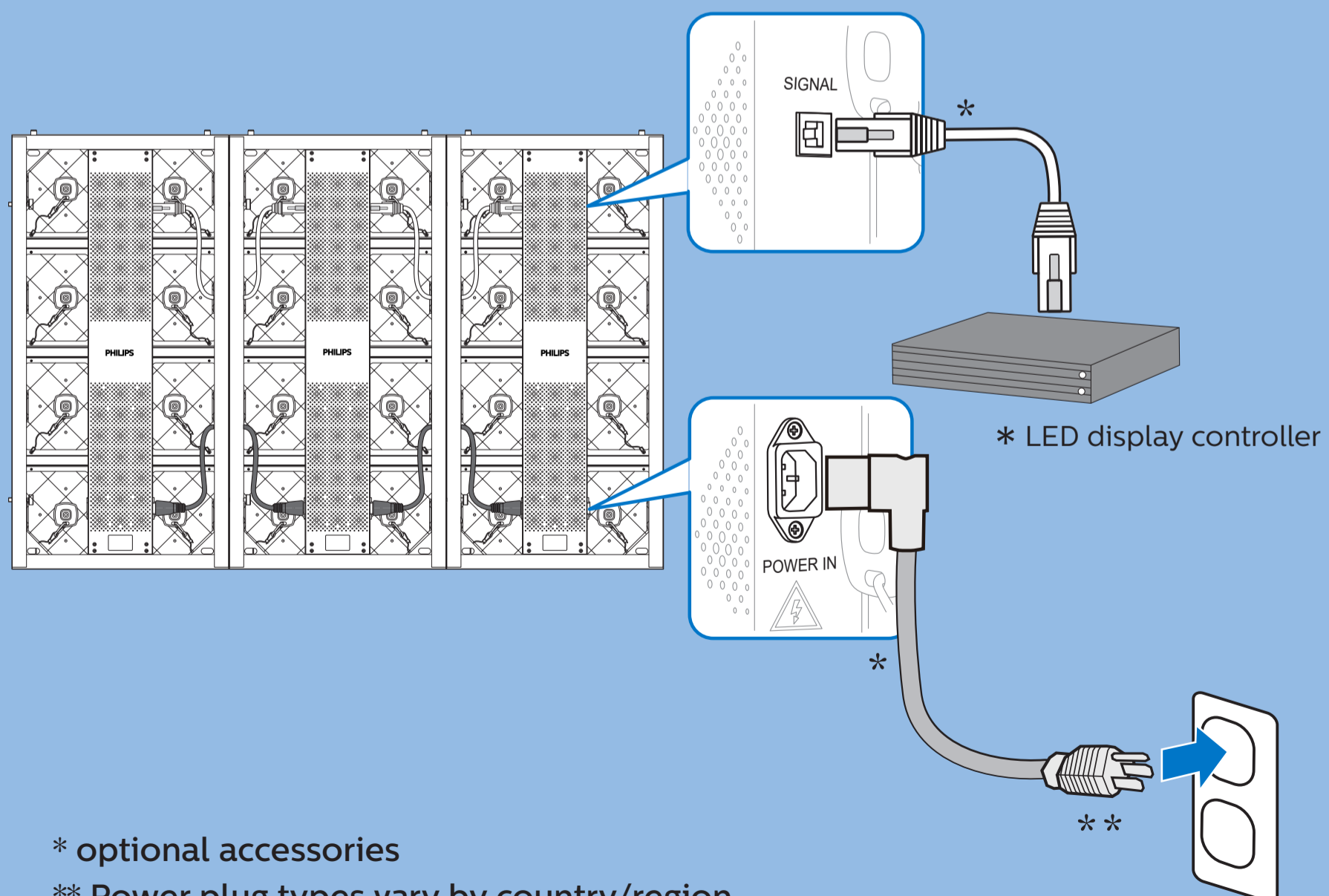

* optional accessories

** Power plug types vary by country/region

© 2019 Koninklijke Philips N.V. All rights reserved.
 This product was manufactured and brought to the market
 by or on behalf of Top Victory Investments Ltd. or one of
 its affiliates. Top Victory Investments Ltd. is the warrantor
 in relation to this product. Philips and the Philips Shield
 Emblem are registered trademarks of Koninklijke Philips
 N.V. used under license.

Specifications are subject to change without notice.
 Version: V1.02 2019-12-05