



Philips  
Professional LCD TV

**107cm/42" System**  
LCD  
Full HD 1080p

**42HFL5580**

## The ultimate Hospitality TV

Experience brilliant performance with a full HD 1080p display. Combined with a powerful Pixel Plus 2HD engine, HD Natural Motion and full Hotel System functionality, this is truly the ultimate in-room Hospitality solution.

### **Best total cost of ownership**

- Wireless SmartLoader for fast cloning
- External loudspeaker connector
- SmartPower for energy saving

### **System ready and future proof**

- SmartPlug Xpress & Serial Xpress Control interfaces
- Installation menu locking
- Switch On Channel Programming

### **Differentiating guest experience**

- Volume limitation
- Full HD LCD display 1920x1080p
- Philips Connectivity Panel compatible to enjoy guest devices

### **Great viewing experience and guest comfort**

- Welcome message on screen display
- Swivel stand with anti-theft provision

# PHILIPS

# Highlights

## Connectivity Panel compatible

This TV work seamlessly with Philips Connectivity Panels. The guest can easily connect and enjoy media from a PC, MP3 player, DVD player, camcorder and various other devices. With autosensing the Connectivity Panel and the TV will automatically switch to display the content from the connected guest device.

## External loudspeaker connector

Amplified audio connector for easy installation of external speakers (like for bathrooms), eliminating the need for investments in external equipment

## Installation menu locking

Prevents unauthorized access to installation and configuration settings, to ensure maximum guest convenience and avoid unnecessary reprogramming costs.

## SmartPlug & Serial Xpress

The Smartplug interface permits OEM or 3rd party decoders and controllers to interface with the TV.

## SmartPower

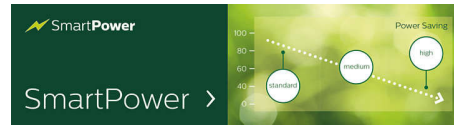

The backlight intensity can be controlled and pre-set by the system to reduce the power consumption by up to 50%, which saves substantially on energy costs.

## Switch On Channel Programming

Perfect for in-house advertising or information channels as it allows to show a predefined channel when the TV is turned on.

## Swivel stand

This LCD TV comes with a swivel stand that allows your guests to adjust the TV so that they can watch TV from any position in the room. The stand can be secured to a table or furniture to provide additional security against theft.

## Welcome message

A welcome greeting is displayed each time the TV set is switched on.

## Wireless SmartLoader

Provides the ability to copy easy and wireless all programming settings from one TV set into other TV sets in less than a minute. The feature ensures uniformity between TV sets and significantly reduces installation time and costs.

## Full HD LCD 1920x1080p (PB)

This display has a resolution that is referred to as Full HD. With state-of-the-art LCD screen technology it has the full high-definition widescreen resolution of 1920 x 1080p. This is the highest resolution that HD broadcast can transmit. It allows the best possible picture quality from any format of HD input signal. It produces brilliant flickerfree progressive scan pictures with optimum brightness and superb colors. This vibrant and sharp image will provide guests with an enhanced viewing experience.

## Volume limitation

This feature predefines the volume range with which the TV set is allowed to operate, preventing excessive volume adjustments and avoiding disturbance of next door guests.

# Specifications

## Picture/Display

- Aspect ratio: Widescreen, 16:9
- Diagonal screen size (inch): 42 inch
- Diagonal screen size (metric): 107 cm
- Panel resolution: 1920x1080p
- Brightness: 500 cd/m<sup>2</sup>
- Picture enhancement: Pixel Plus 2 HD, 3D Combfilter, Contrast Plus, Digital Noise Reduction, Jagged Line Suppression, Luminance Transient Improver, Progressive scan, HD Natural Motion, Active Control
- Contrast ratio (typical): 1000:1
- Display screen type: LCD Full HD W-UXGA Act. matrix
- Dynamic screen contrast: 30000:1
- Response time (typical): 5 ms
- Viewing angle (horizontal): 178 degree
- Viewing angle (vertical): 178 degree
- Screen enhancement: Anti-Reflection coated screen

## Supported Display Resolution

- Computer formats: 640 x 480, 60, 72, 75, 85Hz, 720 x 400, 70Hz, 800 x 600, 60, 72, 75, 85Hz, 1024 x 768, 60, 70, 75, 85Hz, 1280 x 768, 60Hz, 1280 x 1024, 60Hz, 1360 x 768, 60Hz, 1920 x 1080p, 60Hz
- Video formats: 480i, 60Hz, 480p, 60Hz, 576i, 50Hz, 576p, 50Hz, 720p, 50, 60Hz, 1080i, 50, 60Hz, 1080p, 24, 50, 60Hz, 1080p, 24, 25, 30Hz

## Tuner/Reception/Transmission

- Aerial Input: 75 ohm coaxial (IEC75)
- Tuner bands: Hyperband, S-Channel, UHF, VHF
- TV system: PAL I, PAL B/G, PAL D/K, SECAM B/G, SECAM D/K, NTSC
- Number of Preset Channels: 99
- Video Playback: NTSC, SECAM, PAL
- Tuner Display: PLL

## Convenience

- Ease of Installation: Wireless Smart Loading, Fine Tuning, Program Name, Advanced Hotel Mode, Keyboard lock-out, Security menu access
- Comfort: Hotel Guest features, Sleep timer, Switch on channel, Volume limitation, Welcome message
- Screen Format Adjustments: 4:3, 7 Widescreen Modes
- Remote Control: TV

- Interactive hotel features: Smoovie Pay TV
- Remote control type: RC2887
- Teletext: 1000 page Smart Text
- On-Screen Display languages: English, Simplified Chinese, Malay
- Other convenience: Kensington lock, Convertible to consumer TV

## Sound

- Output power (RMS): 2 x 15W
- Sound System: Mono, Stereo, BBE
- Sound Enhancement: Auto Volume Leveler, Incredible Surround, Smart Sound

## Loudspeakers

- Built-in speakers: 2

## Connectivity

- AV 1: Audio L/R in, YPbPr
- Connectivity Enhancements: External Loudspeaker connector, Digital Volume Control, Extra Power supply 12V/1W, RJ12 SmartPlug connector, RJ45 connector, Aux Audio Headphone connector
- AV 2: Audio L/R in, CVBS
- Front / Side connections: Audio L/R in, CVBS in, Headphone Out, S-video in, HDMI v1.3
- HDMI 1: HDMI v1.3
- HDMI 2: HDMI v1.3
- Other connections: PC-in VGA + Audio L/R in, RS232 Serial, Analog audio Left/Right out, Composite video (CVBS) out, S/PDIF out (coaxial)
- HDMI 3: HDMI v1.3

## Power

- Mains power: 100-240V, 50/60Hz
- Ambient temperature: 5 °C to 40 °C
- Power consumption: 200 W
- Standby power consumption: <math>\leq 1\text{W}</math> (Low Power Mode)

## Green Specifications

- Safety: Flame retardant housing
- Eco Designed
- SmartPower

## Accessories

- Included accessories: Tabletop swivel stand, Power cord, Remote Control, Batteries for remote

- control, Warranty Leaflet, User Manual
- Optional accessories: Mounting brackets/ stands, Set up Remote RC2573GR

## Dimensions

- Set Width: 1046 mm
- Set Height: 645 mm
- Set Depth: 88 mm
- Product weight: 20 kg
- Set width (with stand): 1046 mm
- Set height (with stand): 716 mm
- Set depth (with stand): 262 mm
- Product weight (+stand): 25.5 kg
- Box width: 1171 mm
- Box height: 810 mm
- Box depth: 333 mm
- Weight incl. Packaging: 31.5 kg
- Wall mount compatible: 400 x 400 mm

## Rear connectors

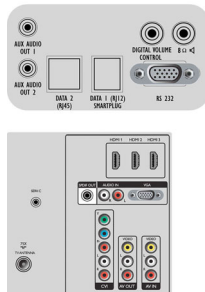

## Side



Issue date 2023-10-05

Version: 3.2.5

EAN: 87 12581 46526 1

© 2023 Koninklijke Philips N.V.  
All Rights reserved.

Specifications are subject to change without notice.  
Trademarks are the property of Koninklijke Philips N.V.  
or their respective owners.

[www.philips.com](http://www.philips.com)