



Philips  
Professional LCD TV

**94 cm (37")**  
LCD  
Full HD 1080p



**37HFL5382**

## The Versatile Hospitality TV

### Philips Full HD LCD TV for Hospitality

This Professional TV offers Advanced Hotel Mode and Full HD picture quality. New features including External Bathroom Loudspeaker and Digital Volume Control are specially designed to ensure reliable operation and maximum guest comfort.

#### **Best total cost of ownership**

- USB cloning of all settings for quick installation
- Installation menu locking
- External loudspeaker connector

#### **Sustainable and safe**

- Eco-friendly design & flame retardant housing
- Lead-free/RoHS compliant with flame retardant housing

#### **Advanced hotel features and future proof**

- Switch On Channel Programming
- Serial Xpress Protocol for interactive systems
- Welcome message on screen display
- Smart Hotel Mode

#### **Great viewing experience and guest comfort**

- Digital Crystal Clear for more vivid cinema-like images
- USB Connector for easy, instant multimedia playing

# PHILIPS

# Highlights

## Smart Hotel Mode

Allows configuration of the TV for limited access, ideal for hotel use. Access to the user menu can be blocked, which enables you to specify channel, picture, and sound settings which your guest will be unable to modify. Picture and sound preferences may be selected from presets on the remote, offering guest selection, but never overwriting your defined settings. Switch on and maximum volume can also be specified so the set always turns on and operates at a comfortable volume. Channels can be blanked to prevent access to premium or adult content. Includes a forced power on mode.

## External loudspeaker connector

Amplified audio connector for easy installation of external speakers (like for bathrooms), eliminating the need for investments in external equipment

## Installation menu locking

Prevents unauthorized access to installation and configuration settings, to ensure maximum guest convenience and avoid unnecessary reprogramming costs.

## Switch On Channel Programming

Perfect for in-house advertising or information channels as it allows to show a predefined channel when the TV is turned on.

## Welcome message

A welcome greeting is displayed each time the TV set is switched on.

## USB Cloning

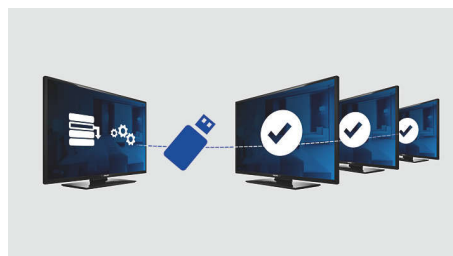

Provides the ability to easily copy all programming and channel programming settings from one TV into other TV sets in less than a minute. The feature ensures uniformity between TV sets and significantly reduces installation time and costs.

## USB multimedia playing

This Philips TV allows the guest to connect a USB stick for easy and instant playing of multimedia content. Playback formats supported are MP3, Slideshow files (.alb) and JPEG Still pictures.

## Serial Xpress Protocol (SXP)

The TV can be connected to external decoders and set-top boxes of all major interactive system providers, through the Serial Xpress Protocol (SXP).

## Digital Crystal Clear

Digital Crystal Clear is a processing technology that digitally adjusts and enhances picture quality by optimizing contrast, color and sharpness levels, resulting in more vivid cinema-like images.

## RoHS & Flame retardant housing

In addition to being lead-free and RoHS compliant, Philips TVs have a special housing of eco-friendly, non-brominated flame-retardant materials. Independent tests carried out by emergency fire services have shown that whereas TVs can sometimes intensify fires caused by external sources, Philips TVs will not contribute to the fire.

## Eco-friendly design

Sustainability is integral to the way Philips does business. Philips TVs are designed and produced according to our EcoDesign principles aimed at minimizing overall environmental impact, through lower power consumption, removal of hazardous substances, lower weight, more efficient packaging and better recyclability. Philips TVs also have a special housing of flame retardant material. Independent tests carried out by emergency fire services have shown that whereas TVs can sometimes intensify fires caused by external sources, Philips TVs will not contribute to the fire.

# Specifications

## Picture/Display

- Aspect ratio: Widescreen
- Diagonal screen size (inch): 37 inch
- Diagonal screen size (metric): 94 cm
- Color cabinet: Black
- Panel resolution: 1920x1080p
- Brightness: 500 cd/m<sup>2</sup>
- Contrast ratio (typical): 1500:1
- Picture enhancement: 3/2 - 2/2 motion pull down, 3D Comfilter, Digital Crystal Clear, 1080p 24/25/30Hz processing, 1080p 50/60Hz processing, 2D/3D noise reduction, Active Control, Color Enhancement, Dynamic contrast enhancement, Dynamic Noise Reduction, Jagged Line Suppression, Sharpness Adjustment
- Display screen type: LCD Full HD W-UXGA Act. matrix
- Dynamic screen contrast: 100000:1
- Response time (typical): 5 ms
- Viewing angle: 178° (H) / 178° (V)

## Supported Display Resolution

- Computer formats: 640 x 480, 60, 72, 75, 85Hz, 800 x 600, 60, 72, 75, 85Hz, 1024 x 768, 60, 70, 75, 85Hz, 1280 x 768, 60Hz, 1280 x 1024, 60Hz, 1360 x 768, 60Hz, 1920 x 1080p, 60Hz
- Video formats: 480i, 60Hz, 480p, 60Hz, 576i, 50Hz, 576p, 50Hz, 720p, 50, 60Hz, 1080i, 50, 60Hz, 1080p, 24, 25, 30, 50, 60Hz

## Tuner/Reception/Transmission

- Aerial Input: 75 ohm coaxial (IEC75)
- Tuner bands: Hyperband, S-Channel, UHF, VHF
- TV system: PAL D/K, PAL B/G, NTSC
- Video Playback: NTSC, PAL

## Multimedia Applications

- Multimedia connections: USB
- Playback Formats: JPEG Still pictures, BMP Still pictures, GIF still pictures, Slideshow files (.alb), MP3, WMA

## Convenience

- Ease of Installation: Cloning of TV settings via USB, Advanced Hotel Mode, PLL Digital Tuning, Fine Tuning, Program Name, Installation menu locking, Keyboard lock-out, Security menu access
- Ease of Use: Auto Volume Leveller (AVL), Graphical User Interface, On Screen Display, Side

Control, Smart Picture, Smart Sound

- Comfort: Hotel Guest features, Sleep timer, Switch on channel, Volume limitation, Welcome message
- Screen Format Adjustments: 4:3, Widescreen, Movie expand 16:9, Movie expand 14:9, Subtitle Zoom, Super Zoom
- Remote Control: TV
- Remote control type: PF01A09B
- Teletext: 1000 page Smart Text
- Firmware upgradeable: Firmware upgradeable via USB

## Sound

- Output power (RMS): 2 x 10 W
- Sound System: Mono, Stereo, Nicam Stereo
- Sound Enhancement: Incredible Surround, Auto Volume Leveler, Treble and Bass Control

## Loudspeakers

- Built-in speakers: 2

## Connectivity

- AV 1: CVBS in, Audio L/R in
- Connectivity Enhancements: Fast Infrared loop through, External Loudspeaker connector, Serial Xpress interface
- AV 2: YPbPr, Audio L/R in
- AV 3: HDMI (v1.3 with CEC)
- EasyLink (HDMI-CEC): One touch play, System standby, Power status, Remote control pass-through, System audio control
- Front / Side connections: Audio L/R in, CVBS in, HDMI v1.3, USB 2.0, Headphone Out, Digital Volume Control, Digital Volume Control Select, External Speaker Out (2W)
- Other connections: PC-In VGA, PC Audio in, Monitor out, CVBS, L/R (cinch), S/PDIF out (coaxial), Antenna IEC75

## Power

- Mains power: 100-264V, 50-60Hz
- Ambient temperature: 0 °C to 35 °C
- Power consumption: 155 W
- Standby power consumption: < 1 W

## Green Specifications

- Safety: Flame retardant housing
- SmartPower

## Accessories

- Included accessories: Remote Control, Power cord, Batteries for remote control, Tabletop swivel stand, External Loudspeaker Cover Cap, Quick start guide, Warranty Leaflet, User Manual
- Optional accessories: Set up Remote RC2573GR

## Dimensions

- Set Width: 901.5 mm
- Set Height: 579.7 mm
- Set Depth: 89.5 mm
- Product weight: 12.5 kg
- Set width (with stand): 901.5 mm
- Set height (with stand): 623.75 mm
- Set depth (with stand): 237 mm
- Product weight (+stand): 14.5 kg
- Box width: 1035 mm
- Box height: 760 mm
- Box depth: 205 mm
- Weight incl. Packaging: 19.8 kg
- Wall mount compatible: 200 x 200 mm

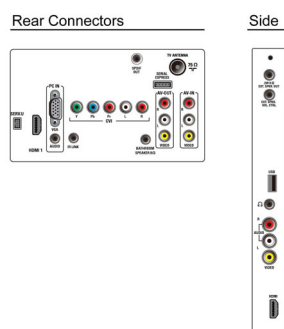

Issue date 2023-10-19

Version: 3.4.11

EAN: 87 12581 55064 6

© 2023 Koninklijke Philips N.V.  
All Rights reserved.

Specifications are subject to change without notice.  
Trademarks are the property of Koninklijke Philips N.V.  
or their respective owners.

[www.philips.com](http://www.philips.com)

