



LCD monitor with Ultra Wide-Color

- E Line
- 24 (Viewable 23.6" / 59.9 cm)
- 1920 x 1080 (Full HD)

246E7QDSB/89

Vivid, true-to-life colors

in an elegant design

This brilliant wide view display with Ultra Wide-Color offers true-to-life colors wrapped in an elegance-inspired design for a light and fresh face in any home or office.

Benefits

Superb Picture Quality

- Ultra Wide-Color wider range of colors for a vivid picture
- PLS LED wide-view technology for image and color accuracy
- 16:9 Full HD display for crisp detailed images
- Less eye fatigue with Flicker-free technology
- SmartContrast for deep black level details
- SmartImage Lite for easy optimized image settings

- EasySelect menu toggle key for quick on-screen menu access
- Elegant, slim design complements your home decor
- Superb glossy finish enhance your home decoration

Experience immersive multimedia

- MHL technology for enjoying mobile content on big screen

Elegant Design

PHILIPS

Features

Ultra Wide-Color Technology



Ultra Wide-Color Technology delivers a wider spectrum of colors for a more brilliant picture. Ultra Wide-Color wider "color gamut" produces more natural-looking greens, vivid reds and deeper blues. Bring media entertainment, images, and even productivity more alive and vivid colors from Ultra Wide-Color Technology.

PLS technology



PLS displays uses an advanced technology which gives you extra wide viewing angles of 178/178 degree, making it possible to view the display from almost any angle - even in 90 degree Pivot mode! Unlike standard TN panels, PLS displays gives you remarkably crisp images with vivid colors, making it ideal not only for Photos, movies and web browsing, but also for professional applications which demand color accuracy and consistent brightness at all times.

16:9 Full HD display



Picture quality matters. Regular displays deliver quality, but you expect more. This display features enhanced Full HD 1920 x 1080 resolution. With Full HD for crisp detail paired with high brightness, incredible contrast and realistic colors expect a true to life picture.

Flicker-free technology



Due to the way brightness is controlled on LED-backlit screens, some users experience flicker on their screen which causes eye fatigue. Philips Flicker-free

Technology applies a new solution to regulate brightness and reduce flicker for more comfortable viewing.

SmartContrast



SmartContrast is a Philips technology that analyzes the contents you are displaying, automatically adjusting colors and controlling backlight intensity to dynamically enhance contrast for the best digital images and videos or when playing games where dark hues are displayed. When Economy mode is selected, contrast is adjusted and backlighting fine-tuned for just-right display of everyday office applications and lower power consumption.

SmartImage Lite

SmartImage Lite is an exclusive, leading edge Philips technology that analyzes the content displayed on your screen. Based on a scenario you select, SmartImage Lite dynamically enhances the contrast, color saturation and sharpness of images and videos for ultimate display performance - all in real time with the press on a single button.

EasySelect Menu Toggle Key

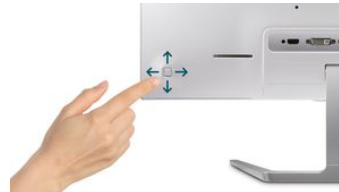

The discreetly placed EasySelect Menu Toggle Key allows you to make quick and easy adjustments to monitor settings in the On-Screen Display menu.

MHL technology



Mobile High Definition Link (MHL) is a mobile audio/video interface for directly connecting mobile phones and other portable devices to high-definition displays. An optional MHL cable allows you to simply connect your MHL capable mobile device to this large Philips MHL display, and watch your HD videos come to life with full digital sound. Now not only you can enjoy your mobile games, photos, movies, or other apps on its big screen, you can simultaneously charge your mobile device so you never run out of power half way.

Specifications

[field not found 'disclaimer_text']

Picture/Display

LCD panel type	PLS LCD
Backlight type	W-LED system
Panel Size	23.6 inch / 59.9 cm
Effective viewing area	521.28 (H) x 293.22 (V)
Aspect ratio	16:9
Optimum resolution	1920 x 1080 @ 60Hz
Response time (typical)	5 ms (Gray to Gray)*

Brightness	250 cd/m ²
Contrast ratio (typical)	1000:1
SmartContrast	20,000,000:1
Pixel pitch	0.272 x 0.272 mm
Viewing angle	178° (H) / 178° (V) @ C/R > 10
Flicker-free	Yes
Picture enhancement	SmartImage Lite

Color gamut (typical) NTSC 101.4% (CIE1976)*
 Display colors 16.7 M
 Scanning Frequency 30 -83 kHz (H) / 56 -76 Hz (V)
 MHL 1080P @ 30Hz
 sRGB Yes

Power LED indicator Operation - White
 Standby mode- White (blinking)
 Power supply External
 100-240VAC, 50-60Hz

Connectivity

Signal Input VGA (Analog)
 DVI-D (digital, HDCP)
 MHL-HDMI (digital, HDCP)
 Sync Input Separate Sync
 Sync on Green
 Audio (In/Out) HDMI audio out

Dimensions

Product with stand 539 x 419 x 179 mm
 (mm)
 Product without stand (mm) 539 x 324 x 45 mm
 Packaging in mm (WxHxD) 581 x 490 x 102 mm

Convenience

User convenience Power On/Off
 Menu
 Volume (HDMI Audio out)
 Input
 OSD Languages SmartImage lite
 Brazil Portuguese
 Czech
 Dutch
 English
 Finnish
 French
 German
 Greek
 Hungarian
 Italian
 Japanese
 Korean
 Polish
 Portuguese
 Russian
 Simplified Chinese
 Spanish
 Swedish
 Traditional Chinese
 Turkish
 Ukranian
 Other convenience Kensington lock
 VESA mount (100x100mm)
 Plug & Play Compatibility DDC/CI
 Mac OS X
 sRGB
 Windows 8.1 / 8 / 7

Weight

Product with stand 3.18 kg
 (kg)
 Product without stand (kg) 2.61 kg
 Product with packaging (kg) 5.13 kg

Operating conditions

Temperature range (operation) 0°C to 40°C °C
 Temperature range (storage) -20°C to 60°C °C
 Relative humidity 20%-80 %
 Altitude Operation: +12,000ft (3,658m), Non-operation: +40,000ft (12,192m)
 MTBF 50,000 (excluding backlight) hour(s)

Sustainability

Environmental and energy EnergyStar 7.0
 RoHS
 Mercury Free
 Recyclable packaging material 100 %

Compliance and standards

Regulatory Approvals CE Mark
 FCC Class B
 CU-EAC
 TCO Certified
 TUV/ISO9241-307
 VCCI
 C-tick
 WEEE
 CECP

Stand

Tilt -5/20 degree

Cabinet

Color Black
 Finish Glossy

Power

On mode 14.47 W (typ.) (EnergyStar 7.0 test method)
 Standby mode 0.5 W (typ.)
 Off mode 0.3 W (typ.)

* This Philips display is MHL certified. However, in case your MHL device does not connect or work correctly, check with your MHL device FAQ or vendor directly for direction. The policy of your device manufacturer may require you to purchase their brand specific MHL cable or adapter in order to work

* Requires optional MHL certified mobile device and MHL cable. (not included) Please check with your MHL device vendor for compatibility.

* Standby/Off energy saving of ErP is not applicable for the MHL charging functionality

* For complete list of MHL-enabled products refer to www.mhlconsortium.org

* HDMI cables vary depending on region and models.

* Response time value equal to SmartResponse

* NTSC 85% (CIE1931), sRGB: 122.7%



data subject to change
 2021, May 19

Version: 3.0.1
 EAN: 8712581752125

© 2021 Koninklijke Philips N.V.
 All rights reserved.

Specifications are subject to change without notice. Trademarks are the property of Koninklijke Philips N.V. or their respective owners.

www.philips.com