

PHILIPS

EVNIA

Full HD gaming
monitor

Gaming Monitor

Evnia 3000

24 (23.8"/60.5 cm diag.)

1920 x 1080 (Full HD)

24M1N3200ZS



Take gaming to the next level

This Philips gaming monitor is a great all-around display for intense, action-packed PC games. Sync technology, 165 Hz and 1 ms deliver smooth gameplay. The virtually frameless display with Ultra Wide-Color enhances the immersive visual experience.

Features designed for you

- EasySelect menu toggle key for quick on-screen menu access
- LowBlue mode and Flicker-free easy-on-the eyes viewing

Immersive visuals

- 16:9 Full HD display for crisp, detailed images
- SmartContrast for rich black details
- IPS LED wide view technology for image and colour accuracy
- Ultra Wide-Color wider range of colours for a vivid picture

The gaming advantage is yours

- 165 Hz refresh rates for ultra-smooth, brilliant images
- 1 ms (MPRT) fast response for crisp images and smooth gameplay
- AMD FreeSync™ Premium; tear free, stutter free, fluid gaming
- SmartImage game mode optimised for gamers
- Low input lag reduces time delay between devices to monitor

Gaming Monitor

Full HD gaming monitor

24M1N3200ZS/00

Highlights

AMD FreeSync™ Premium



Gaming shouldn't be a choice between choppy gameplay or broken frames. AMD FreeSync™ Premium equips serious gamers with a fluid, tear-free gameplay experience at peak performance. There are no compromises, game confidently with a high refresh rate, low framerate compensation and low latency.

165 Hz Gaming



You play intense, competitive gaming. You demand display with lag free, ultra-smooth images. This Philips display redraws the screen image up to 165 times per second, effectively faster than a standard display. A lower frame rate can make enemies appear to jump from spot to spot on the screen, making them difficult targets to hit. With 165 Hz frame rate, you get those critical missing images on the screen which shows enemy movement in ultra-smooth motion so you can easily target them. With ultra-low input lag and no screen tearing, this Philips display is your perfect gaming partner

1 ms MPRT fast response

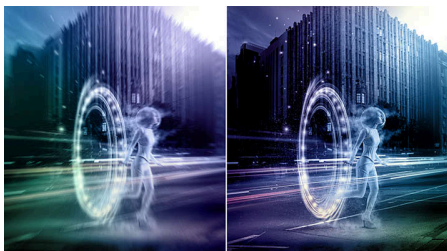

MPRT (motion picture response time) is a more intuitive way to describe response time, which directly refers to the duration between seeing

blurry noise and clean, crisp images. The Philips gaming monitor with 1 ms MPRT effectively eliminates smearing and motion blur and delivers sharper and more precise visuals to enhance your gaming experience. The best choice for playing thrilling and twitch-sensitive games.

Low Input Lag

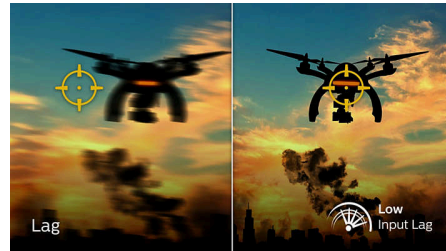

Input lag is the amount of time that elapses between performing an action with connected devices and seeing the result on screen. Low input lag reduces the time delay between entering a command from your devices to monitor, greatly improving play on twitch-sensitive video games, particularly important for playing fast-paced, competitive games.

SmartImage Game mode

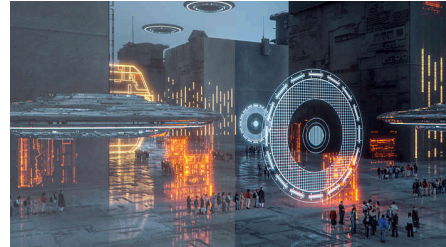

The new Philips gaming display has quick-access OSD fine-tuned for gamers, offering you multiple options. "FPS" mode (First person shooting) improves dark themes in games, allowing you to see hidden objects in dark areas. "Racing" mode adapts the display with the fastest response time and high colour, along with image adjustments. "RTS" mode (Real-time strategy) has a special SmartFrame mode that enables highlighting of specific area and allows for size and image adjustments. Gamer 1 and Gamer 2 enable you to save personal customised settings based on different games, ensuring best performance.

IPS technology



IPS displays use an advanced technology that gives you extra-wide viewing angles of 178/178 degrees, making it possible to view the display from almost any angle. Unlike standard TN panels, IPS displays give you remarkably crisp images with vivid colours, making them ideal not only for Photos, movies and web browsing, but also for professional applications that demand colour accuracy and consistent brightness at all times.

LowBlue Mode and Flicker-free



Our LowBlue Mode and Flicker-free technology have been developed to reduce eye strain and fatigue often caused by long hours in front of a monitor.

EasySelect Menu Toggle Key



The discreetly placed EasySelect Menu Toggle Key allows you to make quick and easy adjustments to monitor settings in the On-Screen Display menu.

AMD
FreeSync
Premium

165Hz

1ms
Fast Response
1ms MPRT

Low Input Lag

SmartImage™
Game

LowBlue Mode

EasySelect

Full HD
1080p

Gaming Monitor

Full HD gaming monitor

24M1N3200ZS/00

Highlights

16:9 Full HD display



Picture quality matters. Regular displays deliver quality, but you expect more. This display features enhanced Full HD 1920 x 1080 resolution. With Full HD for crisp detail paired with high brightness, incredible contrast and realistic colours, expect a true-to-life picture.

SmartContrast



SmartContrast is a Philips technology that analyses the contents you are displaying, automatically adjusting colours and controlling backlight intensity to dynamically enhance contrast for the best digital images and videos or when playing games where dark hues are displayed. When Economy mode is selected, contrast is adjusted and backlighting fine-tuned for just-right display of everyday office applications and lower power consumption.

Ultra Wide-Color Technology



Ultra Wide-Color Technology delivers a wider spectrum of colours for a more brilliant picture. The Ultra Wide-Color wider "colour gamut" produces more natural-looking greens, vivid reds and deeper blues. Bring media entertainment, images and even productivity more alive with vivid colours from Ultra Wide-Color Technology.



Specifications

Picture/Display

Panel Size: 23.8 inch/60.5 cm
Aspect ratio: 16:9
LCD panel type: IPS technology
Backlight type: W-LED system
Pixel pitch: 0.2745 x 0.2745 mm
Brightness: 250 cd/m²
Display colours: 16.7 M
Colour gamut (typical): NTSC 106%*, sRGB 123.9%*, Adobe RGB 90.4%*
Contrast ratio (typical): 1100:1
SmartContrast: Mega Infinity DCR
Response time (typical): 4 ms (Grey to Grey)*
Viewing angle: 178° (H)/178° (V), @ C/R > 10
Picture enhancement: SmartImage game
Maximum resolution: 1920 x 1080 @ 165 Hz*
Effective viewing area: 527.04 (H) x 296.46 (V)
Scanning Frequency: 30 - 200 kHz (H) / 48 - 165 Hz (V)
sRGB
Flicker-free
Pixel Density: 92.56 PPI
LowBlue Mode
Display Screen Coating: Anti-Glare, 3H, Haze 25%
MPRT: 1 ms
Low Input Lag
EasyRead
AMD FreeSync™ technology: Premium

Connectivity

Signal Input: HDMI x 2, DisplayPort x 1
Sync Input: Separate Sync
Audio (In/Out): Audio out
HDCP: HDCP 2.2 (HDMI/DisplayPort)

Convenience

Plug and Play Compatibility: DDC/CI, Mac OS X, sRGB, Windows 10/8.1/8/7
User convenience: Power On/Off, Menu/OK, Input/Up, Game Settings/Down, SmartImage game/Back
OSD Languages: Brazil Portuguese, Czech, Dutch, English, Finnish, French, German, Greek, Hungarian, Italian, Japanese, Korean, Polish, Portuguese, Russian, Spanish, Simplified Chinese, Swedish, Turkish, Traditional Chinese, Ukrainian
Other convenience: Kensington lock, VESA mount (100 x 100 mm)

Stand

Tilt: -5/20 degree

Power

Power supply: External, 100–240 VAC, 50–60 Hz
Off mode: 0.3 W (typ.)
On mode: 24 W (typ.)
Standby mode: 0.5 W (typ.)
Power LED indicator: Operation - White, Standby mode - White (flashing)
Energy Label Class: E

Dimensions

Packaging in mm (W x H x D): 600 x 526 x 164 mm
Product without stand (mm): 540 x 321 x 43 mm
Product with stand (max height): 540 x 416 x 193 mm

Weight

Product with packaging (kg): 5.45 kg
Product with stand (kg): 3.50 kg
Product without stand (kg): 2.40 kg

Operating conditions

Altitude: Operation: +12,000 ft (3658 m), Non-operation: +40,000 ft (12,192 m)
Temperature range (operation): 0°C to 40 °C
MTBF: 50 000 (Excluded backlight) hour(s)
Relative humidity: 20%-80 %
Temperature range (storage): -20°C to 60 °C

Sustainability

Environmental and energy: RoHS
Recyclable packaging material: 100 %
Specific Substances: Mercury free, PVC/BFR free housing

Compliance and standards

Regulatory Approvals: CB, CCC, CECP, CEL, CE Mark, FCC Class B, ICES-003

Cabinet

Colour: Black
Finish: Textured

What's in the box?

Cables: HDMI cable, DisplayPort cable, Power cable
Monitor with stand
User Documentation



* "IPS" word mark / trademark and related patents on technologies belong to their respective owners.

* NTSC Area based on CIE 1976

* sRGB Area based on CIE1931

* Adobe RGB Coverage based on CIE 1976

* The maximum resolution works for either HDMI input or DP input.

* For best output performance, please always ensure that your graphic card is capable of achieving the maximum resolution and refresh rate of this Philips display.

* Response time value equal to SmartResponse

* MPRT adjusts the brightness for blur reduction, so the brightness cannot be adjusted while MPRT is turned on. To reduce motion blur, the LED backlight will strobe in time with the screen refresh rate, which may cause a noticeable change in brightness.

* MPRT is a gaming-optimised mode. Turning on MPRT may cause noticeable screen flickering. It is recommended to turn this mode off when you are not using the gaming function.

* 2020 Advanced Micro Devices, Inc. All rights reserved. AMD, the AMD Arrow logo, AMD FreeSync™ and combinations thereof are trademarks of Advanced Micro Devices, Inc. Other product names used in this publication are for identification purposes only and may be trademarks of their respective companies.

* The monitor may look different from feature images.