

PHILIPS

UltraWide LCD
monitor

Monitor

E Line

34" (86.36 cm)

3440 x 1440 (WQHD)

346E2LAE



Simplify your connections with USB-C

The Philips E line UltraWide display offers expansive panoramic visual. WQHD display and ergonomic stand guarantee the optimal viewing conditions. Features like all-in-one USB-C, built-in USB Hub, and MultiView help boost up productivity.

Features designed for you

- Built-in stereo speakers for multimedia
- Tilt and height-adjust for an ideal viewing position
- MultiView enables simultaneous dual connection and view
- Cable management reduces cable clutter for neat workspace
- LowBlue mode and Flicker-free easy-on-the eyes viewing

Single cable USB-C connection

- Connect your notebook with one USB-C cable

Good for Gaming

- 1ms (MPRT) fast response for crisp image and smooth gameplay
- Effortlessly smooth gameplay with AMD FreeSync™ technology
- SmartImage game mode optimized for gamers

Superb Picture Quality

- VA display delivers awesome images with wide viewing angles
- CrystalClear images with UltraWide QHD 3440 x 1440 pixels

Highlights

USB-C connection



This Philips display features a USB type-C connector with power delivery. With intelligent and flexible power management, you can power charge your compatible device directly. Its slim, reversible USB-C allows for easy, one-cable connection. You can watch high resolution video and transfer data at a super-speed, while powering up and re-charging your compatible device at the same time.

VA display

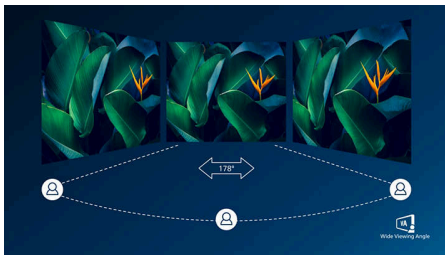

Philips VA LED display uses an advanced multi-domain vertical alignment technology which gives you super-high static contrast ratios for extra vivid and bright images. While standard office applications are handled with ease, it is especially suitable for photos, web-browsing, movies, gaming, and demanding graphical applications. Its optimized pixel management technology gives you 178/178 degree extra wide viewing angle, resulting in crisp images.

UltraWide CrystalClear images

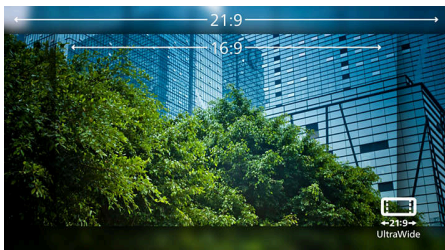

These Philips screens deliver CrystalClear, UltraWide Quad HD 3440 x 1440 pixel images. Utilizing high performance panels with high-

density pixel count, 178/178 wide viewing angles, these new displays will make your images and graphics come alive. The UltraWide 21:9 format enables more productivity with more room for side-by-side comparisons and more viewable spreadsheet columns. Whether you are demanding professional requiring extremely detailed information for CAD-CAM solutions, or a financial wizard working on huge spreadsheets, Philips displays delivers CrystalClear images.

Ultra-smooth gaming

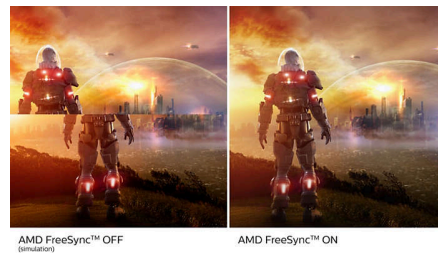

Gaming shouldn't be a choice between choppy gameplay or broken frames. With the new Philips monitor it doesn't have to be. Get fluid, artifact-free performance at virtually any framerate with AMD FreeSync™ technology, smooth quick refresh and ultra-fast response time.

1ms MPRT fast response

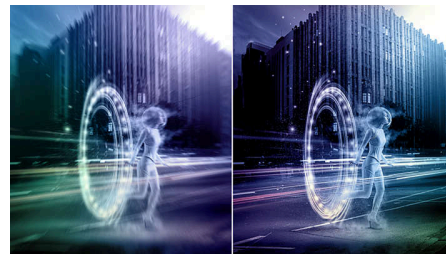

MPRT (motion picture response time) is more intuitive way to describe the response time, which directly refers the duration from seeing blurry noise to clean and crisp images. Philips monitor with 1 ms MPRT effectively eliminates smearing and motion blur, delivers sharper and precise visuals to enhance gaming experience. Best choice for playing thrilling and twitch-sensitive games.

SmartImage Game mode

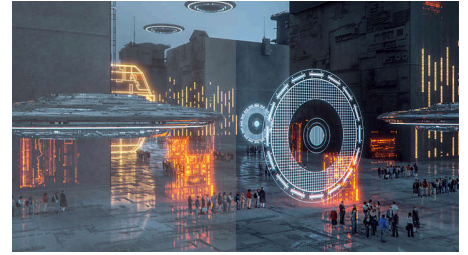

The new Philips gaming display has quick access OSD fine tuned for gamers, offering you multiple options. "FPS" mode (First person shooting) improves dark themes in games, allowing you to see hidden objects in dark areas. "Racing" mode adapts display with fastest response time, high color, along with image adjustments. "RTS" mode (Real time strategy) has a special SmartFrame mode which enables highlighting of specific area and allows for size and image adjustments. Gamer 1 and Gamer 2 enable you to save personal customized settings based on different games, ensuring best performance.

LowBlue Mode & Flicker-free



Our LowBlue Mode and Flicker-free technology have been developed to reduce eye strain and fatigue often caused by long hours in front of a monitor.



Monitor

UltraWide LCD monitor

346E2LAE/75

Highlights

MultiView technology

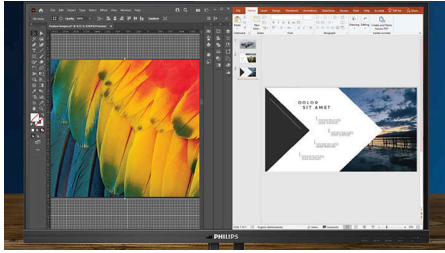

With the ultra-high resolution Philips MultiView display you can now experience a world of connectivity. MultiView enables active dual connect and view so that you can work with multiple devices like a PC and notebook simultaneously, for complex multi-tasking.

Built-in stereo speakers



A pair of high quality stereo speakers built into a display device. It can be visible front firing, or invisible down firing, top firing, rear firing, etc depending on model and design.

Cable management



Cable management is an intimate design that maintains tidy workspace by organizing cables and wires required for the operation of a display device.



LowBlue Mode

Specifications

Picture/Display

Panel Size: 34 inch / 86.36 cm
Aspect ratio: 21:9
LCD panel type: VA LCD
Backlight type: W-LED system
Pixel pitch: 0.23175 x 0.23175 mm
Brightness: 300 cd/m²
Display colors: 16.7 M (8 bit)
Color gamut (typical): NTSC 100.05%*, sRGB 121.32%*
Contrast ratio (typical): 4000:1
SmartContrast: Mega Infinity DCR
Response time (typical): 4 ms (Gray to Gray)*
Viewing angle: 178° (H) / 178° (V), @ C/R > 10
Picture enhancement: SmartImage game
Maximum resolution: 3440 x 1440 @ 100 Hz*
Effective viewing area: 797.22 (H) x 333.72 (V) mm
Scanning Frequency: 30 - 160 kHz (H) / 48 - 100 Hz (V)
 sRGB
 Flicker-free
Pixel Density: 109.68 PPI
LowBlue Mode
Display Screen Coating: Anti-Glare, 3H, Haze 25%
MPRT: 1 ms
EasyRead
AMD FreeSync™ technology

Connectivity

Signal Input: HDMI 2.0 x 1, DisplayPort 1.2 x 1, USB-C x 1 (DP Alt mode, Power delivery)
Sync Input: Separate Sync
Audio (In/Out): Audio out
HDCP: HDCP 1.4 (HDMI / DisplayPort / USB-C), HDCP 2.2 (HDMI / DisplayPort / USB-C)
USB Hub: USB 3.2 Gen 1 / 5 Gbps, USB-A downstream x 4 (with 1 fast charge B.C 1.2)

Power Delivery

Max power delivery: USB-C up to 65W (5V/3A, 7V/3A, 9V/3A, 10V/3A, 12V/3A, 15V/3A, 20V/3.25A)
Version: USB PD version 3.0

Convenience

Built-in Speakers: 3 W x 2
Plug & Play Compatibility: DDC/CI, Mac OS X, sRGB, Windows 11 / 10 / 8.1 / 8 / 7
User convenience: Power On/Off, Menu, Volume, Input, SmartImage Game

OSD Languages: Brazil Portuguese, Czech, Dutch, English, Finnish, French, German, Greek, Hungarian, Italian, Japanese, Korean, Polish, Portuguese, Russian, Simplified Chinese, Spanish, Swedish, Traditional Chinese, Turkish, Ukrainian
Other convenience: Kensington lock, VESA mount (100x100mm)
MultiView: PIP/PBP mode, 2x devices

Stand

Height adjustment: 100 mm
Tilt: -5/20 degree

Power

Power supply: External, 100-240VAC, 50-60Hz
Off mode: 0.3 W (typ.)
On mode: 35 W (typ.)
Standby mode: 0.5 W (typ.)
Power LED indicator: Operation - White, Standby mode- White (blinking)

Dimensions

Packaging in mm (WxHxD): 930 x 525 x 186 mm
Product without stand (mm): 817 x 365 x 49 mm
Product with stand(max height): 817 x 491 x 235 mm

Weight

Product with packaging (kg): 10.70 kg
Product with stand (kg): 7.36 kg
Product without stand (kg): 5.43 kg

Operating conditions

Altitude: Operation: +12,000ft (3,658m), Non-operation: +40,000ft (12,192m)
Temperature range (operation): 0 to 40 °C
MTBF: 50,000 hrs (excluding backlight) hour(s)
Relative humidity: 20%-80 %
Temperature range (storage): -20 to 60 °C

Sustainability

Environmental and energy: RoHS
Recyclable packaging material: 100 %
Specific Substances: Mercury free, PVC / BFR free housing

Compliance and standards

Regulatory Approvals: CB, TUV/ISO9241-307, TUV-BAUART, CU-EAC, EAEU RoHS, MEPS, CE Mark, FCC Class B, ICES-003, RCM

Cabinet

Color: Black
Finish: Textured



* The maximum resolution works for either HDMI input or DP input.
 * For best output performance, please always ensure that your graphic card is capable of achieving the maximum resolution and refresh rate of this Philips display.
 * Response time value equal to SmartResponse
 * MPRT is to adjust brightness for blur reduction, so cannot adjust brightness while MPRT is turned on. To reduce motion blur, LED backlight will strobe synchronously with screen refresh, which may cause noticeable brightness change.
 * MPRT is gaming-optimized mode. Turn on MPRT may cause noticeable screen flickering. It is recommended to turn off when you are not using the gaming function.
 * NTSC Area based on CIE1976
 * sRGB Area based on CIE1931
 * For USB-C power and charging function, your Notebook/device must support USB-C standard Power Delivery specifications. Please check with your Notebook user manual or manufacturer for more details.
 * For Video transmission via USB-C, your Notebook/device must support USB-C DP Alt mode
 * 2020 Advanced Micro Devices, Inc. All rights reserved. AMD, the AMD Arrow logo, AMD FreeSync™ and combinations thereof are trademarks of Advanced Micro Devices, Inc. Other product names used in this publication are for identification purposes only and may be trademarks of their respective companies.
 * The monitor may look different from feature images.