

PHILIPS

LCD monitor

Gaming Monitor

Momentum

27" (68.6 cm)

2560 x 1440 (QHD)

275M8



Get in the moment

This Quad HD Momentum monitor gets you in the moment. AMD FreeSync™ technology and 144Hz fast refresh rate give flawlessly smooth entertainment experience for playing games and watching movies. Scenes look more real with Ultra Wide-Color.

Features designed for you

- DisplayPort connection for maximum visuals
- HDMI ensures universal digital connectivity

Built for fast action

- 144Hz refresh rates for ultra-smooth, brilliant images
- AMD FreeSync™ Premium; tear free, stutter free, fluid gaming
- SmartImage game mode optimized for gamers
- 1ms (MPRT) fast response for crisp image and smooth gameplay

Superb Picture Quality

- VA display delivers awesome images with wide viewing angles
- Crystalclear images with Quad HD 2560 x 1440 pixels
- Ultra Wide-Color wider range of colors for a vivid picture

Get comfortable

- Less eye fatigue with Flicker-free technology
- LowBlue Mode for easy on-the-eyes productivity

Highlights

AMD FreeSync™ Premium

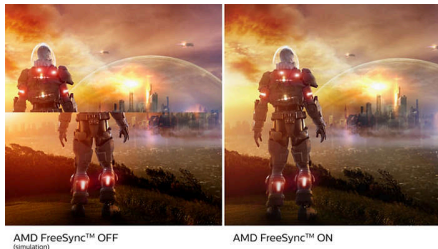

Gaming shouldn't be a choice between choppy gameplay or broken frames. AMD FreeSync™ Premium equips serious gamers with a fluid, tear-free gameplay experience at peak performance. There are no compromises, game confidently with a high refresh rate, low framerate compensation, and low latency.

144Hz Gaming

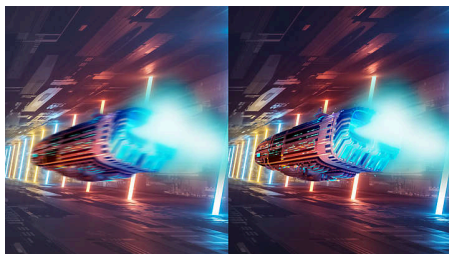

You play intense, competitive gaming. You demand display with lag free, ultra-smooth images. This Philips display redraws the screen image up-to 144 times per second, effectively 2.4x faster than a standard display. A lower frame rate can make enemies appear to jump from spot to spot on the screen, making them difficult targets to hit. With 144Hz frame rate, you get those critical missing images on the screen which shows enemy movement in ultra-smooth motion so you can easily target them. With ultra-low input lag and no screen tearing, this Philips display is your perfect gaming partner

SmartImage Game mode

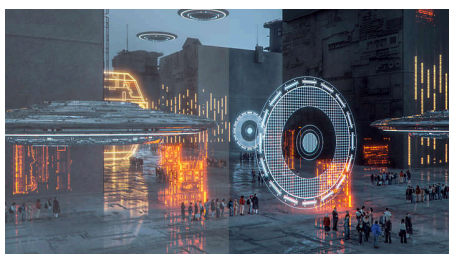

The new Philips gaming display has quick access OSD fine tuned for gamers, offering you multiple options. "FPS" mode (First person shooting)

improves dark themes in games, allowing you to see hidden objects in dark areas. "Racing" mode adapts display with fastest response time, high color, along with image adjustments. "RTS" mode (Real time strategy) has a special SmartFrame mode which enables highlighting of specific area and allows for size and image adjustments. Gamer 1 and Gamer 2 enable you to save personal customized settings based on different games, ensuring best performance.

1ms MPRT fast response

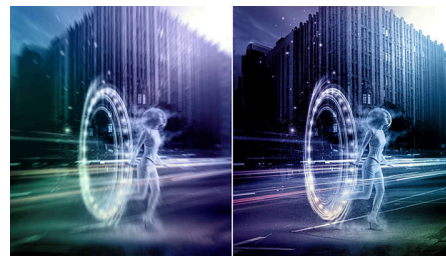

MPRT (motion picture response time) is more intuitive way to describe the response time, which directly refers the duration from seeing blurry noise to clean and crisp images. Philips gaming monitor with 1 ms MPRT effectively eliminates smearing and motion blur, delivers sharper and precise visuals to enhance gaming experience. Best choice for playing thrilling and twitch-sensitive games.

VA display



Philips VA LED display uses an advanced multi-domain vertical alignment technology which gives you super-high static contrast ratios for extra vivid and bright images. While standard office applications are handled with ease, it is especially suitable for photos, web-browsing, movies, gaming, and demanding graphical applications. It's optimized pixel management technology gives you 178/178 degree extra wide viewing angle, resulting in crisp images.

Ultra Wide-Color Technology



Ultra Wide-Color Technology delivers a wider spectrum of colors for a more brilliant picture. Ultra Wide-Color wider "color gamut" produces more natural-looking greens, vivid reds and deeper blues. Bring, media entertainment, images, and even productivity more alive and vivid colors from Ultra Wide-Color Technology.

Crystalclear images

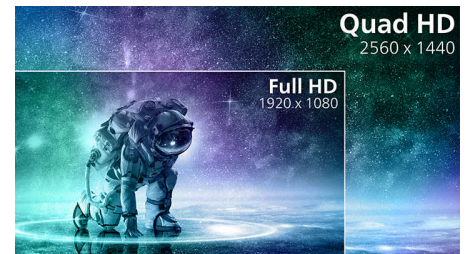

These Philips screens deliver Crystalclear, Quad HD 2560x1440 or 2560x1080 pixel images. Utilizing high performance panels with high density pixel count, enabled by high bandwidth sources, these new displays will make your images and graphics come alive. Whether you are demanding professional requiring extremely detailed information for CAD-CAM solutions, using 3D graphic applications or a financial wizard working on huge spreadsheets, Philips displays will give you Crystalclear images.

Highlights

HDMI Ready



An HDMI-ready device has all the required hardware to accept High-Definition Multimedia Interface (HDMI) input. A HDMI cable enables high-quality digital video and audio all transmitted over a single cable from a PC or any number of AV sources (including set-top boxes, DVD players, A/V receivers and video cameras).

DisplayPort connection



DisplayPort is a digital link from PC to Monitor without any conversion. With higher capabilities than DVI standard, it is fully capable to support

up to 15meter cables and 10.8 Gbps/sec data transfer. With this high performance and zero latency, you get the fastest imaging and refresh rates - making DisplayPort the best choice for not only general office or home use, but also for the demanding gaming and movies, video editing and more. It also keeps interoperability in mind via use of various adapters.

LowBlue Mode



Studies have shown that just as ultra-violet rays can cause eye damage, shortwave length blue light rays from LED displays can cause eye damage and affect vision over time. Developed for wellbeing, Philips LowBlue Mode setting uses a smart software technology to reduce harmful shortwave blue light.

Flicker-free technology

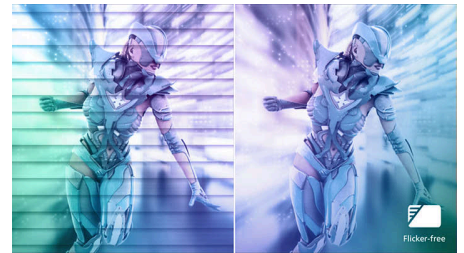

Due to the way brightness is controlled on LED-backlit screens, some users experience flicker on their screen which causes eye fatigue. Philips Flicker-free Technology applies a new solution to regulate brightness and reduce flicker for more comfortable viewing.

Specifications

Picture/Display

Panel Size: 27 inch / 68.6 cm
Aspect ratio: 16:9
LCD panel type: VA LCD
Backlight type: W-LED system
Pixel pitch: 0.233 x 0.233 mm
Optimum resolution: 2560 x 1440 @ 144 Hz
Brightness: 250 cd/m²
Display colors: 16.7 M
Color gamut (typical): NTSC 99%*, sRGB 122%*
Contrast ratio (typical): 3000:1
SmartContrast: Mega Infinity DCR
Response time (typical): 1 ms (MPRT)
Viewing angle: 178° (H) / 178° (V), @ C/R > 10
Effective viewing area: 596.7 (H) x 335.7 (V) mm
Scanning Frequency: 30 - 160 kHz (H) / 48 - 144 Hz (V)
sRGB
Flicker-free
Pixel Density: 109 PPI
LowBlue Mode
Display Screen Coating: Anti-Glare, 3H, Haze 25%
AMD FreeSync™ technology: Premium

Connectivity

Signal Input: DisplayPort x 1, HDMI x 2
Sync Input: Separate Sync, Sync on Green
Audio (In/Out): Audio out

Convenience

Plug & Play Compatibility: DDC/CI, Mac OS X, sRGB, Windows 10 / 8.1 / 8 / 7
User convenience: Power On/Off, Menu/OK, Brightness/UP, Input/Down, SmartImage game/Back
OSD Languages: Brazil Portuguese, Czech, Dutch, English, Finnish, French, German, Greek, Hungarian, Italian, Japanese, Korean, Polish, Portuguese, Russian, Spanish, Simplified Chinese, Swedish, Turkish, Traditional Chinese, Ukrainian
Other convenience: Kensington lock, VESA mount (100x100mm)

Stand

Tilt: -5/20 degree

Power

Power supply: External, 100-240VAC, 50-60Hz
Off mode: 0.3 W (typ.)
On mode: 36.9 W (typ.)
Standby mode: 0.5 W (typ.)
Power LED indicator: Operation - White, Standby mode- White (blinking)

Dimensions

Product with stand (mm): 613 x 461 x 210 mm
Packaging in mm (WxHxD): 683 x 525 x 249 mm
Product without stand (mm): 613 x 368 x 42 mm

Weight

Product with packaging (kg): 6.35 kg
Product with stand (kg): 3.95 kg
Product without stand (kg): 3.40 kg

Operating conditions

Altitude: Operation: +12,000ft (3,658m), Non-operation: +40,000ft (12,192m)
Temperature range (operation): 0°C to 40 °C
MTBF: 50,000 (Excluded backlight) hour(s)
Relative humidity: 20%-80 %
Temperature range (storage): -20°C to 60 °C

Sustainability

Environmental and energy: RoHS
Recyclable packaging material: 100 %
Specific Substances: Mercury free, PVC / BFR free housing

Compliance and standards

Regulatory Approvals: CB, CE Mark, CCC, CEL, CECF, MEPS, RCM

Cabinet

Color: Black
Finish: Textured



* Response time value equal to SmartResponse

* NTSC Area based on CIE1976

* sRGB Area based on CIE1931

* For any questions related to 144Hz performance please refer to your card vendor directly.

* 2020 Advanced Micro Devices, Inc. All rights reserved. AMD, the AMD Arrow logo, AMD FreeSync™ and combinations thereof are trademarks of Advanced Micro Devices, Inc. Other product names used in this publication are for identification purposes only and may be trademarks of their respective companies.

* The monitor may look different from feature images.