



Philips Brilliance
LED monitor with
PowerSensor

B-line

23" (58.4 cm) Full HD

Brilliance

235BL2CS

World's first PowerSensor display saves energy

Large eco-friendly Philips Business Line 235BL2 LED display with intelligent PowerSensor detects user presence and adjusts power consumption saving up to 80% of energy bills!

Sustainable Eco-friendly solution

- PowerSensor ensures lower operating costs by saving energy
- EPEAT Gold ensures lowest impact on environment
- Mercury Free eco-friendly display
- 0.1 watt Soft-Off mode

Ergonomic design

- 70mm height adjustment for ideal sitting position

Outstanding display performance

- LED technology ensures natural colors
- SmartImage: Optimized user friendly display experience

Great convenience

- Modern Touch controls
- Built in stereo audio for multimedia experience
- USB port for convenient peripheral connections

PHILIPS
sense and simplicity

Highlights

PowerSensor

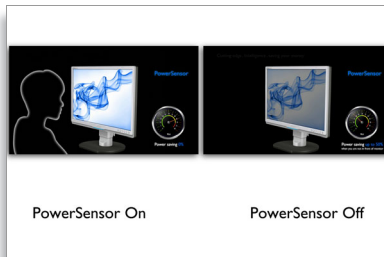

PowerSensor is a built-in 'people sensor' that transmits and receives harmless infrared signals to determine if user is present and automatically reduces monitor brightness when user steps away from the desk, cutting energy costs by up to 80 percent and prolonging monitor life.

LED technology

White LED's are solid state devices which light up to full, consistent brightness faster saving startup time. LED's are free from mercury content which allows for eco-friendly recycling and disposal process. LED's allow for better dimming control of LCD backlight, resulting in super high contrast ratio. It also gives superior color reproduction thanks to consistent brightness across the screen.

Mercury Free

Philips monitors with LED backlighting are free of Mercury content, one of the most toxic natural substances which affects humans and animals. This allows for an eco-friendly display through out its life-cycle from manufacturing to disposal.

EPEAT Gold

Philips EPEAT GOLD certified monitors ensure protection for human health and environment,

and are highly energy efficient ensuring low emissions of climate changing green house gases. EPEAT program helps purchasers evaluate, compare and select Monitors based on 51 environmental criteria supported by US EPA. GOLD certification ensures that at least 30% of plastic used is Post Consumer Resin, which ensures reduction in use of toxic and hazardous materials. EPEAT Gold is valid only where Philips registers the product. Please visit www.epeat.net for registration status in your country.

SmartImage

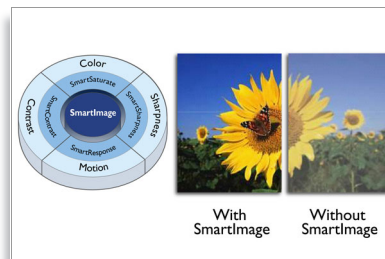

SmartImage is an exclusive leading edge Philips technology that analyzes the content displayed on your screen and gives you optimized display performance. This user friendly interface allows you to select various modes like Office, Image, Entertainment, Economy etc., to fit the application in use. Based on the selection, SmartImage dynamically optimizes the contrast, color saturation and sharpness of images and videos for ultimate display performance. The Economy mode option offers you major power savings. All in real time with the press of a single button!

USB 2.0 port

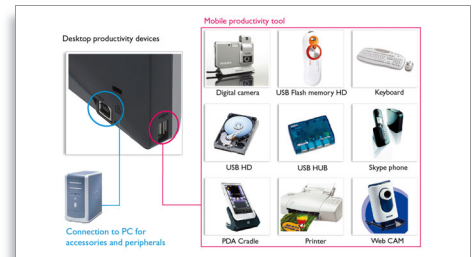

USB port allows user to conveniently connect their plug and play multimedia devices such as USB memory devices, camera, portable HDD, Web camera, PDA, Printer and many other devices which has USB connection available. The conveniently located USB 2.0 port on the monitor allows USB 2.0 signals to pass thru to the computer. Note that many devices like cameras and HDD may need to be powered On independently, as they have higher power requirements than the monitor USB port can provide

70mm height adjustment

The Super Ergo Base is a 'people friendly' Philips monitor base that not only tilts and swivels, but is also height adjustable and pivots to 90 degree, so that each user can adjust the monitor to their personal preference for maximum viewing comfort and efficiency.

Built-in stereo audio

A pair of high quality stereo speakers built into a display device. It can be visible front firing, or invisible down firing, top firing, rear firing, etc depending on model and design.



Specifications

Picture/Display

- LCD panel type: TFT-LCD
- Backlight type: W-LED system
- Panel Size: 23 inch / 58.4 cm
- Aspect ratio: 16:9
- Optimum resolution: 1920 x 1080 @ 60Hz
- Response time (typical): 5 ms
- Brightness: 250 cd/m²
- SmartContrast: 20,000,000:1
- Pixel pitch: 0.265 x 0.265 mm
- Viewing angle: 176° (H) / 170° (V), @ C/R > 5
- Picture enhancement: SmartImage
- Display colors: 16.7 M
- Scanning Frequency: 30 - 83 kHz (H) / 56 - 75 Hz (V)
- sRGB

Connectivity

- Signal Input: VGA (Analog), DVI-D (digital, HDCP)
- USB: USB 2.0 x 1
- Sync Input: Separate Sync, Sync on Green
- Audio In/Out: Stereo Audio, Earphone out (3.5 mm jack) x 1, PC audio-in

Convenience

- Built-in Audio: 1.5 W x 2
- User convenience: SmartImage, Volume, Power On/Off, PowerSensor, Menu
- OSD Languages: English, French, German, Italian, Portuguese, Russian, Simplified Chinese, Spanish
- Other convenience: Kensington lock, VESA mount (100x100mm)
- Plug & Play Compatibility: DDC/CI, Mac OS X, Windows 7/Vista/XP, sRGB

Stand

- Height adjustment: Up to 70 mm
- Swivel: -65/+65 degree
- Tilt: -5/20 degree

Power

- ECO mode: 17.74 W
- On mode: 22.47 W (EnergyStar 5.0 test method)
- Standby mode: 0.1 W
- Off mode: 0.1 W
- Power LED indicator: Operation - White, Standby mode- White (blinking)
- Power supply: Built-in, 100-240VAC, 50/60Hz

Dimensions

- Product with stand (mm): 566 x 499 x 249 mm
- Product without stand (mm): 566 x 360 x 50 mm
- Packaging in mm (WxHxD): 615 x 478 x 171 mm

Weight

- Product with stand (kg): 4.57 kg
- Product without stand (kg): 4.19 kg
- Product with packaging (kg): 6.40 kg

Operating conditions

- Temperature range (operation): 0°C to 40°C °C
- Temperature Range (storage): -20°C to 60°C °C
- Relative humidity: 20%-80 %
- MTBF: 30,000 hour(s)

Sustainability

- Environmental and energy: EPEAT Gold, RoHS, EnergyStar 5.0
- Recyclable packaging material: 100 %

Compliance and standards

- Regulatory Approvals: BSMI, CE Mark, FCC, Class B, GOST, SEMKO, TCO 5.0, TUV/GS, TUV Ergo, UL/cUL

Cabinet

- Color: Silver/Black
- Finish: Texture



Issue date 2012-09-25

Version: 2.0.1

12 NC: 8670 000 67231
EAN: 87 12581 56123 9

© 2012 Koninklijke Philips Electronics N.V.
All Rights reserved.

Specifications are subject to change without notice.
Trademarks are the property of Koninklijke Philips
Electronics N.V. or their respective owners.

www.philips.com