

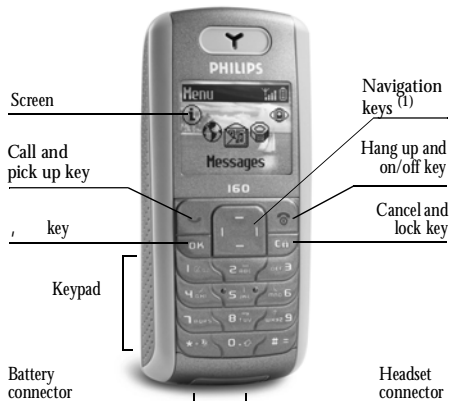

PHILIPS

Discover your phone



(1) Navigation keys will be represented in the manual by the following signs: left < /> right, up + /- down.

Philips continuously strives to improve its products. Therefore, Philips reserves the rights to revise this user guide or withdraw it at any time without prior notice. Philips provides this user guide "as is" and does not accept, except as required by applicable law, liability

for any error, omission or discrepancy between this user guide and the product described. The device is meant to be connected to GSM network.

How to...

| | |
|--|---|
| Switch phone On/Off | Press and hold) . |
| Enter PIN code | Enter your PIN code using the keypad and press , or # to confirm. |
| Make a call | Enter the phone number on the keypad and press (to dial. |
| Answer a call | Press (when your phone rings. |
| End a call | Press) . |
| Set conversation volume | Press + or - during the call. |
| Access the main menu | Press , in idle mode. |
| Change the ringer volume | Press + in idle mode. |
| Access the Contacts | Press - in idle mode. |

| | |
|--|---|
| Use the Contacts | Browse the list by moving + or - and press (to call the selected name. |
| Access the Call list | Press (in idle mode. |
| Go to previous menu | Press C . |
| Quickly return to idle when browsing menus | Press) or press and hold C . |
| Open the SMS menu | Press > in idle mode. |
| Open the Sounds menu | Press < in idle mode. |
| Lock/Unlock the keypad | Press and hold C . |

The carousel

In idle mode, press , to access the carousel menu. Each icon represents a feature or operation of your phone. Use < or > to browse the menu and press , to select a menu (or press C to cancel). Another sub-menu or list will then appear. When browsing a list (of ringers, events, etc.), long press + or - to quickly scroll through the list..

Events

Some events may modify the idle screen (missed call, new message, etc.). Press , to access the corresponding menu or long press C to go back to the idle screen.

Table of contents

| | | | |
|--|----|--|----|
| 1. Getting started | 1 | 5. Settings | 12 |
| Insert the SIM card | 1 | Sounds | 12 |
| Switch on the phone | 1 | Display | 12 |
| Set date and time | 2 | Hotkeys | 13 |
| Copy the SIM phonebook | 2 | Time and date | 13 |
| Charge the battery | 2 | Language | 13 |
| 2. Main features | 4 | Security | 14 |
| Access and view the phonebook | 4 | Network | 15 |
| Make a call | 4 | 6. Messages | 16 |
| Answer and end a call | 4 | SMS | 16 |
| Options during a call | 4 | Broadcast SMS | 18 |
| Adjust the earpiece volume | 5 | SMS chat | 18 |
| Change the ringer | 5 | 7. Multimedia | 19 |
| Activate the vibra alert | 5 | Sounds | 19 |
| 3. Text or number entry | 6 | Memory status | 19 |
| T9® Text input | 6 | 8. Games & Applications | 20 |
| Basic text input | 7 | Calculator | 20 |
| 4. Contacts | 8 | Alarm clock | 20 |
| Settings | 8 | Euro converter | 20 |
| Add contacts in a phonebook | 8 | Games | 21 |
| Fotocall: see & hear who's calling | 9 | 9. Call information | 22 |
| Edit and manage contacts | 10 | Settings | 22 |

| | |
|----------------------------------|-----------|
| Call list | 23 |
| Counters | 23 |
| 10. Operator | 24 |
| Making a second call | 24 |
| Answering a second call | 24 |
| Conference call | 24 |
| Icons & symbols | 26 |
| Precautions | 27 |

| | |
|---|----|
| Troubleshooting | 32 |
| Philips authentic accessories | 35 |
| SAR Information - EU (RTTE) | 37 |
| SAR Information - International (ICNIRP) | 38 |

1 • Getting started

Read the safety instructions in the “Precautions” section before use.

To use your phone, you must insert a valid SIM card supplied by your operator or retailer. The SIM card contains your subscription and a memory in which you can store phone numbers and messages.

Insert the SIM card

1. Press on the back cover and slide it downwards to remove it.

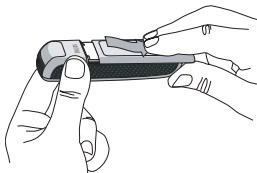

2. Place the SIM card in its slot (with the connectors facing the phone) then replace the metallic holder.



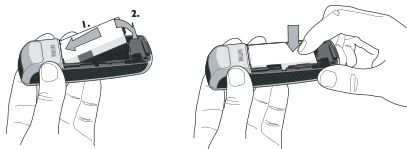

3. Insert the battery (with the connectors facing the connectors of the phone) and press until it clips.



4. Replace the back cover by sliding it back in it slot until it stops. Remove the protective film covering the screen before using the phone.

Switch on the phone

To switch on the phone, long press . Enter the PIN code if required (i.e. the 4- to 8-digit secret code of your SIM card). It is preconfigured and communicated to you by your operator or retailer. To personalise the PIN code, see “Change codes” page 14. Press  to confirm.

If you enter a incorrect PIN code 3 times, your SIM card is blocked. To unblock it, you must request the PUK code from your operator.

Set date and time

As prompted by the phone at first switch on, set the date by pressing the appropriate numeric keys (press C to erase a number), then set the time.

For complete date and time options, see page 13.

Copy the SIM phonebook

The mobile phone detects a SIM card that already contains names and a message asks you if you want to copy your SIM phonebook onto the built-in phonebook. Press C to cancel or , to accept.

If you choose not to copy the SIM phonebook at this time, you can do it manually at a later date (see page 8).

Charge the battery

Your phone is powered by a rechargeable battery. A new battery is partially charged and an alarm will warn you when the battery reaches low. If the battery is

completely flat, it will take 2 or 3 minutes of charging for its icon to reappear.

You may lose all your personal settings if you remove the battery when the phone is switched on.

1. Once the battery and battery cover are clipped on the phone, plug the connector of the charger (supplied with the phone, in the box) into the socket at the base of the phone on one end, then plug it into a main AC power socket with easy access to the other end.

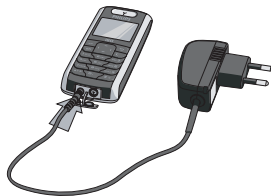

2. The battery symbol indicates the state of charge:
 - During charging the 4 charge indicators scroll; it takes around 2.30 hours to fully recharge your mobile phone.
 - When all 4 bars are steady the battery is fully charged and you can disconnect the charger. Depending on the network and condition of

use, talk time goes from 2 to 4 hours and standby time from 200 to 300 hours.

Keeping the charger plugged into the mobile when the battery is fully charged doesn't damage the battery.

The only way to turn off the charger is to unplug it, so use an easily accessible AC power socket. You can connect the charger to an IT supply (Belgium only).

2 • Main features

Access and view the phonebook

In idle mode, press **[F1]**. Depending on the selected phonebook (in SIM or in phone, see page 10), the content that appears on the screen may vary.

In the phonebook, select **<Search>**, enter the first letters of the name you are searching, and press **[F2]**, to go directly to that name.

To read your own mobile phone number, select Own numbers > Show.

Make a call

1. In idle mode, enter the phone number using the keypad. To correct an error, press **[C]**.
2. Press **[F1]** to dial the number and press **[F3]** to hang up.

*For an international call, press and hold **[*]** to enter the "+" sign instead of the usual international prefix. For details on how to handle several calls (operator-dependent), see page 24.*

Answer and end a call

When receiving a call, the number of the caller may be displayed. If the number is stored in the phonebook, the corresponding name is displayed instead of the number.

1. To answer the call, press **[F1]**.
2. To reject the call, press **[F2]**. If you have activated Call forward (see page 22), the call is diverted to a number or voice mail.
3. To hang up, press **[F3]**.

*If you have selected Any Key Answer (see page 23), you can accept a call by pressing any key (except **[F3]**).*

Options during a call

During a call, press **[F4]** to access call options. Press **[C]** to return to the in-call screen.

Names list

To view the phonebook during the call.

Mute / unmute the microphone

Allows you to mute or unmute the microphone so that the caller cannot hear you. Press **[F5]**, select **Mute** and press **[F5]** again. To unmute the microphone, press **[F5]**, select **Unmute** and press **[F5]** again.

Notepad

Allows you to note down a number. You can then store it in the phonebook, call, or send a message to this number.

Other options during a call

- SMS messages (see page 16)
- Call list (see page 23)
- End call

Adjust the earpiece volume

During a call, press + or - to increase or decrease the volume.

Change the ringer

In the main menu, select [Settings](#) > [Sounds](#) > [Ringtone](#), press , and browse the list of ringers. Select a ringer and press , to confirm.

Activate the vibra alert

To activate the vibra alert, select [Settings](#) > [Sounds](#) > [Vibra alert](#), then [On](#).

The vibra alert is automatically set to Off when you plug the charger.

3 • Text or number entry

Text can be entered in editing screens in two different ways: by using T9® predictive text input, or basic text input. Two other modes for numbers and punctuation marks are also available. Icons appearing on the screen indicate the active text mode.

T9® Text input



Tegic Euro. Pat. App.
0842463

T9® is a trademark of
Tegic Communications
Inc.

T9® predictive Text Input is an intelligent editing mode for messages including a comprehensive dictionary. It allows you to quickly enter text. Press only once on the key corresponding to each letter needed to spell a word: keystrokes input are analysed and the word suggested by T9® is displayed in the edit screen. If several words are available according to the keys used, the word you entered is highlighted: press < or > to browse the list and to choose from those proposed by the T9® built-in dictionary (see example below).

How to use it

Alphabets and symbols represented by each key are as follows:

| | | |
|---|------|--|
| 2 | to 9 | To key in letters. |
| < | or > | To browse the list of candidate words. |
| , | or 1 | To confirm entry. |
| C | | Short press to clear one entry, long press to clear all text. |
| O | | Shift from Standard, to lower, to UPPER case. |
| * | | Shift from T9® to basic mode, to numeric mode. |
| # | | Shift to symbols and punctuation mode. Press > to display other pages. |

Example: how to enter the word "home":

1. Press 4 6 6 3

The screen displays the first word of a list: [Good](#).

2. Press > to scroll and select [Home](#).

3. Press , or 1 to confirm selection of the word Home.

Basic text input

If you wish to access the basic text input, press * . This method requires multiple key presses to reach the desired character: the letter "h" is the second letter on the 4 key, so you must press it twice to enter "h".

Example: how to enter the word "home":

Press 4 , 4 (GH) 6 , 6 , 6 (MNO), 6 (MNO), 3 , 3 (DEF). Press , when the message is completed.

Letters, numbers and symbols are located on each key as follows:

| Short press | Long press |
|---------------------|------------|
| 1 space ' , ! ? " @ | 1 |
| 2 a b c 2 à â ä æ ç | 2 |
| 3 d e f 3 é è Δ Φ | 3 |
| 4 g h i 4 Γ ì | 4 |
| 5 j k l 5 Λ | 5 |
| 6 m n o 6 ñ ò ö | 6 |
| 7 p q r s 7 β Π Θ Σ | 7 |
| 8 t u v 8 ü ù | 8 |
| 9 w x y z 9 ø Ω Ξ Ψ | 9 |
| ○ Shift letter case | 0 |

4 • Contacts



This menu allows you to manage your contacts. The phone has two phonebooks for storing contacts: in the SIM card or in the phone (up to 999 names). When entering new names, they will only be added to the selected phonebook.

99 is the maximum number of names cards, provided that other features (sounds, pictures, etc.) are not using a significant amount of the phone's memory.

Settings

Contacts select

Allows you to select the phonebook to use, in **SIM card** or **In phone**. Contacts added to the selected phonebook can then be copied into the other, via the **Copy to SIM** or **Copy to phone** options.

Your mobile phone only manages one phonebook at a time and will ignore the information relative to the other one e.g. if "Smith" is present in both phonebooks and if you delete it in the phone, it remains unchanged in the SIM.

Delete all

To delete all contacts at once. This option only applies to the phonebook in phone, NOT to the SIM phonebook.

Copy to phone

If you cancelled or aborted the automatic copy of your SIM phonebook at first switch, you can do it manually with this option.

Groups settings

Allows you to manage groups, rename them and link a specific melody and picture to each group. See "Fotocall: see & hear who's calling" page 9.

Add contacts in a phonebook

Contacts will be added to the selected phonebook.

In the SIM phonebook

1. Press- when in idle mode and select **<New>**.
2. Enter the name and the number of your choice, then the type of number allocated to the name (**Phone**, **Fax** or **Data**) and press , to store this name in your phonebook.

A number is limited to 40 digits, depending on your SIM card. Entering international prefix, country &

area codes allows you to dial a number from any location.

In the phone phonebook

1. Press – when in idle mode and select <New>. Enter the first, then last name (up to 20 latin characters); one of the two fields can be empty, but not both.
2. Then select the [Number type](#). Numeric fields can hold up to 40 digits and one "+" sign and alphanumeric fields (e-mail and note) feature up to 50 latin characters. Each contact can feature a maximum of 5 numeric fields (e.g. 2 mobile numbers, 3 work numbers, an e-mail address and a text note).
3. If needed, choose the group you want this contact to belong to.

Own numbers

The [Own numbers](#) item that appears in the names list should contain your own phone number. If not, we advise that you enter your mobile number as well as any other relevant information.

Although all its fields can be empty, the Own numbers item cannot be deleted.

Emergency number

The emergency number will call the emergency services number in your country. In most cases, you can call this number even if you haven't yet entered your PIN.

In Europe the standard emergency number is 112, in the UK it is 999.

Fotocall: see & hear who's calling

This feature is only available when you select the phonebook of your phone, NOT the SIM phonebook.

This feature allows you to personalize the groups available with their own name ("Friends", "Office", etc.), a given picture and a given melody. You then link one or several names to a group: when a name in that group calls, it will appear along with the corresponding picture, and the melody defined for that group will ring.

1. Select [Contacts](#) > [Settings](#) > [Groups setting](#). Rename the group to be identified and select the [Melody](#) and the [Picture](#) to be associated to this group.
2. Back to idle, press – to access the phonebook. Select a contact you wish to link to this group,

then choose **Select group** and select the group of your choice.

Edit and manage contacts

Press **2** when in idle mode to access the **Contacts** you have stored. To search for a given name:

2 to **9** Press the key for the letter that you want to go to in the list (e.g. press **8** twice to access the letter "U"). The first record starting with this letter is selected in the list.

Or press **#** , enter the first letters of the name you are searching, and press **,** to jump directly to that name.

In the SIM card

Choose a contact of your phonebook in the SIM card and press **,** twice to access the following options:

- Call
- Send SMS
- Flash dial
- Copy to phone
- Delete
- Change

Copy to phone *will copy the content of your SIM card into your phone. Selecting this option twice will duplicate all the names.*

In the phone

Choose a contact of your phonebook in phone and press **,** to access the following options:

- Call
- Send SMS
- Change name
- Select group
- Delete
- Show

Select **Show** to access the list of numbers or fields saved for this contact. Select **<New>** to create a new field or select one of the numbers and press **,** to access a second set of options, among which are:

Make default The first number you enter becomes the default number: it appears in first position in the list and is automatically dialled when pressing the pick-up key. This option allows you to make another number default.

Copy to SIM card To copy a contact of your phone phonebook into the SIM card (it is then always updated when switching phonebooks or when using another phone).

Show To display the details of the selected field.

Change type To change or to define the field type of the selected number.

Alphanumeric fields (note and e-mail) can only be changed or deleted.

5 • Settings



This menu allows you to customise your phone and change the settings related to each available option (sounds, time and date, security, etc.).

Sounds

Ringer volume

Press + or - to select the volume of your ringer from Silent to Increasing.

This setting also applies to the messages ringer.

Ringtone

Allows you to select a ringer. The list also includes melodies you saved. Scroll through the list and wait to hear the selected melody being played.

You will not hear the melody if the volume ringer is set to Silence.

Vibra alert

Allows you to set the vibra alert On or Off when receiving a call, when you receive a message or when the alarm rings.

The vibra alert is always Off when you connect the charger or the Cigarette Lighter Adapter.

Battery alert

Allows you to switch On or Off the alert that indicates when the battery is running low.

Minute alert

Allows you to switch On or Off a beep alert that sounds every minute during a call to help you manage the duration of your call.

For alerts, the menu only allows you to set the alert sounds On or Off, NOT the alert themselves.

Key tones

Allows you to switch the key tones On or Off.

Messages ringer

Allows you to switch On or Off an alert for each time you receive a new message. When On, this option allows you to select the alert from the ringers list.

Display

Screen saver

When On, it will run a slide show in idle mode, by using the BMP or GIF file(s) you have stored in your phone and selected. Use < to select the pictures of

your choice, then press **OK** to activate the screen saver.

Backlight

Backlight is activated when receiving incoming calls or messages, browsing menus, etc. Select one of the available values.

Deactivating this function increases battery life.

Contrast

Allows you to choose from several levels of contrast.

Hotkeys

Allows you to set up a direct access to a specific function or a contact by linking it to a key.

*Hotkeys are configured by default, e.g. **6** for Silence, but you can reprogram them (keys from **2** to **9** only). The following hotkeys are locked: **1** (call voice mailbox) and ***** (dial international call). Depending on your service provider, other hotkeys may be predefined and locked.*

Select a key from **2** to **9** and press **OK**. If the key was already programmed, press **OK** and select **Change**. In the list, choose the function you wish to associate with this key and press **OK**. If you select

Flash dial, you will be asked to choose a contact in the names list.

To use the hotkeys, press and hold the programmed key while in idle mode.

Time and date

Clock display

Allows you to select **Analogue**, **Digital**, **Tiny digital** or **No clock** time formats when shown in idle mode.

Set time

Allows you to set the time by pressing the appropriate numeric keys. You can also use **+** **/** **-** to increase or decrease the time minute by minute.

Set date

Allows you to set the date by pressing the appropriate numeric keys. You can also use **+** **/** **-** to set the date.

Language

Allows you to select a language for all menu texts. Press **+** **/** **-** to select a language then **OK** to confirm.

Security

PIN protection

The PIN protection can be set [On](#) or [Off](#). When [On](#), you will be asked to enter your PIN code when switching your phone on. Depending on your SIM card, some features or options may require a PIN2 secret code, given to you by your operator.

You cannot change your PIN code if this option is [Off](#).

Change codes

Allows you to change your [PIN](#) and [PIN 2](#) codes.

If you enter an incorrect PIN2 code 3 times, your SIM card is blocked. To unblock it, request the PUK2 code from your operator or retailer. If you enter an incorrect PUK code 10 times in a row, the SIM card will be blocked and unusable. If this happens, contact your operator or retailer.

Public names

Allows you to manage a specific names list, called [Public Names](#) list, and restrict calls to this list via the [Call restriction](#) option.

This function is subscription dependent and requires a PIN2 code. This option might also apply to WAP.

[Public names](#) Allows you to create, edit and modify your [Public Names](#) list, via a PIN2 code.

[Call restriction](#) Allows you to restrict the calls to the [Public Names](#) list. In this case, you can only access the names of the [Public names](#) list, as opposed to the [Contacts](#) of the main menu.

Call barring

Network dependent. This requires a specific call barring password supplied by your operator.

Allows you to limit the use of your phone to specific calls by letting you bar different types of [Outgoing](#) and/or [Incoming](#) calls. Within each type of call, the [Status](#) option allows you to check the status on call barrings. In the settings, the [Deact. Outgoing](#) and [Deact. Incoming](#) options apply to all types of calls at once. The [Barring code](#) option allows you to change the barring code.

Auto Keypad lock

Allows you to set a delayed automatic keypad lock in idle. The keypad unlocks when receiving a call or when placing an emergency call. In idle mode, long press **C** to unlock the keypad.

Network

Register again

Provides you with a list of the networks available in the area when the **Manual** mode is selected. Select the network you want to register with and press **,**.

Preferred list

Allows you to build a network list in order of preference. Once defined, the phone will try to register on a network, according to your preferences.

6 • Messages



SMS

This menu allows you to send short messages (SMS) with sounds, animations or pictures, as well as manage the ones you receive.

Send SMS

This menu allows you to send an SMS to one or several contacts.

1. Choose from three different types of messages:

| | |
|--------------|---|
| <New> | To write a new message. |
| Last message | To edit, modify and re-send the last message. |
| Template | To select a pre-configured message. e.g. <i>Can you ring me back at this number.</i> |

2. Enter your text then press , to access the next options:

| | |
|-------------|---|
| Save | To store the current message in the Outbox menu. |
| Send | To validate the message and select the recipient(s) of the message. |
| Add sound | To attach a melody. |
| Add graphic | To attach a bitmap image or an animation. |

You can send up to 2 attachments of 2 different types together with your SMS. Animations and pictures are exclusive: if you first select an animation, then a picture, only the picture will be taken into account and vice-versa.

Some pre-defined items are supplied as standard with your mobile phone. Personal pictures and sounds cannot be sent when they are copyright protected.

3. After you select **Send**, choose a recipient in the contacts list or select <New> to add a new number.
4. Select <Add Receipt.> to add other recipient(s). When selecting a recipient in the mailing list,

you can remove it from the list or edit the number.

5. Select **Send now** to send the message.

Inbox

This menu allows you to read SMS you have received. The number indicates the number of unread message(s). When a message is displayed, press , to access the following options:

- Reply** To reply to the sender.
- Forward** To edit and forward the selected message.

Attachments cannot be forwarded.

- Delete all** To delete all the messages at once.
- Delete** To delete the selected message.
- Move to Archive** To store messages in the phone's memory. You can then consult them in **SMS > Archive**.

Moving a message to the archive list deletes it from the read SMS list.

- Call back** To call the sender of the message (operator- dependent).

Store number

To save the number of the sender.

No. extracted

To extract a number included in the message itself, if this number is included in double quotes (several numbers can be included and extracted).

Outbox

Messages you saved or messages you sent when the **Auto Save SMS** option is **On** (see page 18) are stored in this menu.

Settings

This menu allows you to customise your SMS via the following options:

- SMS center** To select your default SMS centre. **If not available on your SIM card, you must enter your SMS centre number.**

- Signature** To add a signature at the end of your message. You can edit or change the signature.

Validity
period

To select the length of time your message is to be stored in your SMS centre.

This feature is subscription dependent.

Delivery
report

When **On**, this option will inform you via SMS whether your own SMS was received or not.

This feature is subscription dependent.

Auto save

When **On**, this option will automatically save messages sent in the **Outbox** menu.

Archive

This menu allows you to consult all stored messages in the phone's memory. Select a message, then press **⏏**, to access to the following options: **Delete** the selected message, **Delete all SMS** at once, **Reply**, **Forward**, **Call back**, **Store number**, **Extract number**.

Broadcast SMS

This feature is network dependent.

This menu allows you to manage the reception of SMS broadcasts regularly transmitted to all subscribers on the network. Please contact your operator for details.

SMS chat

This menu allows you to set the **SMS chat** feature **On** or **Off**. When **On**, any SMS you receive is automatically displayed in idle mode.

Scroll down to read it, and quickly reply by pressing **⏏** twice: first to enter the editing screen, then to send your message. The phone will automatically go back to the idle screen.

*If you receive a second SMS while you are reading one, reply to the first one or press **⏏** to exit. The mobile phone will then display the second message.*

7 • Multimedia



Sounds

This menu allows you to manage and listen to the sounds stored in your mobile phone. Select a sound and press , to access the following options:

| | |
|---------------|--|
| Delete all | To delete all sounds at once. <hr/> <i>Embedded copyright protected melodies cannot be deleted.</i> <hr/> |
| Delete | To delete the selected sound. |
| Set as ringer | To set the selected sound as Ring-tone. |
| As SMS ringer | To set the selected sound as Messages ringer (see page 12). |
| Rename | To rename the selected sound. |

Memory status

This menu allows you to display the percentage of memory available in your phone. Several features share the mobile capacity: sounds, archived messages, phonebook entries, etc.

Press , to check the general memory status (in Kilobytes, KB). Press , again to access the detailed list of memory used by each feature.

If "List full" appears when saving a new item or to free memory space, you must delete an item to be able to create or add a new one.

8 • Games & Applications



Calculator

This menu provides the following operations:

| | | | |
|----------------|---------|------|----------|
| Addition | Press > | or * | once. |
| Substraction | Press < | or * | twice. |
| Multiplication | Press + | or * | 3 times. |
| Division | Press - | or * | 4 times. |
| Equals | Press , | or # | . |

A screen help reminds you which keys to use for entering operators.

Enter the figures using the keypad. Press and hold \bigcirc to get the decimal point. Calculator accuracy is to 2 decimal places and is rounded up to the higher decimal figure.

Alarm clock

This menu allows you to set the alarm clock (up to 3 alarms). Select an alarm clock and press + or -

to set it On or Off. When set to On, enter the time and press , , select the frequency (Once, Every day, On weekdays) and press , . Then select a melody in the list.

The alarm clock will ring even if you turned off your phone, and even if the Ringer volume is set to Silence. Press any key to stop the alarm ringing.

Snooze mode

This menu allows you to set the snooze mode On or Off. The setting applies to all the alarms. When the alarm rings and the snooze mode is On, press any key (except ,) to stop the ringing temporarily or wait till the ringing time is out. The alarm will ring again around 7 minutes later. To stop the alarm repetition, long press , .

The snooze mode is automatically deactivated after 9 alarm repetitions.

Euro converter

These menus allow you to convert a sum from or into Euros by entering the amount and pressing , .

The currency used for the conversion is determined by the country where you have subscribed. The Euro

converter is available upon subscription and only in countries using the Euro.

Games

Your phone is supplied with 2 games: Brick game and Snake.

Brick game

Goal: destroy the bricks by hitting them with a ball.

4 / 6 To move the racket left or right.

To throw the ball.

○ To pause/resume the game.

Snake

Goal: feed the snake without it touching the wall.

1 / 7 To move the snake up, down or left.

3 / 9 To move the snake up, down or right.

○ To pause/resume the game.

9 • Call information



Settings

This menu allows you to set all the call options (call forward, waiting, etc.).

Call forward

To divert incoming calls to your voice mailbox or to a number (whether in your [Contacts](#) or not). This applies to [Data calls](#), [Voice calls](#), and [Fax calls](#).

Before activating this option, you must enter your voice mailbox numbers (see below). This feature is subscription dependent, and different from the call transfer, which takes place when one/several calls are in progress.

[Unconditional](#) Will divert all the incoming calls.

When selecting this option, you will not receive any calls at all until you deactivate it.

[If busy](#)
[If no reply](#)
[If unreachable](#)

Allows you to choose in which circumstance you want to divert the incoming calls.

[Conditional](#)

Will divert the incoming calls in all above circumstances.

[Status](#)

Will display the status of all call forwarding.

Mailboxes

To enter your voice mailbox numbers (if not available on your SIM card).

In some cases, you might have to enter two numbers: one to listen to your mailbox, the other one to forward calls. Contact your operator for more information on this subject.

Auto redial

When this option is [On](#), if the person you are calling is busy, your phone automatically redials this number until a successful connection is made or until the maximum number of attempts is reached (10).

The time between redials increases with each attempt.

Any key answer

When this option is active, you can accept a call by pressing any key, except) (which is used to reject a call).

Call waiting

When this option is **On**, you hear a beep if someone tries to call you while already on a call. Select the **Status** option to check whether the call waiting is active or not.

This function is subscription dependent. Contact your operator.

Caller ID

To **Show** or **Hide** your identity to your correspondent. Select **Status** to check which option is active.

Call list

This menu provides you with the list of outgoing and incoming calls and call details.

Select a call and press , to check the date, time, number and call status. If the number is stored in the selected phonebook, the corresponding name is displayed.

Press , again to access the options: **Call**, **Delete** the selected call, **Delete all** to reset the call list, **Send SMS** or **Store** the number (if not already in your phonebook).

Counters

This menu allows you to handle the duration of your incoming and outgoing calls.

Options mentioned below are subscription dependent.

Total duration To display the duration of **Incoming** or **Outgoing** calls since last reset.

Reset To reset all call counters.

10 • Operator



Most items of this menu are subscription dependent and specific to operators. Consequently, the menus shown following may or may not be available. Contact your network operator for details.

The services provided may involve making a phone call or sending a SMS for which you may be charged.

Making a second call

When you are in an active call, you can dial a number (or select a contact in the phonebook) and press (). The first call is put on hold and the second number is dialled. Then press , to access the following options:

- [Switch calls](#) to toggle between calls.
- [Transfer](#) to connect the two calls. You are disconnected when the transfer is completed.
- [Conference](#) to introduce the caller into a conference call.
- [End call](#) to hang up the active line.

You can also use < and > to toggle between calls

Answering a second call

When you receive a second call while already in communication, the phone emits a beep alert and the screen displays [Call waiting](#). You can then:

Press () To answer the call (the first one is put on hold). Then press , and select:

- [Switch calls](#) to toggle between calls,
- [Conference](#) to introduce the new caller into a conference call.

Press) To reject the call.

Press, To select [End call](#) to end the current call, then answer the incoming call.

To receive a second call, you must have deactivated the Call forward [for voice calls](#) (see page 22) and activated the Call waiting (see page 23).

Conference call

A conference call allows you to speak with up to 5 callers at the same time.

1. Make a first call, then a second one .
2. Press , and select [Conference](#).
3. Repeat the process until 5 callers are connected.

4. Select **Remove party** to disconnect a caller of the conference, or select **Private call** to have a private call with this caller only (other callers are put on hold).
5. Press **)** to disconnect all calls at once.

If there is an incoming call during the conference call and there are less than 5 callers, you can accept this new call and add this member to the conference call (if 5 callers are already connected, you can answer the call, but cannot add it to the conference).

Icons & symbols

In idle mode, several symbols can be displayed simultaneously on the screen.

If the network symbol isn't displayed, the network is not currently available. You may be in a bad reception area, moving to a different location may help.



Silence - Your phone will not ring when receiving a call.



Vibra - Your phone will vibrate when receiving a call.



SMS message - You have received a new message.



Voice mail - You have received a new voice mail.



Battery - The bars indicate the battery level (4 bars = full, 1 bar = low).



Alarm clock activated.



Keypad lock activated.



Roaming - Displayed when your phone is registered to a network other than your own (especially when you're abroad).



SMS full - Memory for messages is full. Delete old messages to receive new ones.



Call Forward Unconditional to number - All your incoming voice calls are being forwarded to a number other than voice mail.



Call Forward to voice mailbox - All your calls are being forwarded to voice mail.



Home zone - A zone designated by your network operator. Subscription dependent, contact your service provider for details.



GSM Network: your phone is connected to a GSM network
Reception quality: the more bars are shown the better the reception is.



SMS Chat - option is set to **On**.



Memory full - The phone's memory is full. Delete items to store new ones.

Precautions

Radio waves



Your cellular mobile phone is a **low power radio transmitter and receiver**. When it is operating, it sends and receives radio waves. The radio waves carry your voice or data signal to a base station that is connected to the telephone network. The network controls the power at which the phone transmits.

- Your phone transmits/receives radio waves in the GSM frequency (900 /1800MHz).
- The GSM network controls transmission power (0.01 to 2 watts).
- Your phone complies with all relevant safety standards.
- The CE mark on your phone shows compliancy with European electromagnetic compatibility (Ref. 89/336/EEC) and low voltage directives (Ref. 73/23/EEC).

Your cellular mobile phone is your **responsibility**. To avoid damage to yourself, to others or to the phone itself, read and follow all the safety instructions and make them known to anyone borrowing your phone.

Furthermore to prevent unauthorised use of your phone:



Keep your phone in a safe place and keep it out of small children's reach.
Avoid writing down your PIN code. Try to remember it instead.

Switch off the phone and remove the battery if you are going to leave it unused for a long time.
Use the **Security** menu to change the PIN code after purchasing the phone and to activate call restriction options.



The design of your phone complies with all applicable laws and regulations. However your phone may cause interference with other electronic devices. Consequently you should follow all **local recommendations and regulations** when using your cellular phone both at home and when away. **Regulations on the use of cellular phones in vehicles and aircraft are particularly stringent.**

Public concern has been focused for some time on the possible health risks for users of cellular phones. The current research on radio wave technology, including the GSM technology, has been reviewed and safety standards have been drawn up to ensure protection

from exposure to radio wave energy. Your cellular telephone **complies with all applicable safety standards** and the Radio Equipment and Telecommunications Terminal Equipment Directive 1999/5/EC.

Always switch off your phone

Inadequately protected or **sensitive electronic equipment** may be affected by radio energy. This interference can lead to accidents.



Before boarding an **aircraft** and/or when packing the phone in your luggage: the use of mobile phones in an aircraft may be dangerous for the operation of the aircraft, disrupt the mobile phones network and may be illegal.



In **hospitals**, clinics, other health care centres and anywhere else where you may be in the close vicinity of **medical equipment**.



In areas with a potentially **explosive atmosphere** (e.g. petrol stations and also areas where the air contains dust particles, such as metal powders).

In a vehicle transporting flammable products (even if the vehicle is parked) or a vehicle powered by liquefied petroleum gas (LPG), check first that the vehicle complies with the applicable safety rules.

In areas where you are requested to turn off radio transmitting devices, such as quarries or other areas where blasting operations are in progress.



Check with the vehicle manufacturer that **electronic equipment** used in your vehicle will not be affected by radio energy.

Users of pacemakers

If you are a user of a **pacemaker**:

- Always keep the phone more than 15 cm from your pacemaker when the phone is switched on, in order to avoid potential interference.
- Do not carry the phone in a breastpocket.
- Use the ear opposite to the pacemaker to minimise the potential interference.
- Switch off your phone if you suspect that interference is taking place.

Users of hearing aids

If you are a user of a **hearing aid**, consult your physician and hearing aid manufacturer to learn whether your particular device is susceptible to cellular phone interference.

Performance improvement

In order to **improve the performance of your phone**, reduce radio energy emission, **reduce battery consumption and ensure safe operation adhere to the following guidelines:**



For the optimal and satisfactory operation of the phone you are recommended to use the phone in the normal operating position (when not using in hands-free mode or with a hands-free accessory).

- Do not expose your phone to extreme temperatures.
- Treat the phone with care. Any misuse will void the International Guarantee.
- Do not immerse the phone in any liquid; if your phone is damp, switch it off, remove the battery and let them dry for 24hrs before using them again.

- To clean the phone, wipe it with a soft cloth.
- Placing and receiving calls consumes the same amount of battery energy. However, the mobile consumes less energy in idle screen when kept in the same place. When in idle screen and while you are moving, your phone consumes energy to transmit updated location information to the network. Setting the backlight for a shorter period of time as well as avoiding unnecessary navigating in the menus will also help to save the battery's energy for longer phoning and stand-by performances.

Information displayed on the battery

- Your phone is powered by a rechargeable battery.
- Use specified charger only.
- Do not incinerate.
- Do not deform or open the battery.
- Do not allow metal objects (such as keys in your pocket) to short circuit the battery contacts.
- Avoid exposure to excessive heat (>60°C or 140°F), moisture or caustic environments.



You should only use Philips Authentic Accessories, as the use of any other accessories may damage your phone and will make all guarantees for your Philips phone null and void. Make sure damaged parts are replaced immediately by a qualified technician and that they are replaced with genuine Philips replacement parts.

Do not use your phone while driving



It lowers concentration, which can be dangerous. Adhere to the following guidelines: Give your full attention to driving. Pull off the road and park before using the phone. Respect the local regulations in countries where you drive and use your GSM phone. If you want to use your phone in a vehicle, install the hands-free car kit which is designed for that purpose, still ensuring you give full attention to driving. Ensure that your phone and car kit do not block any air bags or other security devices fitted in your car. The use of an alarm system to operate a vehicle's light or horn to indicate incoming phone calls is prohibited on public roads in some countries. Check local regulations.

EN 60950 Norm

In case of hot weather or after a prolonged exposure to the sun (e.g. behind a window or a windscreen), the temperature of your phone's casing might increase, especially when featuring a metallic finish. Be very careful in this case when picking up your phone and also avoid using it with an ambient temperature over 40°C.

Environmental care



Remember to observe the local regulations regarding the disposal of your packaging materials, exhausted batteries and old phone and please promote their recycling.

Philips has marked the battery and packaging with standard symbols designed to promote the recycling and appropriate disposal of your eventual waste.



The battery should not be disposed of with general household waste.



The labelled packaging material is recyclable.



A financial contribution has been made to the associated national packaging recovery and recycling system (*e.g.* EcoEmballage in France).



The plastic material is recyclable (also identifies the type of plastic).

Troubleshooting

The phone does not switch on

Remove and reinstall the battery (see page 1). Make sure you plugged the jack of the charger into the correct connector (see page 2). Then charge the phone until the battery icon has stopped scrolling. Finally, unplug from the charger and try to switch the mobile on.

The display shows **BLOCKED** when you switch on

Somebody tried to use your phone but didn't know the PIN code nor the unblocking code (PUK). Contact your service provider.

The display shows **IMSI failure**

This problem is related to your subscription. Contact your operator.

The  symbol is not displayed

The network connection is lost. Either you are in a radio shadow (in a tunnel or between tall buildings) or you are outside the network coverage area. Try from another place, try to reconnect to the network (especially when abroad), check that the antenna is in place if your mobile has an external antenna, or contact your network operator for assistance/information about the network.

The display doesn't respond (or the display responds slowly) to key presses

The display responds more slowly at very low temperatures. This is normal and does not affect the operation of the phone. Take the phone to a warmer place and try again.

In other cases please contact your phone supplier.

Your phone doesn't return to the idle screen

Press and hold **C** or switch off the phone, check that the SIM card and the battery are installed correctly and switch it on again.

Your phone doesn't display the phone numbers of incoming calls

This feature is network and subscription dependent. If the network doesn't send the caller's number, the phone will display **Call 1** or **Withheld** instead. Contact your operator for detailed information on this subject.

You can't send text messages

Some networks don't allow message exchanges with other networks. First check that you entered the number of your SMS centre, or contact your operator for detailed information on this subject.

You can't receive and/or store BMP or GIF pictures

A picture may not be accepted by your mobile phone if it is too large, if its name is too long, or if it doesn't have the correct file format.

During battery charge, the battery icon shows no bar and the outline is flashing

Only charge the battery in an environment where the temperature does not go below 0°C (32°F) or above 50°C (113°F). In other cases please contact your phone supplier.

The display shows SIM failure

Check that the SIM card has been inserted in the right position (see page 1). If the problem remains, your SIM card may be damaged. Contact your operator.

You have the feeling that you miss some calls

To receive all calls, make sure that none of the features "Conditional call forward" or "unconditional call forward" is activated (see page 22).

When attempting to use a feature in the menu, the mobile displays
NOT ALLOWED

The display shows
INSERT YOUR SIM CARD

The autonomy of your phone seems lower than indicated in the user guide

Some features are network dependent. They are only available, therefore, if the network or your subscription supports them. Contact your operator for detailed information on this subject.

Check that the SIM card has been inserted in the right position (see page 1). If the problem remains, your SIM card might be damaged. Contact your operator.

The autonomy is linked to your settings (e.g. ringer volume, backlight duration) and the features you use. To increase the autonomy, and whenever possible, you must deactivate features you do not use.

Your phone doesn't work well in your car

A car contains many metallic parts that absorb electromagnetic waves which can affect the phone's performances. A car kit is available to provide you with an external antenna and enables you to make and receive phone calls without handling the handset. Check with local authorities if you are allowed to use the phone whilst driving.

Your phone is not charging

Make sure you plugged the jack of the charger into the correct connector (see "Charge the battery" page 2). If your battery is completely flat, it might take several minutes of pre-charge (up to 5 in some cases) before the charging icon is displayed on the screen.

Philips authentic accessories

Some accessories, such as a battery and a charger are included as standard in the package of your mobile phone. Other accessories might be sold in the commercial package (according to the operator or the retailer), or sold separately. As a consequence, the package content may vary.

To maximise the performance of your Philips phone and not to void the warranty, always purchase Philips Authentic Accessories that are specially designed for use with your phone. Philips Consumer Electronics cannot be held liable for any damage due to use with non authorised accessories.

Charger

Charges your battery in any AC outlet. Small enough to carry in a briefcase/handbag.

Cigarette light adapter

Charges the battery and plugs into any vehicle power outlet.

Universal car kit

Designed to operate your Philips mobile phone hands-free and easy to use, this compact hands-free solution offers a high audio quality. Simply plug the kit into the vehicle auxiliary outlet.

In certain countries, telephoning whilst driving is prohibited. For safe and trouble free installation, we recommend that specialized technicians install hands-free car kits.

Deluxe headset

In-line answer button offers you a simplified alternative to searching for the phone. Simply answer an incoming call by pressing the button.

SAR Information - EU (RTTE)

THIS MODEL PHONE MEETS THE EU REQUIREMENTS FOR EXPOSURE TO RADIO WAVES

Your mobile phone is a radio transmitter and receiver. It is designed and manufactured not to exceed the limits for exposure to radio frequency (RF) energy recommended by the Council of the European Union. These limits are part of comprehensive guidelines and establish permitted levels of RF energy for the general population. The guidelines were developed by independent scientific organisations through periodic and thorough evaluation of scientific studies. The limits include a substantial safety margin designed to assure the safety of all persons, regardless of age and health.

The exposure standard for mobile phones employs a unit of measurement known as the Specific Absorption Rate, or SAR. The SAR limit recommended by the Council of the European Union is 2.0 W/kg. Tests for SAR have been conducted using standard operating positions with the phone transmitting at its highest certified power level in all tested frequency bands. Although the SAR is determined at the highest certified power level, the actual SAR level of the phone while operating can be well below the maximum value. This is because the phone is designed to operate at multiple power levels so as to use only the power required to reach the network. In general, the closer you are to a base station antenna, the lower the power output.

Before a phone model is available for sale to the public, compliance with the European RTTE directive must be shown. This directive includes as one essential requirement the protection of the health and the safety for the user and any other person.

The highest SAR value for this Philips 160 / CT 1608 model phone when tested for compliance against the standard was 0.567 W/kg. While there may be differences between the SAR levels of various phones and at various positions, they all meet the EU requirements for RF exposure.

SAR Information - International (ICNIRP)

THIS MOBILE PHONE MEETS INTERNATIONAL REQUIREMENTS FOR EXPOSURE TO RADIO WAVES

Your mobile phone is a radio transmitter and receiver. It is designed and manufactured not to exceed the limits for exposure to radio frequency (RF) recommended by international guidelines (ICNIRP). These limits are part of comprehensive guidelines and establish permitted levels of RF energy for the general population. The guidelines were developed by independent scientific organisations through periodic and thorough evaluation of scientific studies. The guidelines include a substantial safety margin designed to assure the safety of all persons, regardless of age and health.

The exposure standard for mobile phones employs a unit of measurement known as the Specific Absorption Rate, or SAR. The SAR limit stated in the international guidelines is 2.0 W/kg. Tests for SAR are conducted using standard operating positions with the phone transmitting at its highest certified power level in all tested frequency bands. Although the SAR is determined at the highest certified power level, the actual SAR of the phone while operating can be well below the maximum value. This is because the phone is designed to operate at multiple power levels so as to use only the power required to reach the network. In general, the closer you are to a base station, the lower the power output of the phone.

The highest SAR value for this Philips 160 / CT 1608 model phone when tested for use at the ear is 0.567 W/kg. While there may be differences between the SAR levels of various phones and at various positions, they all meet the relevant international guidelines for RF exposure.

Declaration of conformity

We,

Philips France - Mobile Telephony
4 rue du Port aux Vins - Les patios
92156 Suresnes Cedex
FRANCE

declare under our sole responsibility that the product

Philips 160

CT 1608

Cellular Mobile Radio GSM 900/GSM 1800

TAC: 355310 00

to which this declaration relates, is in conformity with the following Standards:

EN 60950, EN 50360 and EN 301 489-07

EN 301 511 v 9.0.2

We hereby declare that all essential radio test suites have been carried out and that the above named product is in conformity to all the essential requirements of Directive 1999/5/EC.

The conformity assessment procedure referred to in Article 10 and detailed in Annex V of Directive 1999/5/EC has been followed related to articles 3.1 and 3.2 with the involvement of the following Notified Body: BABT, Claremont House, 34 Molesey Road, Walton-on-Thames, KT12 4RQ, UK

Identification mark: **0168**

Le Mans, 28 June, 2005

Jean-Omer Kifouani
Quality Manager

In case your Philips product is not working correctly or is defective, please return your phone to the place of purchase or to the Philips National Service Center. Refer to the International Guarantee shipped in the box for information on Service centers and technical documentation relevant to your equipment.
