

Philips LED  
4K UHD Android TV

### 3-sided Ambilight TV

Major HDR formats supported  
Dolby Vision and Dolby Atmos  
164 cm (65") Android TV



65PUS7906

## Vibrant picture. Smooth motion. Magical light

### 4K UHD HDR Android TV

The action leaps from the screen with this Philips 4K Android TV. HDR content looks great, and Ambilight makes movies, shows, and games feel bigger and more immersive. Dolby Atmos gives you premium sound to match the brilliant picture.

#### Smooth motion. Great color and depth.

- Cinematic vision and sound. Dolby Vision and Dolby Atmos

#### Looks great off or on

- The one with magical Ambilight. Only from Philips.
- Vibrant HDR picture. Philips 4K UHD TV.
- Grey bezel. Slender feet.
- Slim, attractive design

#### Content at your command.

- Simply smart. Android TV.
- Google Assistant. Control the TV with your voice.

# PHILIPS

## 4K UHD Android TV

3-sided Ambilight TV Major HDR formats supported, Dolby Vision and Dolby Atmos, 164 cm (65") Android TV

# Highlights

### 3-sided Ambilight

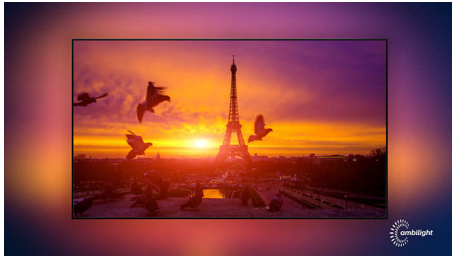

With Philips Ambilight every moment feels closer. Intelligent LEDs around the edge of the TV respond to the on-screen action and emit an immersive glow that's simply captivating. Experience it once and wonder how you enjoyed TV without it.

### Dolby Vision + Dolby Atmos

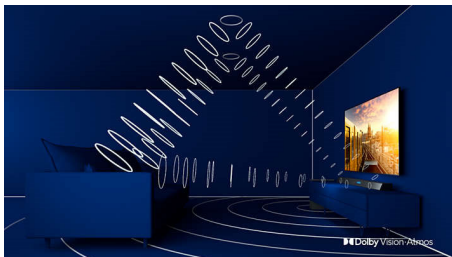

Support for Dolby's premium sound and video formats means the HDR content you watch will look-and sound-glorious. You'll enjoy a picture that reflects the director's original intentions and experience spacious sound with real clarity and depth.

### Simply smart. Android TV



Your Philips Android TV gives you the content you want-when you want it. You can customize the home screen to display your favorite apps, making it simple to start streaming the movies and shows you love. Or pick up where you left off.

### Supports all major HDR formats

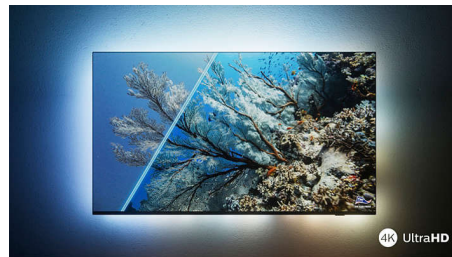

Your Philips 4K UHD TV is compatible with all major HDR formats, including Dolby Vision. Whether it's a must-watch series or the latest video game, shadows will be deeper. Bright surfaces will shine. Colors will be truer.

65PUS7906/73

### Slim, attractive design

Looking for a TV that fits with your room? This 4K smart TV is dressed for the occasion! The virtually bezel-free screen goes with just about any interior scheme. While the slim feet make it seem as if the screen is floating above your TV unit or table.

### Grey bezel. Slender feet.

Grey bezel. Slender feet.

### Google Assistant

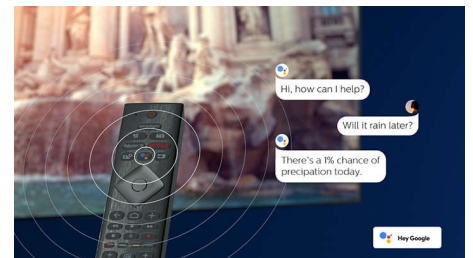

Control your Philips Android TV with your voice. Want to play a game, watch Netflix, or find content and apps in the Google Play store? Just tell your TV. You can even command all Google Assistant-compatible smart home devices-like dimming the lights and setting the thermostat on movie night. Without leaving the sofa.



Dolby Vision Atmos

androidtv



## 4K UHD Android TV

3-sided Ambilight TV Major HDR formats supported, Dolby Vision and Dolby Atmos, 164 cm (65") Android TV

# Specifications

### Ambilight

- Ambilight Features: Game Mode, Lounge mode, Wall colour adaptive
- Ambilight Version: 3-sided

### Picture/Display

- Aspect ratio: 16:9
- Display: 4K Ultra HD LED
- Panel resolution: 3840x2160
- Picture engine: Pixel Precise Ultra HD
- Picture enhancement: Ultra Resolution, Dolby Vision, HLG (Hybrid Log Gamma), HDR10+ compatible

### Supported Display Resolution

- Computer inputs on all HDMI: up to 4K UHD 3840x2160 @60Hz, HDR supported, HDR10/HLG
- Video inputs on all HDMI: up to 4K UHD 3840x2160@60Hz, HDR supported, HDR10/HLG (Hybrid Log Gamma), HDR10+/Dolby Vision

### Tuner/Reception/Transmission

- Digital TV: DVB-T/T2/T2-HD/C/S/S2
- Video Playback: PAL, SECAM
- MPEG Support: MPEG2, MPEG4
- TV Program guide\*: 8 day Electronic Program Guide
- Signal strength indication
- HEVC support

### Android TV

- OS: Android TV™ 10 (Q)
- Pre-installed apps: Amazon Prime Video, Netflix, YouTube
- Memory size(Flash): 8GB

### Smart TV Features

- User Interaction: SimplyShare, Screen mirroring
- SmartTV apps\*: Online video stores, Open internet browser, Youtube, Netflix TV
- Ease of Use: One-stop smart menu button, Onscreen usermanual
- Firmware upgradeable: Firmware auto upgrade wizard, Firmware upgradeable via USB, Online firmware upgrade, App upgrade in background
- Screen Format Adjustments: Advance - Shift, Basic - Fill Screen, Fit to screen, Zoom, stretch, Wide screen
- Voice assistant\*: Google Assistant built-in

### Multimedia Applications

- Video Playback Formats: Containers: AVI, MKV, H264/MPEG-4 AVC, MPEG-1, MPEG-2, MPEG-4, HEVC (H.265), VP9, AV1
- Music Playback Formats: AAC, MP3, WAV, WMA (v2 up to v9.2), WMA-PRO (v9 and v10)
- Subtitles Formats Support: .SML, .SRT, .SUB, .TXT, .ASS, .SSA
- Picture Playback Formats: JPEG, BMP, GIF, PNG, HEIF

### Processing

- Processing Power: Quad Core

### Sound

- Output power (RMS): 20W
- Speaker configuration: 2x10W full range speaker
- Sound Enhancement: 5 Band Equalizer, Clear Dialogue, Dolby Atmos, Auto Volume Leveler, Dolby Bass Enhancement

### Connectivity

- Number of HDMI connections: 4
- HDMI features: Audio Return Channel, 4K
- EasyLink (HDMI-CEC): Remote control pass-through, System audio control, System standby, One touch play
- Number of USBs: 2
- Wireless connection: Wi-Fi 802.11n, 2x2, Dual band, Bluetooth 5.0
- Other connections: Digital audio out (optical), Ethernet-LAN RJ-45, Headphone out, Satellite Connector
- HDCP 2.3: Yes on all HDMI
- HDMI ARC: Yes on HDMI1

### Power

- Mains power: AC 220 - 240 V 50/60Hz
- Ambient temperature: 5 °C to 35 °C
- Standby power consumption: <0.5W
- Power Saving Features: Auto switch-off timer, Picture mute (for radio), Eco mode, Light sensor

### Accessories

- Included accessories: Remote Control, 2 x AAA Batteries, Power cord, Quick start guide, Legal and safety brochure, Table top stand

### Dimensions

- Set Width: 1450.5 mm

65PUS7906/73

- Set Height: 833.5 mm
- Set Depth: 85.1 mm
- Product weight: 21.3 kg
- Set width (with stand): 1450.5 mm
- Set height (with stand): 860.5 mm
- Set depth (with stand): 293.2 mm
- Product weight (+stand): 21.5 kg
- Box width: 1600.0 mm
- Box height: 995.0 mm
- Box depth: 170.0 mm
- Weight incl. Packaging: 28.4 kg
- Wall mount compatible: 300 x 300 mm

## Connections

### Side



### Bottom

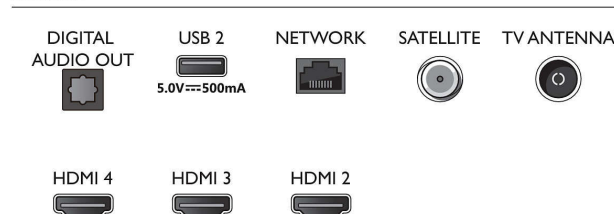

Issue date 2023-07-23

Version: 3.0.1

EAN: 87 18863 03176 6

© 2023 Koninklijke Philips N.V.  
All Rights reserved.

Specifications are subject to change without notice.  
Trademarks are the property of Koninklijke Philips N.V.  
or their respective owners.

[www.philips.com](http://www.philips.com)

\* EPG and actual visibility (up to 8 days) is country and operator dependent.

\* The TV supports DVB reception for 'Free to air' broadcast. Specific DVB operators may not be supported. An up to date list can be found in the FAQ section of the Philips support website. For some operators Conditional Access and subscription are required. Contact your operator for more information.

\* Smart TV app offerings vary per TV model and country. For more details please visit: [www.philips.com/smarttv](http://www.philips.com/smarttv).

\* Google Assistant is available on Philips Android TVs running on Android O (8) or higher OS version. GA is available in selected languages and countries with English-UK and German-DE and French-FR being supported from the start. Supported language/countries list is going to be expanded overtime.

\* Image depicted on the website are non-contractual pictures. Please always refer to the actual TV that are sold in the retail or stores.