

Philips 8200 series
4K UHD LED Android TV

189 cm (75")
Major HDR formats supported
P5 Perfect Picture Engine



75PUT8265

4K UHD LED Android TV

with Ambilight 3-sided

Family movie night. The big game. Whatever the occasion, settle down to superb picture quality and great sound. This TV makes all your content look great.

Slim TV. Beautiful light.

- Philips 4K UHD TV. Vibrant HDR picture.
- The magic of Ambilight. Only from Philips.

Android TV-content at your command

- Google Assistant. Control the TV with your voice.
- Android TV. Simply smart.
- Voice control. Google Assistant built-in. Works with Alexa.
- DTS Play-Fi. Multi-room audio.

Smooth motion. Real color. Incredible depth.

- Philips P5 Engine. Whatever the source, always perfection.
- Dolby Vision and Dolby Atmos. Cinematic vision and sound.
- Stand height adjusts to accommodate a soundbar.

PHILIPS

Highlights

4K UHD HDR



Your Philips 4K UHD TV is compatible with all major HDR formats, including HDR10+ and Dolby Vision. Whether it's a must-watch series or the latest video game, shadows will be deeper. Bright surfaces will shine. Colors will be truer.

P5 Perfect Picture Engine

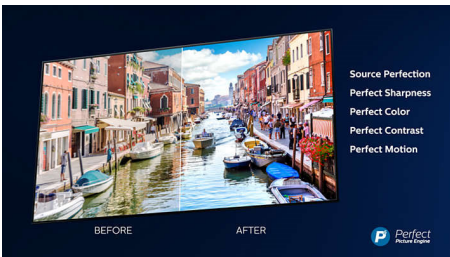

The Philips P5 engine delivers a picture as brilliant as the content you love. Details have noticeably more depth. Colors are vivid, while skin tones look natural. Contrast is so crisp you'll feel every detail. Motion is perfectly smooth.

Dolby Vision and Dolby Atmos

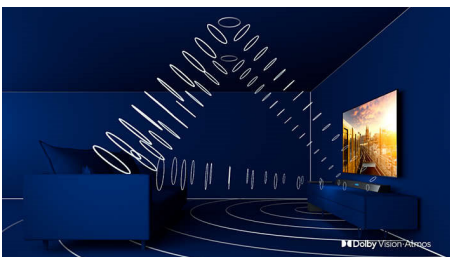

Support for Dolby's premium sound and video formats means the HDR content you watch will look-and sound-gloriously real. Whether it's the latest streaming series or a Blu-Ray disc set, you'll enjoy contrast, brightness, and color that reflect the director's original intentions.

And hear spacious sound with clarity, detail, and depth.

Android TV

Make your Philips Android TV your own. If it's all about Amazon and YouTube this week, and Netflix next week-no problem. A clear, intuitive interface lets you put the content you love front and center. Easily pick up where you left off in the latest series, or check out the new movie releases.

Voice assistant

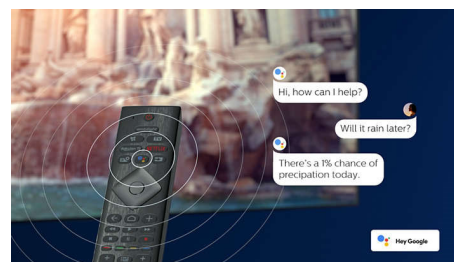

Control your Philips Android TV with your voice. Want to play a game, watch Netflix, or find content and apps in the Google Play store? Just tell your TV. You can even command all Google Assistant-compatible smart home devices, like dimming the lights and setting the thermostat on movie night. Without leaving the sofa. The days of searching for the TV remote are over. Now you can use your voice to control your Philips smart TV via Alexa-enabled devices, like Amazon Echo. Turn your TV on, change the channel, switch to your gaming console and more with Alexa.

Google Assistant

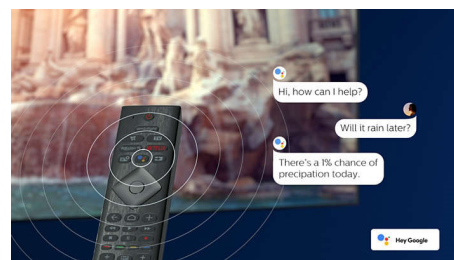

Control your Philips Android TV with your voice. Want to play a game, watch Netflix, or find content and apps in the Google Play store?

Just tell your TV. You can even command all Google Assistant-compatible smart home devices-like dimming the lights and setting the thermostat on movie night. Without leaving the sofa.

Ambilight 3-sided

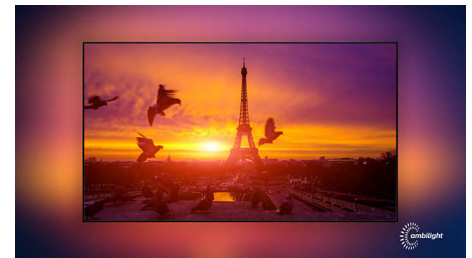

With Philips Ambilight every moment feels closer. Intelligent LEDs around the edge of the TV respond to the on-screen action and emit an immersive glow that's simply captivating. Experience it once and wonder how you enjoyed TV without it.

TV and soundbar

Stand height adjusts to accommodate a soundbar.

DTS Play-Fi

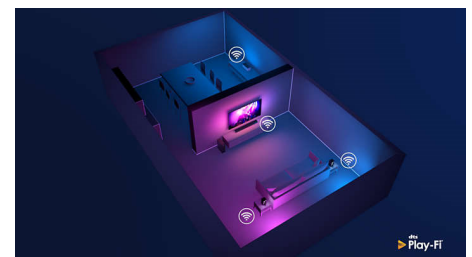

With DTS Play-Fi on your Philips TV you can connect to compatible speakers in any room. Got wireless speakers in the kitchen? Listen to the movie while you make a snack, or keep up with the sports commentary while you get everyone a drink.

Specifications

Ambilight

- Ambilight Features: Ambilight Music, AmbiSleep, AmbiWakeup, Built in Ambilight+hue, Game Mode, Lounge mode, Wall colour adaptive
- Ambilight Version: 3-sided

Picture/Display

- Aspect ratio: 16:9
- Display: 4K Ultra HD LED
- Picture enhancement: Ultra Resolution, Micro Dimming Pro
- Panel resolution: 3840x2160
- Picture engine: P5 Perfect Picture Engine

Supported Display Resolution

- Computer inputs on all HDMI: HDR supported, HDR10/ HLG, up to 4K UHD 3840x2160 @60Hz
- Video inputs on all HDMI: up to 4K UHD 3840x2160@60Hz, HDR10/HLG (Hybrid Log Gamma), HDR10+/Dolby Vision

Tuner/Reception/Transmission

- Digital TV: DVB-T/T2
- Video Playback: NTSC, PAL, SECAM
- MPEG Support: MPEG2, MPEG4
- TV Program guide*: 8 day Electronic Program Guide
- Signal strength indication
- HEVC support

Android TV

- OS: Android TV™ 9 (Pie)
- Pre-installed apps: Google Play Movies*, Google Play Music*, Google Search, YouTube, Netflix, Amazon Prime Video
- Memory size(Flash): 16GB*

Smart TV

- SmartTV apps*: Netflix, YouTube

Smart TV Features

- Voice assistant*: Google Assistant built-in, RC with Mic., Works with Alexa

Multimedia Applications

- Video Playback Formats: Containers: AVI, MKV, H264/MPEG-4 AVC, MPEG-1, MPEG-2, MPEG-4, WMV9/VC1, VP9, HEVC (H.265)
- Music Playback Formats: AAC, MP3, WAV, WMA (v2 up to v9.2), WMA-PRO (v9 and v10)
- Subtitles Formats Support: .SRT, .SUB, .TXT, .SMI
- Picture Playback Formats: JPEG, BMP, GIF, PNG,

360 photo, HEIF

Processing

- Processing Power: Quad Core

Sound

- Output power (RMS): 35W
- Sound Enhancement: Clear Sound, Smart Sound, Auto Volume Leveler, Dolby Atmos
- Speaker configuration: 10Wx2 +15W Woofer

Connectivity

- Number of HDMI connections: 4
- HDMI features: 4K, Audio Return Channel
- EasyLink (HDMI-CEC): Remote control pass-through, System audio control, System standby, One touch play
- Number of USBs: 2
- Wireless connection: Bluetooth 4.2, Wi-Fi 802.11ac, 2x2, Dual band
- Other connections: Ethernet-LAN RJ-45, Headphone out, Digital audio out (optical), Antenna IEC75
- HDCP 2.3: Yes on all HDMI

Power

- Mains power: AC 220 V~ 50/60Hz
- Ambient temperature: 5 °C to 35 °C
- Power Saving Features: Auto switch-off timer, Light sensor, Picture mute (for radio)

Accessories

- Included accessories: Quick start guide, Legal and safety brochure, Power cord, Table top stand, Remote Control
- Included batteries: 2 x AAA Batteries

Dimensions

- Box depth: 200 mm
- Product weight: 35 kg
- Set Width: 1683 mm
- Set width (with stand): 1683 mm
- Wall mount compatible: 600 x 400 mm
- Box height: 1116 mm
- Box width: 1899 mm
- Set Height: 974 mm
- Weight incl. Packaging: 46 kg
- Set Depth: 111.3 mm
- Set height (with stand): 1036.5 mm
- Set depth (with stand): 313 mm
- Product weight (+stand): 36.2 kg



Issue date 2023-04-30

Version: 9.0.1

© 2023 Koninklijke Philips N.V.
All Rights reserved.

Specifications are subject to change without notice.
Trademarks are the property of Koninklijke Philips N.V.
or their respective owners.

www.philips.com

* EPG and actual visibility (up to 8 days) is country and operator dependent.
* Android App offerings vary per country. For more details please visit your local Google Play Store.
* The TV supports DVB reception for 'Free to air' broadcast. Specific DVB operators may not be supported. An up to date list can be found in the FAQ section of the Philips support website. For some operators Conditional Access and subscription are required. Contact your operator for more information.
* Philips TV Remote app and related functionalities vary per TV model, operator, and country, as well as smart device model and OS. For more details please visit: www.philips.com/TVRemoteapp.
* Smart TV app offerings vary per TV model and country. For more details please visit: www.philips.com/smarttv.
* Please note that your Amazon Apps may not always be available in your country. (Currently Amazon apps works only in UK, Germany, Austria)
* Its functionality is subject to ChromeCast built-in apps and smart devices. For more details, please visit ChromeCast built-in product pages.
* Google Assistant is available on Philips Android TVs running on Android O (8) or higher OS version. GA is available in selected languages and countries. Supported language/countries list is going to be expanded overtime. For latest language and countries support list please contact our consumer care.
* Image depicted on the website are non-contractual pictures. Please always refer to the actual TV that are sold in the retail or stores.