



Philips  
Professional LCD TV

107cm (42")

LCD  
Full HD 1080p

42HFL3381



# The Versatile Hospitality TV

## Philips Full HD LCD TV for Hospitality

This professional TV offers advance hotel mode, great picture quality and system control capability specially designed to ensure reliable operation and maximum guest comfort.

### Best total cost of ownership

- USB cloning of all settings for quick installation
- Installation menu locking

### Sustainable and safe

- Eco-friendly design & flame retardant housing
- Lead-free/RoHS compliant with flame retardant housing

### Advanced hotel features and future proof

- Switch On Channel Programming
- Welcome message on screen display
- Smart Hotel Mode

### Great viewing experience and guest comfort

- LCD Full HD display, 1920x1080p
- Digital Crystal Clear for more vivid cinema-like images

**PHILIPS**

# Highlights

## Digital Crystal Clear

Digital Crystal Clear is a processing technology that digitally adjusts and enhances picture quality by optimizing contrast, color and sharpness levels, resulting in more vivid cinema-like images.

## Eco-friendly design

Sustainability is integral to the way Philips does business. Philips TVs are designed and produced according to our EcoDesign principles aimed at minimizing overall environmental impact, through lower power consumption, removal of hazardous substances, lower weight, more efficient packaging and better recyclability. Philips TVs also have a special housing of flame retardant material. Independent tests carried out by emergency fire services have shown that whereas TVs can sometimes intensify fires caused by external sources, Philips TVs will not contribute to the fire.

## Installation menu locking

Prevents unauthorized access to installation and configuration settings, to ensure maximum guest convenience and avoid unnecessary reprogramming costs.

## Switch On Channel Programming

Perfect for in-house advertising or information channels as it allows to show a predefined channel when the TV is turned on.

## Welcome message

A welcome greeting is displayed each time the TV set is switched on.

## Smart Hotel Mode

Allows configuration of the TV for limited access, ideal for hotel use. Access to the user menu can be blocked, which enables you to specify channel, picture, and sound settings which your guest will be unable to modify. Picture and sound preferences may be selected from presets on the remote, offering guest selection, but never overwriting your defined settings. Switch on and maximum volume can also be specified so the set always turns on and operates at a comfortable volume. Channels can be blanked to prevent access to premium or adult content. Includes a forced power on mode.

## USB Cloning

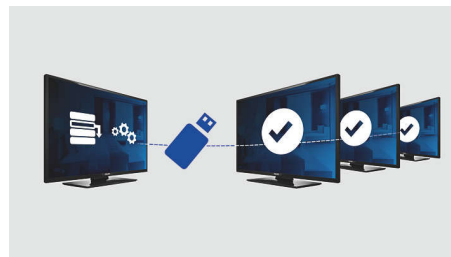

Provides the ability to easily copy all programming and channel programming settings from one TV into other TV sets in less

than a minute. The feature ensures uniformity between TV sets and significantly reduces installation time and costs.

## RoHS & Flame retardant housing

In addition to being lead-free and RoHS compliant, Philips TVs have a special housing of eco-friendly, non-brominated flame-retardant materials. Independent tests carried out by emergency fire services have shown that whereas TVs can sometimes intensify fires caused by external sources, Philips TVs will not contribute to the fire.

## LCD Full HD display 1920x1080p

This display has a resolution that is referred to as Full HD. With state-of-the-art LCD screen technology it has the full high-definition widescreen resolution of 1920 x 1080p. This is the highest resolution that HD broadcast can transmit. It allows the best possible picture quality from any format of HD input signal. It produces brilliant flicker-free progressive scan pictures with optimum brightness and superb colors. This vibrant and sharp image will provide you with an enhanced viewing experience.

# Specifications

## Picture/Display

- Aspect ratio: Widescreen
- Diagonal screen size (inch): 42 inch
- Diagonal screen size (metric): 107 cm
- Color cabinet: Black
- Panel resolution: 1920x1080p
- Brightness: 500 cd/m<sup>2</sup>
- Picture enhancement: 3/2 - 2/2 motion pull down, 3D Combfilter, Digital Crystal Clear, 1080p 24/25/30Hz processing, 1080p 50/60Hz processing, 2D/3D noise reduction, Active Control, Color Enhancement, Dynamic contrast enhancement, Dynamic Noise Reduction, Jagged Line Suppression, Sharpness Adjustment
- Contrast ratio (typical): 1400:1
- Display screen type: LCD Full HD W-UXGA Act. matrix
- Response time (typical): 5 ms
- Viewing angle: 178° (H) / 178° (V)

## Supported Display Resolution

- Computer formats: 640 x 480, 60, 72, 75, 85Hz, 800 x 600, 60, 72, 75, 85Hz, 1024 x 768, 60, 70, 75, 85Hz, 1280 x 768, 60Hz, 1280 x 1024, 60Hz, 1360 x 768, 60Hz
- Video formats: 480i, 60Hz, 480p, 60Hz, 576i, 50Hz, 576p, 50Hz, 720p, 50, 60Hz, 1080i, 50, 60Hz, 1080p, 24, 25, 30, 50, 60Hz

## Tuner/Reception/Transmission

- Aerial Input: 75 ohm coaxial (IEC75)
- Tuner bands: Hyperband, S-Channel, UHF, VHF
- TV system: PAL D/K, PAL B/G, NTSC
- Video Playback: NTSC, PAL

## Convenience

- Ease of Installation: PLL Digital Tuning, Cloning of TV settings, Advanced Hotel Mode, Fine Tuning, Installation menu locking, Keyboard lock-out, Program Name, Security menu access
- Ease of Use: Auto Volume Leveller (AVL), Graphical User Interface, On Screen Display, Side Control, Smart Picture, Smart Sound
- Comfort: Hotel Guest features, Sleep timer, Switch on channel, Volume limitation, Welcome message
- Screen Format Adjustments: 4:3, Widescreen, Movie expand 16:9, Movie expand 14:9, Subtitle Zoom, Super Zoom

- Teletext: 1000 page Smart Text
- Firmware upgradeable: Firmware upgradeable via USB
- Teletext enhancements: 4 favourite pages

## Sound

- Output power (RMS): 2 x 8 W
- Sound System: Mono, Stereo, Nicam Stereo
- Sound Enhancement: Incredible Surround, Auto Volume Leveler, Dynamic Bass Enhancement, Treble and Bass Control

## Loudspeakers

- Built-in speakers: 2

## Connectivity

- AV 1: Audio L/R in, YPbPr
- Connectivity Enhancements: Fast Infrared loop through, Serial Xpress interface
- AV 2: Audio L/R in, YPbPr
- AV 3: Audio L/R in, CVBS in
- EasyLink (HDMI-CEC): One touch play, System standby
- Front / Side connections: Audio L/R in, CVBS in, Headphone Out, HDMI v1.3
- HDMI 1: HDMI v1.3
- Other connections: Monitor out, CVBS, L/R (cinch), PC-in VGA + Audio L/R in, S/PDIF out (coaxial)

## Power

- Mains power: 110-240V, 50-60Hz
- Ambient temperature: 5 °C to 40 °C
- Power consumption: 198 W
- Standby power consumption: 0.3 W

## Green Specifications

- Safety: Flame retardant housing

## Accessories

- Included accessories: User Manual, Power cord, Quick start guide
- Optional accessories: Table top Stand with Swivel, Set up Remote RC2573GR, Guest remote control

## Dimensions

- Set Width: 1026 mm
- Set Height: 667 mm
- Set Depth: 83 mm

### Rear connectors

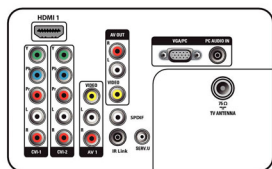

### Side



Issue date 2023-10-02

Version: 1.1.2

EAN: 87 12581 53482 0

© 2023 Koninklijke Philips N.V.  
All Rights reserved.

Specifications are subject to change without notice.  
Trademarks are the property of Koninklijke Philips N.V.  
or their respective owners.

[www.philips.com](http://www.philips.com)