

Philips OLED
4K UHD OLED Android
TV

P5 AI perfect picture engine

Dolby Atmos sound
4-sided Ambilight TV
164 cm (65") Android TV



65OLED806

Uniquely immersive. Completely beautiful.

4K UHD OLED Android TV

The thrillingly realistic picture on this gorgeous OLED TV combines with immersive 4-sided Ambilight to create cinema-sized excitement. Whatever you watch or play, the action will leap from the screen-right into your living room.

Designed to mesmerize.

- All-round immersion. 4-sided Ambilight.
- Premium design. From stand to remote.
- This is what lifelike feels like. Philips OLED TV.

Smooth motion. True color. Incredible depth.

- Vibrant HDR picture. Philips 4K UHD TV.
- Cinematic vision and sound. Dolby Vision and Dolby Atmos
- Great for gaming. Ultra-low latency on any console
- Whatever you watch, a picture so real. P5 engine with AI.

Content at your command.

- Voice control. The Google Assistant. Works with Alexa.
- Multi-room audio. DTS Play-Fi
- Simply smart. Android TV.

PHILIPS

4K UHD OLED Android TV
P5 AI perfect picture engine Dolby Atmos sound, 4-sided Ambilight TV, 164 cm (65") Android TV

65OLED806/98

Highlights

4-sided Ambilight



With Philips 4-sided Ambilight, every moment feels closer. Intelligent LEDs around the edge of the TV respond to the on-screen action and emit an immersive glow that's simply captivating. Experience it once and wonder how you enjoyed TV without it.

Dolby Vision + Dolby Atmos

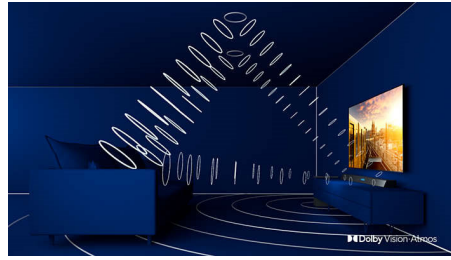

Support for Dolby's premium sound and video formats means the HDR content you watch will look-and sound-glorious. You'll enjoy a picture that reflects the director's original intentions and experience spacious sound with real clarity and depth.

HDMI 2.1 VRR and low latency



Your Philips TV boasts the latest HDMI 2.1 connectivity and automatically switches to an ultra-low-latency setting when you start playing a game on your console. VRR and Freesync are supported for smooth fast-action gameplay. Ambilight's gaming mode brings the thrill right into the room.

P5 engine with AI



Philips P5 processor with AI delivers a picture so real it feels like you could step right into it. A deep-learning AI algorithm processes images in a manner similar to the human brain. No matter what you're watching, you get lifelike detail and contrast, rich color, and smooth motion.

Premium materials



Every inch of this TV looks and feels premium. The ultra-thin metal bezel. The soft, textured leather-backed remote with backlit keys. Or the reversible two-tone metal feet-which you can fit to the TV either way around, depending on the tone you prefer.

DTS Play-Fi compatible

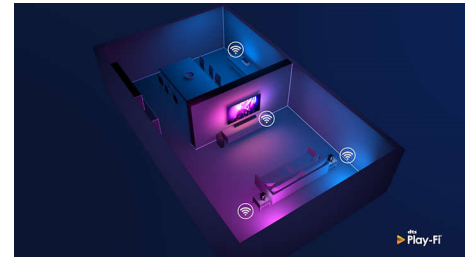

With DTS Play-Fi on your Philips TV you can connect to compatible speakers in any room. Got wireless speakers in the kitchen? Listen to the movie while you make a snack or keep up with the sports commentary while you get everyone drinks.

Philips OLED TV



With a Philips OLED TV, you get a wider viewing angle and a uniquely lifelike picture. Blacks are deeper. Colors are truer. Details in shadows and highlights are precisely reproduced. All major HDR formats are supported. You'll feel the full power of every scene.

Simply smart. Android TV



Your Philips Android TV gives you the content you want-when you want it. You can customize the home screen to display your favorite apps, making it simple to start streaming the movies and shows you love. Or pick up where you left off.

AI voice control

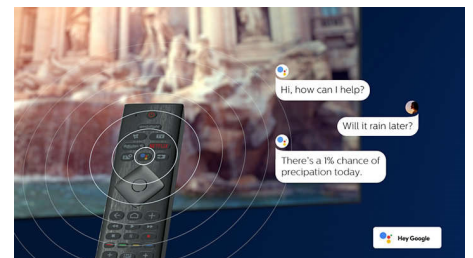

Push a button on the remote to talk to the Google Assistant. Control the TV or Google Assistant-compatible smart home devices with your voice. Or ask Alexa to control the TV via Alexa-enabled devices.



Specifications

Ambilight

- Ambilight Features: Ambilight Music, Game Mode, Wall colour adaptive, Lounge mode, AmbiWakeup, AmbiSleep
- Ambilight Version: 4-sided

Picture/Display

- Aspect ratio: 16:9
- Display: 4K Ultra HD OLED
- Panel resolution: 3840x2160
- Picture engine: P5 AI Perfect Picture Engine
- Picture enhancement: Ultra Resolution, Wide Color Gamut 99% DCI/P3, Dolby Vision, HDR10+, Perfect Natural Motion, A.I. PQ mode, CalMAN Ready, ISF Color Management, Micro Dimming Perfect

Supported Display Resolution

- Computer inputs on HDMI1/2: HDMI2.1 supported., HDR supported, HDR10+/HLG, up to 4K 120 Hz*
- Computer inputs on HDMI3/4: HDMI2.0 supported.
- Video inputs on HDMI1/2: HDMI2.1 supported, HDR supported, HDR10+/HLG, up to 4K 120Hz*
- Video inputs on HDMI3/4: HDMI2.0 supported.

Tuner/Reception/Transmission

- Digital TV: DVB-T/T2
- Video Playback: PAL, SECAM
- Interactive TV: meWatch Red Button
- MPEG Support: MPEG2, MPEG4
- TV Program guide*: 8 day Electronic Program Guide
- Signal strength indication
- Teletext: 1000 page Hypertext
- HEVC support

Android TV

- OS: Android TV™ 10 (Q)
- Pre-installed apps: Google Play Movies*, Google Play Music*, Google Search, YouTube, Netflix, Amazon Prime Video, Spotify
- Memory size(Flash): 32GB*

Smart TV Features

- User Interaction: SimplyShare
- Program: Pause TV, USB recording*
- Ease of Installation: Auto detect Philips devices, Network installation wizard, Settings assistant

- wizard, Device connection wizard
- Ease of Use: One-stop smart menu button, Onscreen usermanual
- Firmware upgradeable: Firmware auto upgrade wizard, Firmware upgradeable via USB, Online firmware upgrade
- Screen Format Adjustments: Basic - Fill Screen, Fit to screen, Advance - Shift, Zoom, stretch, Wide screen
- Remote Control: with Voice, with Key light, with Muirhead leather
- Voice assistant*: Google Assistant built-in, RC with Mic., Works with Alexa

Multimedia Applications

- Video Playback Formats: Containers: AVI, MKV, H264/MPEG-4 AVC, MPEG-1, MPEG-2, MPEG-4, VP9, HEVC (H.265), AV1
- Music Playback Formats: AAC, MP3, WAV, WMA (v2 up to v9.2), WMA-PRO (v9 and v10)
- Subtitles Formats Support: .SRT, .SUB, .TXT, .SMI
- Picture Playback Formats: JPEG, BMP, GIF, PNG, 360 photo, HEIF

Processing

- Processing Power: Quad Core

Sound

- Audio: Output power : 50 Watt (RMS), 2.1 Channel
- Speaker configuration: 10Wx2 mid-high speaker, 30W sub-woofer
- Codec: AC-4, Dolby Atmos, DTS-HD(M6), Dolby Digital MS12 V2.5
- Sound Enhancement: A.I. Sound, Clear Dialogue, Dolby Atmos, Dolby Bass Enhancement, Dolby Volume Leveler, Night mode, A.I. EQ, DTS Play-Fi, Mimi Sound Personalization

Connectivity

- Number of HDMI connections: 4
- HDMI features: 4K, Audio Return Channel
- EasyLink (HDMI-CEC): Remote control pass-through, System audio control, System standby, One touch play
- Number of USBs: 3
- Wireless connection: Wi-Fi 802.11ac, 2x2, Dual band, Bluetooth 5.0
- Other connections: Digital audio out (optical), Ethernet-LAN RJ-45, Headphone out
- HDCP 2.3: Yes on all HDMI

- HDMI ARC: Yes for all ports
- HDMI eARC: Yes on HDMI2
- HDMI VRR: Yes on all HDMI ports, FreeSync Premium

Power

- Mains power: AC 220 - 240 V 50/60Hz
- Ambient temperature: 5 °C to 35 °C
- Power Saving Features: Auto switch-off timer, Light sensor, Picture mute (for radio), Eco mode

Accessories

- Included Accessories: Legal and safety brochure, Power cord, Quick start guide (x1), Remote Control, Table top stand, 2 x AAA Batteries

Dimensions

- Set Width: 1448.7 mm
- Set Height: 826 mm
- Set Depth: 68.0 mm
- Product weight: 26.6 kg
- Set width (with stand): 1448.7 mm
- Set height (with stand): 843.1 mm
- Set depth (with stand): 290.0 mm
- Product weight (+stand): 27.2 kg
- Box width: 1660 mm
- Box height: 995.0 mm
- Box depth: 170.0 mm
- Weight incl. Packaging: 34 kg
- Wall mount dimensions: 300 x 300 mm



Connections

Side

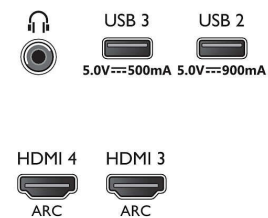

Bottom

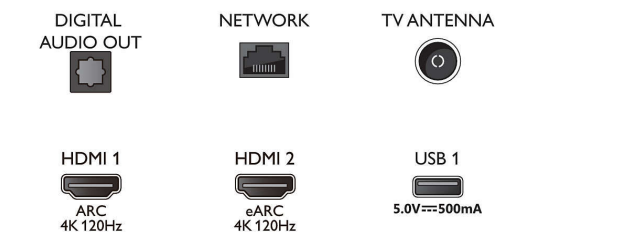

Issue date 2023-07-23

Version: 9.0.1

EAN: 87 18863 03198 8

© 2023 Koninklijke Philips N.V.
All Rights reserved.

Specifications are subject to change without notice.
Trademarks are the property of Koninklijke Philips N.V.
or their respective owners.

www.philips.com

- * EPG and actual visibility (up to 8 days) is country and operator dependent.
- * Android App offerings vary per country. For more details please visit your local Google Play Store.
- * The TV supports DVB reception for 'Free to air' broadcast. Specific DVB operators may not be supported. An up to date list can be found in the FAQ section of the Philips support website. For some operators Conditional Access and subscription are required. Contact your operator for more information.
- * Philips TV Remote app and related functionalities vary per TV model, operator, and country, as well as smart device model and OS. For more details please visit: www.philips.com/TVRemoteapp.
- * Smart TV app offerings vary per TV model and country. For more details please visit: www.philips.com/smarttv.
- * Amazon, Alexa and all related logos are trademarks of Amazon.com, Inc. or its affiliates. Amazon Alexa is available in selected languages and countries.
- * Amazon Prime is available in selected languages and countries.
- * Google Assistant is available on Philips Android TVs running on Android O (8) or higher OS version. Google Assistant is available in selected languages and countries.
- * Netflix subscription required. Subject to terms at <https://www.netflix.com>
- * Cloud Gaming offering depends on game providers.
- * Image depicted on the website are non-contractual pictures. Please always refer to the actual TV that are sold in the retail or stores.
- * Disney+ subscription required. Subject to terms at <https://www.disneyplus.com> (c) 2020 Disney and its related entities. Disney+ is available in selected languages and countries.
- * Memory size (Flash) : 32G, the actual available disc space may differ (dependent on e.g. (pre-)installed apps, installed operating system, etc.)