

Philips OLED
4K UHD OLED Android
TV

P5 AI perfect picture engine

Dolby Atmos sound
3-sided Ambilight TV
139 cm (55") Android TV

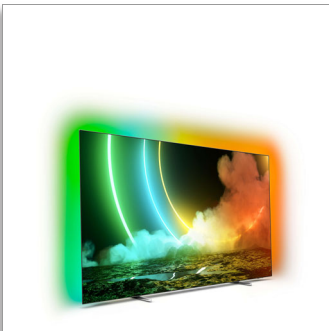

55OLED706

Lifelike picture. Magical light.

4K UHD OLED Android TV

Whatever you love, this OLED TV sets it alight. A richly detailed, beautifully realistic picture combines with Philips unique Ambilight to make movie night a blockbuster event. While every gaming session takes you to another world.

Designed to mesmerize.

- This is what lifelike feels like. Philips OLED TV.
- The one with magical Ambilight. Only from Philips.
- Premium design. From stand to remote

Smooth motion. True color. Incredible depth.

- Vibrant HDR picture. Philips 4K UHD TV.
- Cinematic vision and sound. Dolby Vision and Dolby Atmos
- Great for gaming. Ultra-low latency on any console
- Whatever you watch, a picture so real. P5 engine with AI.

Content at your command.

- Multi-room audio. DTS Play-Fi
- Simply smart. Android TV.
- Google Assistant. Control the TV with your voice.

PHILIPS

Highlights

3-sided Ambilight



With Philips Ambilight every moment feels closer. Intelligent LEDs around the edge of the TV respond to the on-screen action and emit an immersive glow that's simply captivating. Experience it once and wonder how you enjoyed TV without it.

Dolby Vision + Dolby Atmos



Support for Dolby's premium sound and video formats means the HDR content you watch will look-and sound-glorious. You'll enjoy a picture that reflects the director's original intentions and experience spacious sound with real clarity and depth.

DTS Play-Fi compatible

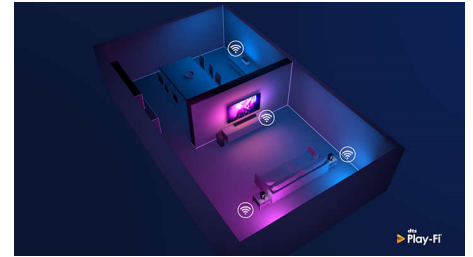

With DTS Play-Fi on your Philips TV you can connect to compatible speakers in any room. Got wireless speakers in the kitchen? Listen to the movie while you make a snack or keep up with the sports commentary while you get everyone drinks.

P5 engine with AI



Philips P5 processor with AI delivers a picture so real it feels like you could step right into it. A deep-learning AI algorithm processes images in a manner similar to the human brain. No matter what you're watching, you get lifelike detail and contrast, rich color, and smooth motion.

Premium materials



Every inch of this TV looks and feels premium. The ultra-thin metal bezel. The beautiful aluminum feet. Or the remote with a backlit Ambilight key, which makes it easy to turn on Ambilight-even in the dark.

Supports all major HDR formats

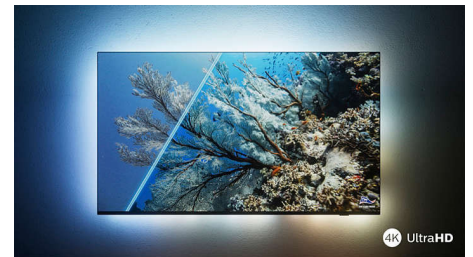

Your Philips 4K UHD TV is compatible with all major HDR formats, including Dolby Vision. Whether it's a must-watch series or the latest video game, shadows will be deeper. Bright surfaces will shine. Colors will be truer.

Philips OLED TV

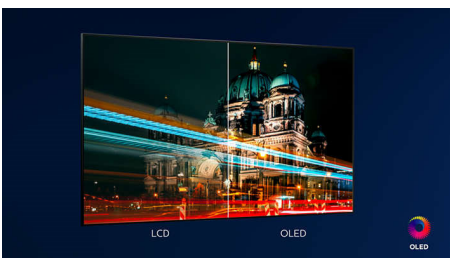

With a Philips OLED TV, you get a wider viewing angle and a uniquely lifelike picture. Blacks are deeper. Colors are truer. Details in shadows and highlights are precisely reproduced. All major HDR formats are supported. You'll feel the full power of every scene.

Simply smart. Android TV

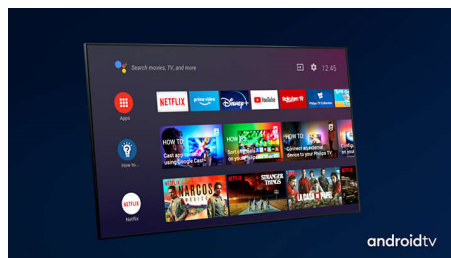

Your Philips Android TV gives you the content you want-when you want it. You can customize the home screen to display your favorite apps, making it simple to start streaming the movies and shows you love. Or pick up where you left off.

Google Assistant

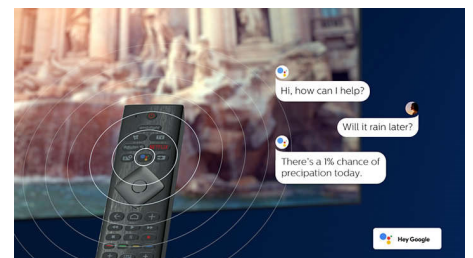

Control your Philips Android TV with your voice. Want to play a game, watch Netflix, or find content and apps in the Google Play store? Just tell your TV. You can even command all Google Assistant-compatible smart home devices-like dimming the lights and setting the thermostat on movie night. Without leaving the sofa.



Specifications

Ambilight

- Ambilight Features: Ambilight Music, Game Mode, Wall colour adaptive, Lounge mode, AmbiWakeUp, AmbiSleep
- Ambilight Version: 3-sided

Picture/Display

- Aspect ratio: 16:9
- Display: 4K Ultra HD OLED
- Picture enhancement: Ultra Resolution, Wide Color Gamut 99% DCI/P3, Dolby Vision, HDR10+, Perfect Natural Motion, A.I. PQ mode, ISF Color Management, Micro Dimming Perfect, CalMAN Ready
- Panel resolution: 3840x2160
- Picture engine: P5 AI Perfect Picture Engine

Supported Display Resolution

- Computer inputs on all HDMI: HDR supported, HDR10+/HLG, HDR supported, HDR10/HLG, up to 4K UHD 3840 x 2160@120Hz
- Video inputs on all HDMI: HDR10/HLG (Hybrid Log Gamma), HDR10+/Dolby Vision, up to 4K UHD 3840x2160@120Hz

Tuner/Reception/Transmission

- Digital TV: DVB-T/T2
- Video Playback: PAL, SECAM
- MPEG Support: MPEG2, MPEG4
- TV Program guide*: 8 day Electronic Program Guide
- Signal strength indication
- HEVC support

Android TV

- OS: Android TV™ 10 (Q)
- Pre-installed apps: Google Play Movies*, Google Play Music*, Google Search, YouTube, Netflix, Amazon Prime Video, Spotify
- Memory size(Flash): 32GB*

Smart TV Features

- User Interaction: SimplyShare
- Program: Pause TV, USB recording*
- Ease of Installation: Auto detect Philips devices, Network installation wizard, Settings assistant wizard, Device connection wizard
- Ease of Use: One-stop smart menu button, Onscreen usermanual
- Firmware upgradeable: Firmware auto upgrade wizard, Firmware upgradeable via USB, Online firmware upgrade, FW download in background
- Screen Format Adjustments: Basic - Fill Screen, Fit to screen, Advance - Shift, Zoom, stretch, Wide screen
- Remote Control: with Voice
- Voice assistant*: Google Assistant built-in, RC with Mic., Works with Alexa

Multimedia Applications

- Video Playback Formats: Containers: AVI, MKV, H264/MPEG-4 AVC, MPEG-1, MPEG-2, MPEG-4, VP9, HEVC (H.265), AV1
- Music Playback Formats: AAC, MP3, WAV, WMA

- (v2 up to v9.2), WMA-PRO (v9 and v10)
- Subtitles Formats Support: .SRT, .SUB, .TXT, .SMI
- Picture Playback Formats: JPEG, BMP, GIF, PNG, 360 photo, HEIF

Processing

- Processing Power: Quad Core

Sound

- Sound Enhancement: A.I. Sound, Clear Dialogue, Dolby Atmos, Dolby Bass Enhancement, Dolby Volume Leveler, Night mode, A.I. EQ, DTS Play-Fi, Mimi Sound Personalization
- Audio: Output power : 50 Watt (RMS), 2.1 Channel
- Codec: AC-4, Dolby Atmos, DTS-HD(M6), Dolby Digital MS12 V2.5
- Speaker configuration: 10Wx2 mid-high speaker, 30W sub-woofer

Connectivity

- Number of HDMI connections: 4
- HDMI features: 4K, Audio Return Channel
- EasyLink (HDMI-CEC): Remote control pass-through, System audio control, System standby, One touch play
- Number of USBs: 3
- Wireless connection: Wi-Fi 802.11ac, 2x2, Dual band, Bluetooth 5.0
- Other connections: Digital audio out (optical), Ethernet-LAN RJ-45, Headphone out
- HDCP 2.3: Yes on all HDMI
- HDMI ARC: Yes for all ports
- HDMI eARC: Yes on HDMI2
- HDMI VRR: Yes on all HDMI ports, FreeSync Premium

Power

- Mains power: AC 220 - 240 V 50/60Hz
- Ambient temperature: 5 °C to 35 °C
- Standby power consumption: $0.5W$
- Power Saving Features: Auto switch-off timer, Light sensor, Picture mute (for radio), Eco mode

Accessories

- Included Accessories: Legal and safety brochure, Power cord, Quick start guide (x1), Remote Control, Table top stand, 2 x AAA Batteries

Dimensions

- Box depth: 160.0 mm
- Product weight: 19.0 kg
- Set Width: 1227.8 mm
- Set width (with stand): 1227.8 mm
- Box height: 860.0 mm
- Box width: 1400.0 mm
- Set Height: 702 mm
- Weight incl. Packaging: 25 kg
- Set Depth: 58.0 mm
- Set height (with stand): 722.4 mm
- Set depth (with stand): 230.0 mm
- Product weight (+stand): 19.4 kg
- Wall mount dimensions: 300 x 300 mm



Issue date 2023-04-30

Version: 2.0.1

© 2023 Koninklijke Philips N.V.
All Rights reserved.

Specifications are subject to change without notice.
Trademarks are the property of Koninklijke Philips N.V.
or their respective owners.

www.philips.com

* EPG and actual visibility (up to 8 days) is country and operator dependent.
* Android App offerings vary per country. For more details please visit your local Google Play Store.
* The TV supports DVB reception for 'Free to air' broadcast. Specific DVB operators may not be supported. An up to date list can be found in the FAQ section of the Philips support website. For some operators Conditional Access and subscription are required. Contact your operator for more information.
* Philips TV Remote app and related functionalities vary per TV model, operator, and country, as well as smart device model and OS. For more details please visit: www.philips.com/TVRemoteapp.
* Smart TV app offerings vary per TV model and country. For more details please visit: www.philips.com/smarttv.
* Amazon Prime is available in selected languages and countries.
* Google Assistant is available on Philips Android TVs running on Android O (8) or higher OS version. Google Assistant is available in selected languages and countries.
* Netflix subscription required. Subject to terms at <https://www.netflix.com>
* Image depicted on the website are non-contractual pictures. Please always refer to the actual TV that are sold in the retail or stores.
* Memory size (Flash) : 32G, the actual available disc space may differ (dependent on e.g. (pre-)installed apps, installed operating system, etc.)