

# PHILIPS

4K UHD LED  
Android TV

8200 series

139 cm (55")

Major HDR formats supported

P5 Perfect Picture Engine



55PUT8215

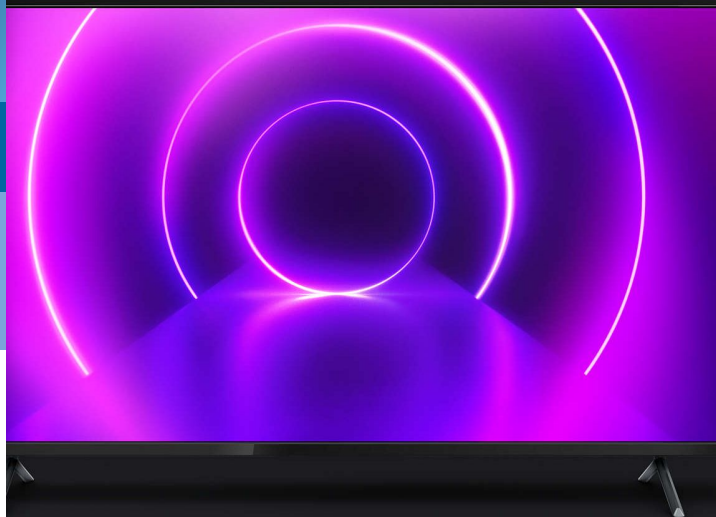

## 4K UHD LED Android TV with P5 Perfect Picture Engine

Family movie night. The big game. Whatever the occasion, settle down to superb picture quality and great sound. This TV makes all your content look great,

### **Android TV-content at your command**

- Google Play store and Philips app gallery. More to love.
- Google Assistant. Control the TV with your voice.
- Android TV. Simply smart.
- DTS Play-Fi. Multi-room audio.

### **Slim TV. Beautiful light.**

- Bright 4K LED TV. Vibrant HDR picture. Smooth motion.

### **Smooth motion. Real color. Incredible depth.**

- Philips P5 Engine. Whatever the source, always perfection.
- Dolby Vision and Dolby Atmos. Cinematic vision and sound.

### **Freeview TV | Network channels**

- Freeview Plus (Australia)
- Freeview ( New Zealand )

# Highlights

## Freeview Plus (Australia)



Never miss a thing with Freeview! Find out what's on now, next or over the next 7 days with the easy to use TV guide. Looking for your favourite show? Use Search for quick access to all your favourite on demand from ABC iView, SBS On Demand, 7+, 9Now and 10 Play. All in one place, all for free.

## Freeview (New Zealand)



Freeview brings together the best channels and an 8-day TV guide, all free on your TV. You can watch your favourite shows, stay informed with NZ news and current affairs, or channel-surf your heart out - all subscription-free.

## P5 Perfect Picture Engine

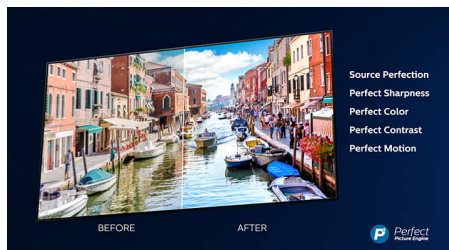

The Philips P5 engine delivers a picture as brilliant as the content you love. Details have noticeably more depth. Colors are vivid, while skin tones look natural. Contrast is so crisp you'll feel every detail. Motion is perfectly smooth.

## Dolby Vision and Dolby Atmos

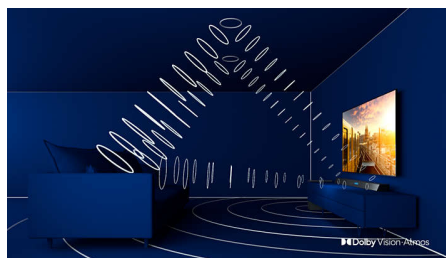

Support for Dolby's premium sound and video formats means the HDR content you watch will look-and sound-gloriously real. Whether it's the latest streaming series or a Blu-Ray disc set, you'll enjoy contrast, brightness, and color that reflect the director's original intentions. And hear spacious sound with clarity, detail, and depth.

## TV Content

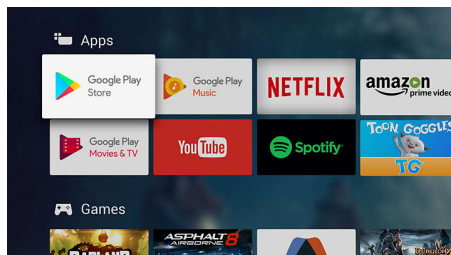

Go beyond traditional TV programming with Google Play Store and Philips App Gallery. Experience endless movies, TV, music, apps and games online. More to love.

## 4K UHD



Bright 4K LED TV. Vibrant HDR picture. Smooth motion. A Philips 4K UHD TV brings content to life with rich colors and crisp

contrast. Images have more depth, and motion is smooth. Movies, shows, games, and more look great no matter the source.

## Android TV

Make your Philips Android TV your own. If it's all about Amazon and YouTube this week, and Netflix next week-no problem. A clear, intuitive interface lets you put the content you love front and center. Easily pick up where you left off in the latest series, or check out the new movie releases.

## Google Assistant

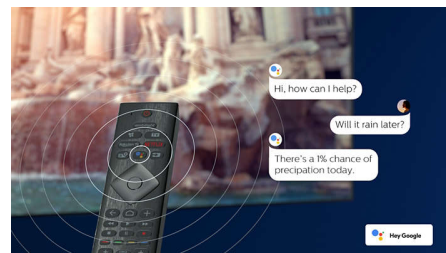

Control your Philips Android TV with your voice. Want to play a game, watch Netflix, or find content and apps in the Google Play store? Just tell your TV. You can even command all Google Assistant-compatible smart home devices-like dimming the lights and setting the thermostat on movie night. Without leaving the sofa.

## DTS Play-Fi

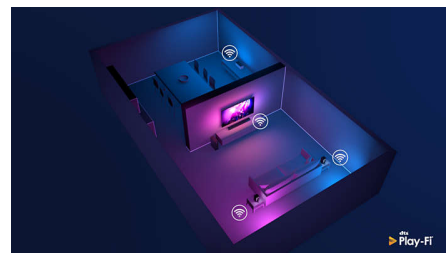

With DTS Play-Fi on your Philips TV you can connect to compatible speakers in any room. Got wireless speakers in the kitchen? Listen to the movie while you make a snack, or keep up with the sports commentary while you get everyone a drink.

# Specifications

## Picture/Display

Aspect ratio: 16:9

Display: 4K Ultra HD LED

Picture enhancement: Ultra Resolution, Micro Dimming Pro

Panel resolution: 3840x2160

Picture engine: P5 Perfect Picture Engine

## Supported Display Resolution

Computer inputs on all HDMI: HDR supported, HDR10/ HLG, up to 4K UHD 3840x2160 @60Hz

Video inputs on all HDMI: up to 4K UHD 3840x2160@60Hz, HDR10/HLG (Hybrid Log Gamma), HDR10+/Dolby Vision

## Tuner/Reception/Transmission

Digital TV: DVB-T/T2

Video Playback: NTSC, PAL, SECAM

MPEG Support: MPEG2, MPEG4

TV Program guide\*: 8 day Electronic Program Guide

Signal strength indication

HEVC support

## Android TV

OS: Android TV™ 9 (Pie)

Pre-installed apps: Google Play Movies\*, Google Play Music\*, Google Search, YouTube

Memory size(Flash): 16GB\*

Memory size to install apps: 5GB

## Smart TV

SmartTV apps\*: Netflix

## Smart TV Features

User Interaction: SimplyShare

Program: Pause TV, USB recording\*

Ease of Installation: Auto detect Philips devices, Network installation wizard, Settings assistant wizard

Ease of Use: One-stop smart menu button, Onscreen usermanual

Firmware upgradeable: Firmware auto upgrade wizard, Firmware upgradeable via USB, Online firmware upgrade

Screen Format Adjustments: Basic - Fill Screen, Fit to screen, Advance - Shift, Zoom,

stretch

Philips TV Remote app\*: Apps, Channels, Control, TV Guide

## Multimedia Applications

Video Playback Formats: Containers: AVI, MKV, H264/MPEG-4 AVC, MPEG-1, MPEG-2, MPEG-4, WMV9/VC1, HEVC (H.265), VP9

Music Playback Formats: AAC, MP3, WAV, WMA (v2 up to v9.2), WMA-PRO (v9 and v10)

Subtitles Formats Support: .SRT, .SUB, .TXT, .SMI

Picture Playback Formats: JPEG, BMP, GIF, PNG, 360 photo, HEIF

## Processing

Processing Power: Quad Core

## Sound

Output power (RMS): 16W

Sound Enhancement: Auto Volume Leveler, Dolby Atmos, Clear Sound, Smart Sound

Speaker configuration: 2x8W full range speaker

## Connectivity

Number of HDMI connections: 4

HDMI features: 4K, Audio Return Channel

EasyLink (HDMI-CEC): Remote control pass-through, System audio control, System standby, One touch play

Number of USBs: 2

Wireless connection: Bluetooth 4.2, Wi-Fi 802.11n, 2x2, Dual band

Other connections: Digital audio out (optical), Ethernet-LAN RJ-45, Headphone out

HDCP 2.2: Yes on all HDMI

## Power

Mains power: AC 220 - 240 V 50/60Hz

Ambient temperature: 5 °C to 35 °C

Power Saving Features: Auto switch-off timer, Picture mute (for radio), Light sensor

## Accessories

Included accessories: Remote Control, Quick start guide, Legal and safety brochure, Power cord, Table top stand

Included batteries: 2 x AAA Batteries

## Dimensions

Box depth: 160.0 mm

Product weight: 11.5 kg

Set Width: 1226.8 mm

Set width (with stand): 1226.8 mm

Wall mount compatible: 200 x 200 mm

Box height: 860.0 mm

Box width: 1360.0 mm

Set Height: 718.8 mm

Weight incl. Packaging: 16.6 kg

Set Depth: 86.6 mm

Set height (with stand): 783.1 mm

Set depth (with stand): 262.7 mm

Product weight (+stand): 11.8 kg



\* EPG and actual visibility (up to 8 days) is country and operator dependent.

\* Android App offerings vary per country. For more details please visit your local Google Play Store.

\* The TV supports DVB reception for 'Free to air' broadcast. Specific DVB operators may not be supported. An up to date list can be found in the FAQ section of the Philips support website. For some operators Conditional Access and subscription are required. Contact your operator for more information.

\* Philips TV Remote app and related functionalities vary per TV model, operator, and country, as well as smart device model and OS. For more details please visit: [www.philips.com/TVRemoteapp](http://www.philips.com/TVRemoteapp).

\* Smart TV app offerings vary per TV model and country. For more details please visit: [www.philips.com/smarttv](http://www.philips.com/smarttv).

\* Please note that your Amazon Apps may not always be available in your country. (Currently Amazon apps works only in UK, Germany, Austria)

\* Its functionality is subject to ChromeCast built-in apps and smart devices. For more details, please visit ChromeCast built-in product pages.

\* Image depicted on the website are non-contractual pictures. Please always refer to the actual TV that are sold in the retail or stores.