



Philips OLED 8 series
4K UHD LED Smart TV

164 cm (65") Ambilight TV

Dolby Atmos cinematic sound
P5 AI Perfect Picture Engine
Android TV



65OLED805

Sophisticated performance. Minimalist design.

4K UHD OLED Android TV

Immerse yourself in a sharp, polished picture with natural colors and rich contrast. This slim, elegant Philips 4K OLED TV brings lifelike depth and fluid motion to the content you love. Ambilight completes the picture beautifully.

Smooth motion. True color. Incredible depth.

- Dolby Vision and Dolby Atmos. Cinematic vision and sound.
- Major HDR formats. See more of what the director intended.
- P5 engine with AI. Whatever you watch, a picture so real.

Designed to mesmerize.

- Muirhead leather-backed remote control with backlit keys.
- The magic of Ambilight. Only from Philips.
- Philips OLED TV. This is what lifelike feels like.

Content at your command.

- The Google Assistant
- Works with Alexa.
- Android TV. Simply smart.
- DTS Play-Fi. Multi-room audio.

PHILIPS

4K UHD LED Smart TV
164 cm (65") Ambilight TV Dolby Atmos cinematic sound, P5 AI Perfect Picture Engine, Android TV

65OLED805/56

Highlights

Ambilight 3-sided



With Philips Ambilight every moment feels closer. Intelligent LEDs around the edge of the TV respond to the on-screen action and emit an immersive glow that's simply captivating. Experience it once and wonder how you enjoyed TV without it.

Philips OLED TV



With a Philips OLED TV, you get a wider viewing angle and a uniquely lifelike HDR picture where every scene feels impressively real. Blacks are deeper, colors more vibrant, and details in shadows and highlights are precisely reproduced.

Dolby Vision and Dolby Atmos

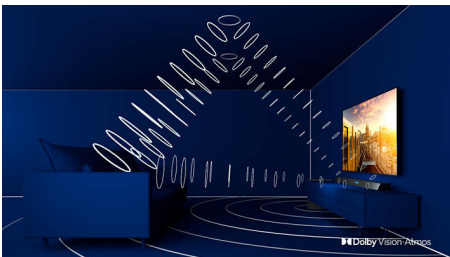

Support for Dolby's premium sound and video formats means the HDR content you watch will look-and sound-gloriously real. Whether it's the latest streaming series or a Blu-Ray disc set, you'll enjoy contrast, brightness, and color that reflect the director's original intentions.

And hear spacious sound with clarity, detail, and depth.

Google Assistant

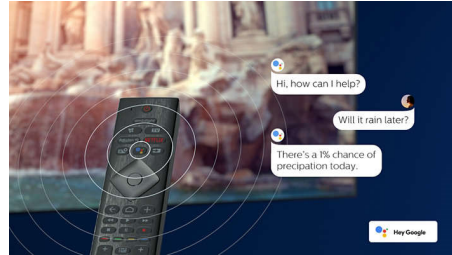

A Philips Android TV with the Google Assistant lets you control your TV, and more, with your voice. Want to find content and apps, play games, or get answers on screen? Just ask. You can even control Google Assistant-compatible smart home devices.

Works with Alexa



The days of searching for the TV remote are over. Now you can use your voice to control your Philips smart TV via Alexa-enabled devices, like Amazon Echo. Turn your TV on, change the channel, switch to your gaming console and more with Alexa.

Design

Muirhead leather-backed remote control with backlit keys.

Android TV



Your Philips Android TV gives you the content you want-when you want it. You can customize the home screen to display your favorite apps, making it simple to start streaming the movies and shows you love. Or pick up where you left off.

DTS Play-Fi

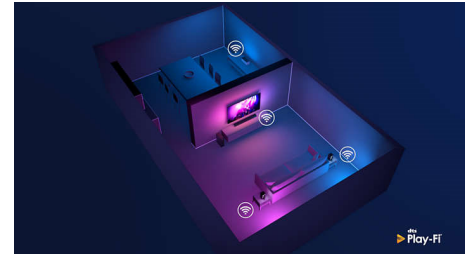

With DTS Play-Fi on your Philips TV you can connect to compatible speakers in any room. Got wireless speakers in the kitchen? Listen to the movie while you make a snack, or keep up with the sports commentary while you get everyone a drink.

Major HDR formats supported

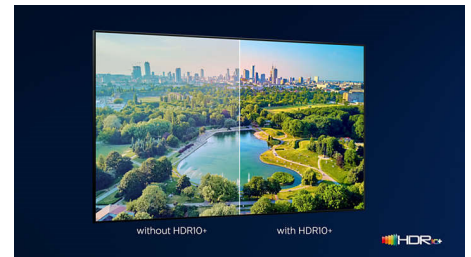

A Philips 4K UHD OLED TV is compatible with all major HDR formats, including HDR10+ and Dolby Vision. Whether it's a must-watch series or the latest video game, shadows will be deeper. Bright surfaces will shine. Colors will be truer. Motion is incredibly smooth.



Specifications

Ambilight

- Ambilight Features: Built in Ambilight+hue, Ambilight Music, Game Mode, Wall colour adaptive, Lounge mode, AmbiWakeup, AmbiSleep
- Ambilight Version: 3-sided

Picture/Display

- Aspect ratio: 16:9
- Display: 4K Ultra HD OLED
- Panel resolution: 3840x2160
- Picture engine: P5 AI Perfect Picture Engine
- Picture enhancement: Ultra Resolution, Dolby Vision, HDR10+, Perfect Natural Motion

Supported Display Resolution

- Computer inputs on all HDMI: up to 4K UHD 3840x2160 @60Hz, HDR supported, HDR10+/HLG, HDR supported, HDR10/HLG
- Video inputs on all HDMI: up to 4K UHD 3840x2160@60Hz, HDR supported, HDR10/HLG (Hybrid Log Gamma), HDR10+/Dolby Vision

Tuner/Reception/Transmission

- Digital TV: DVB-T/T2
- Video Playback: PAL, SECAM
- MPEG Support: MPEG2, MPEG4
- TV Program guide*: 8 day Electronic Program Guide
- Signal strength indication
- Teletext: 1000 page Hypertext
- HEVC support

Android TV

- OS: Android TV™ 9 (Pie)
- Pre-installed apps: Google Play Movies*, Google Play Music*, Google Search, YouTube, Amazon instant video, Netflix
- Memory size(Flash): 16GB*

Smart TV Features

- User Interaction: SimplyShare
- Program: Pause TV, USB recording*
- Ease of Installation: Auto detect Philips devices, Network installation wizard, Settings assistant wizard, Device connection wizard
- Ease of Use: One-stop smart menu button, Onscreen usermanual
- Firmware upgradeable: Firmware auto upgrade wizard, Firmware upgradeable via USB, Online firmware upgrade
- Screen Format Adjustments: Basic - Fill Screen, Fit

- to screen, Advance - Shift, Zoom, stretch, Wide screen
- Remote Control: with Voice, with Key light, with Muirhead leather
- Voice assistant*: Google Assistant built-in, RC with Mic., Works with Alexa

Multimedia Applications

- Video Playback Formats: Containers: AVI, MKV, H264/MPEG-4 AVC, MPEG-1, MPEG-2, MPEG-4, WMV9/VC1, VP9, HEVC (H.265)
- Music Playback Formats: AAC, MP3, WAV, WMA (v2 up to v9.2), WMA-PRO (v9 and v10)
- Subtitles Formats Support: .SRT, .SUB, .TXT, .SMI
- Picture Playback Formats: JPEG, BMP, GIF, PNG, 360 photo, HEIF

Processing

- Processing Power: Quad Core

Sound

- Audio: Output power : 50 Watt (RMS), 2.1 Channel
- Speaker configuration: 10Wx2 mid-high speaker, 30W sub-woofer
- Codec: AC-4, Dolby Atmos, Dolby Digital MS12 V2.3, DTS-HD(M6)
- Sound Enhancement: 5 Band Equalizer, A.I. Sound, Clear Dialogue, Dolby Atmos, Dolby Bass Enhancement, Dolby Volume Leveler, Night mode, Auto Volume Leveler, Bass Enhancement

Connectivity

- Number of HDMI connections: 4
- HDMI features: 4K, Audio Return Channel
- EasyLink (HDMI-CEC): Remote control pass-through, System audio control, System standby, One touch play
- Number of USBs: 2
- Wireless connection: Bluetooth 4.2, Wi-Fi 802.11ac, 2x2, Dual band
- Other connections: Digital audio out (optical), Ethernet-LAN RJ-45, Headphone out
- HDCP 2.3: Yes on all HDMI

Power

- Mains power: AC 220 - 240 V 50/60Hz
- Ambient temperature: 5 °C to 35 °C
- Power Saving Features: Auto switch-off timer, Light sensor, Picture mute (for radio), Eco mode

Accessories

- Included batteries: 2 x AAA Batteries
- Included Accessories: Legal and safety brochure, Power cord, Quick start guide (x1), Remote Control, Table top stand

Dimensions

- Set Width: 1448.7 mm
- Set Height: 829.5 mm
- Set Depth: 58.0 mm
- Product weight: 27.9 kg
- Set width (with stand): 1448.7 mm
- Set height (with stand): 846.1 mm
- Set depth (with stand): 280 mm
- Product weight (+stand): 28.4 kg
- Box width: 1660.0 mm
- Box height: 1002.0 mm
- Box depth: 170 mm
- Weight incl. Packaging: 38 kg
- Wall mount compatible: 300 x 300 mm

Connections

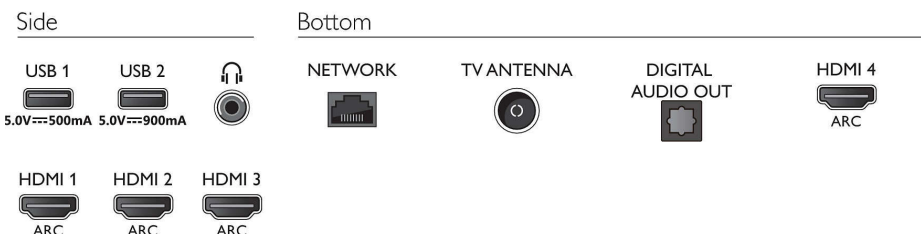

Issue date 2023-10-02

Version: 5.1.1

EAN: 87 18863 02763 9

© 2023 Koninklijke Philips N.V.
All Rights reserved.

Specifications are subject to change without notice.
Trademarks are the property of Koninklijke Philips N.V.
or their respective owners.

www.philips.com

* Memory size (Flash) : 16G, the actual available disc space may differ (dependent on e.g. (pre-)installed apps, installed operating system, etc.)

* EPG and actual visibility (up to 8 days) is country and operator dependent.

* Android App offerings vary per country. For more details please visit your local Google Play Store.

* The TV supports DVB reception for 'Free to air' broadcast. Specific DVB operators may not be supported. An up to date list can be found in the FAQ section of the Philips support website. For some operators Conditional Access and subscription are required. Contact your operator for more information.

* Philips TV Remote app and related functionalities vary per TV model, operator, and country, as well as smart device model and OS. For more details please visit: www.philips.com/TVRemoteapp.

* Smart TV app offerings vary per TV model and country. For more details please visit: www.philips.com/smarttv.

* Image depicted on the website are non-contractual pictures. Please always refer to the actual TV that are sold in the retail or stores.