

PHILIPS

4K UHD OLED
Android TV

OLED 8 series

139 cm (55") Ambilight TV

HDR 10+ / WCG 99%

P5 Pro Perfect Picture Engine



55OLED804



4K UHD OLED Android TV

with Ambilight 3-sided

Rich, natural colors. Exquisite detail in bright and dark scenes. From an HDR miniseries to sports, this Philips 4K OLED TV brings lifelike depth and smooth motion to all the content you love. Ambilight completes the picture beautifully.

Android TV-content at your command

- Google Play store and Philips app gallery. More to love.
- Google Assistant. Control the TV with your voice.

Smooth motion. True color. Incredible depth.

- Dolby Vision and Dolby Atmos. Cinematic vision and sound.
- HDR10+. See more of what the director intended.
- A brand new level of realism in picture quality.

Freeview TV | Network channels

- Freeview Plus (Australia)
- Freeview (New Zealand)

Any source. Always mesmerizing.

- Ambilight. Take the emotion beyond the screen.
- Elegant design. Slender metal bezel and stand.
- 4K UHD OLED TV. This is what lifelike feels like.

Highlights

Freeview Plus (Australia)



Never miss a thing with Freeview! Find out what's on now, next or over the next 7 days with the easy to use TV guide. Looking for your favourite show? Use Search for quick access to all your favourite on demand from ABC iView, SBS On Demand, 7+, 9Now and 10 Play. All in one place, all for free.

Freeview (New Zealand)



Freeview brings together the best channels and an 8-day TV guide, all free on your TV. You can watch your favourite shows, stay informed with NZ news and current affairs, or channel-surf your heart out – all subscription-free.

Ambilight 3-sided

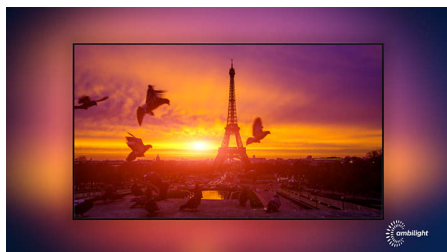

With Philips Ambilight, movies and games feel more immersive. Music gets a light show. And your screen will feel bigger than it is. Intelligent LEDs around the edges of the TV cast on-screen colours onto the walls, and into the room, in real time. You get perfectly tuned ambient lighting. And one more reason to love your TV.

OLED TV

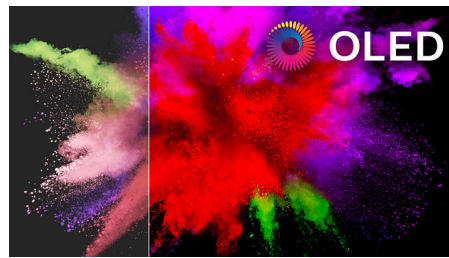

With a Philips OLED TV, every scene feels impressively real. Individual pixels can be dimmed or turned off, giving deeper blacks, vibrant colours, and astonishing contrast. Even details in shadows and highlights are precisely reproduced. You also get a wider viewing angle and, thanks to the Philips processing engine, beautifully smooth motion.

Dolby Vision and Dolby Atmos

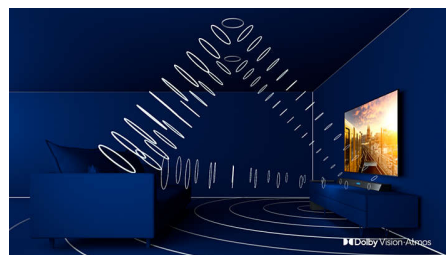

Support for Dolby's premium sound and video formats means the HDR content you watch will look-and-sound-gloriously real. Whether it's the latest streaming series or a Blu-Ray disc set, you'll enjoy contrast, brightness, and color that reflect the director's original intentions. And hear spacious sound with clarity, detail, and depth.

HDR10+

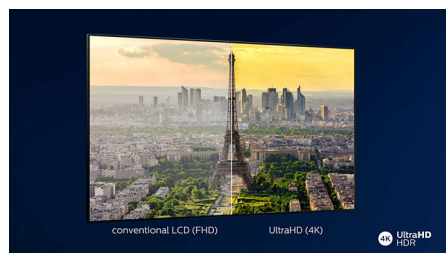

With a Philips HDR10+ TV, picture quality is even more immersive and lifelike. Dynamic metadata enables your TV to adjust brightness levels from frame to frame. From

bright skies to candlelit temples, colours look real. Original details are preserved. Contrast is impeccable.

TV Content

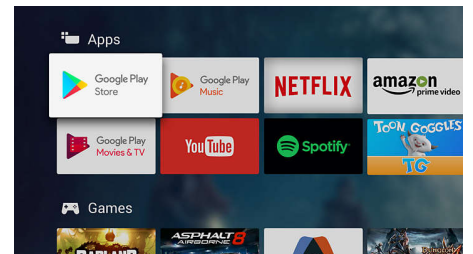

Go beyond traditional TV programming with Google Play Store and Philips App Gallery. Experience endless movies, TV, music, apps and games online. More to love.

Elegant design.

Elegant design. Slender metal bezel and stand.

Google Assistant

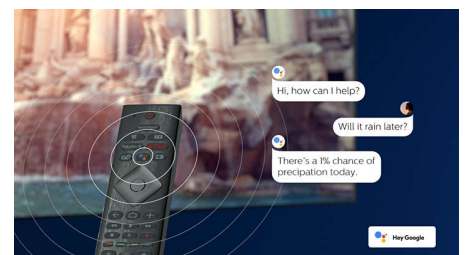

Control your Philips Android TV with your voice. Want to play a game, watch Netflix, or find content and apps in the Google Play store? Just tell your TV. You can even command all Google Assistant-compatible smart home devices—like dimming the lights and setting the thermostat on movie night. Without leaving the sofa.

P5 Pro Perfect Picture Engine

Philips P5 Pro Perfect Picture Engine, with the brand new generation Picture Quality Processor brings you to another level of visual experience. See our OLED TVs with the truest of blacks, vibrant colors, most realistic natural skin tones and incredibly smooth motion. Now you can see every details with greater depth impression, clean and yet sharper picture performance. Our Philips OLED TV brings you a new era of picture quality realism.

Specifications

Ambilight

Ambilight Features: Built in Ambilight+hue, Ambilight Music, Game Mode, Wall colour adaptive, Lounge mode

Ambilight Version: 3-sided

Picture/Display

Aspect ratio: 16:9

Display: 4K Ultra HD OLED

Picture enhancement: Ultra Resolution, Micro Dimming Perfect, Wide Color Gamut 99% DCI/P3, Dolby Vision, HDR10+, Perfect Natural Motion

Panel resolution: 3840x2160

Picture engine: P5 Pro Perfect Picture Engine

Supported Display Resolution

Computer inputs on all HDMI: up to 4K UHD 3840x2160 @60Hz, HDR supported, HDR10+/HLG

Video inputs on all HDMI: up to 4K UHD 3840x2160@60Hz, HDR supported, HDR10+/HLG

Tuner/Reception/Transmission

Digital TV: DVB-T/T2

Video Playback: NTSC, PAL, SECAM

MPEG Support: MPEG2, MPEG4

TV Program guide*: 8 day Electronic Program Guide

Signal strength indication

Teletext: 1000 page Hypertext

HEVC support

Android TV

OS: Android TV™ 9 (Pie)

Pre-installed apps: Google Play Movies*, Google Play Music*, Google Search, YouTube

Memory size(Flash): 16GB*

Smart TV

SmartTV apps*: Netflix

Smart TV Features

User Interaction: SimplyShare

Program: Pause TV, USB recording*

Ease of Installation: Auto detect Philips devices, Network installation wizard, Settings assistant wizard, Device connection wizard

Ease of Use: One-stop smart menu button, Onscreen usermanual

Firmware upgradeable: Firmware auto upgrade wizard, Firmware upgradeable via USB, Online firmware upgrade

Screen Format Adjustments: Basic – Fill Screen, Fit to screen, Advance – Shift, Zoom, stretch, Wide screen

Philips TV Remote app*: Apps, Channels, Control, TV Guide

Multimedia Applications

Video Playback Formats: Containers: AVI, MKV, H264/MPEG-4 AVC, MPEG-1, MPEG-2, MPEG-4, WMV9/VC1, VP9, HEVC (H.265)

Music Playback Formats: AAC, MP3, WAV, WMA (v2 up to v9.2), WMA-PRO (v9 and v10)

Subtitles Formats Support: .SRT, .SUB, .TXT, .SMI

Picture Playback Formats: JPEG, BMP, GIF, PNG, 360 photo, HEIF

Processing

Processing Power: Quad Core

Sound

Sound Enhancement: 5 Band Equalizer, A.I. Sound, Clear Dialogue, Dolby Atmos, Dolby Bass Enhancement, Dolby Volume Leveler, Night mode

Audio: Output power : 50 Watt (RMS), 2.1 Channel

Codec: AC-4, Dolby Atmos, Dolby Digital MS12 V2.3, DTS-HD(M6)

Speaker configuration: 10Wx2 mid-high speaker, 30W build-in sub-woofer

Connectivity

Number of HDMI connections: 4

HDMI features: 4K, Audio Return Channel, Supports HDMI ALLM (HDMI2.1)

Number of component in (YPbPr): 1

EasyLink (HDMI-CEC): Remote control pass-through, System audio control, System standby, One touch play

Number of USBs: 2

Wireless connection: Bluetooth 4.2, Wi-Fi 802.11ac, 2x2, Dual band

Other connections: Digital audio out (optical), Ethernet-LAN RJ-45, Audio L/R in, Headphone out

HDCP 2.2: Yes on all HDMI

Power

Mains power: AC 220 – 240 V 50/60Hz

Ambient temperature: 5 °C to 35 °C

Power Saving Features: Auto switch-off timer, Light sensor, Picture mute (for radio), Eco mode

Accessories

Included Accessories: Legal and safety brochure, Mini-jack to L/R cable, Mini-jack to YPbPr cable, Power cord, Quick start guide (x1), Table top stand, 2 x AAA Batteries, Remote Control

Dimensions

Box depth: 160 mm

Product weight: 22.0 kg

Set Width: 1227.8 mm

Set width (with stand): 1227.8 mm

Wall mount compatible: 300 x 300 mm

Box height: 867.0 mm

Box width: 1400.0 mm

Set Height: 705.6 mm

Weight incl. Packaging: 27.8 kg

Set Depth: 49.3 mm

Set height (with stand): 720.1 mm

Set depth (with stand): 230.0 mm

Product weight (+stand): 22.5 kg



* EPG and actual visibility (up to 8 days) is country and operator dependent.

* Android App offerings vary per country. For more details please visit your local Google Play Store.

* The TV supports DVB reception for 'Free to air' broadcast. Specific DVB operators may not be supported. An up to date list can be found in the FAQ section of the Philips support website. For some operators Conditional Access and subscription are required. Contact your operator for more information.

* Philips TV Remote app and related functionalities vary per TV model, operator, and country, as well as smart device model and OS. For more details please visit: www.philips.com/TVRemoteapp.

* Smart TV app offerings vary per TV model and country. For more details please visit: www.philips.com/smarttv.

* Its functionality is subject to ChromeCast built-in apps and smart devices. For more details, please visit ChromeCast built-in product pages.