



Philips 6900 series  
Android Smart LED TV

**80 cm (32")**

LED TV  
Android / AI voice control



**32PHT6917**

## Fits anywhere. Fine-looking it is.

### Android Smart LED TV

Looking for the best TV for a smaller apartment or room? This Philips TV looks great wherever you place it. The picture is sharp, the sound is clear, and that's simply smart, Philips Android TV.

#### **Android TV-content at your command**

- Google Assistant. Control the TV with your voice.
- Google Play store. More to love
- Simply smart. Android TV.

#### **Beautiful light. Great picture.**

- Lively viewing. Philips HD LED TV.

#### **Rich sound. Feel more.**

- Deep bass and crystal-clear dialogue.

# PHILIPS

# Highlights

## Google Assistant

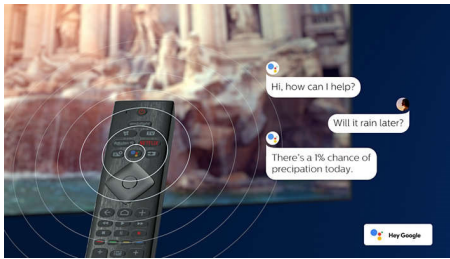

Control your Philips Android TV with your voice. Want to play a game, watch Netflix, or find content and apps in the Google Play store? Just tell your TV. You can even command all Google Assistant-compatible smart home devices-like dimming the lights and setting the thermostat on movie night. Without leaving the sofa.

## TV content

Go beyond traditional TV programming with Google Play Store . Experience endless movies, TV, music, apps and games online. More to love.

## DTS HD

DTS HD optimizes sound processing by preserving the original sound content so that you can enjoy a better sound from your speakers with crystal-clear dialog.

## LED TV

Delight in everything you watch with a Philips HD LED TV. The TV's processing engine optimizes picture quality to deliver sharp images, rich colors, and smooth motion. You get lively viewing experience every time.

## Android TV



Your Philips Android TV gives you the content you want-when you want it. You can customize the home screen to display your favorite apps, making it simple to start streaming the movies and shows you love. Or pick up where you left off.

# Specifications

## Picture/Display

- Aspect ratio: 16:9
- Display: LED HD TV
- Panel resolution: 1366 x 768p
- Picture enhancement: HDR10, HLG (Hybrid Log Gamma), Pixel Plus HD

## Supported Display Resolution

- Computer inputs on all HDMI: HDR supported, HDR10/ HLG
- Video inputs on all HDMI: HDR supported, HDR10/HLG (Hybrid Log Gamma)

## Tuner/Reception/Transmission

- Digital TV: DVB-T/T2
- Video Playback: PAL, SECAM, NTSC
- Interactive TV: meWatch Red Button
- MPEG Support: MPEG2, MPEG4
- TV Program guide\*: 8 day Electronic Program Guide
- Signal strength indication
- HEVC support

## Android TV

- OS: Android TV™ 10 (Q)
- Pre-installed apps: YouTube, Amazon Prime Video, Netflix, Disney+, Google Play Movies\*, Google Play Music\*, Google Search, YouTube Music, meWATCH app
- Memory size(Flash): 8GB

## Smart TV Features

- Program: Pause TV, USB recording\*
- SmartTV apps\*: Netflix TV, Online video stores, Open internet browser, TV on demand, Youtube
- Ease of Use: One-stop smart menu button, Onscreen usermanual
- Firmware upgradeable: App upgrade in background, Firmware auto upgrade wizard, Firmware upgradeable via USB, Online firmware upgrade
- Screen Format Adjustments: Advance - Shift, Basic - Fill Screen, Fit to screen, Wide screen, Zoom, stretch
- Remote Control: with Voice
- Voice assistant\*: Google Assistant built-in, RC with Mic.

## Multimedia Applications

- Video Playback Formats: Containers: AVI, MKV,

- H264/MPEG-4 AVC, MPEG-1, MPEG-2, MPEG-4, VP9, AV1, HEVC (H.265)
- Music Playback Formats: AAC, MP3, WAV, WMA (v2 up to v9.2), WMA-PRO (v9 and v10)
- Subtitles Formats Support: .SML, .SRT, .SUB, .TXT, .ASS, .SSA
- Picture Playback Formats: JPEG, GIF, PNG, HEIF, BMP

## User Interaction

- Remote Control: Voice\*
- Program: USB Recording\*
- Electronic Program Guide\*: 8days Electronic Program Guide

## Sound

- Output power (RMS): 10W
- Speaker configuration: 5Wx2 speaker
- Sound Enhancement: Auto Volume Leveler, Clear Dialogue, Dolby Atmos, Dolby Bass Enhancement

## Connectivity

- Number of HDMI connections: 3
- HDMI features: Audio Return Channel
- EasyLink (HDMI-CEC): One touch play, Remote control pass-through, System audio control, System standby
- Number of USBs: 2
- Wireless connection: Bluetooth 5.0, Wi-Fi 802.11n, 2x2, Dual band
- Other connections: Headphone out, Antenna IEC75, Service connector, AV in, Digital audio out (optical), Ethernet-LAN RJ-45
- SPDIF digital sound output: 1 (Optical)
- HDMI ARC: Yes on HDMI1

## Power

- Mains power: AC 110--240 V 50/60Hz
- Ambient temperature: 5 °C to 35 °C
- Standby power consumption: <0.3W
- Power Saving Features: Auto switch-off timer, Eco mode, Light sensor, Picture mute (for radio)

## Accessories

- Included accessories: 2 x AAA Batteries, Power cord, Quick start guide, Legal and safety brochure, Table top stand, Remote Control

## Dimensions

- Set Width: 716 mm

- Set Height: 425 mm
- Set Depth: 76 mm
- Product weight: 3.98 kg
- Set width (with stand): 716 mm
- Set height (with stand): 453 mm
- Set depth (with stand): 166 mm
- Product weight (+stand): 4.02 kg
- Box width: 798 mm
- Box height: 516 mm
- Box depth: 133 mm
- Weight incl. Packaging: 5.5 kg
- Distance between 2 stands: 573 mm
- Wall mount dimensions: 100 x 100 mm



## Connections

### Side



HDMI 3



USB 2  
5.0V---500mA



USB 1  
5.0V---500mA

### Down



HDMI 1  
ARC



HDMI 2



TV ANTENNA



HEADPHONE



NETWORK



DIGITAL  
AUDIO OUT



Issue date 2024-07-24

Version: 14.14.2

EAN: 87 18863 03556 6

© 2024 Koninklijke Philips N.V.  
All Rights reserved.

Specifications are subject to change without notice.  
Trademarks are the property of Koninklijke Philips N.V.  
or their respective owners.

[www.philips.com](http://www.philips.com)

\* EPG and actual visibility (up to 8 days) is country and operator dependent.

\* Smart TV app offerings vary per TV model and country. For more details please visit: [www.philips.com/smarttv](http://www.philips.com/smarttv).

\* Philips TV does not guarantee 100% interoperability with all HDMI CEC devices

\* Its functionality is subject to ChromeCast built-in apps and smart devices. For more details, please visit ChromeCast built-in product pages.

\* Amazon Prime is available in selected languages and countries.

\* Disney+ subscription required. Subject to terms at <https://www.disneyplus.com> (c) 2020 Disney and its related entities.

Disney+ is available in selected languages and countries.

\* Netflix subscription required. Subject to terms at <https://www.netflix.com>

\* Image depicted on the website are non-contractual pictures. Please always refer to the actual TV that are sold in the retail or stores.

\* Due to the transmission limitations of Bluetooth wireless technology, a slight sound delay might occur when you hear audio from your bluetooth headphone or bluetooth speakers. When this occurs, you might see the character moving his or her mouth but there is a slight delay in spoken dialog accompaniment