

43PUG7408/78  
50PUG7408/78  
55PUG7408/78  
65PUG7408/78  
70PUG7408/78

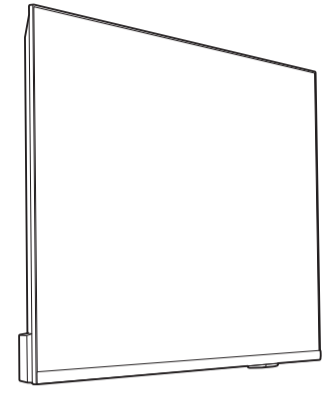

43"/50"/55"  
65"

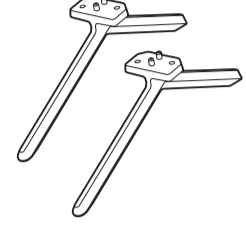

70"

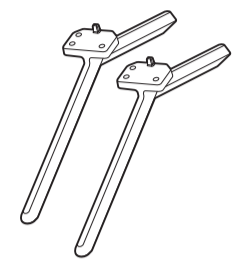

x4

43" (Q4xL18) : x4  
50"/55" (Q4xL20) : x4  
65" (M4xL20) : x4  
70" (M5xL22) : x6

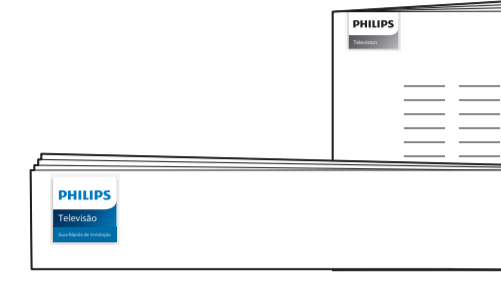
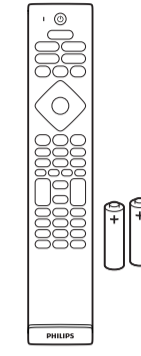
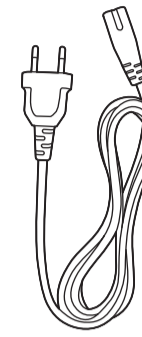

A

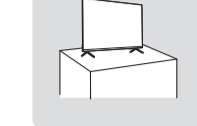

B

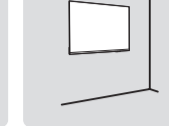

Registre seu produto e obtenha suporte em [www.philips.com/TVsupport](http://www.philips.com/TVsupport)

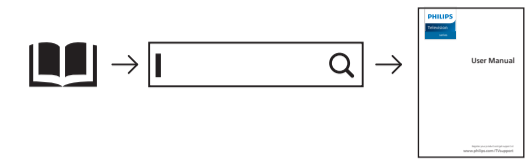

#### A 1a 43"/50"/55"

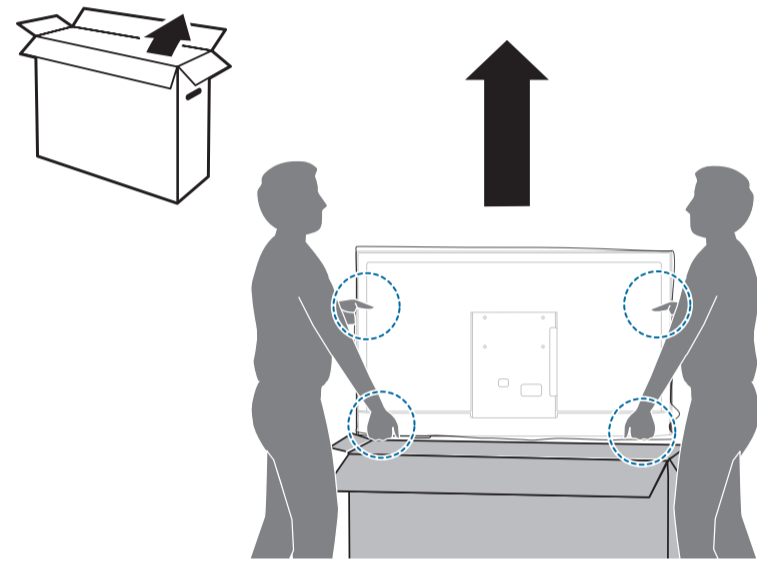

#### 1b 65"/70"

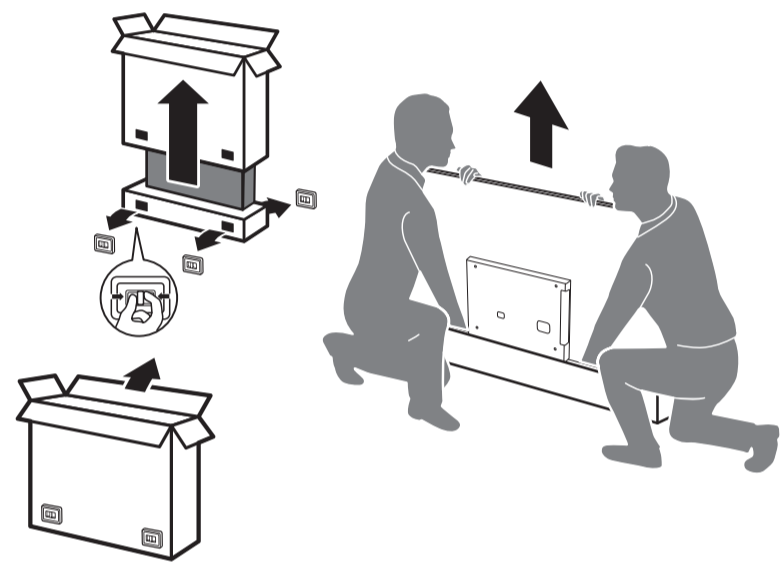

#### 2

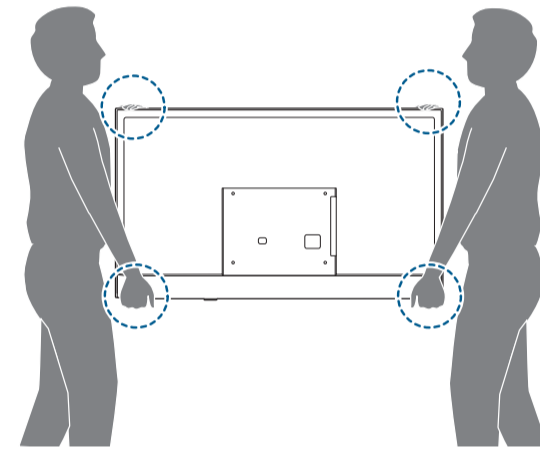
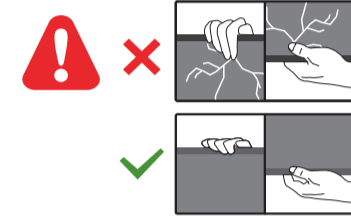

#### 3

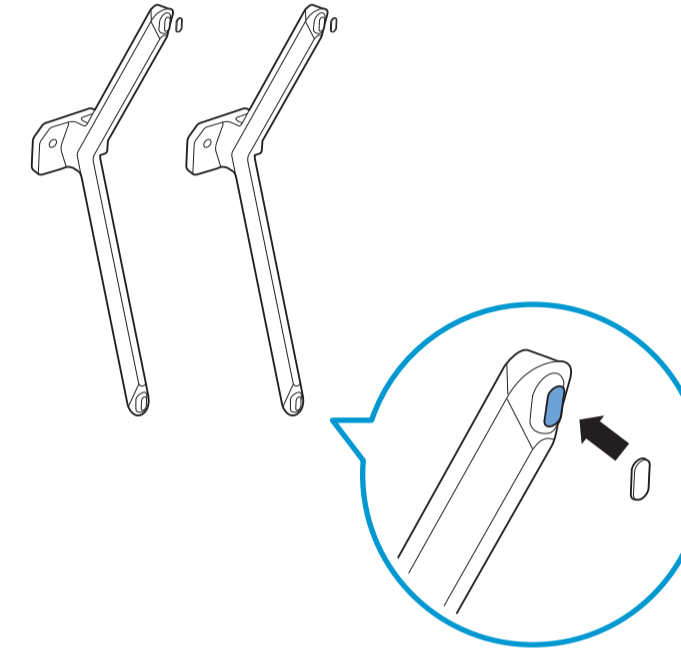

#### B

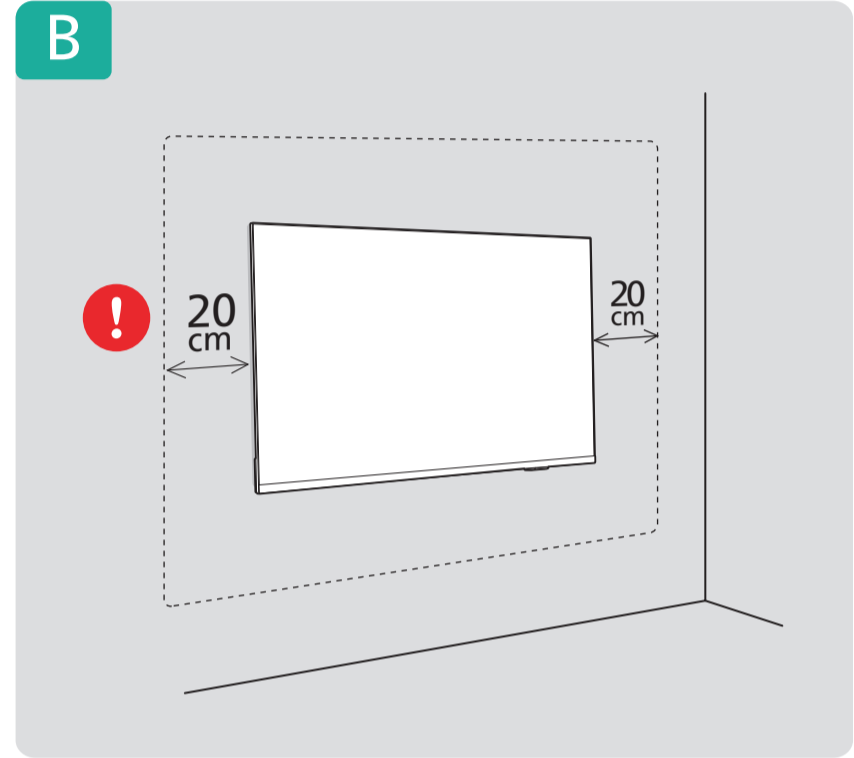

#### 4

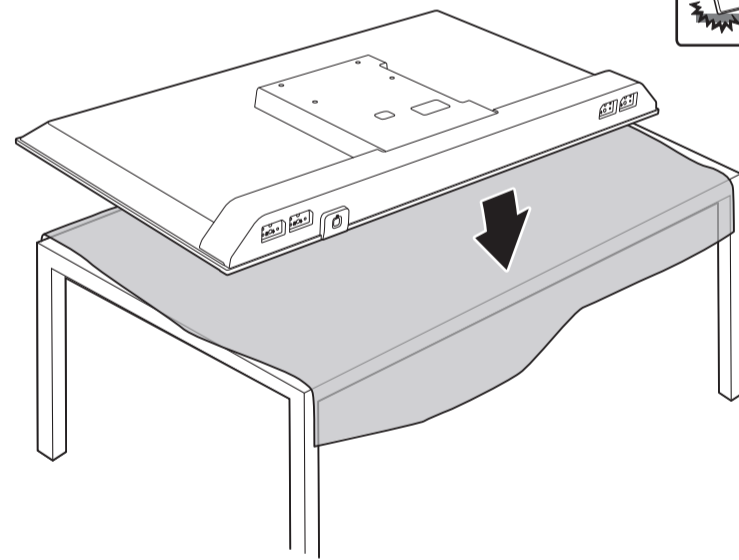
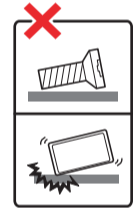

#### 5

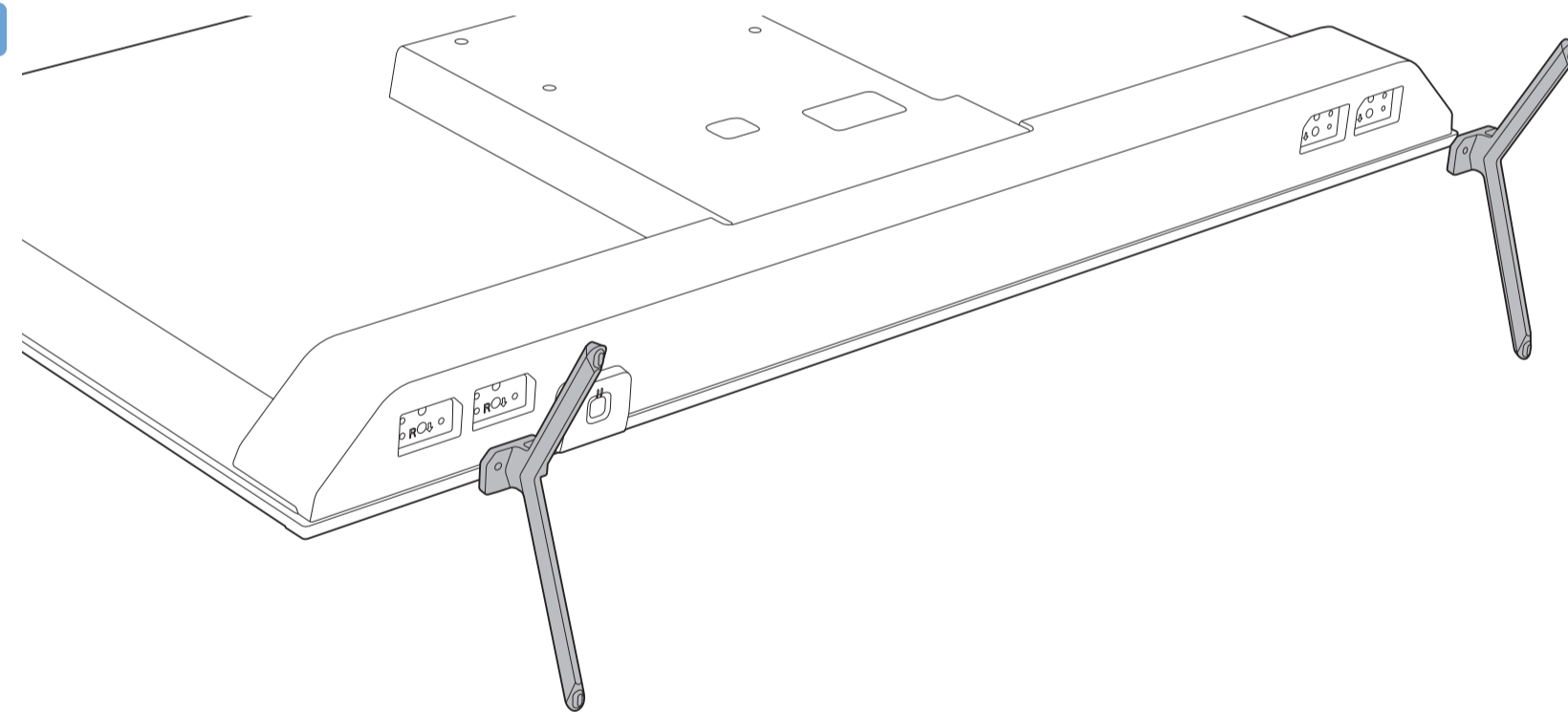

R + L

43"/50"  
55"/65"

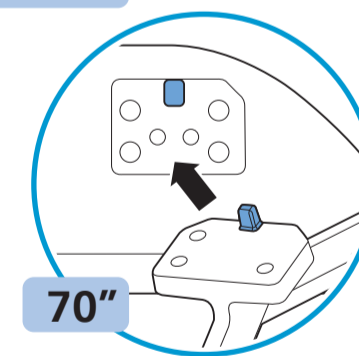
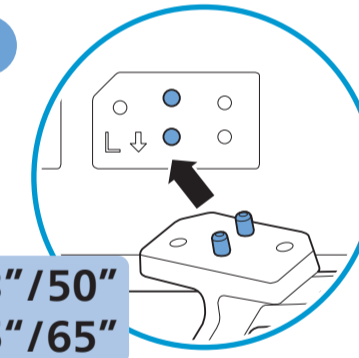

70"

#### Dimensões para montagem na parede (x, y)

43"	200x100mm M6 (L: 8mm~10mm)	108 cm
50"	200x100mm M6 (L: 8mm~10mm)	126 cm
55"	200x100mm M6 (L: 8mm~10mm)	139 cm
65"	400x300mm M8 (L: 12mm~22mm)	164 cm
70"	300x300mm M8 (L: 12mm~20mm)	177 cm

#### 6

43"/70"

50"/55"/65"



R + L

43"/50"  
55"/65"

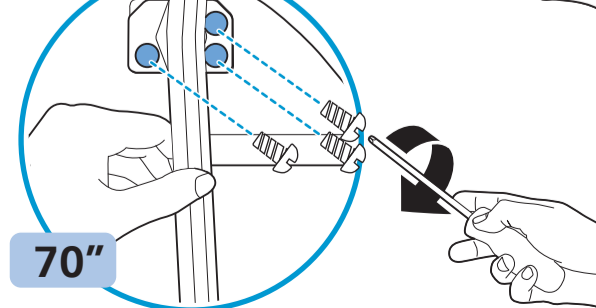
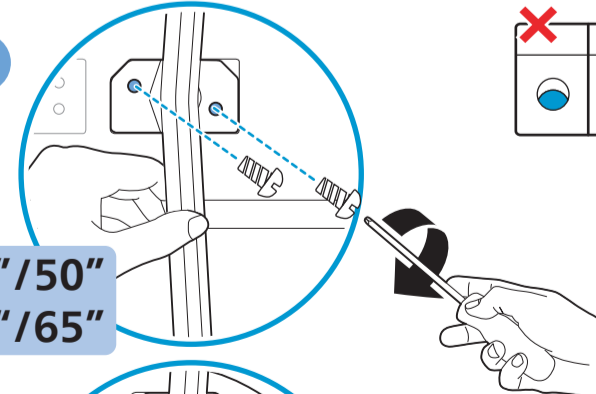

70"

#### 7

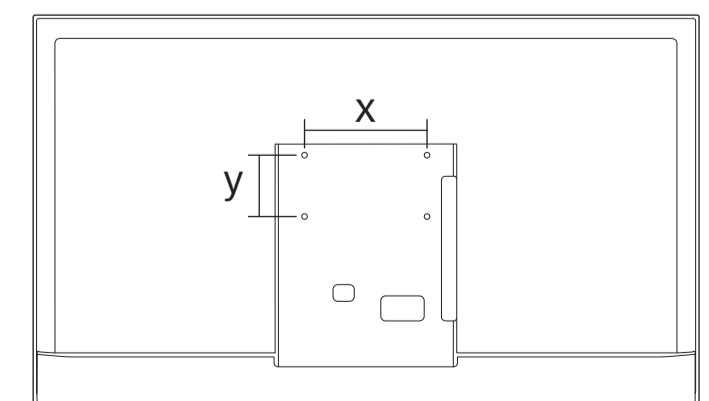
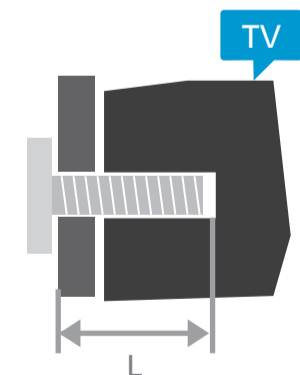
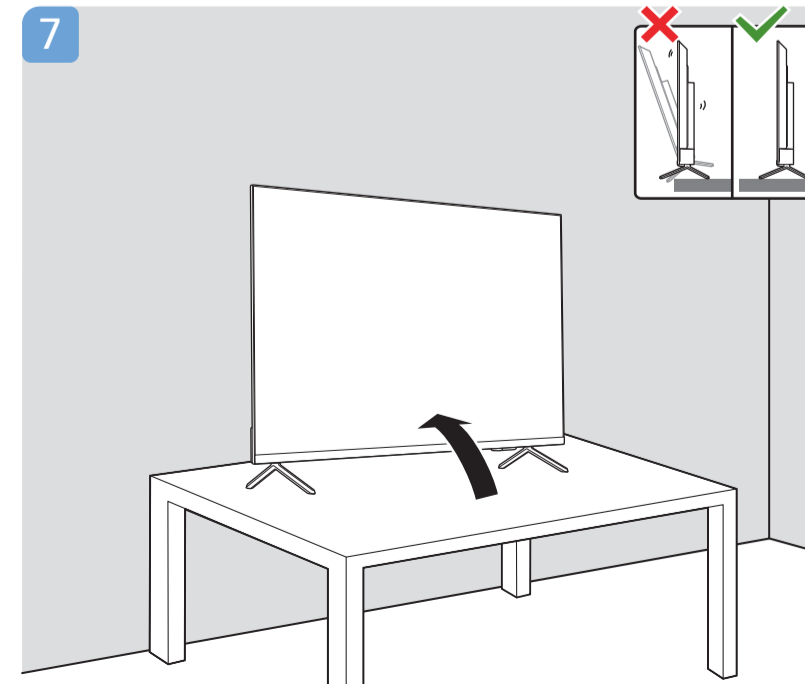

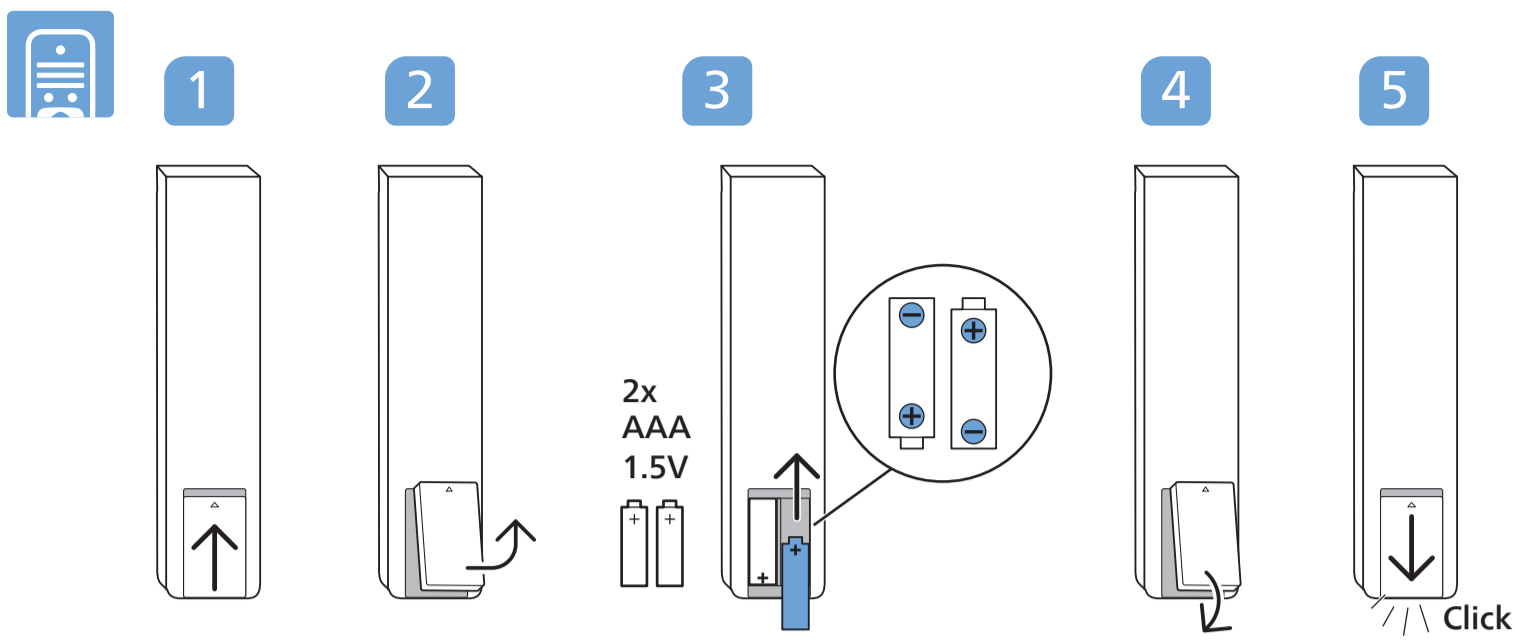

	A	B
43"	75.2	23.7
50"	92.6	25.8
55"	104.2	25.8
65"	126.3	30.0
70"	138.6	33.9

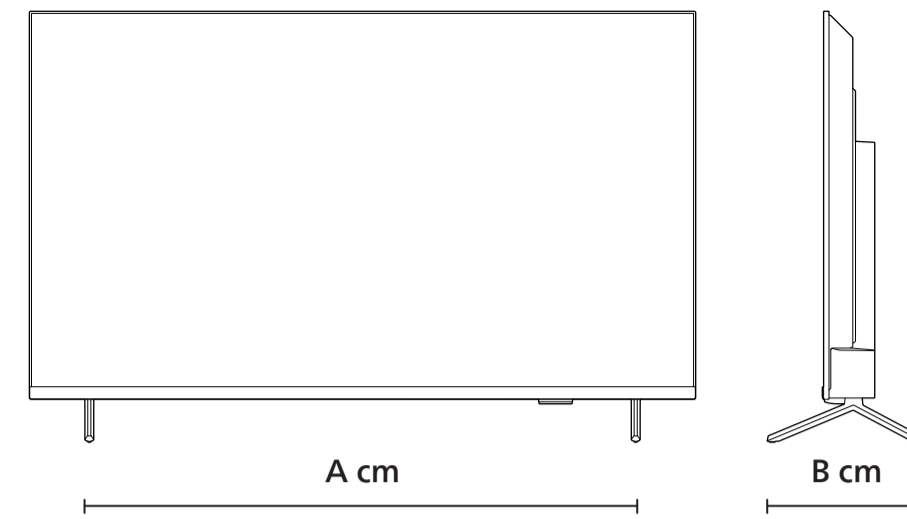

English Read the safety instructions.  
Português Leia as instruções de segurança.



43"/50"/55"/65"

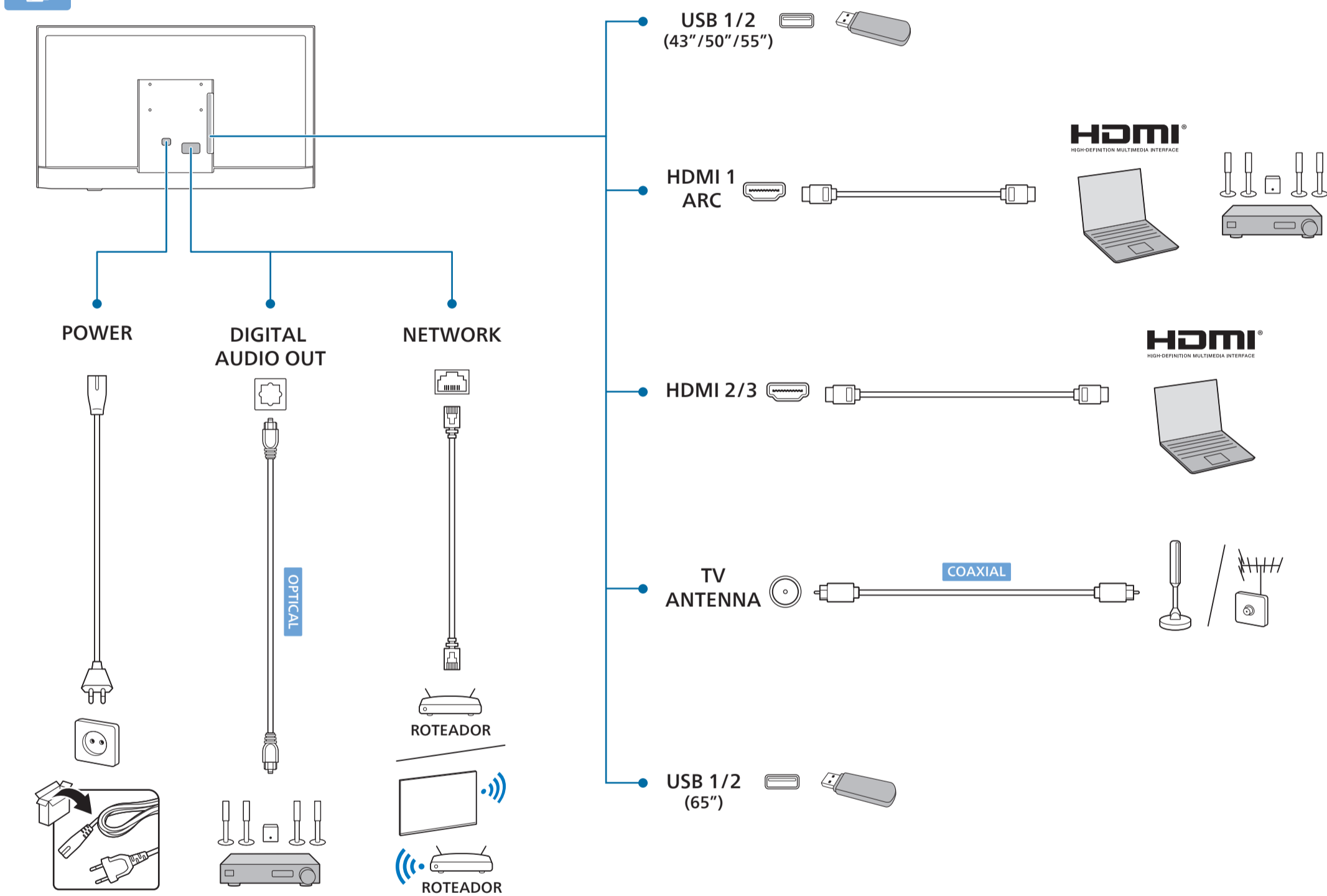

70"

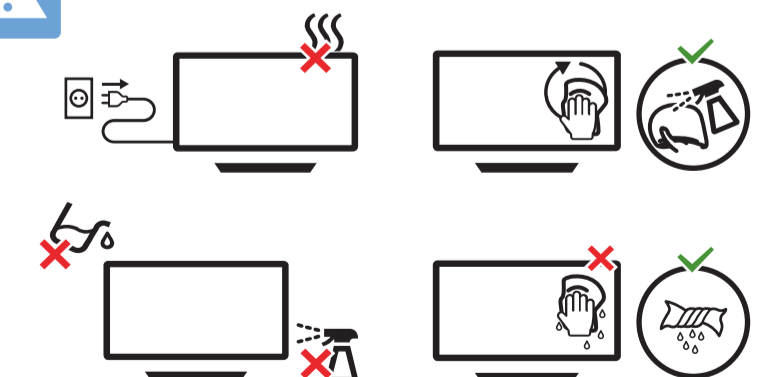
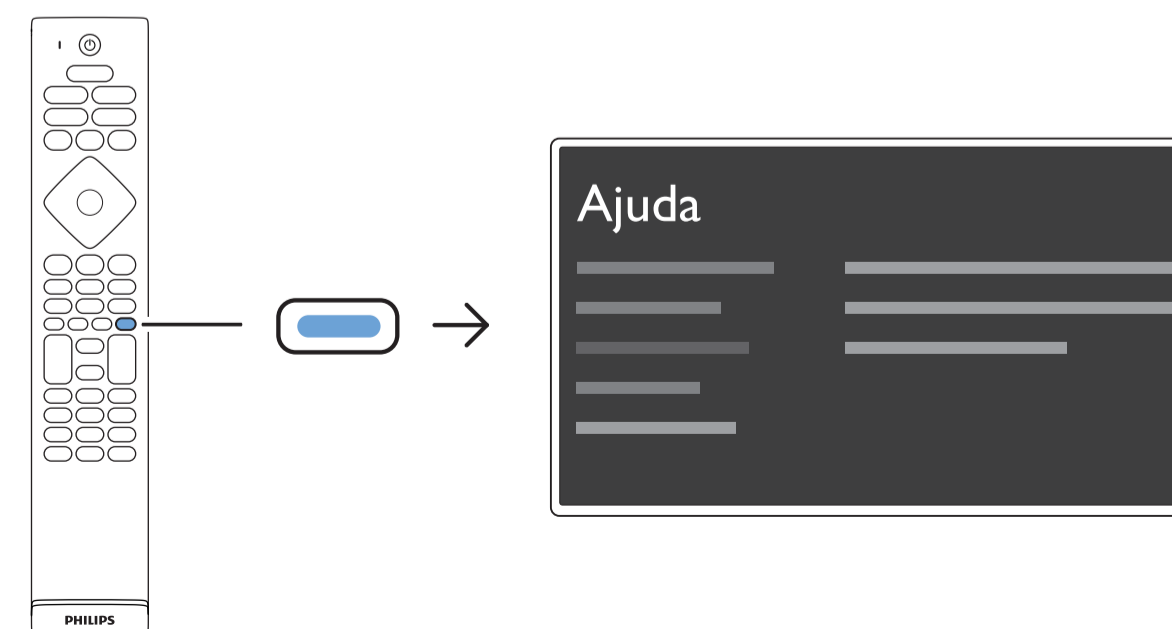
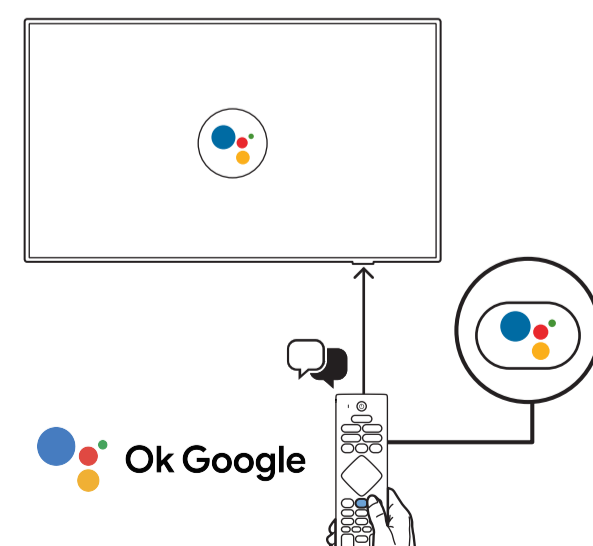
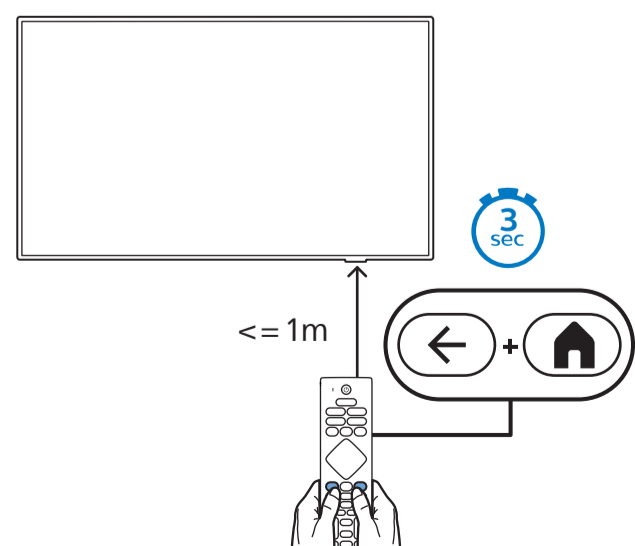
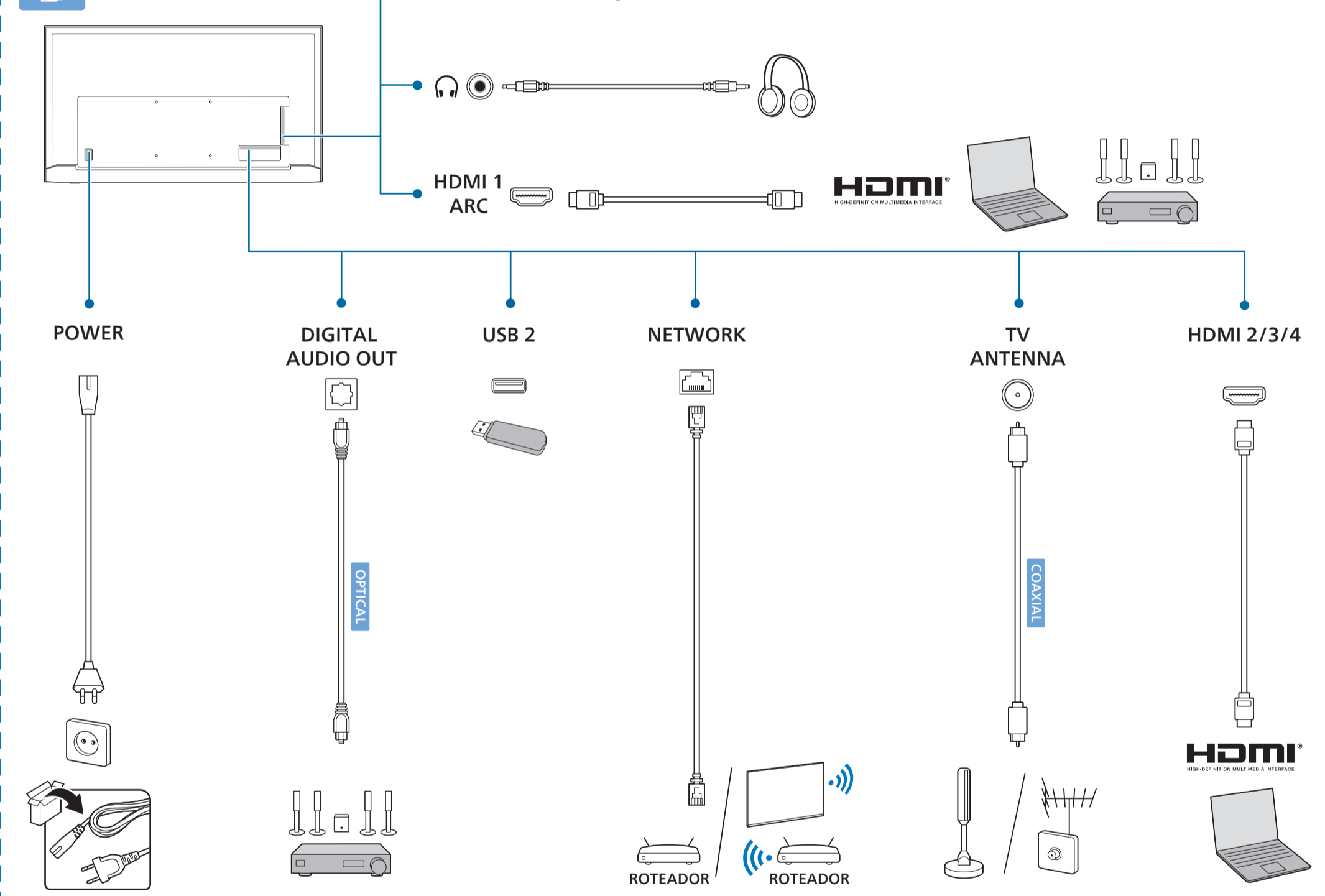

All registered and unregistered trademarks are property of their respective owners. Specifications are subject to change without notice. Philips and the Philips' shield emblem are trademarks of Koninklijke Philips N.V. and are used under license from Koninklijke Philips N.V. This product has been manufactured by and is sold under the responsibility of TP Vision Europe B.V., and TP Vision Europe B.V. is the warrantor in relation to this product. 2023 © TP Vision Europe B.V. All rights reserved. www.philips.com/welcome