

# PHILIPS

## AquaTrio Cordless

双滚刷无线智能洗地机

7000系列

XW7110





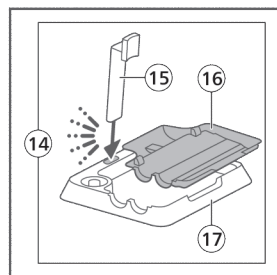
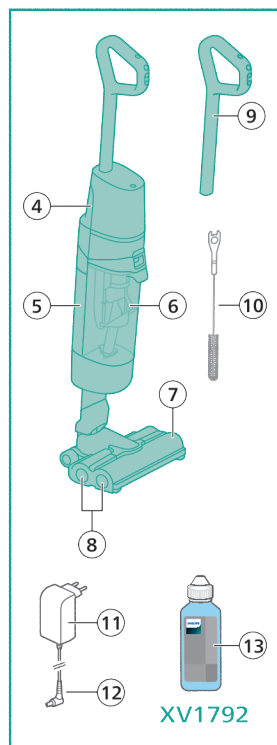
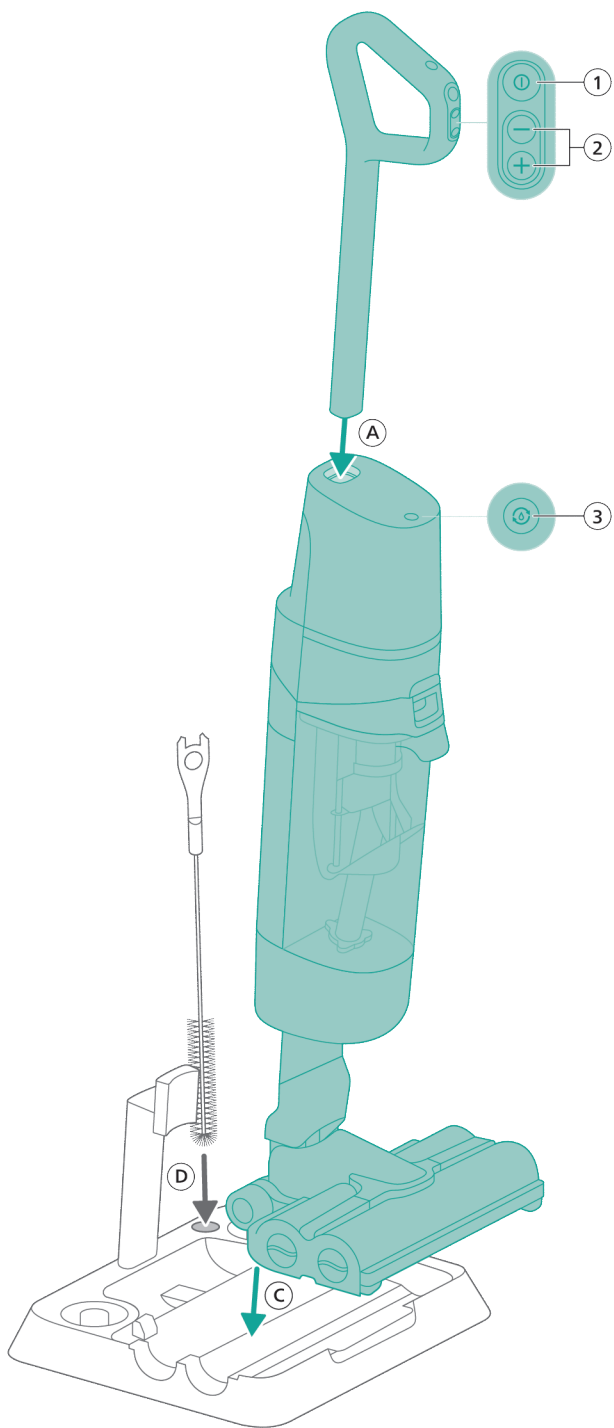



**English 6**  
**简体中文 29**

# Contents

Introduction	6
General description	6
Before first use	6
Charging	8
Vacuuming and mopping hard floors	9
Display icons and their meaning	21
Replacement	23
Troubleshooting	23

## Introduction

Thanks for buying this Philips product! To fully benefit from the support that Philips offers, register your product at [www.philips.com/MyAquaTrio7000s](http://www.philips.com/MyAquaTrio7000s)

## General description

- 1 On/off button
- 2 + and - buttons
- 3 AUTOCLEAN button
- 4 Charging socket including sealing cap
- 5 Clean water tank
- 6 Dirty water tank
- 7 AquaSpin nozzle
- 8 Microfiber brushes
- 9 Handle
- 10 Cleaning brush
- 11 Adapter
- 12 Power plug
- 13 Philips Floor Cleaner XV1792
- 14 After-Clean & Storage station
- 15 Appliance holder
- 16 After-Clean tray
- 17 Baseplate

## Before first use

### Assembling the After-Clean & Storage station

In order to use the AUTOCLEAN function or store and charge the appliance on the After-Clean & Storage station, you need to first assemble the station by clicking the appliance holder into the baseplate.

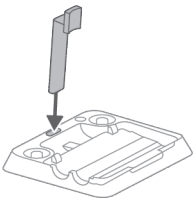

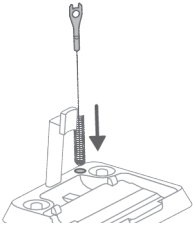

**i** Note: Make sure that the After-Clean tray is placed in the baseplate and that the temperature in the room where the appliance is stored, charged and cleaned is between 5 °C and 35 °C.

**i** Note: you can store the cleaning brush in the After-Clean tray as well.



**1** To assemble the appliance, insert the handle into the main body ('click').

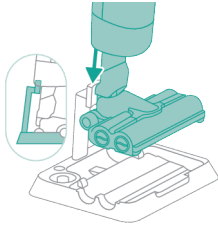

**2** To store the appliance, you can place it in the After-Clean & Storage station. Slide the appliance on to the appliance holder so that the end of the appliance holder sticks into the appliance.

If you need to disassemble the appliance again, follow the steps below:

**1** Insert a pin/flat screwdriver into the hole in the back of the appliance and pull up the handle.

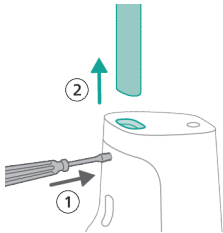

**2** Pull the handle out of the appliance while continuing to push the screwdriver into the hole.



# Charging

The appliance is equipped with a 25 V Li-Ion battery. Charging takes 4 hours.

**1** To charge the appliance, open the sealing cap on the back of the appliance.



**2** Insert the power plug into the socket on the back of the appliance. Then insert the adapter into the wall socket.

**3** A value between 0% and 90% flashes on the screen to indicate that the appliance is charging.

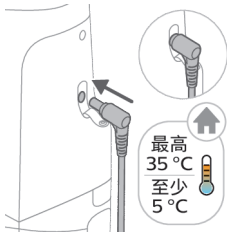

**4** When the appliance is fully charged, the value 100% lights up on the screen. After a few minutes, the display will switch off.

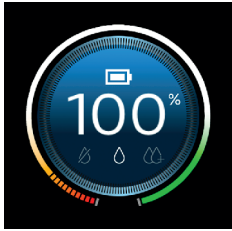

**5** Remove the power plug from the socket on the back of the appliance.

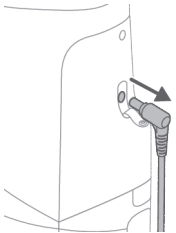

**6** Close the sealing cap.



**⚠ Warning: Store and charge the appliance at a temperature above 5 °C and below 35 °C.**



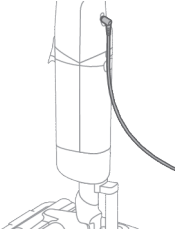

**Tip:** You can charge the appliance in the After-Clean & Storage station.

**Tip:** You can charge the appliance separately in a place that suits you best.

## Vacuuming and mopping hard floors

### Using the appliance

The clean water tank and the dirty water tank are already attached to the appliance upon delivery. You can use the appliance to clean hard floors.

**1** Note: This appliance is suitable for vacuuming and mopping at the same time. It is not necessary to vacuum the floor before mopping.

The appliance is suitable for vacuuming and mopping all types of hard floors, except uncoated wooden floors. You can test the appliance on a small area out of direct view, to make sure that the appliance is suitable for your floor.

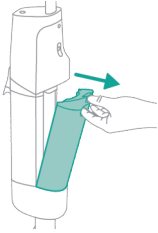

**1** Push the button down to unlock the clean water tank and remove the clean water tank.



**2** Open the cap on the clean water tank.



- 3 Add 15 ml of the XV1792 Philips Floor Cleaner to the clean water tank.

**⚠ Caution:** Philips has only tested this appliance with XV1792 Philips Floor Cleaner. Other detergents may lead to excessive foaming, which reduces performance and may cause the appliance to malfunction. XV1792 Philips Floor Cleaner is available in selected markets. When using any other suitable liquid floor cleaner, add a maximum of 20 ml to the clean water tank.

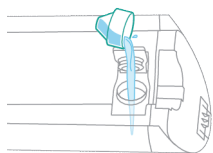

- 4 Fill the clean water tank up to the top with cold or lukewarm tap water.

**⚠ Caution:** The tap water that is poured into the clean water tank must not be warmer than 50°C.



- 5 Close the water tank with the sealing cap.

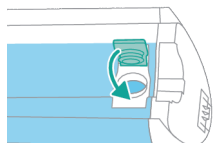

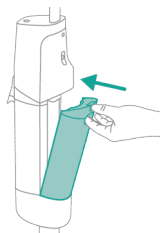

- 6 Place the clean water tank back into the appliance.

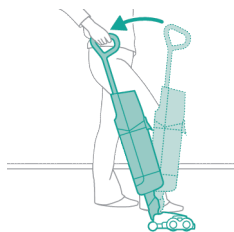



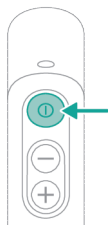

- 7 Take the appliance out of the After-Clean & Storage station and place it on the floor. Put your foot on the AquaSpin nozzle and pull the handle backwards to unlock the AquaSpin nozzle. The appliance is now ready for use.





- 8 To switch on the appliance, press the on/off  button. The appliance will turn on.

**⚠ Caution: do not leave the appliance unattended when the AquaSpin nozzle is unlocked or when the appliance is switched on.**





- 9 Use the + and - buttons to toggle between three different settings:
-  Water absorption mode
  -  Normal wet mode
  -  Intense wet mode

By selecting the normal wet mode , you can use the appliance for regular wet cleaning. The intense wet mode  is for cleaning extra stubborn stains.

If there are wet spots on the floor after cleaning, you can select water absorption mode  to clean them up. We also recommend using it when lifting the appliance over a threshold, carpet or stairs.

If you select water absorption mode , the appliance will stop supplying water and increase suction power for 45 seconds to clean up remaining water on the floor.



- 10 When you are done using the appliance, switch it off by pressing the on/off  button. The appliance will switch to water absorption mode  for 4 seconds to clean up any water remaining in the nozzle.

**i** Note: The appliance can leave a small puddle of water on the floor if you do not move the appliance while switching it off. You can reduce the size of the puddle by moving the appliance while switching it off. If needed, you can remove the last drops with a cloth.

## Active protection system

- This appliance is equipped with an active protection system. This active protection system has been designed to recognize when a foreign object other than dirt or liquid is picked up from the floor.
- When the system is activated, the appliance switches off and the i3 message appears on the display (see 'Display icons and their meaning'). The active protection system can also be activated when the microfiber brushes are too wet, when you move the appliance over a carpet or a rug, or when you move it over flooring that is not properly affixed.

## Tips and other important information

- It is not necessary to vacuum the floor before mopping, as the appliance actively wet-cleans your hard floor to capture all kinds of dirt, including liquids and stains.
- You can move the appliance just like a vacuum cleaner. To remove difficult stains, click the cleaning mode button to activate intense wet mode  and move the appliance slowly over the stains.
- The appliance can leave a small puddle of water on the floor when you switch it off. You can reduce the size of the puddle by moving the appliance while switching it off to reduce the amount of water left on the floor. It is also recommended to use water absorption mode  when lifting the appliance over a threshold, carpet or stairs. This will prevent dirty water from dripping out of the AquaSpin nozzle.
- To prevent water traces on the floor, try to make less strong turns with your appliance and avoid moving the appliance sideways.
- When moving the appliance, it is recommended to stretch your arm to reduce unnecessary tension on the muscles. In this position, you have the best control over the appliance when cleaning, and it will be the most comfortable.

## Usage restrictions

- The appliance is suitable for vacuuming and mopping all types of hard floors, except uncoated wooden floors.
- The appliance is intended for regular cleaning of hard floors. Always follow the cleaning instructions for your hard floor when you use this appliance.
- If you want to add a liquid floor cleaner other than XV1792 Philips Floor Cleaner to the water in the clean water tank, make sure that you use a low-foaming or non-foaming liquid floor cleaner that can be diluted in water like XV1792 Philips Floor Cleaner.
- As the clean water tank has a capacity of 700ml, you only have to add a small amount (max 15ml) of liquid floor cleaner to the water.
- If you use the appliance on linoleum floors, only do so on linoleum floors that are properly affixed to prevent linoleum from being drawn into the AquaSpin nozzle.
- Do not use the appliance to clean carpets.
- If you move/lift the appliance over a carpet or rug when it is switched off, wastewater droplets may end up on your carpet or rug.
- Do not push the appliance over the floor grilles of convector heaters. As the appliance cannot pick up water that comes out of the nozzle when you move it over the grille, water ends up at the bottom of the convector pit.
- While cleaning, do not lift the AquaSpin nozzle from the floor or move the AquaSpin nozzle sideways, and do not make strong turns, as this leaves water traces.

**i** Note: The operating time depends on the power level used during cleaning.

# Cleaning the appliance

## AUTOCLEAN after every use

To prevent odors and scale deposits, use the AUTOCLEAN function after every use. The AUTOCLEAN mode helps you to clean your full appliance in approximately 4 minutes.

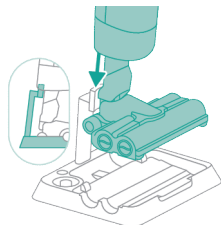

- 1 Place the appliance in the After-Clean & Storage station. Slide the appliance on to the appliance holder so that the end of the appliance holder sticks into the appliance.

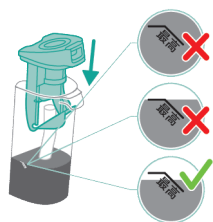

**i** Note: Empty the dirty water tank if the water level is above the AUTOCLEAN indication. Otherwise, you can skip the following steps and move forward to step 6.

- 2 Push the button to unlock the dirty water tank and remove it.

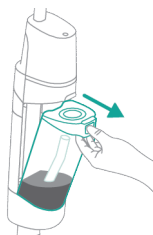

- 3 Remove the wet filter from the dirty water tank.



- 4 Pour the water out of the dirty water tank into the sink.

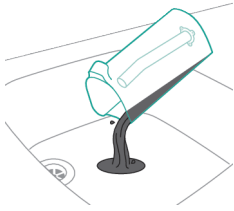

- 5 Place the wet filter back on the dirty water tank.

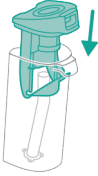

- 6 Fill the clean water tank if the water level is below the AUTOCLEAN indication. Otherwise, you can skip the following steps and move forward to step 12.

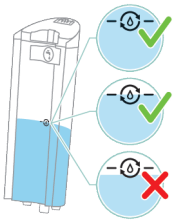

- 7 Place the empty dirty water tank back into the appliance and take out the clean water tank.

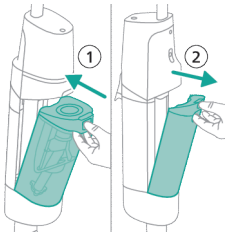

- 8 Open the sealing cap on the clean water tank.

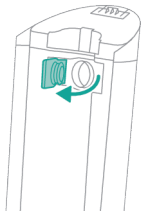

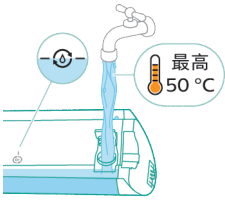

- 9 Fill the clean water tank with cold or lukewarm tap water at least up to the AUTOCLEAN indication.

**⚠ Caution: The tap water that is poured into the clean water tank must not be warmer than 50°C.**

**⚠ Caution: Do not use detergent for the AUTOCLEAN as this might lead to excessive foaming.**

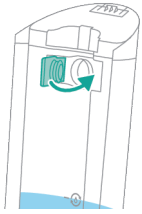

- 10 Close the clean water tank with the sealing cap.

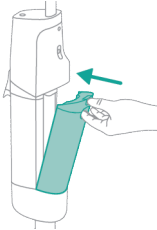



- 11 Place the clean water tank back into the appliance.

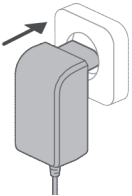

- 12 Charge the appliance. Insert the power plug into the socket on the back of the appliance. Then insert the adapter into the wall socket.

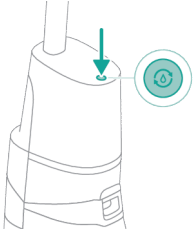



**13** To start the AUTOCLEAN cycle, press the AUTOCLEAN  button. If you see a black screen, press the on/off  button first to activate the screen.



**14** The appliance performs the AUTOCLEAN cycle.

**i** Note: The Autoclean cycle lasts approx. 4 minutes. For best results, let the appliance run through the AUTOCLEAN cycle completely. You can pause or cancel the AUTOCLEAN cycle at any time.

**i** Note: If you cancel the AUTOCLEAN program, the appliance will suck up the remaining water in the After-clean tray for about 10 seconds.

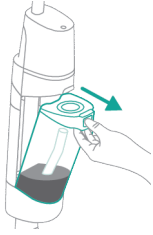

**15** Push the button to unlock the dirty water tank and remove it.

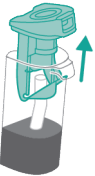

**16** Remove the wet filter from the dirty water tank.

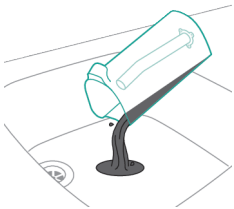

**17** Pour the water out of the dirty water tank into the sink.





**18** Clean the dirty water tank under the tap.

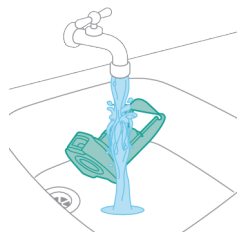

**19** Clean the wet filter under the tap.



**20** Let the wet filter of the dirty water tank and its water flow element dry completely before putting it back on the dirty water tank.

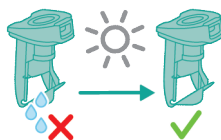

**21** Place the wet filter back on the dirty water tank.

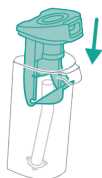

**22** Place the dirty water tank back into the appliance.



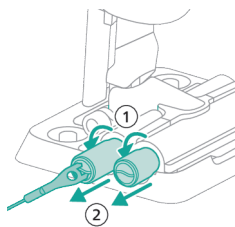

**23** Turn the microfiber brushes counterclockwise (1) and remove them from the AquaSpin nozzle (2).

**Tip:** In case a microfiber brush is difficult to remove, you can use the cleaning brush handle to unlock the microfiber brush.

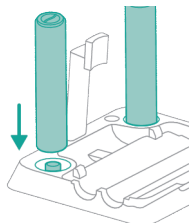

**24** To allow the microfiber brushes to dry, place the open ends of the brushes on the designated holders of the After-Clean & Storage station.

**Note:** Drying can take approximately 24 hours.

## Cleaning the After-Clean tray

If the After-Clean tray gets dirty, you can clean it by following the steps below.

**1** Remove the After-Clean tray from the storage station.

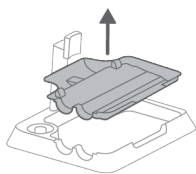

**2** Rinse the After-Clean tray under the tap and let it dry before placing it back in the Storage station.

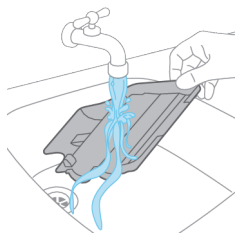

**3** Make sure to always put the After-Clean tray back in the Storage station. The After-Clean tray is essential to perform the AUTOCLEAN correctly.

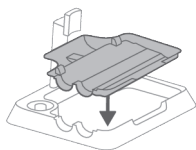

## Cleaning the AquaSpin nozzle

- 1 Turn the microfiber brushes counterclockwise (1) and remove them from the AquaSpin nozzle (2).

 Tip: In case a microfiber brush is difficult to remove, you can use the cleaning brush handle to unlock the microfiber brush.

- 2 You can remove entangled hair or threads from the microfiber brushes by sliding down the microfiber brushes with one hand.

 Tip: You can also use a pair of scissors to cut hairs and threads that have become entangled around the microfiber brushes.

## Removing blockages from the appliance

The appliance may become clogged. You may notice this when more water gets on the floor than usual or when bigger dirt particles are no longer sucked up and fall back on the floor. Below you can find the instructions to remove blockages from different parts of the appliance.

### Clearing blockages from the main body

If there is a blockage in the appliance, first switch off the appliance and remove the dirty water tank. Then remove the blockage by moving the cleaning brush up and down in the suction channel of the main body.

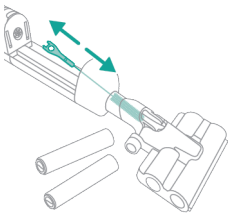
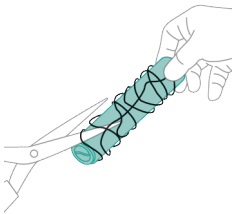
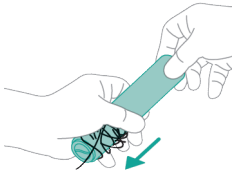
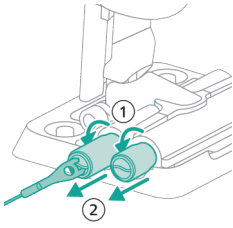

### Clearing blockages from the AquaSpin nozzle

If there is a blockage in the AquaSpin nozzle, remove the brushes from the nozzle. Then move the cleaning brush up and down in the suction channel of the AquaSpin nozzle.

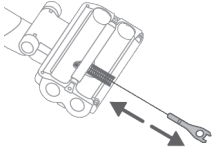

### Clearing blockages from the wetting strips of the AquaSpin nozzle

After long and frequent use of the appliance, the wetting strips of the AquaSpin nozzle may become clogged at some point. Follow the steps below to clear the blockage of the wetting strips of the AquaSpin nozzle.

- 1 Remove the wetting strip covers from the AquaSpin nozzle by moving them sideways.

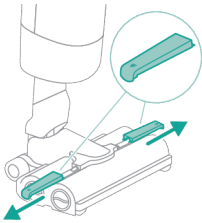

- 2 Remove the wetting strips from the AquaSpin nozzle by pulling them out sideways.

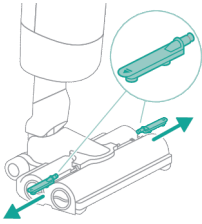

- 3 Rinse the wetting strips under the tap.

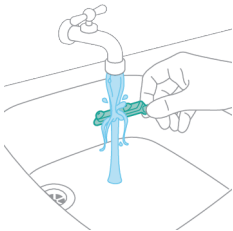



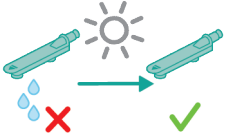

- 4 Let the wetting strips dry before placing them back in the AquaSpin nozzle.



## Display icons and their meaning

Error code	Cause	Solution
 <p>E1</p>	There is a system error.	<p>Disconnect the appliance from the adapter and then reconnect the appliance to the adapter. Then try to restart the appliance.</p> <p>If the solution does not work, please take the appliance to a Philips service center or contact the Consumer Care Center.</p>
 <p>E2</p>	The temperature is too low.	<p>Make sure the temperature in the room where the appliance is used, stored, or charged is above 5 °C. If the device is used and stored at the correct temperature and still shows the error code, please take it to a Philips service center or contact the Consumer Care Center.</p>
 <p>E3</p>	The temperature is too high.	<p>Make sure the temperature in the room where the appliance is used, stored, or charged is below 35 °C. Do not expose the device to direct sunlight or high temperatures (near hot stoves, in microwave ovens, or on induction cookers). If the device is used and stored at the correct temperature and still shows the error code, please take it to a Philips service center or contact the Consumer Care Center.</p>

## Information code

## Cause

## Solution



The dirty water tank is full.

Empty the dirty water tank.



The AquaSpin nozzle is stuck. This is a safety cut-off if something is stuck in the nozzle (for instance, a power cable or a toy).

Check the brushes, bearings, motor parts, and caps for hair or other obstacles and remove them. If there are no obstacles, switching the appliance off and on might solve the problem.



The air inlet openings are blocked.

Check the air inlet openings for blockages and remove them. If this does not solve the problem, check the whole air passage for blockages and remove them. This refers to the nozzle, tube, and the wet filter.



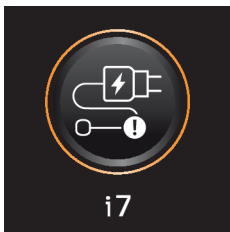

Unplug for use.

Unplug the appliance for use. Otherwise, it will not switch on. Only plug in the appliance during charging and AUTOCLEAN.



The wrong charger is connected.

Only charge the appliance with the adapter supplied. Only use 34V adapter S036-1A340100HE. The corresponding adapter number can be found on the adapter.

Icons	Meaning
	AUTOCLEAN
	Microfiber brush replacement needed

## Replacement

To buy accessories or spare parts, visit [www.philips.com/parts-and-accessories](http://www.philips.com/parts-and-accessories) or go to your Philips dealer. You can also contact the Philips Consumer Care Center in your country (see the international warranty leaflet for contact details).

Replacement parts and type numbers:

- Philips Floor Cleaner XV1792
- Replacement microfiber brushes XV1793





Replace the microfiber brushes every 6 months to ensure maximum performance.

**i** Note: You can dispose the old the microfiber brushes with the normal household waste.



## Troubleshooting

This chapter summarizes the most common problems you could encounter with the appliance. If you are unable to solve the problem with the information below, visit [www.philips.com/support](http://www.philips.com/support) for a list of frequently asked questions or contact the Consumer Care Center in your country.

Problem	Possible cause	Solution
The appliance does not work when I push the on/off  button.	The battery is empty.	To charge the battery, connect the appliance with the charger (see 'Charging').

Problem	Possible cause	Solution
	You did not take the appliance out of the After-Clean & Storage station.	Take the appliance out of the After-Clean & Storage station before switching on the appliance.
	You pushed the on/off  button more than one time.	Wait a few seconds and push the on/off  button again one more time.
	The appliance is clogged.	Switch off the appliance. Then locate and remove the cause of the blockage (see 'Removing blockages from the appliance'). After that, restart the appliance. If you cannot identify the cause of the blockage, restart the appliance. This might already solve the problem.
	The microfiber brushes are stuck.	Take the microfiber brushes out. Then locate and remove the cause of the blockage in the microfiber brushes. Then Place the microfiber brushes back (see 'Cleaning the AquaSpin nozzle').   <b>Tip:</b> In case a microfiber brush is difficult to remove, you can use the cleaning brush handle to unlock the microfiber brush.
The appliance stopped working.	You accidentally touched the on/off  button with your hand.	Switch on the appliance by pushing the on/off  button.
	The dirty water tank may be full. In this case, there is an information icon shown on the screen (see 'Display icons and their meaning').	Empty the dirty water tank.
	The appliance is clogged.	Switch off the appliance. Then locate and remove the cause of the blockage (see 'Removing blockages from the appliance'). After that, restart the appliance. If you do not identify the cause for the blockage, just restart the appliance. This might already solve the problem.
The floor is less wet than usual, or one side of the floor under the nozzle is less wet than the other one.	One or both wetting strips may be blocked.	Remove the two microfiber brushes, fill some water into the clean water tank and switch the appliance on. Make small forward and backward movements on the same position for around 15 seconds. You should be able to see four water stripes on the floor. If this is not the case, or if one or more water stripes only consist out of a few droplets, the wetting strips are partially or fully blocked and you can rinse them under the tap. If that does not help, you can try to carefully open the holes with a needle.



Problem	Possible cause	Solution
There is no water on the floor.	The clean water tank is empty.	Refill the clean water tank.
	The wetting strips are blocked.	Remove the two microfiber brushes, fill the clean water tank with some water, and switch the appliance on. Make small forward and backward movements on the same position for around 15 seconds. You should be able to see four water stripes on the floor. If this is not the case, or if one or more water stripes only consist out of a few droplets, the wetting strips are partially or fully blocked and you can rinse them under the tap. If that does not help, you can try to carefully open the holes with a needle.
		If you have checked the above and there is still no water on the floor, take the appliance to a Philips service center or contact the Consumer Care Center.
There is more water on the floor or in the After-Clean tray than usual.	The water channel of the wet module and/or AquaSpin nozzle is polluted or blocked.	Use the cleaning brush and clean the water channel of the wet module and/or AquaSpin nozzle (see 'Removing blockages from the appliance').
	The dirty water tank is not placed correctly.	Place the dirty water tank into the appliance properly. It is closed correctly when you can hear a 'click' sound.
The appliance leaves water traces on the floor.	You have moved the appliance sideways.	Only move the appliance forwards and backwards.
	You made strong turns with the appliance.	Try to make less strong turns with the appliance.
	You have moved the appliance across a threshold while it was switched on.	Make sure the microfiber brushes stay in contact with the floor. Make sure water absorption mode  is switched on before you lift the appliance over a threshold, carpet or stairs to prevent water traces on the floor or to prevent water from splashing from the AquaSpin nozzle.
	You lifted the appliance up from the floor immediately after you switched it off.	Switch on water absorption mode  to absorb remaining water. Move the appliance forwards and backwards a few times with water absorption mode  engaged before switching it off. If you switch off the appliance and lift it up immediately afterwards, the water that was present between the brushes leaves a trace of water on the floor.

<b>Problem</b>	<b>Possible cause</b>	<b>Solution</b>
	The wheels are blocked.	Check the condition of the wheels. Remove the dirt that blocks the wheels.
The appliance does not clean as well as it used to.	The clean water tank is empty.	Refill the clean water tank.
	The water strips are blocked.	Remove the two microfiber brushes, fill the clean water tank with some water, and switch the appliance on. Make small forward and backward movements on the same position for around 15 seconds. You should be able to see four water stripes on the floor. If this is not the case, or if one or more water stripes only consist out of a few droplets, the water strips are partially or fully blocked and you can rinse them under the tap. If that does not help, you can try to carefully open the holes with a needle.
	The inside of the AquaSpin nozzle is too dirty.	Run the AUTOCLEAN program before returning to cleaning. If there is dirt accumulation in the edges of the nozzle, remove it. Make sure to use the AUTOCLEAN function after each use.
	The microfiber Brushes are not present.	Place the microfiber brushes in the AquaSpin nozzle.
		If you have checked the above and the appliance still does not clean well, take it to a Philips service center or contact the Consumer Care Center.
Bigger dirt particles are not sucked up anymore and fall back on the floor.	The water channel of the wet module and/or AquaSpin nozzle is polluted or blocked.	Use the cleaning brush and clean the water channel of the main body and/or AquaSpin nozzle (see 'Removing blockages from the appliance').
The floor dries with stripes.	You may have used too much detergent.	Make sure to use the right amount of detergent.
	The wheels are dirty.	Remove the dirt from the wheels.
There is too much foam while cleaning, but also during AUTOCLEAN.	You may have used too much detergent.	Make sure to use the right amount of detergent.
	There are still detergent residues on the floor.	Clean the floor without detergent several times. Wait a moment before going over the same stain again.
It is difficult to clean stains.	You may have used too little water or taken too little time to clean the stain.	Apply water and wait a moment. For example you can go with the appliance over the stain to apply water and come back to the same stain in the end of the cleaning session.

Problem	Possible cause	Solution
The sound of the appliance changed while cleaning.	There might be hairs or other obstacles entangled around the microfiber brushes	Remove the microfiber brushes and check for obstacles and remove them.
The display indicates that the dirty water tank is full (code: i1) and shuts down, although the dirty water tank is not full yet.	There may be foam or contamination of the dirty water tank.	Restart the appliance. If that does not solve the problem, clean the dirty water tank. If foaming is the issue, make sure you do not use more than the recommended amount of detergent.
Water drips out of the appliance after it is switched off.	The appliance leaves a puddle on the floor because you did not move it while switching it off. This is normal.	The appliance can leave a small puddle of water on the floor if you do not move the appliance while switching it off. You can reduce the size of the puddle by moving the appliance while switching it off. When you switch off the appliance, it will switch to water absorption mode <b>3</b> for 4 seconds to clean up any water remaining in the nozzle. If needed, you can remove the last drops with a cloth.
	The appliance is dripping when carrying it over the floor (holding it in the air).	While cleaning, do not lift the AquaSpin nozzle from the floor, as this leaves water traces. Only move forwards and backwards. It is also recommended to use water absorption mode <b>3</b> when lifting the appliance over a threshold, carpet or stairs. This will prevent dirty water from dripping out of the AquaSpin nozzle.
	Water leaks from the clean water tank because you overfilled the clean water tank.	Do not fill the clean water tank beyond the MAX indication. If you do, water may spill from the clean water tank when you fasten the cap.
	There is a crack in one of the tanks.	If one of the tanks is damaged, take it to a Philips service center or contact the Consumer Care Center.
I cannot remove the microfiber brushes.	Hair and/or dirt is entangled in the microfiber brushes.	Use the cleaning brush handle to remove the microfiber brushes from the AquaSpin nozzle. Remove entangled hair or dirt. If it is difficult to pull the brushes out, you can give them a push from below the AquaSpin nozzle.
I cannot move the appliance forward or backward.	One or more wheels may be blocked by a small object.	Switch off the appliance and remove the nozzle. Then check the small and the big wheels for blockage. Remove any object that could block the wheel(s). Put the appliance upright again and resume cleaning.
The appliance has a lower suction power than usual.	The water channel of the wet module and/or AquaSpin	Use the cleaning brush and clean the water channel of the wet module and/or

<b>Problem</b>	<b>Possible cause</b>	<b>Solution</b>
	nozzle is polluted or blocked.	AquaSpin nozzle (see 'Removing blockages from the appliance').
	The mesh in the dirty water tank was not dry enough before being used again.	Clean and dry the dirty water tank.
	Hair entanglement on the microfiber brushes.	Switch the appliance off and remove the hair from the microfiber brushes.
	The dirty water tank is not placed correctly.	Place the dirty water tank into the appliance properly. It is closed correctly when you can hear a 'click' sound.
The microfiber brushes do not turn anymore	The microfiber brushes are clogged with hair or dirt.	Clean the microfiber brushes with a pair of scissors or by hand.
The microfiber brushes pop out.	The microfiber brushes are not locked correctly.	Place the microfiber brushes back in the right position and lock them.
The appliance is not charging.	The power plug is not connected properly to the socket or the adapter is not inserted into the wall socket properly.	Make sure that the power plug is connected properly to the socket and that the adapter is inserted into the wall socket properly.
	Wrong adapter connected.	Please use the original adapter.
		If you have checked the above and the appliance still does not charge, take it to a Philips service center or contact the Consumer Care Center.
Error code 'E2' appears on the display.	The temperature is too low.	Make sure the temperature in the room where the appliance is used, stored, or charged is above 5 °C. If the device is used and stored at the correct temperature and still shows the error code, please take it to a Philips service center or contact the Consumer Care Center.
Error code 'E3' appears on the display.	The temperature is too high.	Make sure the temperature in the room where the appliance is used, stored, or charged is below 35 °C. Do not expose the device to direct sunlight or high temperatures (near hot stoves, in microwave ovens, or on induction cookers). If the device is used and stored at the correct temperature and still shows the error code, please take it to a Philips service center or contact the Consumer Care Center.

# 目录

说明	29
基本说明	29
首次使用之前	30
充电	31
对硬地板进行吸尘和拖地	32
显示图标及其含义	45
更换	47
故障处理方法	48

## 说明

感谢购买此款飞利浦产品！为了让您能充分享受飞利浦提供的支持，请在 [www.philips.com/MyAquaTrio7000s](http://www.philips.com/MyAquaTrio7000s) 上注册您的产品

## 基本说明

- 1 开/关按钮
- 2 + 和 - 按钮
- 3 AUTOCLEAN 按钮
- 4 带密封盖的充电插座
- 5 净水箱
- 6 污水箱
- 7 AquaSpin 吸嘴
- 8 微纤维毛刷
- 9 手柄
- 10 清洁刷
- 11 适配器
- 12 电源插头
- 13 飞利浦地板清洁剂 XV1792
- 14 清洁后装置和收纳座
- 15 产品支架
- 16 清洁后托盘
- 17 底板

## 首次使用之前

### 组装清洁后装置和收纳座

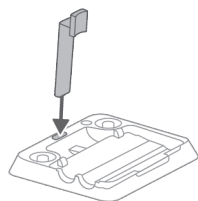

为了使用自动清洁功能或在清洁后装置和收纳座上存放产品并为其充电，需要先将产品支架卡入底板来组装收纳座。

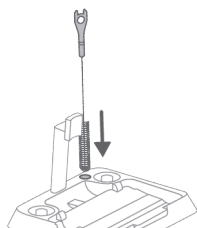

**i** 注意：请确保将清洁后托盘放在底板中，并且产品存放、充电和清洁所在的房间温度介于 5 ° C 到 35 ° C 之间。

**i** 注意：您也可以将清洁刷存放在清洁后托盘中。



**1** 组装产品时，将手柄嵌入机体即可（可听到“咔哒”一声）。

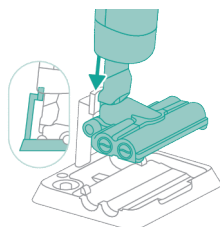

**2** 存放产品时，可将其置于清洁后装置和收纳座中。将产品滑到产品支架上，使产品支架末端插入产品中。

如要拆解产品，请按照以下步骤进行操作：

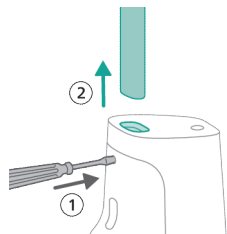

1 将销/平头螺丝刀插入产品背部的孔中，然后向上拉手柄。



2 继续将螺丝刀推入孔中，并将手柄从产品中抽出。

## 充电

本产品配备 25 V 锂电池。充电需 4 小时。

1 为产品充电时，请打开产品背部的密封盖。



2 将电源插头插入产品背面的插孔。然后，将适配器插入插座。

3 屏幕上会闪烁 0% 到 90% 之间的数值，表示产品正在充电。





- 4 当产品充满电时，屏幕上会亮起数值 100%。几分钟后，显示屏将关闭。

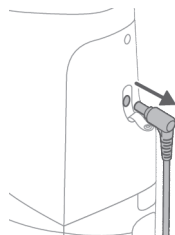

- 5 将产品背面插孔上的电源插头拔出。



- 6 合上密封盖。

**⚠ 警告：** 产品存放和充电时的环境温度应高于 5° C 且低于 35° C。

**💡 提示：** 可在清洁后装置和收纳座中对本产品进行充电。

**💡 提示：** 可以在方便的地方单独为本产品充电。

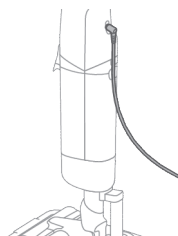

## 对硬地板进行吸尘和拖地

### 使用本产品

净水箱和污水箱在交付时已安装在产品上。您可以使用本产品来清洁硬地板。

**i 注意：** 本产品适用于同时进行吸尘和拖地。拖地前无需吸尘。



本产品适用于对所有类型的硬地板（无涂层木地板除外）进行吸尘和拖地。您可以在隐蔽的小块区域试用本产品，确保产品适用于您的地板。

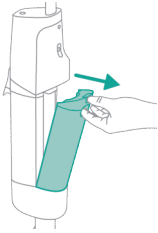

1 按下按钮，解锁净水箱并将其取下。

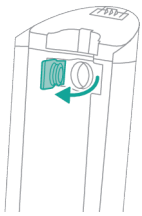

2 打开净水箱上的盖子。



3 在净水箱中加入 15 毫升 XV1792 飞利浦地板清洁剂。

**⚠ 警告：** 飞利浦仅使用 XV1792 飞利浦地板清洁剂对本产品进行了测试。其他清洁剂可能会产生大量泡沫，从而降低性能，并可能导致产品发生故障。XV1792 飞利浦地板清洁剂在部分市场有售。在使用任何其他合适的液体地板清洁剂时，最多只能在净水箱中加入 20 毫升。

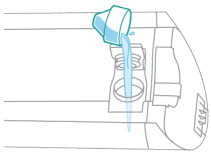

4 向净水箱中注满冷水或温自来水。



**⚠ 警告： 倒入净水箱的自来水温度不得高于 50° C。**

5 用密封盖关闭水箱。

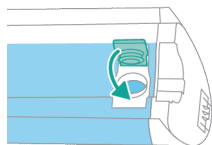

6 将净水箱放回产品内。

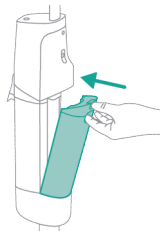

7 将产品从清洁后装置和收纳座上取下，放到地板上。用脚踩住 AquaSpin 吸嘴，然后向后拉手柄，将 AquaSpin 吸嘴解锁。此时产品已准备就绪。

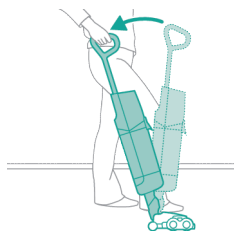

8 若要打开产品，请按开/关  按钮。产品将打开。

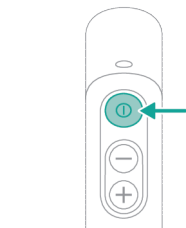

**⚠ 警告： AquaSpin 吸嘴处于解锁状态或产品打开时，本产品必须有人看管。**



## 9 使用 + 和 - 按钮在以下三种不同的设置之间进行切换：

- ③ 吸水模式
- ② 正常湿模式
- ④ 强湿模式

通过选择正常湿模式 ②，您可以使用本产品进行定期湿拖清洁。强湿模式 ④ 用于清洁更多顽固污渍。

如果清洁后地板上有水渍，可以选择吸水模式 ③ 清洁水渍。我们还建议在您提起本产品经过门槛、地毯或楼梯时使用该模式。

如果您选择吸水模式 ③，本产品将停止供水并增大吸力 45 秒以清除地板上残留的水分。

## 10 产品使用完毕后，按开/关 ⑤ 按钮关闭产品。产品将转至吸水模式 ③，持续 4 秒，清除吸嘴中残留的水分。

**i** 注意：如果在产品关闭的状态下将其保持不动，它可能会在地板上留下一小滩水。可在产品关闭时移动产品，以此来缩小这滩水的范围。若有需要，可以用干布擦去最后几滴水。

## 主动保护系统

- 本产品配有主动保护系统。该主动保护系统可识别出从地板上吸取了异物，而非污垢或液体。
- 激活该系统后，产品将会关闭，并且显示屏上会显示 i3 消息 (请参见 '显示图标及其含义')。主动保护系统也可能在以下三种情况下激活：微纤维毛刷太湿、产品移到地毯或毯子上，或者产品移到未正确贴合的地板上。

## 提示和其他重要信息

- 拖地前无需吸尘，因为本产品会主动对硬地板进行湿拖清洁，以吸走液体和污渍等各种污垢。
- 本产品可以像吸尘器一样移动。要去除顽固污渍，请按下清洁模式按钮激活强湿模式 ④，然后缓慢移动本产品清理污渍。
- 关闭产品时，它可能会在地板上留下一小滩水。在关闭产品时移动产品，可缩小地板上的水渍范围，以此来缩小这滩水的范围。若要提起本产品经过门槛、地毯或楼梯，也建议使用吸水模式 ③。这样可以防止污水从 AquaSpin 吸嘴中滴出。

- 为防止地板上留下水迹，请尝试减小转动产品的力度，并避免向侧边移动产品。
- 移动产品时，建议伸展手臂，以减少不必要的肌肉紧张。使用该姿势进行清洁，可以更好地控制本产品，清洁过程也更加舒适。

## 使用限制

- 本产品适用于对所有类型的硬地板（无涂层木地板除外）进行吸尘和拖地。
- 本产品适合用于定期清洁硬地板。使用本产品时，请务必遵循硬地板的清洁说明。
- 如果要在净水箱的水中加入除了 XV1792 飞利浦地板清洁剂以外的液体地板清洁剂，请确保使用像 XV1792 飞利浦地板清洁剂一样可在水中稀释的低泡沫或无泡沫液体地板清洁剂。
- 由于净水箱容量为 700 毫升，只需在水中加入少量（最多 15 毫升）液体地板清洁剂即可。
- 如果在油毡地板上使用本产品，请仅在正确贴合的油毡地板上使用，防止油毡吸入到 AquaSpin 吸嘴中。
- 切勿使用本产品清洁地毯。
- 如果您在产品关闭时在地毯或毯子上移动/抬起产品，污水滴可能会落到地毯或毯子上。
- 请勿在对流加热器的地板栅格上推动本产品。在栅格上移动本产品时，由于本产品无法清扫吸嘴中流出的水，水将进入对流孔的底部。
- 清洁时，请勿将 AquaSpin 吸嘴从地板上提起或将 AquaSpin 吸嘴侧向移动，转动请勿过于剧烈，否则会留下水迹。

**i** 注意：运行时间取决于清洁期间所使用的功率大小。

## 清洁产品

### 每次使用后执行 AUTOCLEAN

为防止异味和水垢沉积，请在每次使用后运行 每次使用后执行自动清洁 功能。每次使用后执行 自动清洁 模式可帮助您在大约 4 分钟内清洁整个产品。

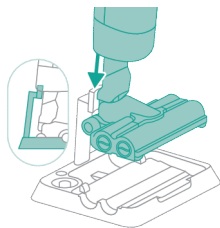

- 1 将本产品放在清洁后装置和收纳座中。将产品滑到产品支架上，使产品支架末端插入产品中。

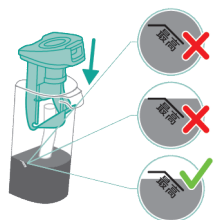

**i** 注意：如果污水箱中水位高于 AUTOCLEAN 水位标示，请倒空污水箱。如无需倒空污水箱，可跳过以下步骤，前进到第 6 步。

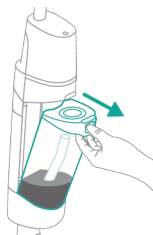

- 2 按下按钮，解锁污水箱并将其取下。



- 3 从污水箱中取出湿式滤网。

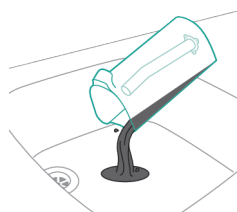

- 4 将污水箱中的水倒入水槽中。

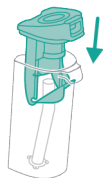

5 将湿式滤网放回污水箱上。

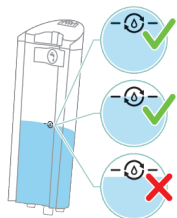

6 如果净水箱中水位低于 AUTOCLEAN 水位标示，请向净水箱中注水。如无需注水，可跳过以下步骤，前进到第 12 步。

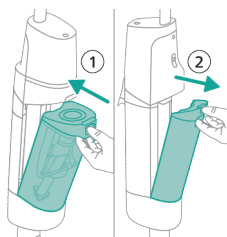

7 将空的污水箱放回产品中，然后取出净水箱。

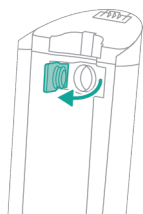

8 打开净水箱上的密封盖。

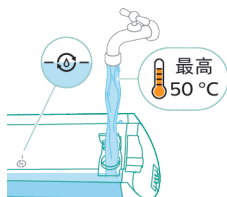

9 向净水箱中注入冷水或温自来水，至少达到自动清洁水位标示。

**⚠ 警告：** 倒入净水箱的自来水温度不得高于 50° C。

**⚠ 警告：** 自动清洁时请勿使用清洁剂，否则可能会产生过多泡沫。

**10** 使用密封盖关闭净水箱。

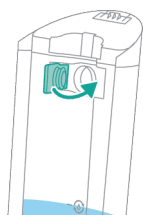

**11** 将净水箱放回产品内。

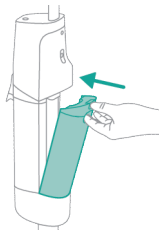

**12** 为产品充电。将电源插头插入产品背面的插孔。然后，将适配器插入插座。

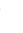

**13** 要启动 AUTOCLEAN 周期，请按下 AUTOCLEAN  按钮。如果出现黑屏，请先按开/关  按钮激活屏幕。

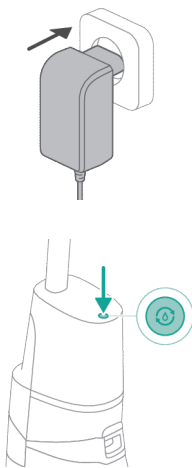

自动清洁  
AUTOCLEAN



**14** 本产品将执行自动清洁周期。

**i** 注意：自动清洁周期大约持续 4 分钟。为了获得最佳效果，请让产品完整运行自动清洁周期。可以随时暂停或取消自动清洁周期。

**i** 注意：如果取消自动清洁程序，本产品会在约 10 秒的时间内吸出清洁后托盘中残留的水。

**15** 按下按钮，解锁污水箱并将其取下。

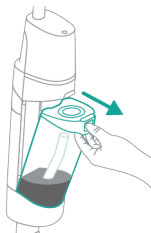

**16** 从污水箱中取出湿式滤网。



**17** 将污水箱中的水倒入水槽中。

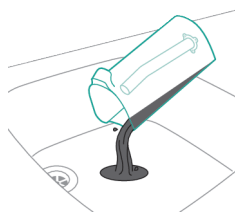

**18** 在水龙头下清洗污水箱。





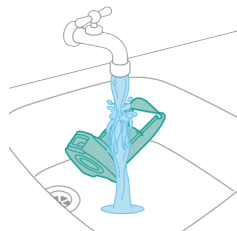

**19** 在水龙头下清洗湿式滤网。



**20** 将污水箱的湿式滤网及其水流部件完全晾干，然后再将其放回污水箱。

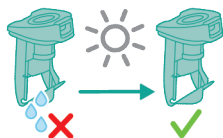

**21** 将湿式滤网放回污水箱上。

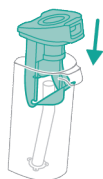

**22** 将污水箱放回产品内。



**23** 逆时针转动微纤维毛刷 (1)，然后将其从双刷吸嘴上取下 (2)。

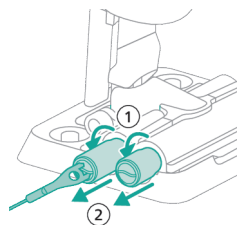

 提示：如果难以取出微纤维毛刷，可以使用清洁刷手柄来拆下微纤维毛刷。

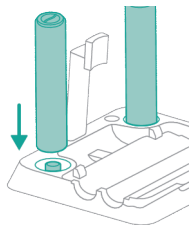

**24** 为了让微纤维毛刷变干，请将毛刷的开口端放在清洁后装置和收纳座的指定支架上。

**i** 注意：可能需要大约 24 小时才能完全晾干。

### 清理清洁后托盘

如果清洁后托盘变脏，可以按照以下步骤进行清洁。

**1** 从收纳座中取出清洁后托盘。

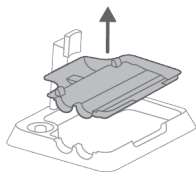

**2** 在水龙头下冲洗清洁后托盘并将其晾干，然后再将其放回收纳座。

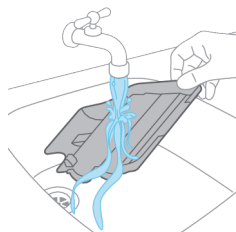

**3** 请务必始终将清洁后托盘放回收纳座。清洁后托盘对于正确执行自动清洁至关重要。

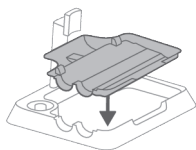

## 清洁 AquaSpin 吸嘴

- 1 逆时针转动微纤维毛刷 (1)，然后将其从 AquaSpin 吸嘴上取下 (2)。

 提示：如果难以取出微纤维毛刷，可以使用清洁刷手柄来拆下微纤维毛刷。

- 2 可以用一只手向下滑动微纤维毛刷，清除微纤维毛刷上缠绕的毛发或线头。

 提示：也可以用剪刀剪掉缠绕在微纤维毛刷周围的毛发和线头。

## 清理产品中的堵塞物

产品可能会堵塞。发生堵塞时，地板上的水会比平时多，或者无法吸起较大的污垢颗粒而落回地板上，很容易引起您的注意。请查看下文，参阅为本产品的不同部件清除堵塞物的说明。

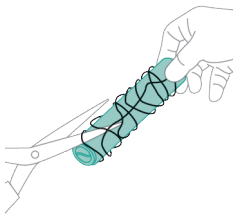
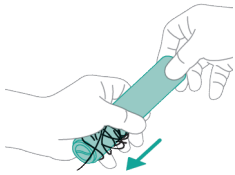
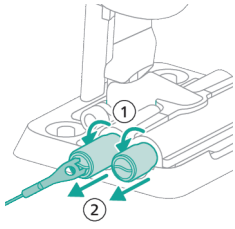

### 清理机体中的堵塞物

如果本产品堵塞，请先关闭产品并取下污水箱。然后，在机体的吸入通道中上下移动清洁刷来清除堵塞物。

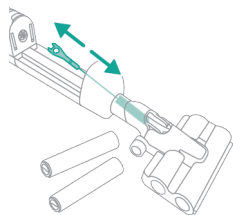

### 清理 AquaSpin 吸嘴中的堵塞物

如果 AquaSpin 吸嘴堵塞，从吸嘴上取下毛刷。然后，在 AquaSpin 吸嘴的吸入通道中上下移动清洁刷来清除堵塞物。

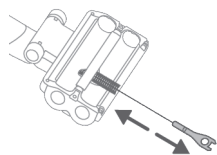

### 清理 AquaSpin 吸嘴湿金属条中的堵塞物

长时间频繁使用本产品后，AquaSpin 吸嘴的湿金属条有时可能会堵塞。请按照以下步骤清理 AquaSpin 吸嘴湿金属条中的堵塞物。

1 侧向移动湿金属条盖，将其从 AquaSpin 吸嘴上取下。

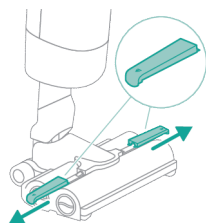

2 侧向拉出湿金属条，将其从 AquaSpin 吸嘴上取下。

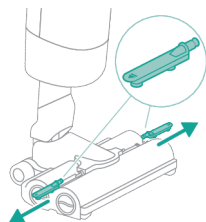

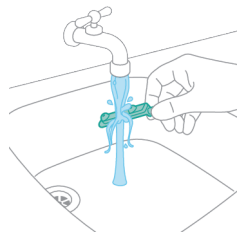

3 在水龙头下冲洗湿金属条。



4 将湿金属条晾干，然后再将其放回 AquaSpin 吸嘴中。

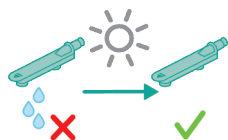

## 显示图标及其含义

错误代码

原因

解决方法

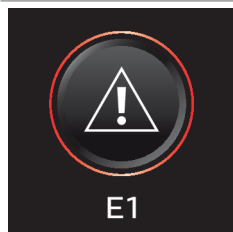

存在系统错误。

断开产品与适配器之间的连接，然后将产品重新连接到适配器。随后尝试重启产品。  
如果此方法未能解决问题，请将产品送至飞利浦服务中心或联系客服服务中心。

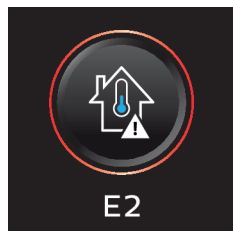

温度过低。

确保产品使用、存放或进行充电所在的房间温度高于 5 °C。如果设备在适当的温度下使用和存放，但仍显示错误代码，请将产品送至飞利浦服务中心或联系客服服务中心。

## 错误代码

## 原因

## 解决方法

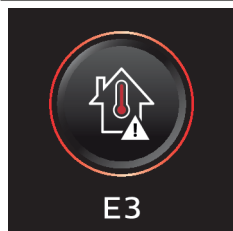

温度过高。

确保产品使用、存放或进行充电所在的房间温度低于 35 ° C。请勿将设备暴露在直射的阳光下或高温下（靠近热炉、在微波炉中或在电磁炉上）。如果设备在适当的温度下使用和存放，但仍显示错误代码，请将产品送至飞利浦服务中心或联系客户服务中心。

## 信息代码

## 原因

## 解决方法

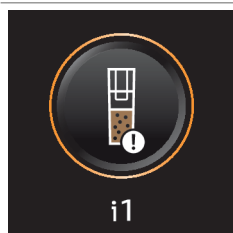

污水箱已满。

倒空污水箱。

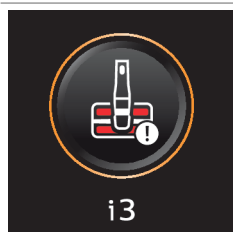

双刷吸嘴被卡住。这是一个安全保护装置，如果有异物（例如，电缆或玩具）卡在吸嘴中，会切断电源。

检查毛刷、轴承、马达部件和盖子上是否有毛发或其他障碍物，并将其清除。如果没有障碍物，关闭并重启产品可能会解决此问题。

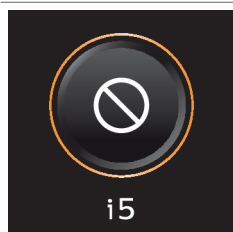

进风口堵塞。

检查进风口是否有堵塞物，并将其清除。如果这种方法无法解决问题，请检查整个空气通道中是否有堵塞物，并将其清除。即检查吸嘴、硬管和湿式滤网。



不要接电源使用。

拔下产品电源后再进行使用。否则，产品将无法启动。仅在充电和 AUTOCLEAN 模式下接通产品电源。

## 信息代码

## 原因

## 解决方法

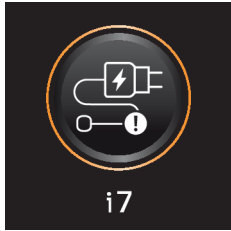

连接了错误的充电器。

只能用随附的适配器为本产品充电。请仅使用 34 伏适配器 S036-1A340100HE。可以在适配器上找到相应的适配器编号。

## 图标

## 含义



AUTOCLEAN



需要更换微纤维毛刷。

## 更换

如需购买附件或备件，请访问 [www.philips.com/parts-and-accessories](http://www.philips.com/parts-and-accessories) 或联系您的飞利浦经销商。您还可以联系所在国家/地区的飞利浦客户服务中心（请参阅保修卡了解详细联系信息）。

替换部件和型号：

- 飞利浦地板清洁剂 XV1792
- 替换微纤维毛刷 XV1793

每 6 个月更换一次微纤维毛刷，确保获得最佳性能。

**i** 注意： 可以将旧微纤维毛刷与一般生活垃圾一起弃置。

## 故障处理方法

本章归纳了使用本产品时最常见的一些问题。如果您无法根据以下信息解决问题，请访问 [www.philips.com/support](http://www.philips.com/support) 查阅常见问题列表，或联系您所在国家/地区的客户服务中心。

问题	可能的原因	解决方法
按下开/关  按钮启动产品。	电池已耗尽。	给电池充电时，请将本产品与充电器连接 (请参见 '充电')。
	未将产品从清洁后装置和收纳座中取出。	将本产品从清洁后装置和收纳座中取出，然后再启动产品。
	多次按下开/关  按钮。	请稍等片刻，然后再按一次开/关  按钮。
	产品堵塞。	关闭产品。然后，找出并排除堵塞原因 (请参见 '清理产品中的堵塞物')。随后重启产品。如果无法确定堵塞原因，请重启本产品。这可能会解决此问题。
	微纤维毛刷卡住。	取出微纤维毛刷。然后，找出并排除堵塞微纤维毛刷的原因。之后将微纤维毛刷放回 (请参见 '清洁 AquaSpin 吸嘴')。  提示：如果难以取出微纤维毛刷，可以使用清洁刷手柄来拆下微纤维毛刷。
产品停止工作。	不小心用手触碰到了开/关  按钮。	按下开/关  按钮启动产品。
	污水箱可能已满。在这种情况下，屏幕上会显示信息图标 (请参见 '显示图标及其含义')。	倒空污水箱。
	产品堵塞。	关闭产品。然后，找出并排除堵塞原因 (请参见 '清理产品中的堵塞物')。随后重启产品。如果无法确定堵塞原因，请直接重启设备。这可能会解决此问题。



问题	可能的原因	解决方法
地板不像平常那么湿，或者吸嘴下方一侧的地板没有另一侧地板那么湿。	一个或两个湿金属条堵塞。	将两个微纤维毛刷取下，向净水箱中注入一些水，然后启动产品。在同一位置前后小幅度移动约 15 秒的时间。您应该能在地板上看到四条水痕。如果并非如此，或者在一条或多条水痕上只有几滴水，这表示湿金属条部分堵塞或完全堵塞，可将其放在水龙头下冲洗。如果问题未解决，可以尝试用针小心地将孔疏通开。
地板上没有水。	净水箱已空。 湿金属条堵塞。	为净水箱重新加水。 将两个微纤维毛刷取下，向净水箱中注入一些水，然后启动产品。在同一位置前后小幅度移动约 15 秒的时间。您应该能在地板上看到四条水痕。如果并非如此，或者在一条或多条水痕上只有几滴水，这表示湿金属条部分堵塞或完全堵塞，可将其放在水龙头下冲洗。如果问题未解决，可以尝试用针小心地将孔疏通开。
		如果已执行上述检查，但地板上仍然没有水，请将产品送至飞利浦服务中心或联系客服服务中心。
地板上或清洁后托盘中的水比平常多。	湿拖模块和/或 AquaSpin 吸嘴的水道受到污染或堵塞。	使用清洁刷清洁湿拖模块和/或 AquaSpin 吸嘴的水道 (请参见 '清理产品中的堵塞物')。
	污水箱未放好。	将污水箱正确地放入产品中。当听到“咔哒”一声，就表示污水箱盖好了。
产品在地板上留下水迹。	您向侧边移动了产品。	只能前后移动产品。
	产品转动过于剧烈。	请尝试更轻微地转动产品。

问题	可能的原因	解决方法
	您在产品启动时将产品移过了门槛。	确保微纤维毛刷与地板保持接触。在提起本产品经过门槛、地毯或楼梯前，  请确保吸水模式已开启，以防在地板上留下水迹或水从 AquaSpin 吸嘴中溅出。
	关闭产品后，立即将其从地板上提起。	开启吸水模式  吸收残留的水。产品关闭前，在吸水模式激活状态下前后  移动本产品数次。如果在关闭产品后，立即将其提起，毛刷之间残留的水分会在地板上留下水迹。
	滚轮堵塞。	检查滚轮的运行状况。清除堵塞滚轮的污垢。
产品的清洁效果没有以前好。	净水箱已空。	为净水箱重新加水。
	水条堵塞。	将两个微纤维毛刷取下，向净水箱中注入一些水，然后启动产品。在同一位置前后小幅度移动约 15 秒的时间。您应该能在地板上看到四条水痕。如果并非如此，或者在一条或多条水痕上只有几滴水，则水条部分堵塞或完全堵塞，可将其放在水龙头下冲洗。如果问题未解决，可以尝试用针小心地将孔疏通开。
	AquaSpin 吸嘴内部太脏。	先运行 AUTOCLEAN 程序，然后再继续清洁。如果吸嘴的边缘有污垢堆积，请将其清除。每次使用后，请务必运行 AUTOCLEAN 功能。
	没有放入微纤维毛刷。	将微纤维毛刷放入 AquaSpin 吸嘴中。
		如果已执行上述检查，但产品的清洁效果仍然不好，请将其送至飞利浦服务中心或联系客服服务中心。

问题	可能的原因	解决方法
大块污垢无法再吸入，而是落回到地板上。	湿拖模块和/或 AquaSpin 吸嘴的水道受到污染或堵塞。	使用清洁刷清洁机体和/或 AquaSpin 吸嘴的水道 (请参见 '清理产品中的堵塞物')。
地板干后出现痕迹。	可能用了太多清洁剂。 滚轮脏了。	确保清洁剂用量正确。 清除滚轮上的污垢。
清洁时有太多泡沫，AUTOCLEAN 期间也是如此。	可能用了太多清洁剂。	确保清洁剂用量正确。
	地板上仍有清洁剂残留。	在不使用清洁剂的情况下，清洁地板数次。稍等片刻再重新擦拭此污渍。
很难清理污渍。	可能用水量太少，或者清理污渍的时间太短。	洒上水后稍等片刻。例如，可以使用本产品擦拭污渍，先洒上水，然后在清洁阶段结束时再清理此污渍。
清洁时，产品声音发生改变。	可能有毛发或其他障碍物缠绕在微纤维毛刷周围。	取下微纤维毛刷，检查毛刷上是否有障碍物，并将其清除。
显示屏显示污水箱已满 (代码: i1)，然后关闭，但污水箱并未满。	污水箱中可能有泡沫或污染物。	请重启产品。如果这种方法无法解决问题，请清洁污水箱。如果问题是有泡沫，请确保使用的清洁剂不超过推荐用量。
产品关闭后，有水滴出。	由于在产品关闭时您将其保持不动，因此会在地板上留下一滩水。这是正常现象。	如果在产品关闭的状态下将其保持不动，它可能会在地板上留下一小滩水。可在产品关闭时移动产品，以此来缩小这滩水的范围。产品关闭后，将转至吸水模式， <b>3</b> 持续 4 秒，清除吸嘴中残留的水分。若有需要，可以用干布擦去最后几滴水。
	您拿着本产品走过地板时 (在空中握持产品)，有水滴落下来。	清洁时，请勿将 AquaSpin 吸嘴从地板上提起，否则会留下水迹。只能前后移动。若要提起本产品经过门槛、地毯或楼梯，也建议使用吸水模式 <b>3</b> 。这样可以

问题	可能的原因	解决方法
		防止污水从 AquaSpin 吸嘴中滴出。
	由于净水箱过满，水从净水箱中漏出。	注入净水箱的水不得超过 MAX（最高）水位标示。如果超过了，拧紧盖子时，水可能会从净水箱中溢出。
	其中一个水箱上有裂纹。	如果其中一个水箱损坏，请将其送至飞利浦服务中心或联系客服服务中心。
无法取下微纤维毛刷。	微纤维毛刷中缠绕了毛发和/或污物。	使用清洁刷手柄，从 AquaSpin 吸嘴上取下微纤维毛刷。清除缠绕的毛发或污物。如果很难将毛刷取出，可以从 AquaSpin 吸嘴下方推一下毛刷。
无法前后移动产品。	可能有小物体堵塞了一个或多个滚轮。	关闭产品并取下吸嘴。然后，检查小滚轮和大滚轮是否堵塞。清除任何可能堵塞滚轮的物体。再次将产品竖直放置，继续清洁。
本产品的吸力比往常要小。	湿拖模块和/或 AquaSpin 吸嘴的水道受到污染或堵塞。	使用清洁刷清洁湿拖模块和/或 AquaSpin 吸嘴的水道 (请参见 '清理产品中的堵塞物')。
	在污水箱中的网面未完全晾干的情况下再次使用。	清洁污水箱并将其晾干。
	微纤维毛刷上有毛发缠绕。	关闭产品，清除微纤维毛刷上的毛发。
	污水箱未放好。	将污水箱正确地放入产品中。当听到“咔哒”一声，就表示污水箱盖好了。
微纤维毛刷不再旋转	微纤维毛刷被毛发或污垢堵塞。	用剪刀或用手清洁微纤维毛刷。
微纤维毛刷弹出。	微纤维毛刷没有锁定到位。	将微纤维毛刷放回到正确的位置，并将其锁定到位。

问题	可能的原因	解决方法
产品未充电。	电源插头未正确连接到插座，或适配器未正确插入电源插座。	确保将电源插头正确连接到插座，并将适配器正确插入电源插座。
	连接了错误的适配器。	请使用原装适配器。
显示屏上出现错误代码“E2”。	温度过低。	如果已执行上述检查但产品依然无法充电，请将其送往飞利浦服务中心，或联系客户服务中心。
		确保产品使用、存放或进行充电所在的房间温度高于 5 ° C。如果设备在适当的温度下使用和存放，但仍显示错误代码，请将产品送至飞利浦服务中心或联系客户服务中心。
显示屏上出现错误代码“E3”。	温度过高。	确保产品使用、存放或进行充电所在的房间温度低于 35 ° C。请勿将设备暴露在直射的阳光下或高温下（靠近热炉、在微波炉中或在电磁炉上）。如果设备在适当的温度下使用和存放，但仍显示错误代码，请将产品送至飞利浦服务中心或联系客户服务中心。











