

# PHILIPS

## Televisión

### Guía Rápida

55OLED707/43  
65OLED707/43  
65OLED707/55

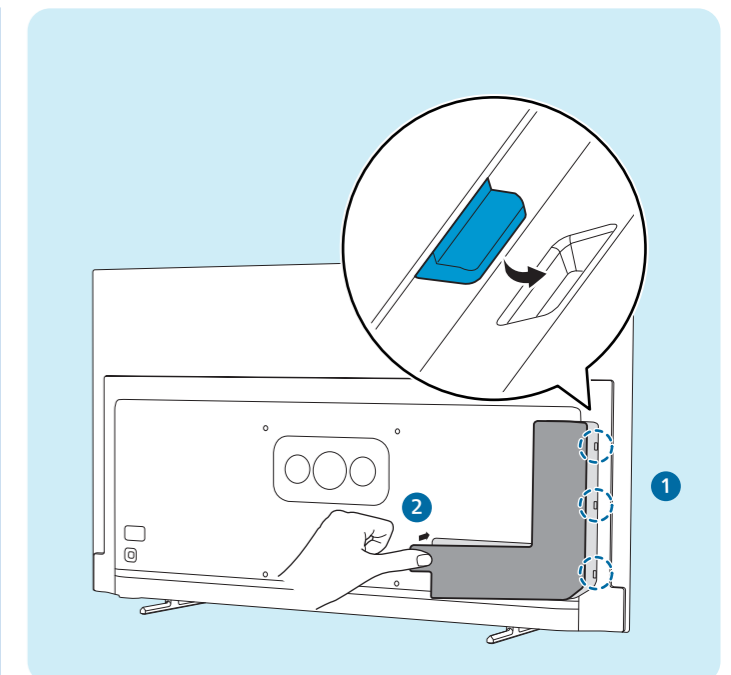
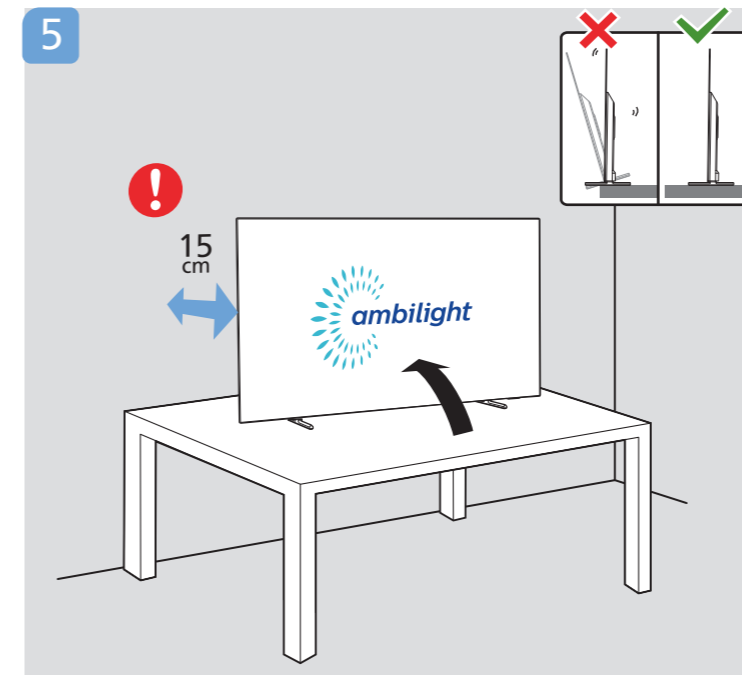
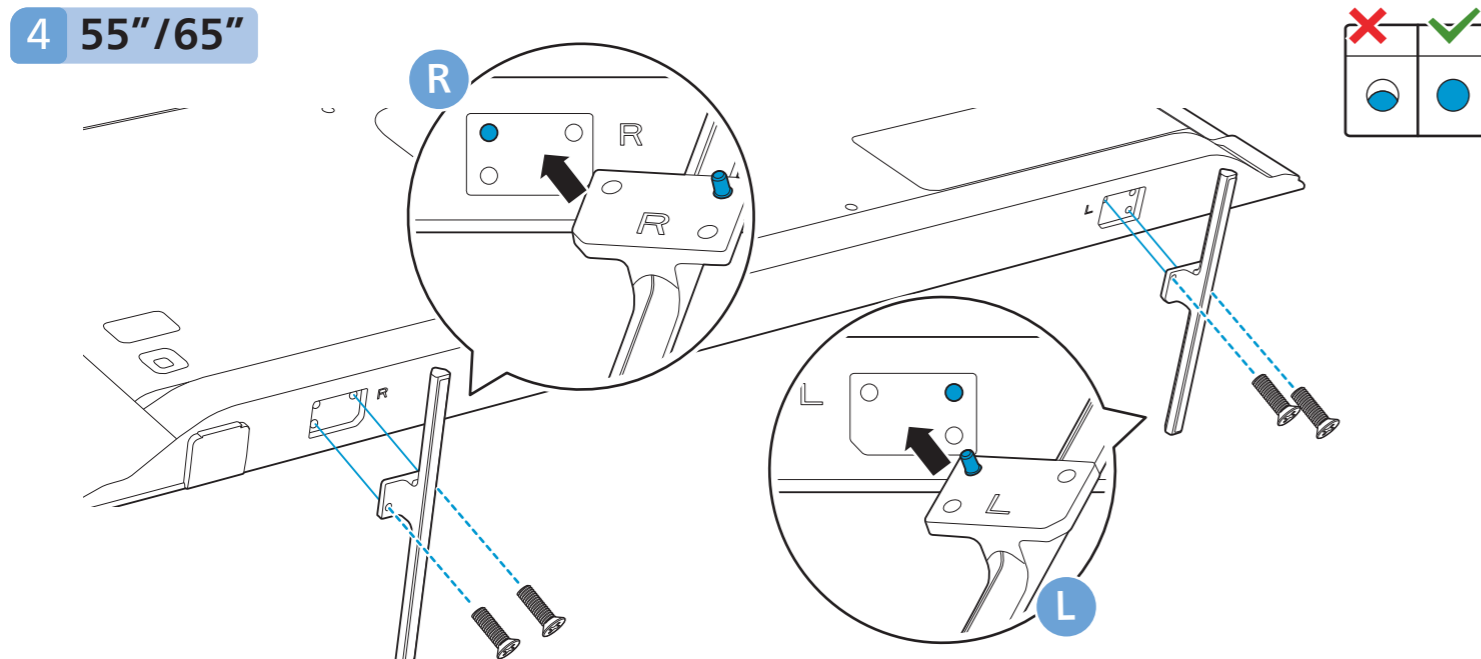
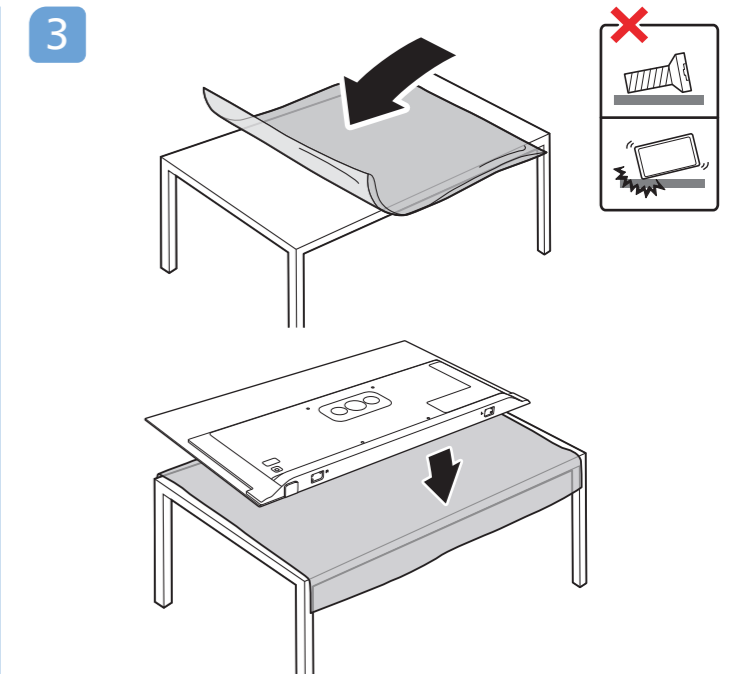
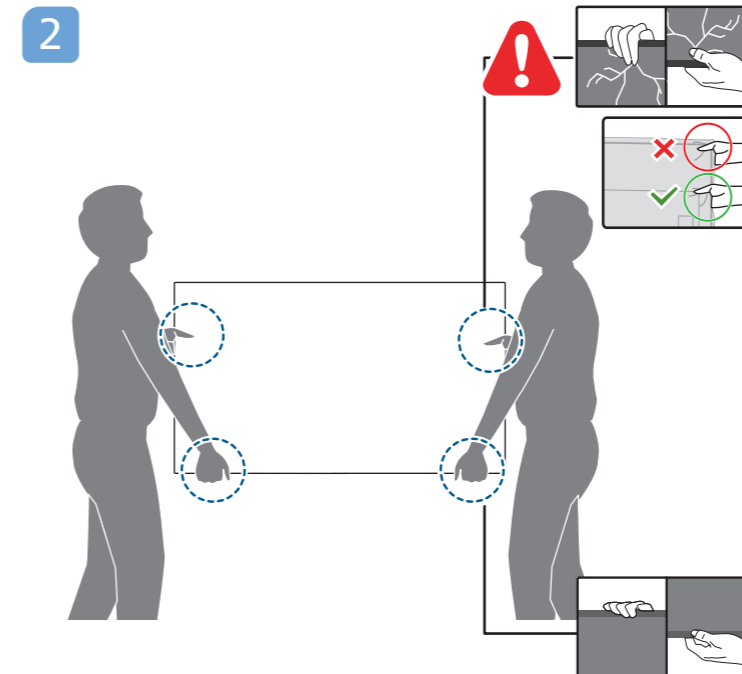
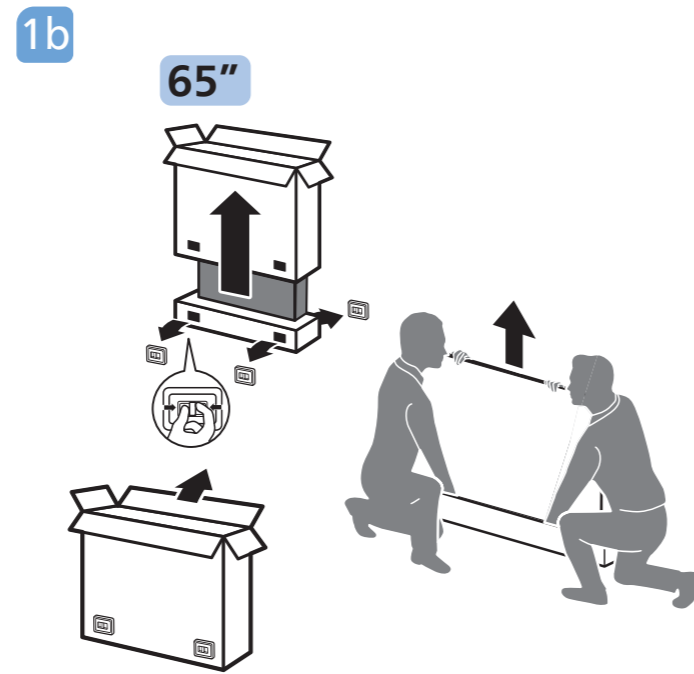
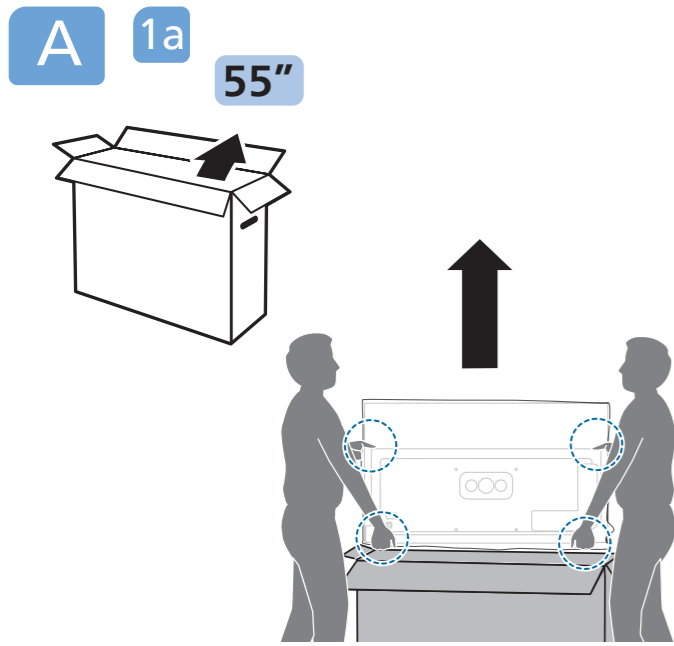
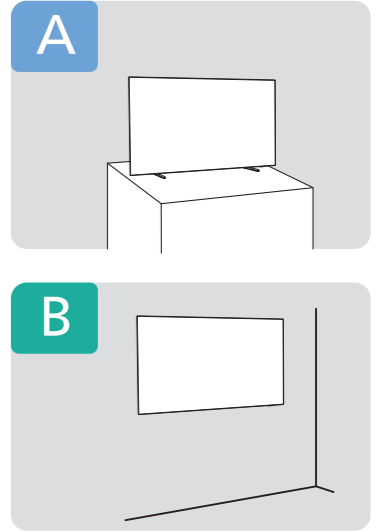
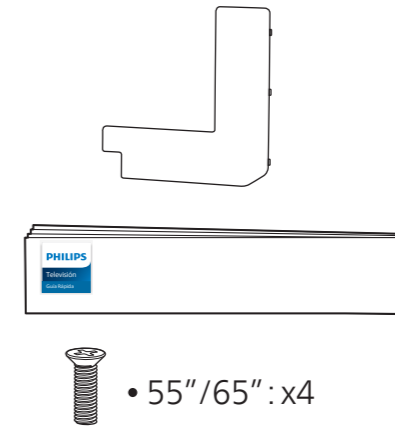
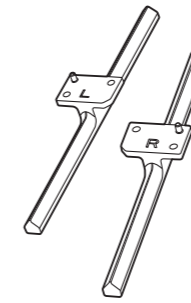
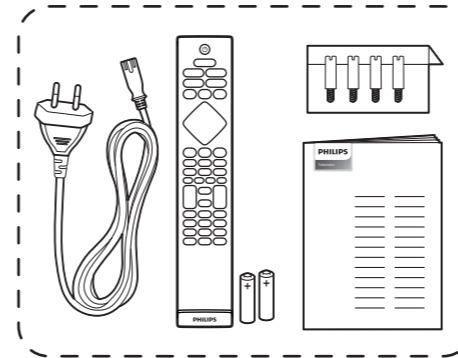
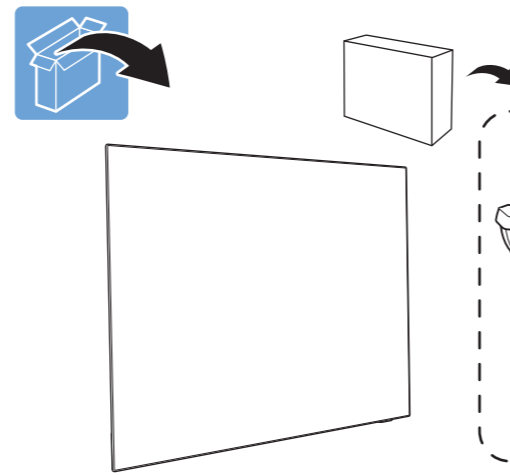

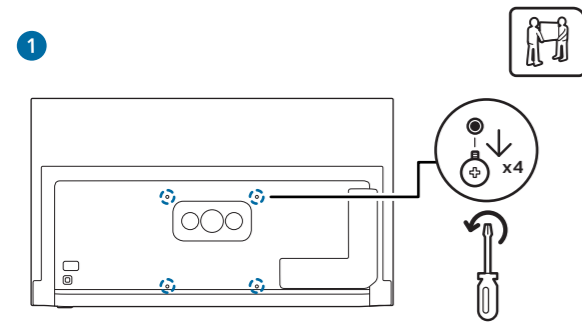
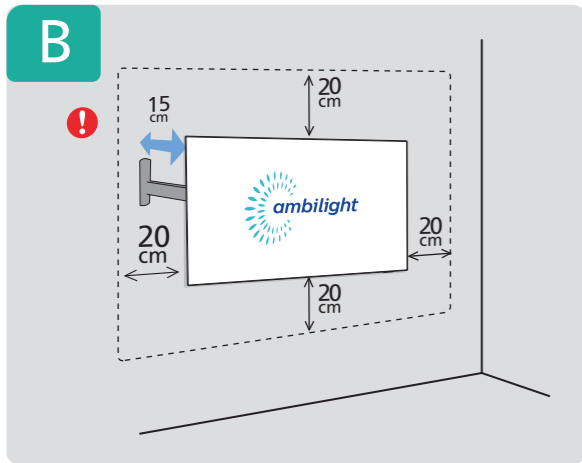

**2 VESA (x,y)**

55" 300x300mm M6 (L: 10mm~15mm)

139 cm

65" 300x300mm M6 (L: 10mm~15mm)

164 cm

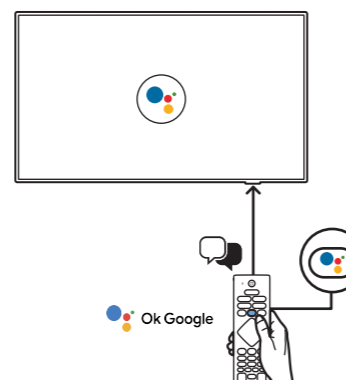
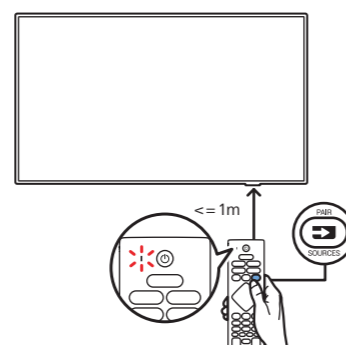
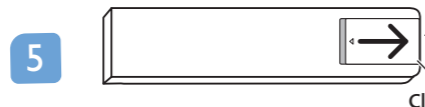
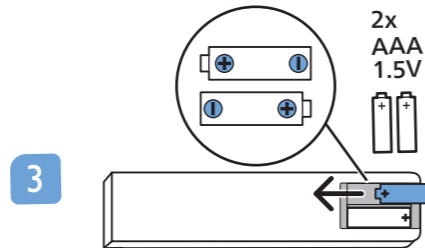
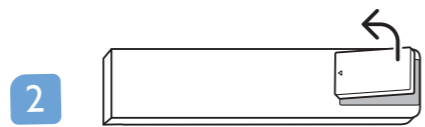
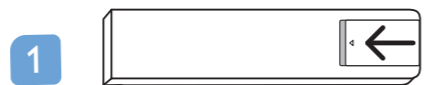
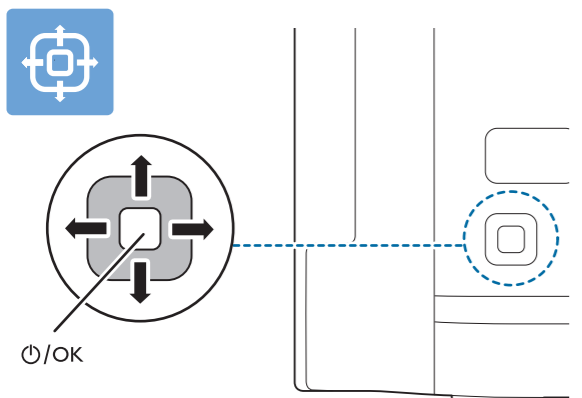
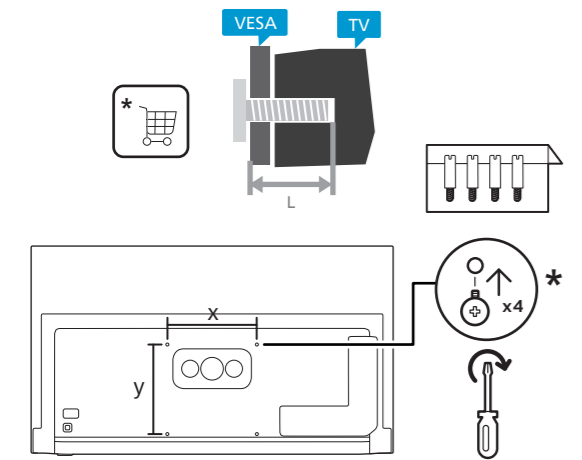

**English** Read the safety instructions.

**Español** Lea la información de seguridad.



Registre su producto y obtenga asistencia en [www.philips.com/TVsupport](http://www.philips.com/TVsupport)

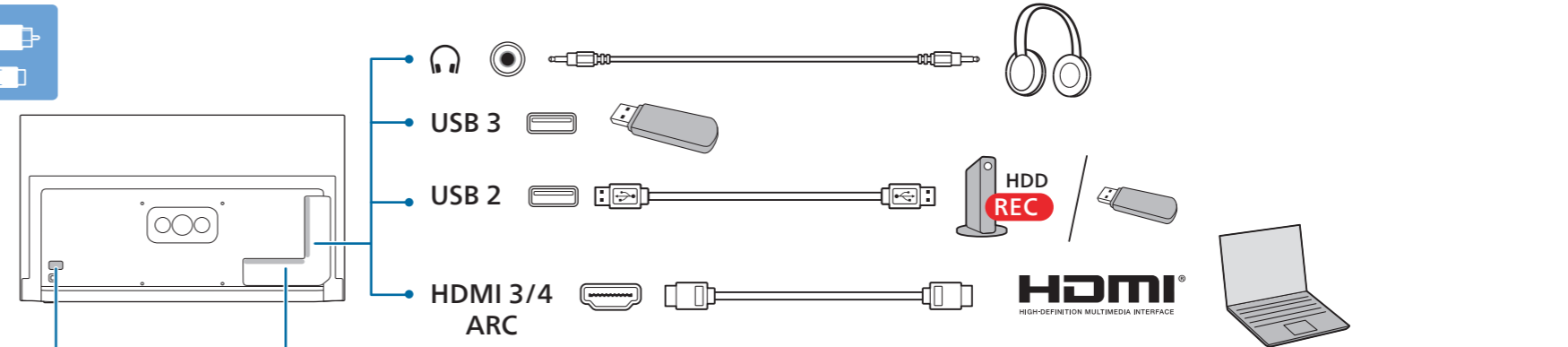
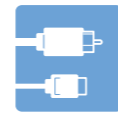
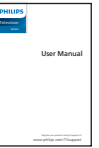
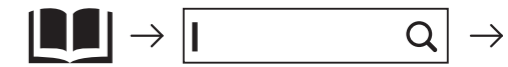

**POWER**  
(/43,/55)

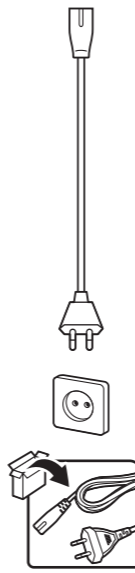

**NETWORK**

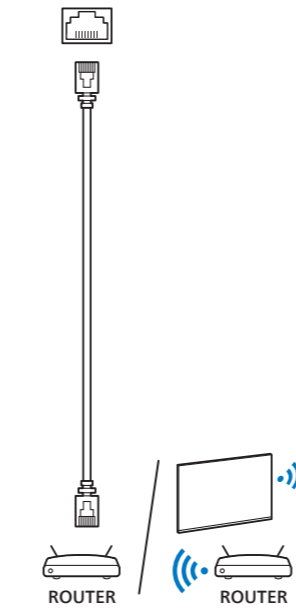

**TV ANTENNA**

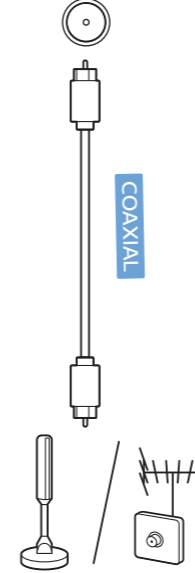

**HDMI 1 ARC**  
4K 120Hz

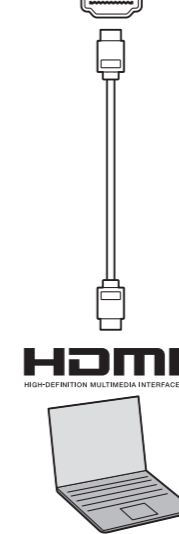

**HDMI 2 eARC**  
4K 120Hz

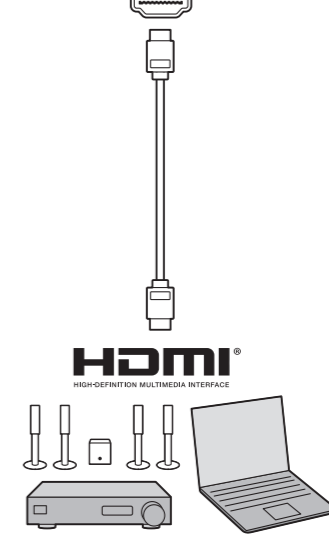

**DIGITAL AUDIO OUT**

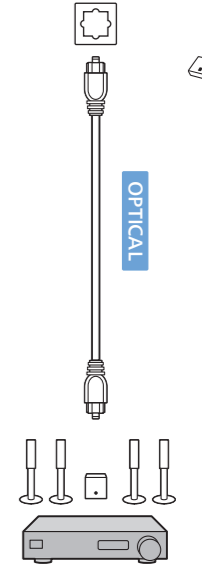

**USB 1**

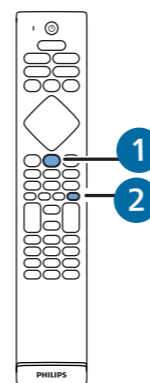
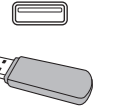

**1**

**2**

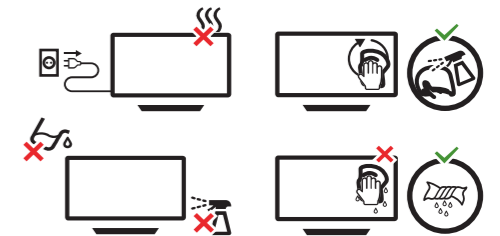
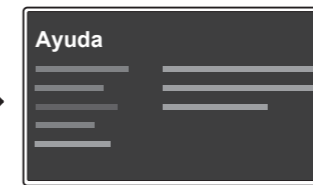

All registered and unregistered trademarks are property of their respective owners. Specifications are subject to change without notice. Philips and the Philips' shield emblem are trademarks of Koninklijke Philips N.V. and are used under license from Koninklijke Philips N.V. This product has been manufactured by and is sold under the responsibility of TP Vision Europe B.V., and TP Vision Europe B.V. is the warrantor in relation to this product. 2022 © TP Vision Europe B.V. All rights reserved. [www.philips.com/welcome](http://www.philips.com/welcome)